

**PLUMBING FIXTURE SCHEDULE**

- MC1 Floor mounted F.V. handoperated water closet, American Standard #4235, 100 Water, 6'-1/8" rim height, "Chicago" WC open-front white seat, bolt caps, Sloan Royal #11-15 flush valve, (16 gallons/flush) 1-1/4" C.N. 4" S. 4" N. 2" V.O. (See plan for trap primer accessory)
- MC2 Floor mounted F.V. handoperated water closet, American Standard #4235, 100 Water, "Chicago" WC open-front white seat, bolt caps, Sloan Royal #11-15 flush valve, (16 gallons/flush) 1-1/4" C.N. 4" S. 4" N. 2" V.O. (See plan for trap primer accessory)
- MC3 Floor mounted F.V. handoperated water closet, American Standard #4235, 100 Water, "Chicago" WC open-front white seat, bolt caps, Sloan Royal #11-15 flush valve, (16 gallons/flush) 1-1/4" C.N. 4" S. 4" N. 2" V.O. (See plan for trap primer accessory)
- MC4 Floor mounted lavatory, floor handoperated water closet, American Standard #2069, 100 Water, 3" S. 4" N. 2" V.O., 1/2" C.N. angled wall stop w/stop
- MC5 Floor mounted ADA stainless steel classroom sink, Haws # 4230ADA with # 590LF gooseneck self-closing faucet and # 5600 bucket, integral strainer, grid drain, (2) angled wall stops with supplies, 17 ga. CR, triphalphenol, 1/2" C.N. 16 bucket and faucet, 2" N. 1/2" V.O. Floor mounted cast iron mop sink, American Standard # 774000 Floorwell, # 774011 mop trap, 3/4" H.N.C.N. 3" N. 2" V.O.
- MC6 Cast iron floor drain, "J.R. Smith" # 2005 with 5" dia. bronze grate, 2" trap with primer connection, 2" N. 1/2" V.O.
- MC7 Floor mounted brass loose key hose bibb, "Acorn" # 6126 with integral vacuum breaker, 3/4" C.N.
- MC8 Wall mounted hand soap dispenser, "Acorn" # 6121 with integral vacuum breaker, 3/4" C.N.
- MC9 Wash sink, American Standard # 4835, 100 Wall hung (XV17) 2 door, single hole drains, CP 17 ga. triphalphenol, (2) 1/2" C.N. 2" N. 1/2" V.O., 2" W.C.C.
- MC10 Wall mounted dual bacterium handoperated drinking fountain, Haws # 1441, mounting plate, cast wall stop with supply to each bubbler, 2" N. 1/2" V.O.
- MC11 Wall mounted 3 bubbler cast aluminum drinking fountain with white powder coated finish, cast wall stop with supply to each bubbler, Haws # 1405 (3) 1/2" C.N. supplies, 2" N. 1/2" V.O., 2" W.C.C. Integral trap and strainer.

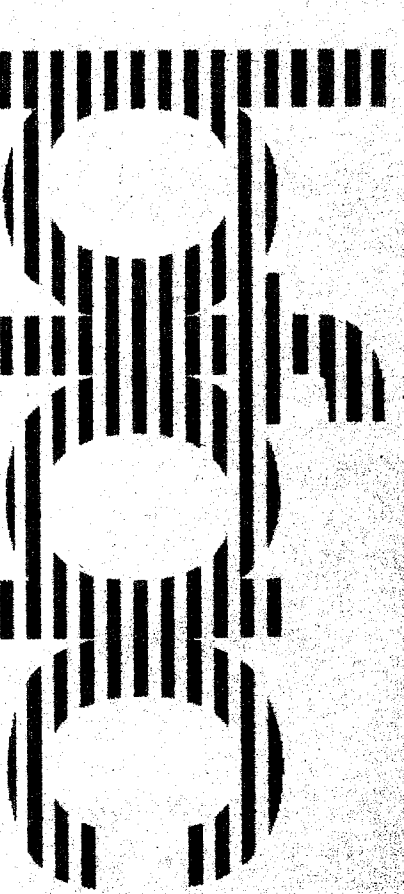

**MECHANICAL EQUIPMENT SCHEDULE**

- ME1 Ceiling exh. fan, TEMPER 24, 30, 4in. @ 1" sp., 50 watts @ 120V-1φ, 4" dia. duct to roof cap, (2) screens, 1000 rpm, speed w/ light

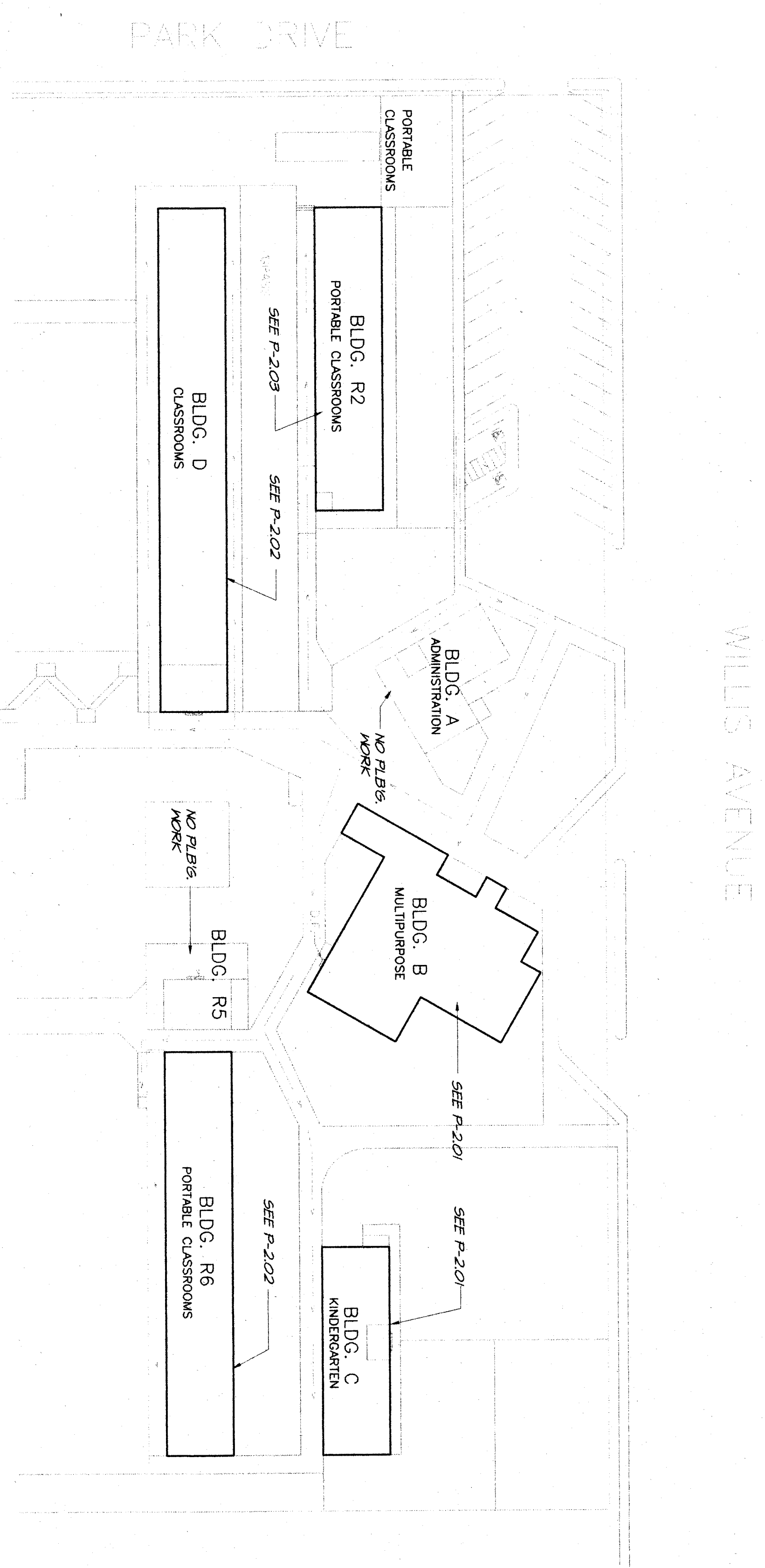

Item (11) Refer to Plumbing Drawings, Sheet P-101:  
 Add Detail (DD) to the Plumbing Fixture Schedule as follows:  
 "J.R. Smith" # 2005 with 5" dia. bronze grate, 2" trap with primer connection, 2" N. 1/2" V.O.  
 Wall mounted dual bacterium handoperated drinking fountain, Haws # 1441, mounting plate, cast wall stop with supply to each bubbler, 2" N. 1/2" V.O.

Item (11) Refer to Plumbing Drawings, Sheet P-101, specifically, Plumbing Fixture Schedule, #590LF in lieu of #590 by Haws and REVERSE bubble to #590LF in lieu of #590 by Haws.

**PLUMBING SITE PLAN**

SCALE 1" = 40'

**MDC** MECHANICAL ENGINEERING SERVICES  
 429 Thruway Avenue, Bakersfield, CA 93301  
 Tel: (805) 328-5100 Fax: (805) 328-5088

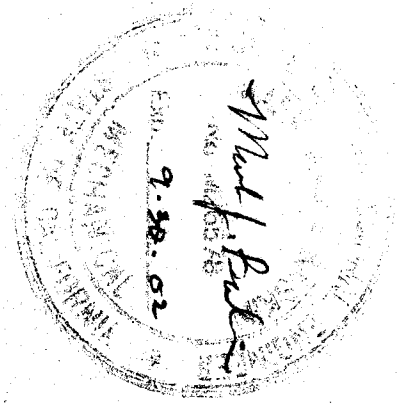

job no.	97-278
date	JUNE 17, 98
drawn by	N.O.
checked by	R.B.
copyright	1988

**PLUMBING SITE PLAN, SCHEDULE & DETAILS**

**HORT SCHOOL MODERNIZATION**  
**BAKERSFIELD CITY SCHOOL DISTRICT**  
 2301 PARK DRIVE  
 BAKERSFIELD, CA. 93306

**CFGC architects/planners inc.**  
 9500 ring avenue, suite 400, kowarsfield ca 93309-4631  
 805 836-4300 fax 805 836-4311

**JOSE OBISPO**  
 3211 broad street suite 113  
 san luis obispo, california 93401  
 805 348-0333  
 SAN JOSE  
 160 west santa clara st. suite 205  
 san jose, california 95113  
 408 924-0841

principal architect

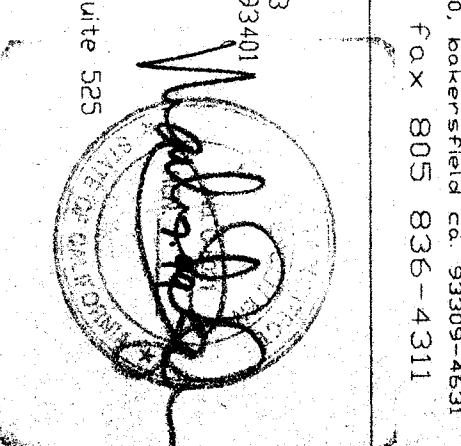

**DRYDEN ENGINEERS**  
 417 KINGSLEY ST.  
 OAKLAND, CA 94612  
 DR. DON L. DRYDEN  
 P.E. 417 KINGSLEY ST. OAKLAND, CA 94612