

WILLIS AVENUE

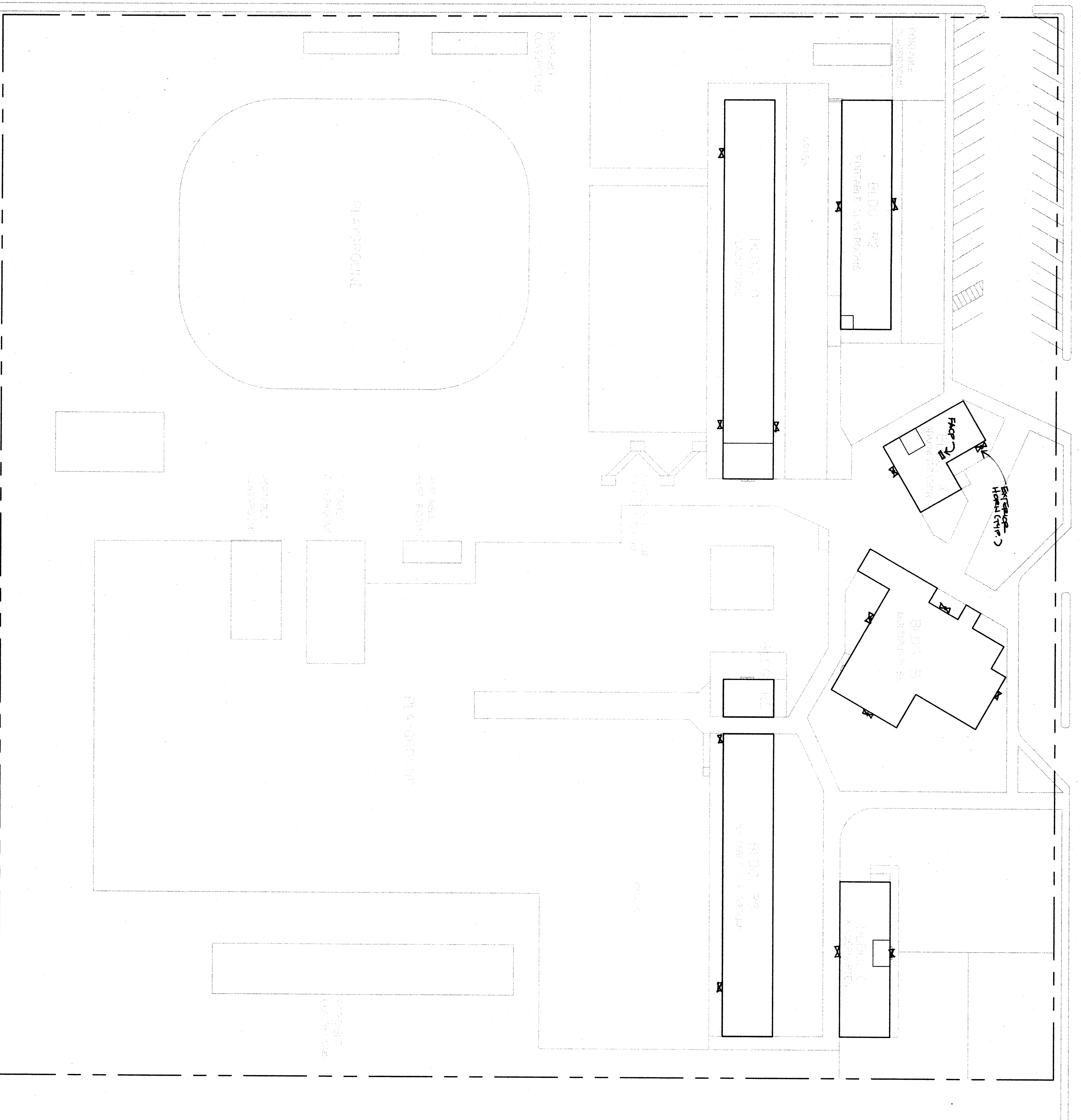

**SYMBOL SCHEDULE**

SYMBOL	NAME	DESCRIPTION
(E)	DESIGNATES EXISTING ITEM	
○	CEILING FIXTURE	SEE PLANS & FIXTURE SCHEDULE
□	WALL BRACKET FIXTURE	SEE PLANS & FIXTURE SCHEDULE
◻	RECESSED FIXTURE	SEE PLANS & FIXTURE SCHEDULE
◻	FLUORESCENT FIXTURE	SEE PLANS & FIXTURE SCHEDULE
◻	FLUORESCENT STRIP	SEE PLANS & FIXTURE SCHEDULE
○	FLOODLIGHT	SEE PLANS & FIXTURE SCHEDULE
○	ILLUMINATED EXIT SIGN	SEE PLANS & FIXTURE SCHEDULE
○	TANDUM FIXTURES WIRING CONNECTION	SEE PLANS
○	FIXTURE TYPE AND WATTAGE	SEE FIXTURE SCHEDULE
○	KEY SWITCH	20A - AC QUIET 277V +45" MAX.
○	LOCAL SWITCH, 2-POLE	20A - AC QUIET 277V +45" MAX.
○	3-WAY SWITCH	20A - AC QUIET 277V +45" MAX.
○	4-WAY SWITCH	20A - AC QUIET 277V +45" MAX.
○	SWITCH W/PILOT LITE	NEON IN TOGGLE +45" MAX.
○	MANUAL STARTER	WATTAGE AS REQUIRED
○	DIMMER SWITCH	WATTAGE AS REQUIRED
○	PHOTOCELL	20A NEMA GROUNDED +15" MIN.
○	DUPLEX CONVENIENCE OUTLET	20A NEMA GROUNDED +15" MIN.
○	CONVENIENCE OUTLET - 1/2 SW.	20A NEMA GROUNDED +15" MIN.
○	QUADRUPLIX CONVENIENCE OUTLET	20A NEMA GROUNDED +15" MIN.
○	WEATHERPROOF CONV. OUTLET	20A NEMA GROUNDED +15" MIN.
○	RANGE OUTLET	AS REQUIRED - SEE PLANS
○	SPECIAL OUTLET	
○	GROUND FAULT INTERRUPTER	
○	U.O.N.	FITTINGS AS REQUIRED
○	FLOOR OUTLET	4S BOX & FLUSH PLATE MINIMUM
○	JUNCTION BOX - AS REQUIRED	REFER TO SINGLE LINE DIAGRAM
○	ELECTRICAL SWITCHBOARD	REFER TO PANEL SCHEDULE
○	ELECTRICAL PANEL	3/4" C. MINIMUM U.O.N.
○	WIRING UNDER FLOOR OR IN WALL	3/4" C. MINIMUM U.O.N.
○	WIRING IN CEILING	
○	CONDUIT STUB AND CAP	
○	CONDUIT RISER	
○	FLEXIBLE CONDUIT	
○	NUMBER OF WASH URINS DENOTES	
○	NUMBER OF CONDUITS	
○	HOME RUN	TO RESPECTIVE PANEL OR TERM. CAB.
○	TELEPHONE FACEWAY	MINIMUM 1" CONDUIT
○	(E) CONDUIT TO REMAIN	
○	EXHAUST FAN	REFER TO MECH. PLANS & SPECS.
○	MOTOR W/DISCONNECT SWITCH	SIZE & ENCLOSURE AS REQUIRED
○	SWITCHPACK	REFER TO MECH. PLANS & SPECS.
○	TERMINAL CABINET	REFER TO MECH. PLANS & SPECS.
○	TELEPHONE OUTLET +12" MIN.	REFER TO MECH. PLANS & SPECS.
○	INTERCOM HANDSEET +48" MAX.	REFER TO MECH. PLANS & SPECS.
○	INTERCOM SPEAKER +84" MAX.	REFER TO MECH. PLANS & SPECS.
○	INTERCOM HORN	REFER TO MECH. PLANS & SPECS.
○	CLOCK (12)	DUKANE #79454
○	TV ANTENNA OUTLET	DUKANE #9431
○	COMPUTER OUTLET	DUKANE #
○	COMMUNICATION/DATA OUTLET	SINGLE GANG BOX W/BLANK PLATE
○	SURFACE FACEWAY	4 1/16" x 2 1/8" BOX WITH 1 1/2" C. ELEVATION TO CONDUIT FROM BLANK COVER
○	TELEPHONE HOME RUN	SPACE WITH NILON PULL LINES

All Electrical Equipment shall be secured or anchored to resist a horizontal force acting in any direction using the following:

Equipment on grade: 20% overhead weight

Equipment on structures: 30% overhead weight

For auxiliary mounting equipment use 4 x the values above and for simultaneous vertical forces use 1/3 x the horizontal force.

The above values are for an importance factor, I = 1.0 and seismic zone, S = 0.4.

Where anchorage details are not shown on the drawings the field installation shall be subject to the approval of the electrical engineer and the field engineer of the Division of the State Architect.

**SITE ELECTRICAL PLAN**

1" = 30'-0"

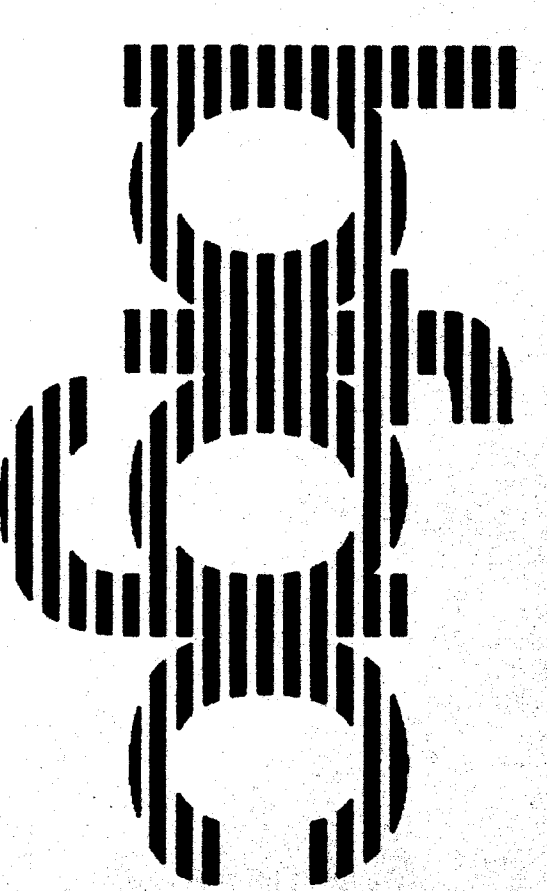
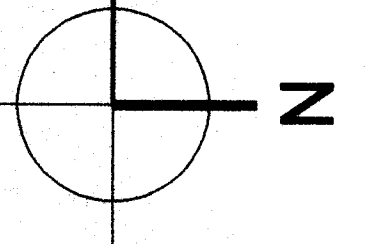

**REGISTERED PROFESSIONAL ENGINEER**  
 444 W. Colton Ave., Suite 100  
 Fresno, California 93711  
 (209) 432-4470 / (209) 432-4474 fax  
 James W. Colton, Electrical Engineer  
 EE #4101

**REGISTERED PROFESSIONAL ENGINEER**  
 5101  
 09/20/02  
 10/1/18  
 007 0 7 1994

**bjgc architects planners inc.**  
 5500 miraloma avenue, suite 450, bakersfield, ca 93309-4631  
 805 838-4300  
 fax 805 838-4311

**son luis obispo**  
 3211 bond street, suite 113  
 sonoma, california 94901  
 505 540-0433

**son jose**  
 160 west soledad drive #1, suite 52  
 san jose, california 95113  
 408 524-0541

principal architects:  
 david r. colton, aia, c-4584, dean & colton, aia, c-4180  
 mark engelstein, aia, c-4823, robert & engelstein, aia, c-10261  
 walter r. frederick, aia, c-8102, robert l. mello, aia, c-18079  
 408 524-0541

**HORT SCHOOL  
 MODERNIZATION**

**BAKERSFIELD CITY  
 SCHOOL DISTRICT**

2301 PARK DRIVE  
 BAKERSFIELD, CA 93306

**ELECTRICAL  
 SITE PLAN**

job no. 97-276  
 date MAY 12, 98  
 drawn by C.A.  
 checked by J.W.G.  
 copyright 1997

**1.00**