

LEGEND	
	(E) 2' x 4' ACOUSTIC TILE
	(E) 1' x 1' ACOUSTIC TILE
	GYPSUM BOARD CEILING (SMOOTH FINISH)
	EXISTING GYPSUM BOARD CEILING (SMOOTH FINISH) PATCH, REPAIR & PAINT
	EXPOSED ABOVE OR EXISTING CEILING TO FINISH SCHEDULE
	RECESSED ELEC. FIXTURE
	SURFACE MTD. ELEC. FIXTURE
	EXTERIOR ELEC. FIXTURE
	(E) SUPPLY AIR DIFFUSER
	(E) RETURN AIR GRILLE
	EXHAUST AIR GRILLE
	ILLUMINATED EXIT SIGN
	ARROW INDICATES DIRECT

**DEMOLITION REFLECTED CEILING PLAN BUILDING R2**

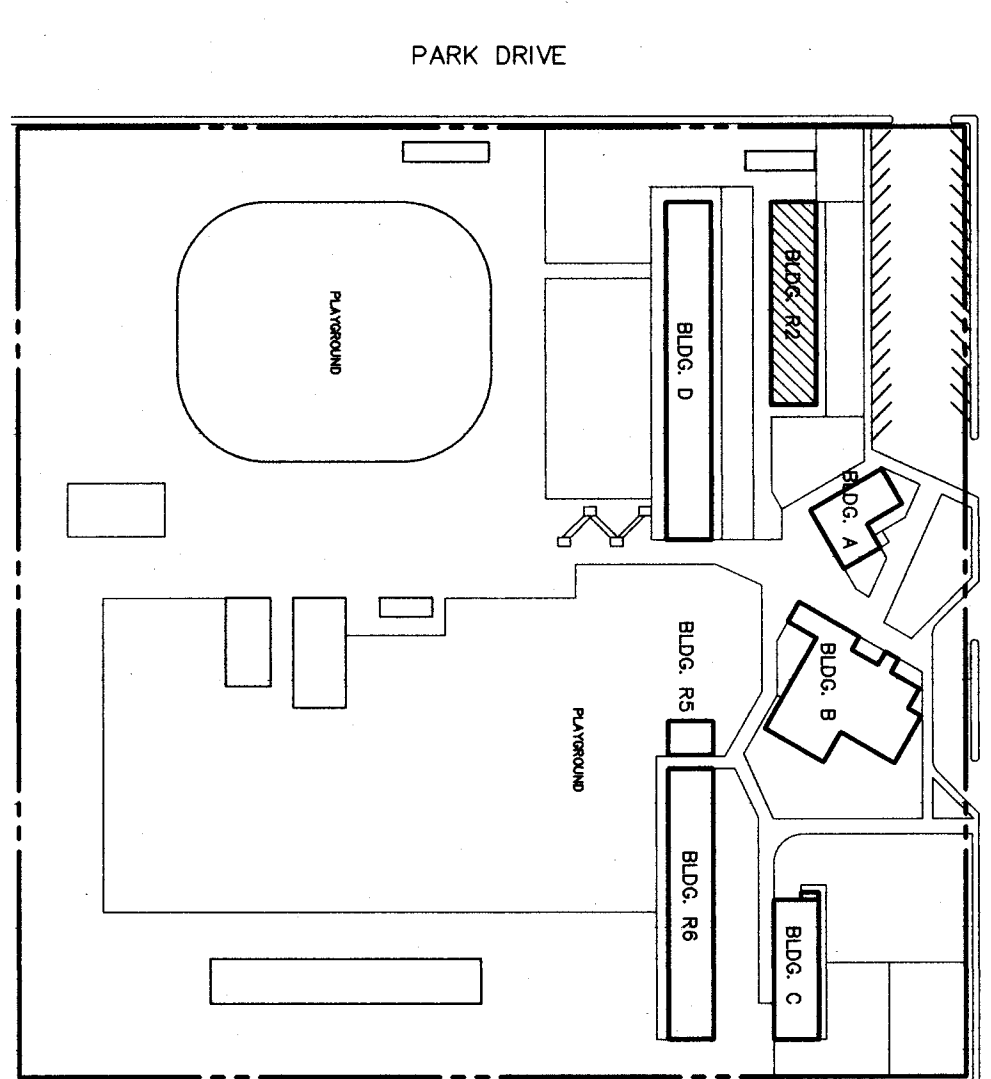

**KEY PLAN**

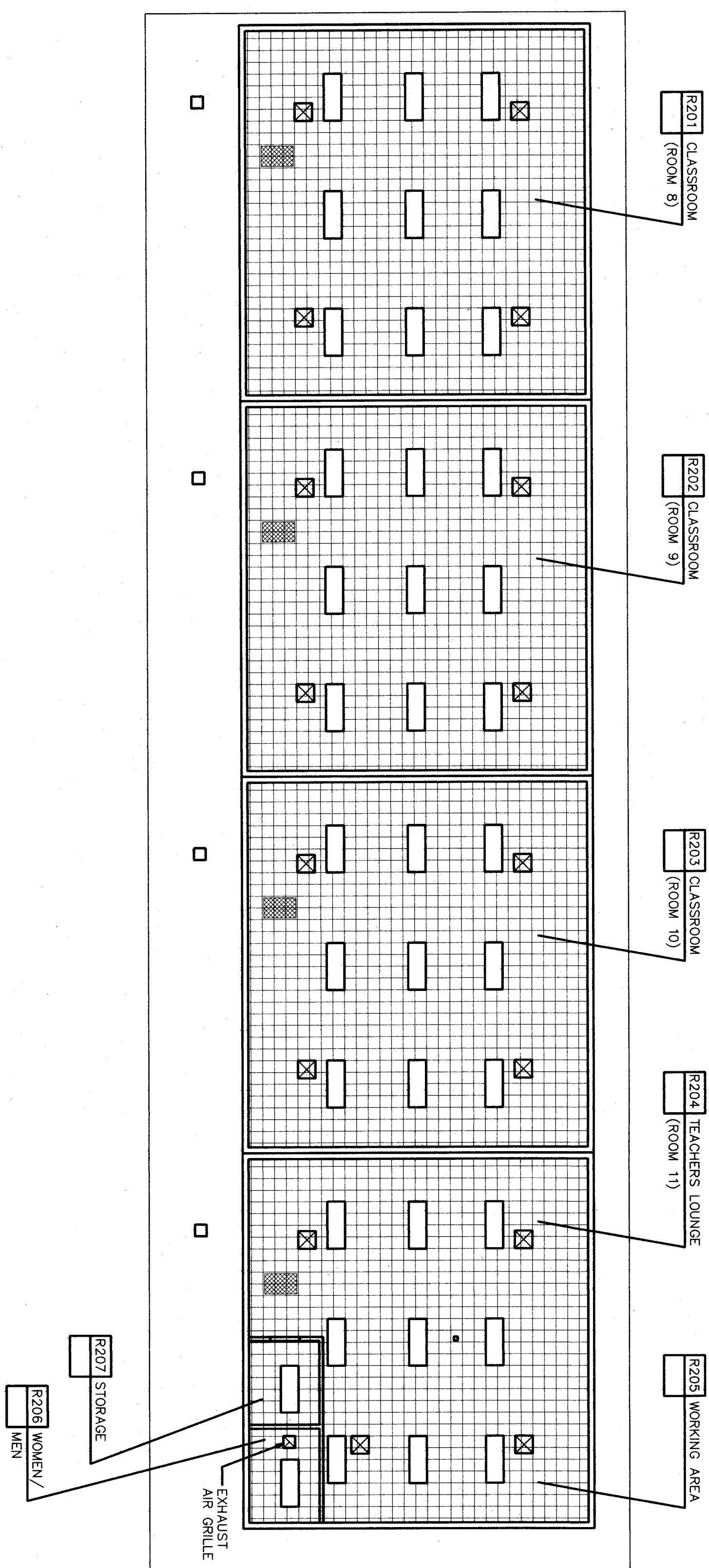
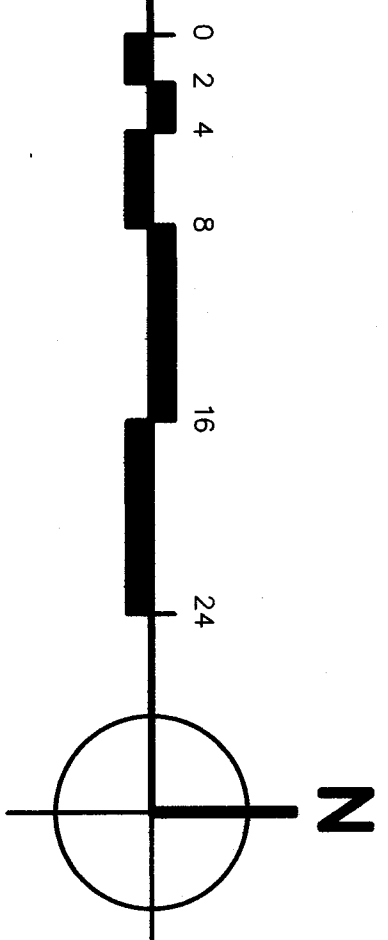
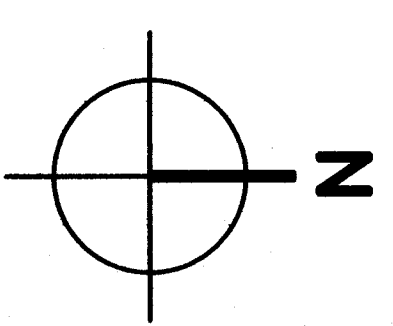

**REFLECTED CEILING PLAN BUILDING R2**

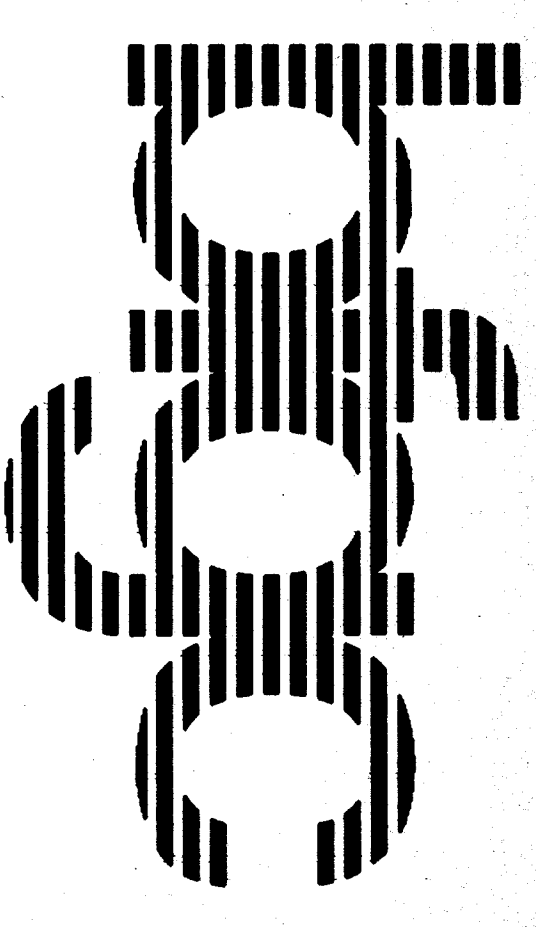
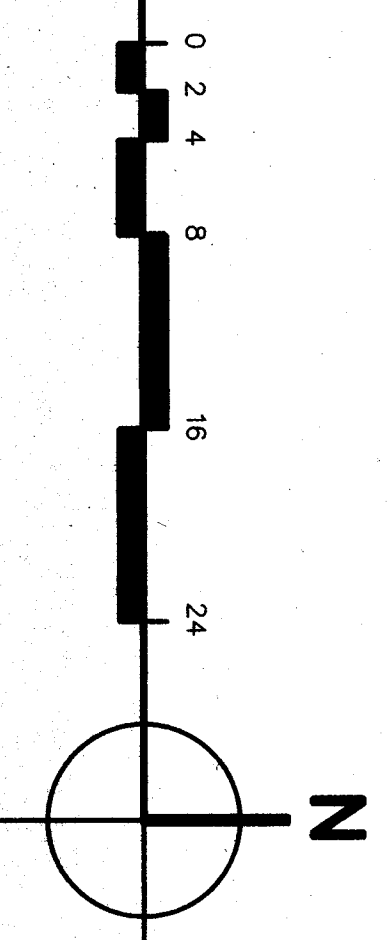

**bfgc architects planners inc.**  
 bakersfield  
 5500 ming avenue, suite 450 bakersfield ca 93309-4831  
 805 836-4300 FAX 805 836-4311

san luis obispo  
 3211 broad street suite 118  
 san luis obispo, california 93401  
 805 396-0455

san jose  
 160 west santa ana at suite 525  
 san jose, california 95113  
 408 824-0841

principal architects  
 david c. gentry, aia, C-9554  
 frank a. baxter, aia, C-8132  
 robert l. wilson, aia, C-8702  
 william r. woodall, aia, C-18079

owner & architect  
 HORT SCHOOL MODERNIZATION  
 BAKERSFIELD CITY SCHOOL DISTRICT  
 2301 PARK DRIVE  
 BAKERSFIELD, CA 93306

**REFLECTED CEILING PLAN**

**BUILDING R2**

1/8" = 1'-0"

job no.	97-218
date	JULY 8, 88
drawn by	ALLG
chk'd by	ROB T.
copy/night	1898

**8,066**

PROJECT: 06-18-88  
 PLOT NUMBER: 153AN/BA/MD/97-218/0307/28208/885

**HORT SCHOOL MODERNIZATION**  
 BAKERSFIELD CITY SCHOOL DISTRICT

**2301 PARK DRIVE**  
 BAKERSFIELD, CA. 93306

**REFLECTED CEILING PLAN**

**BUILDING R2**

1/8" = 1'-0"

job no.	97-218
date	JULY 8, 88
drawn by	ALLG
chk'd by	ROB T.
copy/night	1898

**8,066**

PROJECT: 06-18-88  
 PLOT NUMBER: 153AN/BA/MD/97-218/0307/28208/885