

LEGEND	
	(E) 2' x 4' ACOUSTIC TILE
	(E) 1' x 1' ACOUSTIC TILE
	GYPSUM BOARD CEILING (SMOOTH FINISH)
	EXISTING GYPSUM BOARD CEILING (SMOOTH FINISH) PATCH, REPAIR & PAINT
	EXPOSED ABOVE OR EXISTING CEILING TO REMAIN REFER TO FINISH SCHEDULE
	ELEC. FIXTURE RECESSED
	ELEC. FIXTURE SURFACE MTD.
	ELEC. FIXTURE SURFACE MTD.
	EXTERIOR ELEC. FIXTURE SURFACE MTD.
	(E) SUPPLY AIR DIFFUSER
	(E) RETURN AIR GRILLE
	(E) EXHAUST AIR GRILLE
	ILLUMINATED EXIT SIGN ARROW INDICATES DIRECT

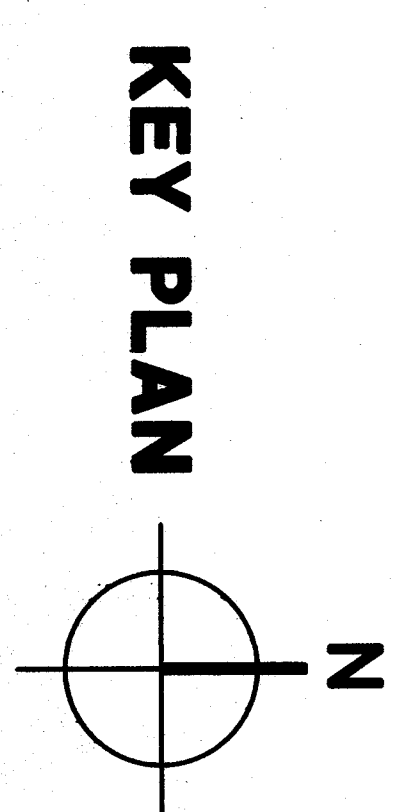
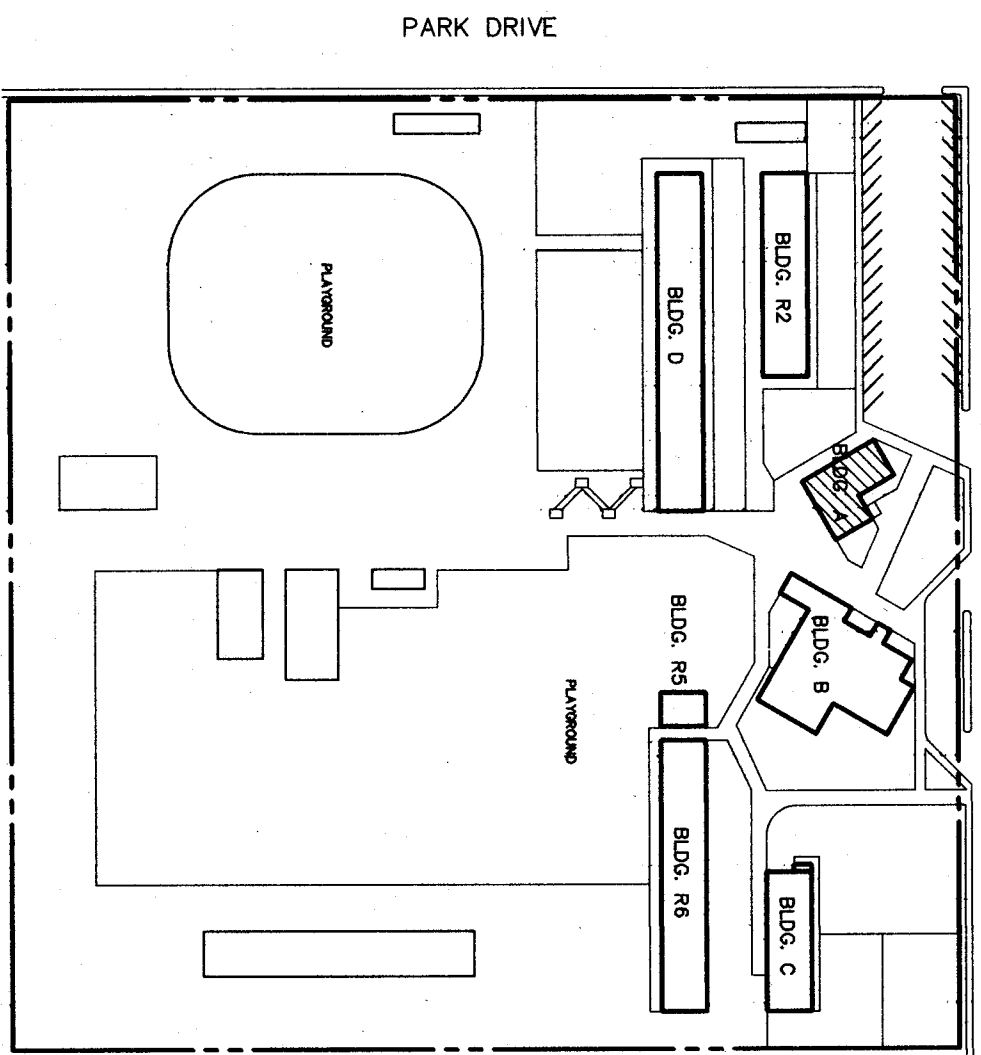
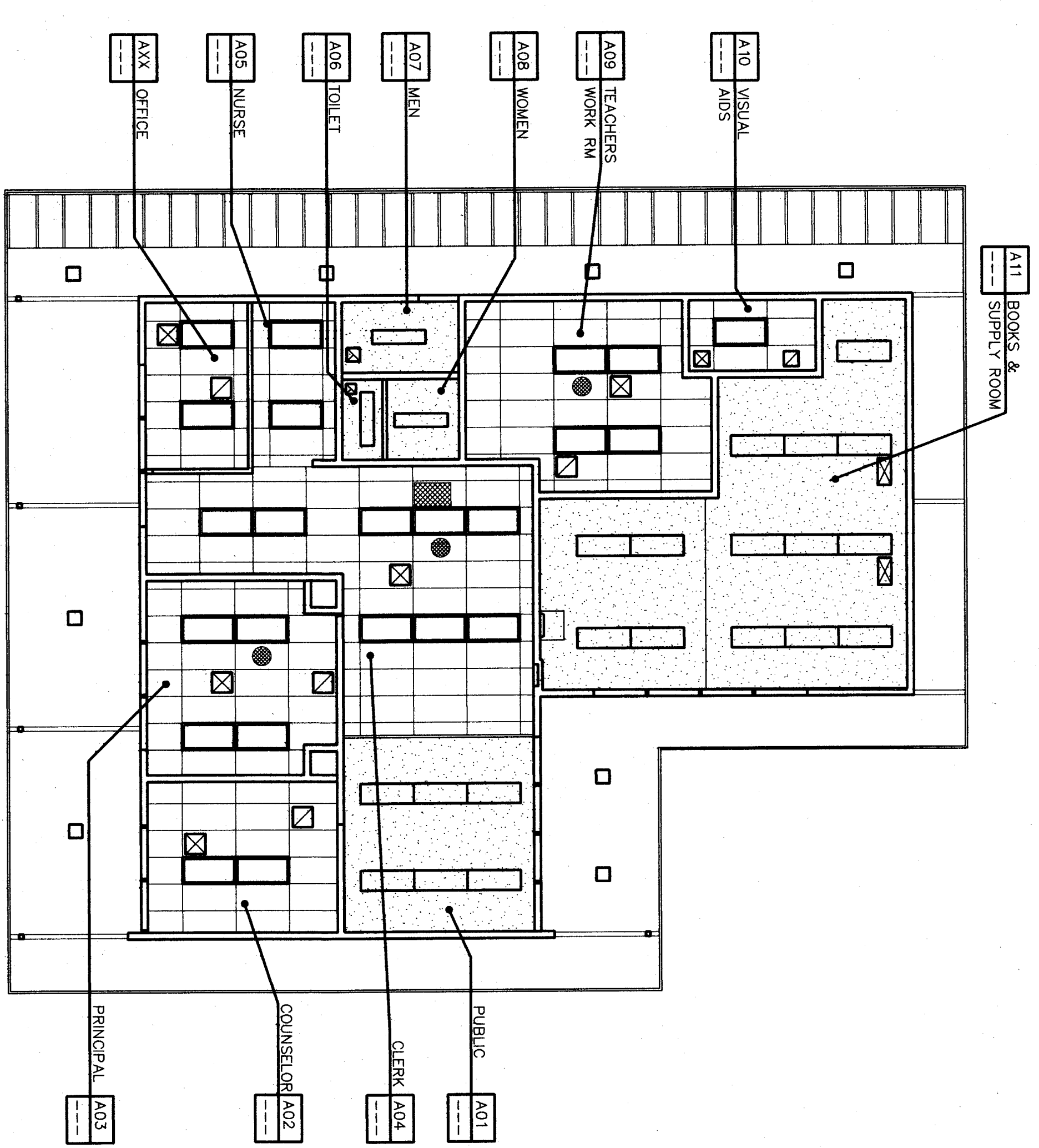
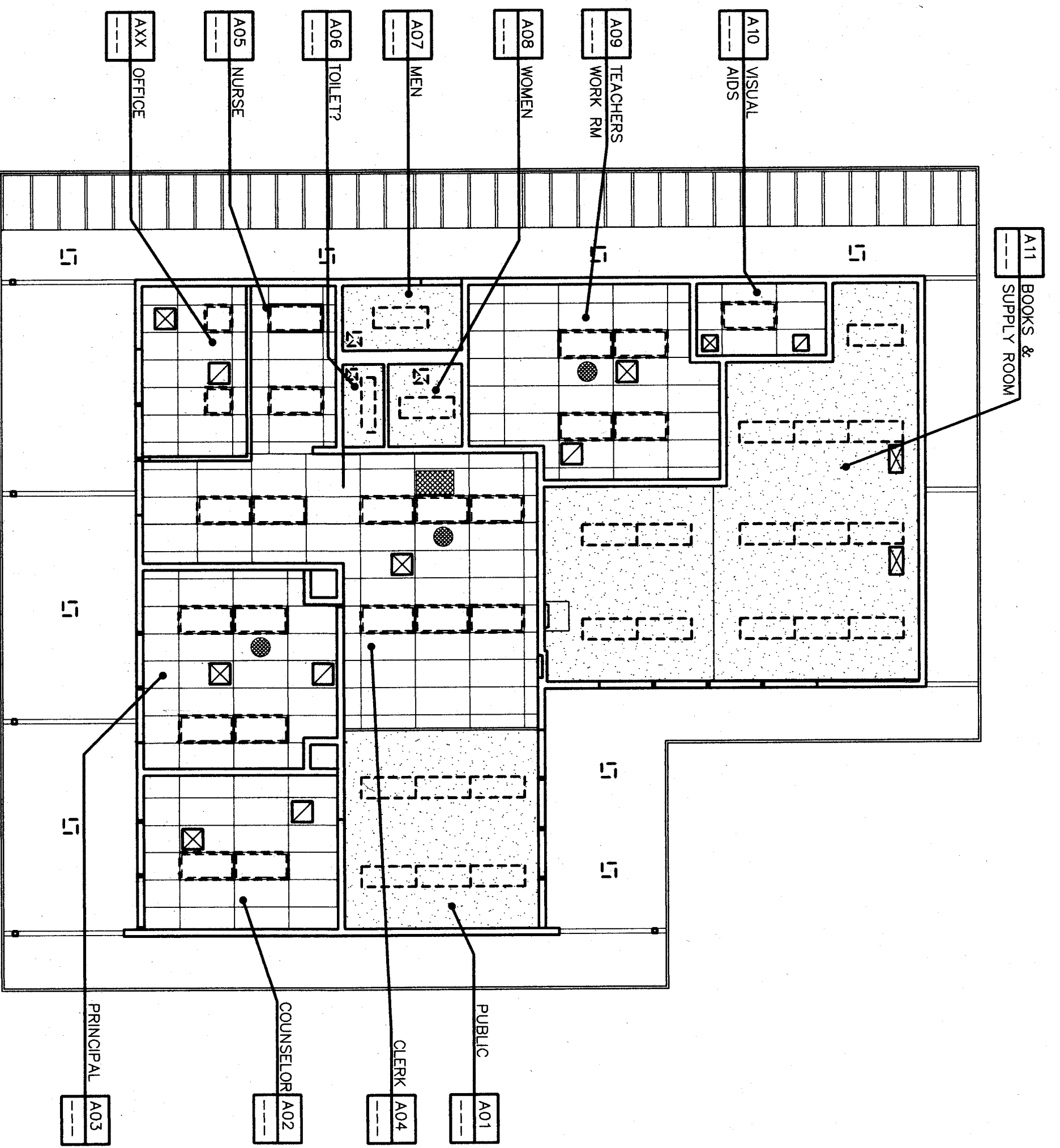

REGISTRATION STAMP
 DIV. OF THE STATE ARCHITECTS
 OFFICE OF REGISTRATION SERVICES
 APRIL 10 11 18
 LUIS OBISPO
 DATE 07/07/98

bico architects planners inc.
 Bakersfield
 5500 ming avenue, suite 450, bakersfield ca, 93309-4831
 805 836-4300 fax 805 836-4311

san luis obispo
 3281 broad street suite 113
 san luis obispo, california 93401
 805 946-0433
 san jose
 180 west santa clara at suite 525
 san jose, california 9513
 408 624-0841

principal architect

dan a. thompson, aia C-8180
 frank a. gomez, aia C-8132
 robert l. webb, rla C-18079
 walter m. shaw, rla C-87102

**HORT SCHOOL
 MODERNIZATION
 BAKERSFIELD CITY
 SCHOOL DISTRICT**

2301 PARK DRIVE
 BAKERSFIELD, CA. 93306

REFLECTED CEILING PLAN

BUILDING A

job no.	97-278
date	MAY 8, 98
drawn by	ALG
chk'd by	ROB T.
copy/print	1898

8.01

PLOT DATE: 10-14-98
 PLOT SCALE: 1/8"=1'-0"
 PLOT NUMBER: USLA/BAKING/97-278/0107/0000/005