

DOOR AND FRAME SCHEDULE

DOOR NUMBER	DOOR		LOUVER	FRAME			PERIOD	HARDWARE SET	SIGN	REMARKS	DOOR NUMBER
	TYPE	SIZE (EACH LEAF)		LEFT JAMB	HEAD	RIGHT JAMB					
A01	EXISTING TO REMAIN	6'-8"		AA	10/A/0.01	10/A/0.01		1		REPAIR/REPLACE (E) DOOR FRAME	A01
A02	EXISTING TO REMAIN	6'-8"		BB	6/A/0.01	6/A/0.01		3		REPAIR/REPLACE (E) DOOR FRAME	A02
A03	EXISTING TO REMAIN	6'-8"		BB	6/A/0.01	6/A/0.01		2		REPAIR/REPLACE (E) DOOR FRAME	A03
A04	EXISTING TO REMAIN	6'-8"		BB	6/A/0.01	6/A/0.01		3		REPAIR/REPLACE (E) DOOR FRAME	A04
A05	EXISTING TO REMAIN	6'-8"		BB	6/A/0.01	6/A/0.01		2		REPAIR/REPLACE (E) DOOR FRAME	A05
A06	EXISTING TO REMAIN	6'-8"		BB	6/A/0.01	6/A/0.01		2		REPAIR/REPLACE (E) DOOR FRAME	A06
A07	EXISTING TO REMAIN	6'-8"		BB	6/A/0.01	6/A/0.01		3		REPAIR/REPLACE (E) DOOR FRAME	A07
A08	EXISTING TO REMAIN	6'-8"		BB	6/A/0.01	6/A/0.01		5		REPAIR/REPLACE (E) DOOR FRAME	A08
A09	EXISTING TO REMAIN	6'-8"		BB	6/A/0.01	6/A/0.01		5		REPAIR/REPLACE (E) DOOR FRAME	A09
A10	EXISTING TO REMAIN	6'-8"		AA	16/A/0.01	16/A/0.01		5		REPAIR/REPLACE (E) DOOR FRAME	A10
A11	EXISTING TO REMAIN	6'-8"		BB	6/A/0.01	6/A/0.01		2		REPAIR/REPLACE (E) DOOR FRAME	A11
A12	EXISTING TO REMAIN	6'-8"		BB	6/A/0.01	6/A/0.01		3		REPAIR/REPLACE (E) DOOR FRAME	A12
A13	EXISTING TO REMAIN	6'-8"		BB	6/A/0.01	6/A/0.01		3		REPAIR/REPLACE (E) DOOR FRAME	A13
A14	EXISTING TO REMAIN	6'-8"		BB	6/A/0.01	6/A/0.01		2		REPAIR/REPLACE (E) DOOR FRAME	A14
A15	EXISTING TO REMAIN	6'-8"		AA	6/A/0.01	6/A/0.01		2		REPAIR/REPLACE (E) DOOR FRAME	A15
A16	EXISTING TO REMAIN	6'-8"		(E)	(E)	(E)		4		MATCH (E) DOOR SIZE - FIELD VERIFY DIMS.	A16
A17	EXISTING TO REMAIN	6'-8"		(E)	(E)	(E)		4		MATCH (E) DOOR SIZE - FIELD VERIFY DIMS.	A17
B01	EXISTING TO REMAIN	6'-8"		AA	16/A/0.01	16/A/0.01		6		REPAIR/REPLACE (E) DOOR FRAME	B01
B02	EXISTING TO REMAIN	6'-8"		AA	6/A/0.01	6/A/0.01		7		REPAIR/REPLACE (E) DOOR FRAME	B02
B03	EXISTING TO REMAIN	6'-8"		AA	6/A/0.01	6/A/0.01		7		REPAIR/REPLACE (E) DOOR FRAME	B03
B04	EXISTING TO REMAIN	6'-8"		AA	16/A/0.01	16/A/0.01		6		REPAIR/REPLACE (E) DOOR FRAME	B04
B05	EXISTING TO REMAIN	6'-8"		AA	6/A/0.01	6/A/0.01		2		REPAIR/REPLACE (E) DOOR FRAME	B05
B06	EXISTING TO REMAIN	6'-8"		AA	11/A/0.01	11/A/0.01		8		REPAIR/REPLACE (E) DOOR FRAME	B06
B07	EXISTING TO REMAIN	6'-8"		AA	16/A/0.01	16/A/0.01		14		REPAIR/REPLACE (E) DOOR FRAME	B07
B08	EXISTING TO REMAIN	6'-8"		AA	10/A/0.01	10/A/0.01		15		REPAIR/REPLACE (E) DOOR FRAME	B08
B09	EXISTING TO REMAIN	6'-8"		AA	10/A/0.01	10/A/0.01		16		REPAIR/REPLACE (E) DOOR FRAME	B09
B10	EXISTING TO REMAIN	6'-8"		AA	10/A/0.01	10/A/0.01		15		REPAIR/REPLACE (E) DOOR FRAME	B10
B11	EXISTING TO REMAIN	6'-8"		AA	6/A/0.01	6/A/0.01		17		REPAIR/REPLACE (E) DOOR FRAME	B11
B12	EXISTING TO REMAIN	6'-8"		AA	6/A/0.01	6/A/0.01		9		REPAIR/REPLACE (E) DOOR FRAME	B12
B13	EXISTING TO REMAIN	6'-8"		AA	6/A/0.01	6/A/0.01		18		REPAIR/REPLACE (E) DOOR FRAME	B13
B14	EXISTING TO REMAIN	6'-8"		AA	6/A/0.01	6/A/0.01		10		REPAIR/REPLACE (E) DOOR FRAME	B14
B15	EXISTING TO REMAIN	6'-8"		AA	6/A/0.01	6/A/0.01		19		REPAIR/REPLACE (E) DOOR FRAME	B15
B16	EXISTING TO REMAIN	6'-8"		AA	6/A/0.01	6/A/0.01		17		REPAIR/REPLACE (E) DOOR FRAME	B16
B17	EXISTING TO REMAIN	6'-8"		AA	6/A/0.01	6/A/0.01		7		REPAIR/REPLACE (E) DOOR FRAME	B17
B18	EXISTING TO REMAIN	6'-8"		AA	6/A/0.01	6/A/0.01		11		REPAIR/REPLACE (E) DOOR FRAME	B18
B19	EXISTING TO REMAIN	6'-8"		AA	6/A/0.01	6/A/0.01		20		REPAIR/REPLACE (E) DOOR FRAME	B19
B20	EXISTING TO REMAIN	6'-8"		AA	10/A/0.01	10/A/0.01		16		REPAIR/REPLACE (E) DOOR FRAME	B20
B21	EXISTING TO REMAIN	6'-8"		AA	6/A/0.01	6/A/0.01		7		REPAIR/REPLACE (E) DOOR FRAME	B21
B22	EXISTING TO REMAIN	6'-8"		AA	6/A/0.01	6/A/0.01		7		REPAIR/REPLACE (E) DOOR FRAME	B22
B23	EXISTING TO REMAIN	6'-8"		AA	6/A/0.01	6/A/0.01		12		REPAIR/REPLACE (E) DOOR FRAME	B23
B24	EXISTING TO REMAIN	6'-8"		AA	6/A/0.01	6/A/0.01		13		REPAIR/REPLACE (E) DOOR FRAME	B24
C01	EXISTING TO REMAIN	6'-8"		BB	11/A/0.01	11/A/0.01		21		REPAIR/REPLACE (E) DOOR FRAME	C01
C02	EXISTING TO REMAIN	6'-8"		AA	10/A/0.01	10/A/0.01		23		REPAIR/REPLACE (E) DOOR FRAME	C02
C03	EXISTING TO REMAIN	6'-8"		AA	10/A/0.01	10/A/0.01		24		REPAIR/REPLACE (E) DOOR FRAME	C03
C04	EXISTING TO REMAIN	6'-8"		AA	10/A/0.01	10/A/0.01		24		REPAIR/REPLACE (E) DOOR FRAME	C04
C05	EXISTING TO REMAIN	6'-8"		BB	11/A/0.01	11/A/0.01		21		REPAIR/REPLACE (E) DOOR FRAME	C05
C06	EXISTING TO REMAIN	6'-8"		BB	11/A/0.01	11/A/0.01		21		REPAIR/REPLACE (E) DOOR FRAME	C06
C07	EXISTING TO REMAIN	6'-8"		AA	6/A/0.01	6/A/0.01		22		REPAIR/REPLACE (E) DOOR FRAME	C07
C08	EXISTING TO REMAIN	6'-8"		AA	6/A/0.01	6/A/0.01		22		REPAIR/REPLACE (E) DOOR FRAME	C08
C09	EXISTING TO REMAIN	6'-8"		AA	6/A/0.01	6/A/0.01		26		REPAIR/REPLACE (E) DOOR FRAME	C09
C10	EXISTING TO REMAIN	6'-8"		AA	6/A/0.01	6/A/0.01		27		REPAIR/REPLACE (E) DOOR FRAME	C10
C11	EXISTING TO REMAIN	6'-8"		AA	10/A/0.01	10/A/0.01		23		REPAIR/REPLACE (E) DOOR FRAME	C11
C12	EXISTING TO REMAIN	6'-8"		AA	10/A/0.01	10/A/0.01		24		REPAIR/REPLACE (E) DOOR FRAME	C12
C13	EXISTING TO REMAIN	6'-8"		BB	11/A/0.01	11/A/0.01		25		REPAIR/REPLACE (E) DOOR FRAME	C13
C14	EXISTING TO REMAIN	6'-8"		BB	11/A/0.01	11/A/0.01		21		REPAIR/REPLACE (E) DOOR FRAME	C14
C15	EXISTING TO REMAIN	6'-8"		BB	11/A/0.01	11/A/0.01		21		REPAIR/REPLACE (E) DOOR FRAME	C15
C16	EXISTING TO REMAIN	6'-8"		BB	11/A/0.01	11/A/0.01		21		REPAIR/REPLACE (E) DOOR FRAME	C16

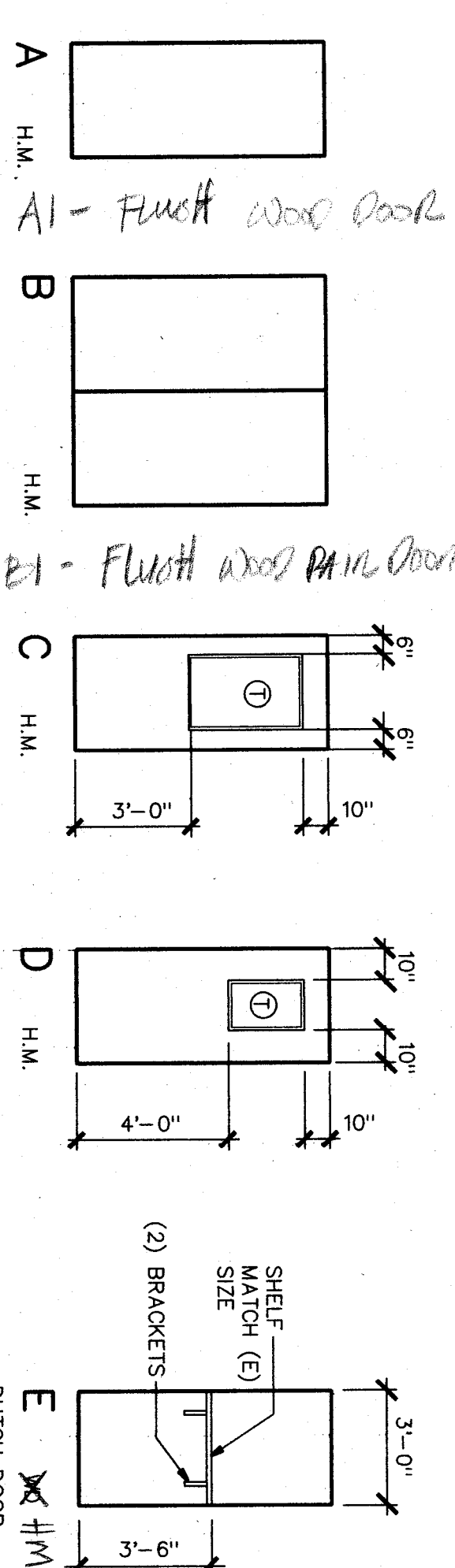

DOOR TYPES

FRAME TYPES

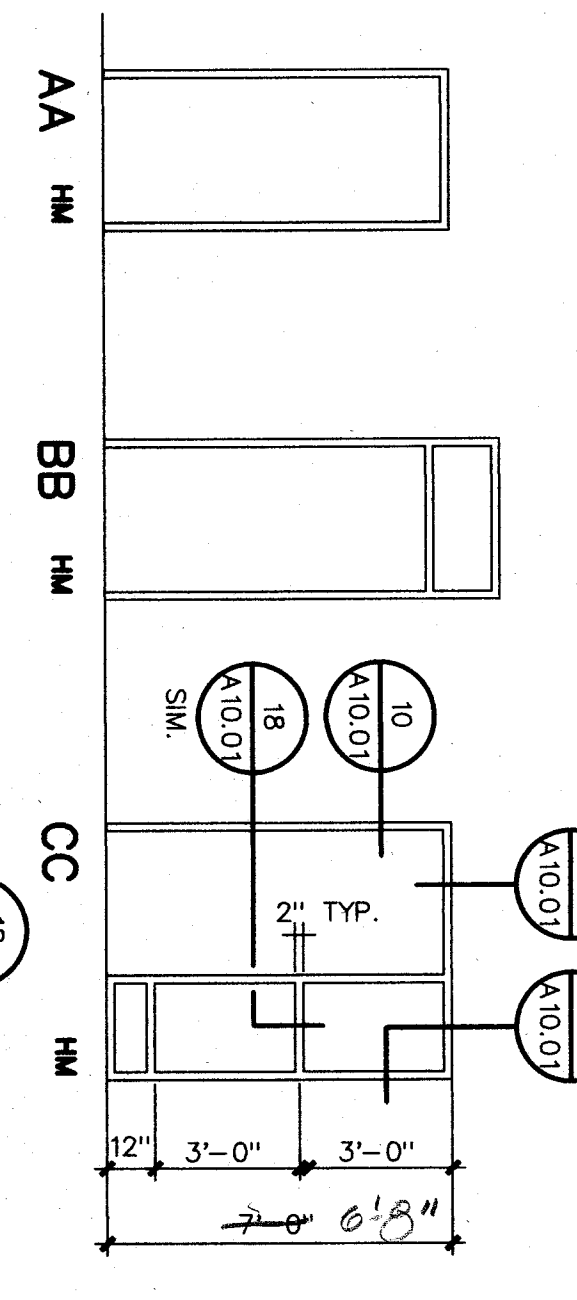

DOOR AND FRAME SCHEDULE

DOOR NUMBER	DOOR		LOUVER	FRAME			PERIOD	HARDWARE SET	SIGN	REMARKS	DOOR NUMBER
	TYPE	SIZE (EACH LEAF)		LEFT JAMB	HEAD	RIGHT JAMB					
D01	EXISTING TO REMAIN	6'-8"		BB	6/A/0.01	6/A/0.01		21		DOOR W/ GLASS TRANSMOM	D01
D02	EXISTING TO REMAIN	6'-8"		BB	6/A/0.01	6/A/0.01		21		DOOR W/ GLASS TRANSMOM	D02
D03	EXISTING TO REMAIN	6'-8"		BB	6/A/0.01	6/A/0.01		21		DOOR W/ GLASS TRANSMOM	D03
D04	EXISTING TO REMAIN	6'-8"		BB	6/A/0.01	6/A/0.01		21		DOOR W/ GLASS TRANSMOM	D04
D05	EXISTING TO REMAIN	6'-8"		BB	6/A/0.01	6/A/0.01		21		DOOR W/ GLASS TRANSMOM	D05
D06	EXISTING TO REMAIN	6'-8"		BB	6/A/0.01	6/A/0.01		21		DOOR W/ GLASS TRANSMOM	D06
D07	EXISTING TO REMAIN	6'-8"		BB	6/A/0.01	6/A/0.01		21		DOOR W/ GLASS TRANSMOM	D07
D08	EXISTING TO REMAIN	6'-8"		BB	6/A/0.01	6/A/0.01		21		DOOR W/ GLASS TRANSMOM	D08
D09	EXISTING TO REMAIN	6'-8"		BB	6/A/0.01	6/A/0.01		21		DOOR W/ GLASS TRANSMOM	D09
D10	EXISTING TO REMAIN	6'-8"		BB	6/A/0.01	6/A/0.01		21		DOOR W/ GLASS TRANSMOM	D10
D11	EXISTING TO REMAIN	6'-8"		BB	6/A/0.01	6/A/0.01		21		DOOR W/ GLASS TRANSMOM	D11
D12	EXISTING TO REMAIN	6'-8"		BB	6/A/0.01	6/A/0.01		21		DOOR W/ GLASS TRANSMOM	D12
D13	EXISTING TO REMAIN	6'-8"		AA	6/A/0.01	6/A/0.01		28		DOOR W/ GLASS TRANSMOM	D13
D14	EXISTING TO REMAIN	6'-8"		AA	6/A/0.01	6/A/0.01		13		DOOR W/ GLASS TRANSMOM	D14
D15	EXISTING TO REMAIN	6'-8"		AA	6/A/0.01	6/A/0.01		29		DOOR W/ GLASS TRANSMOM	D15
D16	EXISTING TO REMAIN	6'-8"		AA	6/A/0.01	6/A/0.01		29		DOOR W/ GLASS TRANSMOM	D16
D17	EXISTING TO REMAIN	6'-8"		AA	6/A/0.01	6/A/0.01		13		DOOR W/ GLASS TRANSMOM	D17
E01	EXISTING TO REMAIN	6'-8"		AA	6/A/0.01	6/A/0.01		21		DOOR W/ GLASS TRANSMOM	E01
E02	EXISTING TO REMAIN	6'-8"		AA	6/A/0.01	6/A/0.01		30		DOOR W/ GLASS TRANSMOM	E02
E03	EXISTING TO REMAIN	6'-8"		AA	6/A/0.01	6/A/0.01		21		DOOR W/ GLASS TRANSMOM	E03
E04	EXISTING TO REMAIN	6'-8"		AA	6/A/0.01	6/A/0.01		30		DOOR W/ GLASS TRANSMOM	E04
E05	EXISTING TO REMAIN	6'-8"		AA	6/A/0.01	6/A/0.01		21		DOOR W/ GLASS TRANSMOM	E05
E06	EXISTING TO REMAIN	6'-8"		AA	6/A/0.01	6/A/0.01		21		DOOR W/ GLASS TRANSMOM	E06
E07	EXISTING TO REMAIN	6'-8"		AA	6/A/0.01	6/A/0.01		21		DOOR W/ GLASS TRANSMOM	E07
E08	EXISTING TO REMAIN	6'-8"		AA	6/A/0.01	6/A/0.01		21		DOOR W/ GLASS TRANSMOM	E08
E09	EXISTING TO REMAIN	6'-8"		AA	6/A/0.01	6/A/0.01		30		DOOR W/ GLASS TRANSMOM	E09
E10	EXISTING TO REMAIN	6'-8"		AA	6/A/0.01	6/A/0.01		21		DOOR W/ GLASS TRANSMOM	E10
E11	EXISTING TO REMAIN	6'-8"		AA	6/A/0.01	6/A/0.01		30		DOOR W/ GLASS TRANSMOM	E11

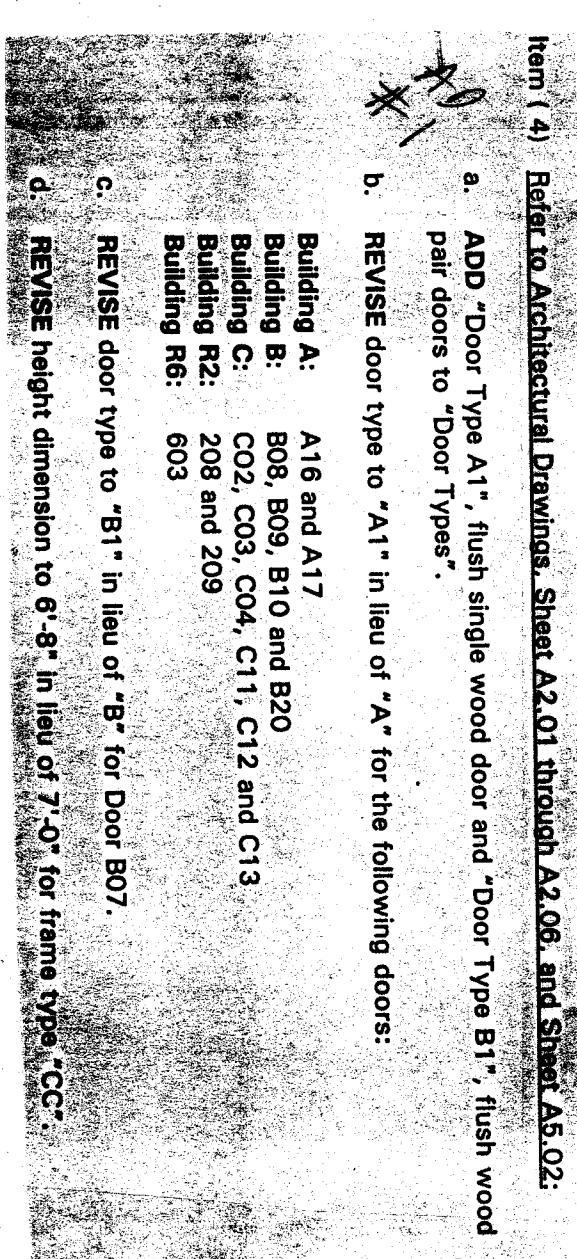

DOOR TYPES

FRAME TYPES

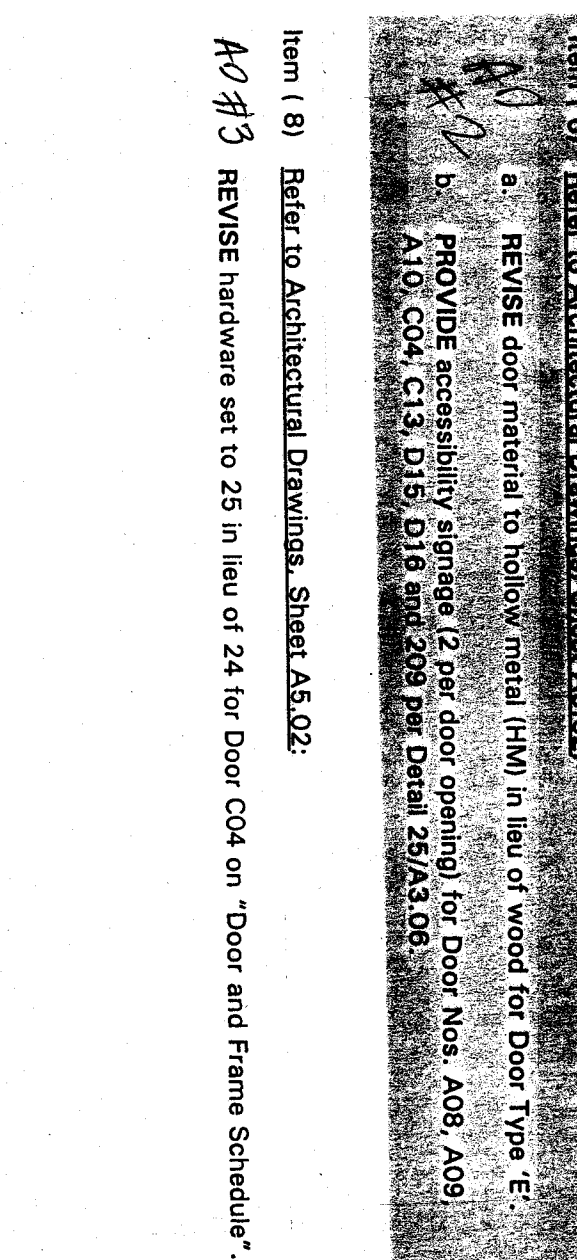

Item (4) Refer to Architectural Drawings, Sheet A5.01 through A5.06, and Sheet A5.02.

a. ADO Door Type A17, flush wood door and Door Type B1, flush wood door with panel.

b. REVERSE door type to "A17" in lieu of "A" for the following doors:

Building #: A16 and A17
Building C: B08, B09, B10 and B20
Building G: C02, C03, C04, C11, C12 and C13
Building RZ: 208 and 209
Building RR: 603

c. REVERSE height dimension to "81" in lieu of "78" for Door B07.

d. REVERSE height dimension to "6'-8" in lieu of "7'-0" for frame types C02, C03, C04, C11, C12 and C13.

Item (8) Refer to Architectural Drawings, Sheet A5.02.

a. REVERSE door material to include metal (MM) in lieu of wood for Door Type E.

b. REVERSE door material to include metal (MM) in lieu of wood for Door Type E.

c. REVERSE door material to include metal (MM) in lieu of wood for Door Type E.

d. REVERSE door material to include metal (MM) in lieu of wood for Door Type E.

HORT SCHOOL MODERNIZATION

BAKERSFIELD CITY SCHOOL DISTRICT

2301 PARK DRIVE
BAKERSFIELD, CA 93306

DOOR & FRAME SCHEDULE

job no. 97-278
date JULY 9, 98
drawn by A.L.G.
chk'd by ROB T.
copyright 1997

502

bfgc architects planners inc.

5500 mgg avenue suite 450 bakersfield ca 93309-4831
805 836-4300 fax 805 836-4831

san luis obispo
220 broad street suite 102
san luis obispo ca 95401
805 546-0483

san jose
860 west santa ana st. suite 525
san jose, california 95131
408 527-0901

principal architect
diane e. carroll, l.a., c-8184
mark e. gonzales, l.a., c-1810
eric a. hughes, l.a., c-1802
william f. bockel, l.a., c-1802

door & frame schedule
c-8180
c-1810
c-1802
c-1802

OFFICE OF RESOLUTION SERVICES

APPL 101118
R.S. 7/98
DATE OCT 17 1998

