

PARK DRIVE

WILLIS AVENUE

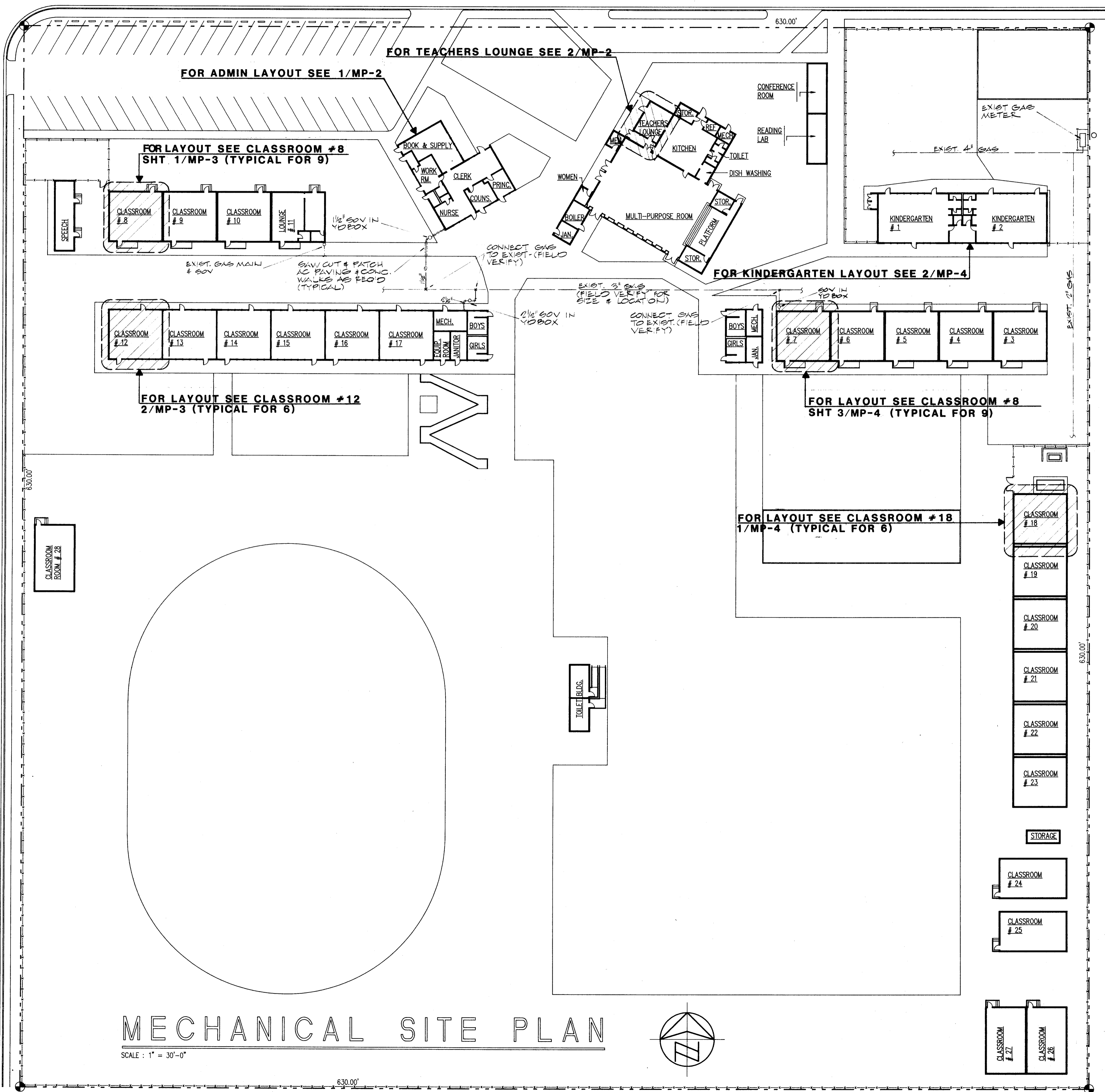

EQUIPMENT SCHEDULE

- AC 1 DAY & NIGHT #580B072 HEATING/COOLING UNIT - 2400 CFM AT .6" ESP - ALT. 1 1/2 HP MOTOR WITH BELT DRIVE - 71.2 MBH TOTAL AND 56.1 SENS. AT 105 DEGREES AMBIENT AND 67 DEGREES EWB - 74,000 BTUH INPUT AND 58,460 BTUH OUTPUT HEATING - 14.08 FLA AT 480V/3PH - ECONOMIZER - 600 LBS
- AC 2 DAY & NIGHT #580B048 HEATING/COOLING UNIT - 1600 CFM AT .6" ESP - ALT. 3/4 HP MOTOR WITH BELT DRIVE - 48.0 MBH TOTAL AND 33.6 MBH SENS. AT 105 DEGREES AMBIENT AND 67 DEGREES EWB - 74,000 BTUH INPUT AND 58,460 BTUH OUTPUT HEATING - 10.78 FLA AT 480V/3PH - ECONOMIZER - 570 LBS
- AC 3 DAY & NIGHT #580B060 HEATING/COOLING UNIT - 2000CFM AT .6" ESP - ALT. 1 HP MOTOR WITH BELT DRIVE - 58.6 MBH TOTAL AND 45.9 MBH SENSIBLE AT 105 DEGREES AMBIENT AND 67 DEGREES EWB - 74,000 BTUH INPUT AND 48,460 BTUH OUTPUT HEATING - 13.68 FLA AT 480V/3PH - ECONOMIZER - 590 LBS
- AC 4 DAY & NIGHT #580B072 HEATING/COOLING UNIT - 1400 CFM AT .4" ESP - ALT. 1 HP MOTOR WITH BELT DRIVE - 48.0 MBH TOTAL AND 33.6 MBH SENSIBLE AT 105 DEGREES AMBIENT AND 67 DEGREES EWB - 74,000 BTUH INPUT AND 58,460 BTUH OUTPUT HEATING - 10.78 FLA AT 480V/3PH - ECONOMIZER - 570 LBS

**NOTE ! AC UNITS ARE TO BE FURNISHED BY THE SCHOOL DISTRICT AND INSTALLED BY THE CONTRACTOR. CONTRACTOR IS TO PROVIDE AND ARRANGE FOR PICKUP AND DELIVERY FROM DISTRICT STORAGE TO SCHOOL SITE. (VERIFY OPERATION OF UNITS & AIR BALANCE)**

NOTE: AIR FILTERS FURNISHED w/ UNITS SHALL COMPLY w/ UMC SEC. 1103 (C), UPC STANDARD NO. 9-6 & SHALL HAVE A CALIF. STATE FIRE MARSHAL LIST NO. NO. 3175-140-0

REGISTER SCHEDULE

- CS-1 ANEMOSTAT #RMD-FP - 24 X 24 PANEL
- CS-2 ANEMOSTAT #RMD-S - SURFACE
- WS-1 ANEMOSTAT #S2HO - WALL
- CR-1 ANEMOSTAT #GC50L - 24 X 24 PANEL
- CR-2 ANEMOSTAT #GC50 - SURFACE

All mechanical and electrical equipment shall be braced or anchored to resist a horizontal force acting in any direction using the following criteria:

Equipment on Grade	20% of Operating Weight
Equipment on Structure	30% of Operating Weight

For flexibly mounted equipment use 4 x the above values, and for simultaneous vertical force use 1/3 x the horizontal force.

The above values are for an importance factor, I = 1.0 and seismic zone, Z = 0.4.

Where anchorage details are not shown on the drawings the field installation shall be subject to the approval of the MECHANICAL Engineer and the Field Engineer of the Office of the State Architect.

NO.	REVISION	DATE	BY

APPROVED  
FIRE AND PANIC ONLY  
APR 4 1991  
STATE FIRE MARSHAL  
SOUTHERN REGION

FIRE MARSHAL  
IDENTIFICATION SYSTEM  
Department of General Services  
Office of the State Architect  
APR 4 1991  
Structural Safety Section  
Checked By: J.P. L.A.  
O.S.A.



MECHANICAL SITE PLAN - EQUIPMENT SCHEDULE

(AIR CONDITIONING)

HORT SCHOOL  
BAKERSFIELD CITY SCHOOL DISTRICT  
2301 PARK DRIVE, BAKERSFIELD, CALIFORNIA

DATE: 1-11-91  
DRAWN: G.S.

JOB NO. 142  
SHEET NO. MP1  
SHEET 1 OF 6

Glenn Hartzell A.I.A.  
26 'H' STREET, 93304  
P.O. BOX 2344, 93303, BAKERSFIELD, CALIFORNIA  
ARCHITECT: C-10298