

**SCA**rchitect, Inc.  
 1301 L Street  
 Bakersfield, CA 93301  
 (805) 327-1092



REGISTRATION STAMP  
 DIVISION OF REGULATION SERVICES  
 FILE NO. 03-102156  
 DATE: 01/13/09

**RUTH HARDING SCHOOL  
 MODERNIZATION**  
 3201 PICO AVE.  
 FOR  
**BAKERSFIELD CITY SCHOOL DISTRICT**  
 BAKERSFIELD, KERN COUNTY, CALIFORNIA

**PARTIAL  
 FLOOR PLAN**

CHECK AND VERIFY ALL DIMENSIONS BEFORE PROCEEDING WITH THE WORK. REPORT DISCREPANCIES TO THE ARCHITECT IMMEDIATELY. ALL CONSTRUCTION SHALL CONFORM TO THE C.S.C.

MARK	DATE	REVISIONS

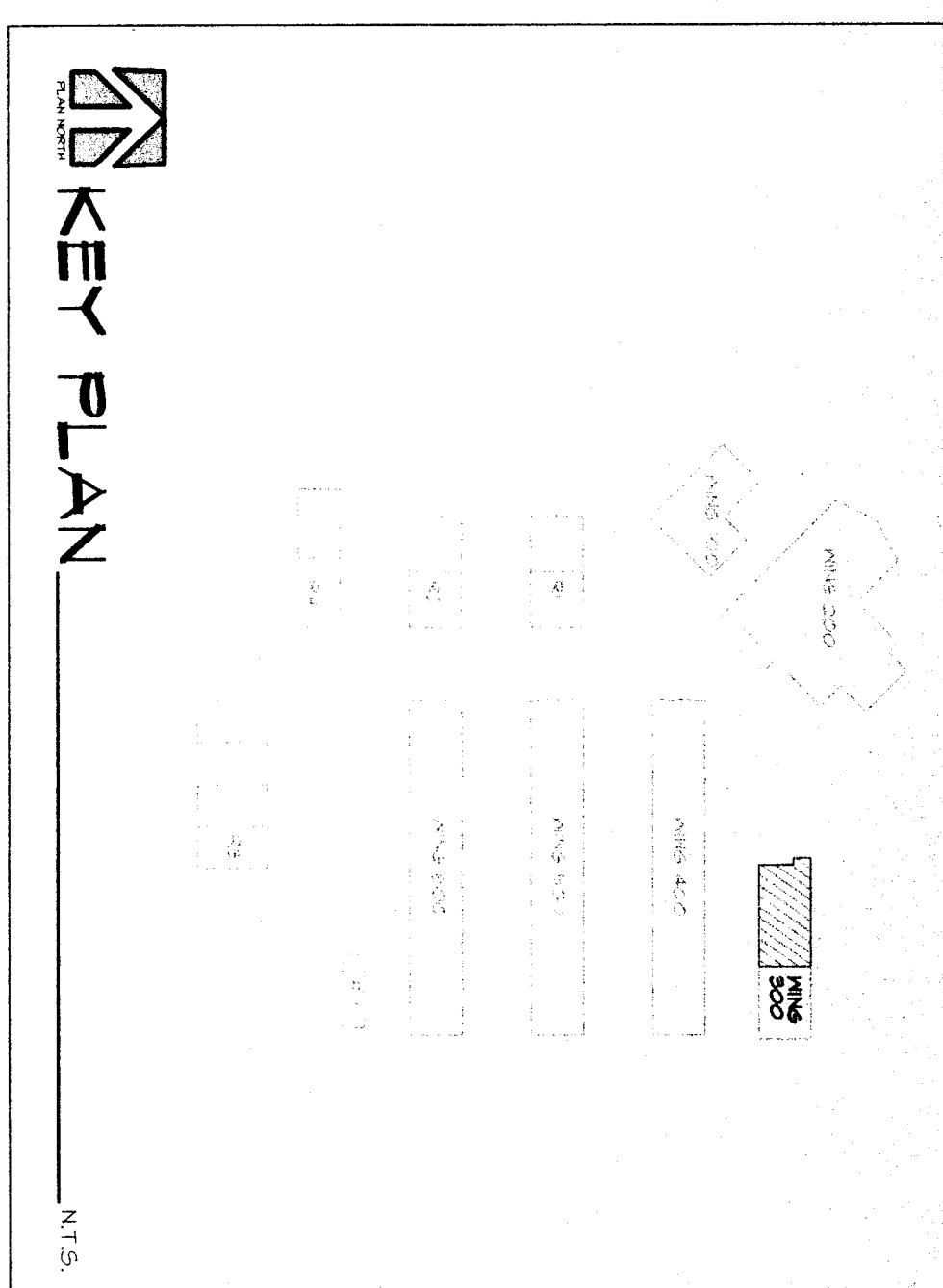

**LEGEND**  
 2" WALL FINISHES TO MATCH (E)  
 (E) WALL TO REMAIN

- KEYNOTES**
- (304) SAWCUT AND REMOVE (E) CONC. AS REQ'D FOR WORK INDICATED
  - (305) PERFORM WALL FINISH AS REQ'D FOR WORK INDICATED
  - (306) REMOVE EXISTING WALL FINISH AS REQ'D TO FORMER A SHOOTER TRANSITION
  - (307) PAINT MEDIUM FRAMES, SINKS, AND MILLING
  - (308) PAINT CABINETS FOR KITCHEN TOP
  - (309) SEE INTERIOR ELEVATIONS
  - (310) STORAGE CABINETS
  - (311) COMPUTER CABINETS
  - (312) HAZARDING BACK
  - (313) INSTRUCTION CLOSET
  - (314) PROJECTION SCREEN (A) (B) (C) (D) (E) (F) (G) (H) (I) (J) (K) (L) (M) (N) (O) (P) (Q) (R) (S) (T) (U) (V) (W) (X) (Y) (Z)
  - (315) SOLID PLASTIC PARTITION (A) (B) (C) (D) (E) (F) (G) (H) (I) (J) (K) (L) (M) (N) (O) (P) (Q) (R) (S) (T) (U) (V) (W) (X) (Y) (Z)
  - (316) PLUMBING FINISHES - SEE PLUMBING SHEETS
  - (317) PATCH AND MATCH CONC. SLAB AS REQUIRED FOR WORK INDICATED
  - (318) NOT USED
  - (319) UPPER CABINETS - SEE INTERIOR ELEVATION
  - (320) NOT USED

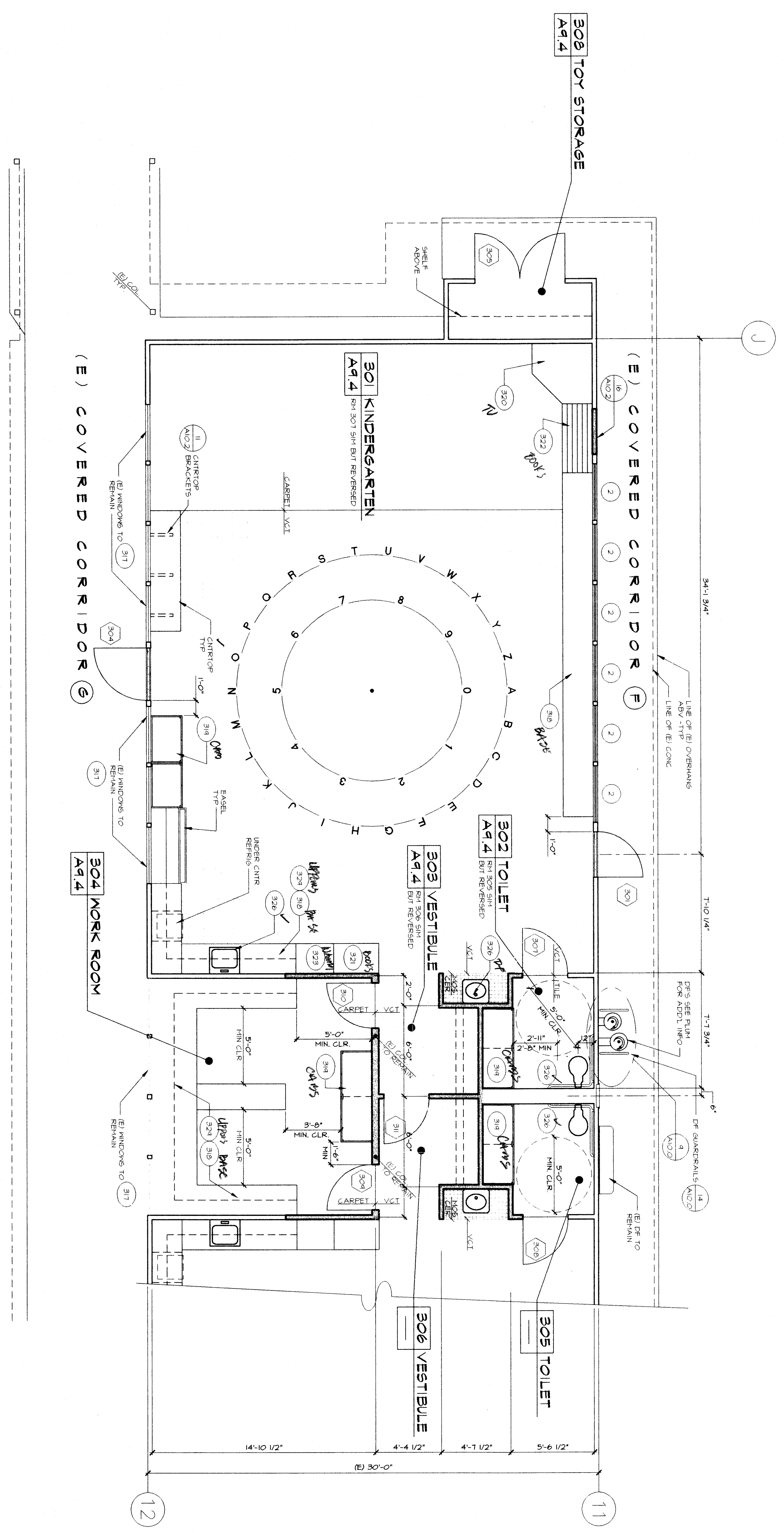

**PARTIAL FLOOR PLAN - MING 300**

SCALE: 1/8" = 1'-0"

VOID