

KEY PLAN

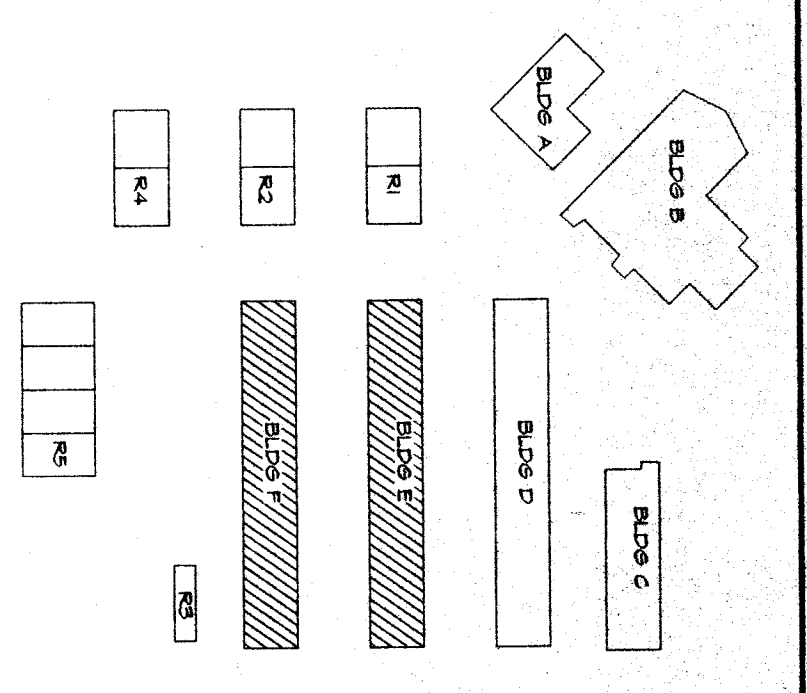

REFERENCE NOTES

- 1) REPLACE (E) PANEL W/NEW 120/208V-3Ø-4W 200A 42 CKS/INSTALL 175/3 MAIN CB, CUT & PATCH
- (E) WALLS AS REQUIRED. SEE SINGLE LINE DIAGRAM
- 2) INTERCEPT AND EXTEND (E) CONDUIT/CONDUCTORS TO NEW LOCATION OF CLOCK @ 8'-0" AFF. AND CONNECT AS REQUIRED
- 3) REPLACE (E) PANEL W/NEW 120/208V-3Ø-4W 225A 42 CKS/INSTALL 225/3 WET MAIN CB & PATCH
- (E) WALLS AS REQUIRED. SEE SINGLE LINE DIAGRAM

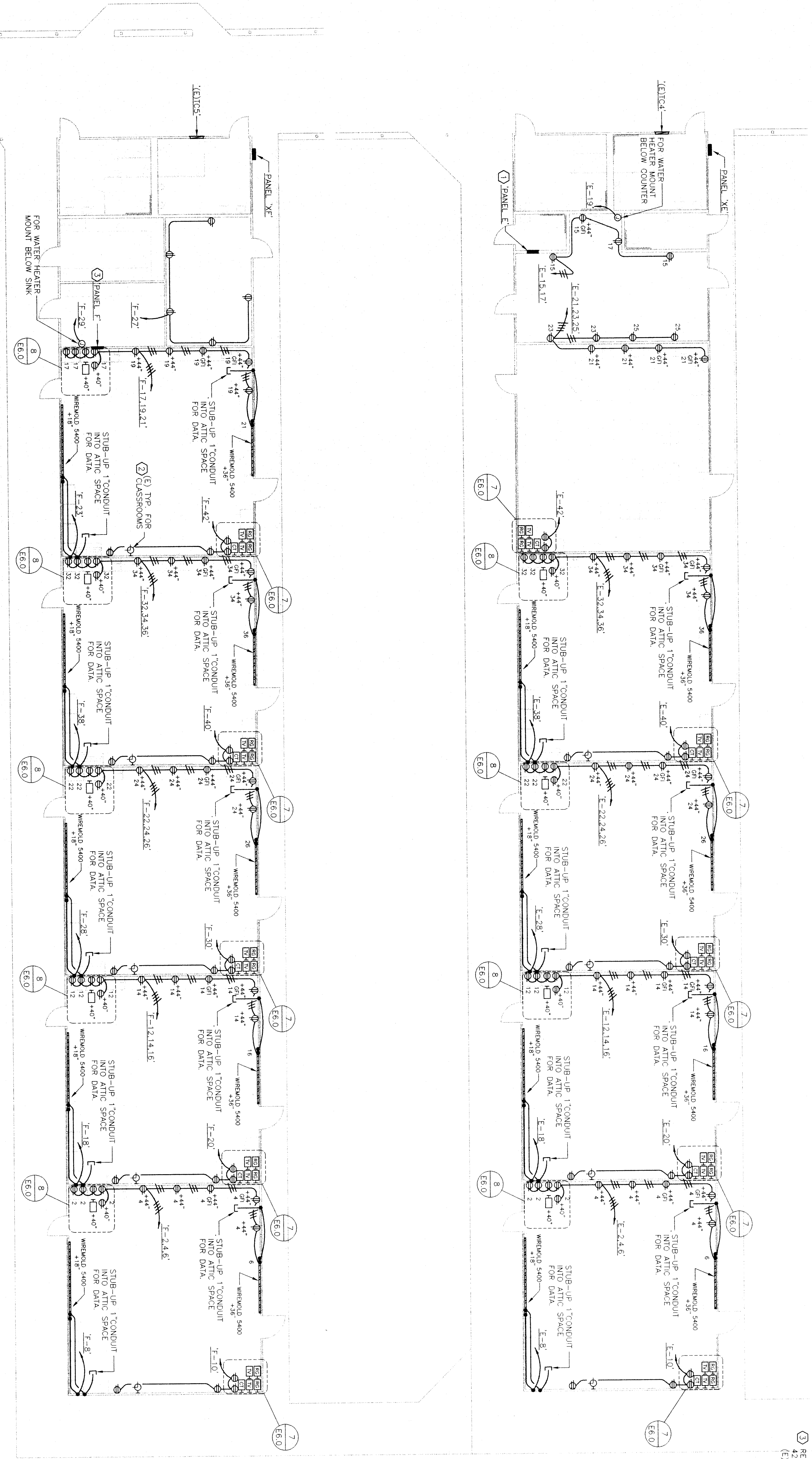

BUILDING 'E' AND BUILDING 'F' POWER PLAN

SCALE: 1/8" = 1'-0"

INTERSTATE ENGINEERS
 440 W. Fairbairn Ave., Suite 106
 Fresno, California 93711
 (509) 452-2400 / (509) 452-4894 fax
 James W. Gorman, Licensed Professional Engineer
 E.T. #8101

**RUTH HARDING SCHOOL
 MODERNIZATION**
 3201 PICO ST.
 FOR
BAKERSFIELD CITY SCHOOL DISTRICT
 BAKERSFIELD, KERN COUNTY, CALIFORNIA

**BLDG. 'E' & 'F'
 POWER PLAN**

REVISION	DATE	DESCRIPTION

PLEASE READ CAREFULLY ALL REQUIREMENTS AND CONDITIONS OF CONTRACT AND SPECIFICATIONS BEFORE PROCEEDING WITH THIS PROJECT. ANY CHANGES TO THE CONTRACT OR SPECIFICATIONS SHALL BE MADE BY A WRITTEN ORDER FROM THE ARCHITECT.

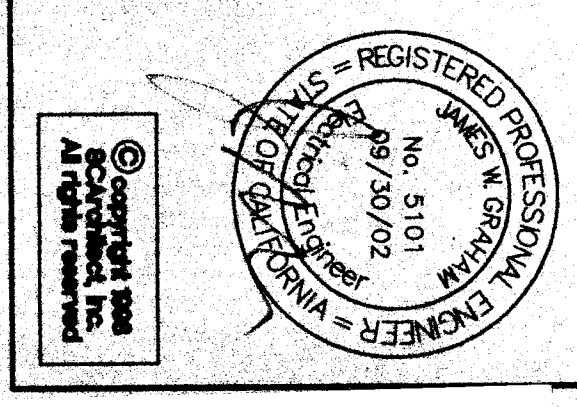

VOID