

ELECTRICAL SITE PLAN

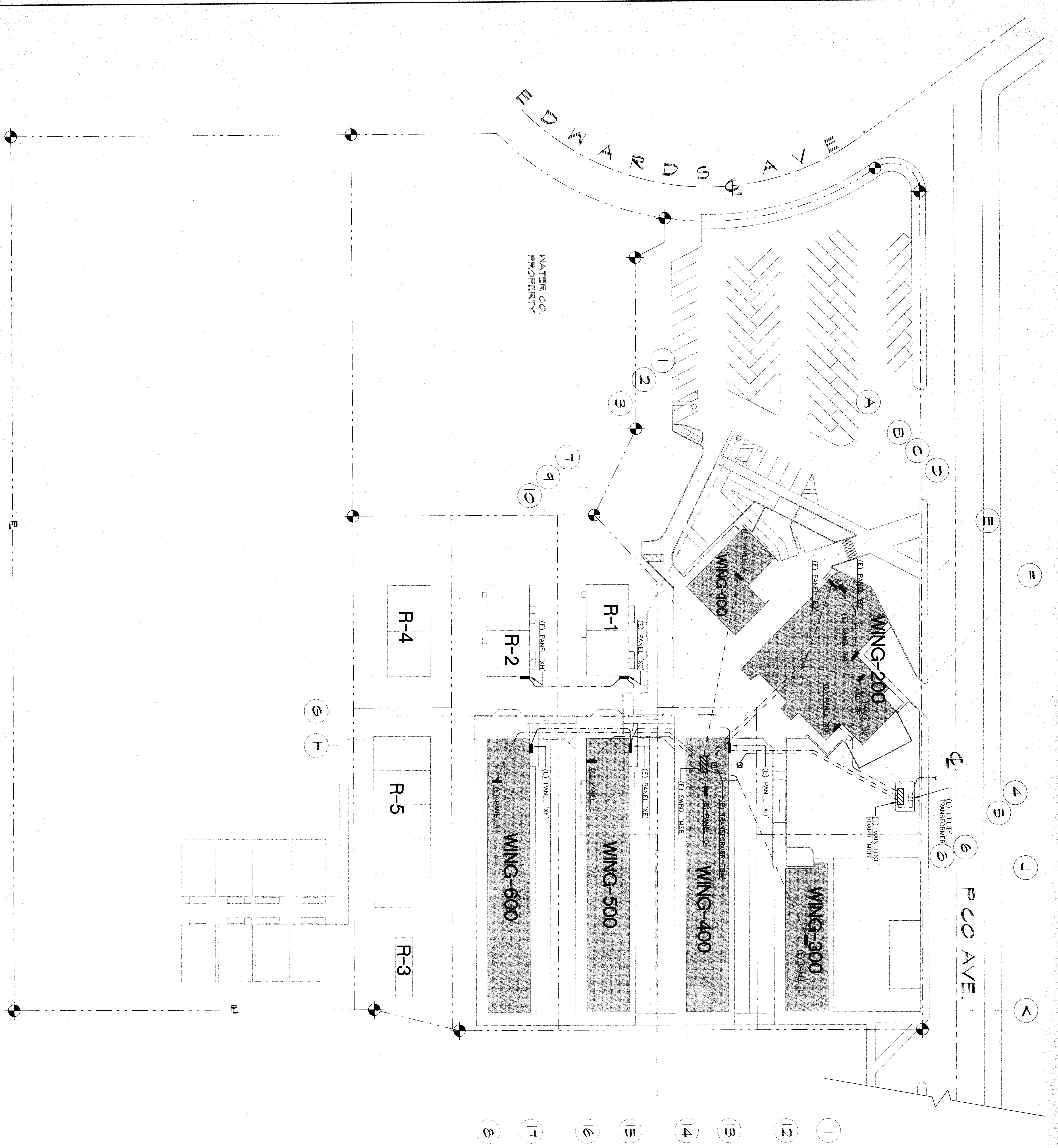

SCALE: 1" = 30'-0"

SYMBOL SCHEDULE

SYMBOL	NAME	DESCRIPTION
(E)	DESIGNATES EXISTING ITEM	
○	CEILING FIXTURE	SEE PLANS & FIXTURE SCHEDULE
○	WALL BRACKET FIXTURE	SEE PLANS & FIXTURE SCHEDULE
□	RECESSED FIXTURE	SEE PLANS & FIXTURE SCHEDULE
□	FLUORESCENT FIXTURE	SEE PLANS & FIXTURE SCHEDULE
□	FLUORESCENT STRIP	SEE PLANS & FIXTURE SCHEDULE
—	TANDEN FIXTURES WIRING CONNECTION	SEE PLANS
—	FIXTURE TYPE AND VOLTAGE	SEE FIXTURE SCHEDULE
○	LOCAL SWITCH	20A - AC QUIET 277V +45" MAX.
○	KEY SWITCH	20A - AC QUIET 277V +45" MAX.
○	LOCAL SWITCH 2-POLE	20A - AC QUIET 277V +45" MAX.
○	3-WAY SWITCH	20A - AC QUIET 277V +45" MAX.
○	4-WAY SWITCH	20A - AC QUIET 277V +45" MAX.
○	PHOTOCELL	20A NEMA GROUNDING +15" MIN.
○	DUPLEX CONVENIENCE OUTLET	20A NEMA GROUNDING +15" MIN.
○	QUADRUPLX CONVENIENCE OUTLET	20A NEMA GROUNDING +15" MIN.
○	WEATHERPROOF CONV. OUTLET	20A NEMA GROUNDING +15" MIN.
○	GROUND FAULT INTERRUPTER	AS REQUIRED - SEE PLANS
○	SPECIAL OUTLET	
○	UNLESS OTHERWISE NOTED	
○	FLOOR OUTLET	FITTINGS AS REQUIRED
○	JUNCTION BOX - AS REQUIRED	45 BOX & FLUSH PLATE MINIMUM
○	ELECTRICAL SWITCHBOARD	REFER TO SINGLE LINE DIAGRAM
○	ELECTRICAL PANEL	REFER TO PANEL SCHEDULE
○	WIRING UNDER FLOOR OR IN WALL	3/4" C. MINIMUM U.O.N.
○	WIRING IN CEILING	3/4" C. MINIMUM U.O.N.
○	CONDUIT STUB AND CAP	
○	CONDUIT RISER	
○	FLEXIBLE CONDUIT	
○	NUMBER OF HASKHARRIS DENOTES NUMBER OF CONDUCTORS	
○	HOME RUN	TO RESPECTIVE PANEL OR TERM. CAB. MINIMUM 1" CONDUIT
○	TELEPHONE RACEWAY	
○	(E) CONDUIT TO REMAIN	
○	EXHAUST FAN	REFER TO MECH. PLANS & SPECS.
○	MOTOR W/DISCONNECT SWITCH	REFER TO MECH. PLANS & SPECS.
○	SWITCHPACK	WATSTOPPER #A1205-P
○	OCCUP. SENSOR (WALL MOUNT)	WATSTOPPER #WS-120
○	OCCUP. SENSOR (CEILING MOUNT)	WATSTOPPER #W-500A
○	OCCUP. SENSOR (CEILING MOUNT)	WATSTOPPER #W-1000A
○	TELEPHONE OUTLET +12" MIN.	SIZE & ENCLOSURE AS REQUIRED AS REQUIRED. MINIMUM 1" CONDUIT
○	TV ANTENNA OUTLET	SINGLE GANG BOX W/BANK PLATE
○	SPEAKER OUTLET	4 1 1/16" X 2 1/8" D. BOX WITH EXTENSION 2 GANG RING, BLANK ABOVE CEILING SPACE WITH NILON PULL LINES.
○	COMMUNICATION/DATA OUTLET	WIREMOLD #3400
○	SURFACE RACEWAY	W/DUPLEX CONV. OUTLET.
○	TELEPHONE HOOKUP	20A NEMA GND. @ 30' O.C. TO NEAREST TELEPHONE BACKBOARD

SCHOOL EQUIPMENT ANCHORAGE

THE SEISMIC ANCHORAGE OF ELECTRICAL EQUIPMENT SHALL CONFORM TO C.C.R. TITLE 24 SECTION 1803.0 AND TABLE 18A-0. ANCHORAGE DETAILS FOR ROOF/FLOOR MOUNTED EQUIPMENT SHALL BE SUBMITTED TO THE FIELD ENGINEER. EQUIPMENT WEIGHTS LESS THAN 20 LBS. MAY BE OMITTED FROM THE PLANS.

ALL ELECTRICAL EQUIPMENT SHALL BE BRACED OR ANCHORED TO RESIST HORIZONTAL FORCE ACTING IN ANY DIRECTION USING THE FOLLOWING:

- EQUIPMENT ON GRADE: 30% OF OPERATING WEIGHT
- EQUIPMENT ON STRUCTURE: 30% OF OPERATING WEIGHT

FOR FLEXIBLY MOUNTED EQUIPMENT USE 4X THE ABOVE VALUES AND FOR SIMULTANEOUS VERTICAL FORCE - USE 1/3X HORIZONTAL FORCE.

THE ABOVE VALUES ARE FOR AN IMPORTANCE FACTOR, I = 1.0 AND SEISMIC ZONE, Z = 0.4

WHERE ANCHORAGE DETAILS ARE NOT SHOWN ON THE DRAWINGS, THE FIELD INSTALLATION SHALL BE SUBJECT TO THE APPROVAL OF THE FIELD ENGINEER AND THE APPROVAL OF THE DIVISION OF THE STATE ARCHITECT.

FIRE PENETRATION NOTE:

REGISTRATION OF PIPES, CONDUITS, ETC., IN WALLS REQUIRING PROTECTED OPENINGS SHALL BE A TESTED ASSEMBLY ACCEPTABLE TO DSA-ORS. (564) AS PER SEC. 300-21.1 CC.

SCAPALINO & LONG
 1800 L STREET
 BAKERSFIELD, CALIFORNIA
 (805) 837-0080

RUTH HARDING SCHOOL MODERNIZATION
 3201 PICO ST.
 FOR
BAKERSFIELD CITY SCHOOL DISTRICT
 BAKERSFIELD, KERN COUNTY, CALIFORNIA

465 W. Foothill Ave., Suite 106
 Fresno, California 93711
 (209) 452-4400 / (209) 452-4494 fax
 James W. Gordon, Registered Engineer
 E.E. #6101

REGISTRATION STATE OF CALIFORNIA
 OFFICE OF REGISTERED PROFESSIONALS
 FILE 15-6
 APR 15 2024
 DATE 03-15-24

ELECTRICAL SITE PLAN & SYMBOL SCHEDULE

OWNER: BAKERSFIELD CITY SCHOOL DISTRICT
 PROJECT: RUTH HARDING SCHOOL MODERNIZATION
 DATE: 04-27-24

DESIGNED AND DRAWN BY: JAMES W. GORDON
 CHECKED BY: JAMES W. GORDON
 DATE: 04-27-24

10

10