

- LEGEND**
- 2x WALL FINISHING TO MATCH (B)
 - (B) WALL TO REMAIN

- KEYNOTES**
- (304) SAWCUT AND REMOVE (B) CONC AS REQD FOR WORK INDICATED
 - (305) DEMO (B) WALL FINISH AS REQD FOR WORK INDICATED
 - (306) DEMO (B) WALL FINISH AS REQD TO REVEAL A SECOND TRANSITION
 - (307) PAINT WOODEN TRAVELERS, JUNKIES, AND MALLONS
 - (308) PAINT CABINET W/ COUNTER TOP - SEE INTERIOR ELEVATIONS
 - (309) STORAGE CABINETS
 - (310) COMPUTER CABINETS
 - (321) BOOK SHELVES
 - (322) MAGAZINE RACK
 - (323) INSTRUCTIONS CLOSET
 - (324) PROTECTION SCREEN
 - (325) SOLID PLASTIC PARTITION
 - (326) FLASHING FINISHES - SEE FLASHING SHEETS
 - (327) PATCH AND MATCH CONC SLAB AS REQUIRED FOR WORK INDICATED
 - (328) NOT USED
 - (329) UPPER CABINETS - SEE INTERIOR ELEVATION
 - (330) NOT USED

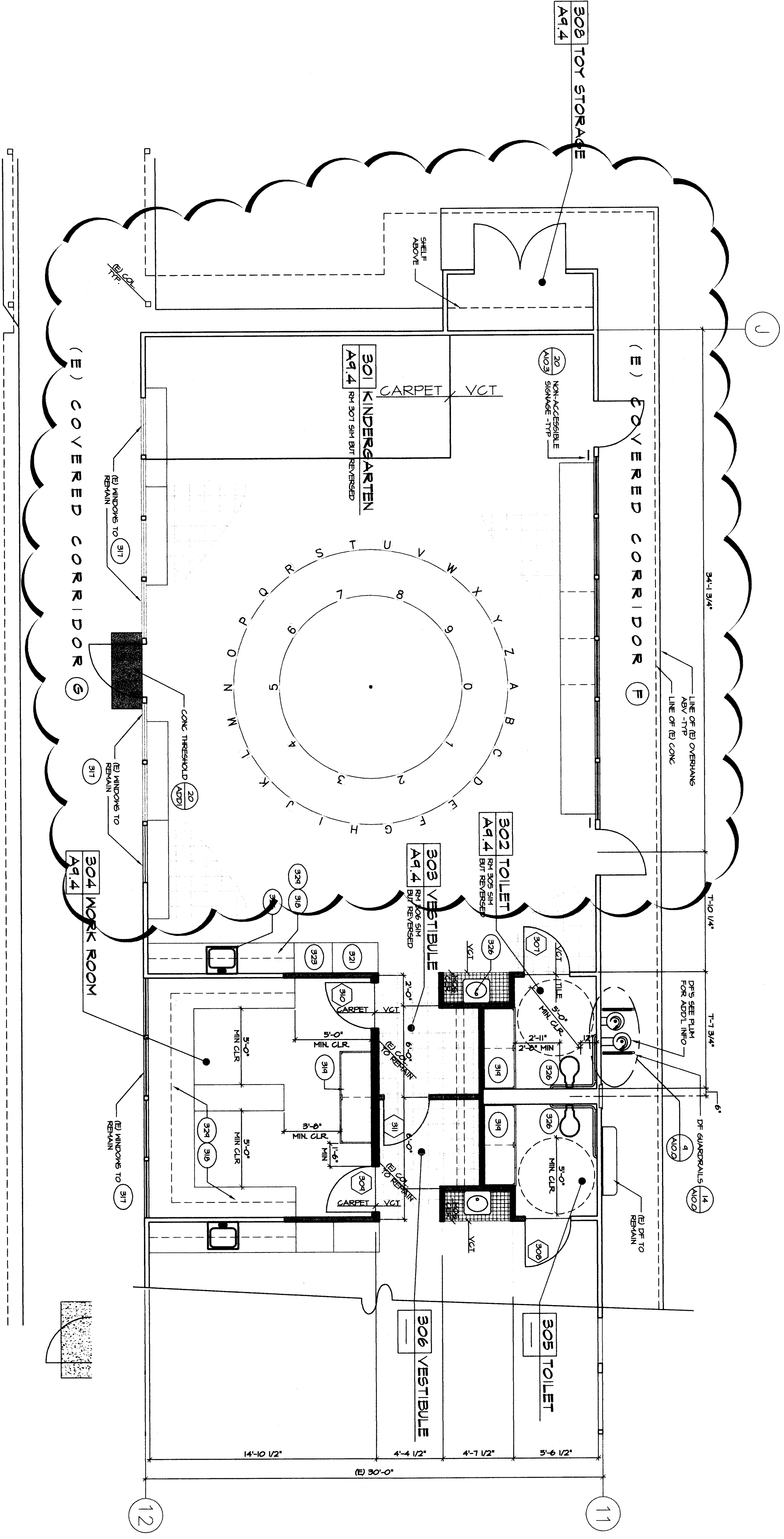
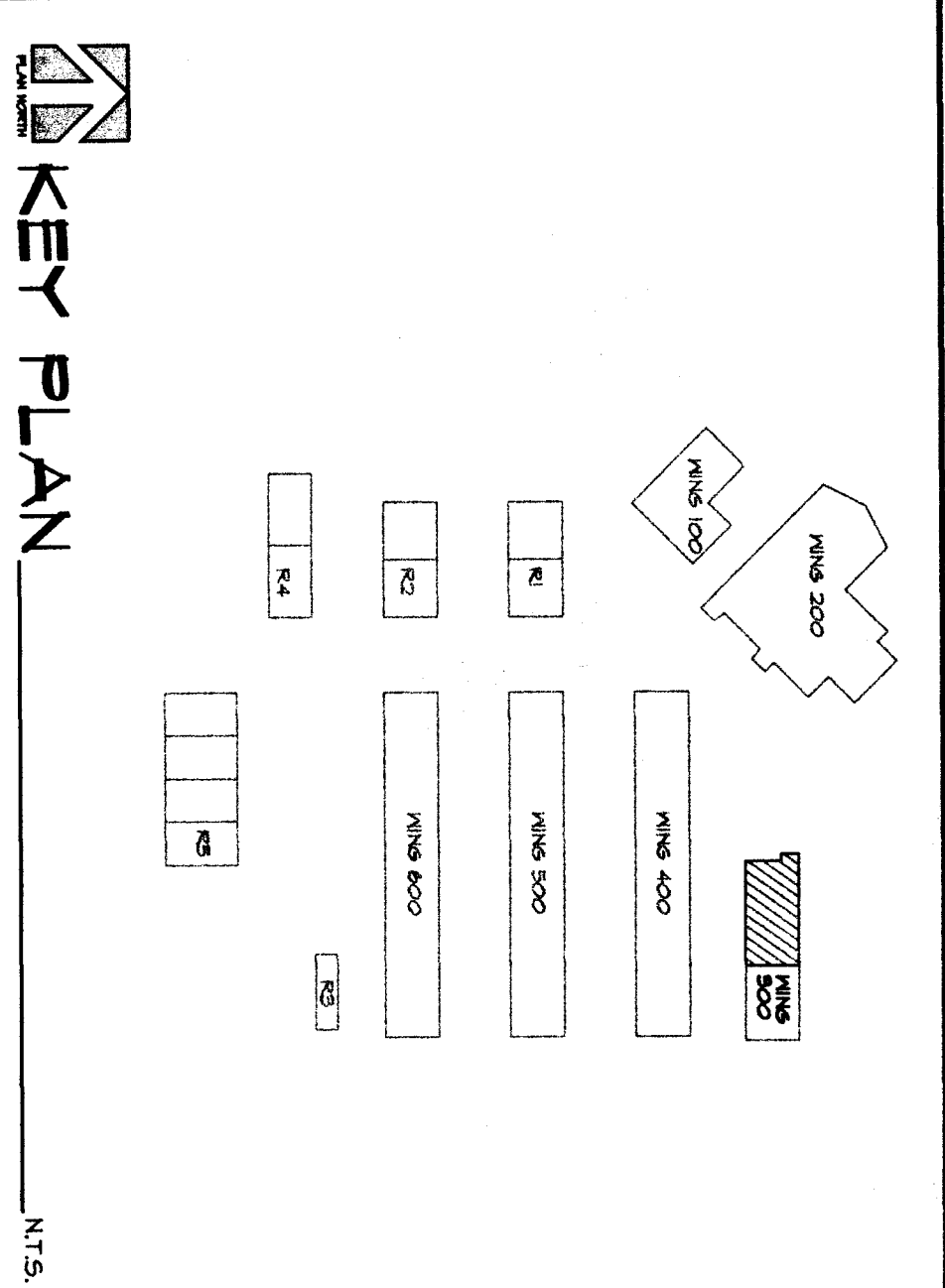

B PARTIAL FLOOR PLAN - WING 300
 WING "300"
 PLAN NORTH

SCALE: 1/4" = 1'-0"

10. Refer to Drawings Sheet A3.1 Partial Floor Plan-Wing 300.
 a. DELETE
 b. ADD

MARK	DATE	REVISIONS

CHECK AND VERIFY ALL DIMENSIONS BEFORE PROCEEDING WITH THE WORK. REPORT DISCREPANCIES TO THE ARCHITECT. ALL DIMENSIONS SHALL CONFORM TO THE CONTRACT.

RUTH HARDING SCHOOL
 MODERNIZATION
 3201 PICO AVE.
 FOR
 BAKERSFIELD CITY SCHOOL DISTRICT
 BAKERSFIELD, KERN COUNTY, CALIFORNIA

REGISTRATION STATE OF THE STATE ARCHITECT
 C. W. BAKER, ARCHITECT
 APR. 03-102156
 FEB. 13-5
 REG. 05-10-10292 - \$5
 P/N: N/A



301 I STRAET
 BAKERSFIELD, CA 93301
 PH: (661) 327-1632
 FAX: (661) 327-2339

ADDENDUM #01
RUTH HARDING SCHOOL
 MODERNIZATION
 BAKERSFIELD CITY SCHOOL DISTRICT
 BAKERSFIELD, CALIFORNIA

JOB NO.	DATE	BY	DATE

6

PARTIAL FLOOR PLAN-WING 300

JOB NO. 957.1
 DRAWN BY: [Signature]
 CHECKED BY: [Signature]
 DATE: 08/19/03

31
 1 OF 31 SHEETS