

GENERAL NOTES:

GENERAL CONTRACTOR SHALL VERIFY AND PROVIDE AS REQUIRED. ALL WORK SHALL BE DONE WITHIN THE PERMITTED TIME FRAME. ALL WORK SHALL BE DONE WITHIN THE PERMITTED TIME FRAME. ALL WORK SHALL BE DONE WITHIN THE PERMITTED TIME FRAME.

REMOVE (E) VCT SCHEDULED TO BE REMOVED TO REVEAL CONCRETE PATCH AREAS SCHEDULED TO RECEIVE CARPETING OVER (E) VCT TO PROVIDE UNIFORM SURFACE SUBSTRATE.

REMOVE (E) CABINETS IN CLASSROOMS SCHEDULED TO RECEIVE NEW CABINETS, SEE FLOOR PLANS & INTERIOR ELEVATIONS.

REMOVE (E) TRACKER IN MULTI-PURPOSE BUILDING PRIOR TO INSTALLING NEW VINYL COVERED TRACKBOARD, SEE INTERIOR ELEVATIONS.

REMOVE EXIST. DOORS & FRAMES AS NOTED ON PLAN. PROVIDE EXIST. DOORS & FRAMES AS SCHEDULED. NOTES TYPICAL OF ALL CLASSROOMS EXCEPT AS NOTED OTHERWISE.

CAP ALL ABANDONED UTILITIES BEHIND FINISH SURFACES.

PROVIDE ADDITIONAL GUE-UP ACOUSTICAL TILES PANELS TO MATCH EXISTING AS REQUIRED WHEN CEILING HAS BEEN DAMAGED DURING CONSTRUCTION. CONTRACTOR SHALL VERIFY ALL EXIST. MECH'L REGISTER & GRILLE LOCATIONS IN EXIST. CEILING.

BLDG. "A" (100)

FLOOR PLAN

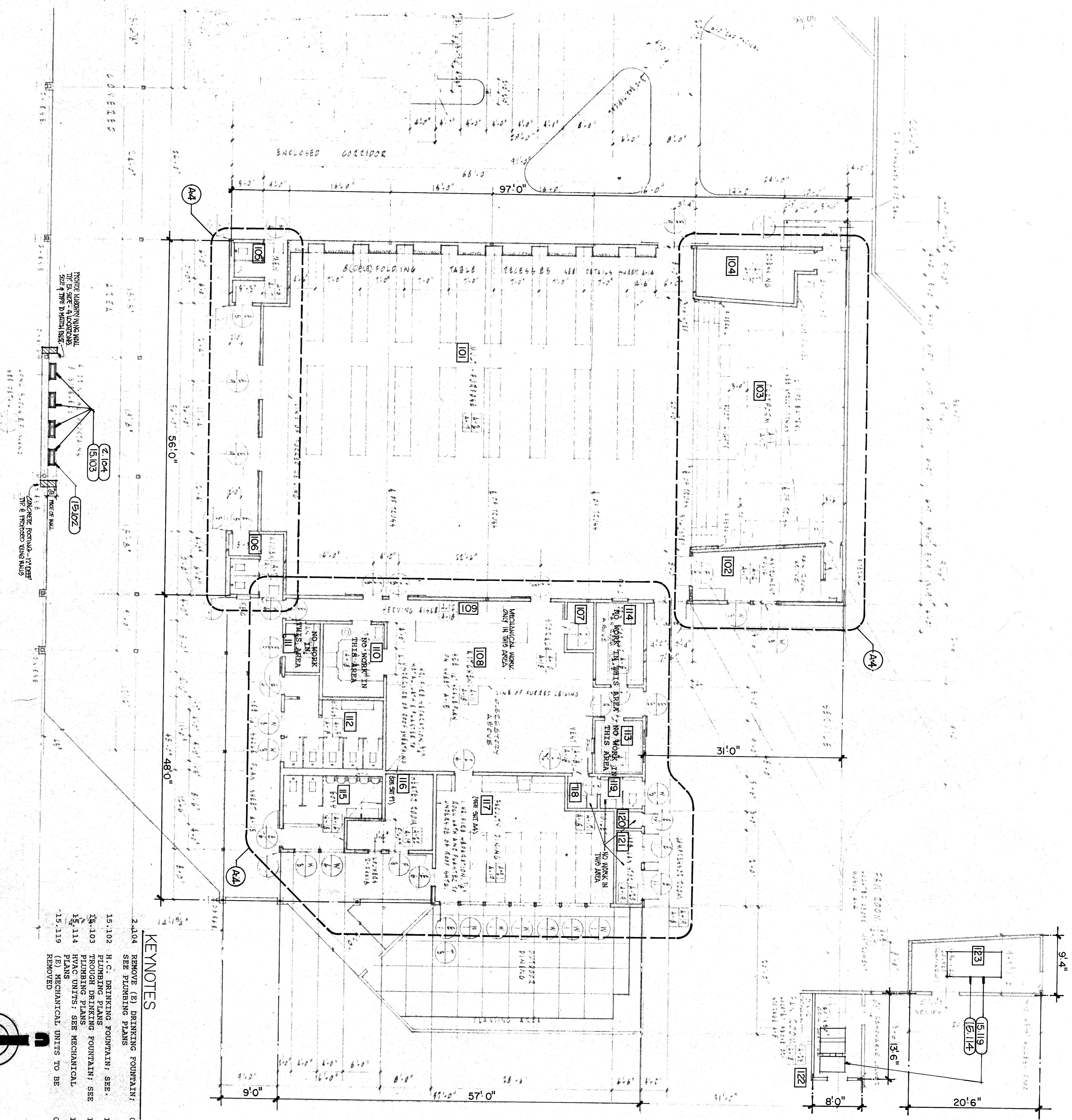

- KEYNOTES**
- 2.104 REMOVE (E) DRINKING FOUNTAIN; SEE FLOORING PLANS 02072
 - 15.102 H.C. DRINKING FOUNTAIN; SEE PLUMBING PLANS 15400
 - 15.103 THROUGH DRINKING FOUNTAIN; SEE PLUMBING PLANS 15400
 - 15.114 HVAC UNITS; SEE MECHANICAL PLANS 15800
 - 15.119 (E) MECHANICAL UNITS TO BE REMOVED 02072

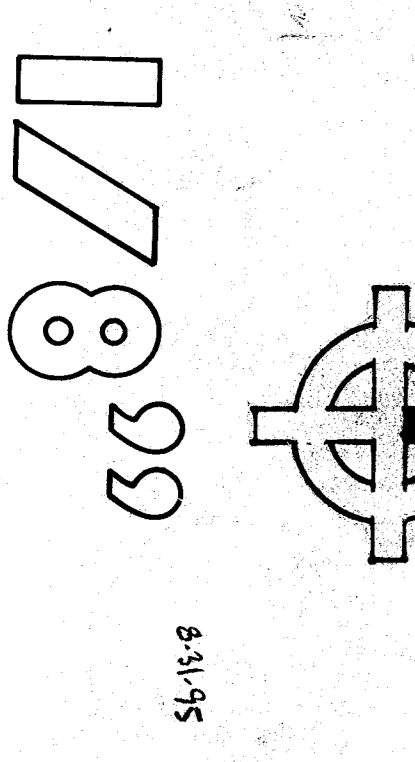

pechin associates architects aia

1400 easton drive suite 138
bakersfield, ca 93309 (805)322-2021

Harvey C. Pechin C-8366

Project Number: 408-0688

Frank West Elementary School
Modernization
Bakersfield City School District

DATE	ISSUE FOR
DATE	REVISION

THESE DRAWINGS, RELATED SPECIFICATIONS, IDEAS, DESIGNS, AND ARRANGEMENTS REPRESENTED THEREBY ARE AND SHALL REMAIN THE PROPERTY OF THE ARCHITECT; AND NO PART THEREOF SHALL BE COPIED, DISCLOSED TO OTHERS OR USED IN CONNECTION WITH ANY WORK OR PROJECT OTHER THAN THE SPECIFIC PROJECT FOR WHICH THEY HAVE BEEN PREPARED AND DEVELOPED WITHOUT THE WRITTEN CONSENT OF THE ARCHITECT. VISUAL CONTACT WITH THESE DRAWINGS OR SPECIFICATIONS SHALL CONSTITUTE CONCLUSIVE EVIDENCE OF ACCEPTANCE OF THESE RESTRICTIONS.

WRITTEN DIMENSIONS ON THESE DRAWINGS SHALL HAVE PRECEDENCE OVER SCALED DIMENSIONS; CONTRACTORS SHALL VERIFY AND BE RESPONSIBLE FOR ALL DIMENSIONS AND CONDITIONS ON THE JOB AND THIS OFFICE MUST BE NOTIFIED OF ANY VARIATIONS FROM THE DIMENSIONS AND CONDITIONS SHOWN BY THESE DRAWINGS.

DETAILED SHOP DRAWINGS MUST BE SUBMITTED TO THIS OFFICE FOR REVIEW BEFORE PROCEEDING WITH THE FABRICATION OF ANY PRODUCT TO BE INCLUDED IN THIS PROJECT.