

TO PORTABLE UNITS R/
SEE PARTIAL SITE PLAN
BELOW FOR CONT'N.

NOTE VERIFY WITH ARCHITECT
FOR ALT BID ITEMS.

UNIT B
All Electrical ~~is~~ Conduits
24" R.O.C. Grade TYP.

PARTIAL SITE ELECTRICAL PLAN
SCALE: 1" = 30'-0"

SEE SITE PLAN
FOR CONT'N.

ELECTRICAL NOTES: SITE ELECTRICAL PLAN

1. NEW EXPOSED CONDUIT TO BE RUN UP WALL FROM ABOVE UNDER EAVE. FINISH THROUGH ROOF TO AC UNITS.
2. REMOVE ALL AC UNITS. REFER TO ONE LINE DIAGRAM, SHEET NO. FOR ALL FEEDER TRACINGS. VERIFY EXISTING ROUTING OF ALL FEEDERS WITH PROJECT'S FEEDER TO NEW WORK.
3. PROVIDE 1/2" X 1/2" X 6" POLY CON OR EXTENSION WALL.
4. RUN FEEDER UP CORNER OF EXTENSION WALL THEN ALONG UNDER EAVE. FINISH THROUGH ROOF TO AC UNITS.
5. PROVIDE UNDERGROUND PULL BOX PER DETAIL 7/22.
6. CONNECT FROM UNIT WIRING TO MAIN SERVICE PANEL. 1/2" WITH 1/2" PANEL. WIRE W/HEAT. FINISH DOWN WALL PER FEED.
7. PROVIDE LOW VOLTAGE CIRCUIT FROM UNIT TO RECOMMEND. W/AC TIE THE CLOCK REWIND. PULL OUT FUSE WIRE AND REMOVE ANY EXPOSED WIRE CONDUIT. LABEL.
8. DISCONNECT AND REMOVE ALL ELECTRICAL SERVICES TO EXISTING SOLAR EQUIPMENT BEING REMOVED. PULL OUT FUSE WIRE AND REMOVE ANY EXPOSED WIRE CONDUIT. LABEL.
9. DISCONNECT ALL ELECTRICAL SERVICES TO EXISTING UNIT VENTILATORS BEING REMOVED. PULL OUT ANY FUSE WIRE AND REMOVE ANY EXPOSED WIRE CONDUIT.
10. FEED AC'S FROM EXISTING PANEL W/ WITH 3/4" X 2" 1/2" X 1/2" GND. PROVIDE 5/8" X 1/2" FROM IN PANEL. REMOVE ALL EXPOSED WIRE AND REMOVE ANY EXPOSED WIRE CONDUIT.
11. DISCONNECT AND REMOVE ALL ELECTRICAL SERVICES TO EXISTING UNIT VENTILATORS BEING REMOVED. PULL OUT ANY FUSE WIRE AND REMOVE ANY EXPOSED WIRE CONDUIT.
12. NEW AC UNIT OR ROOF TO REPLACE EXISTING VAPORATIVE COOLER. PULL OUT ANY FUSE WIRE OR EXPOSED WIRE AND REMOVE ANY EXPOSED WIRE CONDUIT. RE-INSTALL BREAKERS IN EXISTING PANEL AS SHOWN ON ROOF SECTION.
13. NEW CONDENSING UNITS ON GROUND. CONNECT PER ONE LINE DIAGRAM. ALT BID #1.
14. LOCKS DISCONNECT SWITCHES FOR CU UNITS OR EXTENSION WALL OF BUILDING. ALT BID #1.
15. NEW FEED EXPOSED ON WALL UP TO PAN ROOM ABOVE AND CONNECT TO 1-1 UNIT PER ONE LINE DIAGRAM. ALT BID #1.
16. NEW PAN UNIT (48) TO REPLACE EXISTING PAN (289). DISCONNECT ELECTRICAL TO EXISTING PAN AND PULL OUT FUSE WIRE. LABEL BREAKER IN PANEL AS SHOWN. (ALTERNATIVE BID #1)
17. PROVIDE UNDERGROUND 18V CIRCUIT TO PUMPAGE ELECTRIC MOTOR. ALT BID #1.
18. EXISTING PAN UNIT (139V) TO BE REPLACED WITH NEW F-2 UNIT (48V).
19. DISCONNECT ELECTRICAL TO EXISTING AND CONNECT NEW F-2 UNIT AS SHOWN ON ONE LINE DIAGRAM. ALT BID #1.
20. NEW DISTRIBUTION SWITCHBOARD. SEE ONE-LINE DIAGRAM AND DETAIL 6/22.
21. RUN 1 1/2" C SPARE FOR FUTURE AC UNITS AT UNIT D.
22. FEEDERS SIZED PER ONE LINE DIAGRAM. SAN CIP AND PAVO EXISTING PAVING AS REQUIRED. SOBE UNDER WALKS. VERIFY ALL ROUTING WITH ARCHITECT.
23. VERIFY WITH ARCHITECT AND OTHERS FOR ROUTING OF ALL EXPOSED FEEDS PRIOR TO INSTALLATION. TYPICAL AT ALL BUILDING UNITS.
24. VERIFY WITH ARCHITECT AND OTHERS FOR ROUTING OF ALL EXPOSED FEEDS PRIOR TO INSTALLATION. TYPICAL AT ALL BUILDING UNITS.
25. ALL LINE AND LOW VOLTAGE CIRCUIT AND WIRING FOR HVAC UNIT CIRCUITS IS TO BE PROVIDED AND INSTALLED BY CONTRACTOR.
26. ALL EQUIPMENT TO BE REMOVED SHALL REMAIN THE PROPERTY OF THE BAKERSFIELD CITY SCHOOL DISTRICT. AT THE DIRECTION OF THE SCHOOL, THE CONTRACTOR SHALL REMOVE ALL EQUIPMENT OR 17 IN AN APPROVED MANNER. SCHOOL DISTRICT WAREHOUSE OR DISPOSAL OF 17 IN AN APPROVED MANNER. U/E ENT. OF Walkways
27. 3/4" Conduit with Conduit Wires for Energy Management System

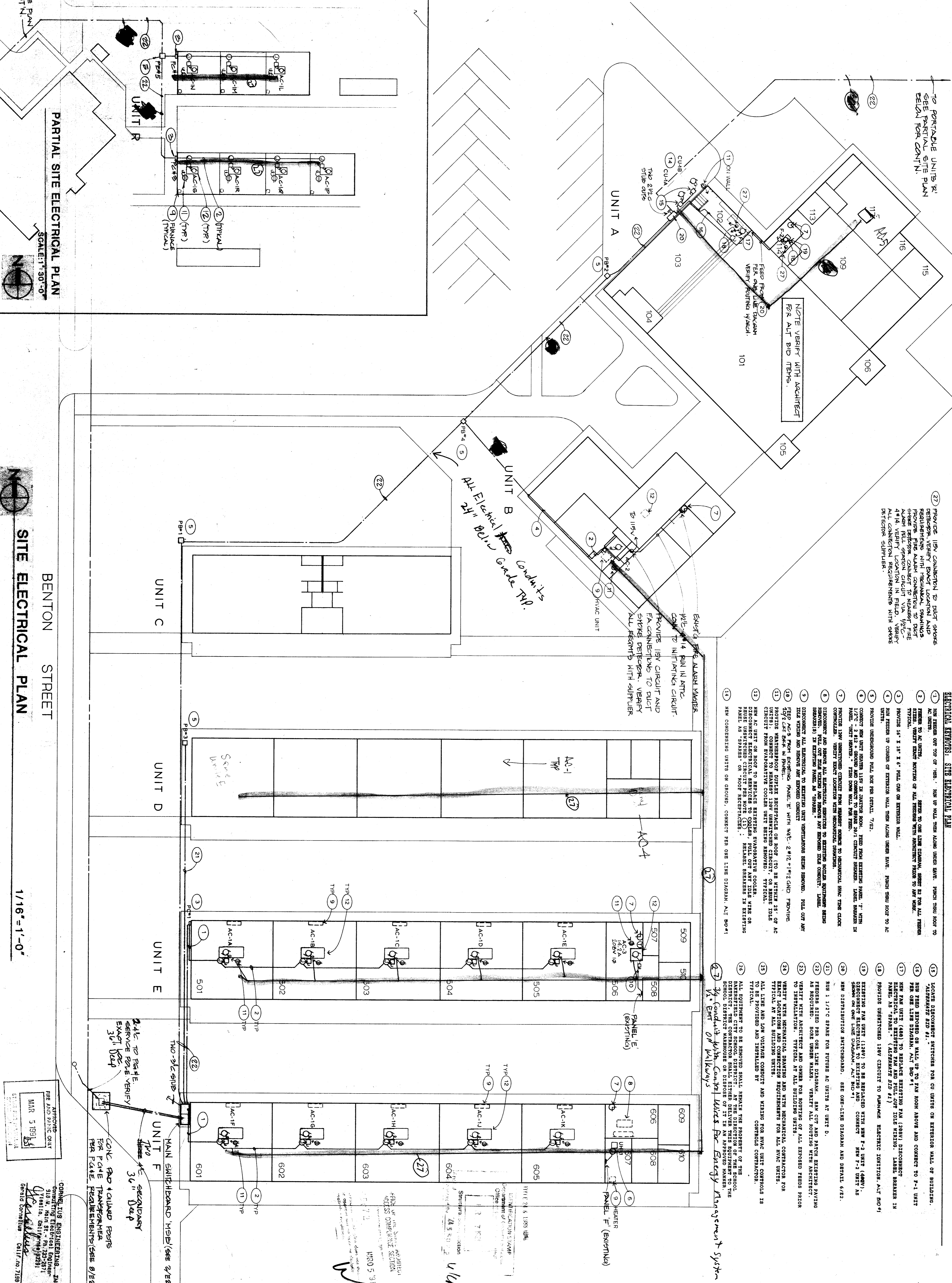

BENTON STREET
SITE ELECTRICAL PLAN
1/16" = 1'-0"

APPROVED
FIRE AND PAVIC ONLY
MAR 3 1991
CONTRACTOR'S SIGNATURE
DATE

pechin associates
architects aia

1400 easton drive suite 138
bakersfield, ca 93309 (805) 822-2021

Frank West Elementary School
HVAC
Bakersfield City School District

DATE	ISSUE FOR
DATE	REVISION

THESE DRAWINGS, RELATED SPECIFICATIONS, IDEAS, DESIGNS AND ARRANGEMENTS REPRESENTED THEREBY ARE AND SHALL REMAIN THE PROPERTY OF THE ARCHITECT AND NO PART THEREOF SHALL BE COPIED, DISCLOSED TO OTHERS OR USED IN CONNECTION WITH ANY WORK OTHER THAN THE SPECIFIC PROJECT FOR WHICH THEY HAVE BEEN PREPARED AND DEVELOPED WITHOUT THE WRITTEN CONSENT OF THE ARCHITECT. VISUAL CONTACT WITH THESE DRAWINGS OR SPECIFICATIONS SHALL CONSTITUTE CONCLUSIVE EVIDENCE OF ACCEPTANCE OF THESE RESTRICTIONS.

WRITTEN DIMENSIONS ON THESE DRAWINGS SHALL HAVE PRECEDENCE OVER SCALED DIMENSIONS. CONTRACTORS SHALL VERIFY AND BE RESPONSIBLE FOR ALL DIMENSIONS AND CONDITIONS ON THE DRAWINGS AND NOTIFY THE ARCHITECT OF ANY VARIATIONS FROM THE DIMENSIONS AND CONDITIONS SHOWN BY THOSE DRAWINGS.

DETAILED SHOP DRAWINGS MUST BE SUBMITTED TO THIS OFFICE FOR REVIEW BEFORE PROCEEDING WITH THE FABRICATION OF ANY PRODUCT TO BE INCLUDED IN THIS PROJECT.