

# FLOOR PLANS

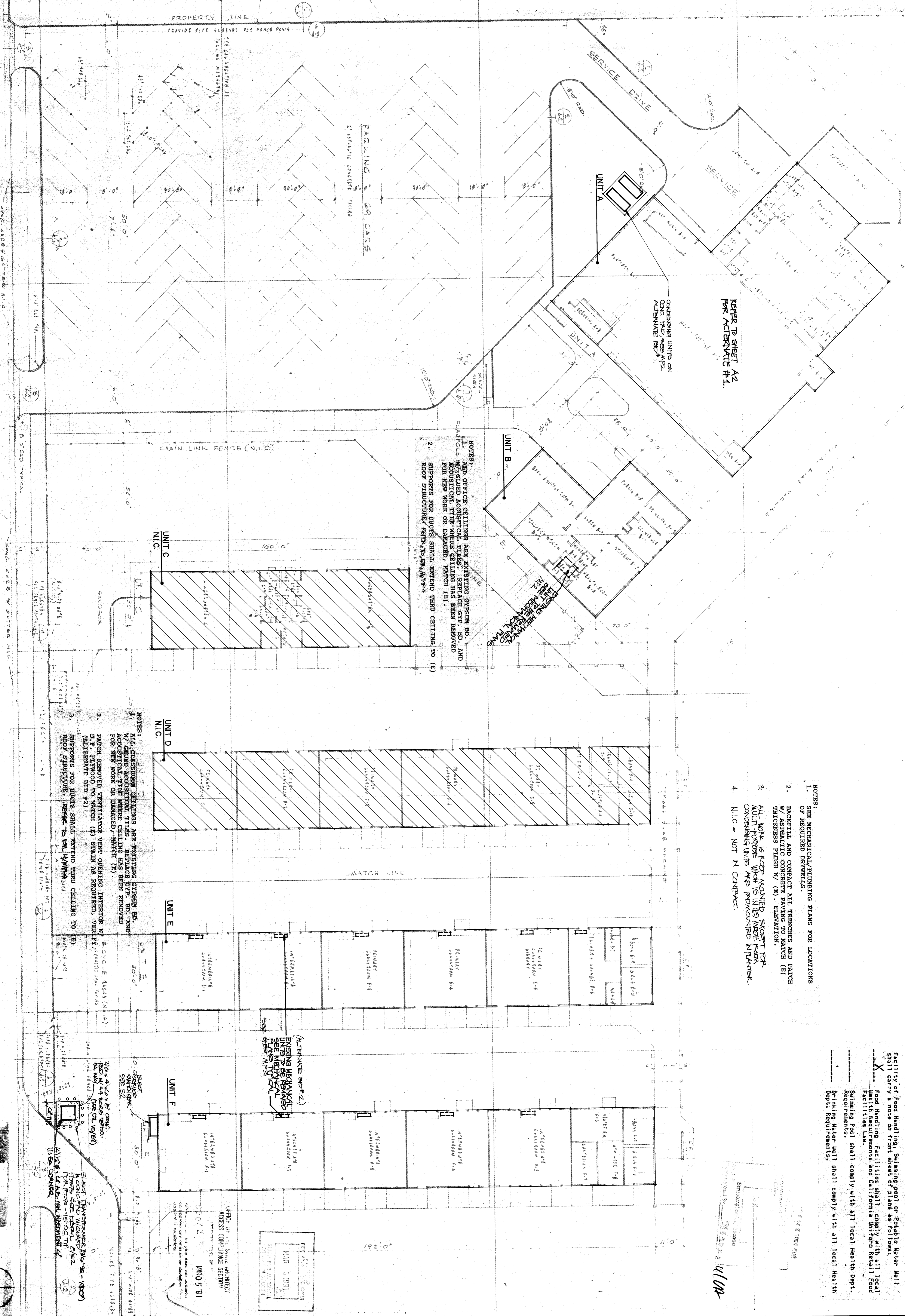

REFER TO SHEET A2 FOR ALTERNATE #1.

**NOTES:**  
1. ALL OFFICE CEILING ARE EXISTING GYPSUM BD. FLATFLOE W/ GIBED ACOUSTICAL TILES. REPLACE GYP. BD. AND ACOUSTICAL TILE WHERE CEILING HAS BEEN REMOVED FOR NEW WORK OR DAMAGED. MATCH (E).  
2. SUPPORTS FOR DUCTS SHALL EXTEND THRU CEILING TO (E) ROOF STRUCTURE. REFER TO SP4/W/MS-4

**NOTES:**  
1. ALL CLASSROOM CEILING ARE EXISTING GYPSUM BD. FLATFLOE W/ GIBED ACOUSTICAL TILES. REPLACE GYP. BD. AND ACOUSTICAL TILE WHERE CEILING HAS BEEN REMOVED FOR NEW WORK OR DAMAGED. MATCH (E).  
2. PATCH REMOVED VENTILATOR VENT OPENING INTERIOR W/ D.P. PLYWOOD TO MATCH (E) STAIN AS REQUIRED. VERIFY MATCH TO MATCH (E).  
3. SUPPORTS FOR DUCTS SHALL EXTEND THRU CEILING TO (E) ROOF STRUCTURE. REFER TO SP4/W/MS-4

- 1. SEE MECHANICAL/PUMPING PLANS FOR LOCATIONS OF REQUIRED DRYWELLS.
- 2. BACKFILL AND COMPACT ALL TRENCHES AND PATCH W/ ASPHALTIC CONCRETE PAVING TO MATCH (E) THICKNESS FINISH W/ (E) ELEVATION.
- 3. ALL WORK IS TO BE NOTICED PERMIT FOR MULTI-PURPOSE WHICH IS IN (E) NEAR INFRASTRUCTURE. CONCRETE UNITS ARE FOUNDATIONED INFRASTRUCTURE.
- 4. N.I.C. = NOT IN CONTACT

**SCHOOL PROJECTS INVOLVING**

Facility of Food Handling, Swimming pool or Potable Water Hall shall carry a note on front sheet of plans as follows:

- Food Handling Facilities shall comply with all local and state health and safety codes and California Uniform Retail Food Facility Law.
- Swimming Pool shall comply with all local Health Dept. Requirements.
- Drinking Water Hall shall comply with all local Health Dept. Requirements.

Structural Steel Connection

07/20/09

DATE	ISSUE FOR
DATE	REVISION

THESE DRAWINGS, RELATED SPECIFICATIONS, IDEAS, DESIGNS, AND ARRANGEMENTS REPRESENTED THEREON AND SHALL REMAIN THE PROPERTY OF THE ARCHITECT, AND NO PART THEREOF SHALL BE COPIED, DISCLOSED TO OTHERS OR USED IN CONNECTION WITH ANY WORK OR PROJECT OTHER THAN THE SPECIFIC PROJECT FOR WHICH THEY HAVE BEEN PREPARED AND DEVELOPED WITHOUT THE WRITTEN CONSENT OF THE ARCHITECT. VISUAL CONTACT WITH THESE DRAWINGS OR SPECIFICATIONS SHALL CONSTITUTE CONCLUSIVE EVIDENCE OF ACCEPTANCE OF THESE RESTRICTIONS.

WRITTEN DIMENSIONS ON THESE DRAWINGS SHALL HAVE PRECEDENCE OVER SCALE DIMENSIONS. CONTRACTORS SHALL VERIFY AND BE RESPONSIBLE FOR ALL DIMENSIONS AND CONDITIONS ON THE JOB AND THE OFFICE MUST BE NOTIFIED OF ANY VARIATIONS FROM THE DIMENSIONS AND CONDITIONS SHOWN BY THOSE DRAWINGS.

DETAILED SHOP DRAWINGS MUST BE SUBMITTED TO THIS OFFICE FOR REVIEW BEFORE PROCEEDING WITH THE FABRICATION OF ANY PRODUCT TO BE INCLUDED IN THIS PROJECT.

**pechin associates aia**  
1400 easton drive suite 138  
bakersfield, ca 93309 (805) 322-2021

**Kerron C. Pechin** C-8366

**PROJECT INFORMATION:**  
FRANK WEST ELEMENTARY SCHOOL  
HVAC  
BAKERSFIELD CITY SCHOOL DISTRICT  
ARCHITECT: KERRON C. PECHIN ASSOCIATES  
DATE: 07/20/09  
PROJECT NUMBER: 449-0889  
Plot Date: 01/03/09