

Frank West Elementary School HVAC

Bakersfield City School District

Project Data

SITE ZONING R-2/C.U.P.
 BUILDING CONSTRUCTION V-NON RATED
 BUILDING OCCUPANCY GROUP E-1 / A-3

UNIT B - ADMINISTRATION BLDG. 3916.84'
 UNIT E - CLASSROOMS (1-6) 6594.50'
 UNIT F - CLASSROOMS (1-6) 6479.00'
 RELOCATABLE R-1 960.00'

Design Team

Architect
PECHIN ASSOCIATES
 1400 Easton Drive, Suite 138
 Bakersfield, Ca. 93309
 (805) 322-2021

Mechanical Engineer
DONALD R. & LAWRENCE & ASSOC.
 1300 W. Snow Ave., Suite 2B
 Fresno, Ca. 93271
 (209) 226-0101

Structural Engineer
WHEELER & GRAY
 7462 N. Figueroa Street
 Los Angeles, Ca. 90041
 (213) 256-2101

Electrical Engineer
CORNELIUS ENGINEERING
 918 West Main Street
 Visalia, CA 93291
 (209) 733-2671

Sheet Index

- ARCHITECTURAL
- TS TITLE SHEET
 - A1 SITE PLAN 1"-40'-0"
 - A2 FLOOR PLANS 1/8" UNITS A, B, E & F
 - A3 ROOF PLANS 1/8" UNITS A, B, E & F
 - A4 EXTERIOR ELEVATIONS 1/8" UNITS A & B
 - A5 EXTERIOR ELEVATIONS 1/8" UNITS E & F
 - A6 FLOOR PLAN & EXTERIOR ELEVATIONS - RELOCATABLES RI
- MECHANICAL/PLUMBING
- MP1 MECHANICAL SITE PLAN, PARTIAL PLAN, LEGENDS
 - MP2 MECHANICAL PLANS - UNITS A & B
 - MP3 MECHANICAL PLANS - UNITS E & F
 - MP4 MECHANICAL DETAILS
 - MP5 MECHANICAL PLAN - RELOCATABLES, RI & SCHEDULES
- ELECTRICAL
- E1 SITE / FLOOR ELECTRICAL PLANS
 - E2 ONE LINE DIAGRAM, NOTES & DETAILS

General Notes

These plans were based on plans by others, furnished by the Owner, indicating work of previous contracts. These plans shall be subject to the Architect's review. The Contractor shall assume no responsibility for the existing conditions and measurements indicated on these plans. The Contractor shall be responsible for providing the measurements and conditions for the work shown on these plans. The Contractor shall be responsible for providing the measurements and conditions for the work shown on these plans. The Contractor shall be responsible for providing the measurements and conditions for the work shown on these plans.

ASBESTOS ABATEMENT NOTES

The Owner shall employ an ASBESTOS ABATEMENT TEAM, that, in conjunction with a Certified Industrial Hygienist, will remove or encapsulate any asbestos materials. Cost of asbestos work and services by the Certified Industrial Hygienist are not a part of this Contract. It shall be clearly understood by the Contractor and the Owner that the Architect is not responsible in any way whatsoever for the detection of the presence of asbestos or the abatement work thereon. After the Certified Industrial Hygienist has certified that the environment is free of asbestos fibers for samples and laboratory tests the General Contractor will complete the work of this Contract. It is the General Contractor's responsibility to keep the Owner informed as to when the Asbestos Abatement Team will be required to commence their work. The General Contractor shall immediately notify both the Owner and the Architect if asbestos is uncovered in any location and the work shall be stopped immediately. Stop work immediately until the Owner has the asbestos removed or encapsulated.

APPLICABLE CODES

Title 24, Part 2, C.C.R.; 1989 C.A.C. (1988 U.S.C. W California amendments)
 Title 24, Part 2, C.C.R.; 1989 C.A.C. (1988 U.S.C. W California amendments)
 Title 24, Part 2, C.C.R.; 1989 C.A.C. (1988 U.S.C. W California amendments)
 Title 24, Part 2, C.C.R.; 1989 C.A.C. (1988 U.S.C. W California amendments)

Alternate Bid No. 1

Provide door grid materials for installing a complete mechanical system. The door grid materials shall be in accordance with the specifications for the door grid materials in the Mechanical Schedule. The door grid materials shall be in accordance with the specifications for the door grid materials in the Mechanical Schedule.

Alternate Bid No. 2

Removal of all heating, ventilating, and piping, repair and patching of floor space the units occupied and fill-in and patching of the wall after removal of unit vents.

The Structural, Mechanical and Electrical Drawings are supplementary to the Architectural Drawings. It shall be the responsibility of the Contractor to check with the Architectural Drawings before the installation of structure or equipment. The Contractor shall be responsible for providing the measurements and conditions for the work shown on these plans. The Contractor shall be responsible for providing the measurements and conditions for the work shown on these plans. The Contractor shall be responsible for providing the measurements and conditions for the work shown on these plans.

Neighborhood Map

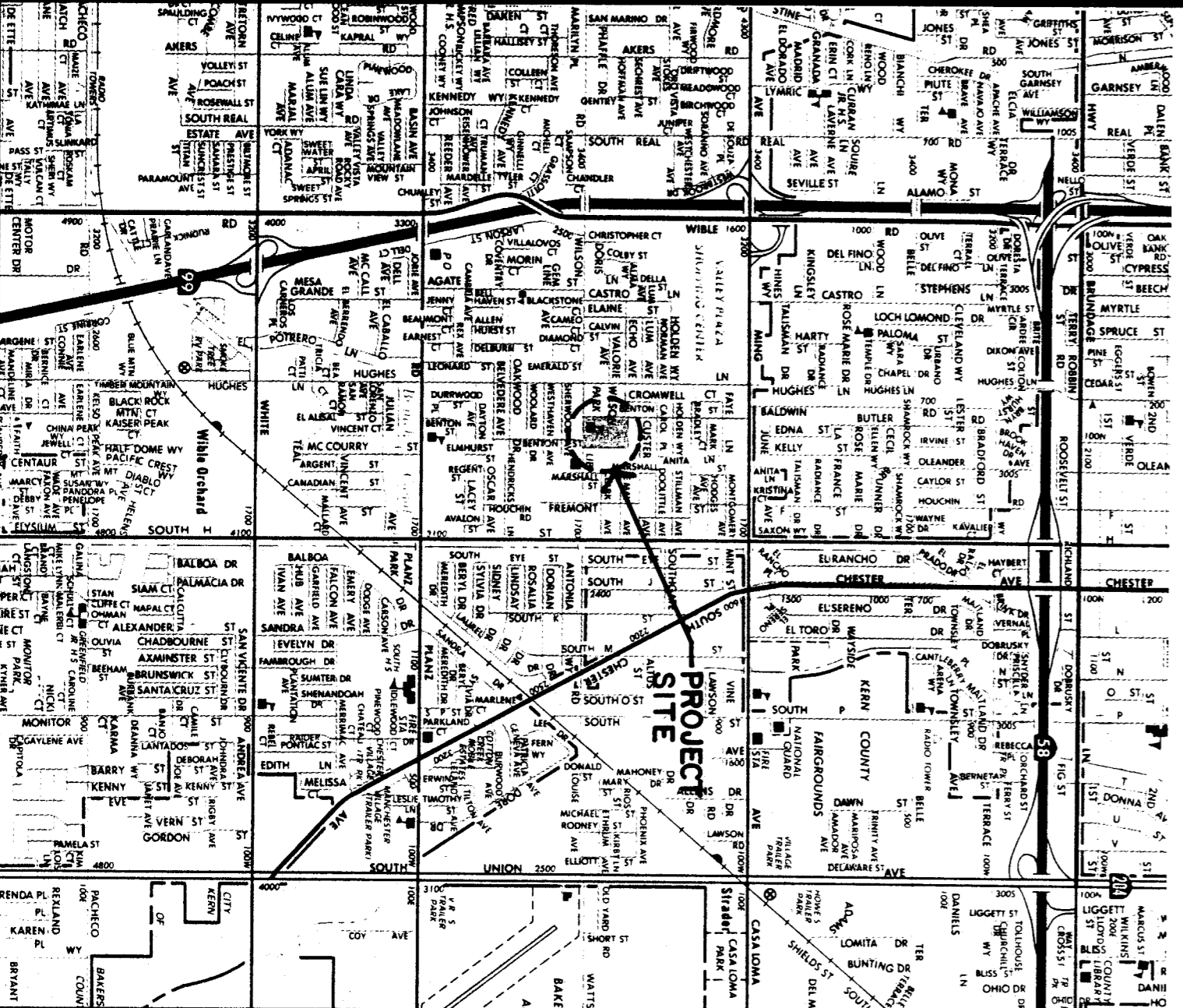

Legend

- ▬ WALLS
- ▬ FILL STUDS AS NOTED
- ⊖ TO BE DEMOLISHED
- ⊖ DOOR NO. DESIGNATION
- ⊖ ROOM NO. DESIGNATION
- ⊖ REMOTE DESIGNATION
- ⊖ DETAIL NO.
- ⊖ SHEET NO.
- ⊖ SECTION NO.
- ⊖ SHEET NO.

OFFICE OF STATE FIRE MARSHAL

APPROVED

Approved by: *[Signature]*
 5/20/72

#10

pechin associates architects aia
 1400 easton drive suite 138
 bakersfield, ca 93309 (805) 322-2021

Frank West Elementary School
 HVAC
 Bakersfield City School District

w/Contractor's As-built notes

| DATE | ISSUE FOR |
|------|-----------|
| | |
| | |
| DATE | REVISION |
| | |
| | |

THESE DRAWINGS, RELATED SPECIFICATIONS, IDEAS, DESIGNS, AND ARRANGEMENTS REPRESENTED THEREBY ARE AND SHALL REMAIN THE PROPERTY OF THE ARCHITECT, AND NO PART THEREOF SHALL BE COPIED, DISCLOSED TO OTHERS OR USED IN CONNECTION WITH ANY WORK OR PROJECT OTHER THAN THE SPECIFIC PROJECT FOR WHICH THEY HAVE BEEN PREPARED AND DEVELOPED WITHOUT THE WRITTEN CONSENT OF THE ARCHITECT. VISUAL CONTACT WITH THESE DRAWINGS OR SPECIFICATIONS SHALL CONSTITUTE CONCLUSIVE EVIDENCE OF ACCEPTANCE OF THESE RESTRICTIONS.

WRITTEN DIMENSIONS ON THESE DRAWINGS SHALL HAVE PRECEDENCE OVER SCALED DIMENSIONS. CONTRACTORS SHALL VERIFY AND BE RESPONSIBLE FOR ALL DIMENSIONS AND CONDITIONS ON THE JOB AND THIS OFFICE MUST BE NOTIFIED OF ANY VARIATIONS FROM THE DIMENSIONS AND CONDITIONS SHOWN BY THESE DRAWINGS.

DETAILED SHOP DRAWINGS MUST BE SUBMITTED TO THIS OFFICE FOR REVIEW BEFORE PROCEEDING WITH THE FABRICATION OF ANY PRODUCT TO BE INCLUDED IN THIS PROJECT.

SHEET **TS**
 Project Number: 449-2399