

FLEWELLING & MOODY
architects & education

HEADQUARTERS OFFICE:
141 South Lake Avenue, Suite 1000
Brea, CA 92610
Tel: 949.453.1100
Fax: 949.453.1101
E-Mail: info@flemoody.com

ANTELOPE VALLEY OFFICE:
1025 West Locust Boulevard
Rockwell, TX 78681-5623
E-Mail: fv-office@flemoody.com

An Oregon-based Corporation

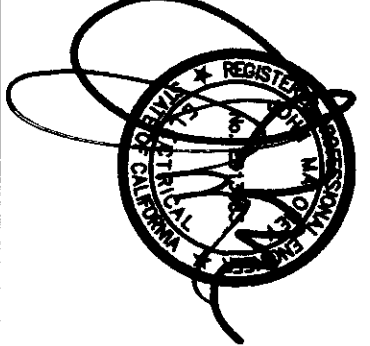
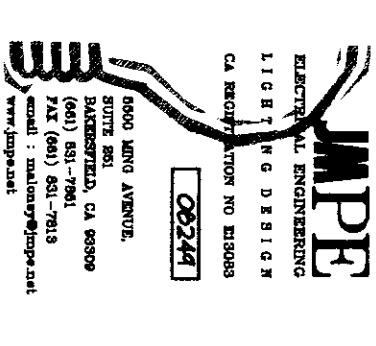
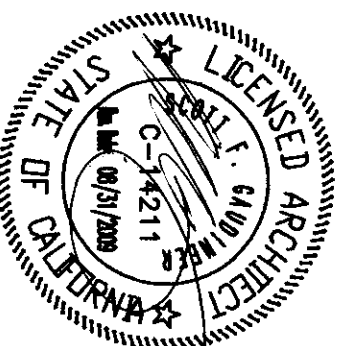

IDENTIFICATION STAMP
DIV. OF THE STATE ARCHITECT
APPROVED 11 2 8 17
ARCHITECT JAMES R. MOORE
DATE 11 2 8 2010

Drawn by	AC	
Checked by	PH	
Revisions		
No.	Date	Description

MODERNIZATION PROJECT AT
EVERGREEN ELEMENTARY SCHOOL
2600 ROSE LAURE DRIVE
BARKERSFIELD, CA 93304

BARKERSFIELD CITY SCHOOL DISTRICT

BUILDING F LIGHTING
DEMOLITION PLAN
BUILDING F LIGHTING
PLAN

Job No. 894300
Date 1-14-2009
E-8.1

- LIGHTING DEMOLITION PLAN NOTES
- 1 REMOVE AND REPAIR OR EXISTING LIGHT FIXTURES-COMPLIANT. DISMOUNT EXISTING CONDUIT BACK TO SERVING PANEL.
 - 2 REMOVE AND REPAIR OR ALL SWITCHES IN BUILDING.

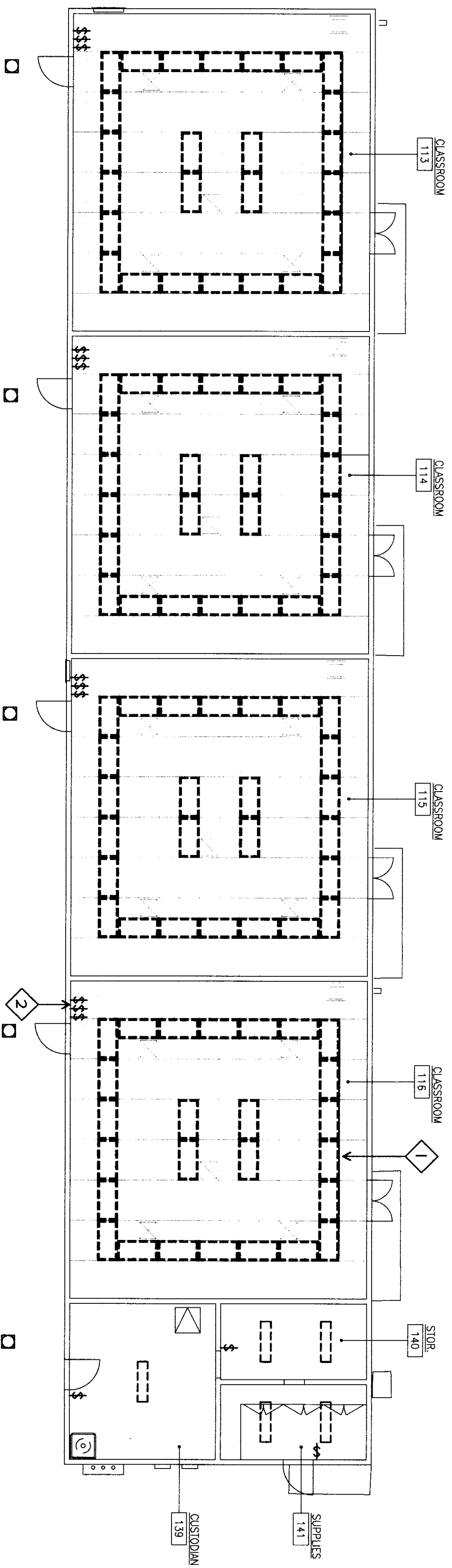

BUILDING F LIGHTING DEMOLITION PLAN

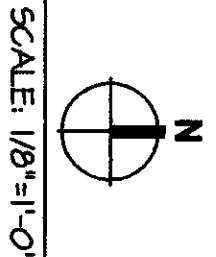

SCALE: 1/8" = 1'-0"

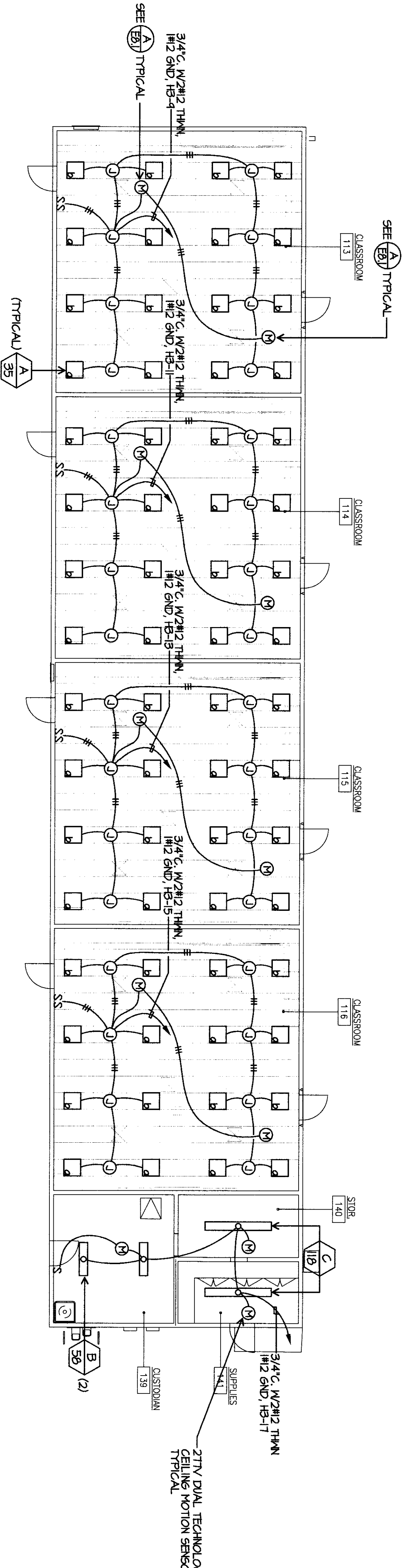

BUILDING F LIGHTING PLAN

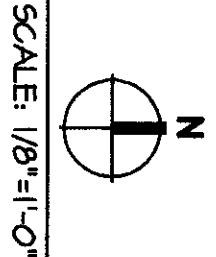

SCALE: 1/8" = 1'-0"

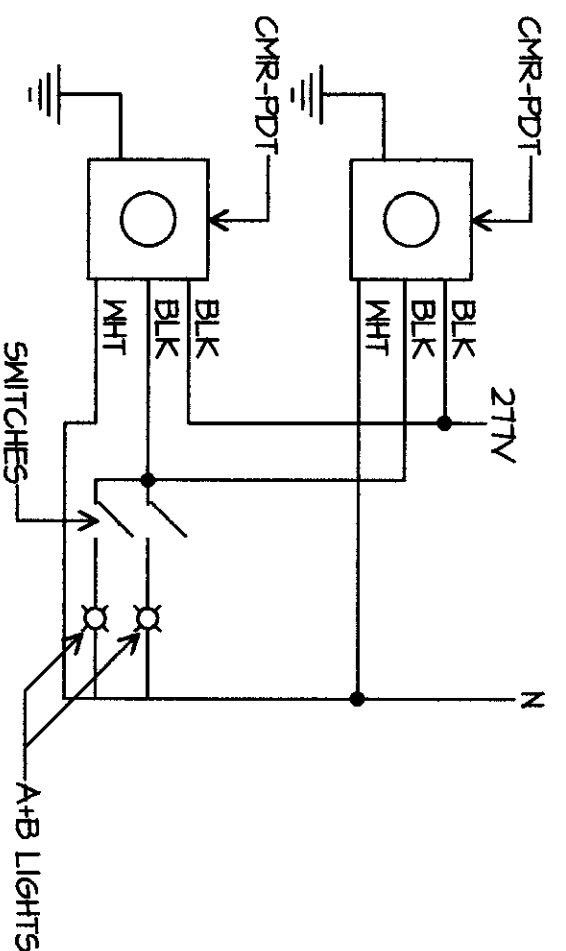

CLASSROOM MOTION SENSOR WIRING DIAGRAM

(A)