

FLEWELLING & MOODY
architects + education

HEADQUARTERS OFFICE:
1400 W. 14th Street
P.O. Box 1110
Redlands, California 91278
Tel: 626.281.1111 FAX: 626.464.4177
E-Mail: info@flemingmoody.com
www.flemingmoody.com

ANTELOPE VALLEY OFFICE:
4000 West 17th Street
Lubbock, California 95324
Tel: 916.837.7111 FAX: 916.837.2324
E-Mail: info@flemingmoody.com
www.flemingmoody.com

All Employees: Equal Opportunity

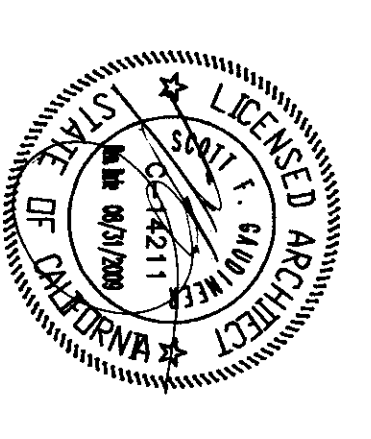

CONSULTANT

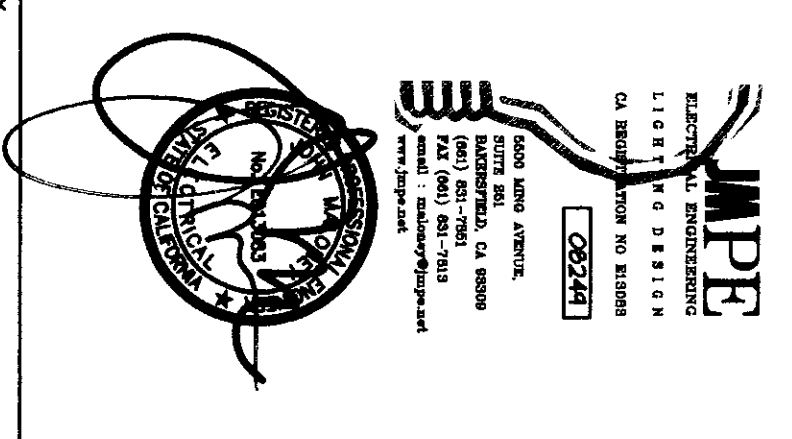

AGENCY

IDENTIFICATION STAMP
DIV. OF THE STATE ARCHITECT
APPROVED 11 2 8 17
JAMES P. MOORE
DATE: APR 18 2009

Drawn by	AC
Checked by	PH
Approved	
No.	Date
Description	

NOTES:
1. THE CLIENT HAS REVIEWED THIS PLAN AND HAS APPROVED IT FOR THE PROJECT.
2. THE CLIENT HAS REVIEWED THIS PLAN AND HAS APPROVED IT FOR THE PROJECT.
3. THE CLIENT HAS REVIEWED THIS PLAN AND HAS APPROVED IT FOR THE PROJECT.
4. THE CLIENT HAS REVIEWED THIS PLAN AND HAS APPROVED IT FOR THE PROJECT.

MODERNIZATION PROJECT AT
EVERGREEN ELEMENTARY SCHOOL
2600 ROSE MADE DRIVE
BAKERSFIELD, CA 93304

BAKERSFIELD CITY SCHOOL DISTRICT

BUILDING F ELECTRICAL
DEMOLITION PLAN
BUILDING F ELECTRICAL
PLAN

Job No.
1884400

Total
E.8.0

1-14-2009

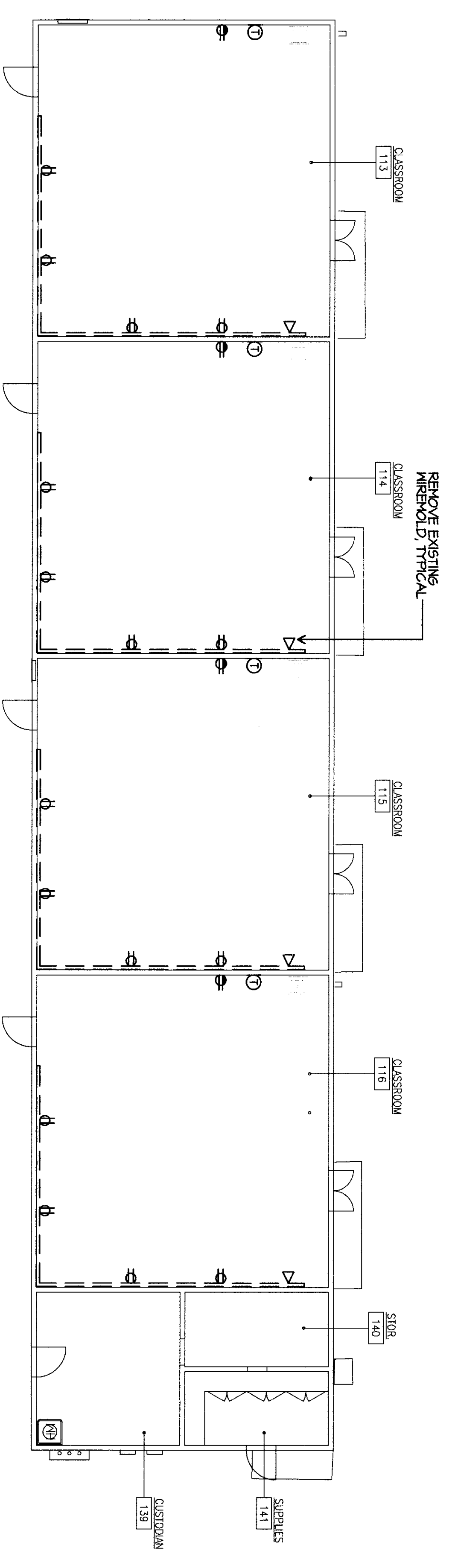

BUILDING F ELECTRICAL DEMOLITION PLAN 1 of 2

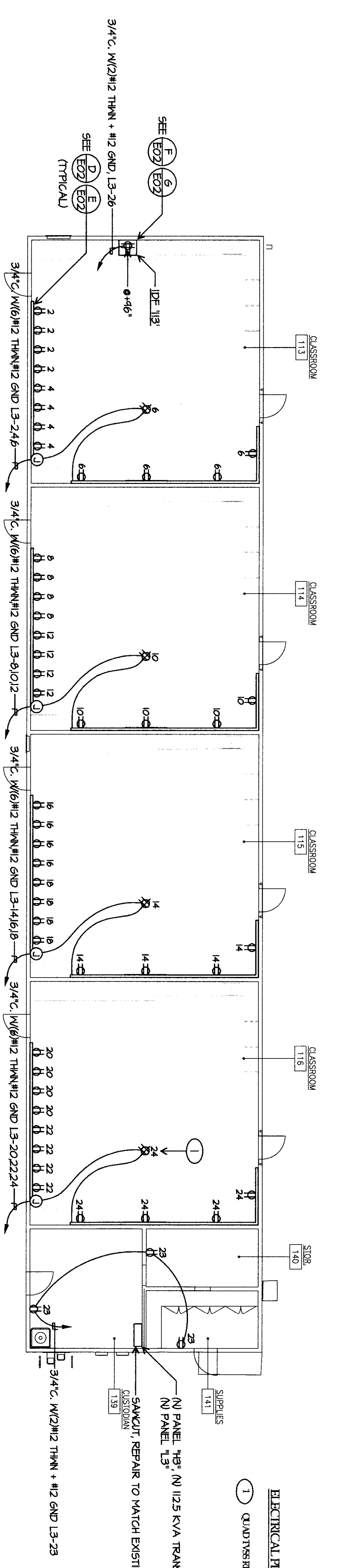
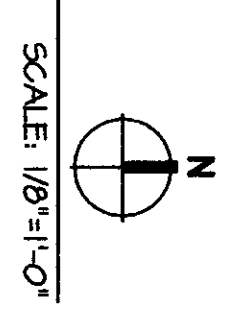

BUILDING F ELECTRICAL PLAN

