

FLEWELLING & MOODY
architects for education

HEADQUARTERS OFFICE:
14 South Lake Avenue, Suite 100
Costa Mesa, California 92626
TEL: 949.441.1111 FAX: 949.441.4477
E-MAIL: fw@flewellingmoody.com

ANTelope VALLEY OFFICE:
17000 Antelope Valley Blvd.
Lodi, California 95240
TEL: 508.927.7111 FAX: 951.942.2343
E-MAIL: fw@flewellingmoody.com
An Employee Owned Corporation

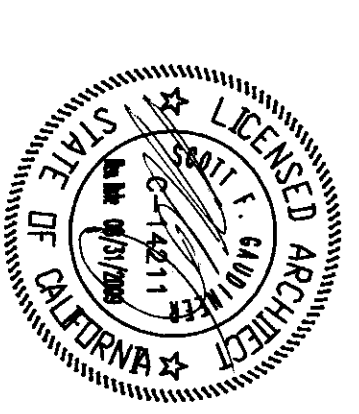

CONSULTANT

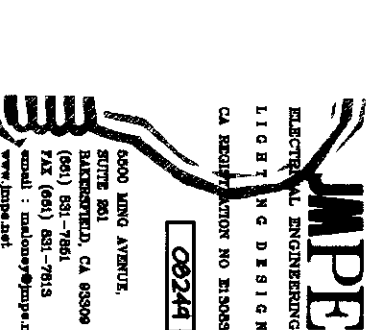

AGENCY

REGISTRATION STAMP
DW OF THE STATE ARCHITECT
APPROX 11.28.17
AC 1152288-13
DATE 11-28-2010

Drawn by	AC
Checked by	FH
Reviewed by	
No.	000
Date	
Description	

MODERNIZATION PROJECT AT
EVERGREEN ELEMENTARY SCHOOL
2600 ROSE WARE DRIVE
BAKERSFIELD, CA 93304

BAKERSFIELD CITY SCHOOL DISTRICT

BUILDING E ELECTRICAL
DEMOLITION PLAN
BUILDING E ELECTRICAL
PLAN

Job No.
1884200

E-7.0

Date
1-14-2009

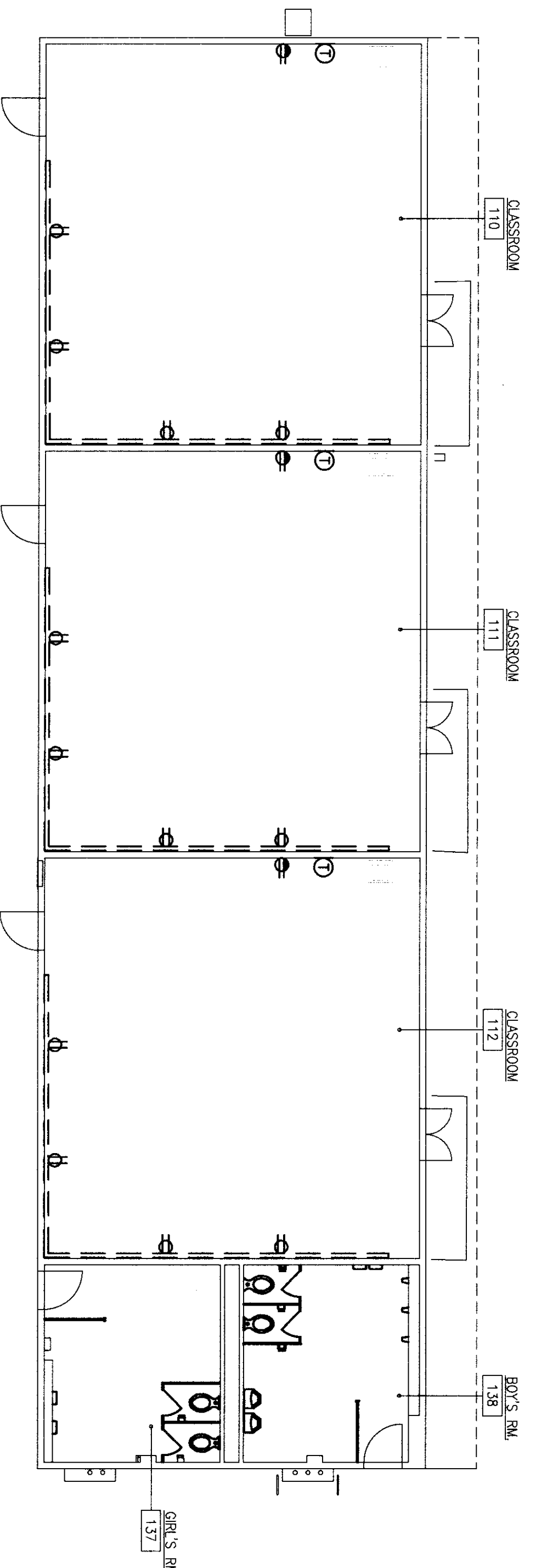

BUILDING E ELECTRICAL DEMOLITION PLAN 1

SCALE: 1/8"=1'-0"

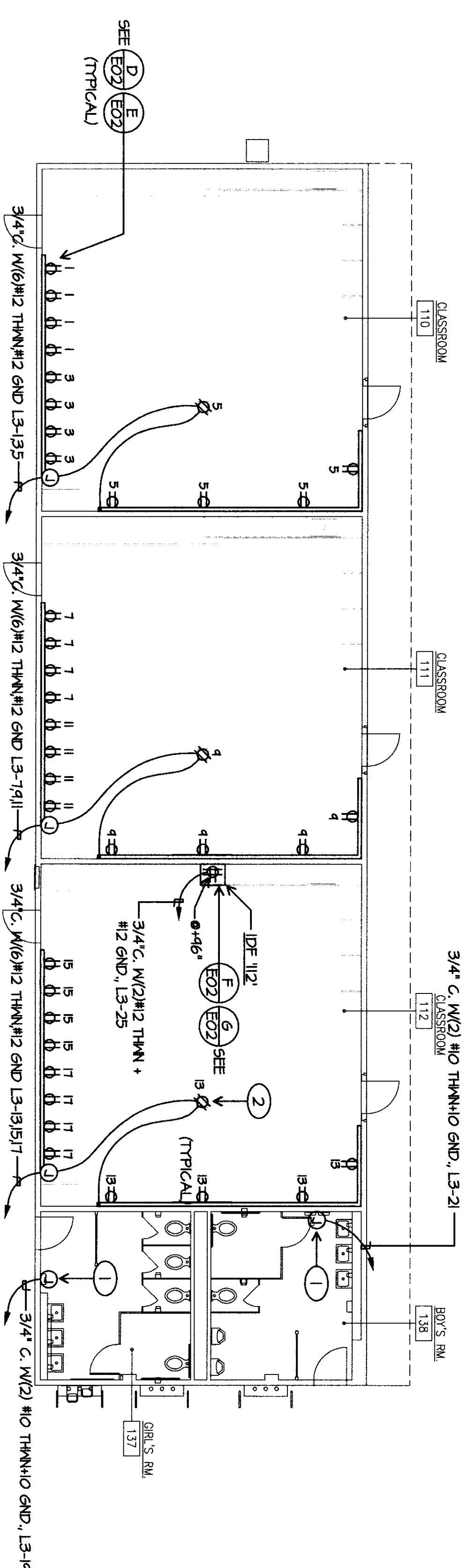

BUILDING E ELECTRICAL PLAN

SCALE: 1/8"=1'-0"

ELECTRICAL HANDICHS

- 1 HANDICHS SHALL BE WORKED WITH A WIRE CUTTING TOOL TO REMOVE THE WIRE FROM THE PANEL.
- 2 QUOTE: REPAIRS, WORK SHALL BE IN ACCORDANCE WITH THE NATIONAL ELECTRICAL CODE (NEC).

- 1 CONTRACTOR SHALL REMOVE DEVICES, BOXES, FITTINGS, CONDUIT, SURFACE RACEWAYS AND CONDUCTORS ETC. BACK TO PANEL SERVING THEM. PROVIDE BLANKS FOR ALL UNUSED OPENINGS. COORDINATE SAVAGE REQUIREMENTS WITH ROBERT VAN PASEL, SUPERVISOR SCHOOL PLANNING AND CONSTRUCTION, BAKERSFIELD CITY SCHOOL DISTRICT, 661-481-3883.
- 2 WHERE REMOVED DEVICES, ETC. SHAVE DOWNSTREAM OWNERS TO REMAIN, RECONNECT THESE.