

FLEWELLING & MOODY
architects education

HEADQUARTERS OFFICE:
417 South Lake Avenue, 2nd floor
Pasadena, California 91107
Phone: 626.799.1177
Fax: 626.799.1178
E-Mail: info@flemwellingmoody.com

ANNELOPE VALLEY OFFICE:
1155 West Lusk Street
Livermore, California 94551
Phone: 925.439.8313
Fax: 925.439.8314
E-Mail: info@flemwellingmoody.com

An Ongoing Ongoing Organization

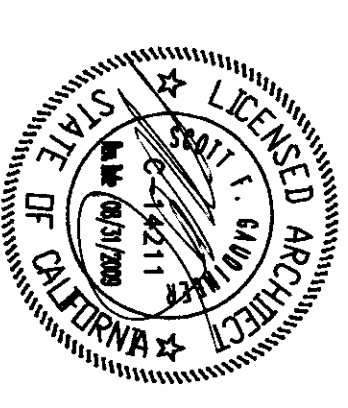

CONSULTANT

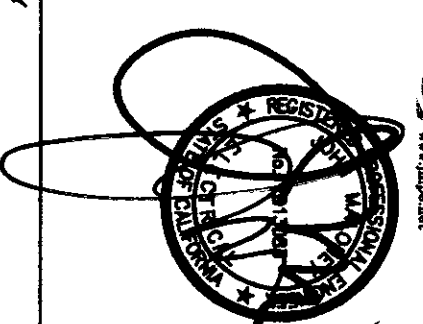
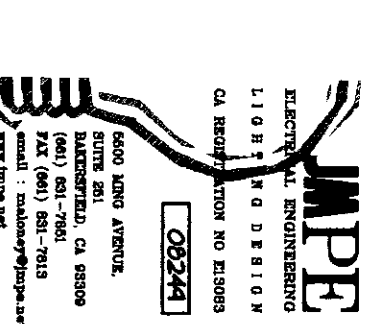

IDENTIFICATION STAMP
DIV. OF THE STATE ARCHITECT
APPROVED 11/28/17
A.C.M. FLS/PH/SS/Rz
DATE: MAR 18 2018

Drawn by: AC
Checked by: PH
Reviewed by:
No. / Date / Description

MODERNIZATION PROJECT AT
EMERSON ELEMENTARY SCHOOL
2002 HENRIE LAURE DRIVE
BAKERSFIELD, CA 93315

BAKERSFIELD CITY SCHOOL DISTRICT

BUILDING D ELECTRICAL
DEMOLITION PLAN
BUILDING D ELECTRICAL
PLAN

Job No. 1894200
Date: 1-14-2009
E-6.0

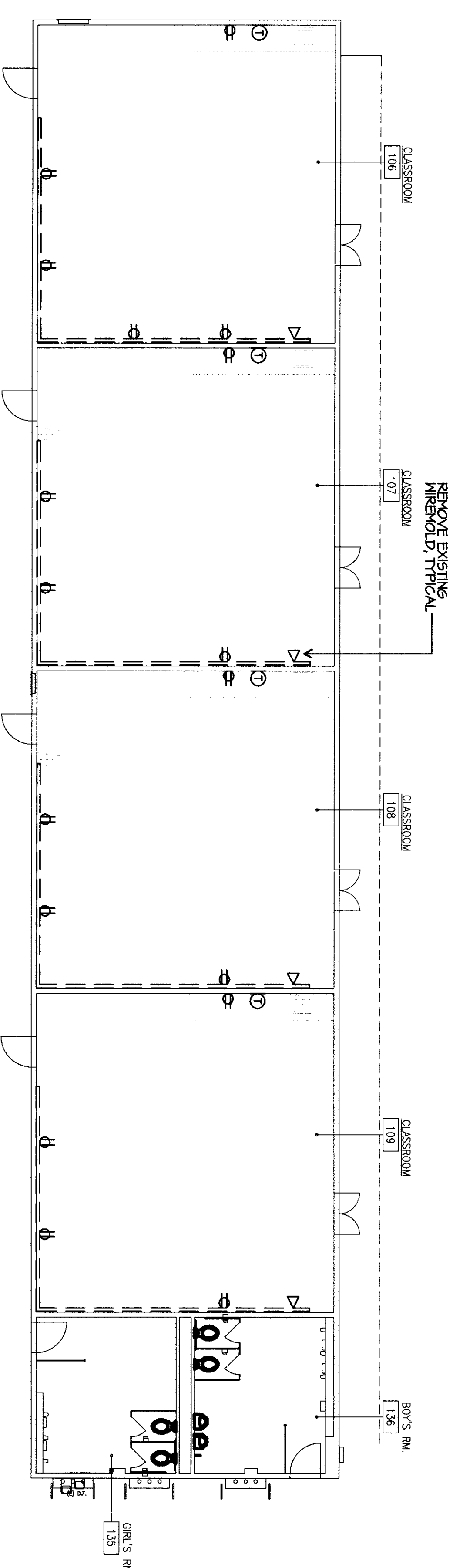

BUILDING D ELECTRICAL DEMOLITION PLAN

SCALE: 1/8"=1'-0"

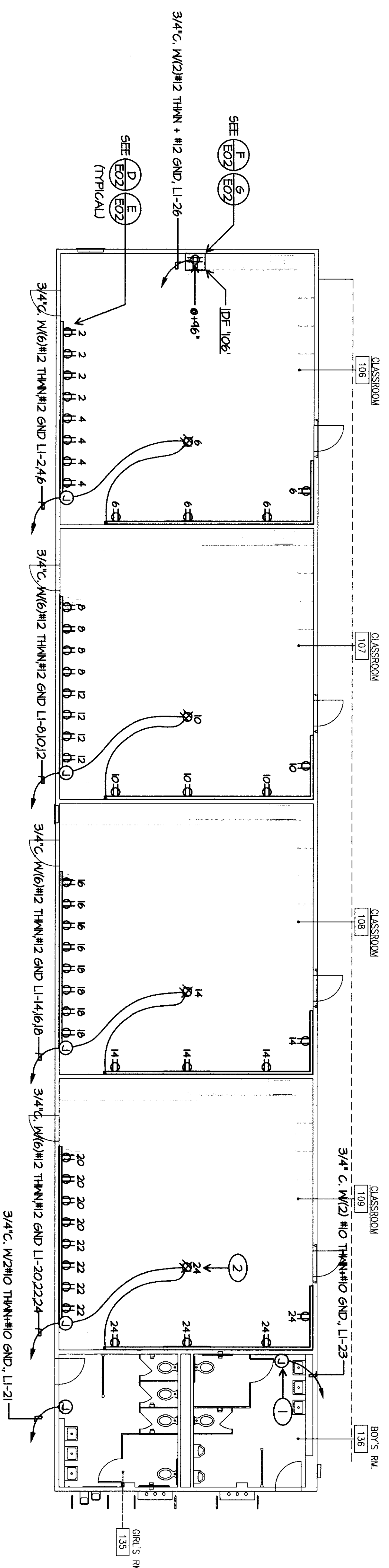

BUILDING D ELECTRICAL PLAN

SCALE: 1/8"=1'-0"

- ELECTRICAL PLAN NOTES
- 1 HAND REMOVAL REQUIRED WORK, WORK WITH WEDGED NEZZLE
 - 2 QUANTITIES REPORTED AS APPROXIMATE FOR ESTIMATE PURPOSES ONLY.

- ELECTRICAL DEMOLITION PLAN NOTES
- CONTRACTOR SHALL REMOVE DEVICES, BOXES, FITTINGS, CONDUIT, SURFACE RACEWAY AND CONDUCTORS ETC. BACK TO PANEL SERVING THEM. PROVIDE BARS FOR ALL UNBRED ROBERT VAN TASSEL, SUPERVISOR SCHOOL PLANNING AND CONSTRUCTION BAKERSFIELD CITY SCHOOL DISTRICT 601-431-5885.
 - WHERE REMOVED DEVICES, ETC. SERVE DOWNSTREAM ONES TO REMAIN, RECONNECT THESE.