

HEADQUARTERS OFFICE:
11 South Loop West, 2nd Floor
Bakersfield, CA 93304
TEL: 805.338.4177
FAX: 805.338.4177
EMAIL: flewelling@flewellingmoody.com

ANTELOPE VALLEY OFFICE:
1025 West Lincoln Boulevard
Bakersfield, CA 93311
TEL: 805.338.4177 FAX: 805.338.4177
EMAIL: bmoody@flewellingmoody.com

An Employee Owned Corporation

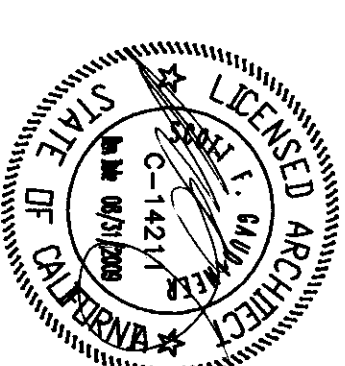

CONSULTANT

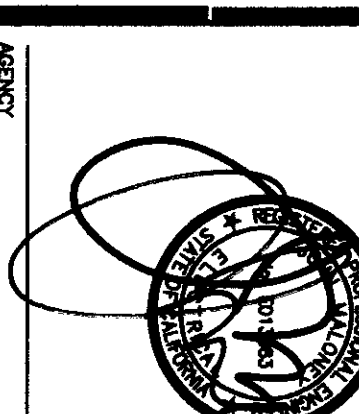
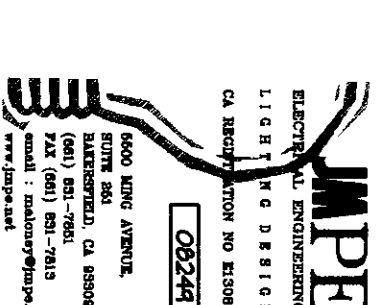

AGENCY

INVESTIGATION STAMP
DIV OF THE STATE ARCHITECT
APPROX. 11 28 17
JAMES R. MOORE
LICENSE NO. 51824
DATE: 11/28/2010

Drawn by	AC	
Checked by	PH	
Revision		
No.	Date	Description

As a condition of use, the user of this stamp is required to pay the applicable fee to the State Architect. The fee is \$100 per stamp. The fee is non-refundable. The fee is due at the time of stamping. The fee is due at the time of stamping. The fee is due at the time of stamping.

**MOOREHEAD PROJECT AT
EMERSON ELEMENTARY SCHOOL**
3600 GREEK WAYE DRIVE
BAKERSFIELD, CA 93304

BAKERSFIELD CITY SCHOOL DISTRICT

**BUILDING A COMMUNICATION
DEMOLITION PLAN
BUILDING A COMMUNICATION
PLAN**

Job No.
1894200
Date
1-14-2009
E-32

- COMMUNICATION DEMOLITION PLAN NOTES**
- 1 REFER TO SPEC HANDBOOK FOR CONVENTION, TYPICAL.
 - 2 REMOVE WIRING TO COMPLETE TYPICAL. REMOVE TV, DATA, AND TELEPHONE. REMOVE ALL CABLE COMPLETE TYPICAL.
 - 3 REMOVE SPEAKERS AND ALL SPEAKER CABLE COMPLETE TYPICAL.

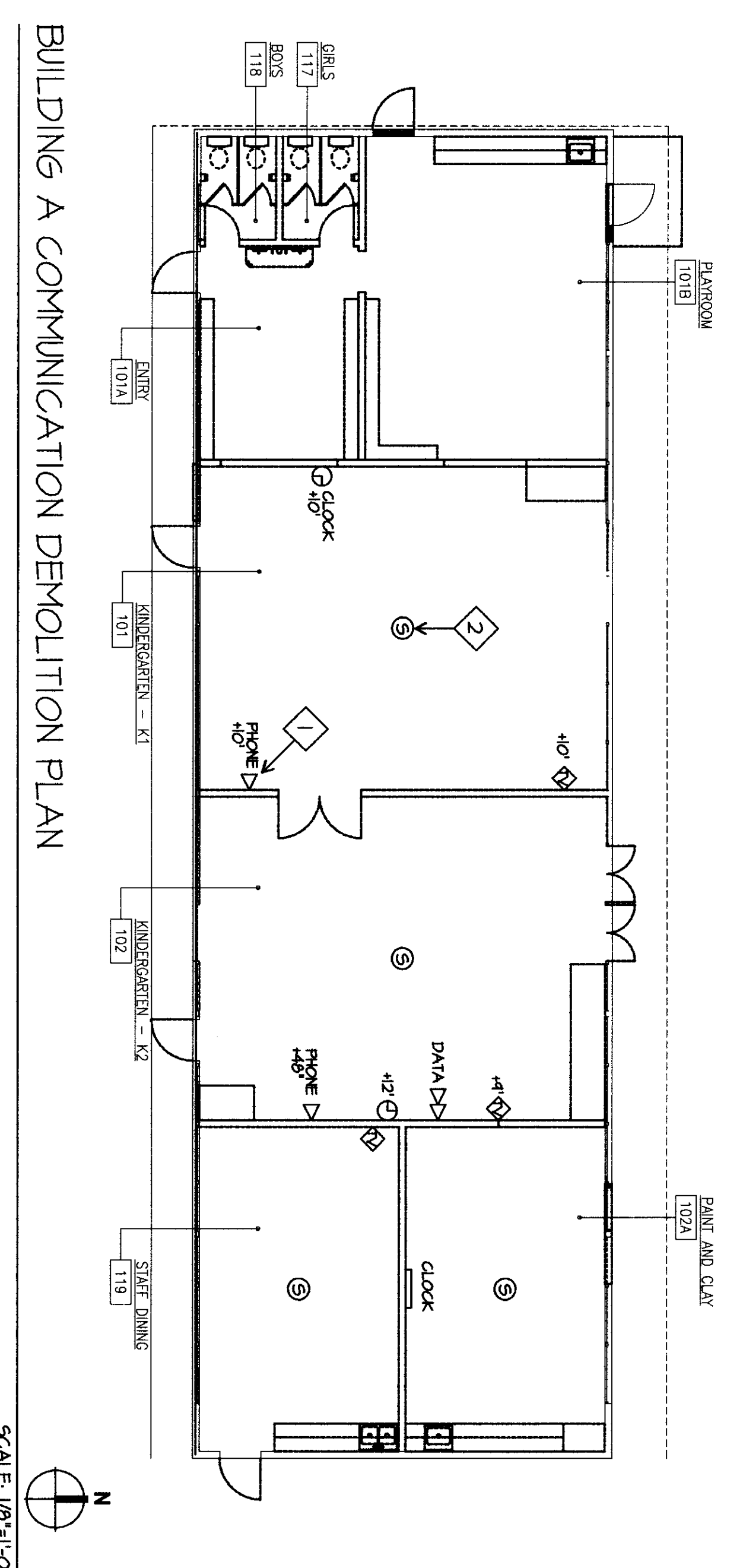

BUILDING A COMMUNICATION DEMOLITION PLAN
SCALE: 1/8"=1'-0"

- COMMUNICATION PLAN NOTES**
- 1 CONTRACTOR SHALL PROVIDE NEW PER ENCLASURE. INSTALL AND CONNECT NEW MIDDLE AT LANDING DIMENSION WITH A PLATE CLASSED TO MEET SPECIFICATIONS FOR 1/2" AND 1/4" THICKNESS DIMENSIONS.
 - 2 SUPPORT THE WIRING AND/OR DATA AND/OR SPEAKER CABLES IN THE CABINETS AND THEIR SPINDLES SHALL BE INDEPENDENT FROM THE ALUMINUM CABLE SUPPORT TYPICAL.
 - 3 PROVIDE AT LEAST 25' W/25W OR EQUAL CEILING MOUNTED SPEAKER. PROVIDE A BENCH TOP CABLE TRAY FOR TERMINATION OF CABLE AT EACH SPEAKER LOCATION. PROVIDE 5' SPAN FOR EACH CABLE TRAY AND 1/2" THICKNESS. PROVIDE ONE FROM EACH CORNER.
 - 4 PROVIDE CORREL COUPLERS TO MATCH NUMBER OF CABLES (SPEAKERS) TERMINATING WITH RJ45 JACK AT EACH OUTLET. PROVIDE INDICATED CAT5 CABLE LENGTH IN THE ENCLASURE.
 - 5 USE CAT5 UTP UNBUNDLED BEND. THIS COMPONENT SHALL BE INSTALLED WITH SHIELDING AND DRIVERS FOR A COMPLETE STRIP. TYPICAL FITTINGS AND DRIVERS FOR A COMPLETE STRIP. TYPICAL PLANNING AND CONSTRUCTION MARKS SHALL BE IN ACCORDANCE WITH THE 2009 IBC. MARKS SHALL BE IN ACCORDANCE WITH THE 2009 IBC. MARKS SHALL BE IN ACCORDANCE WITH THE 2009 IBC.
 - 6 REMOVE ALL CAT5 CABLES BACK TO CLOSET AND TERMINATE ON WALL PANEL. TYPICAL.
 - 7 PROVIDE BLINDING TONGUE FITTERS WITH GROUND SHIELD COMPRESSION TERMINATION. TYPICAL. CABLE CONNECTIONS TO SHIELD FROM THE TERMINATION SHALL BE IN ACCORDANCE WITH THE 2009 IBC. MARKS SHALL BE IN ACCORDANCE WITH THE 2009 IBC. MARKS SHALL BE IN ACCORDANCE WITH THE 2009 IBC.
 - 8 PROVIDE BLINDING TONGUE FITTERS WITH GROUND SHIELD COMPRESSION TERMINATION. TYPICAL. CABLE CONNECTIONS TO SHIELD FROM THE TERMINATION SHALL BE IN ACCORDANCE WITH THE 2009 IBC. MARKS SHALL BE IN ACCORDANCE WITH THE 2009 IBC. MARKS SHALL BE IN ACCORDANCE WITH THE 2009 IBC.

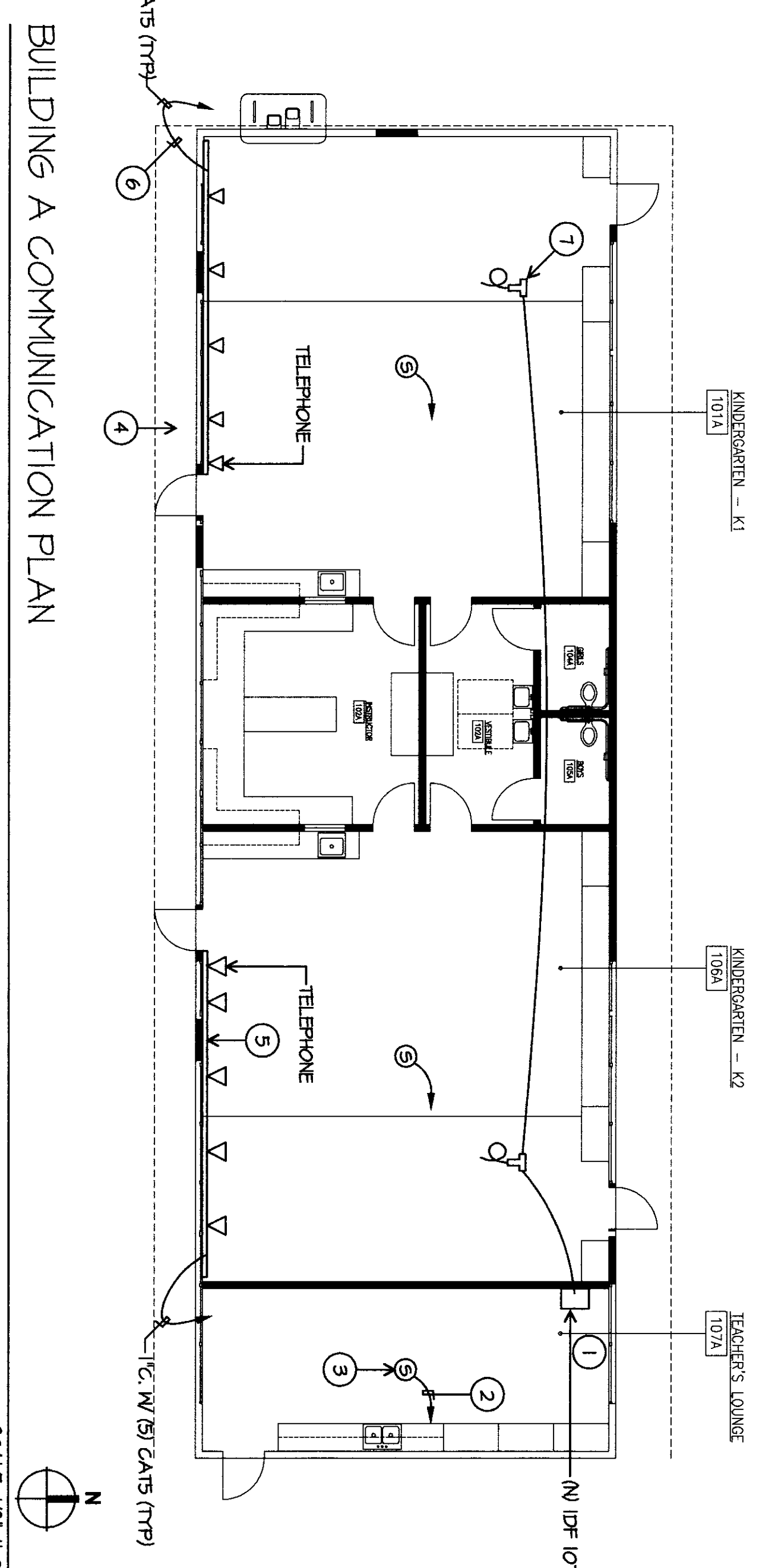

BUILDING A COMMUNICATION PLAN
SCALE: 1/8"=1'-0"