

FLEWELLING & GODOY  
architects for education

HEADQUARTERS OFFICE:  
1400 Franklin Street  
San Francisco, California 94115  
TEL: 415.774.1100 FAX: 415.774.1101  
E-MAIL: [info@flego.com](mailto:info@flego.com)  
[www.flego.com](http://www.flego.com)

ANTELOPE VALLEY OFFICE:  
10000 Westchase Drive  
Dallas, Texas 75243  
TEL: 972.771.1111 FAX: 972.771.1112  
E-MAIL: [info@antelopevalley.com](mailto:info@antelopevalley.com)  
[www.antelopevalley.com](http://www.antelopevalley.com)

An Employee Owned Corporation

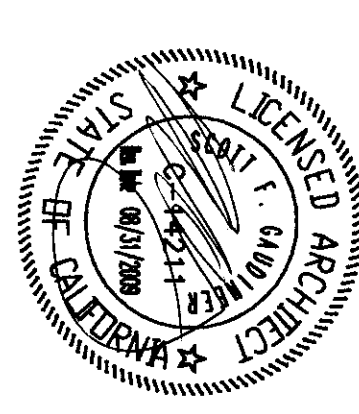

ARCHITECT

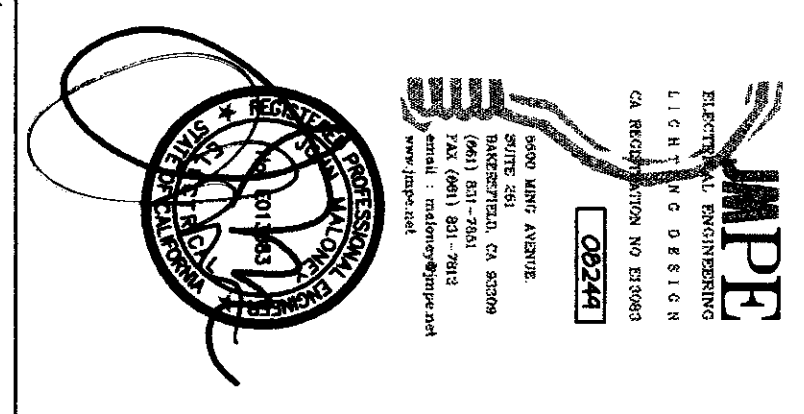

AGENCY  
EDUCATION STAFF  
DIV OF THE STATE ARCHITECT  
APPROX 11.2.17  
DATE: 11.2.17

Drawn by	Checked by	Revised	Date	Description
AC	PH			

AGENCY: BAKERSFIELD CITY SCHOOL DISTRICT  
PROJECT: MODERNIZATION PROJECT AT EVERGREEN ELEMENTARY SCHOOL  
ADDRESS: 2950 ROSE WARE DRIVE, BAKERSFIELD, CA 93304

PROJECT: PARTIAL FIRE ALARM SITE PLAN

Job No. 1894500  
Date 1-14-2009  
Sheet E-2

- PARTIAL FIRE ALARM SITE PLAN NOTES
- 1 INITIAL CONCRETE ABOVE SHALL BE AT THE SPACE BETWEEN BUILDINGS.
  - 2 INITIAL CONCRETE BETWEEN, CORNER CONCRETE, WITHIN AREA AROUND CONDUIT PENETRATIONS TO BATHROOMS.
  - 3 REMOVE EXISTING SERVICES COMPLETE TYPICAL. REMOVE ALL CABLE REQUIRED BY IBC 72.
  - 4 WHEN FEASIBLE CLASSROOMS ARE REMOVED, REMOVE EXTERIOR AND INTERIOR SERVICES, PLUMBING AND CONNECTION BAKERSFIELD CITY SCHOOL DISTRICT 90-01-03M.

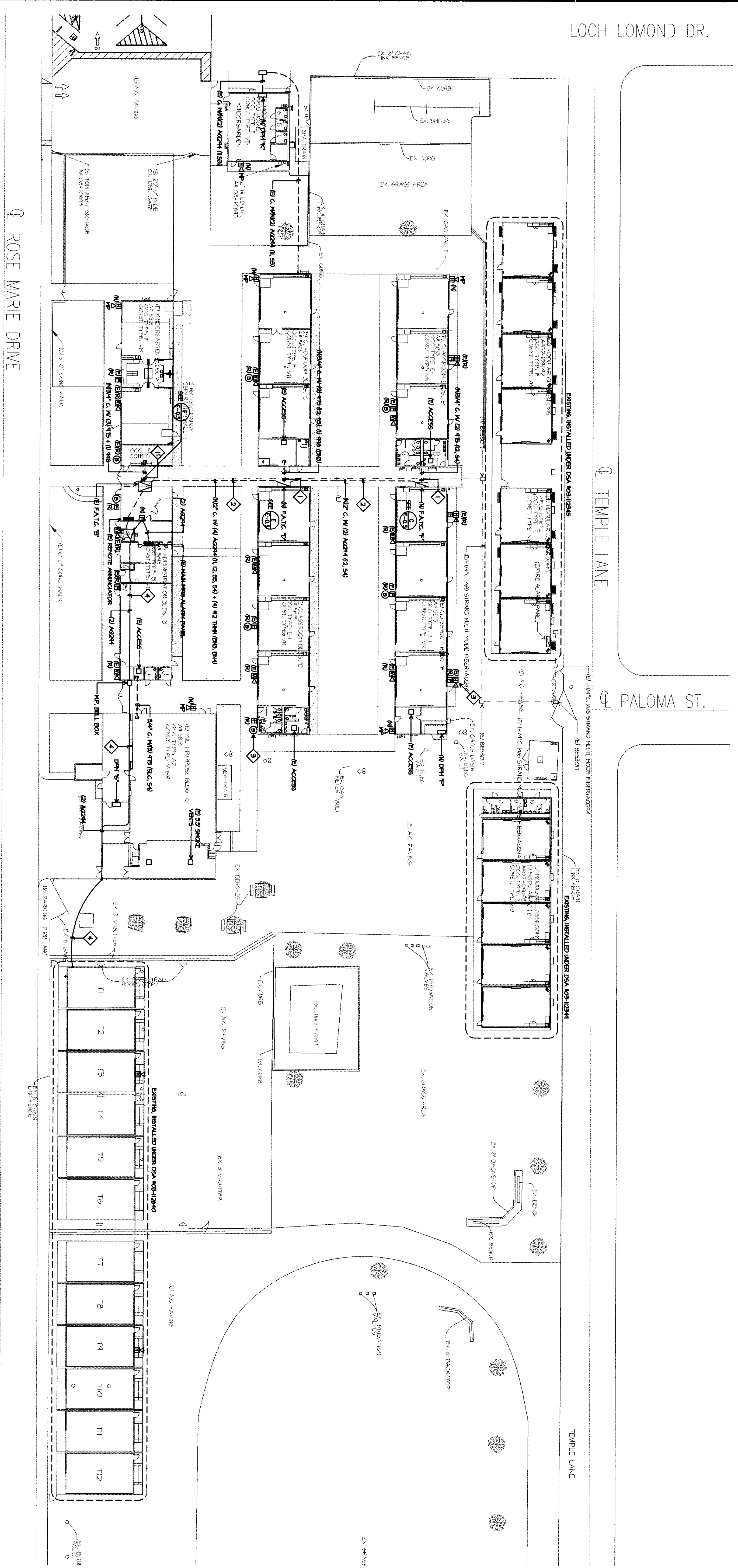

# PARTIAL FIRE ALARM SITE PLAN

