

- 1 REMOVE FREEDER CONDUCTORS BETWEEN EXISTING DISTRIBUTION PANEL "M5" AND PANEL COMPLETE. REFER TO PANEL SCHEDULES FOR CHANGES TO PANELS "M4" AND "M5".
- 2 REMOVE FREEDER CONDUCTORS BETWEEN EXISTING MAIN SWITCHBOARD "M6" AND PANEL COMPLETE. COORDINATE WITH ROBERT VAN TASSEL. REFER TO PANEL SCHEDULES FOR CHANGES TO PANELS "M4" AND "M5".
- 3 REMOVE TRANSFORMER COORDINATE SALVAGE WITH ROBERT VAN TASSEL.
- 4 REMOVE CONDUCTORS BETWEEN TRANSFORMER AND DISTRIBUTION PANEL "M5" COMPLETE.
- 5 LABEL CIRCUIT BREAKERS AS SPARE.
- 6 CLEAN CONDUITS, INSTALL FULL ROPE, LABEL CONDUITS AS SPARE.
- 7 REMOVE EXISTING DISTRIBUTION PANEL "M5" COMPLETE. REFER TO PANEL SCHEDULES FOR CHANGES TO PANELS "M4" AND "M5".
- 8 REMOVE FREEDER CONDUCTORS BETWEEN PORTABLE PANELS AND PANEL "L1".
- 9 REMOVE FREEDER CONDUCTORS BETWEEN MAIN SWITCHBOARD "M6" AND TRANSFORMER COMPLETE.
- 10 REMOVE TRANSFORMER COORDINATE SALVAGE WITH ROBERT VAN TASSEL.
- 11 REMOVE CONDUCTORS BETWEEN TRANSFORMER AND DISTRIBUTION PANEL "M5" COMPLETE.
- 12 REMOVE TRANSFORMER COORDINATE SALVAGE WITH ROBERT VAN TASSEL.

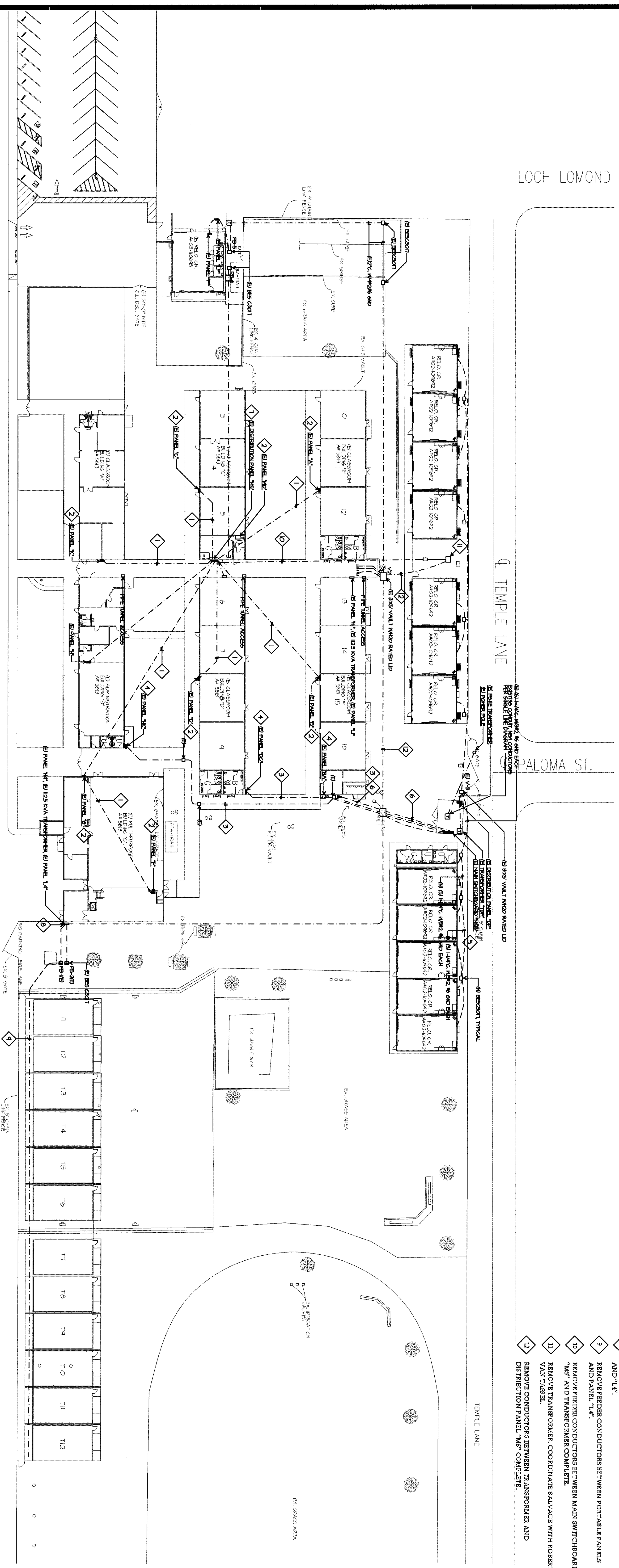

# ELECTRICAL DEMOLITION SITE PLAN

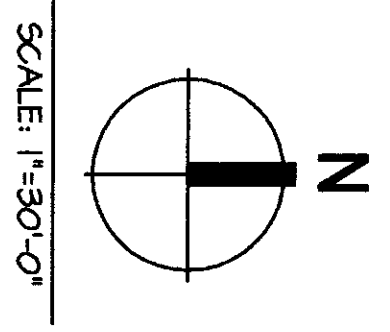

**FLEWELLING MOODY**  
architects for education

HEADQUARTERS OFFICE:  
141 Madison, Corona 92626  
951-444-8777 FAX 951-444-8777  
Email: flewellingmoody@earthlink.net

ANTILOPE VALLEY OFFICE:  
10000 Central Expressway  
861-842771 FAX 861-842-8361  
Email: flewellingmoody@earthlink.net  
An Employee Owned Corporation

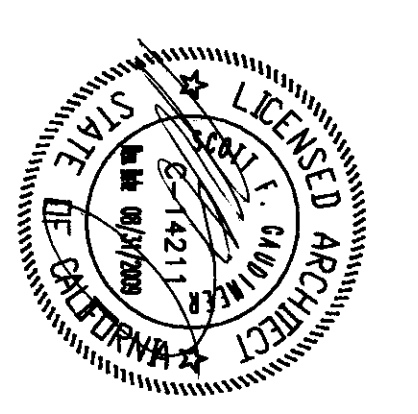

**MPE**  
MECHANICAL  
PLUMBING  
ELECTRICAL  
CONTRACTORS

13821  
13822  
13823  
13824  
13825  
13826  
13827  
13828  
13829  
13830  
13831  
13832  
13833  
13834  
13835  
13836  
13837  
13838  
13839  
13840  
13841  
13842  
13843  
13844  
13845  
13846  
13847  
13848  
13849  
13850  
13851  
13852  
13853  
13854  
13855  
13856  
13857  
13858  
13859  
13860  
13861  
13862  
13863  
13864  
13865  
13866  
13867  
13868  
13869  
13870  
13871  
13872  
13873  
13874  
13875  
13876  
13877  
13878  
13879  
13880  
13881  
13882  
13883  
13884  
13885  
13886  
13887  
13888  
13889  
13890  
13891  
13892  
13893  
13894  
13895  
13896  
13897  
13898  
13899  
13900

IDENTIFICATION STAMP  
DIV OF THE STATE ARCHITECT  
APR 11 9 8 17  
MPE  
13821  
13822  
13823  
13824  
13825  
13826  
13827  
13828  
13829  
13830  
13831  
13832  
13833  
13834  
13835  
13836  
13837  
13838  
13839  
13840  
13841  
13842  
13843  
13844  
13845  
13846  
13847  
13848  
13849  
13850  
13851  
13852  
13853  
13854  
13855  
13856  
13857  
13858  
13859  
13860  
13861  
13862  
13863  
13864  
13865  
13866  
13867  
13868  
13869  
13870  
13871  
13872  
13873  
13874  
13875  
13876  
13877  
13878  
13879  
13880  
13881  
13882  
13883  
13884  
13885  
13886  
13887  
13888  
13889  
13890  
13891  
13892  
13893  
13894  
13895  
13896  
13897  
13898  
13899  
13900

BAKERFIELD CITY SCHOOL DISTRICT  
MODERNIZATION PROJECT AT  
EVERGREEN ELEMENTARY SCHOOL  
2600 ROSE MARIE DRIVE  
BAKERFIELD, CA 93304

ELECTRICAL  
DEMOLITION  
SITE PLAN

Job No.  
1894300  
Date  
1-14-2009  
E-10