

TYPICAL CLASSROOM REFLECTED CEILING PLAN

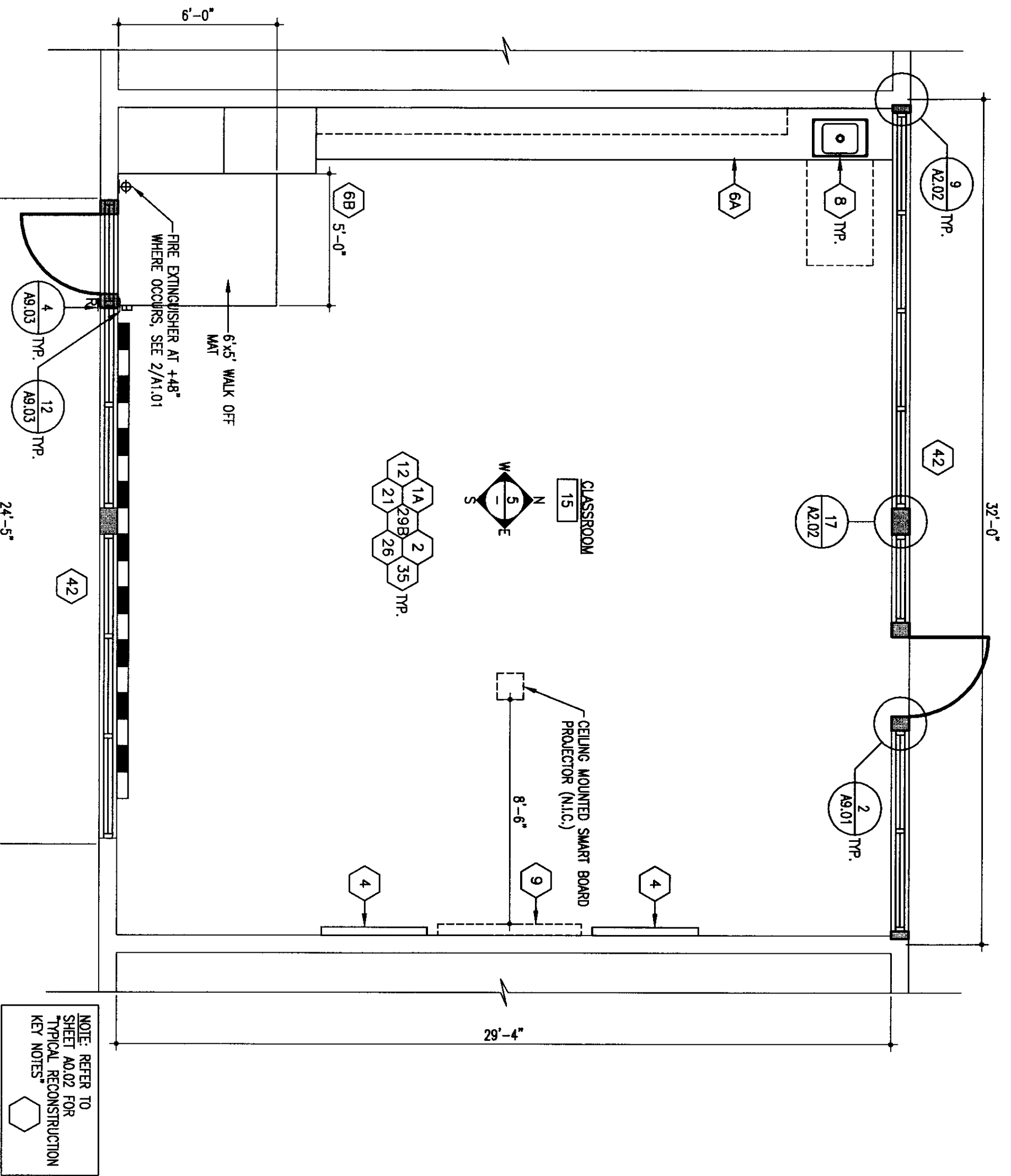

TYPICAL CLASSROOM RECONSTRUCTION PLAN

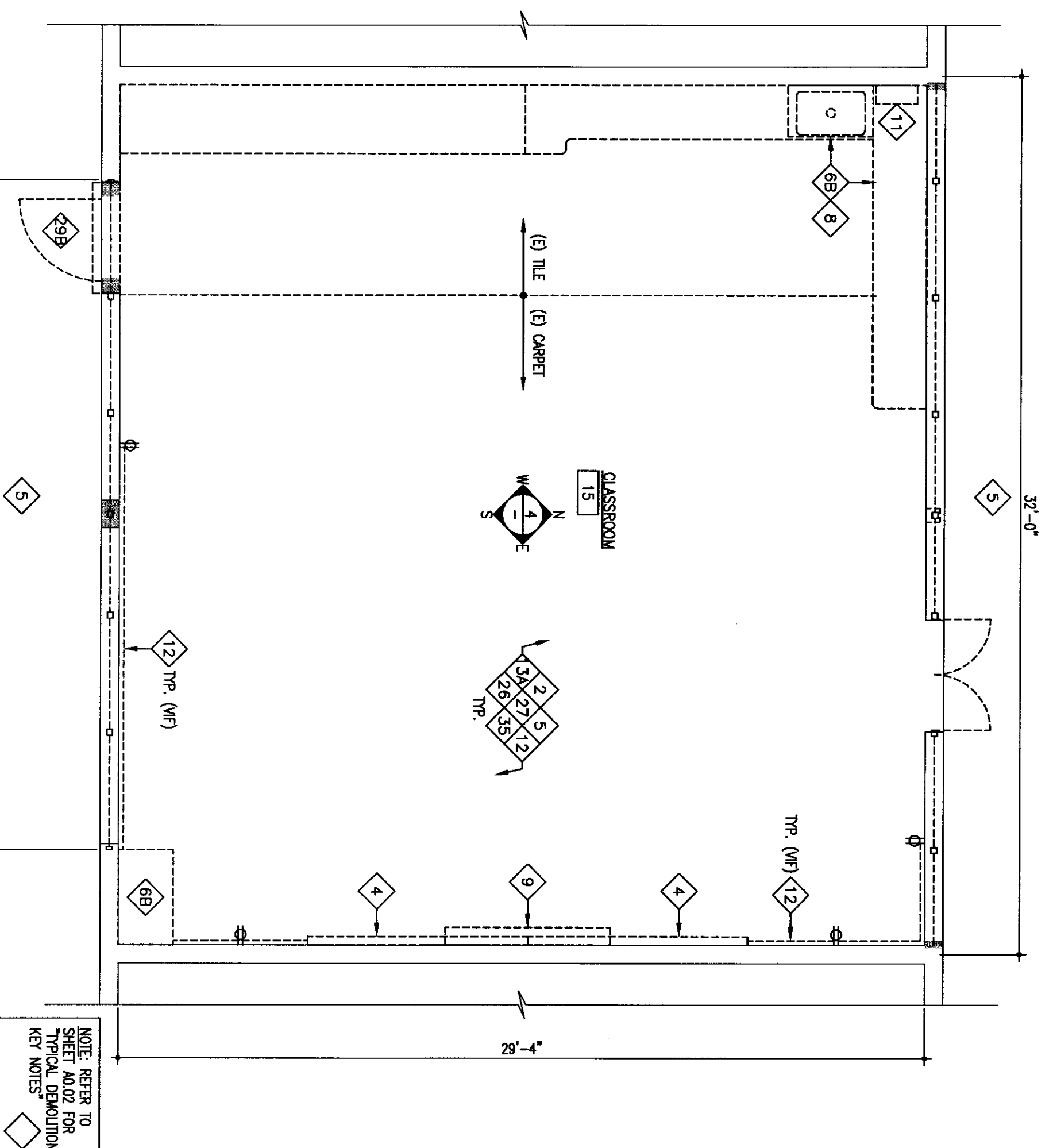

TYPICAL CLASSROOM DEMOLITION PLAN

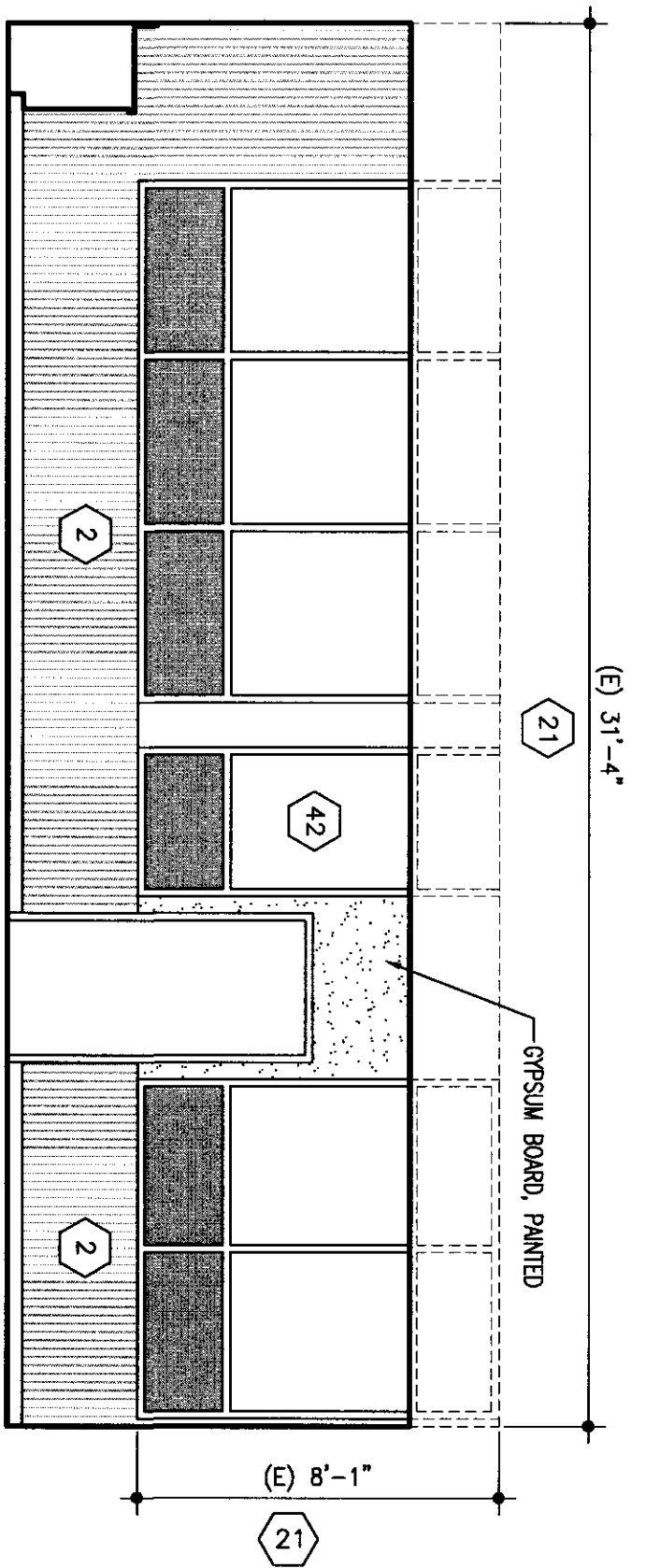

NORTH ELEVATION - #103, 106, 110 AND 113

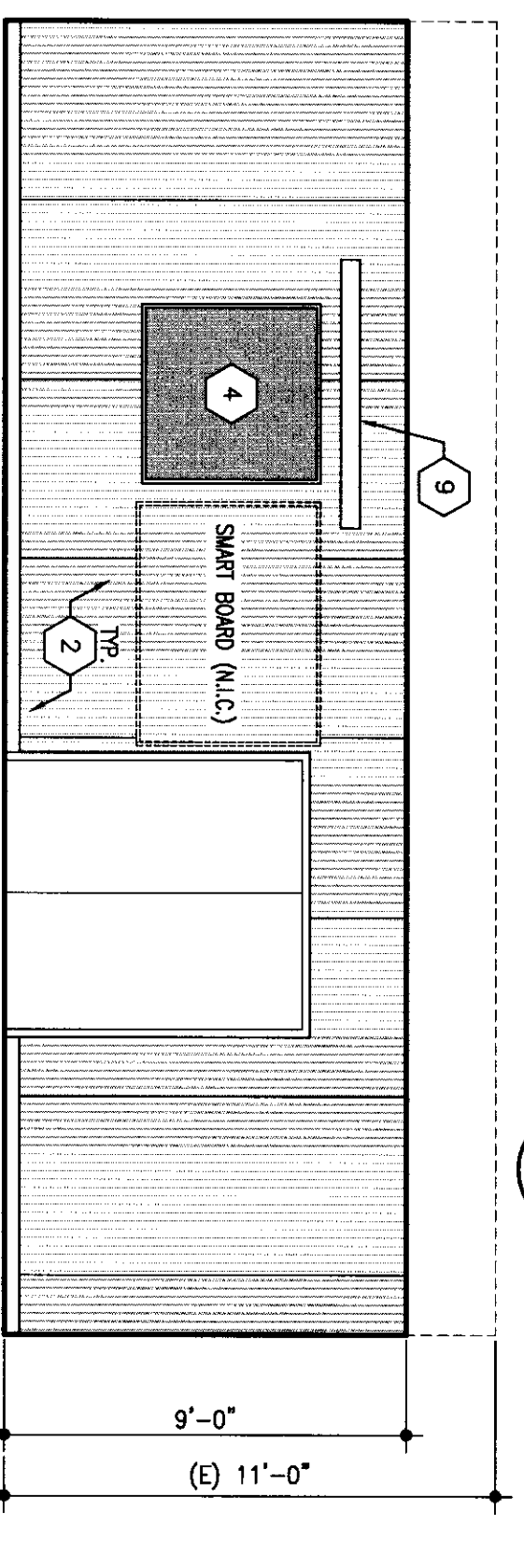

EAST ELEVATION - CLASSROOM #103 ONLY

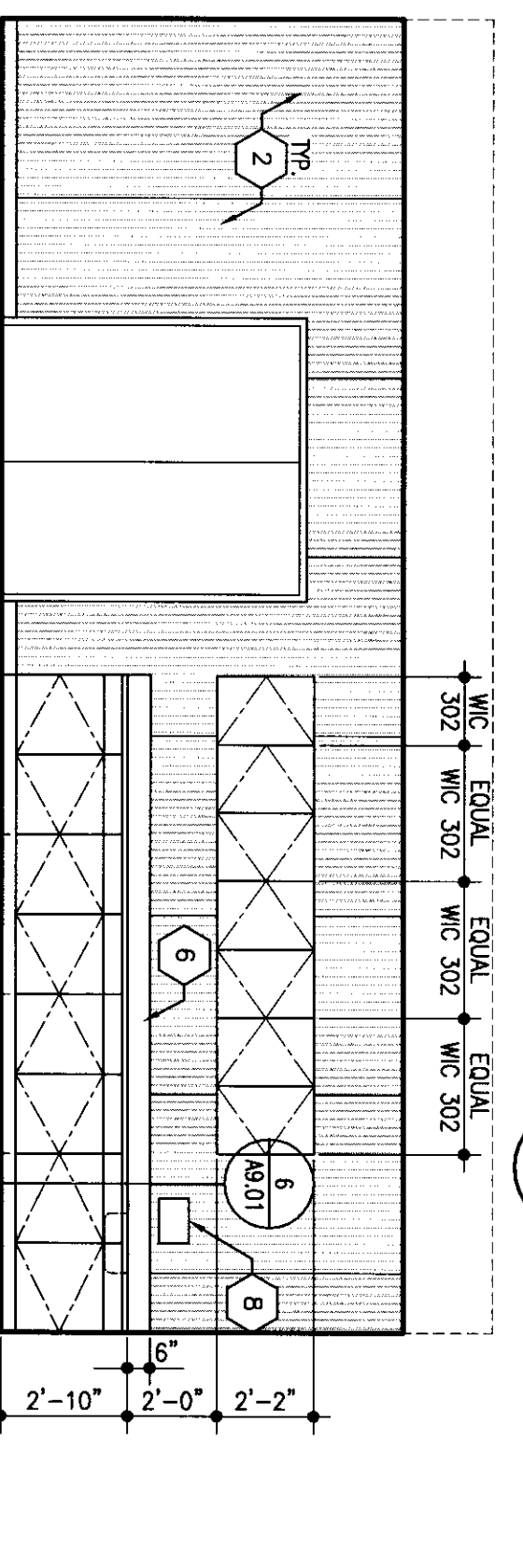

WEST ELEVATION - CLASSROOM #104 ONLY

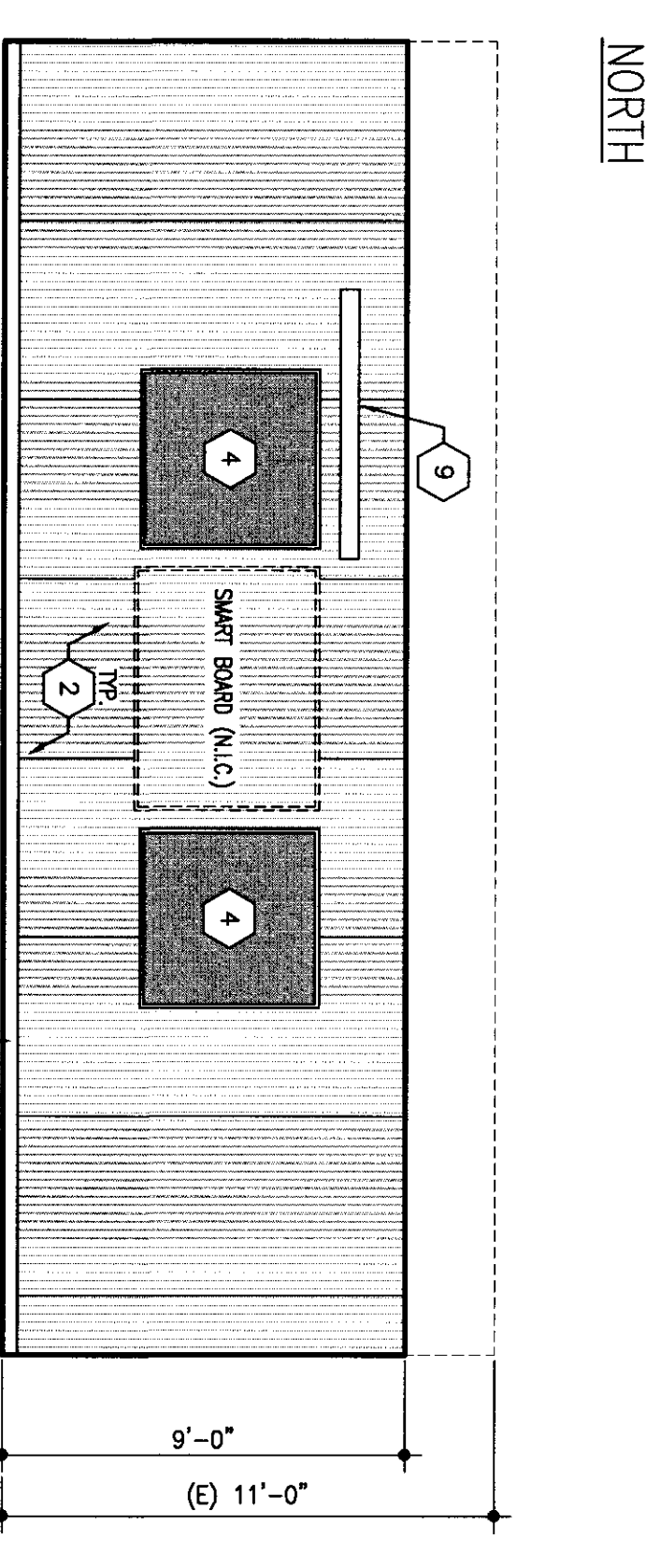

NORTH

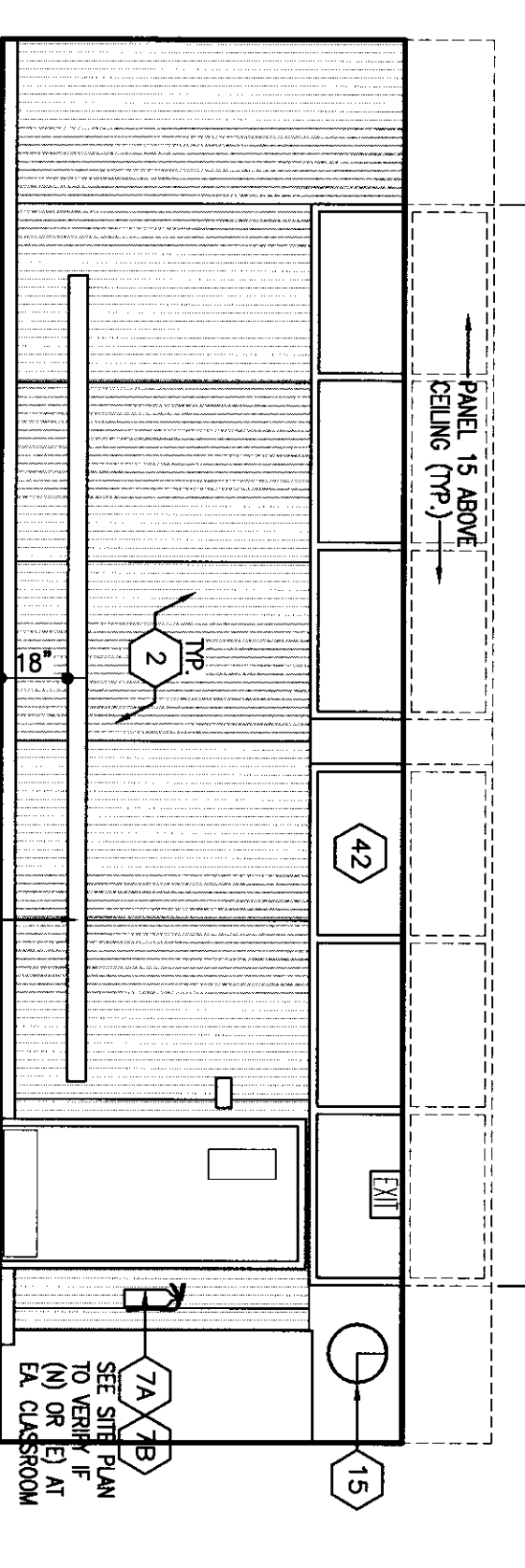

EAST

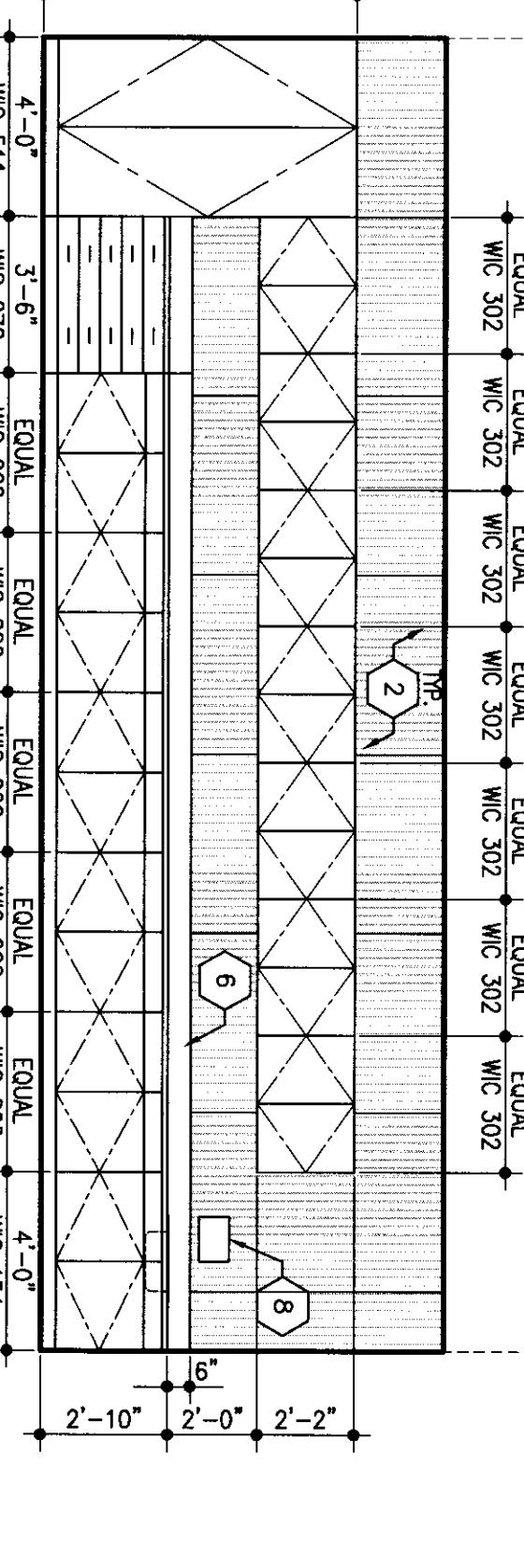

WEST TYP. CLASSROOM RECONSTRUCTION

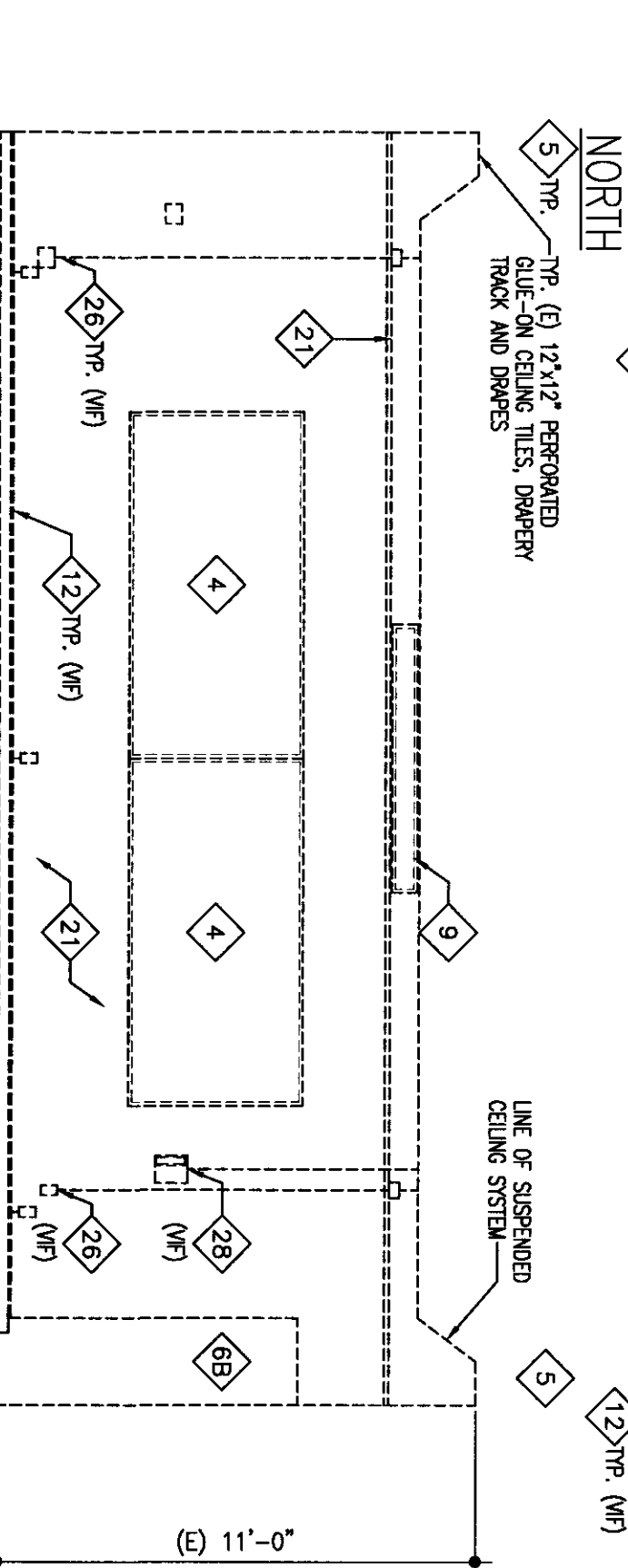

NORTH

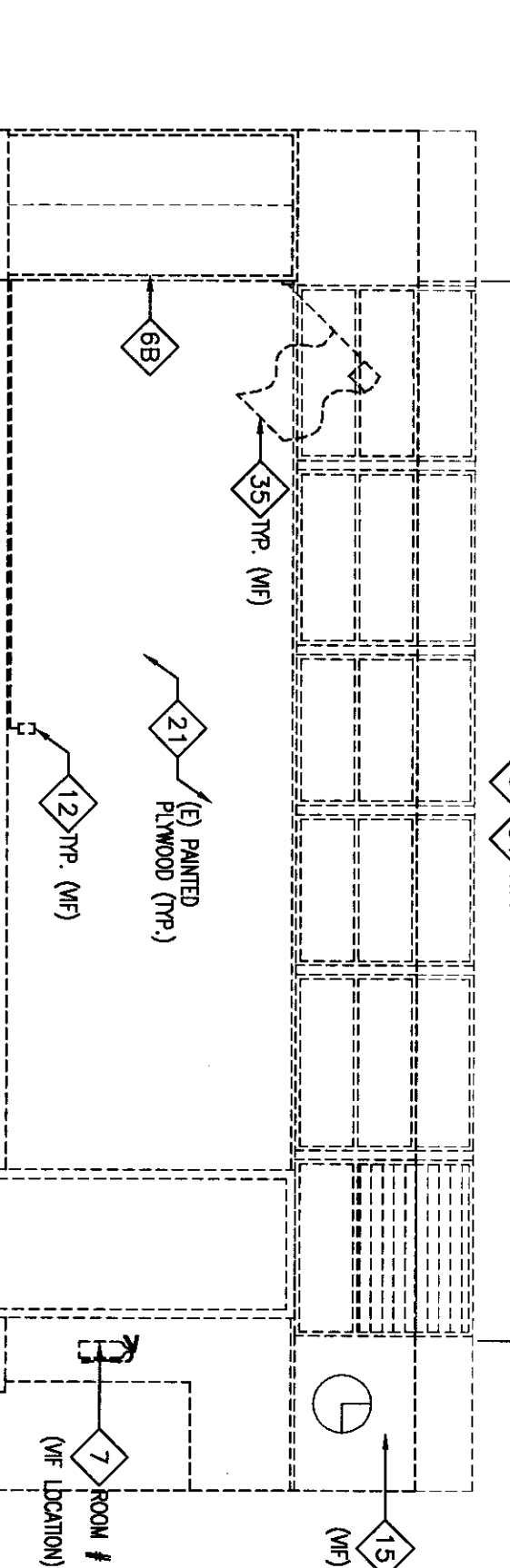

EAST

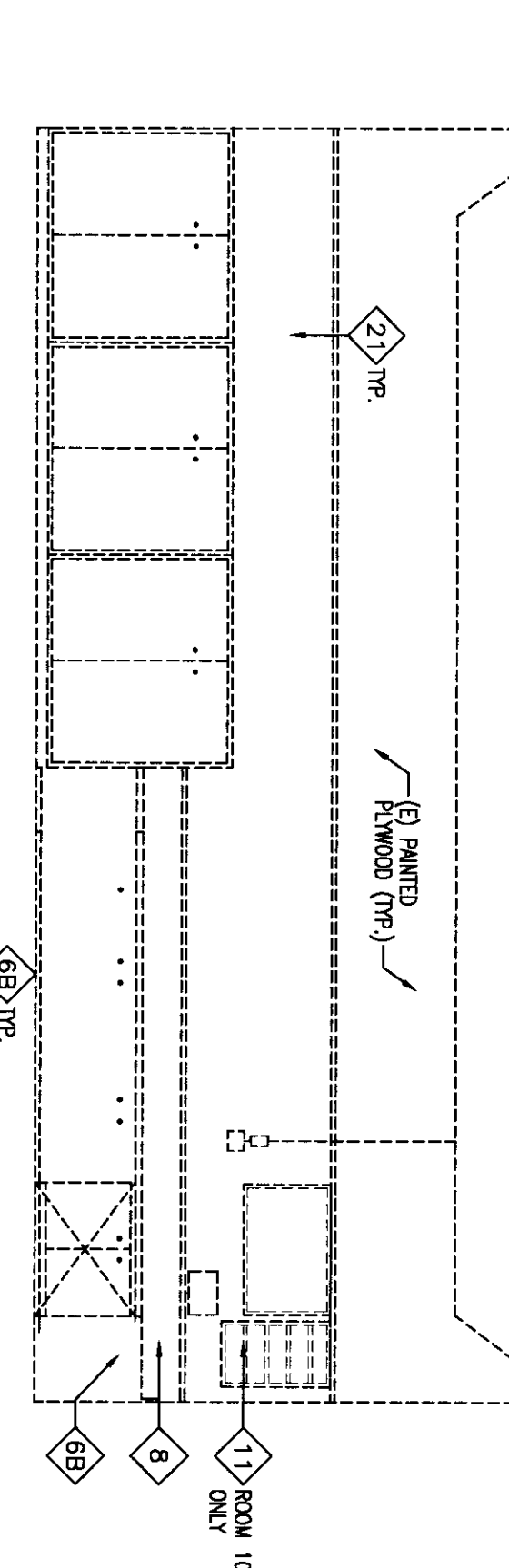

WEST TYP. CLASSROOM DEMOLITION

**FLEWELLING&MOODY**  
architects education

**HEADQUARTERS OFFICE**  
1000 Broadway  
San Francisco, California 94107  
Tel: 415.774.2200  
Fax: 415.774.2201  
Email: info@flewellingandmoody.com

**AMBLERE WILLET OFFICE**  
Lanham, California 92854  
881 S. Bascom  
Tel: 951.264.8771 FAX: 951.264.2843  
Email: flewelling@amblerewillett.com  
An Employee Owned Corporation

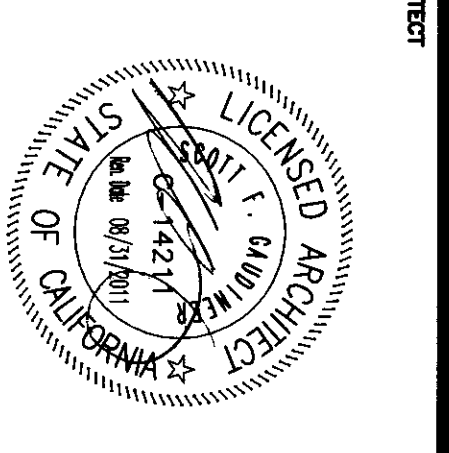

CONSULTANT

DISPERSED STAMP  
BY THE STATE ARCHITECT  
APR 03 12 8 17  
F. J. FLEWELLING  
DATE: APR 03 2010

PROJECT

MODERNIZATION PROJECT AT  
EVERGREEN ELEMENTARY SCHOOL  
BAKERSFIELD, CA 93304

Drawn by: \_\_\_\_\_  
Checked by: \_\_\_\_\_  
Reviewed by: \_\_\_\_\_  
No. \_\_\_\_\_  
Title: \_\_\_\_\_

NOTICE: All work shown on this drawing is the property of the architect. No part of this drawing may be reproduced, stored in a retrieval system, or transmitted in any form or by any means, electronic, mechanical, photocopying, recording, or by any information storage and retrieval system, without the prior written permission of the architect.

DATE: APR 03 2010

PROJECT: MODERNIZATION PROJECT AT EVERGREEN ELEMENTARY SCHOOL, BAKERSFIELD, CA 93304

CLIENT: BAKERSFIELD CITY SCHOOL DISTRICT

TYPICAL CLASSROOM DEMOLITION PLAN  
REFLECTED CEILING PLAN  
INTERIOR ELEVATIONS

1894  
1-26-2010  
A2.01D