

# HEATING AND COOLING MODIFICATIONS AT CASTRO LANE ELEMENTARY SCHOOL BAKERSFIELD CITY SCHOOL DISTRICT

2600 Rose Marie Drive Bakersfield, California

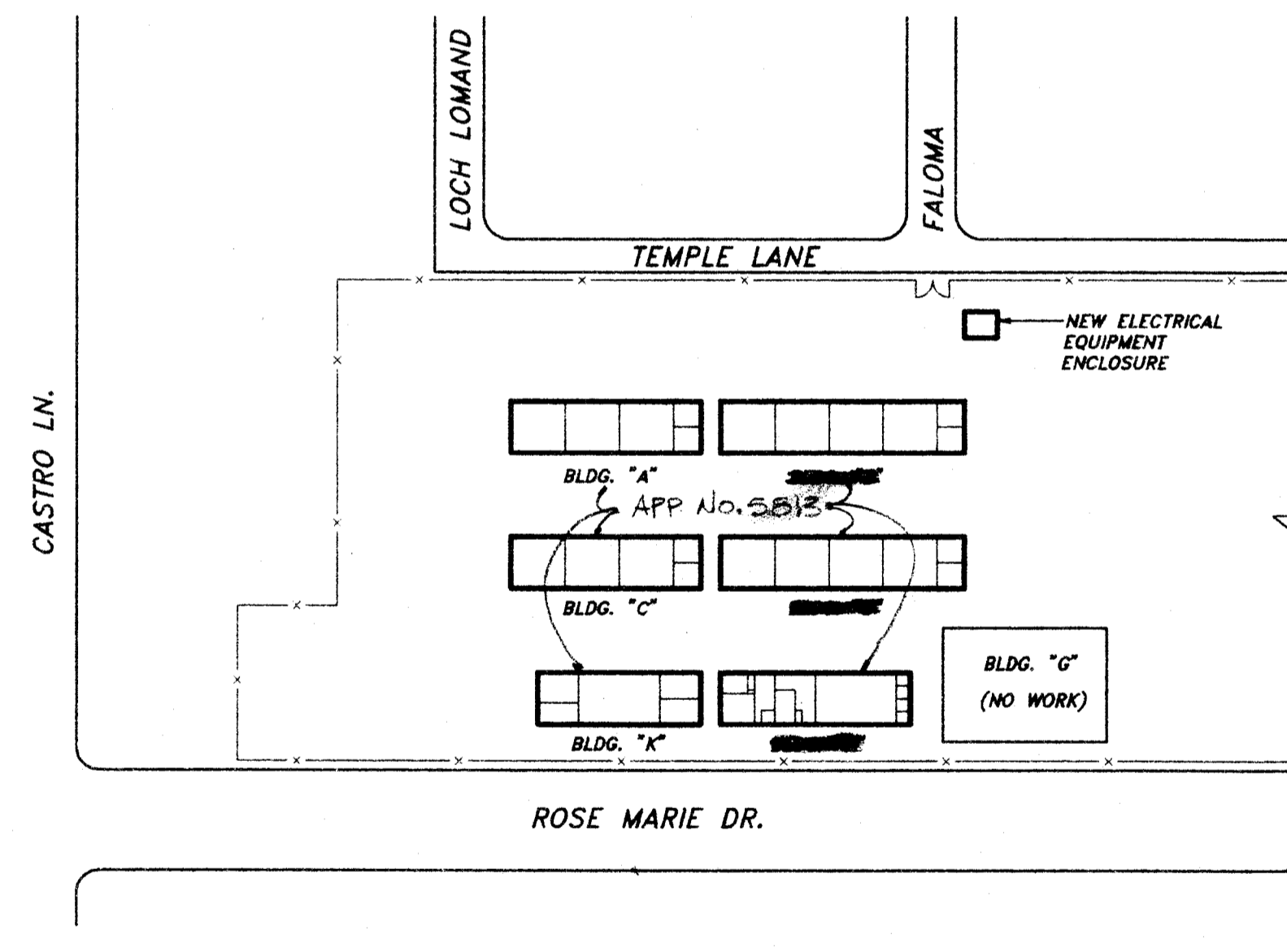

**PARTIAL SITE PLAN**

SCALE: NONE

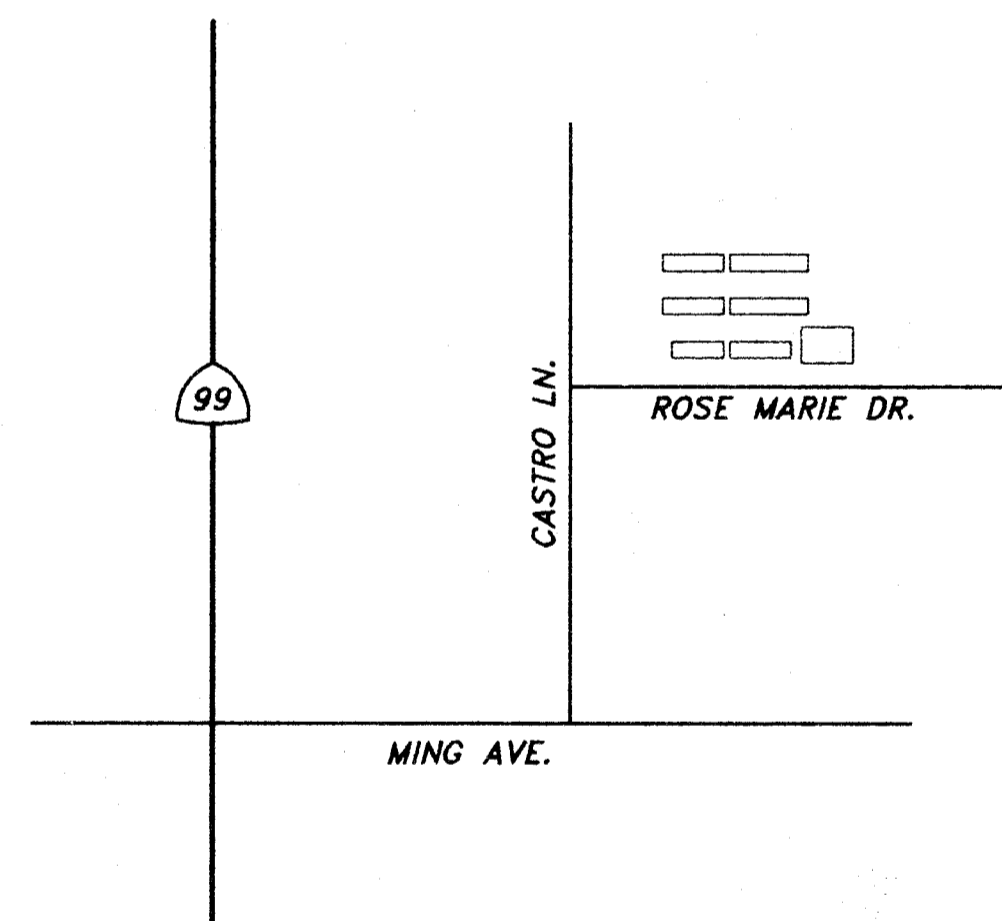
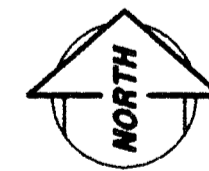

**VICINITY MAP**

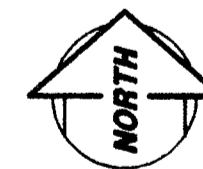

CONSTRUCTION: TYPE VN  
OCCUPANCY: E  
# STORIES: 1

APPLICABLE CODES AND STANDARDS

TITLE 19, PUBLIC SAFETY, STATE FIRE MARSHAL REGULATIONS

TITLE 24, PART 1, ADMINISTRATIVE REGULATIONS

TITLE 24, PART 12, REFERENCED STANDARDS CODE

CALIFORNIA BUILDING CODE - CBC - 1995

CALIFORNIA MECHANICAL CODE - CMC - 1995

CALIFORNIA PLUMBING CODE - CPC - 1995

CALIFORNIA FIRE CODE - CFC - 1995

CALIFORNIA ELECTRICAL CODE - CEC - 1995

NFPA 72, NATIONAL FIRE ALARM CODE - 1993,  
WITH CALIFORNIA AMENDMENTS

CHANGES TO THE APPROVED DRAWINGS AND SPECIFICATIONS SHALL BE MADE BY AN ADDENDUM OR A CHANGE ORDER APPROVED BY THE OFFICE OF THE STATE ARCHITECT, AS REQUIRED BY SECTION 4-338, PART 1, TITLE 24, C.C.R.

## SHEET INDEX

### MECHANICAL

- M-1 AIR CONDITIONING PLAN - BLDGS A, C & K
- M-2 AIR CONDITIONING PLAN - BLDGS B, D & H
- M-3 SCHEDULES AND DETAILS

### STRUCTURAL

- S-1 TYPICAL NOTES AND DETAILS
- S-2 DETAILS

### PLUMBING

- P-1 PLUMBING PLAN - BLDGS A, C & K
- P-2 PLUMBING PLAN - BLDGS B, D & H

### ELECTRICAL

- E-1 ELECTRICAL SITE PLAN
- E-2 ELECTRICAL PLAN - BLDGS A, C & K
- E-3 ELECTRICAL PLAN - BLDGS B, D & H
- E-4 DETAILS
- E-5 DETAILS AND SCHEDULE

### SCHOOL DISTRICT REPRESENTATIVE

LOUIS G. VARGA, DIRECTOR  
MAINTENANCE AND OPERATIONS  
1501 FELIZ DRIVE  
BAKERSFIELD, CALIFORNIA 93307  
(805) 631-5887

### CONSULTANTS

#### STRUCTURAL

JOHN Q. FORESTELLE  
1414 VALHALLA DRIVE  
BAKERSFIELD, CALIFORNIA 93309  
(805) 833-4311

#### ELECTRICAL

CORNELIUS - SING CONSULTING GROUP, INC.  
918 W. MAIN STREET  
VISALIA, CA 93291  
(209) 733-2671

#### ARCHITECTURAL

PECHIN ASSOCIATES ARCHITECTS  
5330 OFFICE CENTER CT., SUITE 39  
BAKERSFIELD, CA 93309  
(805) 322-2021



# Lawrence • Nye • Becker Associates

CONSULTING MECHANICAL ENGINEERS, INCORPORATED

1300 W. Shaw Avenue, Suite 2B  
(209) 226-0101

Fresno, California 93711  
FAX (209) 224-6327

15-6  
IDENTIFICATION STANDARDS  
DIV. OF THE STATE ARCHITECT  
OFFICE OF REGULATION SERVICES  
APPL. 6-08-0  
DATE: APR 11 1997