

FIRE ALARM FLOOR PLAN BLDG. 600

KEYNOTES

1) REPLACE EXISTING EXTERIOR FIRE ALARM HORN WITH NEW WP EXTERIOR FIRE ALARM HORN. SEE FIRE ALARM SINGLE LINE RISER DIAGRAM.

**FULLY AUTOMATIC SYSTEM
FIRE ALARM COMPLETE
PLAN SUBMITTAL**

KEY PLAN

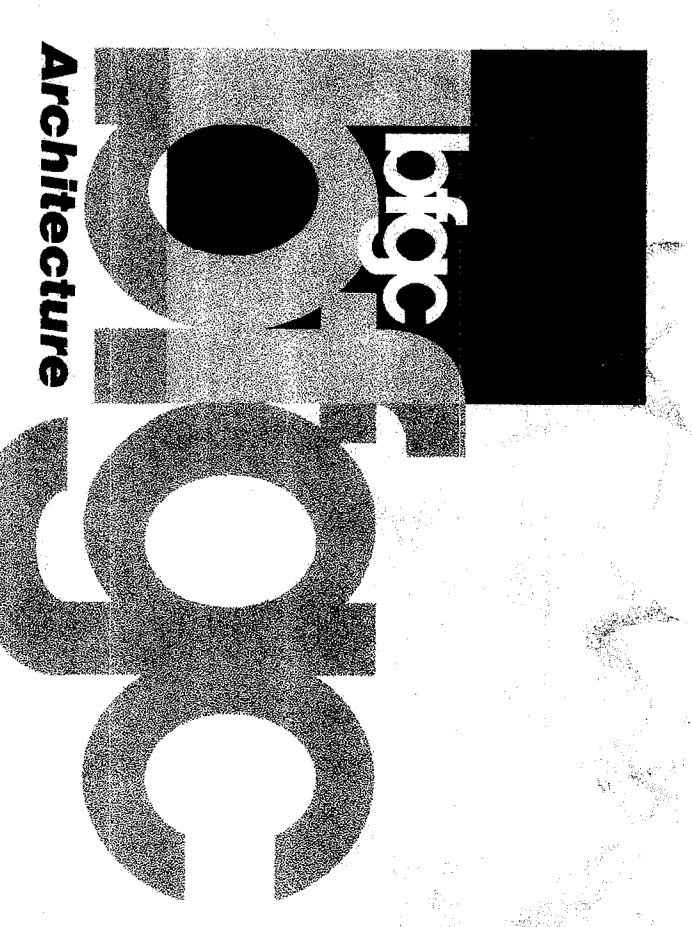
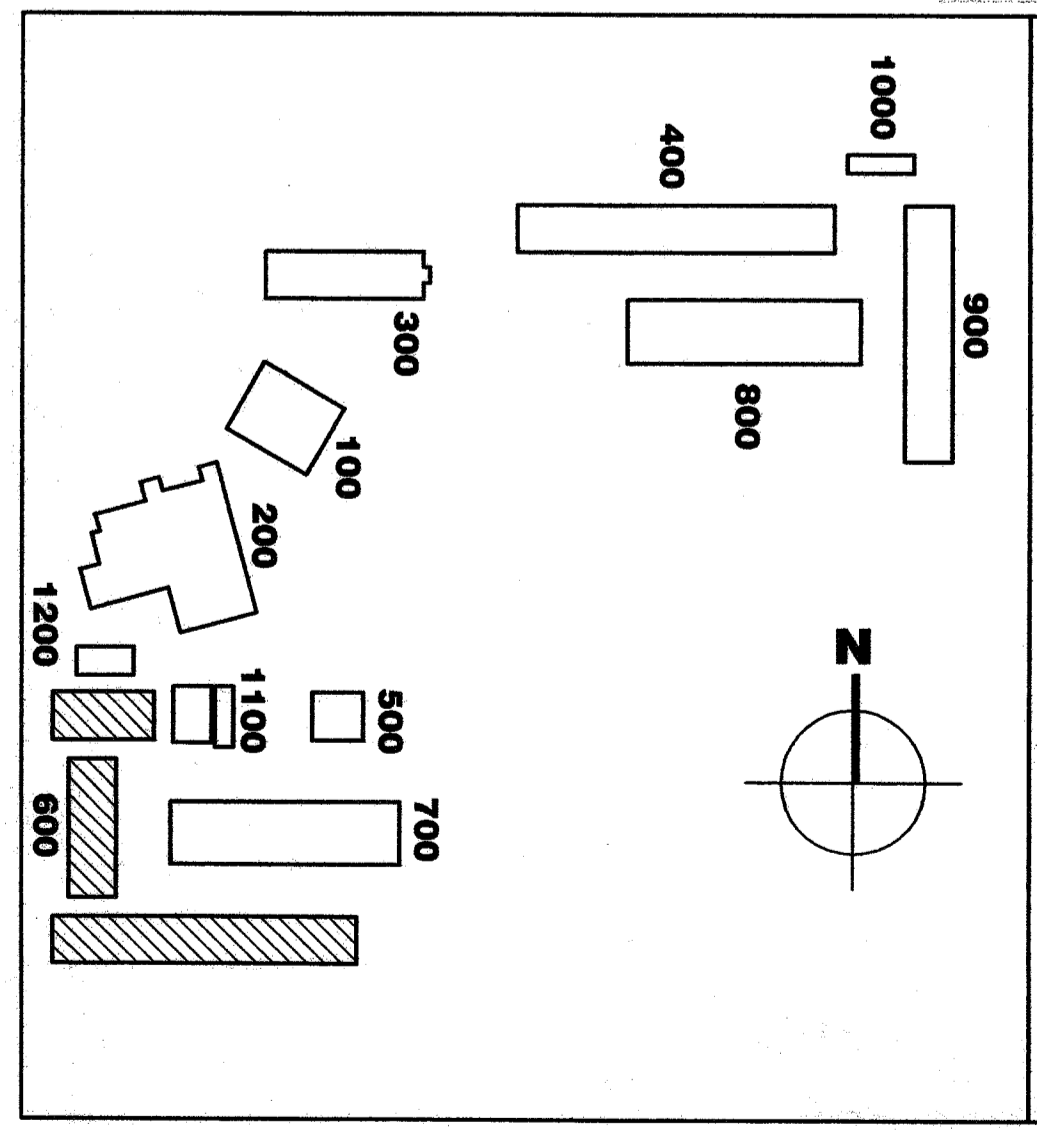

Bakersfield

5500 mingo avenue, suite 450, Bakersfield, ca 93309
661.836.4300 fax 661.836.4311

San Jose
150 south first st., suite 200
408.624.6811
408.624.6811
fax 408.624.6844

San Luis Obispo
300 E. Main Street
San Luis Obispo, ca 93401
805.546.0431
fax 805.546.0294

Oakland
350 First Street, Suite 300
Oakland, California 94612
fax 510.881.0674

Principal Architects
James W. Osborn, P.E., C-1119
James W. Osborn, P.E., C-1122
James W. Osborn, P.E., C-1123
James W. Osborn, P.E., C-1124
James W. Osborn, P.E., C-1125
James W. Osborn, P.E., C-1126
James W. Osborn, P.E., C-1127
James W. Osborn, P.E., C-1128
James W. Osborn, P.E., C-1129
James W. Osborn, P.E., C-1130
James W. Osborn, P.E., C-1131
James W. Osborn, P.E., C-1132
James W. Osborn, P.E., C-1133
James W. Osborn, P.E., C-1134
James W. Osborn, P.E., C-1135
James W. Osborn, P.E., C-1136
James W. Osborn, P.E., C-1137
James W. Osborn, P.E., C-1138
James W. Osborn, P.E., C-1139
James W. Osborn, P.E., C-1140
James W. Osborn, P.E., C-1141
James W. Osborn, P.E., C-1142
James W. Osborn, P.E., C-1143
James W. Osborn, P.E., C-1144
James W. Osborn, P.E., C-1145
James W. Osborn, P.E., C-1146
James W. Osborn, P.E., C-1147
James W. Osborn, P.E., C-1148
James W. Osborn, P.E., C-1149
James W. Osborn, P.E., C-1150

PREPARE ENGINEERING
466 W. Franklin Ave., Suite 105
Bakersfield, CA 93311
(805) 832-4200 / (805) 424-4244 fax
James W. Osborn, Electrical Engineer
E.E. #5101

AGENCY TRACKING NO.: _____
FILE NO.: 15-6
DENOTATION STATE
DIV. OF THE STATE ARCHITECT
APPL. NO.: 03-106663
AC: AL, FLS, JI, SS, R2
DATE: 06-14-09

MODERNIZATION
FOR
HENRY ESSLER SCHOOL
2901 ESSLER STREET
BAKERSFIELD, CA 93306
BAKERSFIELD CITY
SCHOOL DISTRICT

**BUILDING 600
FIRE ALARM
FLOOR PLAN**

Version Date: 02-126
Job no.: 06/24/03
date: 06/24/03
drawn by: T.V.A.
chk'd by: D.P.G.
©copyright 2003

