

MECH. ROOM ABOVE DISHWASHING

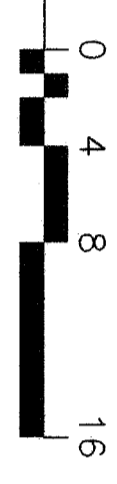

POWER / SIGNAL FLOOR PLAN BLDG. 200

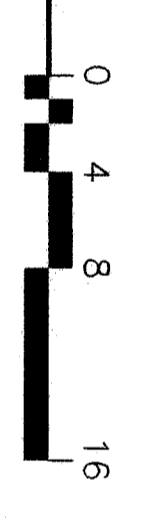
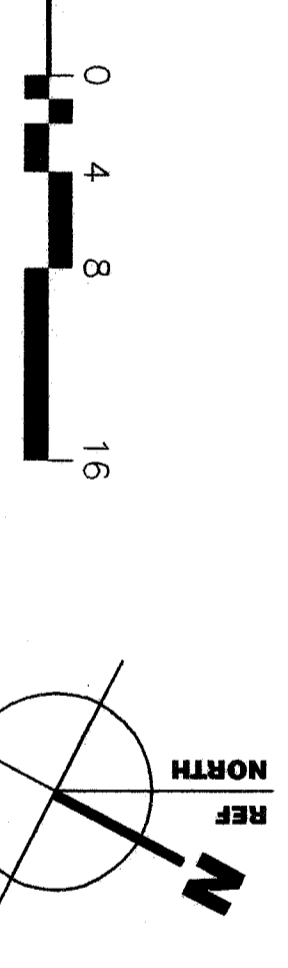

KEYNOTES

- 1 INSTALL WIREMOLD PLUGMOLD # AL2000 WITH OUTLETS AT 12" O.C. MOUNTED ABOVE BACKSPASH. CONNECT TO EXISTING DUPLEX OUTLET ABOVE COUNTER.
- 2 REPLACE EXISTING EXTERIOR DOWNLIGHT. USE RETROFIT KIT FIXTURE TYPE "A".
- 3 REPLACE EXISTING WALL BRACKET FIXTURE. USE FIXTURE TYPE "B".
- 4 REPLACE EXISTING FIXTURES. USE FIXTURES TYPE "C".
- 5 EXISTING 2x4 SURFACE METAL SIDED FIXTURES WITH (4) 40W T-12 LAMPS. REPLACE LAMPS WITH (4) T8 LAMPS. REPLACE BALLAST WITH RAPID START, LOW HARMONICS, ELECTRONIC BALLAST. REPLACE LENS WITH KSH K12.125 ASTIGMATIC LENS.
- 6 REPLACE EXISTING FIXTURE WITH NEW FIXTURE TYPE "D".
- 7 EXISTING FIXTURE TO REMAIN.
- 8 EXISTING RECEPTACLE TO BE REMOVED PROVIDE FOR CONTINUATION OF FEED THRU CIRCUIT AS REQUIRED.
- 9 PROVIDE CONNECTION TO HANDICAP LIFT. FIELD VERIFY EXACT LOCATION AND REQUIREMENTS PRIOR TO ELECTRICAL ROUGH-IN.
- 10 EXISTING PANEL "C1" PROVIDE NEW BREAKER FOR CONNECTION TO HANDICAP LIFT. FURNISH AND INSTALL ALL HARDWARE AS REQUIRED.

NOT ALL KEYNOTES APPLY TO THIS SHEET.

KEY PLAN

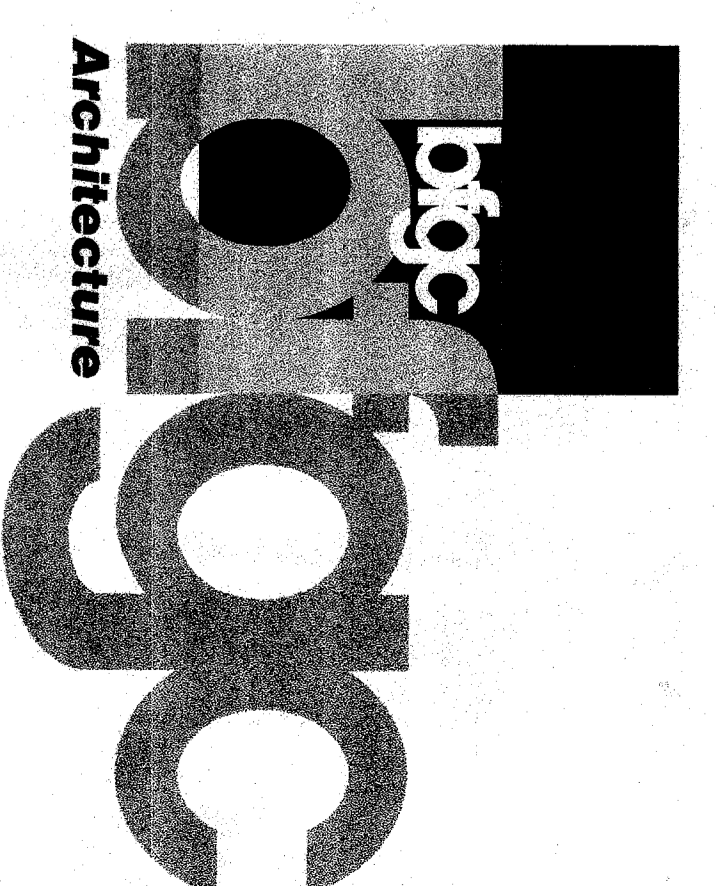
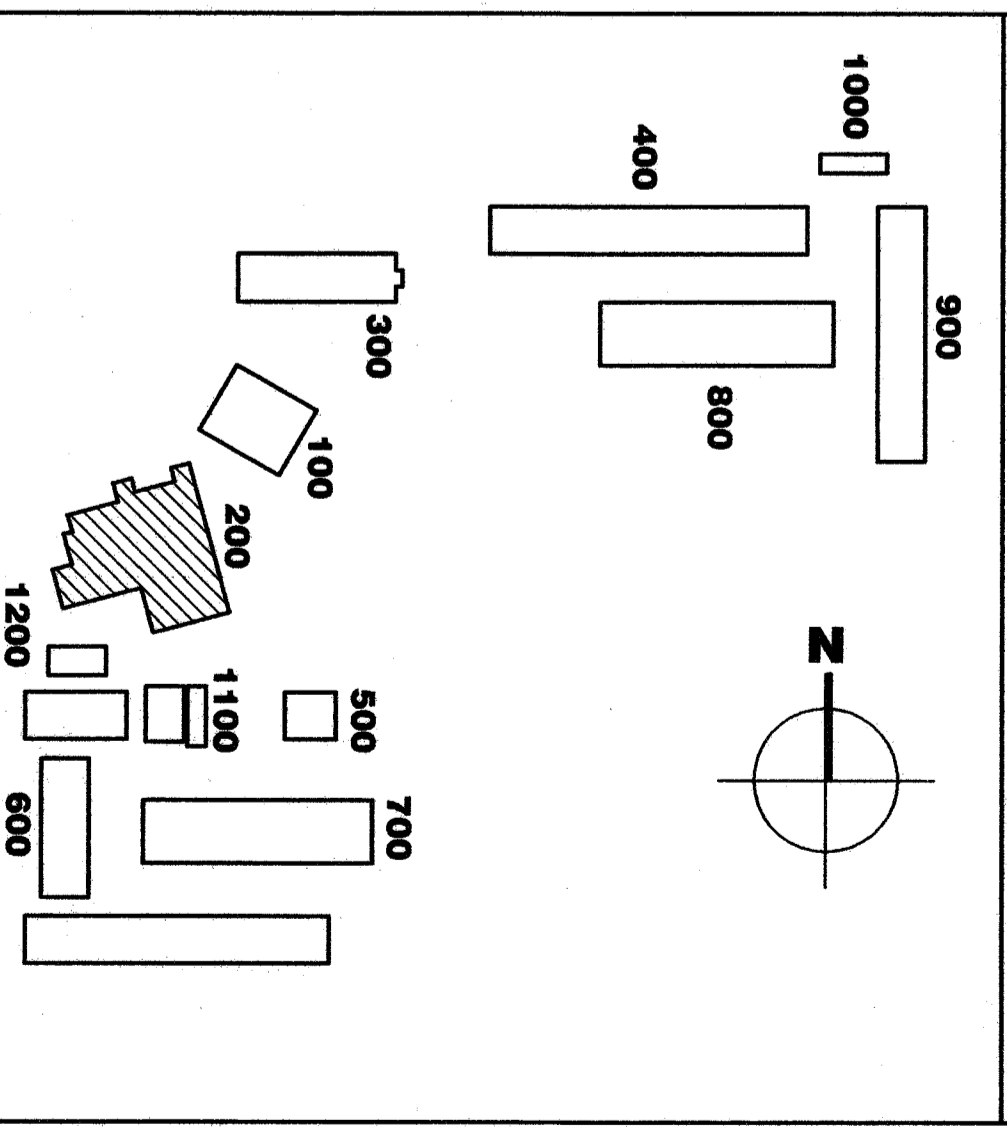

Bakersfield

5500 omig avenue, suite 450, bakersfield, ca 93309
661.838.4300
661.838.4311

San Jose
150 north first st. suite 200
san jose, ca 95113
408.624.9411
408.624.9411

San Luis Obispo
414 n. mission st.
san luis obispo, ca 93401
805.546.6433
805.546.6304



Oakland
350 frank owsen plaza, suite 300
oakland, california 94612
for 510.881.0174

Principal Architects
James W. Gardner, State of California, License No. 5101
James W. Gardner, State of California, License No. 5101
James W. Gardner, State of California, License No. 5101

PREPARE FOR RECORD

466 W. Folsom Ave., Suite 116
Folsom, California 95711
(916) 442-1491 / (916) 452-4444 fax

ESTABLISHED 1981
James W. Gardner, Registered Engineer
E.E. #5101

rev. no. rev. date. revision:

AGENCY TRACKING No. _____

FILE No.: 15-6

INTEGRATION STAMP
DIV. OF THE STATE ARCHITECT

APR 10 03-106693
F.S. SS No.

DATE 06-24-03

MODERNIZATION

FOR

HENRY ESSLER SCHOOL
2901 ESSLER STREET
BAKERSFIELD, CA 93306

BAKERSFIELD CITY
SCHOOL DISTRICT

**BUILDING 200
POWER / SIGNAL
FLOOR PLAN**

Version Date: 02-126
job no. dde
date 06/24/03
drawn by T.V.A.
chk'd by D.P.G.
©copyright 2003

Version time:

2.22