

CEILING LEGEND

NOTE: ALL ITEMS INDICATED ON THIS LIST MAY NOT NECESSARILY OCCUR ON THIS SHEET.

	RM / ROOM NAME		CEILING HEIGHT
	HEAVY DUTY™ 2x4 SUSPENDED CEILING SYSTEM		G.B. CEILING / SOFFIT
	1x4 SURFACE MOUNT LIGHT FIXTURE		NO CEILING WORK U.O.N.
<input checked="" type="checkbox"/>	RECESSED LIGHT FIXTURE SEE ELECTRICAL DRAWINGS FOR ADDITIONAL INFORMATION		
<input checked="" type="checkbox"/>	AIR TERMINAL SEE MECHANICAL DRAWINGS FOR ADDITIONAL INFORMATION		

DASHED LINE INDICATES CEILING GRID IS REFLECTED CEILING PLAN FOR LOCATION. SEE DETAIL 14/A10.01

MAN RUNNERS AT 4'-0" O.C. TYP.

CROSS TEES AT 2'-0" O.C. TYP.

PROVIDE 12 GA. SLACK WIRES AT DIA. CORNERS OF LIGHT FIXTURES AND AIR TERMINALS WEIGHING WIRES AT ALL CORNERS OF LIGHT FIXTURES AND AIR TERMINALS WEIGHING 55 LBS. OR MORE. DRAWINGS TYPICAL AND ELECTRICAL.

SPRAY WIRES PER DETAIL 15/A10.01.

ALL AIR TERMINALS TO BE INSTALLED IN THE LOCATION. ATTACH TO STRUCTURE PER DETAIL 17/A10.01.

ATTACH CEILING GRID TO TWO ADJACENT WALLS WHERE NO DASHED LINES ARE SHOWN ON 13/A10.01. SEE DETAIL.

12 GAUGE HANGERS 8" FROM WALLS. 4'-0" O.C. THEREAFTER ON MAIN RUNNERS. SEE DETAIL 17/A10.01.

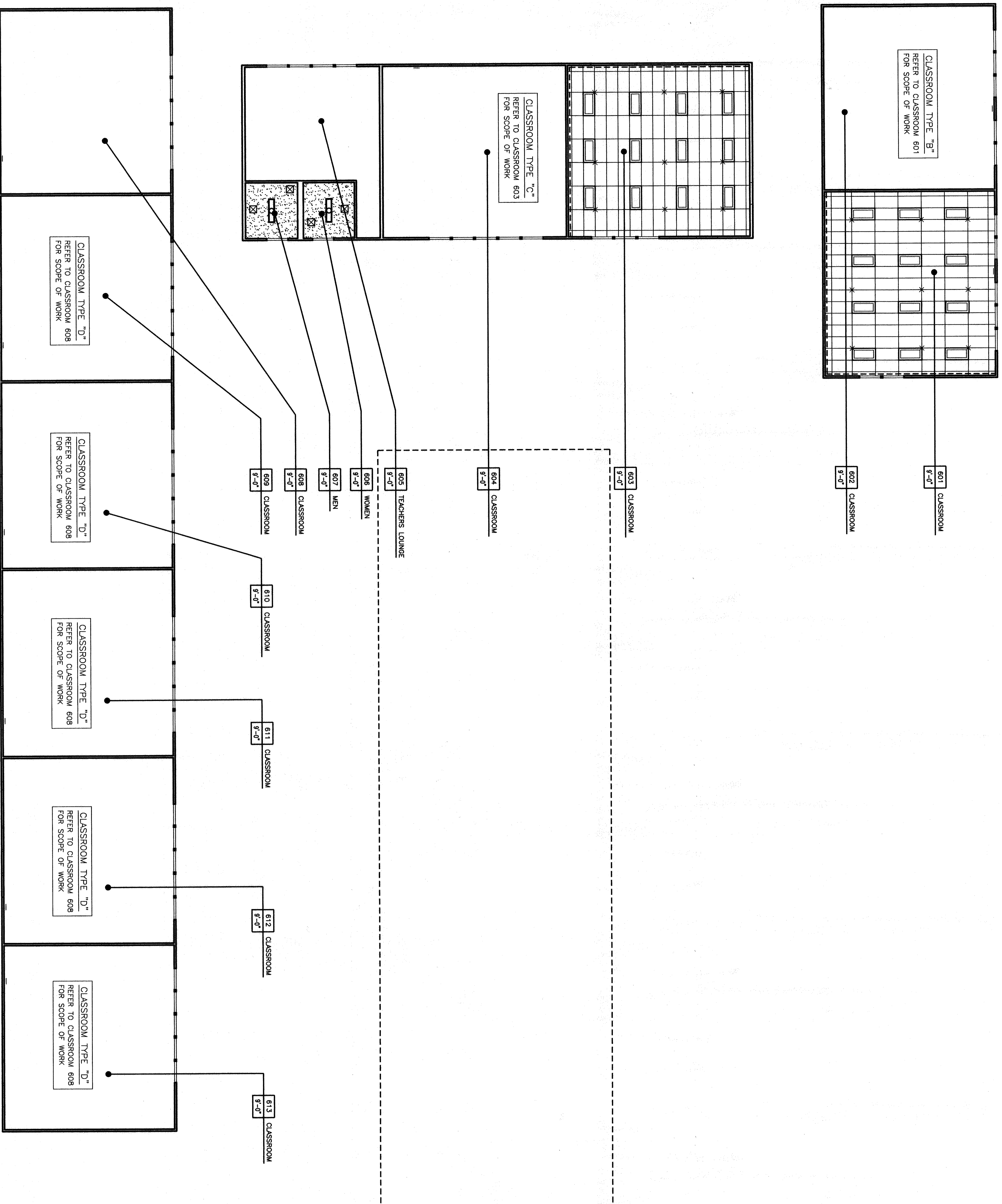

BUILDING 600 REFLECTED CEILING PLAN

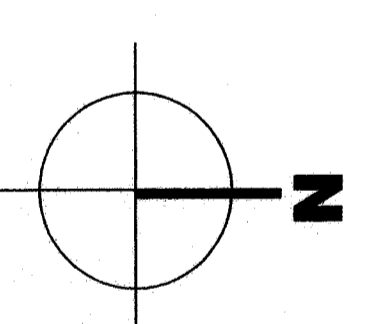

KEY PLAN

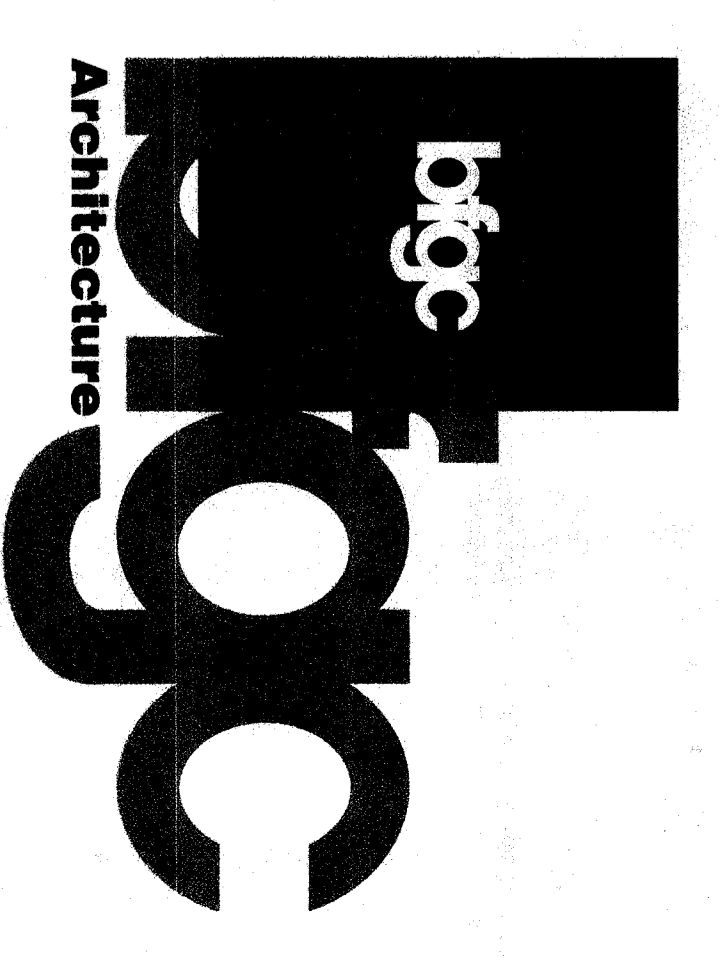
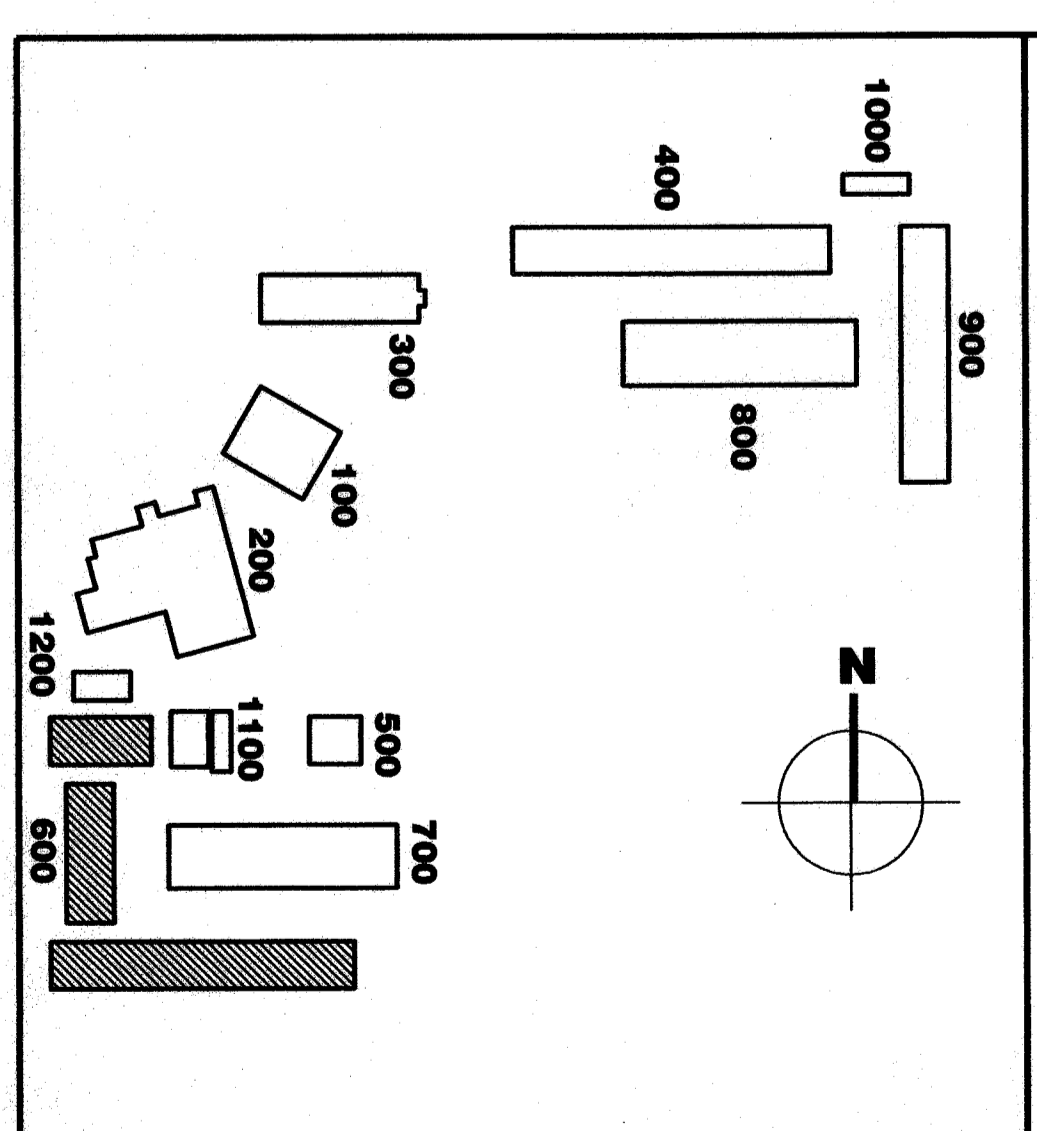

Bakersfield
5900 Ming Avenue, suite 450, Bakersfield, CA 93309
661.836.4300 fax: 661.836.4311

San Jose
150 South First St., Suite 200
Bakersfield, CA 93310
408.679.6666
for 408.976.0844

San Luis Obispo
415 E. Santa Fe Ave., Suite 100
San Luis Obispo, CA 93401
805.548.0133
for 805.548.0304

Oakland
300 Frank Ogden Plaza, Suite 300
Oakland, California 94612
for 510.881.0974

Principal Architects
1000 S. Grand Ave., Suite 1100
Bakersfield, CA 93309
805.548.0133
for 805.548.0304

San Jose
1000 S. Grand Ave., Suite 1100
Bakersfield, CA 93309
805.548.0133
for 805.548.0304

FILE NO.: 15-8

IDENTIFICATION STAMP
DATE: APR 01 10:08:53
APR. NO. 01-108993
AC 21
DATE: 4/1/10

MODERNIZATION
FOR
HENRY ESSLER SCHOOL
2901 ESSLER STREET
BAKERSFIELD, CA 93306
BAKERSFIELD CITY SCHOOL DISTRICT

BUILDING 600 REFLECTED CEILING PLAN

Version Date: 02-1-26
Job no.: 6-24-03
date: 6-24-03
drawn by: XXXX
chk'd by: XXXX
©copyright: 2003

Version: 8-61