

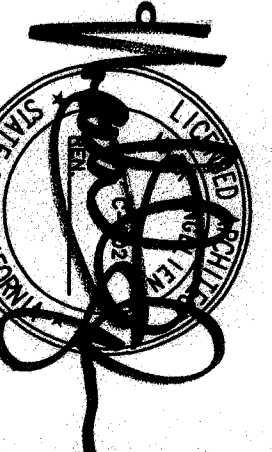

Bakersfield
5500 ming avenue, suite 450, Bakersfield, ca 93309
861.836.4300

San Jose
500 north main st., suite 300
san jose, ca 95113
408.621.0841
for 408.624.0844



San Luis Obispo
4115 bond street, suite 3-5
san luis obispo, ca 93401
505.463.4343
for 505.463.4344

Oakland
350 frank oregon plaza, suite 300
oakland, ca 94612
510.881.0574

Principal Architects
c/o bfgc architecture, 5110
civic center, c-1132
bakersfield, ca 93311
861.836.4300
c-8189
c-8190
c-8191
c-8192
c-8193
c-8194
c-8195
c-8196
c-8197
c-8198
c-8199
c-8200
c-8201
c-8202
c-8203
c-8204
c-8205
c-8206
c-8207
c-8208
c-8209
c-8210
c-8211
c-8212
c-8213
c-8214
c-8215
c-8216
c-8217
c-8218
c-8219
c-8220

KEYNOTES

- NOTE: KEYNOTES IN THIS LIST MAY NOT NECESSARILY OCCUR ON THIS SHEET.
- 101 (E) STUDENT TOILET ROOMS - THE DESIGN FOR ACCESSIBILITY IMPROVEMENTS AND RELATED CONSTRUCTION BY OTHERS. REFER TO APP. # 03-104991 FOR DETAIL 12/A10.01
 - 102 (E) CONCRETE FLOORING TO REMAIN.
 - 103 (E) ASPHALT PAVING TO REMAIN.
 - 104 (E) TURF AREA TO REMAIN.
 - 105 (E) LANDSCAPE PLANTER TO REMAIN.
 - 106 (E) PLAY AREA TO REMAIN.
 - 107 (E) NON-WALK STONING FOUNTAIN TO REMAIN.
 - 108 (E) PROVIDE CONCRETE FLOORING TO REMAIN.
 - 109 PROVIDE HI-LOW COMBINATION DRINKING FOUNTAIN. REFER TO PLUMBING DRAWINGS AND DETAIL 24/A10.02
 - 110 (E) ADA COMPLIANT DRINKING FOUNTAIN.
 - 111 (E) ADA COMPLIANT DRINKING FOUNTAIN.
 - 112 (E) ADA COMPLIANT DRINKING FOUNTAIN.
 - 113 (E) FENCE TO REMAIN.
 - 114 (E) FENCE TO REMAIN. REFER TO DSA APP. # 03-104991 FOR DETAIL 12/A10.01
 - 115 PROVIDE CONCRETE FLOORING TO REMAIN.
 - 116 PROVIDE 5" PAINT HANDRAILS AT GATE. REFER TO APP. # 03-104991 FOR DETAIL 12/A10.01
 - 117 PROVIDE 5" PAINT HANDRAILS AT GATE. REFER TO APP. # 03-104991 FOR DETAIL 12/A10.01

LEGEND

- EXISTING ADA COMPLIANT RESTROOMS
- BUILDINGS OR PORTIONS OF BUILDINGS TO BE DEMOLISHED. REFER TO APP. # 03-104991 FOR DETAIL 12/A10.01
- RESTROOMS TO BE MADE ADA ACCESSIBLE AS PART OF THIS DSA APPLICATION NUMBER AND CONTRACT
- EXISTING STUDENT OR STAFF RESTROOMS
- R = BOYS
M = MEN, W = WOMEN
- EXISTING FIRE DEPARTMENT ACCESS. (20'-0" WIDTH)
- PATH OF TRAVEL AS INDICATED IS A MIN. 4'-0" WIDE BARRIER - FREE ACCESS WITHOUT ANY 1/2" ABRUPT VERTICAL CHANGES EXCEEDING 1/2" AT 1/2" MAX. SLOPE. EXCEPT LEVEL CHANGES AT 1/2" MAX. SLOPE. EXCEPT VERTICAL CURVES SHALL NOT EXCEED 5% UNLESS OTHERWISE NOTED. THE CONTRACTOR SHALL VERIFY THAT ALL BARRIERS ON THE INDICATED PATH OF TRAVEL HAVE BEEN REMOVED.
- PROVIDE SIGN AT ALL GATES ON PATH OF TRAVEL TO READ "GATES TO REMAIN LOCKED IN OPEN POSITION DURING SCHOOL HOURS OR DURING ANY PUBLIC FUNCTIONS. (ALL CHANGES 15A7). ACCESSIBLE BUILDING ENTRANCE
- PROVIDE CONCRETE WALK
- ASSUMED PROPERTY LINE

ACCESSIBILITY NOTE
REFER TO ARCHITECTURAL DRAWINGS, SHEET A1.11 - SEE DRAWING FOR ACCESSIBILITY DETAILS. SEE APP. # 03-104991 FOR DETAIL 12/A10.01. PROVIDE 5" PAINT HANDRAILS AT GATE. REFER TO APP. # 03-104991 FOR DETAIL 12/A10.01. PROVIDE 5" PAINT HANDRAILS AT GATE. REFER TO APP. # 03-104991 FOR DETAIL 12/A10.01.

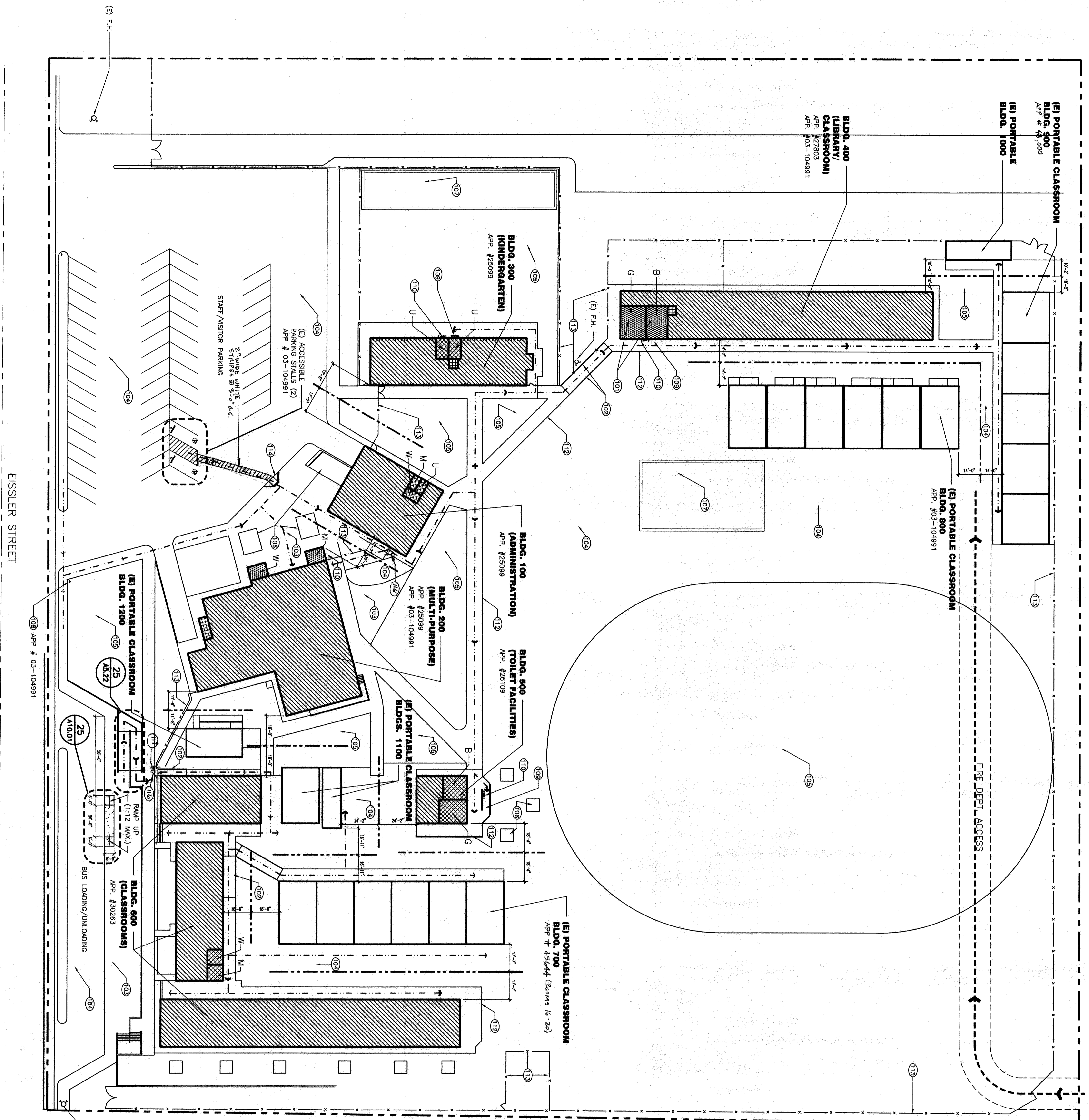

- Item (6)
- a. CLARIFY length of handrails (2) to be 41'-0" each for ramp east of Building 300 (Keynote 102).
 - b. CLARIFY length of handrails (2) to be 20'-6" each for ramp north of Building 600 (Keynote 102).
 - c. CLARIFY length of handrails (2) to be 28'-6" each for ramp east of Building 600 (Keynote 102).
 - d. PROVIDE handrails per Detail 12/A10.01.
 - e. CLARIFY and indicate Keynote 110 shall be Von Dorn 881.991 rim device for each combination fence gate combination of Building 100 and entrance of Building 600.
 - f. ADD full height wavy arch (1 1/2" x 1 1/2" x .250" radius) to each combination fence gate and secure adjacent side fencing (min. 2'-0"). Wavy arch shall be welded to fence and gates and painted to match existing fencing.

MODERNIZATION
FOR
HENRY ESSLER SCHOOL
2901 ESSLER STREET
BAKERSFIELD, CA 93306

BAKERSFIELD CITY SCHOOL DISTRICT

SITE PLAN

Version Date:	Version Desc:
job no. 02-126	
date 6-24-03	
drawn by D.HERBERA	
chk'd by R.TROST	
©copyright 2003	

SITE PLAN

