

Item No. 18 Refer to Sheet A-2311. Elevation "A", "B", "C", "D", "E", "F", "G", "H", "I", "J", "K", "L", "M", "N", "O", "P", "Q", "R", "S", "T", "U", "V", "W", "X", "Y", "Z". Sink cabinet to be made accessible, replace existing sink cabinets with (WVC 155) all references to sink cabinet modification to be deleted. Elevation "A" sink cabinets with (WVC 159) all references to sink cabinet modification to be deleted. Interior upper rack no longer applies. Replace Keynote #04 at 27' in this location. Revise Keynote #02 to read: "Remove and replace existing counter top with granite countertop with (G3) to result. Replace existing sink cabinet with ADA compliant sink cabinet, typical all sink cabinets." Revise Keynote #4 to read: "Existing cabinet to remain, remove and replace all cabinet with ADA compliant sink cabinet, typical all sink cabinets." Revise Keynote #18 to read: "Remove existing rough sink, provide install cabinet with 6" splash & accessible sink per plumbing plans. See addendum drawing A-D-24 for details. Remove existing cabinet, provide accessible return flooring to back wall typical. Revise Keynote #23 to read: "Remove existing return flooring to back of knee space. Add Keynote #27. Demo existing lumber rack, repair all wall and floor surfaces and lockers, repair all floor and wall surfaces to match existing typical." Add Keynote #29. Demo existing tool cabinets and lockers, repair all floor and wall surfaces to match existing typical.

**KEYNOTES**  
THIS SHEET ONLY

- 01 REMOVE (E) RUBBER BASE WHERE OCCURS-PROVIDE/INSTALL RTSB
- 02 REMOVE/REPLACE (E) COUNTERTOP W/CORIAN COUNTERTOP W/6 SPLASH, (VNO) CALL AT WALL
- 03 REPLACE EXISTING SINK CABINET WITH ADA COMPLIANT SINK CABINET TYPICAL. ALL SINK CABINETS
- 04 REMOVE (E) EXISTING DOOR AND BRAKER PULLS SAND BUILD-UP PAINT, FILL DAMAGED AREAS, PREP & PAINT- RENOVATE HANDRAIL
- 05 MAINTAIN (E) OPEN SPACE FOR METAL TILE CABINET
- 06 PROVIDE/INSTALL PAPER TOWEL DISPENSER-SEE SPECIFICATIONS
- 07 PATCH/FILL DAMAGED WALLS AS REQUIRED, PREP-PAINT (E) PLWOOD WALLS
- 08 (E) PLASTER FINISH PAINT
- 09 REMOVE/REPLACE CHALK BOARDS W/LIQUID MARKER BOARDS
- 10 SEE SPECIFICATIONS-SEE SPECIFICATIONS
- 11 REMOVE ABANDON HEATER UNIT CAP ALL SUPPLY/RETURN LINES BEHIND WALL, REMOVE VENT OPENING @ EXTERIOR WALL UNTIL MATCH 2X FRAMING, INSTALL INSULATION, PATCH-MATCH FINISHES-
- 12 (E) DOOR/FRAME TO REMAIN, REPLACE HARDWARE W/ ACCESSIBLE PAINT EXTERIORS, RE-STAIN PREVIOUSLY STAINED AREAS WHERE OCCURS
- 13 (E) DOOR/FRAME TO REMAIN, SEE DOOR SCHEDULE, SAND PREPARE DOOR SURFACE, PAINT EXTERIORS, RE-STAIN PREVIOUSLY STAINED AREAS WHERE OCCURS
- 14 WINDOWS CLEAN/PRIE TUBE STEEL WALLIONS-PAINT
- 15 WINDOWS CLEAN/PRIE WOOD TRIM (JAMB/SILL/HEAD W/DOORS)-PAINT
- 16 (E) WALL MOUNTED TV/RACKETS TO REMAIN
- 17 REMOVE (E) TROUGH SINK, PROVIDE NEW ACCESSIBLE WASH SINK
- 18 REMOVE (E) TROUGH SINK, PROVIDE NEW ACCESSIBLE WASH SINK
- 19 REMOVE (E) TROUGH SINK, PROVIDE NEW ACCESSIBLE WASH SINK
- 20 REMOVE (E) WOOD SHELF/COAT ROD/HOOKS, PATCH WALL AS REQUIRED, PAINT PLWOOD WALL
- 21 PREP/E) WOOD COUNTERTOP & ANGLED SHELVES-PAINT
- 22 27' CLEAN KNEE SPACE
- 23 REMOVE TAGBOARDS/CHAIRBOARDS, PATCH/MATCH FINISHES-PAINT
- 24 REMOVE (E) CABINET PROVIDE ACCESSIBLE CABINET AND CORIAN COUNTERTOP W/6 SPLASH, (VNO) CALL AT WALL
- 25 (E) W/ ACCESSIBLE KNEE SPACE-RETURN FLOORING TO BACK OF OPEN KNEE SPACE
- 26 REMOVE PORTION OF (E) CABINET BACKSPLASH, GRAMER & DOOR PROVIDE CABINETS-PAINT PATCH WALL AS REQUIRED
- 27 DEMO EXISTING LUMBER RACK, REPAIR ALL SURFACES TO MATCH
- 28 DEMO EXISTING CABINETS REPAIR FLOOR AND WALL SURFACES AS REQUIRED TO MATCH EXISTING TYP. LOCKERS, REPAIR ALL FLOOR AND WALL SURFACES TO MATCH EXISTING TYP.
- 29 DEMO EXISTING LOCKERS TO MATCH EXISTING TYP.

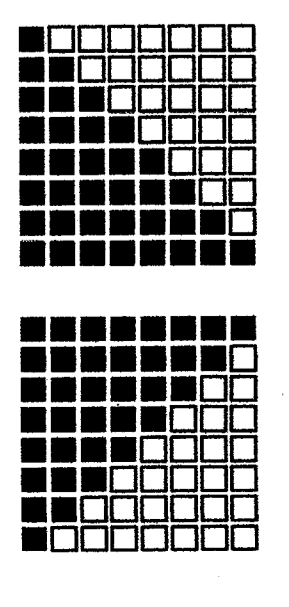

REGISTERED ARCHITECT  
 No. C-10818  
 State of California  
 ARCHITECT  
 WILLIAM L. MELBY, AIA  
 ARCHITECT C-16185  
 CONSULTANT

DEPARTMENT STAMP  
 DIVISION OF STATE ARCHITECT  
 OFFICE OF REGULATION SERVICES  
 APPL. 03-107033  
 FILE # 15-8  
 AC \_\_\_\_\_ FS \_\_\_\_\_ SS \_\_\_\_\_  
 DATE \_\_\_\_\_

MODERNIZATION AT  
 CURRAN MIDDLE  
 SCHOOL  
 FOR:  
 BAKERSFIELD  
 CITY SCHOOL  
 DISTRICT

1116 LYRIC WAY  
 BAKERSFIELD  
 CALIFORNIA  
 93309

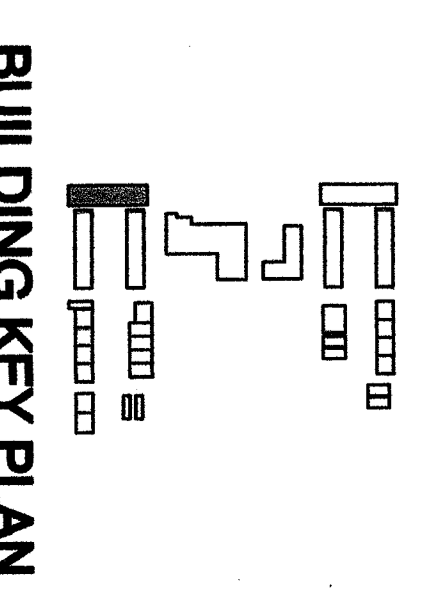

MARK	DATE	DESCRIPTION
SD		
CD	08/29/07	ADDENDUM 1
AD	09/11/07	ADDENDUM 2
AD	11/01/07	ADDENDUM 3

DATE PLOTTED: 11/02/07 12:43 PM  
 CHECKED BY: MKB  
 DESIGNED BY: MKB  
 REPORT DEVELOPED BY: MKB  
 REPORT DRAWN BY: MKB  
 PROJECT NO: 03-107033  
 SHEET TITLE: INTERIOR ELEVATIONS BUILDING G  
 SHEET IDENTIFICATION NUMBER: A-2311  
 SHEET 30 OF 48