

KITCHEN CABINETS  
SCALE 1/2" = 1'-0"

DRAWER DETAIL

CONFERENCE RM.  
SCALE 1/2" = 1'-0"

REST RM.  
SCALE 1/2" = 1'-0"

FOOD STORAGE  
SCALE 1/2" = 1'-0"

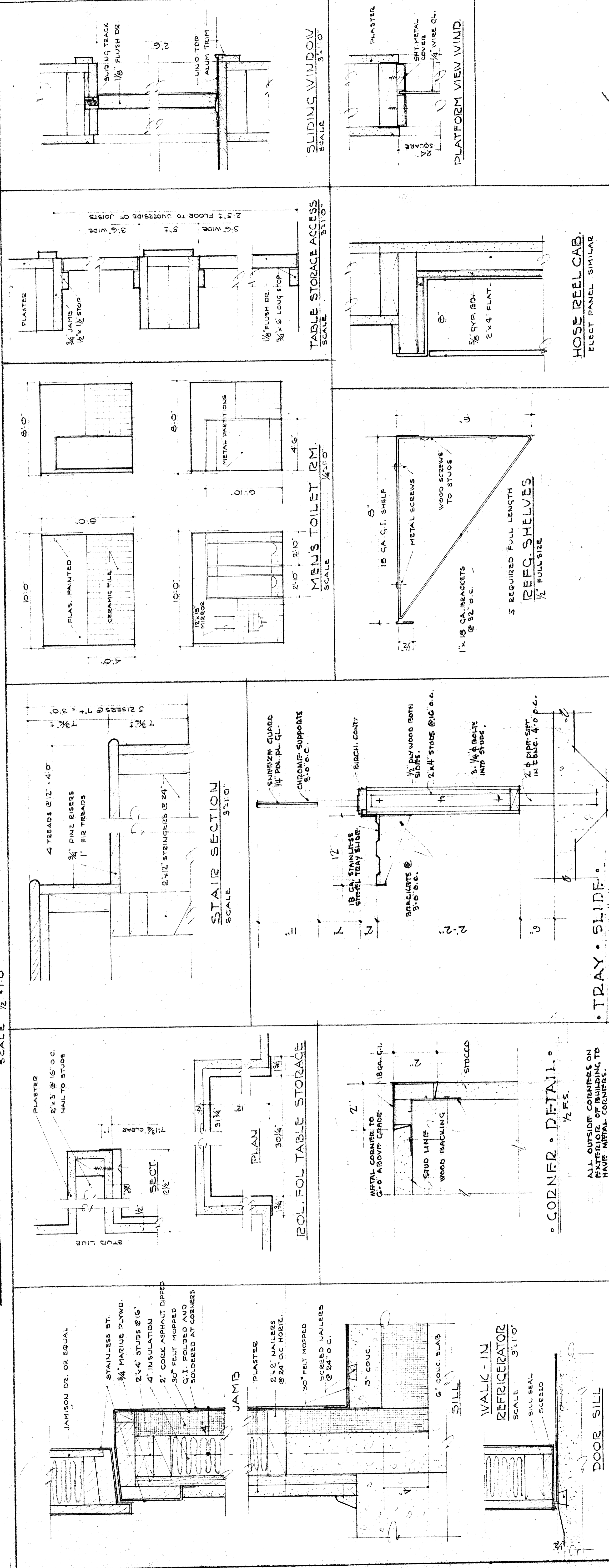

STAIR SECTION  
SCALE 3/16" = 1'-0"

REF. FOL TABLE STORAGE  
SCALE 3/16" = 1'-0"

WALK-IN REFRIGERATOR  
SCALE 3/16" = 1'-0"

HOSE REEL CAB.  
ELECT. PANEL SIMILAR

APPROVED ARCHITECTS & REGISTERED ARCHITECTS  
BY THE DEPARTMENT OF PUBLIC WORKS  
DIVISION OF ARCHITECTURE  
STATE OF CALIFORNIA  
APPROVED JUL 9 - 1957  
16-079  
NOTE: CONTRACTOR IS TO VERIFY ALL DIMENSIONS AND CONDITIONS OF THE CONSTRUCTION.  
THIS DRAWING IS TO BE USED IN CONNECTION WITH THE CONTRACT.  
MAY BE RETURNED TO ARCHITECTS UPON COMPLETION OF THE PROJECT.  
CONSULT THE ARCHITECTS.

BAKERSFIELD CITY SCHOOL DISTRICT  
APPROVED MAY 9 1957  
BOARD OF EDUCATION  
DIVISION OF ARCHITECTURE  
BY RESOLUTION  
*John S. Long*  
*John S. Long*

DIVISION OF ARCHITECTURE  
STATE OF CALIFORNIA  
APPROVED JUL 9 - 1957  
16-079

MULTI-PURPOSE ROOM  
HEIGHT STREET SCHOOL  
BAKERSFIELD CITY SCHOOL DISTRICT  
BAKERSFIELD CALIFORNIA

ALFORD, THOMAS & LEYDENFROST  
C. B. ALFORD • W. J. THOMAS • ARCHITECTS • H. B. LEYDENFROST  
BAKERSFIELD • CALIFORNIA

MAY 9 1957  
A 6