

### BUILDING 500 - POWER AND SIGNALS PLAN

1/8"

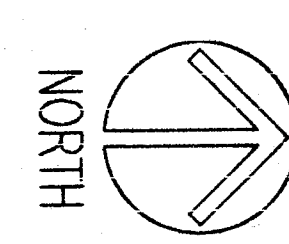
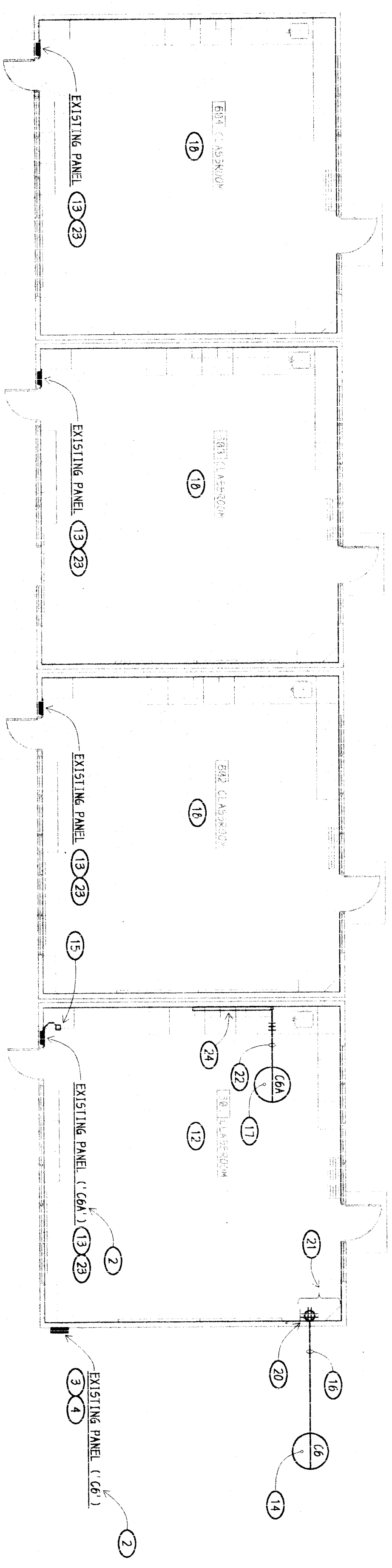

### BUILDING 600 - POWER AND SIGNALS PLAN

1/8"

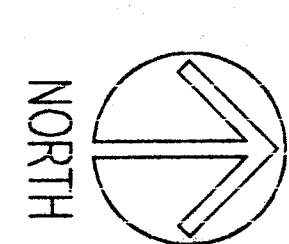
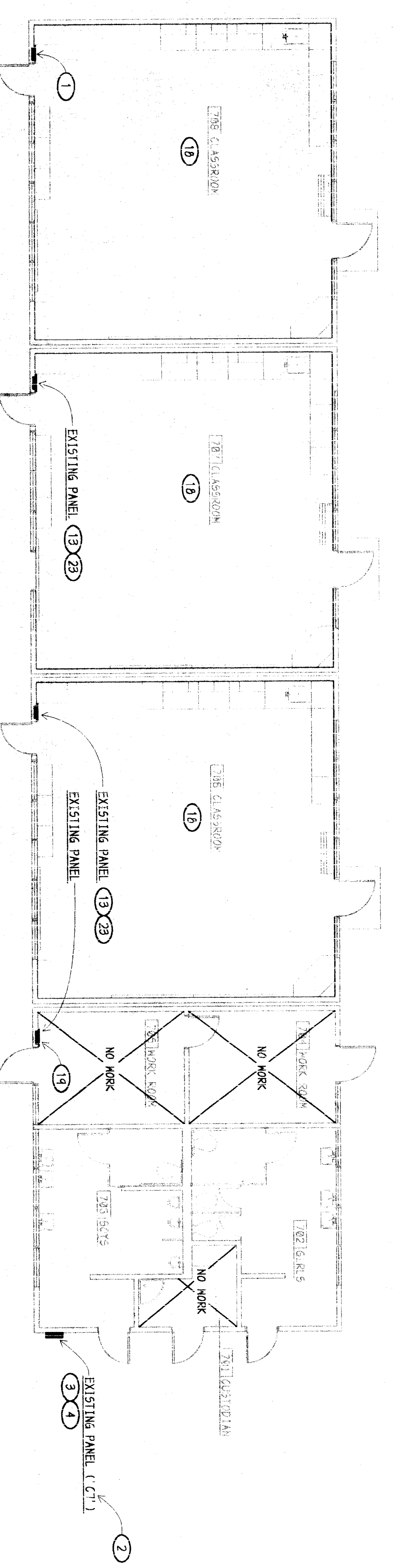

### BUILDING 700 - POWER AND SIGNALS PLAN

1/8"

**NOTES (THIS SHEET ONLY):**

- 1) EXISTING "FREE" PANELS TO REMAIN. WIRE DOWN, WADON AND BURNOUT PANEL.
- 2) THIS PANEL DESIGNATION IS ONLY FOR REFERENCE TO THESE DRAWINGS FOR CLARITY.
- 3) PANEL HAS BEEN INVESTIGATED AND HAS CAPACITY FOR NEW LOAD.
- 4) ADD NEW BREAKERS TO EXISTING CHALLENGER PANEL AS NOTED.
- 5) ADD TWO NEW 20/1 BREAKERS IN PANEL "X" WHICH AIC BATTING OF EXISTING BREAKERS. CONTRACTOR TO FIELD VERIFY.
- 6) SAME AS NOTE 5) EXCEPT ONE NEW 20/1 BREAKER.
- 7) ROUTE WIRE FROM CONCEALED OVERHEAD IN ACCESSIBLE ATTIC. NEW PENETRATION THROUGH ROOFING IS REQUIRED.
- 8) SAME AS NOTE 5) EXCEPT THREE 20/1 BREAKERS.
- 9) RUN CONDUITS CONCEALED IN COUNTER. MAKE TRANSITION TO SURFACE METAL RACEWAY PRIOR TO PENETRATING COUNTER TOP AND CONNECTING TO SURFACE BOXES.
- 10) MOUNT BOXES IN SURFACE RACEWAY BOXES AT 42". VERIFY EXACT MOUNTING HEIGHT WITH ARCHITECT PRIOR TO ROOFING.
- 11) RUN TWO 2" BETWEEN LOCATIONS CONCEALED OVERHEAD IN ACCESSIBLE ATTIC.
- 12) THIS IS THE TYPICAL LAYOUT FOR ALL CLASSROOMS.
- 13) CHECK OPERATION OF ALL BREAKERS IN PANEL. REPLACE ANY THAT ARE BROKEN OR MALFUNCTIONING.
- 14) ADD NEW 20/1 BREAKER IN PANEL AT EAST END OF BLDG.
- 15) NEW SCREWCORNER PULL CAN IN ATTIC PER DETAIL #1/EN.1.
- 16) RUN CONDUIT UP INSIDE CABINET. PENETRATE INTO ACCESSIBLE ATTIC. RUN CONCEALED IN ATTIC. THEN PENETRATE THRU EXTERIOR WALL & RUN DOWN WALL TO PANEL & CONNECT.
- 17) CONNECT TO A NEW 20/1 GFI BREAKER IN EXISTING PANEL AT NOTE 13).
- 18) SEE CLASSROOM # 611 FOR TYPICAL WORK REQUIRED FOR THIS CLASSROOM, U.O.N.
- 19) NO WORK REQUIRED.
- 20) INSTALL A NEW GROUND OUTLET IN CABINET FOR MULTI-MEDIA EQUIPMENT. VERIFY EXACT LOCATION & MOUNTING HEIGHT WITH ARCHITECT PRIOR TO ROOFING.
- 21) RELOCATE EXISTING T.V. & OUTLETS INSIDE OF CABINET. MOVE INTERCOM EQUIPMENT (HANDSET, SPEAKER, ETC.) TO SOUTH TO CLERK NEW CABINET. (SPEAKER, HANDSET, ETC.) IS REQUIRED TO BE REMOVED TO NEW LOCATIONS EQUIPMENT TO NEW LOCATIONS.
- 22) RUN CONDUIT CONCEALED OVERHEAD VIA SCREW CORNER CAN AT NOTE 15) THEN DOWN INSIDE ROOFING TO PANEL & CONNECT PER NOTE 16).
- 23) CHECK PANEL CONDITION. IF PANEL IS MISSING DOOR, PROVIDE NEW FRONT & DOOR. FIELD VERIFY.
- 24) DISCONNECT EXISTING PLUS/STRIP & REINSTALL ON WALL ABOVE COUNTER SPLASH.
- 25) 1" - ONE "X" CABLE.
- 26) 1 1/2" - TWO "X" CABLES TO TEL. BBOX. ROUTE CONCEALED OVERHEAD.
- 27) 1" - ONE "X" CABLE TO TEL. BBOX. ROUTE CONCEALED OVERHEAD.
- 28) RE-INSTALL ADMINISTRATIVE PHONE AT COUNTER. VERIFY EXACT LOCATION WITH OWNER ARCHITECT.
- 29) PROVIDE NEW TELE/POWER POLE WITH TWO TEL/DATA OUTLETS & TWO DUAL-EX RECEPTACLES EACH ON A SEPARATE CIRCUIT.
- 30) INSTALL OWNER PROVIDED NEW TEL. SWITCH AND CONNECT TO EXISTING DUKANE SYSTEM. COORDINATE REQUIREMENTS WITH DUKANE REPRESENTATIVE. PROVIDE MATERIALS AS REQUIRED.
- 31) NEW DISPLAY PHONE PER SPEC 5.
- 32) 2" C.
- 33) 2 1/2" X 2 1/2" X 8" NEW BR. SCREW COVER PULL CAN. MOUNT ON WALL AT 42" TO CENTER.
- 34) RUN ONE 2" TO RAIL CAN AT NOTE 33). CONCEALED OVERHEAD.
- 35) INSTALL EXISTING BUREAU ALARM HANGER ON WALL. VERIFY EXACT LOCATION WITH ARCHITECT PRIOR TO ROOFING. PICK-UP EXISTING B.A. CIRCUITS AND ENTER.
- 36) 2" C. STUB INTO ACCESSIBLE ATTIC SPACE ABOVE CEILING.

### KEY PLAN

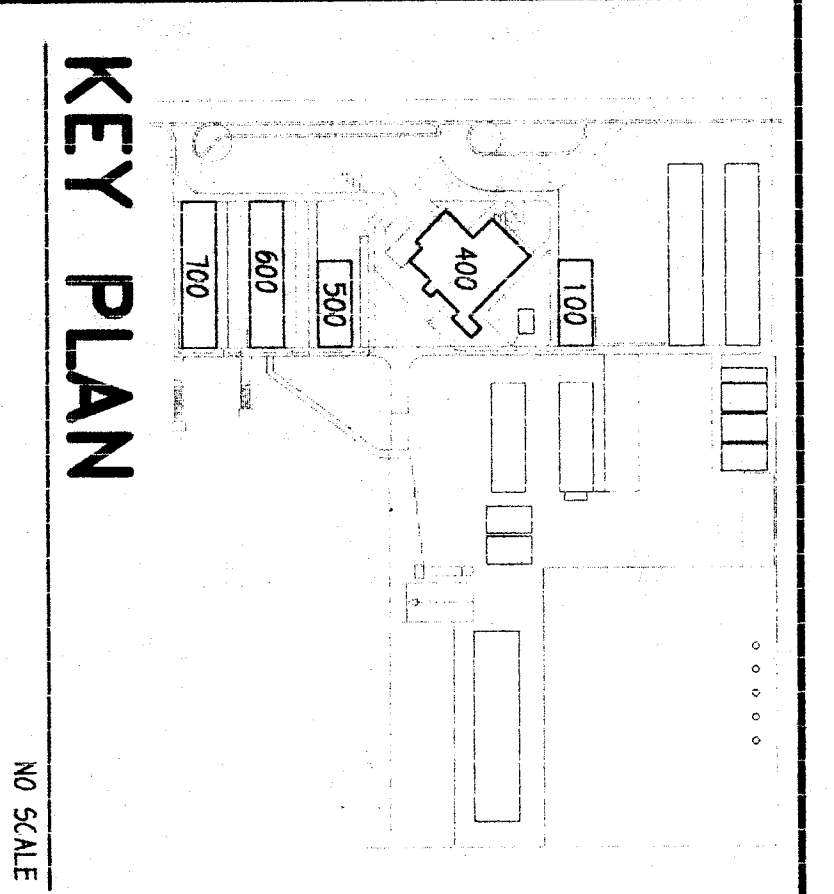

NO SCALE

**ORDIZ MELBY ARCHITECTS**  
 5620 DISTRICT BLVD., #106  
 BAKERSFIELD, CA 93313  
 TEL. (805)-832-5528  
 FAX. (805)-832-4391

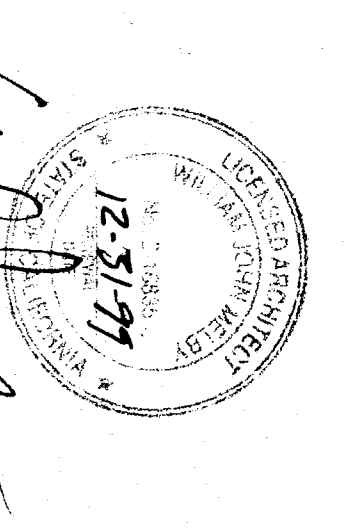

WILLIAM J. MELBY, AIA  
 ARCHITECT  
 C-14, 728  
 C-16, 835

IDENTIFICATION STAMP  
 DIV. OF STATE ARCHITECT  
 OFFICE OF REGULATIONS SERVICES  
 FILE NO. 101484  
 DATE 1-15-1999  
 MC

AS BUILT DRAWINGS  
 MODERNIZATION OF  
 COLLEGE HEIGHTS  
 ELEM. SCHOOL  
 FOR:

**BAKERSFIELD CITY SCHOOL DISTRICT**

2551 SUNNY LN.  
 BAKERSFIELD,  
 CALIFORNIA  
 93305

GENERAL AND SPECIAL ALL DIMENSIONS SHOWN PROCEEDING WITH THE WORK. REPORT DISCREPANCIES TO THE ARCHITECT

MARK	DATE	REVISION

BUILDINGS 500, 600, AND 700 - POWER AND SIGNALS PLANS

DATE 9/21/98  
 01-06-99  
 DRAWN BY RTS  
**E** SHEET 7.0

**Howell**  
 CONSULTING CONSULTING GROUP, INC.  
 Consulting Electrical Engineers  
 3400 W. 10th Street  
 Visalia, California 93281