

# LIGHTING PLANS - BUILDINGS 100 & 400

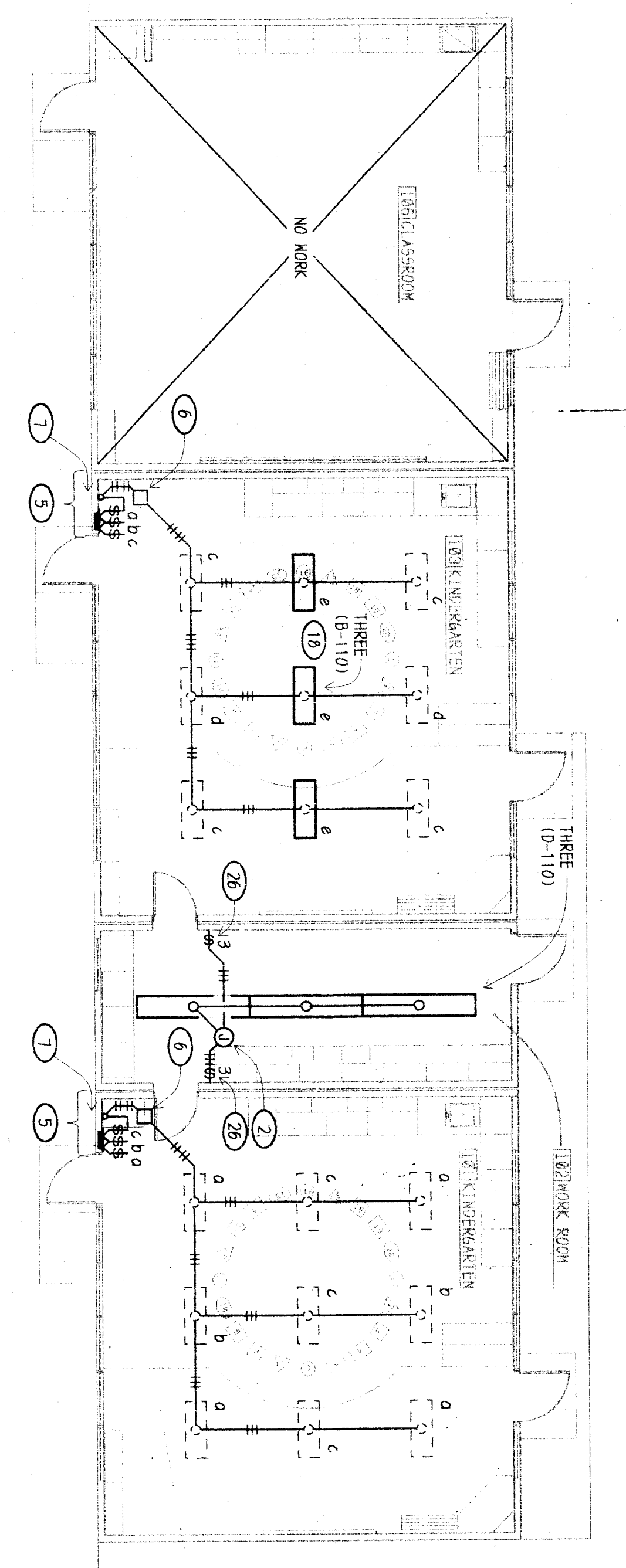

BUILDING 100



BUILDING 400

- FIXTURE SCHEDULE NOTES:**
- (1) THIS FIXTURE REPRESENTS ALL TYPE 'R' FIXTURES BOTH NEW & EXISTING (EXISTING FIXTURES HAVE BEEN DETAILLED WITH 10 LAMPS & ELECTRONIC BALLASTS) AND HAS BEEN SELECTED TO MATCH THE EXISTING FIXTURE STYLE.
  - (2) SOME FIXTURES ARE TO BE EQUIPPED WITH FACTORY INSTALLED EMERGENCY BATTERY PACKS. SEE PLANS FOR LOCATIONS.
  - (3) PROVIDE ALL COMPONENTS AS REQUIRED TO FORM COMPLETE SYSTEMS.
  - (4) PROVIDE OWNER WITH 4 SETS #1300 SERIES FILTERS, ALL COLORS.
  - (5) WHITE FINISH.

FIXTURE SCHEDULE					
TYPE	QTY	VOLT	MANUFACTURER	CATALOG NO.	NOTES
A	62	2-120V	LITHONIA	AM232-120-GB1/2	SURFACE 4' - 2' LAMP
B	110	4-120V	LITHONIA	1B432-120-GB1/4	SURFACE 4' - 4' LAMP (1)
C	84	3-120V	LITHONIA	AM232-120-GB1/3	SURFACE 4' - 3' LAMP (2)
D	110	4-120V	LITHONIA	1M-232-120-GB1/4	SURFACE 6' - 4' LAMP
E	110	4-120V	LITHONIA	AM-432-120-GB8	SURFACE 4' - 4' LAMP
F	32	1-120V	LITHONIA	10P46	SURFACE ROUND DRUM
G	220	4-120V	LITHONIA	1M432-120-GB8	SURFACE 6' - 4' LAMP (2)
H	62	2-120V	LITHONIA	005-232-120-GB8	SURFACE
J	26	4-120V	LITHONIA	AM-26011-64K-120-GB8	SURFACE
K	62	2-120V	LITHONIA	10A-132-GB8	SURFACE
L	—	—	HALO	ONE 1621, TWO 1622, ONE 1600, ONE 1421, ONE 1424, ONE 1423	SURFACE (5)
M	500	650MA	HALO	1375HP	TRACK (4)
P	110	4-120V	LITHONIA	AM432-120-GB1/4	SURFACE
Q	32	1-120V	LITHONIA	CA132-GB8-120V	SURFACE
R	5	INCL.	LITHONIA	10M-5-MR-120-ELN	SURFACE

- NOTES (THIS SHEET ONLY):**
- (1) INSTALL NEW FIXTURE IN SAME LOCATION AS OLD FIXTURE & CONNECT TO SAME SWITCH.
  - (2) PICK UP UNMOUNTED HOT LIG, NEUTRAL, & GROUND OF EXISTING LIGHTING CIRCUIT AND USE TO RECONNECT NEW LIGHTS AS SHOWN.
  - (3) SHARED FIXTURE REMOVED, FIXTURE WHICH IS TO HAVE A FACTORY-INSTALLED EMERGENCY BATTERY PACK, CONNECT PER DETAIL #3/E1.1.
  - (4) PICK UP EXISTING CIRCUIT FROM LIGHT FIXTURE, WHICH IS BEING REMOVED, EXTEND TO NEW FIXTURE AS SHOWN WITH MAINTAINING CONDUIT & WIRE.
  - (5) INSTALL NEW RACKWAY & SWITCHES IN THIS AREA BY ELECTRICAL PER DETAIL #3/E1.1 & RECONNECT AS SHOWN.
  - (6) NEW SCREEN COVER PULL CAN IN ATTIC PER DETAIL #3/E1.1, MOUNT IN AN ACCESSIBLE LOCATION.
  - (7) ROUTE WIRING THROUGH NEW RACKWAY PER DETAIL #3/E1.1.
  - (8) REMOVE EXISTING EXIT SIGN & RETURN TO OWNER, REPLACE WITH NEW EXIT SIGN CIRCUIT WITH EMERGENCY BATTERY PACK & CONNECT TO SAME EXISTING CIRCUIT.
  - (9) INSTALL THREE EXISTING ON EACH CIRCUIT. AIR & POSITION ON TRACK AS DIRECTED BY OWNER.
  - (10) CONNECT THESE 100 ROOMS OF FIXTURE ON SAME CIRCUIT.
  - (11) EXTEND EXISTING SURFACE RACKWAY TO NEW LOCATION WITH RACKWAY & WIRING TO MATCH EXISTING & CONNECT NEW EXIT SIGN.
  - (12) INTERCEPT EXISTING CIRCUIT (UNMOUNTED LEG & NEUTRAL) & EXTEND AS SHOWN TO CONNECT NEW FIXTURES.
  - (13) CUT & PATCH WALL AS REQUIRED TO INTERCEPT EXISTING LIGHTING CIRCUIT & RECONNECT AS SHOWN. INSTALL SWITCHES FLUSH IN WALL.
  - (14) CUT & PATCH WALL AS REQUIRED TO INSTALL SWITCH & CONDUIT FLUSH IN WALL.
  - (15) INTERCEPT EXISTING LIGHTING CIRCUIT WITH NEW 4-80W & EXTEND TO CONNECT NEW LIGHTS AS SHOWN.
  - (16) INSTALL NEW RACKWAY & SWITCHES PER DETAIL #3/E1.1.
  - (17) ROUTE LIGHTING CIRCUITS VIA PANEL, CONDUITS & RACKWAY AS REQUIRED. SEE DETAIL #3/E1.1 FOR ADDITIONAL INFORMATION.
  - (18) NOTE: REMOVE EXISTING FIXTURES REMOVED FROM OTHER BUILDINGS AS A PART OF RENOVATION WORK. WHEN ALL TYPE 'B' STYLE EXISTING FIXTURES HAVE BEEN USED, PROVIDE NEW TYPE 'B'.
  - (19) USE EXISTING CONDUIT TO RECONNECT LIGHTS AS SHOWN. CONTRACTOR MAY USE EXISTING WIRE IF IT IS 12 GA. & ENOUGH EXISTS AS IS NOTED. IF NOT, PULL OUT EXISTING WIRE & PULL IN NEW.
  - (20) TO SWITCHES 'd' VIA EXISTING CONDUIT & NEW RACKWAY PER DETAIL #3/E1.1.
  - (21) TO SWITCHES 'b' VIA EXISTING CONDUIT & NEW RACKWAY PER DETAIL #3/E1.1.
  - (22) TO SWITCHES 'c' VIA EXISTING CONDUIT & NEW RACKWAY PER DETAIL #3/E1.1.
  - (23) TO SWITCHES 'e, f, g' AND 'h' VIA EXISTING CONDUIT & NEW RACKWAY PER DETAIL #3/E1.1.
  - (24) INSTALL J-BOX IN POSITION WHERE FIRST TYPICAL FIXTURE WAS LOCATED. INTERCEPT CONDUIT COMING FROM PANEL & USE TO RECONNECT NEW TRACK LIGHTS AS SHOWN.
  - (25) EXISTING 3 WAY SWITCHES TO REMAIN. CONNECT TO NEW LIGHTS AS SHOWN.

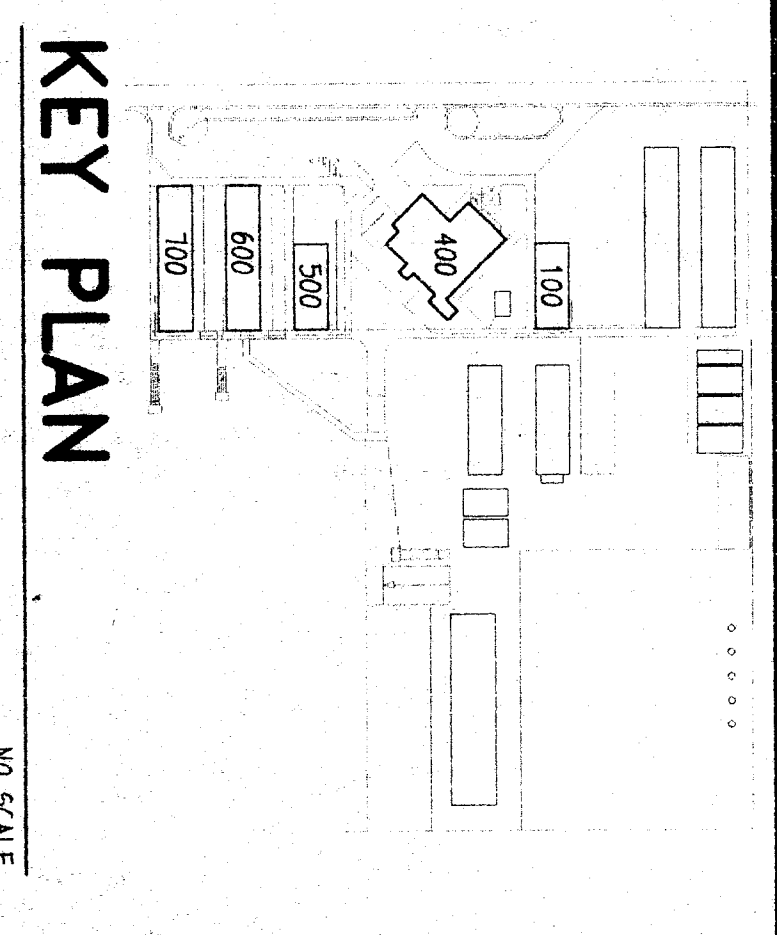

1/8"

REGISTERED PROFESSIONAL ENGINEER  
 No. 7198  
 12/26/90  
 CONSULTING ELECTRICAL ENGINEER  
 CONSULTING ELECTRICAL ENGINEER  
 918 W. Main St., Ph. 232-2871  
 Visalia, California 93291

ORDIZ MELBY ARCHITECTS  
 5620 DISTRICT BLVD., #105  
 BAKERSFIELD, CA 93313  
 TEL. (805)-832-9298  
 FAX. (805)-832-4291

BAKERSFIELD CITY SCHOOL DISTRICT  
 2551 SUNNY LN.  
 BAKERSFIELD, CALIFORNIA 93305

MODERNIZATION OF COLLEGE HEIGHTS FOR: SCHOOL

AS BUILT DRAWINGS

REGISTRATION STAMP  
 OFFICE OF REGULATORY SERVICES  
 APR. NO. 101484  
 FILE NO.  
 AC FILE # 15-1777  
 DATE 1-15-1777

DANNY E. ORDI  
 ARCHITECT  
 C-14,7250

WILLIAM J. MELBY, AIA  
 ARCHITECT  
 C-16,805

DATE 06-99

108 NUMBER 97140 SHEET 4 OF 0

LIGHTING PLANS - BUILDINGS 100 & 400

DATE REVISION

CHECK AND VERIFY ALL DIMENSIONS BEFORE PROCEEDING WITH THE WORK. DISCREPANCIES TO THE ARCHITECT.