

**KEY NOTES**  
THIS SHEET ONLY

- (E)P1C01 EXISTING PLASTER CEILING TO REMAIN NO WORK AT THIS LOCATION.
- (E)P1C02 EXISTING PLASTER CEILING TO REMAIN REPAIR/REPLACE ANY DAMAGED AREA AS REQUIRED. PREP SURFACE-PAINT.
- (E)P1C03 EXISTING ACOUSTIC TILE CEILING TO REMAIN. REPLACE BROKEN/DAMAGED TILE--PREP SURFACE-PAINT.
- (E)P1C04 EXISTING PLYWOOD CEILING TO REMAIN. REPLACE ANY DAMAGED PANELS. PREP SURFACE-PAINT.
- (E)P1C05 PAINT EXISTING CEILING FINISH AS REQUIRED PER PLAN (SEE DEMO PLAN)--PREP & PAINT WALLS (SEE DEMO PLAN)--PREP & PAINT
- (E)P1W0 (E) 3/8" PLYWOOD SCOFF OVERHANGING TO REMAIN. REPLACE ANY DAMAGED PANELS. PREP SURFACE-PAINT.
- (N)D1G01 REMOVE/INSTALL 12"x12" ACOUSTIC TILE (W/NO DAMAGED WERE W/LS) SEE DEMO
- (N)D1G02 PROVIDE/INSTALL NEW 1/2" GYP BOARD W/ 1/8" PLASTER VENER OVER 2x8 @ 18" O.C.
- (N)D1G03 REMOVE/INSTALL NEW 6"X6" @ 18"x18" ACOUSTIC TILE ON (E) 1/4" PLYWOOD. PROVIDE/INSTALL NEW LIGHT FIXTURES--SEE ELECTRICAL PLANS
- (N)LITE PROVIDE/INSTALL NEW LIGHT FIXTURES--SEE ELECTRICAL PLANS

**ORDIZ MELBY ARCHITECTS INC.**  
5620 DISTRICT BLVD. #105  
BAKERSFIELD, CA 93313  
TEL. (805) 832-5566  
FAX. (805) 832-4291

**REGISTERED ARCHITECT**  
No. C-4243  
EXPIRES 12/31/2009  
STATE OF CALIFORNIA

DANNY E. BRDIZ A.I.A.  
ARCHITECT  
C-14,728

WILLIAM J. MELBY A.I.A.  
ARCHITECT  
C-16,595

INDICATION STAMP  
OF STATE ARCHITECT  
OFFICE OF REGULATIONS SERVICES

APR 11 101484  
A.C. F.L. M.K.  
DATE 1/15-1777

AS BUILT DRAWINGS  
MODERNIZATION OF  
COLLEGE HEIGHTS  
ELEM. SCHOOL  
FOR:

**BAKERSFIELD CITY SCHOOL DISTRICT**

2551 SUNNY LN.  
BAKERSFIELD,  
CALIFORNIA  
93305

**KEY MAP** NO SCALE  
CHECK AND VERIFY ALL DIMENSIONS BEFORE PROCEEDING WITH THE WORK. REPORT DISCREPANCIES TO THE ARCHITECT.

MARK DATE REVISION

REFLECTED CEILING PLANS - UNITS 100, 500, 600

JOB NUMBER 500, 600

DATE 07/14/09  
DRAWN BY M.K.B.

**3.2**  
SHEET or 20

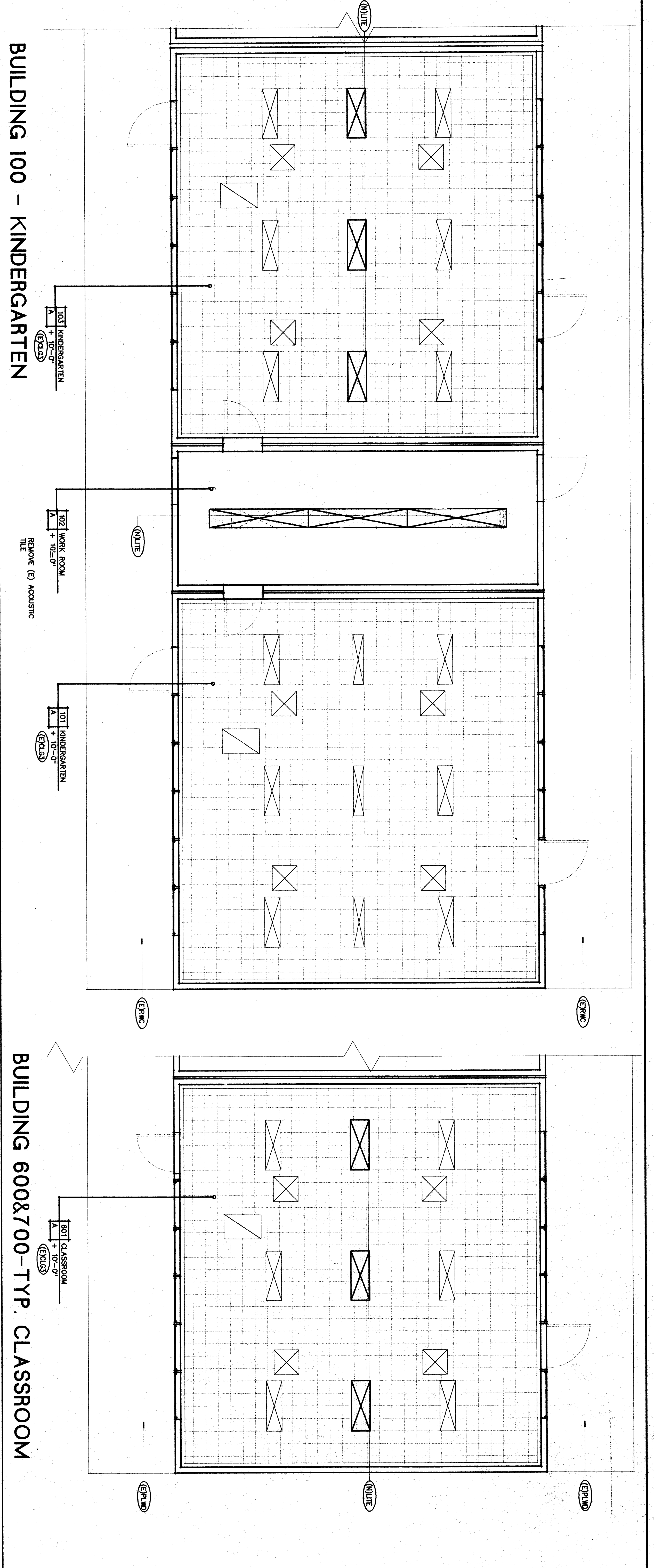

**BUILDING 600&700-TYP. CLASSROOM**

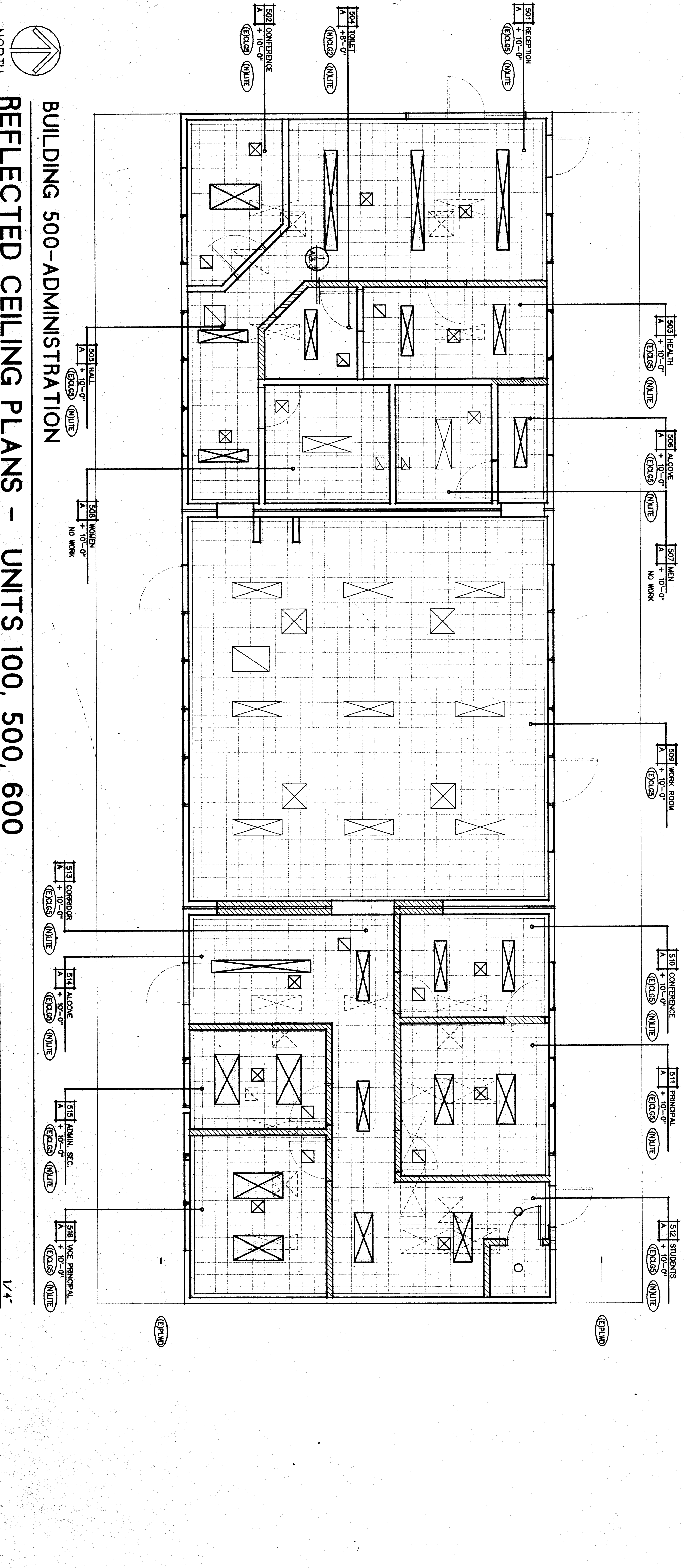

**BUILDING 500-ADMINISTRATION**

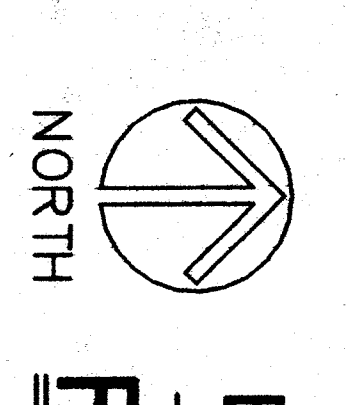

**REFLECTED CEILING PLANS - UNITS 100, 500, 600**

**LEGEND**

- ☒ SURFACE MOUNTED LIGHT FIXTURE SEE ELECTRICAL
- ☒ (E) SURFACE MOUNTED LIGHT FIXTURE TO REMAIN SEE ELECTRICAL
- ☒ (E) LIGHT FIXTURE TO BE REMOVED SEE ELECTRICAL
- ☒ 12" x 12" ACOUSTIC CEILING
- ☒ 12" x 12" ACOUSTIC CEILING
- ☒ VENER PLASTER
- ☒ EXTERIOR PLYWOOD SCOFF--PAINT
- ☒ SUPPLY AIR GRILL--SEE MECHANICAL
- ☒ RETURN AIR GRILL--SEE MECHANICAL
- ☒ EXHAUST FAN--SEE MECHANICAL
- ☒ ROOM NUMBER
- ☒ ROOM NAME
- ☒ FINISHED CEILING HEIGHT