

SHALIMAR DRIVE

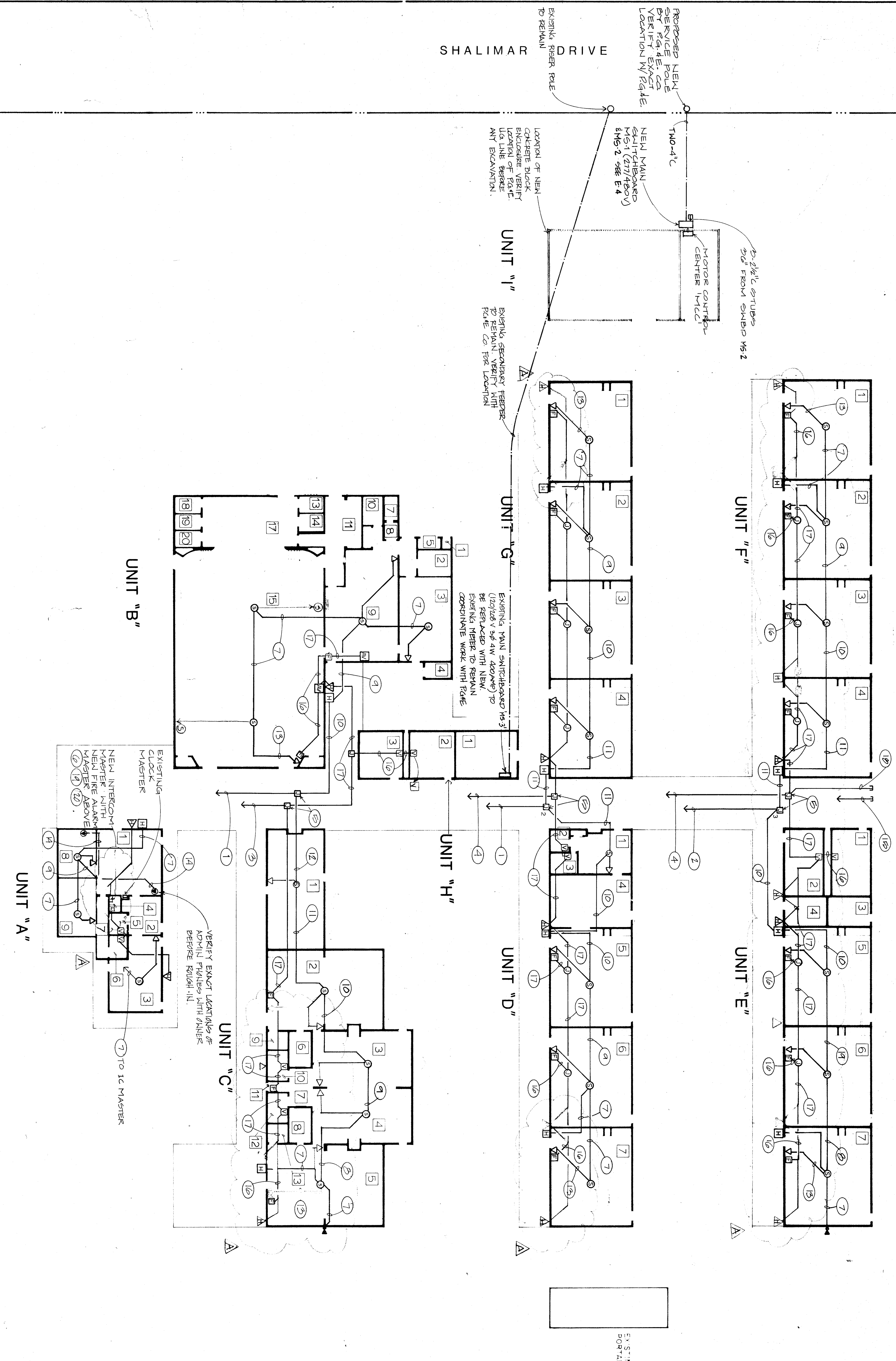

PARTIAL SITE ELECTRICAL PLAN

SCALE: 1/16"=1'-0"

PIONEER DRIVE

**UTILITY Co. REQUIREMENTS**  
 VERIFY AND COMPLY WITH ALL UTILITY COMPANY REQUIREMENTS BEFORE BIDDING JOB AND BEFORE CONSTRUCTION.  
 POWER CO. \_\_\_\_\_ PH: (805) 291-1945  
 WATER CO. \_\_\_\_\_ PH: \_\_\_\_\_  
 GAS CO. \_\_\_\_\_ PH: \_\_\_\_\_

- SITE PLAN NOTES:**
- 1 1/4" C - 10 I.C. CABLES
  - 2 1 1/4" C - 9 I.C. CABLES
  - 3 1" C - 10 #14 (F.A.), SEE F.A. LINE DIAGRAM (DETAIL 6/89) FOR WIRING AND ZONE REQUIREMENTS.
  - 4 1" C - 12 #14 (F.A.) SEE DETAIL 6/89 FOR WIRING REQUIREMENTS.
  - 5 PROVIDE 18" X 18" X 8" W.P. FULL CAN ON TOP OF WALK COVER. PROVIDE INTERCONNECTION BETWEEN EXISTING CLOCK MASTER AND NEW INTERCON MASTER. RUN 1/2" C - 8 #14 BETWEEN MASTERS.
  - 6 1/2" C - 1 I.C. CABLE
  - 7 1/2" C - 2 I.C. CABLES
  - 8 3/4" C - 3 I.C. CABLES
  - 9 3/4" C - 4 I.C. CABLES
  - 10 3/4" C - 5 I.C. CABLES
  - 11 1" C - 6 I.C. CABLES
  - 12 1/2" C - 1 I.C. CABLE. TYPICAL TO EACH I.C. HANDBOX UNIT.
  - 13 1/2" C - 1 I.C. CABLE FROM ADMINISTRATIVE PHONE TO I.C. MASTER EQUIPMENT.
  - 14 1" C STUB TO EDGE OF WALK COVER FROM INTERCON MASTER.
  - 15 1/2" C - 4 #14
  - 16 1/2" C - 4 #14
  - 17 3/4" C - 8 #14
  - 18 1" C STUB TO EDGE OF WALK COVER.
  - 19 PROVIDE 12W TO NEW F.A. MASTER FROM SHED 75'. SEE LINE DIAGRAM 4/24. VERIFY FOOTING WITH OWNER.
  - 20 VERIFY EXACT LOCATIONS OF NEW INTERCON AND FUSE ALARM MASTER EQUIPMENT WITH OWNER BEFORE ROUGHING IN ANY WORK.

<p><b>ROBERT F. STUHLER ARCHITECT INC.</b>        3121 CALIFORNIA AVE.        BAKERSFIELD CA        (805) 327-1632</p>	<p>ROBERT F. STUHLER AIA C-1610        WILLIAM J. MELBY AIA C-18635        DANNEY ORDOZ AIA C-14728</p>	<p><b>CONSULTING ENGINEERING, INC.</b>        Consulting Electrical Engineer        518 N. California Street        Bakersfield, California 93301        Phone: (805) 327-1632</p>	<p><b>SITE ELECTRICAL PLAN</b></p> <p><b>PIONEER DRIVE MODERNIZATION</b>        BAKERSFIELD CITY SCHOOL DISTRICT        BAKERSFIELD, KERN COUNTY, CALIFORNIA</p>	<p><b>'As Built's'</b></p>	<p>DATE: 5/14/89        DRAWN: [Signature]        CHECKED: [Signature]</p>	<p>MARK DATE: [Blank]        BY: [Blank]        IN: [Blank]</p>	<p>DATE: [Blank]        CHECKED: [Blank]        OF 5 SHEETS</p>
--	---	--	--	----------------------------	--	---	---