

SHEET SCHEDULE
ROOSEVELT SCHOOL RECONSTRUCTION OF ENTRY WALKS & RAMPS
A/01 EXISTING SITE TOPO & DEMOLITION PLAN
A/11 PARTIAL SITE PLAN
A/21 DETAIL PLAN
A/31 DETAILS
A/32 DETAILS

CARL G. ELLIOTT
ARCHITECT NCARB CERTIFIED

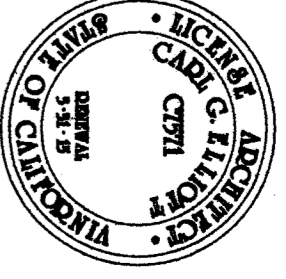

5118 Bourdett Court
Bakersfield, California 93308
Tel: 801.922.1089 Fax: 801.922.1089

Project:
**BAKERSFIELD
CITY SCHOOL DISTRICT**

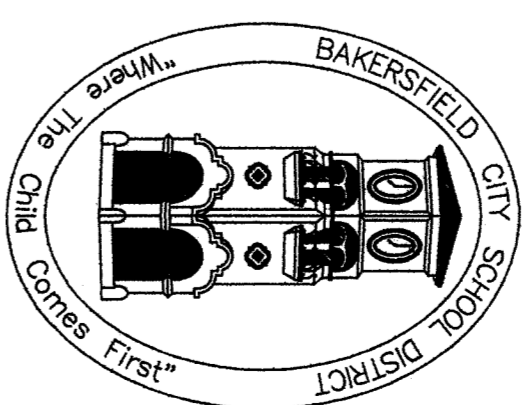

**RECONSTRUCTION of
ENTRY WALKS & RAMPS**
ROOSEVELT SCHOOL
2324 Verde Street
Bakersfield, California

DRAWING SPECIFICATIONS AND DETAILS (L) ARE CONTROLLED BY THE ARCHITECT. NO PART MAY BE COPIED, USED OR REPRODUCED IN ANY MANNER WITHOUT THE WRITTEN CONSENT OF THE ARCHITECT. FURTHER, THE ARCHITECT ASSUMES NO LIABILITY FOR THE ACCURACY OF THE INFORMATION PROVIDED HEREIN.

BEFORE VARIATIONS OR DISCREPANCIES OF CONDITIONS SHOWN ON DRAWINGS, REVISED SHOP DRAWINGS MUST BE SUBMITTED AND APPROVED BY THE ARCHITECT IN WRITING BEFORE PROCEEDING WITH CONSTRUCTION.

Date	Approved
Date	Checked for
07/15/15	ISSUING
Date	Prepared

Sheet Title
**EXISTING SITE TOPO &
DEMOLITION PLAN**

Approved / Architect Date: 07/07/15
Checked: Drawn By: Job No. 15-215

Sheet Number

A/01

OF FIVE Sheets

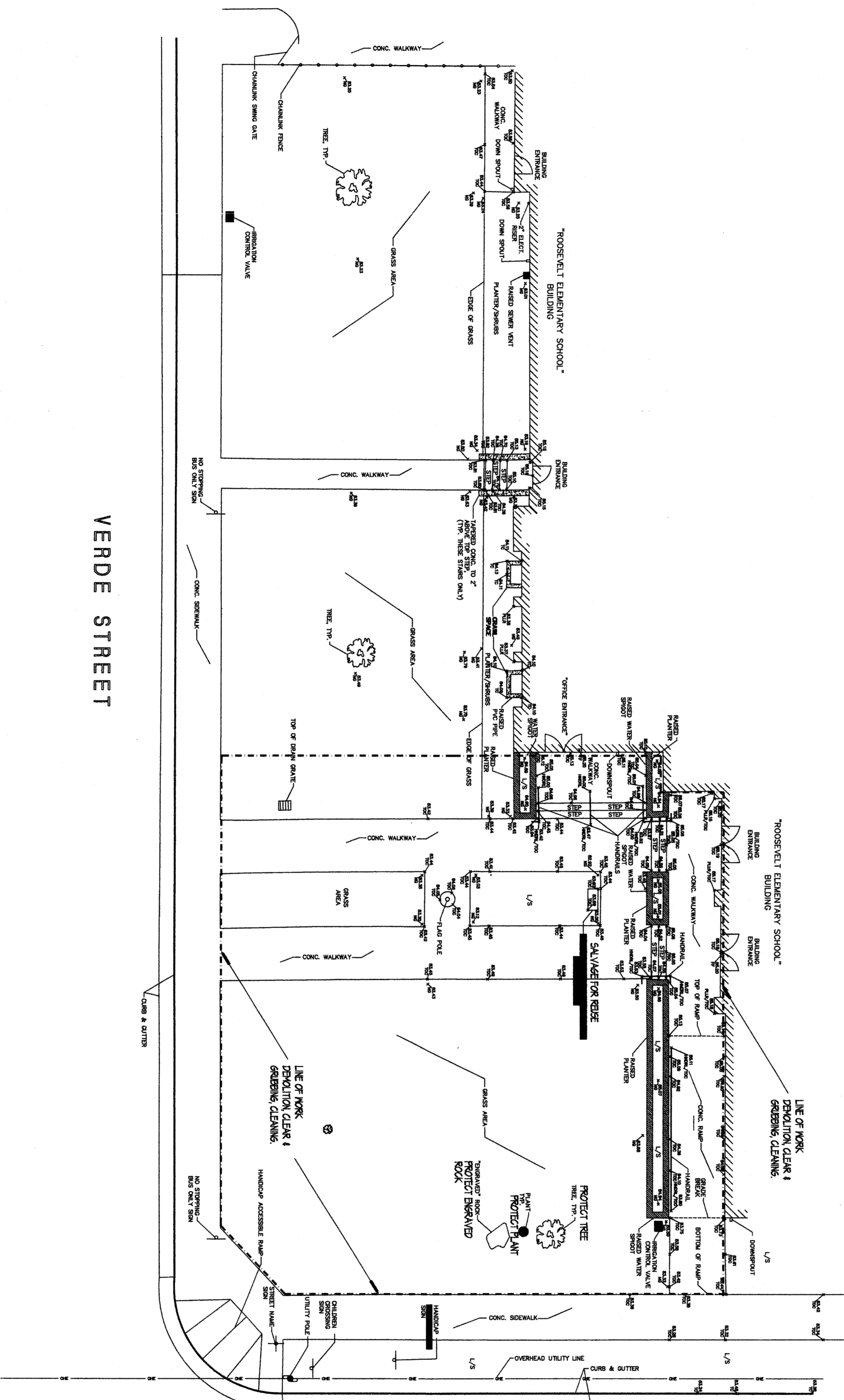

HOLTBY ROAD

ROOSEVELT SCHOOL - EXISTING SITE TOPO & DEMOLITION PLAN
RECONSTRUCTION OF ENTRY WALKS AND RAMPS

DISCLAIMER STATEMENT AND WORK COPYRIGHT:
Any product generated by Porter & Associates, Inc. and provided in an electronic format is a courtesy to you, the intended recipient. The delivery of the electronic file does not constitute an offer of insurance, or any other financial product. Porter & Associates, Inc. is not an insurance agent and does not provide any insurance or other financial products. The recipient of any product generated by Porter & Associates, Inc. is responsible for verifying the accuracy and completeness of the information provided. The recipient of any product generated by Porter & Associates, Inc. is not to be held liable for any loss or damage resulting from the use of the information provided. Porter & Associates, Inc. is not responsible for any loss or damage resulting from the use of the information provided. Porter & Associates, Inc. is not responsible for any loss or damage resulting from the use of the information provided.