

LEGEND

NEW BUILDINGS MAY HAVE BEEN ADDED TO THIS SITE. SEE NEW SITES/NEW BUILDING TAB.

SISC

SAFETY & LOSS CONTROL

INSPECTION DATE: 02/27 - 03/29/2001
 DRAWING NUMBER: 030COV

AHERA COMPLIANCE PROGRAM

060027-030
 BAKERSFIELD CITY SCHOOL DISTRICT
 PIONEER DRIVE SCHOOL
 SITE MAP

SISC - AHERA COMPLIANCE PROGRAM

County: **KERN**
Project #: **060027 - BAKERSFIELD CITY SCHOOL DISTRICT**
Campus #: **030 - PIONEER DRIVE SCHOOL**
Building #: **001 - OFFICES**
Inspection Dates: **02/27/2001 To 03/29/2001**

Inspected by: **HAL GOUNDER**
Certification#: **3023**
State: **CA**
Gross Square Ft: **0**

INSPECTION RESULTS UNIFIED SAMPLING AREA - 001

Material Category: **MISCELLANEOUS** Location: **MAIN OFFICE/RR/HEALTH/WORKROOM** Material Description: **ACOUSTICAL TILE (1X1)**

Damage Category: **N/A** Reason for Damage Category: Potential for Disturbance:

Sample#	% Asb	Date	Inspector	Sample#	% Asb	Date	Inspector
8582	0	12/20/1995	CTL ENVIRONMENTAL	8584	0	12/20/1995	CTL ENVIRONMENTAL

Asbestos: **N** Friable: **N/A** ACM Status: **No Suspect Material**

MATERIAL QUANTITIES

1,000 SQ FEET

MANAGEMENT PLAN RECOMMENDATION

Recommended Response Action: Priority: Preventative Measures:

Action Election:

Response Action Schedule

Start Date Completion Date

Inspector's Comments:

SISG - AHERA COMPLIANCE PROGRAM

County: **KERN**
 Project #: **060027 - BAKERSFIELD CITY SCHOOL DISTRICT**
 Campus #: **030 - PIONEER DRIVE SCHOOL**
 Building #: **001 - OFFICES**
 Inspection Dates: **02/27/2001 To 03/29/2001**

Inspected by: **HAL GOUNDER**
 Certification#: **3023**
 State: **CA**
 Gross Square Ft: **0**

INSPECTION RESULTS UNIFIED SAMPLING AREA - 002

Material Category: **MISCELLANEOUS** Location: **THROUGHOUT** Material Description: **VINYL FLOOR TILE**

Damage Category: **ACBM WITH POTENTIAL FOR DAMAGE** Reason for Damage Category: **MATERIAL IN GOOD CONDITION** Potential for Disturbance: **SLIGHT**

Sample#	% Asb	Date	Inspector	Sample#	% Asb	Date	Inspector
8580	2	12/20/1988	CTL ENVIRONMENTAL				

Asbestos: **Y** Friable: **N** ACM Status: **Non-Friable ACBM**

MATERIAL QUANTITIES

1,800 SQ FEET

MANAGEMENT PLAN RECOMMENDATION

Recommended Response Action: **O&M MAINTAIN AND MONITOR** Priority: **3** Preventative Measures: **USED W/MISC. & CEMENTITIOUS MATERIAL INCL. VAFT, TRANSITE, TILE UNDERLAY & SCRATCH COATS**

Action Election: _____ Response Action Schedule

	-----	-----
	Start Date	Completion Date
	=====	=====

Inspector's Comments: **CARPET OVER OFF WHITE 1 X 1 TILE**

SISO - AHERA COMPLIANCE PROGRAM

County: **KERN**
Project #: **060027 - BAKERSFIELD CITY SCHOOL DISTRICT**
Campus #: **030 - PIONEER DRIVE SCHOOL**
Building #: **001 - OFFICES**
Inspection Dates: **02/27/2001 To 03/29/2001**

Inspected by: **HAL GOUNDER**
Certification#: **3023**
State: **CA**
Gross Square Ft: **0**

INSPECTION RESULTS UNIFIED SAMPLING AREA 003

Material Category: **MISCELLANEOUS** Location: **HEALTH OFFICE RESTROOM** Material Description: **LINOLEUM**

Damage Category: **ACBM WITH POTENTIAL FOR DAMAGE** Reason for Damage Category: **MATERIAL IN GOOD CONDITION** Potential for Disturbance: **SLIGHT**

Sample#	% Asb	Date	Inspector	Sample#	% Asb	Date	Inspector
8575	15	12/20/1988	CTL ENVIRONMENTAL				

Asbestos: **Y** Friable: **N** ACM Status: **Non-Friable ACBM**

MATERIAL QUANTITIES

80 SQ FEET

MANAGEMENT PLAN RECOMMENDATION

Recommended Response Action: **O&M MAINTAIN AND MONITOR** Priority: **3** Preventative Measures: **USED W/MISC. & CEMENTITIOUS MATERIAL INCL. VAFT, TRANSITE, TILE UNDERLAY & SCRATCH COATS**

Action Election: _____ Response Action Schedule

Start Date	Completion Date
=====	=====

Inspector's Comments: _____

SIS - AHERA COMPLIANCE PROGRAM

County: **KERN**
Project #: **060027 - BAKERSFIELD CITY SCHOOL DISTRICT**
Campus #: **030 - PIONEER DRIVE SCHOOL**
Building #: **001 - OFFICES**
Inspection Dates: **02/27/2001 To 03/29/2001**

Inspected by: **HAL GOUNDER**
Certification#: **3023**
State: **CA**
Gross Square Ft: **0**

INSPECTION RESULTS UNIFIED SAMPLING AREA 004

Material Category: **MISCELLANEOUS** Location: **ON FLOOR UNDER TILE** Material Description: **MASTIC**

Damage Category: **ACBM WITH POTENTIAL FOR DAMAGE** Reason for Damage Category: **MATERIAL IN GOOD CONDITION** Potential for Disturbance: **SLIGHT**

Sample#	% Asb	Date	Inspector	Sample#	% Asb	Date	Inspector
=====	=====	=====	=====	=====	=====	=====	=====
ASSUMED		08/07/1995	JAY OLSEN				

Asbestos: **Y** Friable: **N** ACM Status: **Non-Friable ACBM**

MATERIAL QUANTITIES

MANAGEMENT PLAN RECOMMENDATION

Recommended Response Action: **O&M MAINTAIN AND MONITOR** Priority: **3** Preventative Measures: **USED W/MISC. & CEMENTITIOUS MATERIAL INCL. VAFT, TRANSITE, TILE UNDERLAY & SCRATCH COATS**

Action Election: _____ Response Action Schedule

Start Date	Completion Date
=====	=====

Inspector's Comments: **MATERIAL SHOULD BE SAMPLED PRIOR TO ABATEMENT TO VERIFY ASBESTOS CONTENT.**

SISC - AHERA COMPLIANCE PROGRAM

County: **KERN**
Project #: **060027 - BAKERSFIELD CITY SCHOOL DISTRICT**
Campus #: **030 - PIONEER DRIVE SCHOOL**
Building #: **001 - OFFICES**
Inspection Dates: **02/27/2001 To 03/29/2001**

Inspected by: **HAL GOUNDER**
Certification#: **3023**
State: **CA**
Gross Square Ft: **0**

***** INSPECTION RESULTS UNIFIED SAMPLING AREA - 005 *****

Material Category: **MISCELLANEOUS** Location: **PRINCIPAL'S OFFICE/HALLWAY/DEAN'S OFFICE** Material Description: **DROP OR LAY-IN PANEL**

Damage Category: **N/A** Reason for Damage Category: Potential for Disturbance:

Sample#	% Asb	Date	Inspector	Sample#	% Asb	Date	Inspector
8574	0	12/20/1988	CTL ENVIRONMENTAL				

Asbestos: **N** Friable: **N/A** ACM Status: **No Suspect Material**

MATERIAL QUANTITIES

800 SQ FEET

MANAGEMENT PLAN RECOMMENDATION

Recommended Response Action: Priority: Preventative Measures:

Action Election:

Response Action Schedule

Start Date Completion Date

Inspector's Comments:

SISC - AHERA COMPLIANCE PROGRAM

County: **KERN**
Project #: **060027 - BAKERSFIELD CITY SCHOOL DISTRICT**
Campus #: **030 - PIONEER DRIVE SCHOOL**
Building #: **001 - OFFICES**
Inspection Dates: **02/27/2001 To 03/29/2001**

Inspected by: **HAL GOUNDER**
Certification#: **3023**
State: **CA**
Gross Square Ft: **0**

INSPECTION RESULTS UNIFIED SAMPLING AREA - 006

Material Category: **MISCELLANEOUS** Location: **THROUGHOUT** Material Description: **DRYWALL**

Damage Category: **N/A** Reason for Damage Category: Potential for Disturbance:

Sample#	% Asb	Date	Inspector	Sample#	% Asb	Date	Inspector
8576	0	12/20/1988	CTL ENVIRONMENTAL				

Asbestos: **N** Friable: **N/A** ACM Status: **No Suspect Material**

MATERIAL QUANTITIES

MANAGEMENT PLAN RECOMMENDATION

Recommended Response Action: Priority: Preventative Measures:

Action Election:

Response Action Schedule

Start Date Completion Date

Inspector's Comments:

WALLS THROUGHOUT

SISC - AHERA COMPLIANCE PROGRAM

County: KERN
Project #: 060027 - BAKERSFIELD CITY SCHOOL DISTRICT
Campus #: 030 - PIONEER DRIVE SCHOOL
Building #: 001 - OFFICES
Inspection Dates: 02/27/2001 To 03/29/2001

Inspected by: HAL GOUNDER
Certification#: 3023
State: CA
Gross Square Ft: 0

INSPECTION RESULTS UNIFIED SAMPLING AREA - 007

Material Category: SURFACING MATERIALS Location: THROUGHOUT Material Description: HARDWALL/CEILING PLASTER

Damage Category: N/A Reason for Damage Category: Potential for Disturbance:

Sample#	% Asb	Date	Inspector	Sample#	% Asb	Date	Inspector
8583	0	12/20/1988	CTL ENVIRONMENTAL				

Asbestos: N Friable: N/A ACM Status: No Suspect Material

MATERIAL QUANTITIES

3,300 SQ FEET

MANAGEMENT PLAN RECOMMENDATION

Recommended Response Action: Priority: Preventative Measures:

Action Election:

Response Action Schedule

Start Date Completion Date

Inspector's Comments:

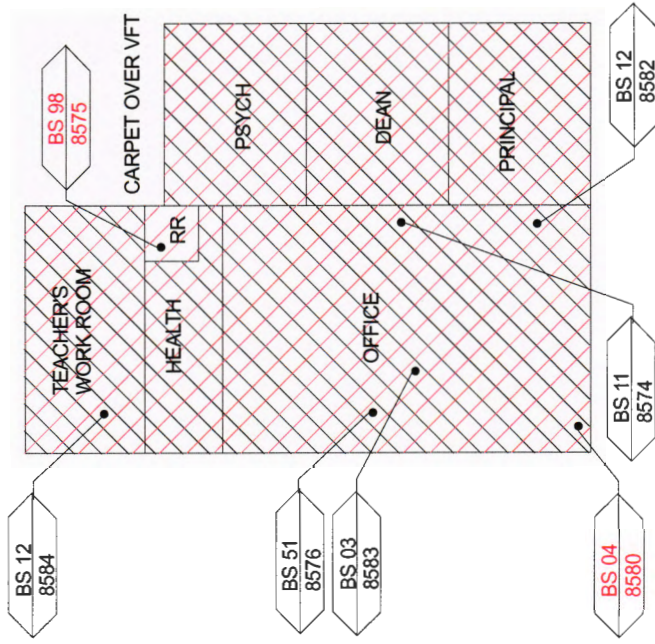

LEGEND

NON-ASBESTOS VINYL FLOOR TILE

NON-ASBESTOS CEILING TILES

NON-ASBESTOS SPRAY / TROWEL APPLIED MATERIAL

ASBESTOS CONTAINING VINYL FLOOR TILE

ASBESTOS CONTAINING CEILING TILES

ASBESTOS CONTAINING SPRAY / TROWEL APPLIED MATERIAL

SISC

SAFETY & LOSS CONTROL

INSPECTION DATE
02/27 - 03/29/2001

DRAWING NUMBER
030001

AHERA COMPLIANCE PROGRAM

060027-030-001
BAKERSFIELD CITY SCHOOL DISTRICT
PIONEER DRIVE SCHOOL OFFICES

SISC - AHERA COMPLIANCE PROGRAM

County: **KERN**
Project #: **060027 - BAKERSFIELD CITY SCHOOL DISTRICT**
Campus #: **030 - PIONEER DRIVE SCHOOL**
Building #: **002 - MULTIPURPOSE ROOM**
Inspection Dates: **02/27/2001 To 03/29/2001**

Inspected by: **HAL GOUNDER**
Certification#: **3023**
State: **CA**
Gross Square Ft: **0**

***** INSPECTION RESULTS UNIFIED SAMPLING AREA - 001 *****

Material Category: **SURFACING MATERIALS** Location: **CAFETERIA ROOM** Material Description: **ACOUSTICAL PLASTER**

Damage Category: **ACBM WITH POTENTIAL FOR DAMAGE** Reason for Damage Category: **MATERIAL IN GOOD CONDITION** Potential for Disturbance: **MODERATE**

Sample#	% Asb	Date	Inspector	Sample#	% Asb	Date	Inspector
8587	12	12/20/1995	CTL ENVIRONMENTAL				

Asbestos: **Y** Friable: **N** ACM Status: **Non-Friable ACBM**

MATERIAL QUANTITIES

3,600 SQ FEET

MANAGEMENT PLAN RECOMMENDATION

Recommended Response Action: **O&M MAINTAIN AND MONITOR** Priority: **3** Preventative Measures: **USED WMISC. & CEMENTITIOUS MATERIAL INCL. VAFT, TRANSITE, TILE UNDERLAY & SCRATCH COATS**

Action Election: _____ Response Action Schedule

Start Date	Completion Date
=====	=====

Inspector's Comments: _____

SISC - AHERA COMPLIANCE PROGRAM

County: **KERN**
Project #: **060027 - BAKERSFIELD CITY SCHOOL DISTRICT**
Campus #: **030 - PIONEER DRIVE SCHOOL**
Building #: **002 - MULTIPURPOSE ROOM**
Inspection Dates: **02/27/2001 To 03/29/2001**

Inspected by: **HAL GOUNDER**
Certification#: **3023**
State: **CA**
Gross Square Ft: **0**

INSPECTION RESULTS UNIFIED SAMPLING AREA - 002

Material Category: **SURFACING MATERIALS** Location: **KITCHEN HALLWAY/REFRIDGERATOR AREA** Material Description: **HARDWALL/CEILING PLASTER**

Damage Category: **N/A** Reason for Damage Category: Potential for Disturbance:

Sample#	% Asb	Date	Inspector	Sample#	% Asb	Date	Inspector
8560	0	12/20/1995	JAY OLSEN				

Asbestos: **N** Friable: **N/A** ACM Status: **No Suspect Material**

MATERIAL QUANTITIES

MANAGEMENT PLAN RECOMMENDATION

Recommended Response Action: Priority: Preventative Measures:

Action Election:

Response Action Schedule

Start Date Completion Date

Inspector's Comments:

SISC - AHERA COMPLIANCE PROGRAM

County: KERN
Project #: 060027 - BAKERSFIELD CITY SCHOOL DISTRICT
Campus #: 030 - PIONEER DRIVE SCHOOL
Building #: 002 - MULTIPURPOSE ROOM
Inspection Dates: 02/27/2001 To 03/29/2001

Inspected by: HAL GOUNDER
Certification#: 3023
State: CA
Gross Square Ft: 0

INSPECTION RESULTS UNIFIED SAMPLING AREA - 003

Material Category: MISCELLANEOUS
Location: ON FLOOR UNDER TILE
Material Description: MASTIC

Damage Category: ACBM WITH POTENTIAL FOR DAMAGE
Reason for Damage Category: MATERIAL IN GOOD CONDITION
Potential for Disturbance: SLIGHT

Sample#	% Asb	Date	Inspector	Sample#	% Asb	Date	Inspector
ASSUMED		08/07/1995	JAY OLSEN				

Asbestos: Y Friable: N ACM Status: Non-Friable ACBM

MATERIAL QUANTITIES

16 SQUARE FEET

MANAGEMENT PLAN RECOMMENDATION

Recommended Response Action: O&M MAINTAIN AND MONITOR
Priority: 3
Preventative Measures: USED W/MISC. & CEMENTITIOUS MATERIAL INCL. VAFT, TRANSITE, TILE UNDERLAY & SCRATCH COATS

Action Election: _____
Response Action Schedule
Start Date _____ Completion Date _____
Inspector's Comments: _____

MATERIAL SHOULD BE SAMPLED PRIOR TO ABATEMENT TO VERIFY ASBESTOS CONTENT. UNDER AIR DUCT INSIDE CLOSET. SEE MAP FOR LOCATION.

SISC - AHERA COMPLIANCE PROGRAM

County: **KERN**
Project #: **060027 - BAKERSFIELD CITY SCHOOL DISTRICT**
Campus #: **030 - PIONEER DRIVE SCHOOL**
Building #: **002 - MULTIPURPOSE ROOM**
Inspection Dates: **06/15/2001 To 06/15/2001**

Inspected by: **HAL GOUNDER**
Certification#: **3023**
State: **CA**
Gross Square Ft: **0**

INSPECTION RESULTS UNIFIED SAMPLING AREA - 004

Material Category: **MISCELLANEOUS** Location: **INSIDE CLOSET, SEE MAP** Material Description: **VINYL FLOOR TILE**

Damage Category: **ACBM WITH POTENTIAL FOR DAMAGE** Reason for Damage Category: **MATERIAL IN GOOD CONDITION** Potential for Disturbance: **SLIGHT**

Sample#	% Asb	Date	Inspector	Sample#	% Asb	Date	Inspector
ASSUMED		06/05/2001	HAL GOUNDER				

Asbestos: **Y** Friable: **N** ACM Status: **Non-Friable Assumed**

MATERIAL QUANTITIES

MANAGEMENT PLAN RECOMMENDATION

Recommended Response Action: **O&M MAINTAIN AND MONITOR** Priority: **3** Preventative Measures: **USED W/MISC. & CEMENTITIOUS MATERIAL INCL. VAFT, TRANSITE, TILE UNDERLAY & SCRATCH COATS**

Action Election: _____ Response Action Schedule

Start Date	Completion Date
=====	=====

Inspector's Comments: **9 X 9 TILE UNDER AIR DUCT INSIDE CLOSET. SEE MAP FOR LOCATION.**

SISC - AHERA COMPLIANCE PROGRAM

County: **KERN**
Project #: **060027 - BAKERSFIELD CITY SCHOOL DISTRICT**
Campus #: **030 - PIONEER DRIVE SCHOOL**
Building #: **002 - MULTIPURPOSE ROOM**
Inspection Dates: **02/27/2001 To 03/29/2001**

Inspected by: **HAL GOUNDER**
Certification#: **3023**
State: **CA**
Gross Square Ft: **0**

***** INSPECTION RESULTS UNIFIED SAMPLING AREA - 005 *****

Material Category: **SURFACING MATERIALS** Location: **THROUGHOUT** Material Description: **HARDWALL/CEILING PLASTER**

Damage Category: **N/A** Reason for Damage Category: Potential for Disturbance:

Sample#	% Asb	Date	Inspector	Sample#	% Asb	Date	Inspector
8585	0	12/20/1995	CTL ENVIRONMENTAL				

Asbestos: **N** Friable: **N/A** ACM Status: **No Suspect Material**

MATERIAL QUANTITIES

MANAGEMENT PLAN RECOMMENDATION

Recommended Response Action: Priority: Preventative Measures:

Action Election: Response Action Schedule

Start Date	Completion Date
=====	=====

Inspector's Comments:

SISC - AHERA COMPLIANCE PROGRAM

County: KERN
Project #: 060027 - BAKERSFIELD CITY SCHOOL DISTRICT
Campus #: 030 - PIONEER DRIVE SCHOOL
Building #: 002 - MULTIPURPOSE ROOM
Inspection Dates: 02/27/2001 To 03/29/2001

Inspected by: HAL GOUNDER
Certification#: 3023
State: CA
Gross Square Ft: 0

INSPECTION RESULTS UNIFIED SAMPLING AREA - 006

Material Category:
MISCELLANEOUS

Location:
STAFF DINING ROOM

Material Description:
DROP OR LAY-IN PANEL

Damage Category:
N/A

Reason for Damage Category:

Potential for Disturbance:

Sample#	% Asb	Date	Inspector	Sample#	% Asb	Date	Inspector
8591	0	12/20/1995	CTL ENVIRONMENTAL				

Asbestos: N Friable: N/A ACM Status: No Suspect Material

MATERIAL QUANTITIES

600 SQ FEET

MANAGEMENT PLAN RECOMMENDATION

Recommended Response Action: Priority: Preventative Measures:

Action Election:

Response Action Schedule

Start Date Completion Date

Inspector's Comments:

SISC - AHERA COMPLIANCE PROGRAM

County: **KERN**
Project #: **060027 - BAKERSFIELD CITY SCHOOL DISTRICT**
Campus #: **030 - PIONEER DRIVE SCHOOL**
Building #: **002 - MULTIPURPOSE ROOM**
Inspection Dates: **02/27/2001 To 03/29/2001**

Inspected by: **HAL GOUNDER**
Certification#: **3023**
State: **CA**
Gross Square Ft: **0**

INSPECTION RESULTS UNIFIED SAMPLING AREA - 007

Material Category: **MISCELLANEOUS** Location: **MULTIPURPOSE ROOM** Material Description: **VINYL FLOOR TILE**

Damage Category: **N/A** Reason for Damage Category: Potential for Disturbance:

Sample#	% Asb	Date	Inspector	Sample#	% Asb	Date	Inspector
=====	=====	=====	=====	=====	=====	=====	=====

Asbestos: **N** Friable: **N/A** ACM Status: **No Suspect Material**

MATERIAL QUANTITIES

MANAGEMENT PLAN RECOMMENDATION

Recommended Response Action: Priority: Preventative Measures:

Action Election:

Response Action Schedule

Start Date Completion Date

Inspector's Comments:

**12X12 FLOOR TILE BLUE, GREY, RED. NEW MATERIAL INSTALLED
SUMMER 2001. SEE DISTRICT FOR DOCUMENTATION ON ASBESTOS
FOR THIS MATERIAL.**

SISC - AHERA COMPLIANCE PROGRAM

County: KERN
Project #: 060027 - BAKERSFIELD CITY SCHOOL DISTRICT
Campus #: 030 - PIONEER DRIVE SCHOOL
Building #: 002 - MULTIPURPOSE ROOM
Inspection Dates: 02/27/2001 To 03/29/2001

Inspected by: HAL GOUNDER
Certification#: 3023
State: CA
Gross Square Ft: 0

INSPECTION RESULTS UNIFIED SAMPLING AREA - 008

Material Category: MISCELLANEOUS
Location: KITCHEN
Material Description: LINOLEUM

Damage Category: N/A
Reason for Damage Category:
Potential for Disturbance:

Sample#	% Asb	Date	Inspector	Sample#	% Asb	Date	Inspector
=====	=====	=====	=====	=====	=====	=====	=====

Asbestos: N Friable: N/A ACM Status: No Suspect Material

MATERIAL QUANTITIES

MANAGEMENT PLAN RECOMMENDATION

Recommended Response Action: Priority: Preventative Measures:

Action Election:

Response Action Schedule

Start Date Completion Date

Inspector's Comments:

NEW GREY SHEET VINYL INSTALLED SUMMER 2001. SEE DISTRICT FOR DOCUMENTATION ON ASBESTOS FOR THIS MATERIAL.

SISC - AHERA COMPLIANCE PROGRAM

County: **KERN**
Project #: **060027 - BAKERSFIELD CITY SCHOOL DISTRICT**
Campus #: **030 - PIONEER DRIVE SCHOOL**
Building #: **002 - MULTIPURPOSE ROOM**
Inspection Dates: **02/27/2001 To 03/29/2001**

Inspected by: **HAL GOUNDER**
Certification#: **3023**
State: **CA**
Gross Square Ft: **0**

INSPECTION RESULTS UNIFIED SAMPLING AREA - 009

Material Category:
MISCELLANEOUS

Location:
TEACHERS DINNING

Material Description:
VINYL FLOOR TILE

Damage Category:
N/A

Reason for Damage Category:

Potential for Disturbance:

Sample#	% Asb	Date	Inspector	Sample#	% Asb	Date	Inspector
=====	=====	=====	=====	=====	=====	=====	=====

Asbestos: **N** Friable: **N/A** ACM Status: **No Suspect Material**

MATERIAL QUANTITIES

MANAGEMENT PLAN RECOMMENDATION

Recommended Response Action: Priority: Preventative Measures:

Action Election:

Response Action Schedule

Start Date Completion Date

Inspector's Comments:

12 X 12 FLOOR TILE (BLUE, GREY) NEW MATERIAL INSTALLED SUMMER 2001. SEE DISTRICT DESIGNATED PERSON FOR SPECIFIC INFORMATION ON ASBESTOS FOR THIS MATERIAL.

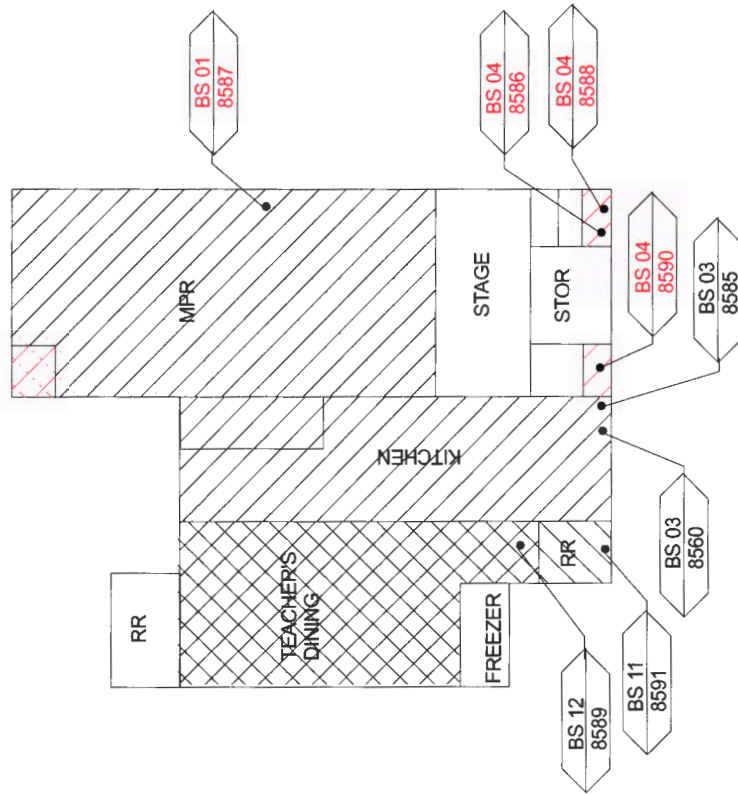

LEGEND

NON-ASBESTOS VINYL FLOOR TILE

NON-ASBESTOS NON-ASBESTOS CEILING TILES

NON-ASBESTOS SPRAY / TROWEL APPLIED MATERIAL

ASBESTOS CONTAINING VINYL FLOOR TILE

ASBESTOS CONTAINING CEILING TILES

ASBESTOS CONTAINING SPRAY / TROWEL APPLIED MATERIAL

SISC
SAFETY & LOSS CONTROL

INSPECTION DATE
02/27 - 03/29/2001

DRAWING NUMBER
030002

AHERA
COMPLIANCE PROGRAM

060027-030-002
BAKERSFIELD CITY SCHOOL DISTRICT
PIONEER DRIVE SCHOOL
MPR

SISC - AHERA COMPLIANCE PROGRAM

County: **KERN**
 Project #: **060027 - BAKERSFIELD CITY SCHOOL DISTRICT**
 Campus #: **030 - PIONEER DRIVE SCHOOL**
 Building #: **003 - CLASSROOMS 13-17**
 Inspection Dates: **02/27/2001 To 03/29/2001**

Inspected by: **HAL GOUNDER**
 Certification#: **3023**
 State: **CA**
 Gross Square Ft: **0**

INSPECTION RESULTS UNIFIED SAMPLING AREA - 001

Material Category: **MISCELLANEOUS** Location: **ON FLOOR UNDER TILE** Material Description: **MASTIC**

Damage Category: **ACBM WITH POTENTIAL FOR DAMAGE** Reason for Damage Category: **MATERIAL IN GOOD CONDITION** Potential for Disturbance: **SLIGHT**

Sample#	% Asb	Date	Inspector	Sample#	% Asb	Date	Inspector
ASSUMED		08/07/1995	JAY OLSEN				

Asbestos: **Y** Friable: **N** ACM Status: **Non-Friable Assumed**

MATERIAL QUANTITIES

MANAGEMENT PLAN RECOMMENDATION

Recommended Response Action: **O&M MAINTAIN AND MONITOR** Priority: **3** Preventative Measures: **USED W/MISC. & CEMENTITIOUS MATERIAL INCL. VAFT, TRANSITE, TILE UNDERLAY & SCRATCH COATS**

Action Election: _____ Response Action Schedule

Start Date	Completion Date
=====	=====

Inspector's Comments: **MATERIAL SHOULD BE SAMPLED PRIOR TO ABATEMENT TO VERIFY ASBESTOS CONTENT.**

SISC - AHERA COMPLIANCE PROGRAM

County: **KERN**
 Project #: **060027 - BAKERSFIELD CITY SCHOOL DISTRICT**
 Campus #: **030 - PIONEER DRIVE SCHOOL**
 Building #: **003 - CLASSROOMS 13-17**
 Inspection Dates: **02/27/2001 To 03/29/2001**

Inspected by: **HAL GOUNDER**
 Certification#: **3023**
 State: **CA**
 Gross Square Ft: **0**

INSPECTION RESULTS UNIFIED SAMPLING AREA - 002

Material Category: **MISCELLANEOUS** Location: **BOOK STORAGE/K-2** Material Description: **VINYL FLOOR TILE**

Damage Category: **ACBM WITH POTENTIAL FOR DAMAGE** Reason for Damage Category: **MATERIAL IN GOOD CONDITION** Potential for Disturbance: **SLIGHT**

Sample#	% Asb	Date	Inspector	Sample#	% Asb	Date	Inspector
8562	15	12/20/1988	CTL ENVIRONMENTAL				

Asbestos: **Y** Friable: **N** ACM Status: **Non-Friable ACBM**

MATERIAL QUANTITIES

4,800 SQ FEET

MANAGEMENT PLAN RECOMMENDATION

Recommended Response Action: **O&M MAINTAIN AND MONITOR** Priority: **3** Preventative Measures: **USED W/MISC. & CEMENTITIOUS MATERIAL INCL. VAFT, TRANSITE, TILE UNDERLAY & SCRATCH COATS**

Action Election: _____ Response Action Schedule

Start Date	Completion Date
=====	=====

Inspector's Comments:
GREEN 9 X 9 TILE

SISC AHERA COMPLIANCE PROGRAM

County: **KERN**
 Project #: **060027 - BAKERSFIELD CITY SCHOOL DISTRICT**
 Campus #: **030 - PIONEER DRIVE SCHOOL**
 Building #: **003 - CLASSROOMS 13-17**
 Inspection Dates: **02/27/2001 To 03/29/2001**

Inspected by: **HAL GOUNDER**
 Certification#: **3023**
 State: **CA**
 Gross Square Ft: **0**

INSPECTION RESULTS UNIFIED SAMPLING AREA - 003

Material Category: **MISCELLANEOUS** Location: **ROOMS K-1/K-3** Material Description: **VINYL FLOOR TILE**

Damage Category: **ACBM WITH POTENTIAL FOR DAMAGE** Reason for Damage Category: **MATERIAL IN GOOD CONDITION** Potential for Disturbance: **SLIGHT**

Sample#	% Asb	Date	Inspector	Sample#	% Asb	Date	Inspector
8598	8	12/20/1988	CTL ENVIRONMENTAL				

Asbestos: **Y** Friable: **N** ACM Status: **Non-Friable ACBM**

MATERIAL QUANTITIES

2,300 SQ FEET

MANAGEMENT PLAN RECOMMENDATION

Recommended Response Action: **O&M MAINTAIN AND MONITOR** Priority: **3** Preventative Measures: **USED W/MISC. & CEMENTITIOUS MATERIAL INCL. VAFT, TRANSITE, TILE UNDERLAY & SCRATCH COATS**

Action Election: _____ Response Action Schedule

Start Date	Completion Date
=====	=====

Inspector's Comments:
12 X 12 TILE - CARPET IN ROOMS IS OVER TILE

SISC - AHERA COMPLIANCE PROGRAM

County: **KERN**
Project #: **060027 - BAKERSFIELD CITY SCHOOL DISTRICT**
Campus #: **030 - PIONEER DRIVE SCHOOL**
Building #: **003 - CLASSROOMS 13-17**
Inspection Dates: **02/27/2001 To 03/29/2001**

Inspected by: **HAL GOUNDER**
Certification#: **3023**
State: **CA**
Gross Square Ft: **0**

INSPECTION RESULTS UNIFIED SAMPLING AREA - 004

Material Category: **MISCELLANEOUS** Location: **CLASSROOMS** Material Description: **ACOUSTICAL TILE (1X1)**

Damage Category: **N/A** Reason for Damage Category: Potential for Disturbance:

Sample#	% Asb	Date	Inspector	Sample#	% Asb	Date	Inspector
8594	0	12/20/1988	CTL ENVIRONMENTAL				

Asbestos: **N** Friable: **N/A** ACM Status: **No Suspect Material**

MATERIAL QUANTITIES

4,800 SQ FEET

MANAGEMENT PLAN RECOMMENDATION

Recommended Response Action: Priority: Preventative Measures:

Action Election:

Response Action Schedule

Start Date Completion Date

Inspector's Comments:

SISC - AHERA COMPLIANCE PROGRAM

County: **KERN**
 Project #: **060027 - BAKERSFIELD CITY SCHOOL DISTRICT**
 Campus #: **030 - PIONEER DRIVE SCHOOL**
 Building #: **003 - CLASSROOMS 13-17**
 Inspection Dates: **02/27/2001 To 03/29/2001**

Inspected by: **HAL GOUNDER**
 Certification#: **3023**
 State: **CA**
 Gross Square Ft: **0**

***** INSPECTION RESULTS UNIFIED SAMPLING AREA - 005 *****

Material Category: **MISCELLANEOUS** Location: **THROUGHOUT** Material Description: **DROP OR LAY-IN PANEL**

Damage Category: **N/A** Reason for Damage Category: Potential for Disturbance:

Sample#	% Asb	Date	Inspector	Sample#	% Asb	Date	Inspector
8595	0	12/20/1988	CTL ENVIRONMENTAL	8596	0	12/20/1988	CTL ENVIRONMENTAL
8597	0	12/20/1988	CTL ENVIRONMENTAL				

Asbestos: **N** Friable: **N/A** ACM Status: **No Suspect Material**

MATERIAL QUANTITIES

3,800 SQ FEET

MANAGEMENT PLAN RECOMMENDATION

Recommended Response Action: Priority: Preventative Measures:

Action Election:

Response Action Schedule

 Start Date Completion Date

Inspector's Comments:

SISC - AHERA COMPLIANCE PROGRAM

County: **KERN**
 Project #: **060027 - BAKERSFIELD CITY SCHOOL DISTRICT**
 Campus #: **030 - PIONEER DRIVE SCHOOL**
 Building #: **003 - CLASSROOMS 13-17**
 Inspection Dates: **02/27/2001 To 03/29/2001**

Inspected by: **HAL GOUNDER**
 Certification#: **3023**
 State: **CA**
 Gross Square Ft: **0**

INSPECTION RESULTS UNIFIED SAMPLING AREA - 006

Material Category: **SURFACING MATERIALS** Location: **THROUGHOUT** Material Description: **HARDWALL/CEILING PLASTER**

Damage Category: **N/A** Reason for Damage Category: Potential for Disturbance:

Sample#	% Asb	Date	Inspector	Sample#	% Asb	Date	Inspector
8613	0	12/20/1988	CTL ENVIRONMENTAL	8619	0	12/20/1988	CTL ENVIRONMENTAL

Asbestos: **N** Friable: **N/A** ACM Status: **No Suspect Material**

MATERIAL QUANTITIES

14,300

MANAGEMENT PLAN RECOMMENDATION

Recommended Response Action: Priority: Preventative Measures:

Action Election:

Response Action Schedule

 Start Date Completion Date

Inspector's Comments:

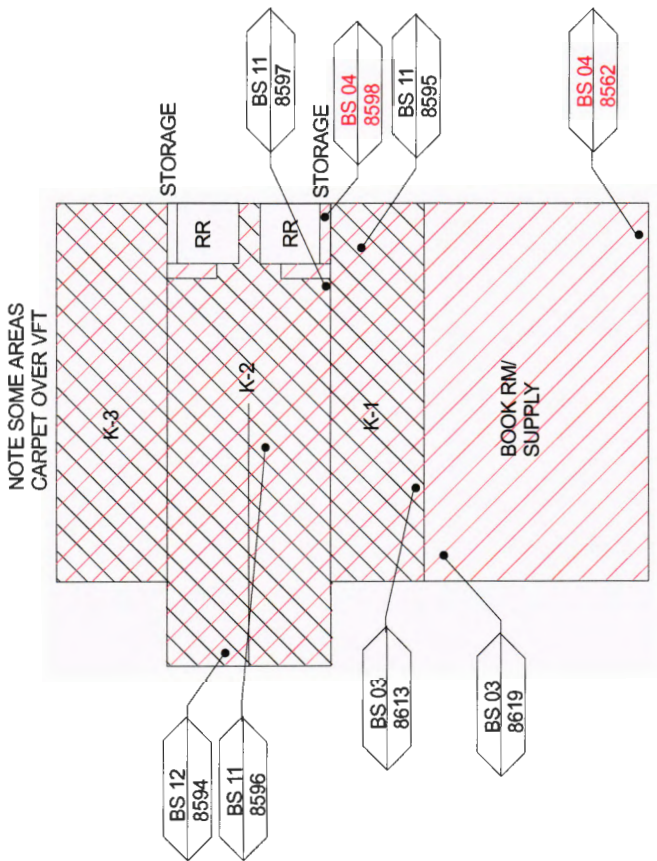

NOTE SOME AREAS
CARPET OVER VFT

LEGEND

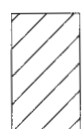

NON-ASBESTOS
VINYL FLOOR TILE



NON-ASBESTOS
CEILING TILES



NON-ASBESTOS
SPRAY / TROWEL
APPLIED MATERIAL



ASBESTOS
CONTAINING
VINYL FLOOR TILE



ASBESTOS
CONTAINING
CEILING TILES



ASBESTOS
CONTAINING
SPRAY / TROWEL
APPLIED MATERIAL

SISC

SAFETY & LOSS CONTROL

INSPECTION
DATE

02/27 - 03/29/2001

DRAWING
NUMBER

030003

**AHERA
COMPLIANCE PROGRAM**

060027-030-003
BAKERSFIELD CITY SCHOOL DISTRICT
PIONEER DRIVE SCHOOL
KINDERGARTEN

SISC - AHERA COMPLIANCE PROGRAM

County: **KERN**
 Project #: **060027 - BAKERSFIELD CITY SCHOOL DISTRICT**
 Campus #: **030 - PIONEER DRIVE SCHOOL**
 Building #: **004 - CLASSROOMS 5-7**
 Inspection Dates: **02/27/2001 To 03/29/2001**

Inspected by: **HAL GOUNDER**
 Certification#: **3023**
 State: **CA**
 Gross Square Ft: **0**

***** INSPECTION RESULTS UNIFIED SAMPLING AREA - 001 *****

Material Category: **MISCELLANEOUS** Location: **ON FLOOR UNDER TILE** Material Description: **MASTIC**

Damage Category: **ACBM WITH POTENTIAL FOR DAMAGE** Reason for Damage Category: **MATERIAL IN GOOD CONDITION** Potential for Disturbance: **SLIGHT**

Sample#	% Asb	Date	Inspector	Sample#	% Asb	Date	Inspector
=====	=====	=====	=====	=====	=====	=====	=====
ASSUMED		08/07/1995	JAY OLSEN				

Asbestos: **Y** Friable: **N** ACM Status: **Non-Friable Assumed**

MATERIAL QUANTITIES

MANAGEMENT PLAN RECOMMENDATION

Recommended Response Action: **O&M MAINTAIN AND MONITOR** Priority: **3** Preventative Measures: **USED W/MISC. & CEMENTITIOUS MATERIAL INCL. VAFT, TRANSITE, TILE UNDERLAY & SCRATCH COATS**

Action Election: _____

Response Action Schedule	
Start Date	Completion Date
=====	=====

Inspector's Comments:
MATERIAL SHOULD BE SAMPLED PRIOR TO ABATEMENT TO VERIFY ASBESTOS CONTENT.

SISC - AHERA COMPLIANCE PROGRAM

County: **KERN**
 Project #: **060027 - BAKERSFIELD CITY SCHOOL DISTRICT**
 Campus #: **030 - PIONEER DRIVE SCHOOL**
 Building #: **004 - CLASSROOMS 5-7**
 Inspection Dates: **02/27/2001 To 03/29/2001**

Inspected by: **HAL GOUNDER**
 Certification#: **3023**
 State: **CA**
 Gross Square Ft: **0**

INSPECTION RESULTS UNIFIED SAMPLING AREA - 002

Material Category: **MISCELLANEOUS** Location: **THROUGHOUT** Material Description: **VINYL FLOOR TILE**

Damage Category: **ACBM WITH POTENTIAL FOR DAMAGE** Reason for Damage Category: **MATERIAL IN GOOD CONDITION** Potential for Disturbance: **SLIGHT**

Sample#	% Asb	Date	Inspector	Sample#	% Asb	Date	Inspector
8614	15	12/20/1988	CTL ENVIRONMENTAL	8615	0	12/20/1988	CTL ENVIRONMENTAL

Asbestos: **Y** Friable: **N** ACM Status: **Non-Friable ACBM**

MATERIAL QUANTITIES

4,350 SQ FEET

MANAGEMENT PLAN RECOMMENDATION

Recommended Response Action: **O&M MAINTAIN AND MONITOR** Priority: **3** Preventative Measures: **USED W/MISC. & CEMENTITIOUS MATERIAL INCL. VAFT, TRANSITE, TILE UNDERLAY & SCRATCH COATS**

Action Election: _____ Response Action Schedule

Start Date	Completion Date
=====	=====

Inspector's Comments: **CARPET OVER TILE**

SISC - AHERA COMPLIANCE PROGRAM

County: **KERN**
 Project #: **060027 - BAKERSFIELD CITY SCHOOL DISTRICT**
 Campus #: **030 - PIONEER DRIVE SCHOOL**
 Building #: **004 - CLASSROOMS 5-7**
 Inspection Dates: **02/27/2001 To 03/29/2001**

Inspected by: **HAL GOUNDER**
 Certification#: **3023**
 State: **CA**
 Gross Square Ft: **0**

INSPECTION RESULTS UNIFIED SAMPLING AREA - 003

Material Category: **SURFACING MATERIALS** Location: **THROUGHOUT** Material Description: **HARDWALL/CEILING PLASTER**

Damage Category: **N/A** Reason for Damage Category: Potential for Disturbance:

Sample#	% Asb	Date	Inspector	Sample#	% Asb	Date	Inspector
8593	0	12/20/1988	CTL ENVIRONMENTAL	8618	0	12/20/1988	CTL ENVIRONMENTAL

Asbestos: **N** Friable: **N/A** ACM Status: **No Suspect Material**

MATERIAL QUANTITIES

7,300 SQ FEET

MANAGEMENT PLAN RECOMMENDATION

Recommended Response Action: Priority: Preventative Measures:

Action Election:

Response Action Schedule

 Start Date Completion Date

Inspector's Comments:

SISC - AHERA COMPLIANCE PROGRAM

County: **KERN**
Project #: **060027 - BAKERSFIELD CITY SCHOOL DISTRICT**
Campus #: **030 - PIONEER DRIVE SCHOOL**
Building #: **004 - CLASSROOMS 5-7**
Inspection Dates: **02/27/2001 To 03/29/2001**

Inspected by: **HAL GOUNDER**
Certification#: **3023**
State: **CA**
Gross Square Ft: **0**

INSPECTION RESULTS UNIFIED SAMPLING AREA - 004

Material Category: **MISCELLANEOUS** Location: **THROUGHOUT** Material Description: **ACOUSTICAL TILE (1X1)**

Damage Category: **N/A** Reason for Damage Category: Potential for Disturbance:

Sample#	% Asb	Date	Inspector	Sample#	% Asb	Date	Inspector
8611	0	12/20/1988	CTL ENVIRONMENTAL				

Asbestos: **N** Friable: **N/A** ACM Status: **No Suspect Material**

MATERIAL QUANTITIES

4,200 SQ FEET

MANAGEMENT PLAN RECOMMENDATION

Recommended Response Action: Priority: Preventative Measures:

Action Election:

Response Action Schedule

Start Date Completion Date

Inspector's Comments:

SISC - AHERA COMPLIANCE PROGRAM

County: **KERN**
Project #: **060027 - BAKERSFIELD CITY SCHOOL DISTRICT**
Campus #: **030 - PIONEER DRIVE SCHOOL**
Building #: **004 - CLASSROOMS 5-7**
Inspection Dates: **02/27/2001 To 03/29/2001**

Inspected by: **HAL GOUNDER**
Certification#: **3023**
State: **CA**
Gross Square Ft: **0**

INSPECTION RESULTS UNIFIED SAMPLING AREA 005

Material Category: **MISCELLANEOUS** Location: **THROUGHOUT** Material Description: **DROP OR LAY-IN PANEL**

Damage Category: **N/A** Reason for Damage Category: Potential for Disturbance:

Sample#	% Asb	Date	Inspector	Sample#	% Asb	Date	Inspector
8609	0	12/20/1988	CTL ENVIRONMENTAL	8616	0	12/20/1988	CTL ENVIRONMENTAL

Asbestos: **N** Friable: **N/A** ACM Status: **No Suspect Material**

MATERIAL QUANTITIES

3,100 SQ FEET

MANAGEMENT PLAN RECOMMENDATION

Recommended Response Action: Priority: Preventative Measures:

Action Election:

Response Action Schedule

Start Date Completion Date

Inspector's Comments:

SISC - AHERA COMPLIANCE PROGRAM

County: **KERN**
Project #: **060027 - BAKERSFIELD CITY SCHOOL DISTRICT**
Campus #: **030 - PIONEER DRIVE SCHOOL**
Building #: **004 - CLASSROOMS 5-7**
Inspection Dates: **02/27/2001 To 03/29/2001**

Inspected by: **HAL GOUNDER**
Certification#: **3023**
State: **CA**
Gross Square Ft: **0**

INSPECTION RESULTS UNIFIED SAMPLING AREA - 006

Material Category: **MISCELLANEOUS** Location: **CLASSROOMS** Material Description: **OTHER-SEE COMMENTS**

Damage Category: **N/A** Reason for Damage Category: Potential for Disturbance:

Sample#	% Asb	Date	Inspector	Sample#	% Asb	Date	Inspector
=====	=====	=====	=====	=====	=====	=====	=====

Asbestos: **N** Friable: **N/A** ACM Status: **No Suspect Material**

MATERIAL QUANTITIES

MANAGEMENT PLAN RECOMMENDATION

Recommended Response Action: Priority: Preventative Measures:

Action Election:

Response Action Schedule

Start Date Completion Date

Inspector's Comments:

SHEET VINYL STRIP ALONG BACK OF CLASSROOMS AT CABINETS AND SINK OVER TOP OF ASBESTOS CONTAINING VFT. DATE OF INSTALLATION UNKNOWN. SEE DISTRICT FOR DOCUMENTATION.

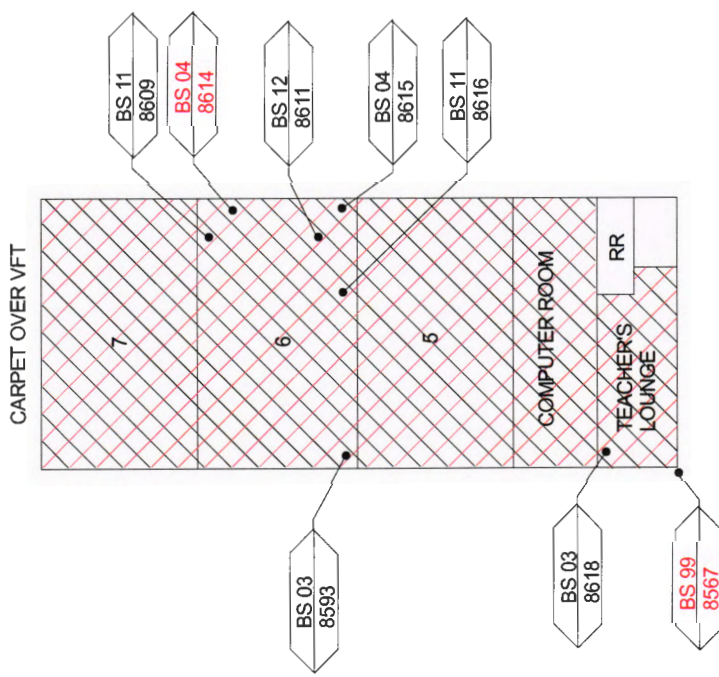

LEGEND

NON-ASBESTOS VINYL FLOOR TILE

NON-ASBESTOS CEILING TILES

NON-ASBESTOS SPRAY / TROWEL APPLIED MATERIAL

ASBESTOS CONTAINING VINYL FLOOR TILE

ASBESTOS CONTAINING CEILING TILES

ASBESTOS CONTAINING SPRAY / TROWEL APPLIED MATERIAL

SISC
SAFETY & LOSS CONTROL

INSPECTION DATE
02/27 - 03/29/2001

DRAWING NUMBER
030004

AHERA
COMPLIANCE PROGRAM

060027-030-004
BAKERSFIELD CITY SCHOOL DISTRICT
PIONEER DRIVE SCHOOL
CLASSROOMS 5-7

SISC - AHERA COMPLIANCE PROGRAM

County: **KERN**
 Project #: **060027 - BAKERSFIELD CITY SCHOOL DISTRICT**
 Campus #: **030 - PIONEER DRIVE SCHOOL**
 Building #: **005 - CLASSROOMS 8-10**
 Inspection Dates: **02/27/2001 To 03/29/2001**

Inspected by: **HAL GOUNDER**
 Certification#: **3023**
 State: **CA**
 Gross Square Ft: **0**

INSPECTION RESULTS UNIFIED SAMPLING AREA - 001

Material Category: **MISCELLANEOUS** Location: **THROUGHOUT** Material Description: **DROP OR LAY-IN PANEL**

Damage Category: **N/A** Reason for Damage Category: Potential for Disturbance:

Sample#	% Asb	Date	Inspector	Sample#	% Asb	Date	Inspector
8603	0	12/20/1988	CTL ENVIRONMENTAL	8604	0	12/20/1988	CTL ENVIRONMENTAL
8601	0	12/20/1988	CTL ENVIRONMENTAL				

Asbestos: **N** Friable: **N/A** ACM Status: **No Suspect Material**

MATERIAL QUANTITIES

MANAGEMENT PLAN RECOMMENDATION

Recommended Response Action: Priority: Preventative Measures:

Action Election:

Response Action Schedule

 Start Date Completion Date

Inspector's Comments:

SISC - AHERA COMPLIANCE PROGRAM

County: **KERN**
 Project #: **060027 - BAKERSFIELD CITY SCHOOL DISTRICT**
 Campus #: **030 - PIONEER DRIVE SCHOOL**
 Building #: **005 - CLASSROOMS 8-10**
 Inspection Dates: **02/27/2001 To 03/29/2001**

Inspected by: **HAL GOUNDER**
 Certification#: **3023**
 State: **CA**
 Gross Square Ft: **0**

***** INSPECTION RESULTS UNIFIED SAMPLING AREA - 002 *****

Material Category: **MISCELLANEOUS** Location: **ON FLOOR UNDER TILE** Material Description: **MASTIC**

Damage Category: **ACBM WITH POTENTIAL FOR DAMAGE** Reason for Damage Category: **MATERIAL IN GOOD CONDITION** Potential for Disturbance: **SLIGHT**

Sample#	% Asb	Date	Inspector	Sample#	% Asb	Date	Inspector
=====	=====	=====	=====	=====	=====	=====	=====
ASSUMED		08/07/1995	JAY OLSEN				

Asbestos: **Y** Friable: **N** ACM Status: **Non-Friable Assumed**

MATERIAL QUANTITIES

MANAGEMENT PLAN RECOMMENDATION

Recommended Response Action: **O&M MAINTAIN AND MONITOR** Priority: **3** Preventative Measures: **USED W/MISC. & CEMENTITIOUS MATERIAL INCL. VAFT, TRANSITE, TILE UNDERLAY & SCRATCH COATS**

Action Election: _____ Response Action Schedule

Start Date	Completion Date
=====	=====

Inspector's Comments: **MATERIAL SHOULD BE SAMPLED PRIOR TO ABATEMENT TO VERIFY ASBESTOS CONTENT.**

SISC - AHERA COMPLIANCE PROGRAM

County: **KERN**
 Project #: **060027 - BAKERSFIELD CITY SCHOOL DISTRICT**
 Campus #: **030 - PIONEER DRIVE SCHOOL**
 Building #: **005 - CLASSROOMS 8-10**
 Inspection Dates: **02/27/2001 To 03/29/2001**

Inspected by: **HAL GOUNDER**
 Certification#: **3023**
 State: **CA**
 Gross Square Ft: **0**

INSPECTION RESULTS UNIFIED SAMPLING AREA - 003

Material Category: **MISCELLANEOUS** Location: **CLASSROOMS/BALLROOM** Material Description: **VINYL FLOOR TILE**

Damage Category: **ACBM WITH POTENTIAL FOR DAMAGE** Reason for Damage Category: **MATERIAL IN GOOD CONDITION** Potential for Disturbance: **SLIGHT**

Sample#	% Asb	Date	Inspector	Sample#	% Asb	Date	Inspector
8600	12	12/20/1988	CTL ENVIRONMENTAL				

Asbestos: **Y** Friable: **N** ACM Status: **Non-Friable ACBM**

MATERIAL QUANTITIES

3,800 SQ FEET

MANAGEMENT PLAN RECOMMENDATION

Recommended Response Action: **O&M MAINTAIN AND MONITOR** Priority: **3** Preventative Measures: **USED W/MISC. & CEMENTITIOUS MATERIAL INCL. VAFT, TRANSITE, TILE UNDERLAY & SCRATCH COATS**

Action Election: _____ Response Action Schedule

Start Date	Completion Date
=====	=====

Inspector's Comments:
CARPET OVER 9 X 9 TILE IN CLASSROOMS

SISC - AHERA COMPLIANCE PROGRAM

County: **KERN**
Project #: **060027 - BAKERSFIELD CITY SCHOOL DISTRICT**
Campus #: **030 - PIONEER DRIVE SCHOOL**
Building #: **005 - CLASSROOMS 8-10**
Inspection Dates: **02/27/2001 To 03/29/2001**

Inspected by: **HAL GOUNDER**
Certification#: **3023**
State: **CA**
Gross Square Ft: **0**

INSPECTION RESULTS UNIFIED SAMPLING AREA - 004

Material Category: **SURFACING MATERIALS** Location: **RESTROOMS/CUSTODIAN/BALLROOM** Material Description: **HARDWALL/CEILING PLASTER**

Damage Category: **N/A** Reason for Damage Category: Potential for Disturbance:

Sample#	% Asb	Date	Inspector	Sample#	% Asb	Date	Inspector
8610	0	12/20/1988	CTL ENVIRONMENTAL				

Asbestos: **N** Friable: **N/A** ACM Status: **No Suspect Material**

MATERIAL QUANTITIES

8,000 SQ FEET

MANAGEMENT PLAN RECOMMENDATION

Recommended Response Action: Priority: Preventative Measures:

Action Election:

Response Action Schedule

Start Date Completion Date

Inspector's Comments:

ROUGH PLASTER

SISC - AHERA COMPLIANCE PROGRAM

County: **KERN**
Project #: **060027 - BAKERSFIELD CITY SCHOOL DISTRICT**
Campus #: **030 - PIONEER DRIVE SCHOOL**
Building #: **005 - CLASSROOMS 8-10**
Inspection Dates: **02/27/2001 To 03/29/2001**

Inspected by: **HAL GOUNDER**
Certification#: **3023**
State: **CA**
Gross Square Ft: **0**

INSPECTION RESULTS UNIFIED SAMPLING AREA - 005

Material Category: **MISCELLANEOUS** Location: **CLASSROOMS** Material Description: **ACOUSTICAL TILE (1X1)**

Damage Category: **N/A** Reason for Damage Category: Potential for Disturbance:

Sample#	% Asb	Date	Inspector	Sample#	% Asb	Date	Inspector
8612	0	12/20/1988	CTL ENVIRONMENTAL				

Asbestos: **N** Friable: **N/A** ACM Status: **No Suspect Material**

MATERIAL QUANTITIES

3,600 SQ FEET

MANAGEMENT PLAN RECOMMENDATION

Recommended Response Action: Priority: Preventative Measures:

Action Election:

Response Action Schedule

Start Date Completion Date

Inspector's Comments:

SISC - AHERA COMPLIANCE PROGRAM

County: **KERN**
 Project #: **060027 - BAKERSFIELD CITY SCHOOL DISTRICT**
 Campus #: **030 - PIONEER DRIVE SCHOOL**
 Building #: **005 - CLASSROOMS 8-10**
 Inspection Dates: **02/27/2001 To 03/29/2001**

Inspected by: **HAL GOUNDER**
 Certification#: **3023**
 State: **CA**
 Gross Square Ft: **0**

*** **INSPECTION RESULTS UNIFIED SAMPLING AREA - 006** ***

Material Category: **SURFACING MATERIALS** Location: **RESTROOMS** Material Description: **HARDWALL/CEILING PLASTER**

Damage Category: **N/A** Reason for Damage Category: Potential for Disturbance:

Sample#	% Asb	Date	Inspector	Sample#	% Asb	Date	Inspector
8617	0	12/20/1988	CTL ENVIRONMENTAL				

Asbestos: **N** Friable: **N/A** ACM Status: **No Suspect Material**

MATERIAL QUANTITIES

1,200 SQ FEET

MANAGEMENT PLAN RECOMMENDATION

Recommended Response Action: Priority: Preventative Measures:

Action Election:

Response Action Schedule

 Start Date Completion Date

Inspector's Comments:

SMOOTH PLASTER

SISC - AHERA COMPLIANCE PROGRAM

County: **KERN**
Project #: **060027 - BAKERSFIELD CITY SCHOOL DISTRICT**
Campus #: **030 - PIONEER DRIVE SCHOOL**
Building #: **005 - CLASSROOMS 8-10**
Inspection Dates: **02/27/2001 To 03/29/2001**

Inspected by: **HAL GOUNDER**
Certification#: **3023**
State: **CA**
Gross Square Ft: **0**

INSPECTION RESULTS UNIFIED SAMPLING AREA - 007

Material Category: **MISCELLANEOUS** Location: **CLASSROOMS** Material Description: **OTHER-SEE COMMENTS**

Damage Category: **N/A** Reason for Damage Category: Potential for Disturbance:

Sample#	% Asb	Date	Inspector	Sample#	% Asb	Date	Inspector
=====	=====	=====	=====	=====	=====	=====	=====

Asbestos: **N** Friable: **N/A** ACM Status: **No Suspect Material**

MATERIAL QUANTITIES

MANAGEMENT PLAN RECOMMENDATION

Recommended Response Action: Priority: Preventative Measures:

Action Election:

Response Action Schedule

Start Date Completion Date

Inspector's Comments:

**SHEET VINYL STRIP ALONG BACK OF CLASSROOMS AT CABINETS AND
SINK OVER TOP OF ASBESTOS CONTAINING VFT. DATE OF INSTALLATION
UNKNOWN. SEE DISTRICT FOR DOCUMENTATION.**

*NOTE CARPET OVER VFT

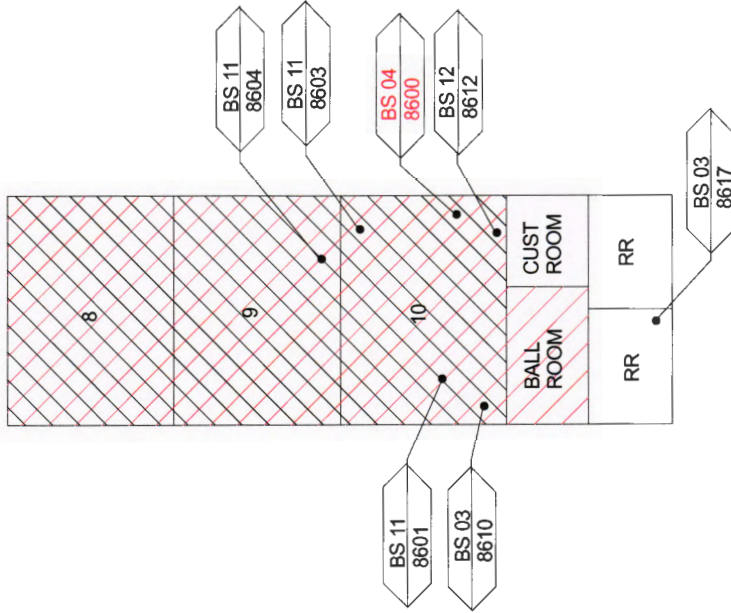

LEGEND

NON-ASBESTOS VINYL FLOOR TILE

NON-ASBESTOS CEILING TILES

NON-ASBESTOS SPRAY / TROWEL APPLIED MATERIAL

ASBESTOS CONTAINING VINYL FLOOR TILE

ASBESTOS CONTAINING CEILING TILES

ASBESTOS CONTAINING SPRAY / TROWEL APPLIED MATERIAL

SISC

SAFETY & LOSS CONTROL

INSPECTION DATE
02/27 - 03/29/2001

DRAWING NUMBER
030005

AHERA COMPLIANCE PROGRAM

060027-030-005
BAKERSFIELD CITY SCHOOL DISTRICT
PIONEER DRIVE SCHOOL
CLASSROOMS 8-10

SISC - AHERA COMPLIANCE PROGRAM

County: **KERN**
 Project #: **060027 - BAKERSFIELD CITY SCHOOL DISTRICT**
 Campus #: **030 - PIONEER DRIVE SCHOOL**
 Building #: **006 - CLASSROOMS 11-14**
 Inspection Dates: **02/27/2001 To 03/29/2001**

Inspected by: **HAL GOUNDER**
 Certification#: **3023**
 State: **CA**
 Gross Square Ft: **0**

INSPECTION RESULTS UNIFIED SAMPLING AREA - 001

Material Category: **MISCELLANEOUS** Location: **ON FLOOR UNDER TILE** Material Description: **MASTIC**

Damage Category: **ACBM WITH POTENTIAL FOR DAMAGE** Reason for Damage Category: **MATERIAL IN GOOD CONDITION** Potential for Disturbance: **SLIGHT**

Sample#	% Asb	Date	Inspector	Sample#	% Asb	Date	Inspector
=====	=====	=====	=====	=====	=====	=====	=====
ASSUMED		08/07/1995	JAY OLSEN				

Asbestos: **Y** Friable: **N** ACM Status: **Non-Friable Assumed**

MATERIAL QUANTITIES

MANAGEMENT PLAN RECOMMENDATION

Recommended Response Action: **O&M MAINTAIN AND MONITOR** Priority: **3** Preventative Measures: **USED W/MISC. & CEMENTITIOUS MATERIAL INCL. VAFT, TRANSITE, TILE UNDERLAY & SCRATCH COATS**

Action Election:

Response Action Schedule	
Start Date	Completion Date
=====	=====

Inspector's Comments:
MATERIAL SHOULD BE SAMPLED PRIOR TO ABATEMENT TO VERIFY ASBESTOS CONTENT.

SISC AHERA COMPLIANCE PROGRAM

County: **KERN**
 Project #: **060027 - BAKERSFIELD CITY SCHOOL DISTRICT**
 Campus #: **030 - PIONEER DRIVE SCHOOL**
 Building #: **006 - CLASSROOMS 11-14**
 Inspection Dates: **02/27/2001 To 03/29/2001**

Inspected by: **HAL GOUNDER**
 Certification#: **3023**
 State: **CA**
 Gross Square Ft: **0**

INSPECTION RESULTS UNIFIED SAMPLING AREA - 002

Material Category: **MISCELLANEOUS** Location: **CLASSROOMS 11-14** Material Description: **VINYL FLOOR TILE**

Damage Category: **ACBM WITH POTENTIAL FOR DAMAGE** Reason for Damage Category: **MATERIAL IN GOOD CONDITION** Potential for Disturbance: **SLIGHT**

Sample#	% Asb	Date	Inspector	Sample#	% Asb	Date	Inspector
8592	10	12/20/1988	CTL ENVIRONMENTAL				

Asbestos: **Y** Friable: **N** ACM Status: **Non-Friable ACBM**

MATERIAL QUANTITIES

2,200 SQ FEET

MANAGEMENT PLAN RECOMMENDATION

Recommended Response Action: **O&M MAINTAIN AND MONITOR** Priority: **3** Preventative Measures: **USED W/MISC. & CEMENTITIOUS MATERIAL INCL. VAFT, TRANSITE, TILE UNDERLAY & SCRATCH COATS**

Action Election: _____ Response Action Schedule

Start Date	Completion Date
=====	=====

Inspector's Comments:
9 X 9 GREEN W/BLACK & WHITE UNDER CARPET.

SISC - AHERA COMPLIANCE PROGRAM

County: **KERN**
 Project #: **060027 - BAKERSFIELD CITY SCHOOL DISTRICT**
 Campus #: **030 - PIONEER DRIVE SCHOOL**
 Building #: **006 - CLASSROOMS 11-14**
 Inspection Dates: **02/27/2001 To 03/29/2001**

Inspected by: **HAL GOUNDER**
 Certification#: **3023**
 State: **CA**
 Gross Square Ft: **0**

INSPECTION RESULTS UNIFIED SAMPLING AREA - 003

Material Category: **MISCELLANEOUS** Location: **THROUGHOUT** Material Description: **DROP OR LAY-IN PANEL**

Damage Category: **N/A** Reason for Damage Category: Potential for Disturbance:

Sample#	% Asb	Date	Inspector	Sample#	% Asb	Date	Inspector
8602	0	12/20/1988	CTL ENVIRONMENTAL				

Asbestos: **N** Friable: **N/A** ACM Status: **No Suspect Material**

MATERIAL QUANTITIES

4,400 SQ FEET

MANAGEMENT PLAN RECOMMENDATION

Recommended Response Action: Priority: Preventative Measures:

Action Election:

Response Action Schedule

 Start Date Completion Date

Inspector's Comments:

SISC - AHERA COMPLIANCE PROGRAM

County: **KERN**
 Project #: **060027 - BAKERSFIELD CITY SCHOOL DISTRICT**
 Campus #: **030 - PIONEER DRIVE SCHOOL**
 Building #: **006 - CLASSROOMS 11-14**
 Inspection Dates: **02/27/2001 To 03/29/2001**

Inspected by: **HAL GOUNDER**
 Certification#: **3023**
 State: **CA**
 Gross Square Ft: **0**

*** **INSPECTION RESULTS UNIFIED SAMPLING AREA - 005** ***

Material Category: **MISCELLANEOUS** Location: **THROUGHOUT** Material Description: **ACOUSTICAL TILE (1X1)**

Damage Category: **N/A** Reason for Damage Category: Potential for Disturbance:

Sample#	% Asb	Date	Inspector	Sample#	% Asb	Date	Inspector
8606	0	12/20/1988	CTL ENVIRONMENTAL				

Asbestos: **N** Friable: **N/A** ACM Status: **No Suspect Material**

MATERIAL QUANTITIES

4,400 SQ FEET

MANAGEMENT PLAN RECOMMENDATION

Recommended Response Action: Priority: Preventative Measures:

Action Election:

Response Action Schedule

 Start Date Completion Date

Inspector's Comments:

SISC - AHERA COMPLIANCE PROGRAM

County: **KERN**
Project #: **060027 - BAKERSFIELD CITY SCHOOL DISTRICT**
Campus #: **030 - PIONEER DRIVE SCHOOL**
Building #: **006 - CLASSROOMS 11-14**
Inspection Dates: **02/27/2001 To 03/29/2001**

Inspected by: **HAL GOUNDER**
Certification#: **3023**
State: **CA**
Gross Square Ft: **0**

INSPECTION RESULTS UNIFIED SAMPLING AREA - 006

Material Category: **SURFACING MATERIALS** Location: **THROUGHOUT** Material Description: **HARDWALL/CEILING PLASTER**

Damage Category: **N/A** Reason for Damage Category: Potential for Disturbance:

Sample#	% Asb	Date	Inspector	Sample#	% Asb	Date	Inspector
8607	0	12/20/1988	CTL ENVIRONMENTAL				

Asbestos: **N** Friable: **N/A** ACM Status: **No Suspect Material**

MATERIAL QUANTITIES

6,000 SQ FEET

MANAGEMENT PLAN RECOMMENDATION

Recommended Response Action: Priority: Preventative Measures:

Action Election:

Response Action Schedule

Start Date Completion Date

Inspector's Comments:

ROUGH PLASTER

SISC - AHERA COMPLIANCE PROGRAM

County: **KERN**
Project #: **060027 - BAKERSFIELD CITY SCHOOL DISTRICT**
Campus #: **030 - PIONEER DRIVE SCHOOL**
Building #: **006 - CLASSROOMS 11-14**
Inspection Dates: **02/27/2001 To 03/29/2001**

Inspected by: **HAL GOUNDER**
Certification#: **3023**
State: **CA**
Gross Square Ft: **0**

INSPECTION RESULTS UNIFIED SAMPLING AREA - 007

Material Category: **MISCELLANEOUS** Location: **CLASSROOMS** Material Description: **OTHER-SEE COMMENTS**

Damage Category: **N/A** Reason for Damage Category: Potential for Disturbance:

Sample#	% Asb	Date	Inspector	Sample#	% Asb	Date	Inspector
=====	=====	=====	=====	=====	=====	=====	=====

Asbestos: **N** Friable: **N/A** ACM Status: **No Suspect Material**

MATERIAL QUANTITIES

MANAGEMENT PLAN RECOMMENDATION

Recommended Response Action: Priority: Preventative Measures:

Action Election:

Response Action Schedule

Start Date Completion Date

Inspector's Comments:

SHEET VINYL STRIP ALONG BACK OF CLASSROOMS AT CABINETS AND SINK OVER TOP OF ASBESTOS CONTAINING VFT. DATE OF INSTALLATION UNKNOWN. SEE DISTRICT FOR DOCUMENTATION.

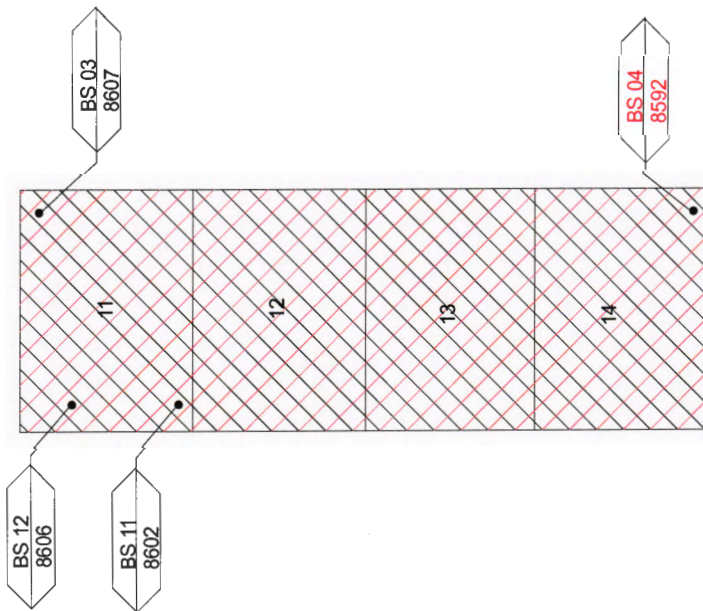

LEGEND

NON-ASBESTOS VINYL FLOOR TILE

NON-ASBESTOS CEILING TILES

NON-ASBESTOS SPRAY / TROWEL APPLIED MATERIAL

ASBESTOS CONTAINING VINYL FLOOR TILE

ASBESTOS CONTAINING CEILING TILES

ASBESTOS CONTAINING SPRAY / TROWEL APPLIED MATERIAL

SISC
SAFETY & LOSS CONTROL

INSPECTION DATE
02/27 - 03/29/2001

DRAWING NUMBER
030006

AHERA
COMPLIANCE PROGRAM

060027-030-006
BAKERSFIELD CITY SCHOOL DISTRICT
PIONEER DRIVE SCHOOL
CLASSROOMS 11-14

SISC - AHERA COMPLIANCE PROGRAM

County: **KERN**
 Project #: **060027 - BAKERSFIELD CITY SCHOOL DISTRICT**
 Campus #: **030 - PIONEER DRIVE SCHOOL**
 Building #: **007 - CLASSROOMS 1-4**
 Inspection Dates: **02/27/2001 To 03/29/2001**

Inspected by: **HAL GOUNDER**
 Certification#: **3023**
 State: **CA**
 Gross Square Ft: **0**

INSPECTION RESULTS UNIFIED SAMPLING AREA - 001

Material Category: **MISCELLANEOUS** Location: **THROUGHOUT** Material Description: **VINYL FLOOR TILE**

Damage Category: **ACBM WITH POTENTIAL FOR DAMAGE** Reason for Damage Category: **MATERIAL IN GOOD CONDITION** Potential for Disturbance: **SLIGHT**

Sample#	% Asb	Date	Inspector	Sample#	% Asb	Date	Inspector
8608	12	12/20/1988	CTL ENVIRONMENTAL				

Asbestos: **Y** Friable: **N** ACM Status: **Non-Friable ACBM**

MATERIAL QUANTITIES

4,400 SQ FEET

MANAGEMENT PLAN RECOMMENDATION

Recommended Response Action: **O&M MAINTAIN AND MONITOR** Priority: **3** Preventative Measures: **USED W/MISC. & CEMENTITIOUS MATERIAL INCL. VAFT, TRANSITE, TILE UNDERLAY & SCRATCH COATS**

Action Election: _____ Response Action Schedule

Start Date	Completion Date
=====	=====

Inspector's Comments:
9 X 9 GREEN W/BLACK & WHITE

SISC - AHERA COMPLIANCE PROGRAM

County: **KERN**
Project #: **060027 - BAKERSFIELD CITY SCHOOL DISTRICT**
Campus #: **030 - PIONEER DRIVE SCHOOL**
Building #: **007 - CLASSROOMS 1-4**
Inspection Dates: **02/27/2001 To 03/29/2001**

Inspected by: **HAL GOUNDER**
Certification#: **3023**
State: **CA**
Gross Square Ft: **0**

INSPECTION RESULTS UNIFIED SAMPLING AREA - 002

Material Category: **SURFACING MATERIALS** Location: **THROUGHOUT** Material Description: **HARDWALL/CEILING PLASTER**

Damage Category: **N/A** Reason for Damage Category: Potential for Disturbance:

Sample#	% Asb	Date	Inspector	Sample#	% Asb	Date	Inspector
8625	0	12/20/1988	CTL ENVIRONMENTAL				

Asbestos: **N** Friable: **N/A** ACM Status: **No Suspect Material**

MATERIAL QUANTITIES

6,000 SQ FEET

MANAGEMENT PLAN RECOMMENDATION

Recommended Response Action: Priority: Preventative Measures:

Action Election:

Response Action Schedule

Start Date Completion Date

Inspector's Comments:

ROUGH PLASTER

SISC - AHERA COMPLIANCE PROGRAM

County: **KERN**
Project #: **060027 - BAKERSFIELD CITY SCHOOL DISTRICT**
Campus #: **030 - PIONEER DRIVE SCHOOL**
Building #: **007 - CLASSROOMS 1-4**
Inspection Dates: **02/27/2001 To 03/29/2001**

Inspected by: **HAL GOUNDER**
Certification#: **3023**
State: **CA**
Gross Square Ft: **0**

INSPECTION RESULTS UNIFIED SAMPLING AREA - 003

Material Category:
MISCELLANEOUS

Location:
ON FLOOR UNDER TILE

Material Description:
MASTIC

Damage Category:
ACBM WITH POTENTIAL FOR DAMAGE

Reason for Damage Category:
MATERIAL IN GOOD CONDITION

Potential for Disturbance: **SLIGHT**

Sample#	% Asb	Date	Inspector	Sample#	% Asb	Date	Inspector
=====	=====	=====	=====	=====	=====	=====	=====
ASSUMED		08/07/1995	JAY OLSEN				

Asbestos: **Y** Friable: **N** ACM Status: **Non-Friable Assumed**

MATERIAL QUANTITIES

MANAGEMENT PLAN RECOMMENDATION

Recommended Response Action: **O&M MAINTAIN AND MONITOR** Priority: **3** Preventative Measures: **USED W/MISC. & CEMENTITIOUS MATERIAL INCL. VAFT, TRANSITE, TILE UNDERLAY & SCRATCH COATS**

Action Election:

Response Action Schedule

Start Date Completion Date

Inspector's Comments:

MATERIAL SHOULD BE SAMPLED PRIOR TO ABATEMENT TO VERIFY ASBESTOS CONTENT.

SISC - AHERA COMPLIANCE PROGRAM

County: **KERN**
Project #: **060027 - BAKERSFIELD CITY SCHOOL DISTRICT**
Campus #: **030 - PIONEER DRIVE SCHOOL**
Building #: **007 - CLASSROOMS 1-4**
Inspection Dates: **02/27/2001 To 03/29/2001**

Inspected by: **HAL GOUNDER**
Certification#: **3023**
State: **CA**
Gross Square Ft: **0**

***** INSPECTION RESULTS UNIFIED SAMPLING AREA - 004 *****

Material Category: **MISCELLANEOUS** Location: **THROUGHOUT** Material Description: **ACOUSTICAL TILE (1X1)**

Damage Category: **N/A** Reason for Damage Category: Potential for Disturbance:

Sample#	% Asb	Date	Inspector	Sample#	% Asb	Date	Inspector
8626	0	12/20/1988	CTL ENVIRONMENTAL				

Asbestos: **N** Friable: **N/A** ACM Status: **No Suspect Material**

MATERIAL QUANTITIES

4,400 SQ FEET

MANAGEMENT PLAN RECOMMENDATION

Recommended Response Action: Priority: Preventative Measures:

Action Election:

Response Action Schedule

Start Date Completion Date

Inspector's Comments:

SISC - AHERA COMPLIANCE PROGRAM

County: **KERN**
Project #: **060027 - BAKERSFIELD CITY SCHOOL DISTRICT**
Campus #: **030 - PIONEER DRIVE SCHOOL**
Building #: **007 - CLASSROOMS 1-4**
Inspection Dates: **02/27/2001 To 03/29/2001**

Inspected by: **HAL GOUNDER**
Certification#: **3023**
State: **CA**
Gross Square Ft: **0**

INSPECTION RESULTS UNIFIED SAMPLING AREA - 005

Material Category: **MISCELLANEOUS** Location: **THROUGHOUT** Material Description: **DROP OR LAY-IN PANEL**

Damage Category: **N/A** Reason for Damage Category: Potential for Disturbance:

Sample#	% Asb	Date	Inspector	Sample#	% Asb	Date	Inspector
8627	0	12/20/1988	CTL ENVIRONMENTAL				

Asbestos: **N** Friable: **N/A** ACM Status: **No Suspect Material**

MATERIAL QUANTITIES

4,400 SQ FEET

MANAGEMENT PLAN RECOMMENDATION

Recommended Response Action: Priority: Preventative Measures:

Action Election:

Response Action Schedule

Start Date Completion Date

Inspector's Comments:

SISG - AHERA COMPLIANCE PROGRAM

County: **KERN**
Project #: **060027 - BAKERSFIELD CITY SCHOOL DISTRICT**
Campus #: **030 - PIONEER DRIVE SCHOOL**
Building #: **007 - CLASSROOMS 1-4**
Inspection Dates: **02/27/2001 To 03/29/2001**

Inspected by: **HAL GOUNDER**
Certification#: **3023**
State: **CA**
Gross Square Ft: **0**

INSPECTION RESULTS UNIFIED SAMPLING AREA - 006

Material Category: **MISCELLANEOUS** Location: **CLASSROOMS** Material Description: **OTHER-SEE COMMENTS**

Damage Category: **N/A** Reason for Damage Category: Potential for Disturbance:

Sample#	% Asb	Date	Inspector	Sample#	% Asb	Date	Inspector
=====	=====	=====	=====	=====	=====	=====	=====

Asbestos: **N** Friable: **N/A** ACM Status: **No Suspect Material**

MATERIAL QUANTITIES

MANAGEMENT PLAN RECOMMENDATION

Recommended Response Action: Priority: Preventative Measures:

Action Election: Response Action Schedule

Start Date	Completion Date
=====	=====

Inspector's Comments:

SHEET VINYL STRIP ALONG BACK OF CLASSROOMS AT CABINETS AND SINK OVER TOP OF ASBESTOS CONTAINING VFT. DATE OF INSTALLATION UNKNOWN. SEE DISTRICT FOR DOCUMENTATION.

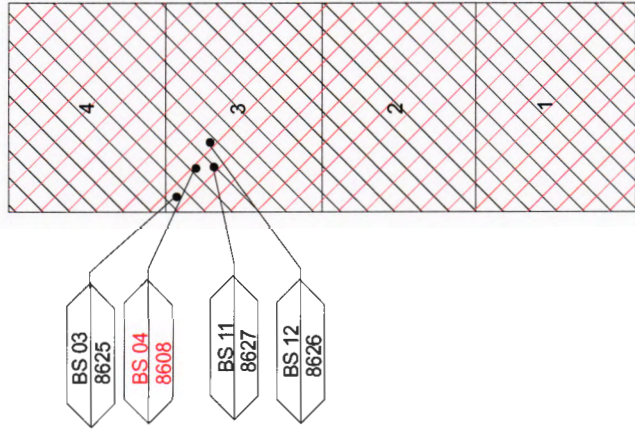

LEGEND

NON-ASBESTOS VINYL FLOOR TILE

NON-ASBESTOS CEILING TILES

NON-ASBESTOS SPRAY / TROWEL APPLIED MATERIAL

ASBESTOS CONTAINING VINYL FLOOR TILE

ASBESTOS CONTAINING CEILING TILES

ASBESTOS CONTAINING SPRAY / TROWEL APPLIED MATERIAL

SISC
SAFETY & LOSS CONTROL

INSPECTION DATE
02/27 - 03/29/2001

DRAWING NUMBER
030007

AHERA
COMPLIANCE PROGRAM

060027-030-007
BAKERSFIELD CITY SCHOOL DISTRICT
PIONEER DRIVE SCHOOL
CLASSROOMS 1-4

SISC - AHERA COMPLIANCE PROGRAM

County: **KERN**
Project #: **060027 - BAKERSFIELD CITY SCHOOL DISTRICT**
Campus #: **030 - PIONEER DRIVE SCHOOL**
Building #: **008 - RESTROOMS**
Inspection Dates: **02/27/2001 To 03/29/2001**

Inspected by: **HAL GOUNDER**
Certification#: **3023**
State: **CA**
Gross Square Ft: **0**

***** INSPECTION RESULTS UNIFIED SAMPLING AREA - 001 *****

Material Category: **SURFACING MATERIALS** Location: **THROUGHOUT** Material Description: **HARDWALL/CEILING PLASTER**

Damage Category: **N/A** Reason for Damage Category: Potential for Disturbance:

Sample#	% Asb	Date	Inspector	Sample#	% Asb	Date	Inspector
8620	0	12/20/1988	CTL ENVIRONMENTAL				

Asbestos: **N** Friable: **N/A** ACM Status: **No Suspect Material**

MATERIAL QUANTITIES

1,800 SQ FEET

MANAGEMENT PLAN RECOMMENDATION

Recommended Response Action: Priority: Preventative Measures:

Action Election:

Response Action Schedule

Start Date Completion Date

Inspector's Comments:

SMOOTH PLASTER

SISC - AHERA COMPLIANCE PROGRAM

County: **KERN**
 Project #: **060027 - BAKERSFIELD CITY SCHOOL DISTRICT**
 Campus #: **030 - PIONEER DRIVE SCHOOL**
 Building #: **008 - RESTROOMS**
 Inspection Dates: **02/27/2001 To 03/29/2001**

Inspected by: **HAL GOUNDER**
 Certification#: **3023**
 State: **CA**
 Gross Square Ft: **0**

INSPECTION RESULTS UNIFIED SAMPLING AREA - 002

Material Category:
SURFACING MATERIALS

Location:
THROUGHOUT

Material Description:
HARDWALL/CEILING PLASTER

Damage Category:
N/A

Reason for Damage Category:

Potential for Disturbance:

Sample#	% Asb	Date	Inspector	Sample#	% Asb	Date	Inspector
8621	0	12/20/1988	CTL ENVIRONMENTAL				

Asbestos: **N** Friable: **N/A** ACM Status: **No Suspect Material**

MATERIAL QUANTITIES

2,000 SQ FEET

MANAGEMENT PLAN RECOMMENDATION

Recommended Response Action: Priority: Preventative Measures:

Action Election:

Response Action Schedule

 Start Date Completion Date

Inspector's Comments:

ROUGH PLASTER

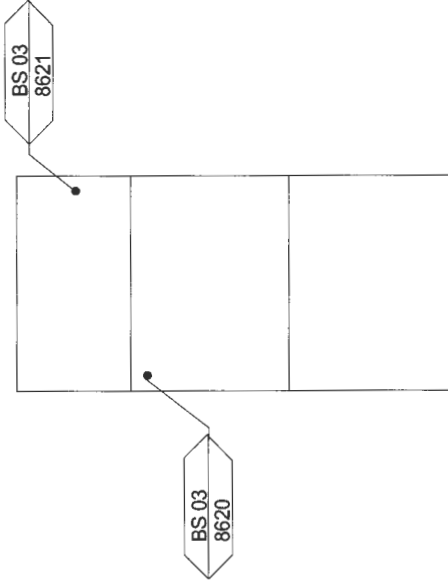

LEGEND

NON-ASBESTOS VINYL FLOOR TILE

NON-ASBESTOS CEILING TILES

NON-ASBESTOS SPRAY / TROWEL APPLIED MATERIAL

ASBESTOS CONTAINING VINYL FLOOR TILE

ASBESTOS CONTAINING CEILING TILES

ASBESTOS CONTAINING SPRAY / TROWEL APPLIED MATERIAL

SISC

SAFETY & LOSS CONTROL

INSPECTION DATE
02/27 - 03/29/2001

DRAWING NUMBER
030008

AHERA COMPLIANCE PROGRAM

060027-030-008
BAKERSFIELD CITY SCHOOL DISTRICT
PIONEER DRIVE SCHOOL
RESTROOMS

SISC - AHERA COMPLIANCE PROGRAM

County: **KERN**
 Project #: **060027 - BAKERSFIELD CITY SCHOOL DISTRICT**
 Campus #: **030 - PIONEER DRIVE SCHOOL**
 Building #: **009 - CLASSROOMS 15-19**
 Inspection Dates: **02/27/2001 To 03/29/2001**

Inspected by: **HAL GOUNDER**
 Certification#: **3023**
 State: **CA**
 Gross Square Ft: **0**

INSPECTION RESULTS UNIFIED SAMPLING AREA - 001

Material Category: **MISCELLANEOUS** Location: **THROUGHOUT** Material Description: **WALLBOARD**

Damage Category: **N/A** Reason for Damage Category: Potential for Disturbance:

Sample#	% Asb	Date	Inspector	Sample#	% Asb	Date	Inspector
8628	0	12/20/1988	CTL ENVIRONMENTAL				

Asbestos: **N** Friable: **N/A** ACM Status: **No Suspect Material**

MATERIAL QUANTITIES

4,800 SQ FEET

MANAGEMENT PLAN RECOMMENDATION

Recommended Response Action: Priority: Preventative Measures:

Action Election:

Response Action Schedule

 Start Date

 Completion Date

Inspector's Comments:

SISC - AHERA COMPLIANCE PROGRAM

County: **KERN**
 Project #: **060027 - BAKERSFIELD CITY SCHOOL DISTRICT**
 Campus #: **030 - PIONEER DRIVE SCHOOL**
 Building #: **009 - CLASSROOMS 15-19**
 Inspection Dates: **02/27/2001 To 03/29/2001**

Inspected by: **HAL GOUNDER**
 Certification#: **3023**
 State: **CA**
 Gross Square Ft: **0**

***** INSPECTION RESULTS UNIFIED SAMPLING AREA - 002 *****

Material Category: **MISCELLANEOUS** Location: **CLASSROOMS 15-19** Material Description: **OTHER-SEE COMMENTS**

Damage Category: **N/A** Reason for Damage Category: Potential for Disturbance:

Sample#	% Asb	Date	Inspector	Sample#	% Asb	Date	Inspector
=====	=====	=====	=====	=====	=====	=====	=====

Asbestos: **N** Friable: **N/A** ACM Status: **No Suspect Material**

MATERIAL QUANTITIES

4,800 SQ FEET

MANAGEMENT PLAN RECOMMENDATION

Recommended Response Action: Priority: Preventative Measures:

Action Election:

Response Action Schedule

 Start Date Completion Date

Inspector's Comments:

**SHEET VINYL STRIP ALONG BACK OF CLASSROOMS AT CABINETS AND
 SINK OVER TOP OF ASBESTOS CONTAINING VFT. DATE OF INSTALLATION
 UNKNOWN. SEE DISTRICT FOR DOCUMENTATION.**

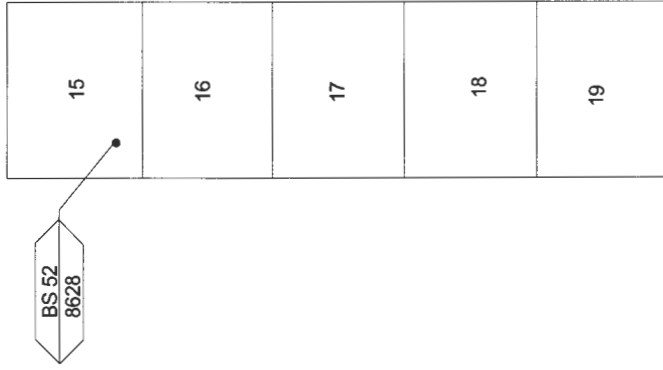

LEGEND

NON-ASBESTOS VINYL FLOOR TILE

NON-ASBESTOS CEILING TILES

NON-ASBESTOS SPRAY / TROWEL APPLIED MATERIAL

ASBESTOS CONTAINING VINYL FLOOR TILE

ASBESTOS CONTAINING CEILING TILES

ASBESTOS CONTAINING SPRAY / TROWEL APPLIED MATERIAL

SISC

SAFETY & LOSS CONTROL

INSPECTION DATE
02/27 - 03/29/2001

DRAWING NUMBER
030009

AHERA COMPLIANCE PROGRAM

060027-030-009
BAKERSFIELD CITY SCHOOL DISTRICT
PIONEER DRIVE SCHOOL
CLASSROOMS 15-19

SISC - AHERA COMPLIANCE PROGRAM

County: **KERN**
 Project #: **060027 - BAKERSFIELD CITY SCHOOL DISTRICT**
 Campus #: **030 - PIONEER DRIVE SCHOOL**
 Building #: **010 - RSP**
 Inspection Dates: **02/27/2001 To 03/29/2001**

Inspected by: **HAL GOUNDER**
 Certification#: **3023**
 State: **CA**
 Gross Square Ft: **0**

INSPECTION RESULTS UNIFIED SAMPLING AREA - 001

Material Category: **MISCELLANEOUS** Location: **THROUGHOUT** Material Description: **ACOUSTICAL TILE (1X1)**

Damage Category: **N/A** Reason for Damage Category: Potential for Disturbance:

Sample#	% Asb	Date	Inspector	Sample#	% Asb	Date	Inspector
8570	0	12/20/1988	CTL ENVIRONMENTAL				

Asbestos: **N** Friable: **N/A** ACM Status: **No Suspect Material**

MATERIAL QUANTITIES

520 SQ FEET

MANAGEMENT PLAN RECOMMENDATION

Recommended Response Action: Priority: Preventative Measures:

Action Election:

Response Action Schedule

 Start Date Completion Date

Inspector's Comments:

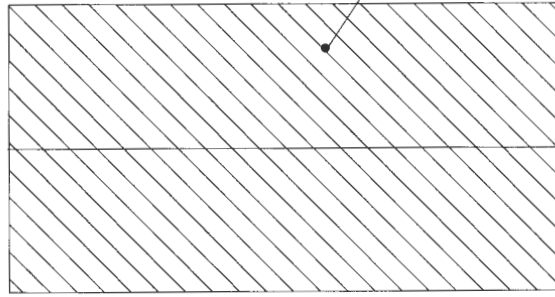

BS.12
8570

LEGEND

NON-ASBESTOS
VINYL FLOOR TILE

NON-ASBESTOS
CEILING TILES

NON-ASBESTOS
SPRAY / TROWEL
APPLIED MATERIAL

ASBESTOS
CONTAINING
VINYL FLOOR TILE

ASBESTOS
CONTAINING
CEILING TILES

ASBESTOS
CONTAINING
SPRAY / TROWEL
APPLIED MATERIAL

SISC

SAFETY & LOSS CONTROL

INSPECTION
DATE
02/27 - 03/29/2001

DRAWING
NUMBER
030010

**AHERA
COMPLIANCE PROGRAM**

060027-030-010
BAKERSFIELD CITY SCHOOL DISTRICT
PIONEER DRIVE SCHOOL
RSP

SISC - AHERA COMPLIANCE PROGRAM

County: KERN
Project #: 060027 - BAKERSFIELD CITY SCHOOL DISTRICT
Campus #: 030 - PIONEER DRIVE SCHOOL
Building #: 011 - CLASSROOMS 20-22
Inspection Dates: 02/27/2001 To 03/29/2001

Inspected by: HAL GOUNDER
Certification#: 3023
State: CA
Gross Square Ft: 0

INSPECTION RESULTS UNIFIED SAMPLING AREA - 001

Material Category: MISCELLANEOUS
Location: THROUGHOUT
Material Description: WALLBOARD

Damage Category: N/A
Reason for Damage Category:
Potential for Disturbance:

Table with 8 columns: Sample#, % Asb, Date, Inspector, Sample#, % Asb, Date, Inspector. Row 1: 8568, 0, 12/20/1988, CTL ENVIRONMENTAL

Asbestos: N Friable: N/A ACM Status: No Suspect Material

MATERIAL QUANTITIES

4,500 SQ FEET

MANAGEMENT PLAN RECOMMENDATION

Recommended Response Action: Priority: Preventative Measures:

Action Election:

Response Action Schedule

Start Date Completion Date

Inspector's Comments:

SISC - AHERA COMPLIANCE PROGRAM

County: **KERN**
 Project #: **060027 - BAKERSFIELD CITY SCHOOL DISTRICT**
 Campus #: **030 - PIONEER DRIVE SCHOOL**
 Building #: **011 - CLASSROOMS 20-22**
 Inspection Dates: **02/27/2001 To 03/29/2001**

Inspected by: **HAL GOUNDER**
 Certification#: **3023**
 State: **CA**
 Gross Square Ft: **0**

***** INSPECTION RESULTS UNIFIED SAMPLING AREA - 002 *****

Material Category: **MISCELLANEOUS** Location: **THROUGHOUT** Material Description: **DROP OR LAY-IN PANEL**

Damage Category: **N/A** Reason for Damage Category: Potential for Disturbance:

Sample#	% Asb	Date	Inspector	Sample#	% Asb	Date	Inspector
8569	0	12/20/1988	CTL ENVIRONMENTAL				

Asbestos: **N** Friable: **N/A** ACM Status: **No Suspect Material**

MATERIAL QUANTITIES

3,300 SQ FEET

MANAGEMENT PLAN RECOMMENDATION

Recommended Response Action: Priority: Preventative Measures:

Action Election:

Response Action Schedule

 Start Date Completion Date

Inspector's Comments:

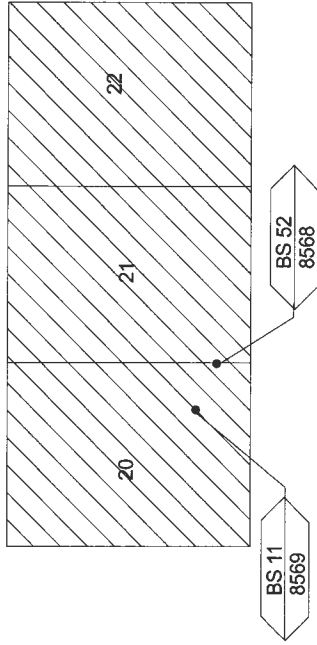

LEGEND

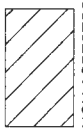

NON-ASBESTOS
VINYL FLOOR TILE



NON-ASBESTOS
CEILING TILES

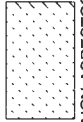

NON-ASBESTOS
SPRAY / TROWEL
APPLIED MATERIAL



ASBESTOS
CONTAINING
VINYL FLOOR TILE



ASBESTOS
CONTAINING
CEILING TILES



ASBESTOS
CONTAINING
SPRAY / TROWEL
APPLIED MATERIAL

SJSC

SAFETY & LOSS CONTROL

INSPECTION
DATE
02/27 - 03/29/2001

DRAWING
NUMBER
030011

**AHERA
COMPLIANCE PROGRAM**

060027-030-011
BAKERSFIELD CITY SCHOOL DISTRICT
PIONEER DRIVE SCHOOL
CLASSROOMS 20-22

SISC - AHERA COMPLIANCE PROGRAM

County: **KERN**
Project #: **060027 - BAKERSFIELD CITY SCHOOL DISTRICT**
Campus #: **030 - PIONEER DRIVE SCHOOL**
Building #: **012 - ROOM 24**
Inspection Dates: **02/27/2001 To 03/29/2001**

Inspected by: **HAL GOUNDER**
Certification#: **3023**
State: **CA**
Gross Square Ft: **0**

INSPECTION RESULTS UNIFIED SAMPLING AREA - 001

Material Category:
MISCELLANEOUS

Location:

Material Description:
NO SUSPECT MATERIAL

Damage Category:
N/A

Reason for Damage Category:

Potential for Disturbance:

Sample#	% Asb	Date	Inspector	Sample#	% Asb	Date	Inspector
=====	=====	=====	=====	=====	=====	=====	=====

Asbestos: **N** Friable: **N/A** ACM Status: **No Suspect Material**

MATERIAL QUANTITIES

MANAGEMENT PLAN RECOMMENDATION

Recommended Response Action: Priority: Preventative Measures:

Action Election:

Response Action Schedule

Start Date Completion Date

Inspector's Comments:

NO SUSPECT MATERIAL

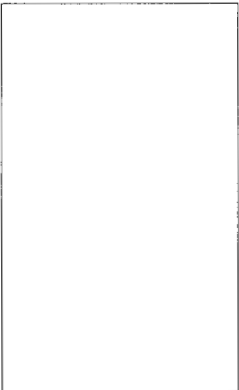

NO SUSPECT MATERIAL

LEGEND



NON-ASBESTOS
VINYL FLOOR TILE

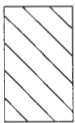

NON-ASBESTOS
CEILING TILES



NON-ASBESTOS
SPRAY / TROWEL
APPLIED MATERIAL



ASBESTOS
CONTAINING
VINYL FLOOR TILE



ASBESTOS
CONTAINING
CEILING TILES



ASBESTOS
CONTAINING
SPRAY / TROWEL
APPLIED MATERIAL

SISC

SAFETY & LOSS CONTROL

INSPECTION
DATE

02/27 - 03/29/2001

DRAWING
NUMBER

030012

**AHERA
COMPLIANCE PROGRAM**

060027-030-012
BAKERSFIELD CITY SCHOOL DISTRICT
PIONEER DRIVE SCHOOL
CLASSROOM 24

SISC - AHERA COMPLIANCE PROGRAM

County: **KERN**
Project #: **060027 - BAKERSFIELD CITY SCHOOL DISTRICT**
Campus #: **030 - PIONEER DRIVE SCHOOL**
Building #: **014 - ROOM 25**
Inspection Dates: **02/27/2001 To 03/29/2001**

Inspected by: **HAL GOUNDER**
Certification#: **3023**
State: **CA**
Gross Square Ft: **0**

INSPECTION RESULTS UNIFIED SAMPLING AREA - 001

Material Category: **MISCELLANEOUS** Location: Material Description: **NO SUSPECT MATERIAL**

Damage Category: **N/A** Reason for Damage Category: Potential for Disturbance:

Sample#	% Asb	Date	Inspector	Sample#	% Asb	Date	Inspector
=====	=====	=====	=====	=====	=====	=====	=====

Asbestos: **N** Friable: **N/A** ACM Status: **No Suspect Material**

MATERIAL QUANTITIES

MANAGEMENT PLAN RECOMMENDATION

Recommended Response Action: Priority: Preventative Measures:

Action Election:

Response Action Schedule

Start Date Completion Date

Inspector's Comments:

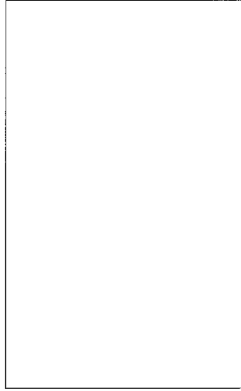

NO SUSPECT MATERIAL

LEGEND

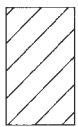

NON-ASBESTOS
VINYL FLOOR TILE

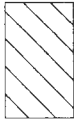

NON-ASBESTOS
CEILING TILES



NON-ASBESTOS
SPRAY / TROWEL
APPLIED MATERIAL



ASBESTOS
CONTAINING
VINYL FLOOR TILE



ASBESTOS
CONTAINING
CEILING TILES



ASBESTOS
CONTAINING
SPRAY / TROWEL
APPLIED MATERIAL

SISC

SAFETY & LOSS CONTROL

INSPECTION
DATE
02/27 - 03/29/2001

DRAWING
NUMBER
030014

**AHERA
COMPLIANCE PROGRAM**

060027-030-014
BAKERSFIELD CITY SCHOOL DISTRICT
PIONEER DRIVE SCHOOL
CLASSROOM 25

SISC - AHERA COMPLIANCE PROGRAM

County: **KERN**
Project #: **060027 - BAKERSFIELD CITY SCHOOL DISTRICT**
Campus #: **030 - PIONEER DRIVE SCHOOL**
Building #: **015 - ROOM 26**
Inspection Dates: **02/27/2001 To 03/29/2001**

Inspected by: **HAL GOUNDER**
Certification#: **3023**
State: **CA**
Gross Square Ft: **0**

***** INSPECTION RESULTS UNIFIED SAMPLING AREA - 001 *****

Material Category: **MISCELLANEOUS** Location: Material Description: **NO SUSPECT MATERIAL**

Damage Category: **N/A** Reason for Damage Category: Potential for Disturbance:

Sample#	% Asb	Date	Inspector	Sample#	% Asb	Date	Inspector
=====	=====	=====	=====	=====	=====	=====	=====

Asbestos: **N** Friable: **N/A** ACM Status: **No Suspect Material**

MATERIAL QUANTITIES

MANAGEMENT PLAN RECOMMENDATION

Recommended Response Action: Priority: Preventative Measures:

Action Election:

Response Action Schedule

Start Date Completion Date

Inspector's Comments:

=====

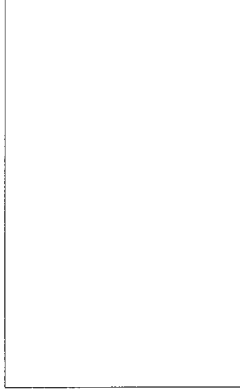

NO SUSPECT MATERIAL

LEGEND



NON-ASBESTOS
VINYL FLOOR TILE

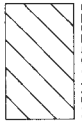

NON-ASBESTOS
CEILING TILES

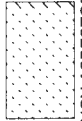

NON-ASBESTOS
SPRAY / TROWEL
APPLIED MATERIAL

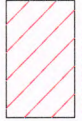

ASBESTOS
CONTAINING
VINYL FLOOR TILE



ASBESTOS
CONTAINING
CEILING TILES

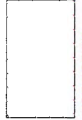

ASBESTOS
CONTAINING
SPRAY / TROWEL
APPLIED MATERIAL

SISC

SAFETY & LOSS CONTROL

INSPECTION
DATE
02/27 - 03/29/2001

DRAWING
NUMBER
030015

**AHERA
COMPLIANCE PROGRAM**

060027-030-015
BAKERSFIELD CITY SCHOOL DISTRICT.
PIONEER DRIVE SCHOOL
CLASSROOM 26

SISC - AHERA COMPLIANCE PROGRAM

County: **KERN**
 Project #: **060027 - BAKERSFIELD CITY SCHOOL DISTRICT**
 Campus #: **030 - PIONEER DRIVE SCHOOL**
 Building #: **016 - ROOM 29**
 Inspection Dates: **02/27/2001 To 03/29/2001**

Inspected by: **HAL GOUNDER**
 Certification#: **3023**
 State: **CA**
 Gross Square Ft: **0**

***** INSPECTION RESULTS UNIFIED SAMPLING AREA - 001 *****

Material Category: **MISCELLANEOUS** Location: Material Description: **NO SUSPECT MATERIAL**

Damage Category: **N/A** Reason for Damage Category: Potential for Disturbance:

Sample#	% Asb	Date	Inspector	Sample#	% Asb	Date	Inspector
=====	=====	=====	=====	=====	=====	=====	=====

Asbestos: **N** Friable: **N/A** ACM Status: **No Suspect Material**

MATERIAL QUANTITIES

MANAGEMENT PLAN RECOMMENDATION

Recommended Response Action: Priority: Preventative Measures:

Action Election:

Response Action Schedule

 Start Date Completion Date

Inspector's Comments:

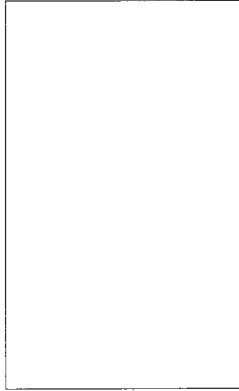

NO SUSPECT MATERIAL

LEGEND



NON-ASBESTOS
VINYL FLOOR TILE

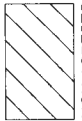

NON-ASBESTOS
CEILING TILES

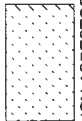

NON-ASBESTOS
SPRAY / TROWEL
APPLIED MATERIAL



ASBESTOS
CONTAINING
VINYL FLOOR TILE



ASBESTOS
CONTAINING
CEILING TILES

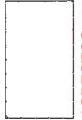

ASBESTOS
CONTAINING
SPRAY / TROWEL
APPLIED MATERIAL

SISC

SAFETY & LOSS CONTROL

INSPECTION
DATE
02/27 - 03/29/2001

DRAWING
NUMBER
030016

**AHERA
COMPLIANCE PROGRAM**

060027-030-016
BAKERSFIELD CITY SCHOOL DISTRICT
PIONEER DRIVE SCHOOL
CLASSROOM 29

SISC - AHERA COMPLIANCE PROGRAM

County: **KERN**
Project #: **060027 - BAKERSFIELD CITY SCHOOL DISTRICT**
Campus #: **030 - PIONEER DRIVE SCHOOL**
Building #: **017 - ROOM 30**
Inspection Dates: **02/27/2001 To 03/29/2001**

Inspected by: **HAL GOUNDER**
Certification#: **3023**
State: **CA**
Gross Square Ft: **0**

***** INSPECTION RESULTS UNIFIED SAMPLING AREA - 001 *****

Material Category: **MISCELLANEOUS** Location: Material Description: **NO SUSPECT MATERIAL**

Damage Category: **N/A** Reason for Damage Category: Potential for Disturbance:

Sample#	% Asb	Date	Inspector	Sample#	% Asb	Date	Inspector
=====	=====	=====	=====	=====	=====	=====	=====

Asbestos: **N** Friable: **N/A** ACM Status: **No Suspect Material**

MATERIAL QUANTITIES

MANAGEMENT PLAN RECOMMENDATION

Recommended Response Action: Priority: Preventative Measures:

Action Election:

Response Action Schedule

Start Date Completion Date

Inspector's Comments:

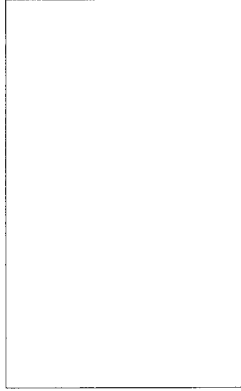

NO SUSPECT MATERIAL

LEGEND



NON-ASBESTOS
VINYL FLOOR TILE



NON-ASBESTOS
CEILING TILES



NON-ASBESTOS
SPRAY / TROWEL
APPLIED MATERIAL



ASBESTOS
CONTAINING
VINYL FLOOR TILE



ASBESTOS
CONTAINING
CEILING TILES



ASBESTOS
CONTAINING
SPRAY / TROWEL
APPLIED MATERIAL

SISC

SAFETY & LOSS CONTROL

INSPECTION
DATE

02/27 - 03/29/2001

DRAWING
NUMBER

030017

**AHERA
COMPLIANCE PROGRAM**

060027-030-017
BAKERSFIELD CITY SCHOOL DISTRICT
PIONEER DRIVE SCHOOL
CLASSROOM 30

SISC - AHERA COMPLIANCE PROGRAM

County: **KERN**
Project #: **060027 - BAKERSFIELD CITY SCHOOL DISTRICT**
Campus #: **030 - PIONEER DRIVE SCHOOL**
Building #: **018 - CLASSROOM 27**
Inspection Dates: **02/27/2001 To 03/29/2001**

Inspected by: **HAL GOUNDER**
Certification#: **3023**
State: **CA**
Gross Square Ft: **1,920**

***** INSPECTION RESULTS UNIFIED SAMPLING AREA - 001 *****

Material Category: **MISCELLANEOUS** Location: **CLASSROOM 27** Material Description: **OTHER-SEE COMMENTS**

Damage Category: **N/A** Reason for Damage Category: Potential for Disturbance:

Sample#	% Asb	Date	Inspector	Sample#	% Asb	Date	Inspector
=====	=====	=====	=====	=====	=====	=====	=====

Asbestos: **N** Friable: **N/A** ACM Status: **No Suspect Material**

MATERIAL QUANTITIES

MANAGEMENT PLAN RECOMMENDATION

Recommended Response Action: Priority: Preventative Measures:

Action Election:

Response Action Schedule

Start Date Completion Date

Inspector's Comments:





GE CAP 6505 & 6506 SEE DISTRICT DESIGNATED PERSON FOR SPECIFIC INFORMATION ON ASBESTOS FOR THIS BUILDING.

(

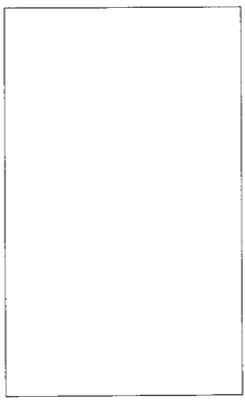
(

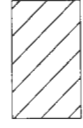
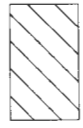
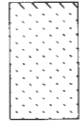
(



LEGEND		NON-ASBESTOS VINYL FLOOR TILE
		NON-ASBESTOS CEILING TILES
		NON-ASBESTOS SPRAY / TROWEL APPLIED MATERIAL
		ASBESTOS CONTAINING VINYL FLOOR TILE
		ASBESTOS CONTAINING CEILING TILES
		ASBESTOS CONTAINING SPRAY / TROWEL APPLIED MATERIAL
SISC		AHERA COMPLIANCE PROGRAM
SAFETY & LOSS CONTROL		060027-030-018 BAKERSFIELD CITY SCHOOL DISTRICT PIONEER DRIVE SCHOOL CLASSROOM 27
INSPECTION DATE	02/27 - 03/29/2001	DRAWING NUMBER 030018

SISC - AHERA COMPLIANCE PROGRAM

County: **KERN**
Project #: **060027 - BAKERSFIELD CITY SCHOOL DISTRICT**
Campus #: **030 - PIONEER DRIVE SCHOOL**
Building #: **019 - CLASSROOM 28**
Inspection Dates: **02/27/2001 To 03/29/2001**

Inspected by: **HAL GOUNDER**
Certification#: **3023**
State: **CA**
Gross Square Ft: **1,920**

INSPECTION RESULTS UNIFIED SAMPLING AREA - 00T

Material Category:
MISCELLANEOUS

Location:
CLASSROOM 28

Material Description:
OTHER-SEE COMMENTS

Damage Category:
N/A

Reason for Damage Category:

Potential for Disturbance:

Sample#	% Asb	Date	Inspector	Sample#	% Asb	Date	Inspector
=====	=====	=====	=====	=====	=====	=====	=====

Asbestos: **N** Friable: **N/A** ACM Status: **No Suspect Material**

MATERIAL QUANTITIES

MANAGEMENT PLAN RECOMMENDATION

Recommended Response Action: Priority: Preventative Measures:

Action Election:

Response Action Schedule

Start Date Completion Date

Inspector's Comments:

GE CAP 9966 & 9967 SEE DISTRICT DESIGNATED PERSON FOR SPECIFIC INFORMATION ON ASBESTOS FOR THIS BUILDING.

(

(

(

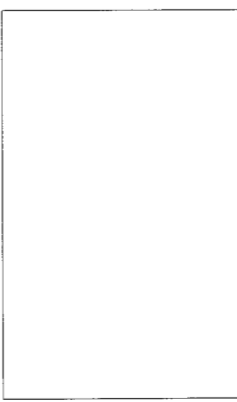

LEGEND

 NON-ASBESTOS VINYL FLOOR TILE

 NON-ASBESTOS CEILING TILES

 NON-ASBESTOS SPRAY / TROWEL APPLIED MATERIAL

 ASBESTOS CONTAINING VINYL FLOOR TILE

 ASBESTOS CONTAINING CEILING TILES

 ASBESTOS CONTAINING SPRAY / TROWEL APPLIED MATERIAL

SISC

SAFETY & LOSS CONTROL

INSPECTION DATE
02/27 - 03/29/2001

DRAWING NUMBER
030019

AHERA COMPLIANCE PROGRAM

060027-030-019
BAKERSFIELD CITY SCHOOL DISTRICT
PIONEER DRIVE SCHOOL
CLASSROOM 28

SISC - AHERA COMPLIANCE PROGRAM

County: **KERN**
Project #: **060027 - BAKERSFIELD CITY SCHOOL DISTRICT**
Campus #: **030 - PIONEER DRIVE SCHOOL**
Building #: **020 - CLASSROOM 15A**
Inspection Dates: **02/27/2001 To 03/29/2001**

Inspected by: **HAL GOUNDER**
Certification#: **3023**
State: **CA**
Gross Square Ft: **960**

***** INSPECTION RESULTS UNIFIED SAMPLING AREA - 001 *****

Material Category: **MISCELLANEOUS** Location: **CLASSROOM 15A** Material Description: **OTHER-SEE COMMENTS**

Damage Category: **N/A** Reason for Damage Category: Potential for Disturbance:

Sample#	% Asb	Date	Inspector	Sample#	% Asb	Date	Inspector
=====	=====	=====	=====	=====	=====	=====	=====

Asbestos: **N** Friable: **N/A** ACM Status: **No Suspect Material**

MATERIAL QUANTITIES

MANAGEMENT PLAN RECOMMENDATION

Recommended Response Action: Priority: Preventative Measures:

Action Election:

Response Action Schedule

Start Date Completion Date

Inspector's Comments:

SMC 2001-264&265 SEE DISTRICT DESIGNATED PERSON FOR SPECIFIC INFORMATION ON ASBESTOS FOR THIS BUILDING.

(

(

(

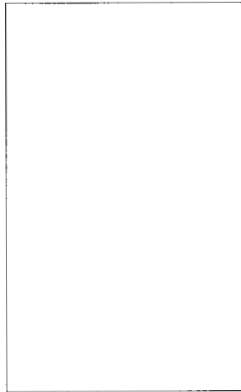

LEGEND

 NON-ASBESTOS VINYL FLOOR TILE

 NON-ASBESTOS CEILING TILES

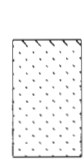
 NON-ASBESTOS SPRAY / TROWEL APPLIED MATERIAL

 ASBESTOS CONTAINING VINYL FLOOR TILE

 ASBESTOS CONTAINING CEILING TILES

 ASBESTOS CONTAINING SPRAY / TROWEL APPLIED MATERIAL

SISC

SAFETY & LOSS CONTROL

INSPECTION DATE
02/27 - 03/29/2001

DRAWING NUMBER
030020

AHERA COMPLIANCE PROGRAM

060027-030-020
BAKERSFIELD CITY SCHOOL DISTRICT
PIONEER DRIVE SCHOOL
CLASSROOM 15A