

BUILDING 001

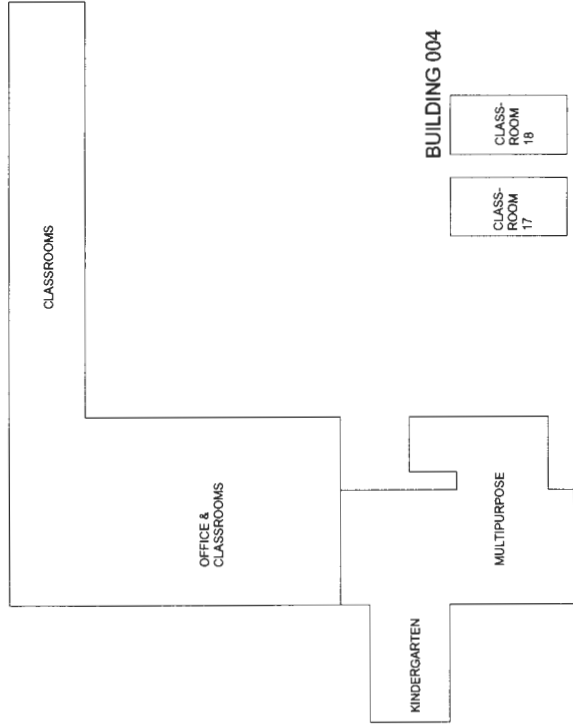

BUILDING 002

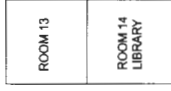

BUILDING 006



KINDERGARTEN

BUILDING 004



BUILDING 005

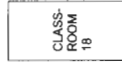

LEGEND

NEW BUILDINGS MAY HAVE BEEN ADDED TO THIS SITE. SEE NEW SITES/NEW BUILDING TAB.

SISC
SAFETY & LOSS CONTROL

INSPECTION DATE	DRAWING NUMBER
02/27 - 03/29/2001	029COV

AHERA
COMPLIANCE PROGRAM

060027-029
BAKERSFIELD CITY SCHOOL DISTRICT
WILLIAM PENN SCHOOL
SITE MAP

SISC - AHERA COMPLIANCE PROGRAM

County: **KERN**

Project #: **060027 - BAKERSFIELD CITY SCHOOL DISTRICT**

Inspected by: **HAL GOUNDER**

Campus #: **029 - WILLIAM PENN SCHOOL**

Certification#: **3023**

Building #: **001 - MPR/OFFICE/CLASSROOMS**

State: **CA**

Inspection Dates: **02/27/2001 To 03/29/2001**

Gross Square Ft: **0**

INSPECTION RESULTS UNRIED SAMPLING AREA - 001

Material Category:
SURFACING MATERIALS

Location:
MPR/OFFICE/CLASSROOMS

Material Description:
STUCCO, PLASTER

Damage Category:
N/A

Reason for Damage Category:

Potential for Disturbance:

Sample#	% Asb	Date	Inspector	Sample#	% Asb	Date	Inspector
2427	0	11/16/1988	CTL ENVIRONMENTAL	2428	0	11/16/1988	CTL ENVIRONMENTAL
61148	0	11/16/1988	CTL ENVIRONMENTAL				

Asbestos: **N** Friable: **N/A** ACM Status: **No Suspect Material**

MATERIAL QUANTITIES

MANAGEMENT PLAN RECOMMENDATION

Recommended Response Action: Priority: Preventative Measures:

Action Election:

Response Action Schedule

Start Date

Completion Date

Inspector's Comments:

SAMPLE #61448 LOCATION UNKNOWN

SISC - AHERA COMPLIANCE PROGRAM

County: **KERN**
Project #: **060027 - BAKERSFIELD CITY SCHOOL DISTRICT**
Campus #: **029 - WILLIAM PENN SCHOOL**
Building #: **001 - MPR/OFFICE/CLASSROOMS**
Inspection Dates: **02/27/2001 To 03/29/2001**

Inspected by: **HAL GOUNDER**
Certification#: **3023**
State: **CA**
Gross Square Ft: **0**

INSPECTION RESULTS UNIFIED SAMPLING AREA - 002

Material Category: **SURFACING MATERIALS** Location: **EXTERIOR WALLS** Material Description: **STUCCO, PLASTER**

Damage Category: **N/A** Reason for Damage Category: Potential for Disturbance:

Sample#	% Asb	Date	Inspector	Sample#	% Asb	Date	Inspector
2426	0	11/16/1988	CTL ENVIRONMENTAL				

Asbestos: **N** Friable: **N/A** ACM Status: **No Suspect Material**

MATERIAL QUANTITIES

8,345 SQ FEET

MANAGEMENT PLAN RECOMMENDATION

Recommended Response Action: Priority: Preventative Measures:

Action Election:

Response Action Schedule

Start Date

Completion Date

Inspector's Comments:

SISC - AHERA COMPLIANCE PROGRAM

County: **KERN**
Project #: **060027 - BAKERSFIELD CITY SCHOOL DISTRICT**
Campus #: **029 - WILLIAM PENN SCHOOL**
Building #: **001 - MPR/OFFICE/CLASSROOMS**
Inspection Dates: **02/27/2001 To 03/29/2001**

Inspected by: **HAL GOUNDER**
Certification#: **3023**
State: **CA**
Gross Square Ft: **0**

INSPECTION RESULTS UNIFIED SAMPLING AREA 003

Material Category: **MISCELLANEOUS** Location: **IMC** Material Description: **LINOLEUM**

Damage Category: **N/A** Reason for Damage Category: Potential for Disturbance:

Sample#	% Asb	Date	Inspector	Sample#	% Asb	Date	Inspector
2423	0	11/16/1988	CTL ENVIRONMENTAL				

Asbestos: **N** Friable: **N/A** ACM Status: **No Suspect Material**

MATERIAL QUANTITIES

60 SQ FEET

MANAGEMENT PLAN RECOMMENDATION

Recommended Response Action: Priority: Preventative Measures:

Action Election:

Response Action Schedule

Start Date Completion Date

Inspector's Comments:

DARK BROWN

SISC - AHERA COMPLIANCE PROGRAM

County: **KERN**
 Project #: **060027 - BAKERSFIELD CITY SCHOOL DISTRICT**
 Campus #: **029 - WILLIAM PENN SCHOOL**
 Building #: **001 - MPR/OFFICE/CLASSROOMS**
 Inspection Dates: **02/27/2001 To 03/29/2001**

Inspected by: **HAL GOUNDER**
 Certification#: **3023**
 State: **CA**
 Gross Square Ft: **0**

INSPECTION RESULTS UNIFIED SAMPLING AREA - 004

Material Category: **MISCELLANEOUS** Location: **ON FLOOR UNDER TILE** Material Description: **MASTIC**

Damage Category: **ACBM WITH POTENTIAL FOR DAMAGE** Reason for Damage Category: **MATERIAL IN GOOD CONDITION** Potential for Disturbance: **SLIGHT**

Sample#	% Asb	Date	Inspector	Sample#	% Asb	Date	Inspector
=====	=====	=====	=====	=====	=====	=====	=====
ASSUMED		08/07/1995	JAY OLSEN				

Asbestos: **Y** Friable: **N** ACM Status: **Non-Friable ACBM**

MATERIAL QUANTITIES

MANAGEMENT PLAN RECOMMENDATION

Recommended Response Action: **O&M MAINTAIN AND MONITOR** Priority: **3** Preventative Measures: **USED W/MISC. & CEMENTITIOUS MATERIAL INCL. VAFT, TRANSITE, TILE UNDERLAY & SCRATCH COATS**

Action Election: _____ Response Action Schedule

Start Date	Completion Date
=====	=====

Inspector's Comments: **MATERIAL SHOULD BE SAMPLED PRIOR TO ABATEMENT TO VERIFY ASBESTOS CONTENT.**

SISC - AHERA COMPLIANCE PROGRAM

County: **KERN**
Project #: **060027 - BAKERSFIELD CITY SCHOOL DISTRICT**
Campus #: **029 - WILLIAM PENN SCHOOL**
Building #: **001 - MPR/OFFICE/CLASSROOMS**
Inspection Dates: **02/27/2001 To 03/29/2001**

Inspected by: **HAL GOUNDER**
Certification#: **3023**
State: **CA**
Gross Square Ft: **0**

INSPECTION RESULTS UNIFIED SAMPLING AREA - 005

Material Category:
MISCELLANEOUS

Location:
CLASSROOMS 10,11,12

Material Description:
VINYL FLOOR TILE

Damage Category:
N/A

Reason for Damage Category:

Potential for Disturbance:

Sample#	% Asb	Date	Inspector	Sample#	% Asb	Date	Inspector
2408	3	11/16/1988	CTL ENVIRONMENTAL				

Asbestos: **Y** Friable: **N** ACM Status: **Non-Friable ACBM**

MATERIAL QUANTITIES

3,000 SQ FEET

MANAGEMENT PLAN RECOMMENDATION

Recommended Response Action: Priority: Preventative Measures:

Action Election:

Response Action Schedule

Start Date

Completion Date

Inspector's Comments:

12 X 12 BEIGE W/WHITE BROWN

SISC - AHERA COMPLIANCE PROGRAM

County: **KERN**
Project #: **060027 - BAKERSFIELD CITY SCHOOL DISTRICT**
Campus #: **029 - WILLIAM PENN SCHOOL**
Building #: **001 - MPR/OFFICE/CLASSROOMS**
Inspection Dates: **02/27/2001 To 03/29/2001**

Inspected by: **HAL GOUNDER**
Certification#: **3023**
State: **CA**
Gross Square Ft: **0**

INSPECTION RESULTS UNIFIED SAMPLING AREA - 006

Material Category:
MISCELLANEOUS

Location:
CLASSROOMS 2-8

Material Description:
LINOLEUM

Damage Category:
N/A

Reason for Damage Category:

Potential for Disturbance:

Sample#	% Asb	Date	Inspector	Sample#	% Asb	Date	Inspector
2406	0	11/16/1988	CTL ENVIRONMENTAL				

Asbestos: **N** Friable: **N/A** ACM Status: **No Suspect Material**

MATERIAL QUANTITIES

400 SQ FEET

MANAGEMENT PLAN RECOMMENDATION

Recommended Response Action: Priority: Preventative Measures:

Action Election:

Response Action Schedule

Start Date

Completion Date

Inspector's Comments:

GRAY

SISC - AHERA COMPLIANCE PROGRAM

County: **KERN**
 Project #: **060027 - BAKERSFIELD CITY SCHOOL DISTRICT**
 Campus #: **029 - WILLIAM PENN SCHOOL**
 Building #: **001 - MPR/OFFICE/CLASSROOMS**
 Inspection Dates: **02/27/2001 To 03/29/2001**

Inspected by: **HAL GOUNDER**
 Certification#: **3023**
 State: **CA**
 Gross Square Ft: **0**

INSPECTION RESULTS UNINED SAMPLING AREA - 007

Material Category: **MISCELLANEOUS** Location: **CLASSROOMS 2-8 EXCEPT RESTROOMS** Material Description: **ACOUSTICAL TILE (1X1)**

Damage Category: **N/A** Reason for Damage Category: Potential for Disturbance:

Sample#	% Asb	Date	Inspector	Sample#	% Asb	Date	Inspector
2407	0	11/16/1988	CTL ENVIRONMENTAL				

Asbestos: **N** Friable: **N/A** ACM Status: **No Suspect Material**

MATERIAL QUANTITIES

7,000 SQ FEET

MANAGEMENT PLAN RECOMMENDATION

Recommended Response Action: Priority: Preventative Measures:

Action Election:

Response Action Schedule

 Start Date Completion Date

Inspector's Comments:

12 X 12 WHITE RANDOM HOLES

SISC - AHERA COMPLIANCE PROGRAM

County: **KERN**
Project #: **060027 - BAKERSFIELD CITY SCHOOL DISTRICT**
Campus #: **029 - WILLIAM PENN SCHOOL**
Building #: **001 - MPR/OFFICE/CLASSROOMS**
Inspection Dates: **02/27/2001 To 03/29/2001**

Inspected by: **HAL GOUNDER**
Certification#: **3023**
State: **CA**
Gross Square Ft: **0**

INSPECTION RESULTS UNIFIED SAMPLING AREA - 008

Material Category: **MISCELLANEOUS** Location: **CLASSROOMS 2,3/LIBRARY** Material Description: **LINOLEUM**

Damage Category: **N/A** Reason for Damage Category: Potential for Disturbance:

Sample#	% Asb	Date	Inspector	Sample#	% Asb	Date	Inspector
2409	0	11/16/1988	CTL ENVIRONMENTAL				

Asbestos: **N** Friable: **N/A** ACM Status: **No Suspect Material**

MATERIAL QUANTITIES

300 SQ FEET

MANAGEMENT PLAN RECOMMENDATION

Recommended Response Action: Priority: Preventative Measures:

Action Election:

Response Action Schedule

Start Date

Completion Date

Inspector's Comments:

GREEN

SISC - AHERA COMPLIANCE PROGRAM

County: **KERN**

Project #: **060027 - BAKERSFIELD CITY SCHOOL DISTRICT**

Inspected by: **HAL GOUNDER**

Campus #: **029 - WILLIAM PENN SCHOOL**

Certification#: **3023**

Building #: **001 - MPR/OFFICE/CLASSROOMS**

State: **CA**

Inspection Dates: **02/27/2001 To 03/29/2001**

Gross Square Ft: **0**

INSPECTION RESULTS UNIFIED SAMPLING AREA 009

Material Category:
SURFACING MATERIALS

Location:
CLASSROOM 2/RESTROOMS

Material Description:
HARDWALL/CEILING PLASTER

Damage Category:
N/A

Reason for Damage Category:

Potential for Disturbance:

Sample#	% Asb	Date	Inspector	Sample#	% Asb	Date	Inspector
2410	0	11/16/1988	CTL ENVIRONMENTAL				

Asbestos: **N** Friable: **N/A** ACM Status: **No Suspect Material**

MATERIAL QUANTITIES

2,950 SQ FEET

MANAGEMENT PLAN RECOMMENDATION

Recommended Response Action: Priority: Preventative Measures:

Action Election:

Response Action Schedule

Start Date

Completion Date

Inspector's Comments:

SISC - AHERA COMPLIANCE PROGRAM

County: **KERN**

Project #: **060027 - BAKERSFIELD CITY SCHOOL DISTRICT**

Inspected by: **HAL GOUNDER**

Campus #: **029 - WILLIAM PENN SCHOOL**

Certification#: **3023**

Building #: **001 - MPR/OFFICE/CLASSROOMS**

State: **CA**

Inspection Dates: **02/27/2001 To 03/29/2001**

Gross Square Ft: **0**

INSPECTION RESULTS UNIFIED SAMPLING AREA - 010

Material Category:
MISCELLANEOUS

Location:
CLASSROOMS 2,3,5/LIBRARY

Material Description:
VINYL FLOOR TILE

Damage Category:
N/A

Reason for Damage Category:

Potential for Disturbance:

Sample#	% Asb	Date	Inspector	Sample#	% Asb	Date	Inspector
2411	0	11/16/1988	CTL ENVIRONMENTAL				

Asbestos: **N** Friable: **N/A** ACM Status: **No Suspect Material**

MATERIAL QUANTITIES

4,000 SQ FEET

MANAGEMENT PLAN RECOMMENDATION

Recommended Response Action: Priority: Preventative Measures:

Action Election:

Response Action Schedule

Start Date

Completion Date

Inspector's Comments:

12 X 12 TAN W/BROWN & WHITE

SISC - AHERA COMPLIANCE PROGRAM

County: **KERN**
Project #: **060027 - BAKERSFIELD CITY SCHOOL DISTRICT**
Campus #: **029 - WILLIAM PENN SCHOOL**
Building #: **001 - MPR/OFFICE/CLASSROOMS**
Inspection Dates: **02/27/2001 To 03/29/2001**

Inspected by: **HAL GOUNDER**
Certification#: **3023**
State: **CA**
Gross Square Ft: **0**

INSPECTION RESULTS UNIFIED SAMPLING AREA - 011

Material Category: **THERMAL SYSTEM INSULATION** Location: **CUSTODIAN AND ATTIC** Material Description: **MJP ON NON-SUSPECT PIPE COVERING**

Damage Category: **ACBM WITH POTENTIAL FOR DAMAGE** Reason for Damage Category: **MATERIAL IN FAIR CONDITION** Potential for Disturbance: **SLIGHT**

Sample#	% Asb	Date	Inspector	Sample#	% Asb	Date	Inspector
=====	=====	=====	=====	=====	=====	=====	=====
ASSUMED		11/16/1988	CTL ENVIRONMENTAL				

Asbestos: **Y** Friable: **Y** ACM Status: **Friable ACBM**

MATERIAL QUANTITIES

31 ELBOWS

MANAGEMENT PLAN RECOMMENDATION

Recommended Response Action: **O&M MAINTAIN AND MONITOR** Priority: **3** Preventative Measures: **FOR USE W/PIPE INSULATION & MUDDED JOINT FITTINGS**

Action Election: _____ Response Action Schedule

Start Date	Completion Date
=====	=====

Inspector's Comments: _____

SISC AHERA COMPLIANCE PROGRAM

County: **KERN**
Project #: **060027 - BAKERSFIELD CITY SCHOOL DISTRICT**
Campus #: **029 - WILLIAM PENN SCHOOL**
Building #: **001 - MPR/OFFICE/CLASSROOMS**
Inspection Dates: **02/27/2001 To 03/29/2001**

Inspected by: **HAL GOUNDER**
Certification#: **3023**
State: **CA**
Gross Square Ft: **0**

INSPECTION RESULTS UNIFIED SAMPLING AREA 012

Material Category: **MISCELLANEOUS** Location: **ENTIRE BLDG EXCEPT RR/MECH/STORAGE** Material Description: **ACOUSTICAL TILE (1X1)**

Damage Category: **N/A** Reason for Damage Category: Potential for Disturbance:

Sample#	% Asb	Date	Inspector	Sample#	% Asb	Date	Inspector
2412	0	11/16/1988	CTL ENVIRONMENTAL				

Asbestos: **N** Friable: **N/A** ACM Status: **No Suspect Material**

MATERIAL QUANTITIES

7,400 SQ FEET

MANAGEMENT PLAN RECOMMENDATION

Recommended Response Action: Priority: Preventative Measures:

Action Election:

Response Action Schedule

Start Date Completion Date

Inspector's Comments:

12 X 12 WHITE W/RANDOM HOLES

SISC - AHERA COMPLIANCE PROGRAM

County: **KERN**
Project #: **060027 - BAKERSFIELD CITY SCHOOL DISTRICT**
Campus #: **029 - WILLIAM PENN SCHOOL**
Building #: **001 - MPR/OFFICE/CLASSROOMS**
Inspection Dates: **02/27/2001 To 03/29/2001**

Inspected by: **HAL GOUNDER**
Certification#: **3023**
State: **CA**
Gross Square Ft: **0**

INSPECTION RESULTS UNIFIED SAMPLING AREA - 013

Material Category:
MISCELLANEOUS

Location:
CLASSROOMS

Material Description:
LINOLEUM

Damage Category:
N/A

Reason for Damage Category:

Potential for Disturbance:

Sample#	% Asb	Date	Inspector	Sample#	% Asb	Date	Inspector
2413	0	11/16/1988	CTL ENVIRONMENTAL				

Asbestos: **N** Friable: **N/A** ACM Status: **No Suspect Material**

MATERIAL QUANTITIES

500 SQ FEET

MANAGEMENT PLAN RECOMMENDATION

Recommended Response Action: Priority: Preventative Measures:

Action Election:

Response Action Schedule

Start Date

Completion Date

Inspector's Comments:

GREEN/SAMPLE LOCATION UNKNOWN

SISC AHERA COMPLIANCE PROGRAM

County: **KERN**
Project #: **060027 - BAKERSFIELD CITY SCHOOL DISTRICT**
Campus #: **029 - WILLIAM PENN SCHOOL**
Building #: **001 - MPR/OFFICE/CLASSROOMS**
Inspection Dates: **02/27/2001 To 03/29/2001**

Inspected by: **HAL GOUNDER**
Certification#: **3023**
State: **CA**
Gross Square Ft: **0**

INSPECTION RESULTS UNIFIED SAMPLING AREA 014

Material Category: **MISCELLANEOUS** Location: **HEALTH ROOM** Material Description: **LINOLEUM**

Damage Category: **N/A** Reason for Damage Category: Potential for Disturbance:

Sample#	% Asb	Date	Inspector	Sample#	% Asb	Date	Inspector
2414	0	11/16/1988	CTL ENVIRONMENTAL				

Asbestos: **N** Friable: **N/A** ACM Status: **No Suspect Material**

MATERIAL QUANTITIES

50 SQ FEET

MANAGEMENT PLAN RECOMMENDATION

Recommended Response Action: Priority: Preventative Measures:

Action Election:

Response Action Schedule

Start Date

Completion Date

Inspector's Comments:

BROWN/WHITE

SISC - AHERA COMPLIANCE PROGRAM

County: **KERN**
 Project #: **060027 - BAKERSFIELD CITY SCHOOL DISTRICT**
 Campus #: **029 - WILLIAM PENN SCHOOL**
 Building #: **001 - MPR/OFFICE/CLASSROOMS**
 Inspection Dates: **02/27/2001 To 03/29/2001**

Inspected by: **HAL GOUNDER**
 Certification#: **3023**
 State: **CA**
 Gross Square Ft: **0**

INSPECTION RESULTS UNIFIED SAMPLING AREA: 015

Material Category: **MISCELLANEOUS** Location: **ON FLOOR UNDER TILE** Material Description: **MASTIC**

Damage Category: **ACBM WITH POTENTIAL FOR DAMAGE** Reason for Damage Category: **MATERIAL IN GOOD CONDITION** Potential for Disturbance: **SLIGHT**

Sample#	% Asb	Date	Inspector	Sample#	% Asb	Date	Inspector
=====	=====	=====	=====	=====	=====	=====	=====
ASSUMED		08/07/1995	JAY OLSEN				

Asbestos: **Y** Friable: **N** ACM Status: **Non-Friable ACBM**

MATERIAL QUANTITIES

MANAGEMENT PLAN RECOMMENDATION

Recommended Response Action: **O&M MAINTAIN AND MONITOR** Priority: **3** Preventative Measures: **USED W/MISC. & CEMENTITIOUS MATERIAL INCL. VAFT, TRANSITE, TILE UNDERLAY & SCRATCH COATS**

Action Election:

Response Action Schedule	
Start Date	Completion Date
=====	=====

Inspector's Comments:
MATERIAL SHOULD BE SAMPLED PRIOR TO ABATEMENT TO VERIFY ASBESTOS CONTENT.

SISC - AHERA COMPLIANCE PROGRAM

County: **KERN**
 Project #: **060027 - BAKERSFIELD CITY SCHOOL DISTRICT**
 Campus #: **029 - WILLIAM PENN SCHOOL**
 Building #: **001 - MPR/OFFICE/CLASSROOMS**
 Inspection Dates: **02/27/2001 To 03/29/2001**

Inspected by: **HAL GOUNDER**
 Certification#: **3023**
 State: **CA**
 Gross Square Ft: **0**

INSPECTION RESULTS UNIFIED SAMPLING AREA - 016

Material Category:
MISCELLANEOUS

Location:
**ENTIRE BLDG EXCEPT
 RR/MECH/STORAGE**

Material Description:
VINYL FLOOR TILE

Damage Category:
N/A

Reason for Damage Category:

Potential for Disturbance:

Sample#	% Asb	Date	Inspector	Sample#	% Asb	Date	Inspector
2416	0	11/16/1988	CTL ENVIRONMENTAL				

Asbestos: **N** Friable: **N/A** ACM Status: **No Suspect Material**

MATERIAL QUANTITIES

7,400 SQ FEET

MANAGEMENT PLAN RECOMMENDATION

Recommended Response Action: Priority: Preventative Measures:

Action Election:

Response Action Schedule

Start Date

Completion Date

Inspector's Comments:

12 X 12 TAN

SISC - AHERA COMPLIANCE PROGRAM

County: **KERN**
Project #: **060027 - BAKERSFIELD CITY SCHOOL DISTRICT**
Campus #: **029 - WILLIAM PENN SCHOOL**
Building #: **001 - MPR/OFFICE/CLASSROOMS**
Inspection Dates: **02/27/2001 To 03/29/2001**

Inspected by: **HAL GOUNDER**
Certification#: **3023**
State: **CA**
Gross Square Ft: **0**

INSPECTION RESULTS UNIFIED SAMPLING AREA - 018

Material Category: **MISCELLANEOUS** Location: **NURSES/DITTO RM/OFFICE/KITCHEN** Material Description: **LINOLEUM**

Damage Category: **N/A** Reason for Damage Category: Potential for Disturbance:

Sample#	% Asb	Date	Inspector	Sample#	% Asb	Date	Inspector
2415	0	11/16/1988	CTL ENVIRONMENTAL				

Asbestos: **N** Friable: **N/A** ACM Status: **No Suspect Material**

MATERIAL QUANTITIES

220 SQ FEET

MANAGEMENT PLAN RECOMMENDATION

Recommended Response Action: Priority: Preventative Measures:

Action Election:

Response Action Schedule

Start Date Completion Date

Inspector's Comments:

RED & COUNTER TOPS

SISC - AHERA COMPLIANCE PROGRAM

County: **KERN**
Project #: **060027 - BAKERSFIELD CITY SCHOOL DISTRICT**
Campus #: **029 - WILLIAM PENN SCHOOL**
Building #: **001 - MPR/OFFICE/CLASSROOMS**
Inspection Dates: **02/27/2001 To 03/29/2001**

Inspected by: **HAL GOUNDER**
Certification#: **3023**
State: **CA**
Gross Square Ft: **0**

INSPECTION RESULTS UNIFIED SAMPLING AREA 021

Material Category: **THERMAL SYSTEM INSULATION** Location: **STAGE ATTIC** Material Description: **MJP ON NON-SUSPECT PIPE COVERING**

Damage Category: **ACBM WITH POTENTIAL FOR DAMAGE** Reason for Damage Category: **MATERIAL IN FAIR CONDITION** Potential for Disturbance: **SLIGHT**

Sample#	% Asb	Date	Inspector	Sample#	% Asb	Date	Inspector
=====	=====	=====	=====	=====	=====	=====	=====
ASSUMED		11/16/1988	CTL ENVIRONMENTAL				

Asbestos: **Y** Friable: **Y** ACM Status: **Friable ACBM**

MATERIAL QUANTITIES

10 ELBOWS

MANAGEMENT PLAN RECOMMENDATION

Recommended Response Action: **O&M MAINTAIN AND MONITOR** Priority: **3** Preventative Measures: **FOR USE W/PIPE INSULATION & MUDDED JOINT FITTINGS**

Action Election: _____ Response Action Schedule
Start Date _____ Completion Date _____
Inspector's Comments: _____
=====

SISC - AHERA COMPLIANCE PROGRAM

County: **KERN**
 Project #: **060027 - BAKERSFIELD CITY SCHOOL DISTRICT**
 Campus #: **029 - WILLIAM PENN SCHOOL**
 Building #: **001 - MPR/OFFICE/CLASSROOMS**
 Inspection Dates: **02/27/2001 To 03/29/2001**

Inspected by: **HAL GOUNDER**
 Certification#: **3023**
 State: **CA**
 Gross Square Ft: **0**

INSPECTION RESULTS UNIFIED SAMPLING AREA - 023

Material Category:
SURFACING MATERIALS

Location:
MULTIPURPOSE ROOM

Material Description:
HARDWALL/CEILING PLASTER

Damage Category:
N/A

Reason for Damage Category:

Potential for Disturbance:

Sample#	% Asb	Date	Inspector	Sample#	% Asb	Date	Inspector
2424	0	11/16/1988	CTL ENVIRONMENTAL				

Asbestos: **N** Friable: **N/A** ACM Status: **No Suspect Material**

MATERIAL QUANTITIES

9,050 SQ FEET

MANAGEMENT PLAN RECOMMENDATION

Recommended Response Action: Priority: Preventative Measures:

Action Election:

Response Action Schedule

Start Date

Completion Date

Inspector's Comments:

SISE - AHERA COMPLIANCE PROGRAM

County: KERN
Project #: 060027 - BAKERSFIELD CITY SCHOOL DISTRICT
Campus #: 029 - WILLIAM PENN SCHOOL
Building #: 001 - MPR/OFFICE/CLASSROOMS
Inspection Dates: 02/27/2001 To 03/29/2001

Inspected by: HAL GOUNDER
Certification#: 3023
State: CA
Gross Square Ft: 0

INSPECTION RESULTS UNIFIED SAMPLING AREA - 024

Material Category: SURFACING MATERIALS

Location: CLASSROOM 5

Material Description: HARDWALL/CEILING PLASTER

Damage Category: N/A

Reason for Damage Category:

Potential for Disturbance:

Table with 8 columns: Sample#, % Asb, Date, Inspector, Sample#, % Asb, Date, Inspector. Row 1: 2418, 0, 11/16/1988, CTL ENVIRONMENTAL

Asbestos: N Friable: N/A ACM Status: No Suspect Material

MATERIAL QUANTITIES

11,620 SQ FEET

MANAGEMENT PLAN RECOMMENDATION

Recommended Response Action: Priority: Preventative Measures:

Action Election:

Response Action Schedule

Start Date

Completion Date

Inspector's Comments:

SISC - AHERA COMPLIANCE PROGRAM

County: **KERN**
 Project #: **060027 - BAKERSFIELD CITY SCHOOL DISTRICT**
 Campus #: **029 - WILLIAM PENN SCHOOL**
 Building #: **001 - MPR/OFFICE/CLASSROOMS**
 Inspection Dates: **02/27/2001 To 03/29/2001**

Inspected by: **HAL GOUNDER**
 Certification#: **3023**
 State: **CA**
 Gross Square Ft: **0**

INSPECTION RESULTS UNIFIED SAMPLING AREA - 025

Material Category: **MISCELLANEOUS** Location: **ON FLOOR UNDER TILE** Material Description: **MASTIC**

Damage Category: **ACBM WITH POTENTIAL FOR DAMAGE** Reason for Damage Category: **MATERIAL IN GOOD CONDITION** Potential for Disturbance: **SLIGHT**

Sample#	% Asb	Date	Inspector	Sample#	% Asb	Date	Inspector
ASSUMED		08/07/1995	JAY OLSEN				

Asbestos: **Y** Friable: **N** ACM Status: **Non-Friable ACBM**

MATERIAL QUANTITIES

MANAGEMENT PLAN RECOMMENDATION

Recommended Response Action: **O&M MAINTAIN AND MONITOR** Priority: **3** Preventative Measures: **USED W/MISC. & CEMENTITIOUS MATERIAL INCL. VAFT, TRANSITE, TILE UNDERLAY & SCRATCH COATS**

Action Election: _____ Response Action Schedule

Start Date	Completion Date
=====	=====

Inspector's Comments: **MATERIAL SHOULD BE SAMPLED PRIOR TO ABATEMENT TO VERIFY ASBESTOS CONTENT.**

SISC - AHERA COMPLIANCE PROGRAM

County: **KERN**
Project #: **060027 - BAKERSFIELD CITY SCHOOL DISTRICT**
Campus #: **029 - WILLIAM PENN SCHOOL**
Building #: **001 - MPR/OFFICE/CLASSROOMS**
Inspection Dates: **02/27/2001 To 03/29/2001**

Inspected by: **HAL GOUNDER**
Certification#: **3023**
State: **CA**
Gross Square Ft: **0**

INSPECTION RESULTS UNIFIED SAMPLING AREA - 026

Material Category: **MISCELLANEOUS** Location: **MPR/ENTRY/RESTROOM** Material Description: **VINYL FLOOR TILE**

Damage Category: **ACBM WITH POTENTIAL FOR DAMAGE** Reason for Damage Category: **MATERIAL IN GOOD CONDITION** Potential for Disturbance: **SLIGHT**

Sample#	% Asb	Date	Inspector	Sample#	% Asb	Date	Inspector
2425	0	11/16/1988	CTL ENVIRONMENTAL				

Asbestos: **N** Friable: **N/A** ACM Status: **No Suspect Material**

MATERIAL QUANTITIES

5,310 SQ FEET

MANAGEMENT PLAN RECOMMENDATION

Recommended Response Action: Priority: Preventative Measures:

Action Election:

Response Action Schedule

Start Date Completion Date

Inspector's Comments:

12 X 12 TAN W/WHITE

SISC - AHERA COMPLIANCE PROGRAM

County: **KERN**
 Project #: **060027 - BAKERSFIELD CITY SCHOOL DISTRICT**
 Campus #: **029 - WILLIAM PENN SCHOOL**
 Building #: **001 - MPR/OFFICE/CLASSROOMS**
 Inspection Dates: **02/27/2001 To 03/29/2001**

Inspected by: **HAL GOUNDER**
 Certification#: **3023**
 State: **CA**
 Gross Square Ft: **0**

*** **INSPECTION RESULTS UNIFIED SAMPLING AREA - 027** ***

Material Category: **MISCELLANEOUS** Location: **CLASSROOM 1 / KINDERGARTEN** Material Description: **LINOLEUM**

Damage Category: **N/A** Reason for Damage Category: Potential for Disturbance:

Sample#	% Asb	Date	Inspector	Sample#	% Asb	Date	Inspector
2419	0	11/16/1988	CTL ENVIRONMENTAL				

Asbestos: **N** Friable: **N/A** ACM Status: **No Suspect Material**

MATERIAL QUANTITIES

60 SQ FEET

MANAGEMENT PLAN RECOMMENDATION

Recommended Response Action: Priority: Preventative Measures:

Action Election:

Response Action Schedule

 Start Date Completion Date

Inspector's Comments:

GREEN

SISC - AHERA COMPLIANCE PROGRAM

County: **KERN**
 Project #: **060027 - BAKERSFIELD CITY SCHOOL DISTRICT**
 Campus #: **029 - WILLIAM PENN SCHOOL**
 Building #: **001 - MPR/OFFICE/CLASSROOMS**
 Inspection Dates: **02/27/2001 To 03/29/2001**

Inspected by: **HAL GOUNDER**
 Certification#: **3023**
 State: **CA**
 Gross Square Ft: **0**

***** INSPECTION RESULTS UNIFIED SAMPLING AREA - 028 *****

Material Category: **MISCELLANEOUS** Location: **CLASSROOM 1 / KINDERGARTEN** Material Description: **LINOLEUM**

Damage Category: **N/A** Reason for Damage Category: Potential for Disturbance:

Sample#	% Asb	Date	Inspector	Sample#	% Asb	Date	Inspector
2420	0	11/16/1988	CTL ENVIRONMENTAL				

Asbestos: **N** Friable: **N/A** ACM Status: **No Suspect Material**

MATERIAL QUANTITIES

40 SQ FEET

MANAGEMENT PLAN RECOMMENDATION

Recommended Response Action: Priority: Preventative Measures:

Action Election:

Response Action Schedule

 Start Date Completion Date

Inspector's Comments:

DARK BROWN

SISC - AHERA COMPLIANCE PROGRAM

County: **KERN**
 Project #: **060027 - BAKERSFIELD CITY SCHOOL DISTRICT**
 Campus #: **029 - WILLIAM PENN SCHOOL**
 Building #: **001 - MPR/OFFICE/CLASSROOMS**
 Inspection Dates: **02/27/2001 To 03/29/2001**

Inspected by: **HAL GOUNDER**
 Certification#: **3023**
 State: **CA**
 Gross Square Ft: **0**

***** INSPECTION RESULTS UNIFIED SAMPLING AREA - 029 *****

Material Category: **MISCELLANEOUS** Location: **CLASSROOM 1 / KINDERGARTEN** Material Description: **VINYL FLOOR TILE**

Damage Category: **N/A** Reason for Damage Category: Potential for Disturbance:

Sample#	% Asb	Date	Inspector	Sample#	% Asb	Date	Inspector
2421	0	11/16/1988	CTL ENVIRONMENTAL				

Asbestos: **N** Friable: **N/A** ACM Status: **No Suspect Material**

MATERIAL QUANTITIES

2,500 SQ FEET

MANAGEMENT PLAN RECOMMENDATION

Recommended Response Action: Priority: Preventative Measures:

Action Election:

Response Action Schedule

Start Date Completion Date

Inspector's Comments:

12 X 12 OFF WHITE W/WHITE & GRAY

SISC - AHERA COMPLIANCE PROGRAM

County: **KERN**
Project #: **060027 - BAKERSFIELD CITY SCHOOL DISTRICT**
Campus #: **029 - WILLIAM PENN SCHOOL**
Building #: **001 - MPR/OFFICE/CLASSROOMS**
Inspection Dates: **02/27/2001 To 03/29/2001**

Inspected by: **HAL GOUNDER**
Certification#: **3023**
State: **CA**
Gross Square Ft: **0**

***** INSPECTION RESULTS UNIFIED SAMPLING AREA - 030 *****

Material Category: **MISCELLANEOUS** Location: **CLASSROOM
1/KINDERGARTEN/MPR/ENTRY/KITCHEN** Material Description: **ACOUSTICAL TILE (1X1)**

Damage Category: **N/A** Reason for Damage Category: Potential for Disturbance:

Sample#	% Asb	Date	Inspector	Sample#	% Asb	Date	Inspector
2422	0	11/16/1988	CTL ENVIRONMENTAL				

Asbestos: **N** Friable: **N/A** ACM Status: **No Suspect Material**

MATERIAL QUANTITIES

6,500 SQ FEET

MANAGEMENT PLAN RECOMMENDATION

Recommended Response Action: Priority: Preventative Measures:

Action Election:

Response Action Schedule

Start Date Completion Date

Inspector's Comments:

12 X 12 WHITE W/RANDOM HOLES

SISC: AHERA COMPLIANCE PROGRAM

County: **KERN**
Project #: **060027 - BAKERSFIELD CITY SCHOOL DISTRICT**
Campus #: **029 - WILLIAM PENN SCHOOL**
Building #: **001 - MPR/OFFICE/CLASSROOMS**
Inspection Dates: **02/27/2001 To 03/29/2001**

Inspected by: **HAL GOUNDER**
Certification#: **3023**
State: **CA**
Gross Square Ft: **0**

INSPECTION RESULTS UNIFIED SAMPLING AREA 031

Material Category: **MISCELLANEOUS** Location: **CLASSROOMS** Material Description: **DROP OR LAY-IN PANEL**

Damage Category: **N/A** Reason for Damage Category: Potential for Disturbance:

Sample#	% Asb	Date	Inspector	Sample#	% Asb	Date	Inspector
=====	=====	=====	=====	=====	=====	=====	=====

Asbestos: **N** Friable: **N/A** ACM Status: **No Suspect Material**

MATERIAL QUANTITIES

MANAGEMENT PLAN RECOMMENDATION

Recommended Response Action: Priority: Preventative Measures:

Action Election:

Response Action Schedule

Start Date Completion Date

Inspector's Comments:

New material-does not contain asbestos.

SISC - AHERA COMPLIANCE PROGRAM

County: **KERN**
Project #: **060027 - BAKERSFIELD CITY SCHOOL DISTRICT**
Campus #: **029 - WILLIAM PENN SCHOOL**
Building #: **001 - MPR/OFFICE/CLASSROOMS**
Inspection Dates: **02/27/2001 To 03/29/2001**

Inspected by: **HAL GOUNDER**
Certification#: **3023**
State: **CA**
Gross Square Ft: **0**

INSPECTION RESULTS UNIFIED SAMPLING AREA - 032

Material Category: **MISCELLANEOUS** Location: **MPR STAGE** Material Description: **TRANSITE PANEL**

Damage Category: **N/A** Reason for Damage Category: Potential for Disturbance:

Sample#	% Asb	Date	Inspector	Sample#	% Asb	Date	Inspector
ASSUMED		03/19/2001	HAL GOUNDER				

Asbestos: **Y** Friable: **N** ACM Status: **Non-Friable Assumed**

MATERIAL QUANTITIES

600 SQ FT

MANAGEMENT PLAN RECOMMENDATION

Recommended Response Action: **O&M MAINTAIN AND MONITOR** Priority: **3** Preventative Measures: **USED W/MISC. & CEMENTITIOUS MATERIAL INCL. VAFT, TRANSITE, TILE UNDERLAY & SCRATCH COATS**

Action Election: Response Action Schedule

Start Date	Completion Date
=====	=====

Inspector's Comments: **CORRIGATED PANEL IS LOCATED ABOVE STAGE PAINTED WHITE.**

SISC - AHERA COMPLIANCE PROGRAM

County: **KERN**
 Project #: **060027 - BAKERSFIELD CITY SCHOOL DISTRICT**
 Campus #: **029 - WILLIAM PENN SCHOOL**
 Building #: **001 - MPR/OFFICE/CLASSROOMS**
 Inspection Dates: **02/27/2001 To 03/29/2001**

Inspected by: **HAL GOUNDER**
 Certification#: **3023**
 State: **CA**
 Gross Square Ft: **0**

INSPECTION RESULTS UNIFIED SAMPLING AREA - 033

Material Category:
THERMAL SYSTEM INSULATION

Location:
ATTIC

Material Description:
PIPE COVERING

Damage Category:
ACBM WITH POTENTIAL FOR DAMAGE

Reason for Damage Category:
MATERIAL IN FAIR CONDITION

Potential for Disturbance: **SLIGHT**

Sample#	% Asb	Date	Inspector	Sample#	% Asb	Date	Inspector
=====	=====	=====	=====	=====	=====	=====	=====
ASSUMED		03/15/2001	HAL GOUNDER				

Asbestos: **Y** Friable: **Y** ACM Status: **Friable Assumed**

MATERIAL QUANTITIES

400 LINEAR FEET

4" AND 6" OD

MANAGEMENT PLAN RECOMMENDATION

Recommended Response Action:

O&M MAINTAIN AND MONITOR

Priority:

3

Preventative Measures:

FOR USE W/PIPE INSULATION & MUDDED JOINT FITTINGS

Action Election:

Response Action Schedule

 Start Date

 Completion Date

Inspector's Comments:

 =====

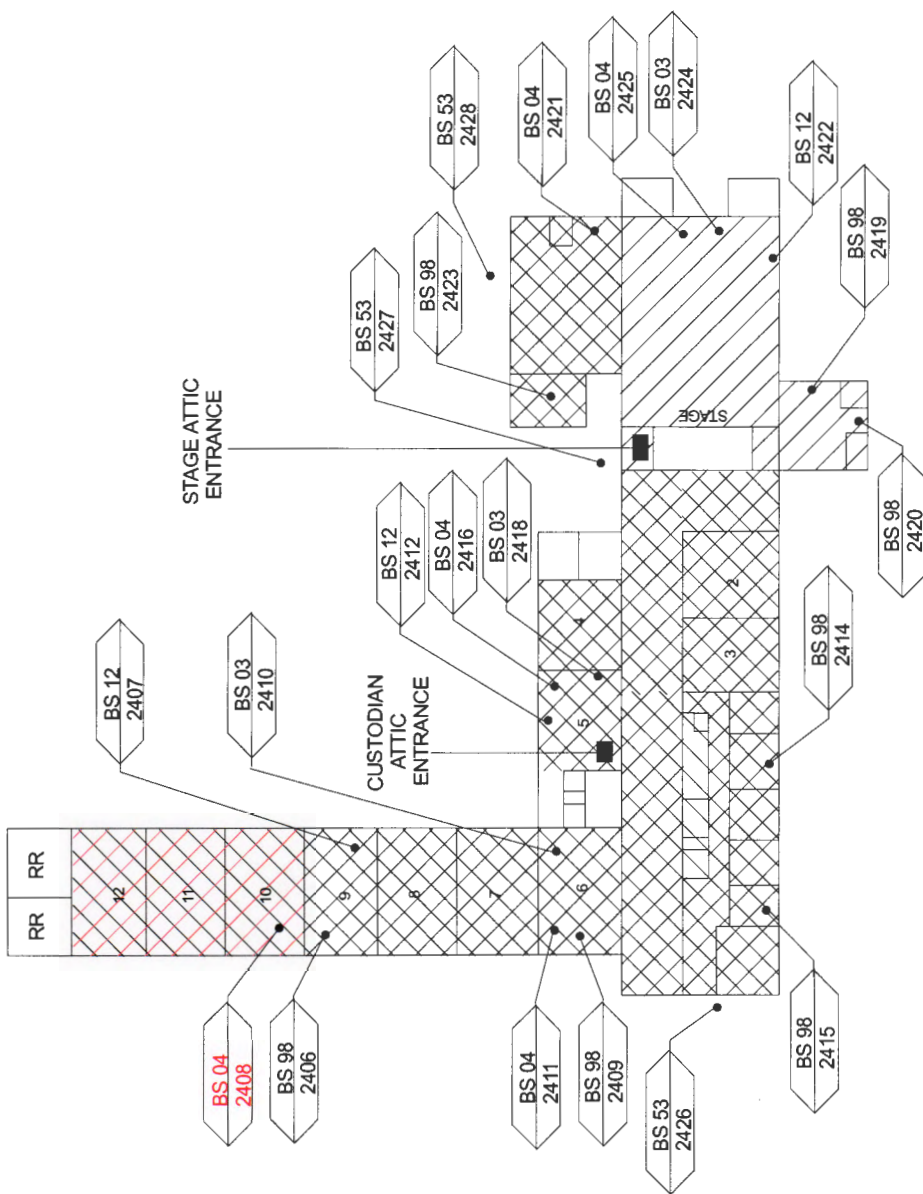

AHERA COMPLIANCE PROGRAM
 060027-029-001
 BAKERSFIELD CITY SCHOOL DISTRICT
 WILLIAM PENN SCHOOL
 MPR / OFFICE / CLASSROOMS

SISC SAFETY & LOSS CONTROL
 INSPECTION DATE: 02/27 - 03/29/2001
 DRAWING NUMBER: 029001

LEGEND	
	NON-ASBESTOS VINYL FLOOR TILE
	NON-ASBESTOS CEILING TILES
	NON-ASBESTOS SPRAY / TROWEL APPLIED MATERIAL
	ASBESTOS CONTAINING VINYL FLOOR TILE
	ASBESTOS CONTAINING CEILING TILES
	ASBESTOS CONTAINING SPRAY / TROWEL APPLIED MATERIAL

SIS - AHERA COMPLIANCE PROGRAM

County: **KERN**
Project #: **060027 - BAKERSFIELD CITY SCHOOL DISTRICT**
Campus #: **029 - WILLIAM PENN SCHOOL**
Building #: **002 - CLASSROOMS 13-14/LIBRARY**
Inspection Dates: **02/27/2001 To 03/29/2001**

Inspected by: **HAL GOUNDER**
Certification#: **3023**
State: **CA**
Gross Square Ft: **0**

INSPECTION RESULTS UNIFIED SAMPLING AREA - 001

Material Category:
MISCELLANEOUS

Location:
ENTIRE BUILDING

Material Description:
WALLBOARD

Damage Category:
N/A

Reason for Damage Category:

Potential for Disturbance:

Sample#	% Asb	Date	Inspector	Sample#	% Asb	Date	Inspector
2404	0	11/16/1988	CTL ENVIRONMENTAL				

Asbestos: **N** Friable: **N/A** ACM Status: **No Suspect Material**

MATERIAL QUANTITIES

2,200 SQ FEET

MANAGEMENT PLAN RECOMMENDATION

Recommended Response Action: Priority: Preventative Measures:

Action Election:

Response Action Schedule

Start Date

Completion Date

Inspector's Comments:

BS. 52
2404

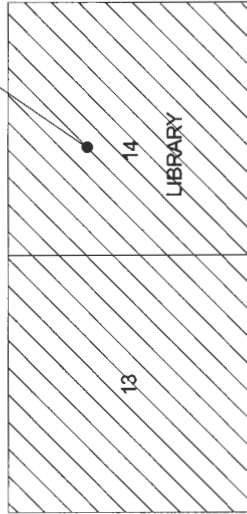

LEGEND

NON-ASBESTOS
VINYL FLOOR TILE

NON-ASBESTOS
CEILING TILES

NON-ASBESTOS
SPRAY / TROWEL
APPLIED MATERIAL

ASBESTOS
CONTAINING
VINYL FLOOR TILE

ASBESTOS
CONTAINING
CEILING TILES

ASBESTOS
CONTAINING
SPRAY / TROWEL
APPLIED MATERIAL

SISC
SAFETY & LOSS CONTROL

INSPECTION
DATE
02/27 - 03/29/2001

DRAWING
NUMBER
029002

**AHERA
COMPLIANCE PROGRAM**

060027-029-002
BAKERSFIELD CITY SCHOOL DISTRICT
WILLIAM PENN SCHOOL
CLASSROOM 13-14/LIBRARY

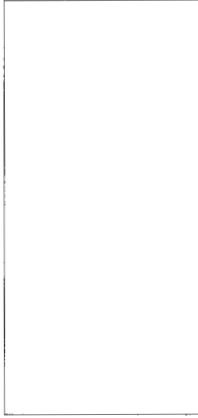

NO SUSPECT MATERIAL

LEGEND



NON-ASBESTOS
VINYL FLOOR TILE

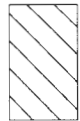

NON-ASBESTOS
CEILING TILES

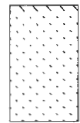

NON-ASBESTOS
SPRAY / TROWEL
APPLIED MATERIAL



ASBESTOS
CONTAINING
VINYL FLOOR TILE

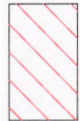

ASBESTOS
CONTAINING
CEILING TILES



ASBESTOS
CONTAINING
SPRAY / TROWEL
APPLIED MATERIAL

SISC

SAFETY & LOSS CONTROL

INSPECTION
DATE

02/27 - 03/29/2001

DRAWING
NUMBER

029004

**AHERA
COMPLIANCE PROGRAM**

060027-029-004
BAKERSFIELD CITY SCHOOL DISTRICT
WILLIAM PENN SCHOOL
CLASSROOM 18

SISCA/ASHERA COMPLIANCE PROGRAM

County: **KERN**
Project #: **060027 - BAKERSFIELD CITY SCHOOL DISTRICT**
Campus #: **029 - WILLIAM PENN SCHOOL**
Building #: **005 - ROOM 17**
Inspection Dates: **02/27/2001 To 03/29/2001**

Inspected by: **HAL GOUNDER**
Certification#: **3023**
State: **CA**
Gross Square Ft: **0**

INSPECTION RESULTS UNIFIED SAMPLING AREA 00

Material Category:
MISCELLANEOUS

Location:

Material Description:
NO SUSPECT MATERIAL

Damage Category:
N/A

Reason for Damage Category:

Potential for Disturbance:

Sample#	% Asb	Date	Inspector	Sample#	% Asb	Date	Inspector
=====	=====	=====	=====	=====	=====	=====	=====

Asbestos: **N** Friable: **N/A** ACM Status: **No Suspect Material**

MATERIAL QUANTITIES

MANAGEMENT PLAN RECOMMENDATION

Recommended Response Action: Priority: Preventative Measures:

Action Election:

Response Action Schedule

Start Date Completion Date

Inspector's Comments:

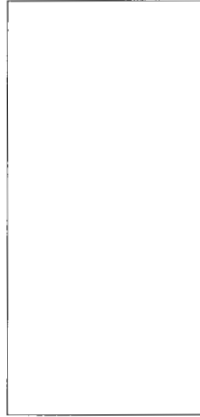

NO SUSPECT MATERIAL

LEGEND



NON-ASBESTOS
VINYL FLOOR TILE

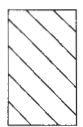

NON-ASBESTOS
CEILING TILES



NON-ASBESTOS
SPRAY / TROWEL
APPLIED MATERIAL



ASBESTOS
CONTAINING
VINYL FLOOR TILE



ASBESTOS
CONTAINING
CEILING TILES



ASBESTOS
CONTAINING
SPRAY / TROWEL
APPLIED MATERIAL

SISC

SAFETY & LOSS CONTROL

INSPECTION
DATE
02/27 - 03/29/2001

DRAWING
NUMBER
029005

**AHERA
COMPLIANCE PROGRAM**

060027-029-005
BAKERSFIELD CITY SCHOOL DISTRICT
WILLIAM PENN SCHOOL
CLASSROOM 17

SISC / AHERA COMPLIANCE PROGRAM

County: **KERN**
Project #: **060027 - BAKERSFIELD CITY SCHOOL DISTRICT**
Campus #: **029 - WILLIAM PENN SCHOOL**
Building #: **006 - RSP**
Inspection Dates: **02/27/2001 To 03/29/2001**

Inspected by: **HAL GOUNDER**
Certification#: **3023**
State: **CA**
Gross Square Ft: **0**

INSPECTION RESULTS UNIFIED SAMPLING AREA - 001

Material Category: **MISCELLANEOUS** Location: Material Description: **NO SUSPECT MATERIAL**

Damage Category: **N/A** Reason for Damage Category: Potential for Disturbance:

Sample#	% Asb	Date	Inspector	Sample#	% Asb	Date	Inspector
=====	=====	=====	=====	=====	=====	=====	=====

Asbestos: **N** Friable: **N/A** ACM Status: **No Suspect Material**

MATERIAL QUANTITIES

MANAGEMENT PLAN RECOMMENDATION

Recommended Response Action: Priority: Preventative Measures:

Action Election:

Response Action Schedule

Start Date

Completion Date

Inspector's Comments:

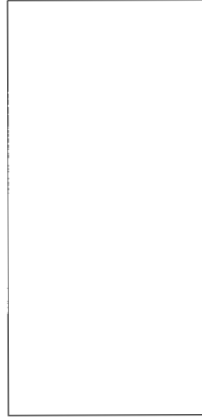

NO SUSPECT MATERIAL

LEGEND

 NON-ASBESTOS VINYL FLOOR TILE

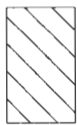
 NON-ASBESTOS CEILING TILES

 NON-ASBESTOS SPRAY / TROWEL APPLIED MATERIAL

 ASBESTOS CONTAINING VINYL FLOOR TILE

 ASBESTOS CONTAINING CEILING TILES

 ASBESTOS CONTAINING SPRAY / TROWEL APPLIED MATERIAL

SISC
SAFETY & LOSS CONTROL

INSPECTION DATE
02/27 - 03/29/2001

DRAWING NUMBER
029006

AHERA
COMPLIANCE PROGRAM

060027-029-006
BAKERSFIELD CITY SCHOOL DISTRICT
WILLIAM PENN SCHOOL
RSP