

- SITE COMMUNICATION PLAN NOTES**
- 1 PULL NEW CABLES IN EXISTING CONDUIT. PULL PAST EXISTING CABLES.
 - 2 SAWCUT AND REPAIR TO MATCH EXISTING. BORING IS AN ACCEPTABLE METHOD OF CONDUIT INSTALLATION. PROVIDE METHOD OF PROCEDURE FOR BORING TO ENGINEER FOR REVIEW AND APPROVAL. DETAIL BORING PROCEDURE. IDENTIFY TYPE OF CONDUIT TO BE USED IN BORE.

SITE COMMUNICATION PLAN

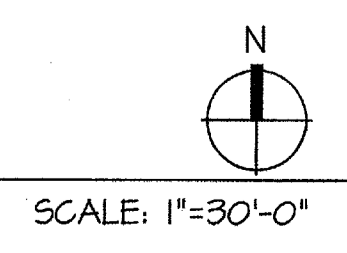

JMPE
 ELECTRICAL ENGINEERING
 LIGHTING DESIGN
 CA REGISTRATION NO. E12085
 04082
 3400 MING AVENUE
 SUITE 200
 BAKERSFIELD, CA 93309
 (805) 835-7165
 FAX (805) 835-7163
 email: info@jmpe.net
 www.jmpe.net

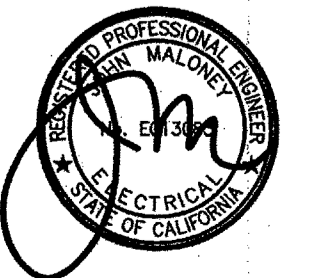
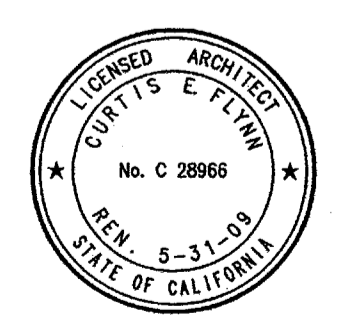

Job No.: **3832**

Sheet No.: **E-2**

Release: **APPENDIX 1**
 CURTIS MCNALLY

Ownership of Documents
 This document, the ideas and designs incorporated herein, as an instrument of Professional Service is the property of Integrated Designs by SOMAM Inc. and is not to be used, in whole or in part for any other project without written authorization.
 © COPYRIGHT 2009

integrated designs by SOMAM, Inc.
 ARCHITECTURE - ENGINEERING - INTERIOR DESIGN - CONSTRUCTION MANAGEMENT
 6011 N. Fresno, Suite 130 - Fresno, California 93710
 Phone: (559) 438-0881 Fax: (559) 438-0887 E-Mail: design@somam.com
 www.integrateddesigns.com

Rev. No.	Date	Description
1	10/15/09	ADDENDUM 1

SITE COMMUNICATION PLAN

Project Name & Address:
MUNSEY ELEMENTARY SCHOOL
10 NEW PORTABLE CLASSROOMS
 BAKERSFIELD CITY SCHOOL DISTRICT
 3801 BRAVE AVE. BAKERSFIELD, CA 93309

Issue Date: 05/02/06
 Designer: DESIGNER
 DR: DRAFTER
 PC: CJM

DSA Identification Stamp: