

POTOMAC AVENUE

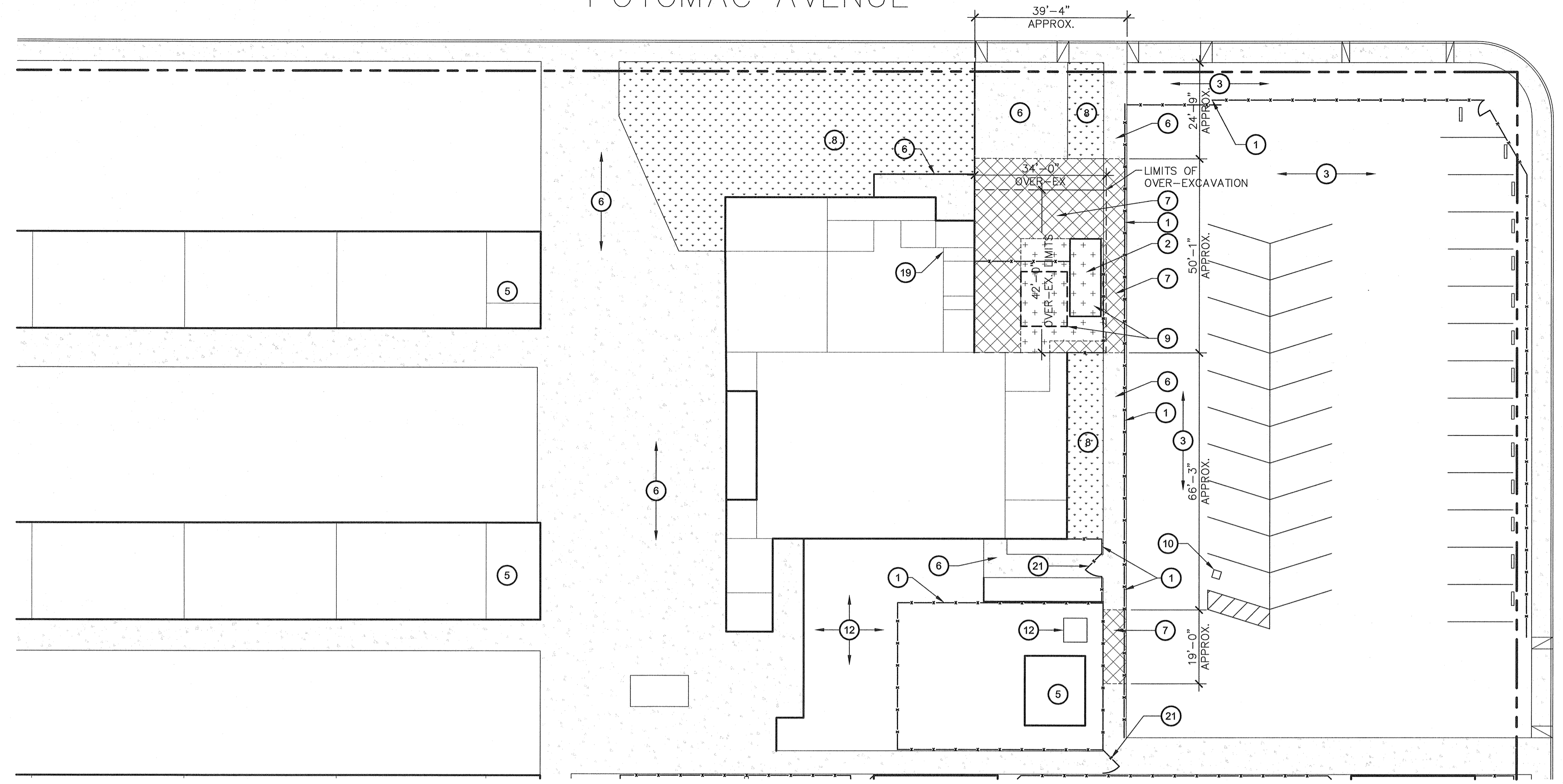

**1**  
A1.02  
**DEMOLITION ENLARGED SITE PLAN**  
KITCHEN ADDITION

SCALE: 1" = 20'

POTOMAC AVENUE

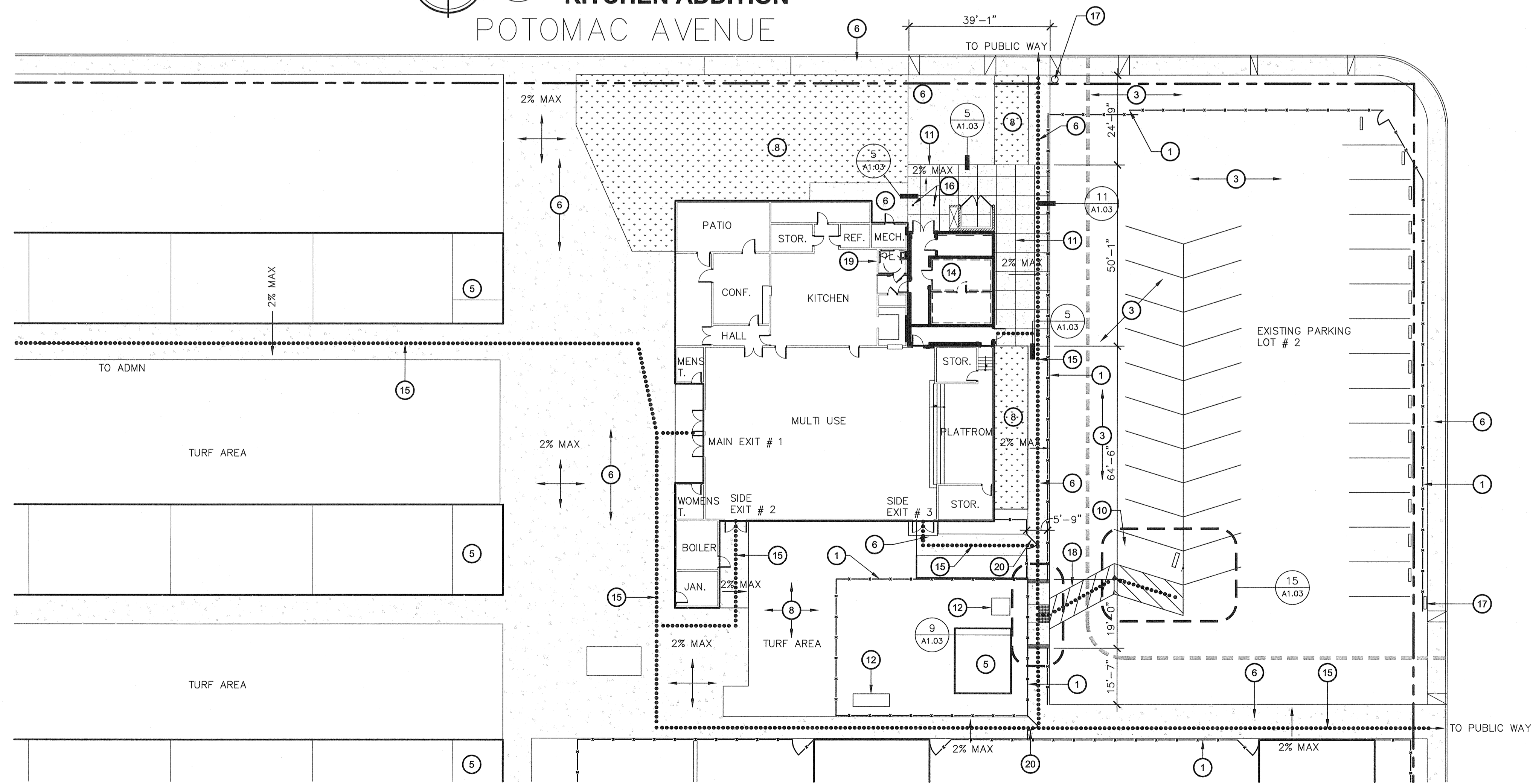

**2**  
A1.02  
**PROPOSED ENLARGED SITE PLAN**  
KITCHEN ADDITION

SCALE: 1" = 20'

**KEY NOTES**

1. (E) CHAIN LINK FENCE AND GATE TO REMAIN
2. (E) AC PAVING TO BE SAW CUT AND REMOVED
3. (E) AC PAVING TO REMAIN (NO WORK)
4. (E) FIRE TRUCK ACCESS LANE
5. (E) BUILDING TO REMAIN (NO WORK)
6. (E) CONCRETE WALK TO REMAIN (NO WORK)
7. (E) CONCRETE WALK TO BE SAWCUT AND REMOVED
8. (E) LANDSCAPE AND IRRIGATION TO REMAIN
9. (E) COOLING UNIT AND STORAGE CONTAINER TO BE REMOVED FROM SITE BY OWNER
10. (E) PARKING STALLS TO BE MODIFIED PER 15/A1.03
11. (N) CONCRETE WALK, SEE DETAIL 6/A1.03
12. (E) ELECTRICAL EQUIPMENT TO REMAIN, SEE ELECTRICAL DRAWINGS AND SPECS FOR ANY ADDITIONAL WORK
13. LIMITS OF OVER-EXCAVATION AND RECOMPACTION, SEE DETAIL 6/A1.03
14. PROPOSED KITCHEN ADDITION, SEE SHEET A2.01 FOR ADDITIONAL INFORMATION
15. PATH OF TRAVEL
16. (N) STEEL PIPE BOLLARDS, SEE DETAIL 16/A1.03
17. (N) TOW AWAY SIGN PER DETAIL 3/A1.03
18. (N) 4" WIDE STRIPING.
19. MODIFY (E) STAFF TOILET TO BE ADA COMPLIANT.
20. (N) ACCESSIBLE GATE PER DETAIL 3/A1.04
21. REMOVE (E) GATE. SEE 2/A1.02 FOR (N) WORK

**EXIT ANALYSIS**

AREA:	
MULTI-PURPOSE PLATFORM	: 3072 SF
	: 448 SF
OCCUPANT LOAD	
MULTI-PURPOSE PLATFORM	3072 ÷ 7 = 439
	448 ÷ 15 = 30
TOTAL	= 469
LESS THAN 500 2 EXITS REQUIRED	
THREE EXITS PROVIDED	
MAIN EXIT	
469 x .5 = 234.5	
234.5 x 2 = 469' REQUIRED	
EXISTING / PROVIDED = 144"	
SIDE EXIT (EACH)	
469 x .25 = 117.25	
117.25 x 2 = 234.5' REQUIRED	
EXISTING PROVIDED : 72"	

**ACCESSIBILITY NOTES**

- ARCHITECT HAS INSPECTED THE PATH OF TRAVEL (P.O.T.) AS INDICATED ON THE PLANS AND HAS FOUND IT TO BE, OR HAS INDICATED ON THE PLANS REMEDIAL WORK WHICH WOULD CAUSE IT TO BE, A BARRIER-FREE ACCESSIBLE ROUTE:
- AT LEAST 48" IN WIDTH, OR AS APPROVED BY CODE
  - FREE OF ABRUPT LEVEL CHANGES EXCEEDING 1/4" IF BEVELED AT 1:2 MAX SLOPE, OR VERTICAL LEVEL CHANGES EXCEEDING 3/4"
  - WITH A FIRM, STABLE, AND SLIP RESISTANT SURFACE
  - WITH A RUNNING SLOPE OF 1:20 OR LESS, UNLESS OTHERWISE INDICATED, AND A CROSS SLOPE OF 1:50 OR LESS
  - IS FREE OF OVERHEAD OBSTRUCTIONS WITHIN 80" ABOVE THE WALKING SURFACE
  - IS FREE OF OBJECTS WHICH PROTRUDE MORE THAN 4" BETWEEN THE HEIGHTS OF 27" AND 80" ABOVE THE WALKING SURFACE

**LEGEND**

- INDICATES EXISTING BUILDING TO REMAIN (NO WORK)
- INDICATES EXISTING AC-PAVING TO BE REMOVED
- INDICATES EXISTING CONCRETE TO BE REMOVED
- INDICATES EXISTING LANDSCAPE AND IRRIGATION TO REMAIN
- INDICATES NEW CONCRETE WALK
- INDICATES EXISTING CONCRETE WALK TO REMAIN (NO WORK)
- PATH OF TRAVEL, SEE ACCESSIBILITY NOTES ABOVE
- (E) FIRE TRUCK ACCESS LANE TO REMAIN

Ownership of Documents  
This document, the ideas and designs incorporated herein, as an instrument of Professional Service is the property of Integrated Designs by SOMAM Inc. and is not to be used, in whole or in part for any other project without written authorization.  
© COPYRIGHT 2012

**integrated designs** by SOMAM, Inc.  
ARCHITECTURE - ENGINEERING - INTERIOR DESIGN - CONSTRUCTION MANAGEMENT  
6011 N. Fresno, Suite 130 - Fresno, California 93710  
Phone (559) 435-0881 Fax (559) 435-0887 E-Mail: design@somam.com  
www.integrateddesigns.com

Rev. No.	Date	Description

**ENLARGED SITE PLAN**

Project Name & Address:  
**MT. VERNON ELEMENTARY SCHOOL**  
**KITCHEN ADDITION**  
BAKERSFIELD CITY SCHOOL DISTRICT  
2161 POTOMAC AVENUE BAKERSFIELD CA.

Issue Date: 07/20/12  
Date: 07/31/12  
Designer: [Signature]  
DR: [Signature]  
PC: C/M

Agency Approval Stamp:

FILE # 15-6  
IDENTIFICATION STAMP  
DIV. OF THE STATE ARCHITECT  
OFFICE OF REGULATION SERVICES  
03-114521  
DATE: 8/17/12  
TRACKING #: 63321-118

Stamp(s):

Job No.: **3990**

Sheet No.: **A1.02**

Release: -