

TYPICAL Door Opening

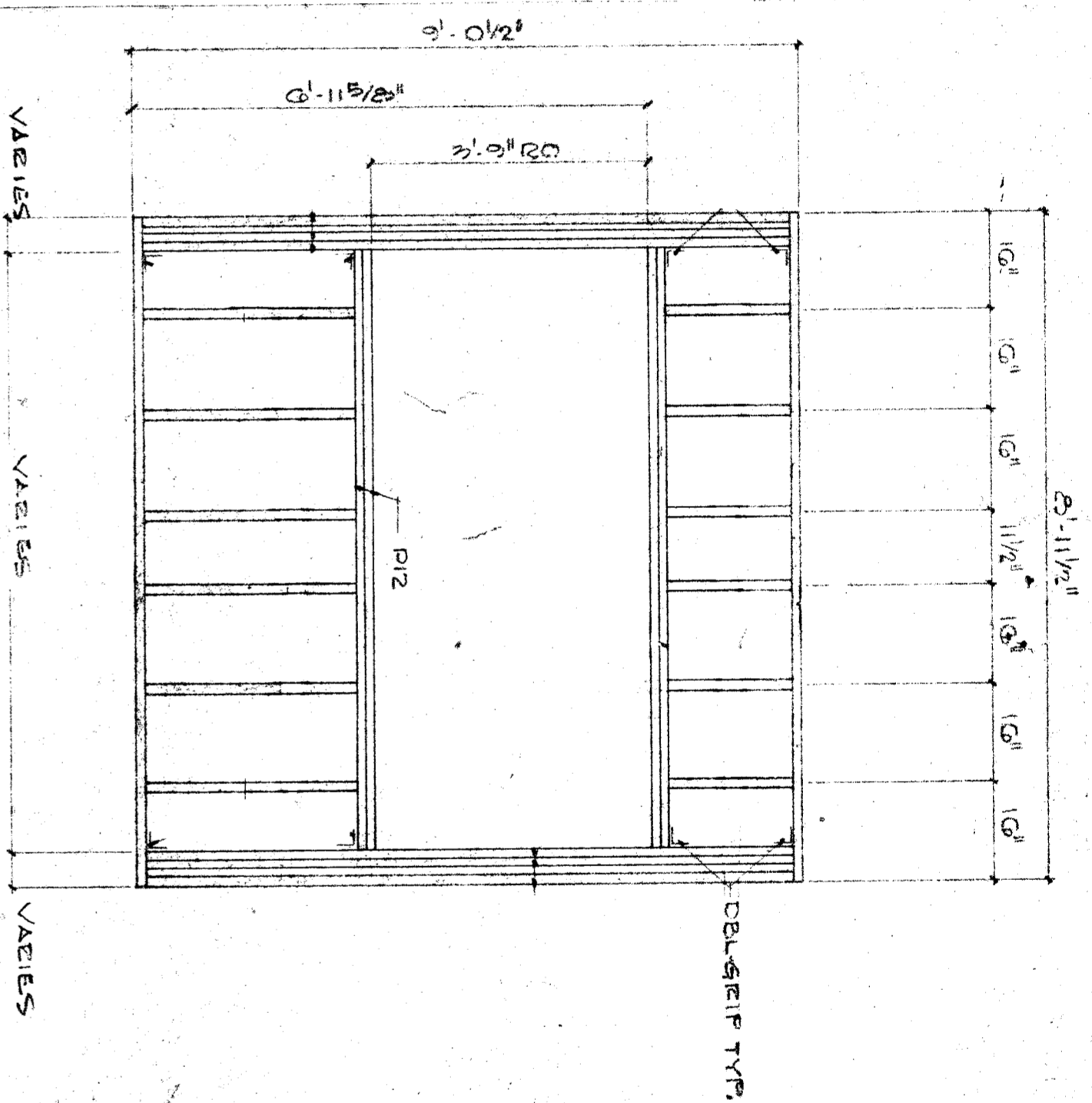

TYPICAL Window Opening

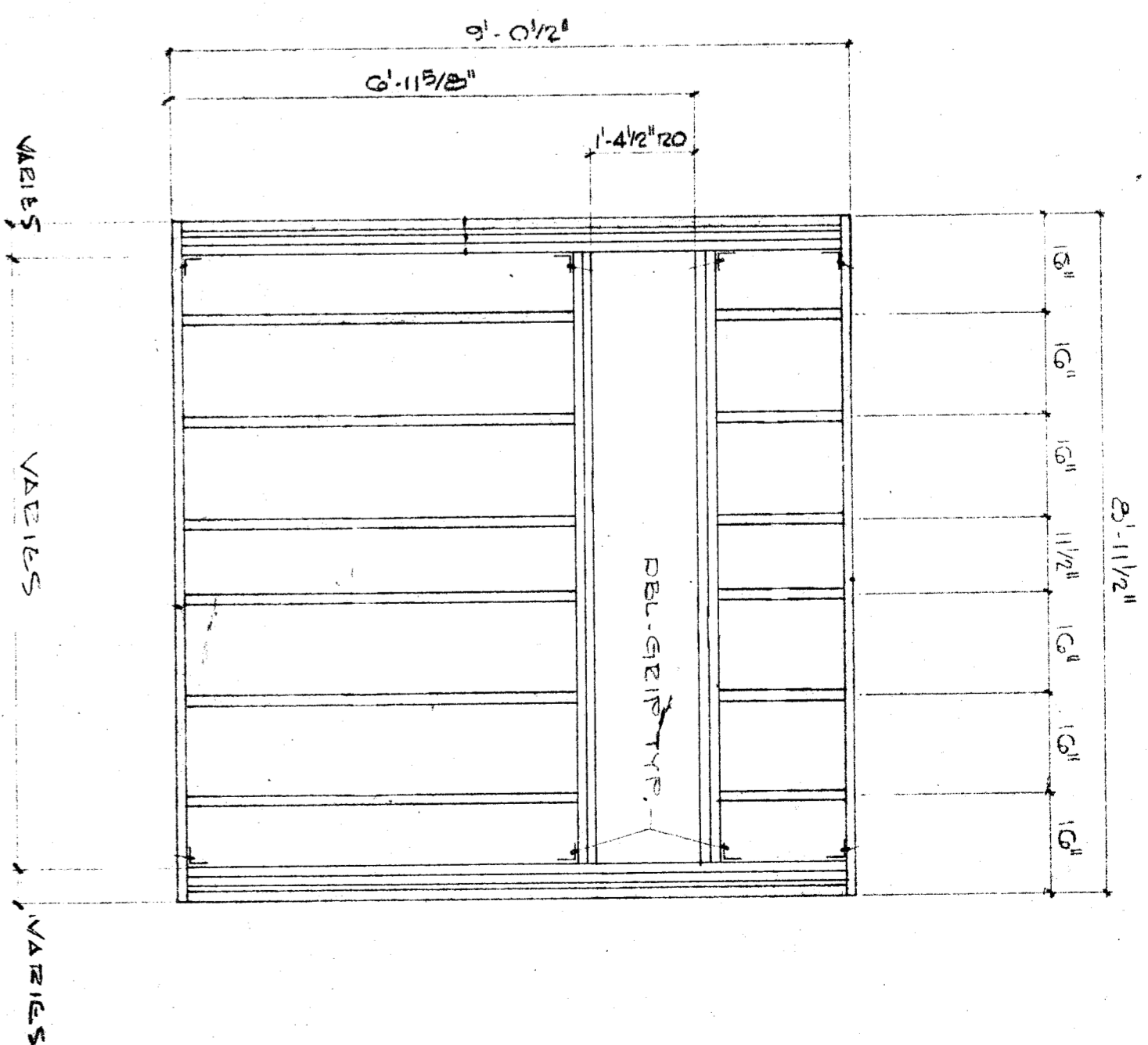

TYPICAL Hi Vault Opening

**TYPICAL WALL PANELS**

1. INTERIOR SKIN NAIL GUARD USE #4 COOPER RING SHANK NAILS, 2 1/2\"/>
2. EXTERIOR SKIN NAIL GUARD: USE STAPLES, 16 GA. GALVANIZED OR COATED WITH RESIN OR CEMENT AT 3\"/>
3. WHERE SKINS ARE NAIL GUARD USE 2 1/2\"/>
4. GUESS SHALL BE CEMENT TYPE WITH MOISTURE RESISTOR AND COMPLY WITH SPEC. C-9-4900

REVISIONS NO.    DATE    NO.    REFERENCE PLAN SET NO.	APPROVED BY 82682 APPROVED OCT 31 1989 OFFICE OF ARCHITECTURE & CONSTRUCTION	APPROVED BY STATE FIRE MARSHAL	APPROVED BY School District	KING BRINOFF-STERMANN KING CONSULTING ENGINEERS 1201 BAYSHORE DRIVE SHERMAN OAKS, CALIF. 91105	DRAWN BY SATHIE	CHECKED BY DATE TELEPHONE	WALL PANEL FINISHES BAKERSFIELD CITY S.D. BAKERSFIELD, CALIF.	SPEEDSPACE CORPORATION RELOCATABLE BUILDINGS 1401 East 500 - Santa Ana, California 92701 Telephone (707) 344-1661	SPEEDSPACE JOB NO. S9-1325 SHEET NO. 22 OF 31
---	--	-----------------------------------	--------------------------------	---	--------------------	---------------------------------	---	--	--