

**GENERAL NOTES**

1. FIRE ALARM SYSTEM: WRITTEN ALARM EQUIPMENT DISTRIBUTION SHALL BE SUBMITTED TO THE ELECTRICAL ENGINEER AND STATING THAT THE SYSTEM ARE AS LISTED AND ARE AND THAT THE INSTALLATION THE REQUIREMENTS AS CALIFORNIA ADMINISTRATIVE CODE, P.E. 11.
2. FOR FIRE ALARM.
3. EXIT DOORS SHALL BE OPERABLE FROM THE INSIDE OF KEY OR ANY SPECIAL KNOWLEDGE.

**NOTE:**  
 CONTRACTOR SHALL VERIFY EXACT LOCATION OF NEW AND EXISTING BUILDINGS WITH OWNER AND ARCHITECT BEFORE STARTING ANY WORK.

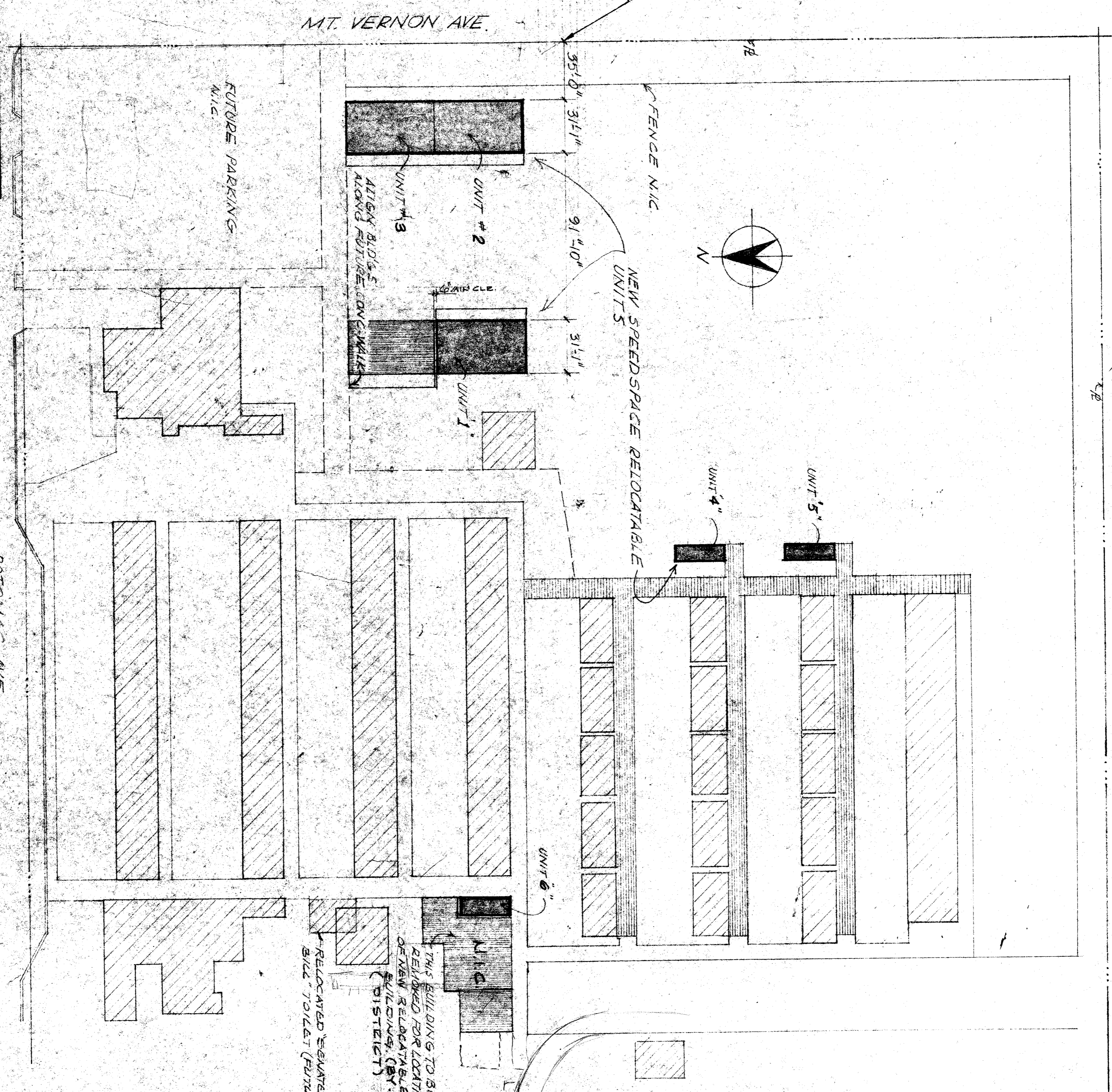

MOUNT VERNON AVE  
 2101 POTOMAC AVE  
 BAKERSFIELD, CALIF.

**LEGEND**  
 SPEEDSPACE RELOCATABLE UNITS IN CONTRACT  
 EXISTING BUILDINGS OR BUILDINGS IN CONTRACT  
 NEW RELOCATABLE UNIT TO BE RELOCATED BY SPEEDSPACE (SEE SPECIFICATIONS NOTES)  
 FUTURE WALKS A.I.C.

**NOTE:**  
 CLEARING OF SITE, ROUGH GRADING, FENCES, LANDSCAPE

REVISIONS	DATE	NO.	REFERENCE PLAN

APPROVED BY  
 ARCHITECT  
 82682 APPROVED  
 STATE FIRE MARSHAL

APPROVED BY  
 ARCHITECT  
 STATE FIRE MARSHAL

APPROVED BY  
 ARCHITECT  
 STATE FIRE MARSHAL

SITE PLAN  
 BAKERSFIELD CITY SD  
 BAKERSFIELD, CALIFORNIA

**SPEEDSPACE CORPORATION**  
 1041 Highway 10  
 Bakersfield, California 93311  
 Telephone (707) 544-1641

**ATC**  
 Licensed Architect  
 License No. 14011  
 State of California

SPEEDSPACE JOB NO. 521/EX S  
 SHEET NO. 0-1  
 1 OF 31  
 69121-5