

**LEGEND: -- GRADING PLAN**

	PROPOSED ASPHALT CONCRETE SURFACE		PROPOSED PC CONCRETE SURFACE
	DESIGN ELEVATION		DESIGN SLOPE
	PROPOSED HAND RAIL		PROPOSED CHAIN LINK FENCE
	3' CONCRETE PARKING BUMPER (FURNISH & INSTALL)		ADA ROUTE
	EXISTING "TOPO" SHOT WITH SURVEYOR'S DESCRIPTION		EXISTING PC CONCRETE SURFACE
	EXISTING CHAIN LINK FENCE		GRADE BREAK
	ASPHALT CONCRETE PAVEMENT		ANGLE POINT
	BENCHMARK		INVERT
	CATCH BASIN		LIP OF GUTTER
	END OF CURVE		NATURAL GROUND
	EDGE OF GUTTER		POINT ON CURVE
	EDGE OF PAVEMENT		POINT ON LINE
	END OF ROAD		TOP OF CURB
	EXISTING		TOP OF GRATE
	FLOWLINE		TOP OF SLOPE
	FINISHED FLOOR		TOP OF WALL
	FINISHED SURFACE		TYPICAL
	FENCE		WATER VALVE
	GROUND		

**CONSTRUCTION NOTES--GRADING & SITE IMPROVEMENTS:**  
(SEE ALSO UTILITY PLANS HEREIN)

- 1) PRIOR TO COMMENCEMENT OF WORK, CONTRACTOR SHALL SUBMIT A PLAN TO THE DISTRICT FOR SAFE PASSAGE OF VEHICLES AND PEDESTRIANS AROUND WORK LIMITS. PLAN SHALL CORDON OFF WORK AREAS WITH CAUTION TAPE, DELINEATORS AND BARRICADES. PLAN SHALL INCLUDE TRAFFIC CONTROL ON PUBLIC STREETS, PARKING CONTROL, AND SHALL NOT INTERRUPT STUDENT DROP-OFFS. PLAN IS SUBJECT TO APPROVAL BY DISTRICT.
- 2) PRIOR TO COMMENCEMENT OF WORK, CONTRACTOR SHALL RESEARCH ALL UTILITIES AND POINTS OF CONNECTION. CONTRACTOR SHALL "POTHOLE" EXISTING UTILITIES AT ALL POINTS OF CONNECTION, AND AT OTHER LOCATIONS OF POTENTIAL CONFLICT. DEPTH AND LOCATION SHALL BE VERIFIED AND REPORTED TO THE ENGINEER. DISCREPANCIES WITH THE PLANS OR AS-BUILTS SHALL BE IMMEDIATELY REPORTED TO THE ENGINEER SUCH THAT ADJUSTMENTS CAN BE MADE PRIOR TO INSTALLATION.
- 3) CONTRACTOR SHALL PERFORM ALL NECESSARY DEMOLITION WITHIN THE LIMITS OF WORK. PROTECT EXISTING UTILITIES AND IMPROVEMENTS THAT ARE TO REMAIN. CUT AND CAP EXISTING IRRIGATION LINES, SEWER, AND WATER LINES AT DEMOLITION LIMITS. CONTRACTOR SHALL RECORD DEPTH AND LOCATION OF CAP. ALL IMPROVEMENTS TO BE REMOVED SHALL BE SAWCUT.
- 4) BUILDING PAD AREAS SHALL BE OVER-EXCAVATED AND RECOMPACTED IN ACCORDANCE WITH THE RECOMMENDATION OF THE SOILS REPORT. AS NECESSARY SAWCUT AND REMOVE EXISTING PAVEMENT, CONCRETE FLATWORK, AND OTHER IMPROVEMENTS TO PERMIT PAD PREPARATION.
- 5) GRADE SITE TO THE LINES AND ELEVATIONS INDICATED ON THE PLANS. ANY EXCESS MATERIAL SHALL BECOME THE PROPERTY OF THE CONTRACTOR AND SHALL BE REMOVED FROM THE SITE.
- 6) WHERE INDICATED ON THE PLANS, REMOVE EXISTING PAVEMENT OR CONCRETE FLATWORK AND REPLACE WITH ASPHALT CONCRETE STRUCTURAL SECTION PER DETAIL (4) HEREIN. REGRADE AND IMPORT CLASS II AGGREGATE BASE TO ACHIEVE PLAN ELEVATION AND POSITIVE DRAINAGE.
- 7) PATCH ASPHALT CONCRETE PAVEMENT PER CITY OF BAKERSFIELD STANDARD S-6. AC PAVEMENT SHALL BE 3" MIX IN ACCORDANCE WITH DISTRICT STANDARDS.
- 8) CONSTRUCT PC CONCRETE WALKS IN ACCORDANCE WITH DETAIL (8) HEREIN. NEW WALKS SHALL MEET ALL STATE AND FEDERAL REQUIREMENTS INCLUDING THE AMERICANS WITH DISABILITIES ACT (ADA). FORMS SHALL BE CHECKED FOR ADA COMPLIANCE PRIOR TO POURING CONCRETE.
- 9) CONSTRUCT 3-FOOT WIDE PC CONCRETE VEE GUTTER PER DETAIL (9) HEREIN. IF NECESSARY, WIDEN GUTTER TO 8-FOOT AT DESIRED ADA ROUTE CROSSING.
- 10) FURNISH AND INSTALL 3-FOOT CONCRETE PARKING BUMPER.
- 11) CONSTRUCT REINFORCED PC CONCRETE RETAINING WALL WITH HANDRAILS, PER DETAIL (5) HEREIN.
- 12) ADJUST ALL EXISTING UTILITY BOXES TO FINISHED GRADE. CONCRETE COLLARS SHALL BE POURED AROUND CLEAN-OUTS, BLOW-OFFS AND ANY OTHER UTILITY BOXES. NEW ASPHALT CONCRETE SHALL BE SAWCUT FOR CONCRETE COLLARS.
- 13) FURNISH AND INSTALL PC CONCRETE EXPANSION JOINTS BETWEEN ALL PC STRUCTURES, AND IN ACCORDANCE WITH THE INTERVALS SPECIFIED IN THE STANDARD SPECIFICATIONS.
- 14) FURNISH AND INSTALL 6-FOOT TALL CHAIN LINK FENCE IN ACCORDANCE WITH DISTRICT STANDARDS.
- 15) ALL "JOINS" SHALL BE SAWCUT. PC CONCRETE "JOINS" SHALL BE DOWELLED IN ACCORDANCE WITH DETAIL (6) HEREIN.
- 16) RE-STRIPE PARKING STALL AFFECTED BY THE WORK. RE-STRIPE PEDESTRIAN ACCESS ROUTE AS SHOWN ON THE PLAN.

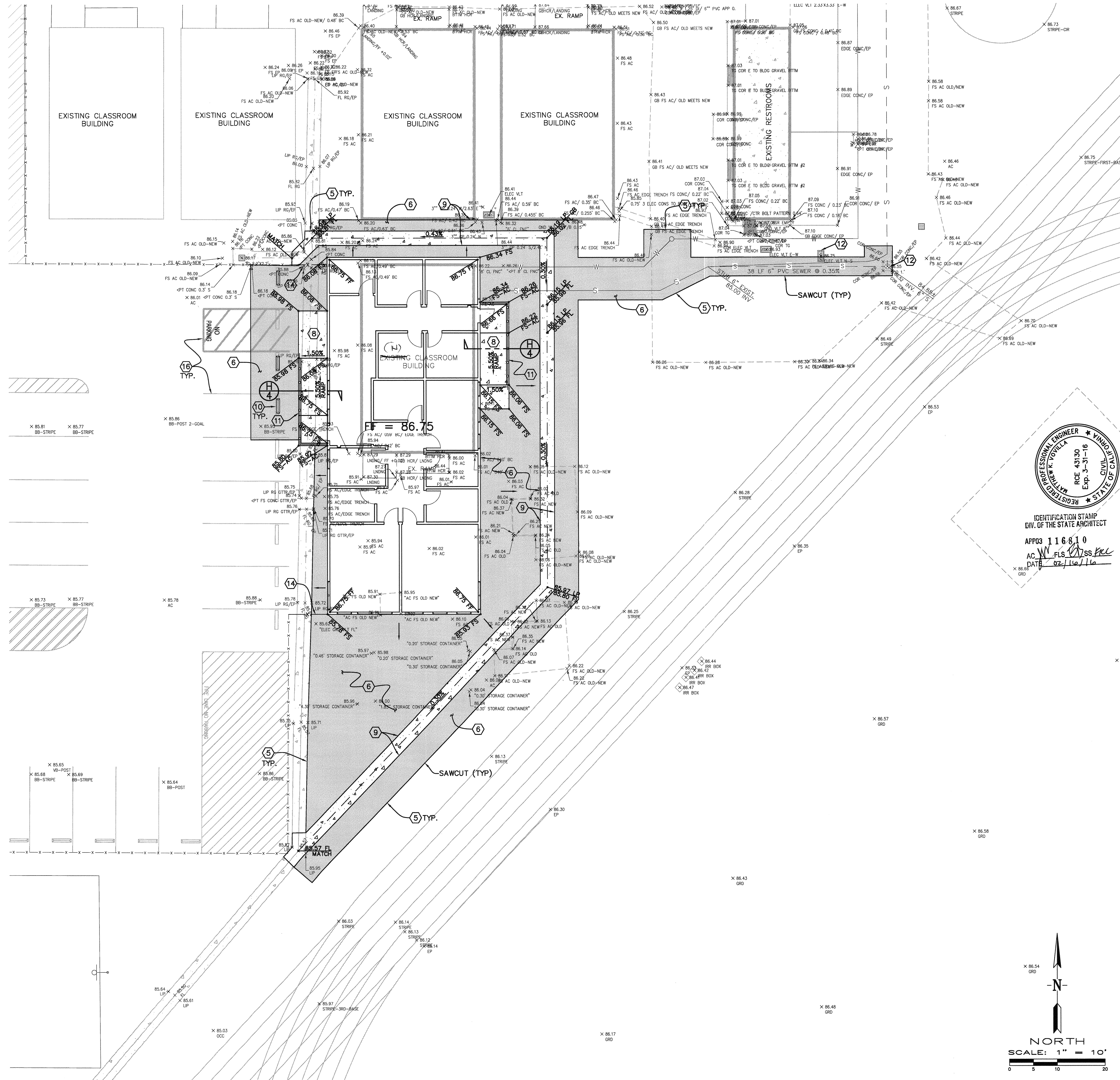

IDENTIFICATION STAMP  
DIV. OF THE STATE ARCHITECT

APPROVED  
116810  
AC W. FLS. JSS/PCL  
DATE 02/16/16

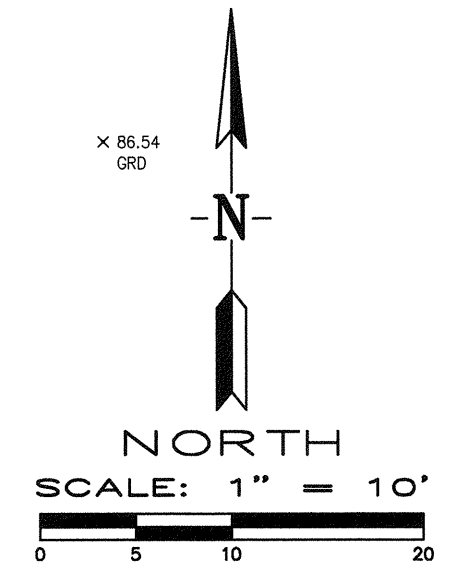

**LAV // Pinnacle Engineering**  
5401 Business Park South, Suite 204, Bakersfield, CA 93309  
Phone: (661) 869-0184 Fax: (661) 377-0076

02/01/16	DATE
RCE 43130 EXP. 3/31/16	REVISIONS
MATTHEW K. VOVILLA	REVISIONS

**GRADING & SITE IMPROVEMENT PLANS**  
FOR HEALTH CLINIC  
MCKINLEY ELEMENTARY SCHOOL  
604 4TH STREET  
BAKERSFIELD, CALIFORNIA

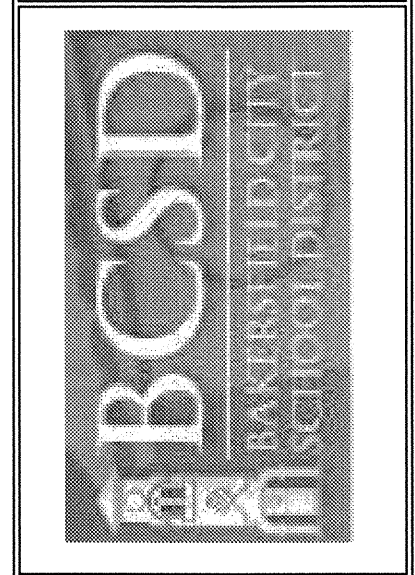

JOB No.:	15-677
DWG NO.:	BM01
DATE:	02/01/2016
DRAWN BY:	ADA
CHECKED BY:	MKV
SHEET	7
OF 8 SHEETS	