



# Bakersfield City School District

## Maintenance, Operations and Facilities Department

1501 Feliz Drive  
Bakersfield, California 93307  
Office (661) 631-5883 Fax (661) 834-9986

Jason Sitton, Director I [sittonj@bcسد.com](mailto:sittonj@bcسد.com)

Leonard Zasoski, Jr., Assistant Director II [zasoskil@bcسد.com](mailto:zasoskil@bcسد.com)

Daniel Wastaferrero, Assistant Director II [wastaferrero@bcسد.com](mailto:wastaferrero@bcسد.com)

Juan Montelongo, Assistant Director II [montelongoj@bcسد.com](mailto:montelongoj@bcسد.com)

April 4, 2024

To: Interested Classification C-22, C-15, C-33 & C-2 Contractors  
Re: McKinley Elementary School Abatement, Flooring, Painting & Tackboard – Addendum 2

1. RFI - Attachment 'C' Walk -Off Locations and Color
  - See attachment C-Walk-Off Mats for location and size.
  - Walk-Off Mat Color
    - I0316 PASEO for Walk Off Mats
    - 595 OBSIDIAN - [Patcraft | paseo I0316](#)
2. RFI – Flooring Type & Color
  - I0302 VIVID for Field
  - 431 SPECTRUM - [Patcraft | vivid I0302](#)
3. RFI -Type of Sub-Floor per Room
  - Rooms 14, 15, 16, 17, 18 have a concrete floor.
  - Rooms 24, 25, 26, 27, 28, 29 have a wood floor.
4. RFI-Underlayment for the wood floors.
  - See attachment A – Underlayment
5. Liquidated Damages
  - See number 6, on the Agreement Form Document 00 52 13 provided on the BCSD project link on our website.
6. Sub-Floor Patching Material
  - See attachment B - Smoothing & Finishing Compound
7. Flooring Base Material
  - Burke 4 – Inch Top Set Base (Black)

Please date, sign and return this form via email to Brenda Orozco at [orozcob@csd.com](mailto:orozcob@csd.com).

---

Date      Print Name      Signature

---

Print Company Name

Sincerely,

Leonard Zasoski, Jr.  
Assistant Director II  
Maintenance, Operations and Facilities  
Bakersfield City School District

## TECHNICAL DATA SHEET POWERHOLD PLUS UNDERLAYMENT

<b>Material:</b>	6 mm (5 ply) & 9mm (7 ply) Plywood; 100% birch hardwood construction
<b>Glue:</b>	Exterior Grade; Passes APA Boil Test
<b>Formaldehyde:</b>	<0.05ppm - Meets California Air Resources Board (CARB) Regulation 93120 phases I & II.
<b>Dimensions:</b>	Available in 4' x 4', 4' x 5' & 4' x 8' panel - 6mm and 4' x 4' - 9mm Precision square cut for a TileTite fit. Each panel ultrasonically tested for voids.
<b>Nailing Pattern:</b>	Each panel is printed with a proprietary nailing pattern for proper installation.
<b>Core:</b>	Rugged solid puncture resistant Birch hardwood core.
<b>Thickness:</b>	<ul style="list-style-type: none"> <li>• 6mm (1/4") for vinyl floors and general purpose use.</li> <li>• 9mm (3/8") for ceramic tile areas and where a subfloor build-up is required.</li> </ul>
<b>Surface Treatment:</b>	Fine sanded face and touch sanded back to provide a smooth surface and consistent thickness.
<b>Moisture Content:</b>	6.5% (50%RH @ 20°C)
<b>Stain Resistance:</b>	Non-staining veneers and ink; compatible with all vinyl floor coverings.
<b>Density:</b>	41.8 lbs/cu.ft.
<b>*Internal Bond:</b>	375.0 PSI
<b>*Modulus of Elasticity:</b>	Perpendicular: 796,000 PSI Parallel: 2,048,000 PSI
<b>*Compression: (Crushing Strength)</b>	3996 lbs/in <sup>2</sup>
<b>*Janka Ball Hardness:</b>	1370 lbs.
<b>*Thickness Swell:</b>	
2-Hour Soak:	4.5%
24-Hour Soak:	8.0%
<b>*Linear Expansion:</b>	Perpendicular % Change: 0.077% @ 50% - 90% Relative Humidity Parallel % Change: 0.086 @ 50% - 90% Relative Humidity
<b>Thermal Resistance: (R-Value)</b>	6mm - 0.31 ft <sup>2</sup> -hr-°F/BTU 9mm - 0.43 ft <sup>2</sup> -hr-°F/BTU
<b>Flame Spread Rating:</b>	80 - 200
<b>Flame Spread Class:</b>	Class III or Class C
<b>Standards:</b>	Meets the requirements of: American Plywood Association APA PS 1-07; American Society for Testing and Materials *ASTM D1037; Canadian Standards Association CSA 0153
<b>Vinyl Manufacturers Recommendations:</b>	Meets requirements of Armstrong, Congoleum, Mannington and Tarkett.
<b>Ceramic Tile:</b>	9mm Matrixx meets TCNA F 160-07 for installation of ceramic tile over wood sub-floors.
<b>LACEY ACT:</b>	POWERHOLD PLUS Hardwood Underlayment is sourced in compliance with Lacey Act.

# SAFETY DATA SHEET

PRODUCT: Exterior Grade Phenolic Bonded Birch Plywood Underlayment

PAGE 1 OF 3

## 1. Product and Company Identification

IDENTITY	POWERHOLD PLUS BIRCH UNDERLAYMENT	MANUFACTURERS	
		NAME	TRAXX CORPORATION
SYNONYMS	WOOD UNDERLAYMENT, EXTERIOR GRADE BIRCH PLYWOOD	ADDRESS	1201 E. LEXINGTON AVE. POMONA, CA 91766
CAS NUMBER	NONE	EMERGENCY	
		TELEPHONE NO.	(909) 623-8032
DATE OF LAST ALTERATION	July 20, 2018	INFORMATION	
		TELEPHONE NO.	(909) 623-8032

## 2. Hazards Identifications

HMIS Rating: Health: 0      Fire: 1      Reactivity: 0      PPE: B This material does not contain any hazardous substances at or above OSHA, CARB and WHMIS reportable levels. Use this product as intended. <b>Compliant with the TSCA Title VI or the California Air Resources Board (CARB) Airborne Toxic Control Measures (ATCM) Phase II emission standards.</b>			
---	--	--	--

## 3. Composition/Information on Ingredients

HAZARDOUS INGREDIENTS					
HAZARDOUS COMPONENTS	ACGIH TLV-TWA	ACGIH TLV-STEL	OSHA STEL	OSHA PEL	PERCENTAGE
HARDWOOD DUST	5 mg/m <sup>3</sup>	10 mg/m <sup>3</sup>	5 mg/m <sup>3</sup>	10 mg/m <sup>3</sup>	TRACE
FORMALDEHYDE	N/A	0.3 ppm ( C* )	2 ppm	0.75 ppm	<0.05 ppm

\* C = Ceiling Limit, never to be exceeded

## 4. First-Aid Measures

<b>EMERGENCY AND FIRST AID PROCEDURES</b>	
1.	INHALATION: REMOVE FROM AREA TO FRESH AIR. IF PERSISTENT IRRITATION, SEVERE COUGHING, BREATHING DIFFICULTIES OR RASH OCCUR. SEEK MEDICAL ADVICE. (PRIMARY ROUTE OF EXPOSURE IS INHALATION).
2.	EYES: SAW DUST MAY MECHANICALLY IRRITATE THE EYE RESULTING IN REDNESS OR WATERING. FLUSH WITH WATER FOR AT LEAST 15 MINUTES TO REMOVE DUST PARTICLES. IF IRRITATION PERSISTS, SEEK MEDICAL ATTENTION.
3.	SKIN: VARIOUS SPECIES OF WOOD DUST CAN ELICIT ALLERGIC CONTACT DERMATITIS IN SENSITIZED INDIVIDUALS AFTER REPETITIVE CONTACT. IF A RASH, OR PERSISTENT IRRITATION, OR DERMATITIS OCCUR, SEEK MEDICAL ADVICE.
4.	INGESTION: NOT APPLICABLE UNDER NORMAL USE.

## 5. Fire-Fighting Measures

<b>FIRE AND EXPLOSION HAZARD DATA</b>			
FLASH POINT		AUTOIGNITION TEMPERATURE	400-500°F
(TEST METHOD)	N/A		
FLAMMABLE LIMITS IN AIR, PERCENT BY VOLUME		LOWER	UPPER
WOOD DUST	(LEL) APPROX. 40g/M <sup>2</sup>	(UEL) N/A	
EXTINGUISHING			
MEDIA:	WATER, SAND, CO <sub>2</sub> AND CHEMICAL EXTINGUISHERS.		
SPECIAL FIRE FIGHTING			
PROCEDURES:	USE NORMAL FIREFIGHTING METHODS FOR WOOD FIRES.		
UNUSUAL FIRE AND EXPLOSION HAZARDS:	NONE		

**6. Accidental Release Measures****SPILL OR LEAK PROCEDURES**

NOT APPLICABLE FOR PRODUCT IN PURCHASED FORM. SAW DUST AND SCRAPS MAY BE VACUUMED OR SHOVELED FOR RECOVERY OR DISPOSAL. AVOID DUSTING CONDITIONS; PROVIDE GOOD VENTILATION WHERE DUSTING IS POSSIBLE. USE NIOSH/OSHA APPROVED DUST RESPIRATOR AND GOGGLES WHERE VENTILATION IS NOT POSSIBLE.

**7. Handling and Storage****PRECAUTIONS FOR SAFE HANDLING AND USE**

SPECIAL HANDLING PRECAUTIONS ARE REQUIRED. PLYWOOD PANELS ARE COMBUSTIBLE. KEEP IN COOL, DRY PLACE AWAY FROM OPEN FLAME AND OTHER SOURCES OF IGNITION. WEAR GLOVES TO AVOID SPLINTERS AND SKIN PUNCTURE.

**8. Exposure Controls and Personal Protection****CONTROL MEASURES****PRECAUTIONS:**

IF THIS PRODUCT IS USED IN A PROCESS WHICH GENERATES DUST LEVELS IN EXCESS OF THE ALLOWABLE EXPOSURE LIMIT(S) FOR WOOD DUST, A NIOSH/SHA APPROVED DUST RESPIRATOR AND GOGGLES SHOULD BE WORN. DUE TO THE EXPLOSIVE POTENTIAL OF WOOD DUST WHEN SUSPENDED IN AIR, PRECAUTIONS SHOULD BE TAKEN TO PREVENT SPARKS OR OTHER IGNITION SOURCES IN VENTILATION SYSTEMS. USE OF TOTALLY ENCLOSED MOTORS IS RECOMMENDED OR MAY BE WARRANTED IF PROCESS GENERATES EXCESSIVE LEVELS OF WOOD DUST.

**9. Physical and Chemical Properties****PHYSICAL DATA**

<i>BOILING POINT</i> (760 mm, Hg)	N/A	<i>MELTING POINT</i>	N/A
<i>pH</i>	N/A		
SPECIFIC GRAVITY (H <sub>2</sub> O=1)	0.8	VAPOR PRESSURE AT 20°C	N/A
VAPOR DENSITY (AIR=1)	N/A	SOLUBILITY IN WATER % BY WT.	<1%
PERCENT VOLATILES		EVAPORATION RATE	N/A
BY VOLUME	0	(BUTYL ACETATE = 1)	

APPEARANCE AND ODOR BROWN OR TAN PLYWOOD, SLIGHTLY AROMATIC WOOD ODOR.

**10. Stability and Reactivity****REACTIVITY DATA**

STABILITY: STABLE

CONDITIONS TO AVOID: AVOID CONTACT WITH OXIDIZING AGENTS. AVOID OPEN FLAME. PRODUCT MAY IGNITE AT TEMPERATURE IN EXCESS OF 400° F (204° C).

**INCOMPATIBILITY**

(MATERIALS TO AVOID) OXIDIZING AGENTS AND DRYING OILS.

HAZARDOUS DECOMPOSITION PRODUCTS: CARBON MONOXIDE, CARBON DIOXIDE, ALIPHATIC ALDEHYDES, ROSIN ACIDS, TERPENES, AND POLYCYCLIC AROMATIC HYDROCARBONS.

HAZARDOUS POLYMERIZATION: WILL NOT OCCUR

**11. Toxicological Information**

**HEALTH HAZARD DATA**

EFFECTS OF OVEREXPOSURE:

ACUTE OVEREXPOSURE:

WOOD SAW DUST CAN IRRITATE THE EYES AND BREATHING PASSAGES. SOME WOOD SPECIES MAY CAUSE SKIN AND RESPIRATORY IRRITATION. CHEMICAL EFFECTS FROM SOME WOOD SPECIES CAN RESULTS IN RESPIRATORY ALLERGIES. RESPIRATORY AILMENTS HAVE INCLUDED BROCHITIS, IMPAIRMENT OF BREATHING FUNCTIONS, AND ASTHMA. EXCESSIVE CONCENTRATION MAY CAUSE DEPOSITS IN NASAL.

CHRONIC OVEREXPOSURE:

SOME SPECIES OF WOOD DUST CAN ELICIT ALLERGIC CONTACT DERMATITIS IN SENSITIZED INDIVIDUALS AS WELL AS MECHANICAL IRRITATION RESULTING IN ERYTHEMA AND HIVES. PROLONGED EXPOSURE TO CERTAIN SPECIES OF HARDWOOD DUST HAVE BEEN STATISTICALLY ASSOCIATED WITH NASAL CANCER. FORMALDEHYDE HAS BEEN SHOWN TO CAUSE CANCER IN CERTAIN LABORATORY ANIMALS AT EXTREME CONDITIONS. FORMALDEHYDE MAY BE IRRITATING TO THE EYES, NOSE, SKIN, AND MAY AGGRAVATE EXISTING RESPIRATORY PROBLEMS AND CAUSE ALLERGIES TO SUSCEPTIBLE PERSONS.

**12. Ecological Information**

Toxicity: Not expected

Degradability: Not readily biodegradable

Other adverse effect: Not Known

**13. Disposal Considerations**

Product and Packaging Disposal

Dispose of according to local/state/federal regulations.

**14. Transport Information**

US DOT & TDG SURFACE

Valuation..... Not required for transport

Other Information.... None

**15. Regulatory Information**

This Material does not contain any TSCA 12(b), CERLA, SARA, and SARA 313 regulated chemicals above minimum levels.

Proposition 65 (California) - Chemicals known to cause cancer: Wood Dust (no CAS), Formaldehyde CAS 50-0-0 Chemical known to cause cancer or reproductive toxicity.

**16. Other Information**

DISCLAIMER:

This Safety Data Sheet (SDS) meets the requirements of the Federal OSHA Hazard Communication Standard (28 CFR1910.1200).

TRAXX CORPORATION BELIEVES THE INFORMATION CONTAINED IN THIS SDS TO BE ACCURATE AT THE TIME OF PREPERATION AND HAS BEEN COMPILED USING SOURCES BELIEVED TO BE RELIABLE. THE INFORMATION SET FORTH HEREIN IS OFFERED AS A SERVICE TO OUR CUSTOMERS AND IS NOT INTENDED TO RELIEVE A CUSTOMER FROM ITS RESPONSIBILITY TO DETERMINE THE SUITABILITY OF THIS INFORMATION OR OF THE MATERIALS DESCRIBED HEREIN FOR PURCHASER'S PURPOSES, TO INVESTIGATE OTHER SOURCES OF INFORMATION, TO COMPLY WITH ALL LAWS AND PROCEDURES REGARDING SAFE USE OF THESE MATERIALS; AND TO USE THESE MATERIALS IN A SAFE MANNER. ALTHOUGH THIS INFORMATION IS BELIEVED TO BE ACCURATE, TRAXX SPECIFICALLY DISCLAIMS RESPONSIBILITY FOR ANY INACCURACY SET FORTH HEREIN. THUS, TRAXX DISCLAIMS LIABILITY OF ANY KIND ARISING FROM ANY PARTY'S USE OF OR RELIANCE ON INFORMATION OF RECOMMENDATIONS SET FORTH HEREIN. FURTHERMORE, NO WARRANTY OF ANY KIND SHALL BE CONSTRUED TO ARISE BY IMPLICATION FROM ANY INFORMATION OR RECOMMENDATION CONTAINED HEREIN, OR OTHERWISE.



# SCHÖNOX SL

## Cement Based Rapid Drying, Smoothing and Finishing Compound

Suitable to provide a smooth finish on various substrates in interior areas. SCHÖNOX SL can be installed as a true featheredge.

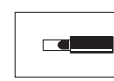

### Product characteristics

- EMICODE EC 1<sup>PLUS</sup> R: very low emission
- for interior use only
- featheredge achievable
- exceptional hardness and strength
- fast drying
- suitable for underfloor heating systems
- layer thickness above featheredge up to 1/4", in small, well-defined areas up to 1" (on wooden floors up to 1/8")
- suitable for castor wheels loadings
- very smooth surface
- moisture resistant (interior only), no moisture vapor emission limitations on properly prepared concrete
- conforms with USD 96/98/BC

### Applications

**SCHÖNOX SL is suitable for patching, smoothing and leveling of:**

- concrete, cement substrates
- floor leveling compounds
- gypsum substrates
- old substrates such as ceramic tiles
- old, water-resistant adhesive residues
- wooden substrates

**as well as for filling, smoothing and leveling of unheated, cement based substrates under:**

- SCHÖNOX Moisture Mitigation Systems

### Requirements of substrate

- Subfloors must be smooth, sound, clean, dry and free of any contaminants which may hinder adhesion.
- Surface treatments or any "friable" areas of the subfloor must be mechanically removed back to a sound base and the substrate repaired with SCHÖNOX repair compounds as required.
- This product is not a vapor barrier and will allow free passage of moisture. Follow the directions of the floor covering manufacturer regarding the maximum allowable substrate moisture content and test the substrate prior to installing SCHÖNOX SL. Where substrate moisture exceeds the maximum allowed then application of SCHÖNOX MR 18, SCHÖNOX EPA or SCHÖNOX EPA RAPID may be used to suppress residual moisture.
- Do not use SCHÖNOX SL where hydrostatic pressure conditions exist or where moisture vapor emissions exceed the recommended levels.
- Gypsum substrates should always be dry. Do not use moisture mitigation systems on gypsum substrates.

- Old water-soluble adhesives should be removed completely, old non-water-soluble adhesives should be mechanically removed as far as possible. The complete mechanical removal of cutback (i.e. grinding, sanding, blasting) can be hazardous as old cutback adhesive may contain asbestos. Do not sand or grind adhesive residue. Refer to the Resilient Floor Covering Institute's publication "recommended work practice for removal of resilient floor coverings" for instruction. Prime remaining adhesive residues accordingly.
- The use of trowelable patching compounds to mask the presence of adhesive residues can be used successfully, but only when the new adhesive to be used does not react with the old residue, and the floor covering to be installed will not be affected by adhesive bleed-through.

- All cement based or wooden substrates must be solid, thoroughly clean and free of oil, wax, grease, asphalt, latex and gypsum compounds, curing compounds, sealers and any contaminant that might act as a bond breaker. If necessary, mechanically clean the floor down to sound, solid surface.
- Solidly bonded non-porous substrates such as ceramic tile and terrazzo must be thoroughly cleaned and abraded including the complete removal of existing waxes and sealers, dust, dirt, debris and any other contaminant that may act as a bond breaker.
- For use as an embossing leveler SCHÖNOX SL can be used over existing well-bonded full-spread adhered residential sheet vinyl. Do not use with cushion-backed floor covering. Prime with SCHÖNOX SHP
- Substrates such as epoxy or urethane based sealers/coatings are primed with SCHÖNOX SHP following the referring product data sheet prior to apply SCHÖNOX SL.
- Porous substrates as required for installing resilient flooring using wet set adhesives are achieved applying underlayments or patching compounds above 1/8".
- The requirements of the relevant valid standards (such as ASTM F710-22), guidelines and data sheets apply.
- Vacuum substrates thoroughly.

### Priming

- porous substrates such as:
  - concrete, cement substrates
  - OSB board, plywood (well screwed and/or bonded)
 no priming required.

### Technical data

- pot life: approx 10 - 20 minutes
- ready for foot traffic: after approx. 20 minutes
- ready for covering:
  - after approx. 20 minutes when applied as a true featheredge
- working temperature: 41°F - 90°F
- coverage per unit:
  - approx. 200 sq.ft. when applied as a true featheredge
  - approx. 35 sq.ft. at 1/8" (depending on substrate conditions)
- compressive strength (ASTM C109):
  - 25 N/mm<sup>2</sup> / 3700 psi after 28 days
- flexural strength (ASTM C348):
  - approx. 7 N/mm<sup>2</sup> / 1300 psi after 28 days
- classified in accordance with ASTM E84 (ANSI/UL 723):
  - Flame Spread 0; Smoke Development 0

All values are approximate, are subject to local climatic fluctuations based upon conditions at 70°F with atmosphere of less than 65 % relative humidity following the recommended mixing ratio. Do not install underlayment or topping before the substrate has dried thoroughly.





# SCHÖNOX SL

## ■ non porous substrates such as:

- ceramic tiles (thoroughly cleaned and abraded)
  - terrazzo
  - water-resistant adhesive residues (removed as far as possible)
- no priming required.

## ■ gypsum substrates (sanded and vacuumed) prime with SCHÖNOX KH FIX.

## Mixing ratio

- mix each 4.5kg / 10lb. bag with 1.9 liters / 2.0 quarts of water

## Recommended method of working

- Using a clean mixing bucket, add SCHÖNOX SL to cold, clean water to form a homogeneous mixture. Mix thoroughly for approx. 3 minutes using a heavy-duty drill (min. 600 rpm) to obtain a lump-free mix. Or mix smaller volumes by hand approx. 2 - 3 minutes to consistency. Apply, smooth and shape using a stainless steel smoother or a smoothing trowel.
- Do not mix more material than can be applied within 15 minutes.
- Protect curing SCHÖNOX SL layers from high ambient temperatures, direct sunlight and draughts.
- Clean tools in water immediately.

## Packaging

- 4.5kg / 10lb. net weight in paper bags

## Storage

- Store in cool and dry conditions.
- Shelf life: 18 months unopened.
- End of shelf life does not generally indicate the end of the products suitability for the intended use. Always test in a small area.

## Disposal

- Empty packaging and dispose of in accordance with federal, state and local waste disposal regulations.

## VOC Content

- 0g/l (calculated), SCAQMD 1113

## LEED

May help contribute to LEED v4 certification of projects in the categories:

- EQc2 - 3 points  
Low-Emitting Materials

- MRC1 - up to 2 points  
Life-Cycle Impact Reduction
- MRC2 - 1 point  
Environmental Product Declaration
- MRC4 - 1 point  
Material Ingredients

## Environmental Product Declaration (EPD)

- Declaration number:  
EPD-DBC-20220218-IBF1-EN

## Instructions

- Do not use in areas of constant water exposure (such as interior swimming pools).
- Always install an adequate number of properly located test areas, to include the finish flooring, to determine the suitability of the product for its intended use. As floor coverings vary, always contact and rely upon the floor covering manufacturer for specific directions such as maximum allowable moisture content, adhesive selection, and intended end use of the product.
- Low substrate temperatures and/or high ambient humidity require longer drying times.

## Precautions

- SCHÖNOX SL contains Portland cement. Avoid eye and skin contact. In case of contact, rinse immediately with plenty of water. In case of contact with eyes seek additional medical advice. Mix in a well ventilated area and avoid breathing powder or dust.
- Never mix with cement or additives other than SCHÖNOX approved products. Observe the basic rules of concrete work. Do not install below 41°F surface temperature. Install quickly if substrate is warm.

Prior to each use of any SCHÖNOX product, the user must always read and follow the warnings and instructions on the product's most current product label, Product Data Sheet and Safety Data Sheet which are available at [www.hpsubfloors.com](http://www.hpsubfloors.com), or by calling the Technical Service Department at 855-391-2649. Nothing contained in any SCHÖNOX materials relieves the user of the obligation to read and follow the warnings and instruction for each Schönox product as set forth in the current product label, Product Data Sheet and Safety Data Sheet prior to product use. This product data sheet supersedes all previous editions.



Management system certified to ISO 9001 and 14001 by SQS.

## In North America provided by:

HPS North America, Inc  
511 Wilhite Street Florence, AL 35630  
Phone: 256.246.0345  
Fax: 256.246.0346  
Email: [info@hpsubfloors.com](mailto:info@hpsubfloors.com)  
<http://www.hpsubfloors.com>

**SCHÖNOX**®

KEEP CONTAINER TIGHTLY CLOSED • KEEP OUT OF REACH OF CHILDREN • NOT FOR INTERNAL CONSUMPTION • FOR INDUSTRIAL USE ONLY • FOR PROFESSIONAL USE ONLY  
SCHÖNOX products are supplied in the USA by SCHÖNOX HPS North America, a business unit of HPS North America, Inc. (HPS SCHÖNOX).

For further information and advice regarding transportation, handling, storage and disposal of chemical products, users should refer to the actual Safety Data Sheets containing physical, ecological, toxicological and other safety related data. Read the current actual Safety Data Sheet before using the product. In case of emergency, call GBK/Infotrac ID 108313 at 1 800 535 5053 (USA) or 001 352 323 3500 (International). HPS SCHÖNOX warrants this product for one year from date of installation to be free from manufacturing defects and to meet the technical properties on the current Product Data Sheet if used as directed within shelf life. User determines suitability of product for intended use and assumes all risks. Buyer's sole remedy shall be limited to the purchase price or replacement of product exclusive of labor or cost of labor. NO OTHER WARRANTIES EXPRESSED OR IMPLIED SHALL APPLY INCLUDING ANY WARRANTY OF MERCHANTABILITY OR FITNESS FOR A PARTICULAR PURPOSE. HPS SCHÖNOX SHALL NOT BE LIABLE UNDER ANY LEGAL THEORY FOR SPECIAL OR CONSEQUENTIAL DAMAGES. HPS SCHÖNOX SHALL NOT BE RESPONSIBLE FOR THE USE OF THIS PRODUCT IN A MANNER TO INFRINGE ON ANY PATENT OR ANY OTHER INTELLECTUAL PROPERTY RIGHTS HELD BY OTHERS. Sale of SCHÖNOX products are subject to the Terms and Conditions of Sale which are available at [www.schonox.us](http://www.schonox.us).



Typical Walk-Off Mat Dimensions at Each Classroom

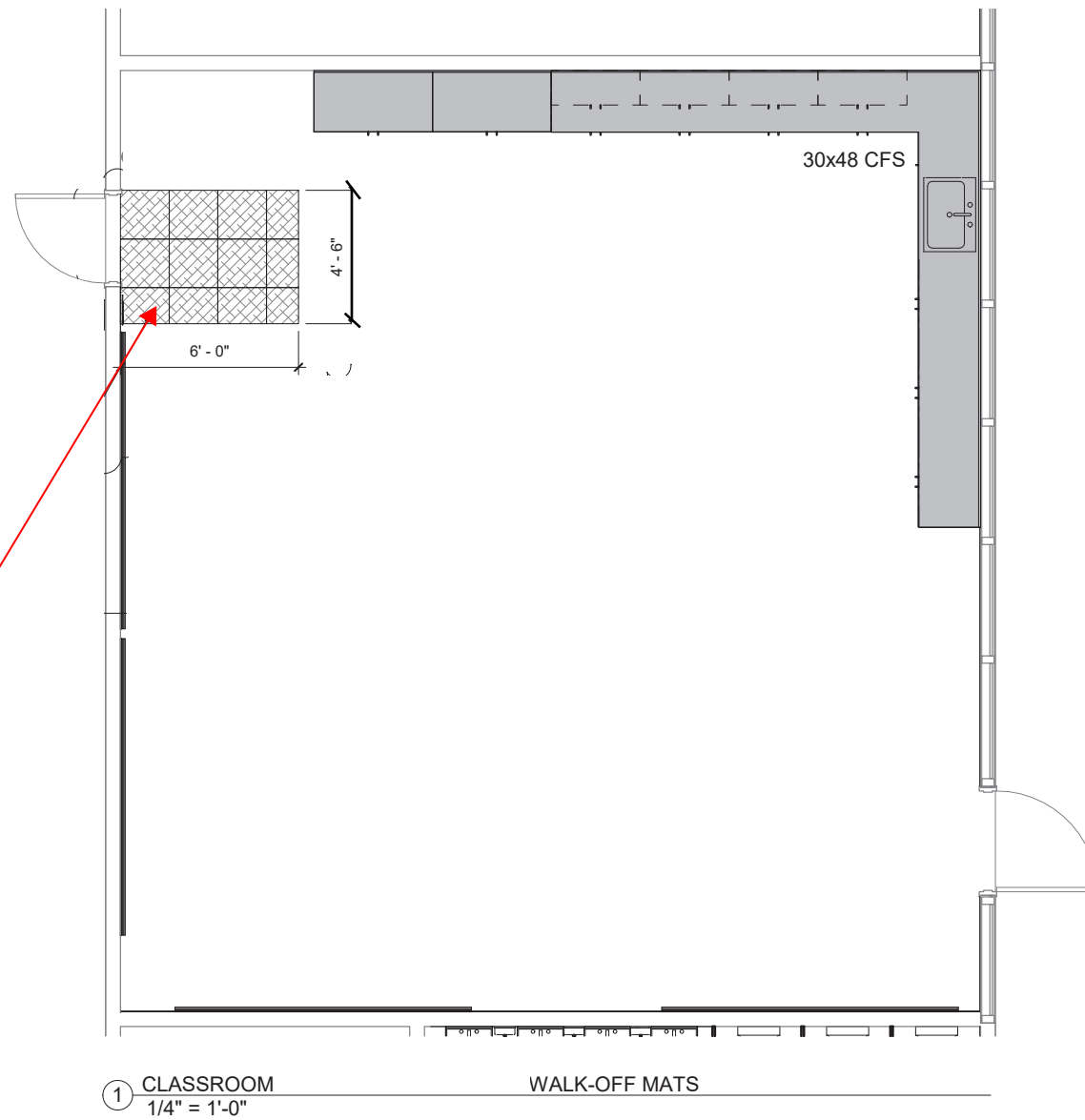

Attachment "C" Walk-Off Mat Locations and Dimensions