



BAKERSFIELD CITY SCHOOL DISTRICT

MAINTENANCE, OPERATIONS & FACILITIES

1501 FELIZ DRIVE

BAKERSFIELD, CALIFORNIA 93307

(661) 631-5883 FAX: (661) 834-9986

Michael Hamlin, DirectorHamlinm@bcscd.com**Daniel Wastafarro, Assistant Director**wastafarro@bcscd.com**Gary Long, Assistant Director**longg@bcscd.com**Jason Sitton, Assistant Director**sittonj@bcscd.com**Education Center**

1300 Baker Street

Bakersfield, CA 93305

Office: (661) 631-4600

Fax: (661) 326-1485

January 26, 2023

To: All interested Bidders

Re: Project #22244.00-73-MD: Installation of concrete masonry walls, iron fencing and operable access gates at the perimeter of the District's Maintenance and Transportation yard

ADDENDUM 3:

Contract Documents and addenda are available for review at the District Facilities Office or documents can be downloaded from the following website link:

<http://mot.bcsd.com/Construction%20Consultants/MOT%20Yard%20-%20Perimeter%20Wall%20and%20Iron%20Fencing/>

1. Refer to addenda 2, item 1; revise the schedule as follows
 Construction shall be performed in four phases. See attached overall site plan for phasing locations. Construction days shall remain at 222 calendar days based on the following schedule:
 Phase 1a and 1b – Begin on or before March 27, 2023. Phases to be complete on or before May 19, 2023.
 Phase 2 – Begin on or before May 22, 2023. Phase to be complete on or before July 28, 2023.
 Phase 3 – Begin on or before July 31, 2023. Phase to be complete on or before September 15, 2023.
 Phase 4 – Begin on or before September 18, 2023. Phase to be complete on or before November 11, 2023.
2. Schedule for new iron fencing and gates installation will be as follows: Fencing and Gate 1 – April 3rd through April 11th. Gate 2 will be included within the phase 1a and 1b schedule as indicated above. Gates 3 and 4 will be included within the phase 4 schedule. Successful contractor will need to coordinate installation with wall construction contractor.
3. Refer to drawings, sheet 2, details B/2, D/2 and E/2. Add new curb and gutter to already noted wall and footing construction. Add curb and gutter details A and B to scope of work. See attached details.

4. Refer to drawings, sheet 3, overall partial site plan. Add new curb and gutter scope to already noted wall and footing construction. Provide demo as indicated. Added scope area denoted by red line designation. Provide weep holes as designated by red dashed boxes. See attached plan and details as indicated in note 3 above.
5. Refer to drawings, sheet 3, overall partial site plan. The south entry and exit drives, exterior curbs located on north and south sides of drives will be required to be sawcut as necessary and replace back to previous condition. See attached pictures of existing conditions.
6. Refer to drawings, sheet 4, overall partial site plan. Add new curb and gutter scope to already noted wall and footing construction. Provide demo as indicated. Added scope area denoted by red line designation. See attached plan and details as indicated in note 3 above.
7. Refer to drawings, sheet 4, south boundary; gate and motor to be demolished by contractor. Electrical will be abandoned by the district. No gate is required to be included in this area.
8. Refer to the phase 4 construction; an existing utility pole is located adjacent to the existing fencing planned for removal. Extra caution should be taken near the existing pole during construction. See attached picture.

The following items are recent RFI questions for clarification.

Q1 - Along the south section of MLK and the west section of the community services wall there is a curb and gutter and the existing fence is butted up right next to the curb part of the curb and gutter. Per the detail on sheet 2 of the plans the new block wall is about 6" from the fence which would require the removal of this existing curb and gutter for the new footing. However, the plans do not show a new curb and gutter being installed on the MOT side of the new block wall. Shall a new curb and gutter be installed or will the water just run along the block wall?

Answer - Yes, the planned scope for these areas is to demo and replace all curbs/gutter and V gutter to accommodate the wall/footing installation. Asphalt will also need to be removed to accommodate these additions. New curbs and gutter to be installed per clarification info indicated above and updated drawings are attached to this addendum.

Q2 - Per Note 4: Add 2 can you provide the actual quantity of solid 1/4 inch Ornamental fencing required at South side of west exit gate?

Answer - Provide the solid steel panel for the entire small area of fencing between posts and the floating panel south of gate 2. The distance indicate is approximately +/-8'-4" per issued drawings under addenda 2.

Q3 - Ref Add 2 Note13: Gate Operators. Can you clarify whether new gate operator motor uses existing motor concrete pads, or any new concrete work required for anchoring new motor or any new angle track embedment needed? Provide demo of existing concrete motor pad as needed and provide new pad as needed for new motor controller. Existing angle track to be removed. New angle track will be provided, 2x2 angle with already attached J-hooks for embedment into cored holes of existing concrete.

Q4 - Is there any safety or access control devices needed for new operators ? ie-photo beam, edge for gates, loops, keypads ,transmitters, receivers.

Answer - Any new items required for operation of the gates will be provided and installed by District's vendor for this set up.

Q5 - As per Note 8: Who provides the 3inch X 12 inch galvanized sleeves for the block wall set at 32 inches , o,c .

Answer - New wall construction contractor will provide these.

Please date, sign and return this Addenda 3 acknowledgement to me at the e-mail indicated below

Date	Print Name	Signature
------	------------	-----------

Print Company Name

Please direct any questions to me at 661-631-5883

Robert Van Tassel
Supervisor – School Planning & Construction
vantasselr@bcisd.com

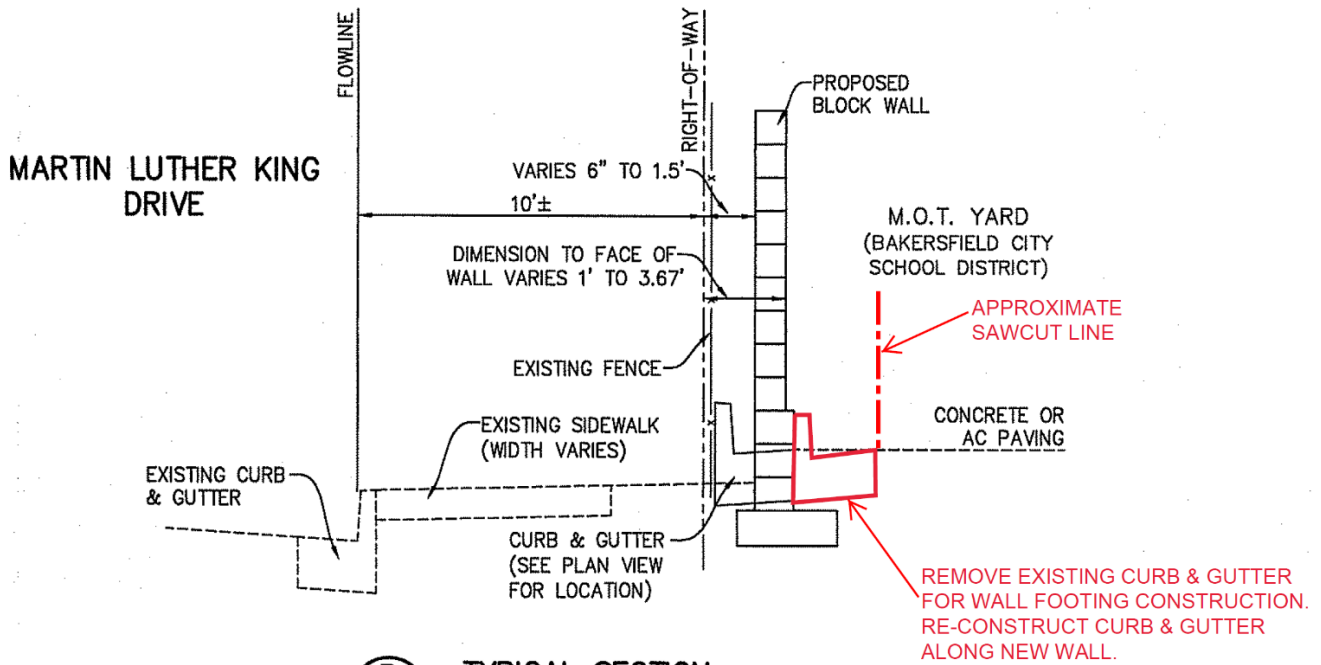

B
 2
TYPICAL SECTION
 NOT TO SCALE

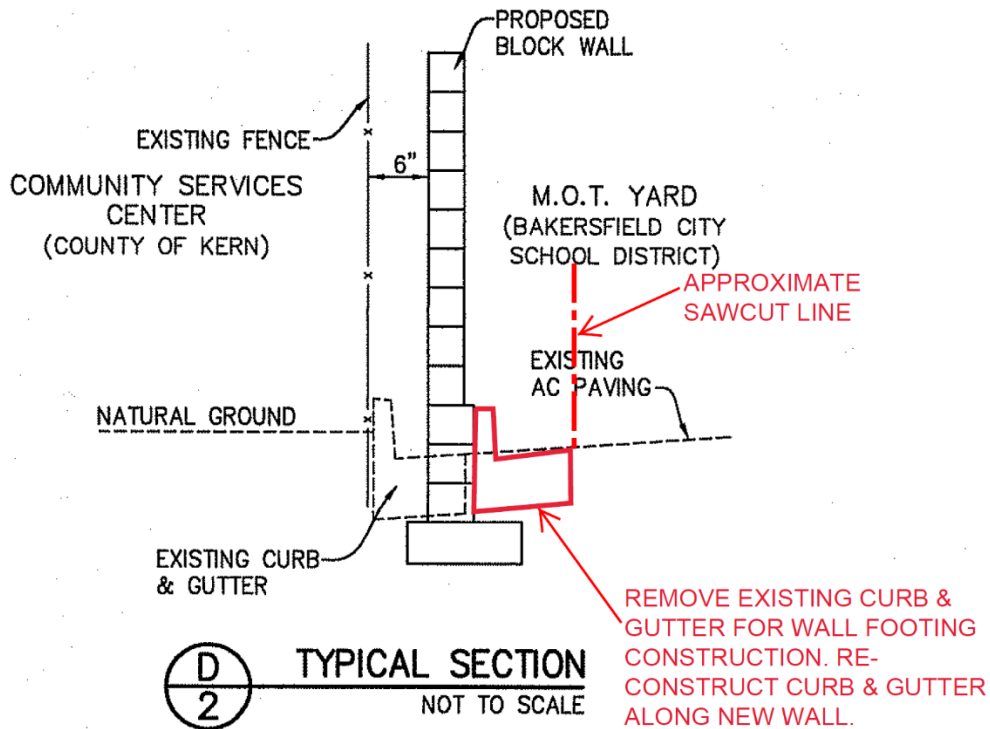

D
 2
TYPICAL SECTION
 NOT TO SCALE

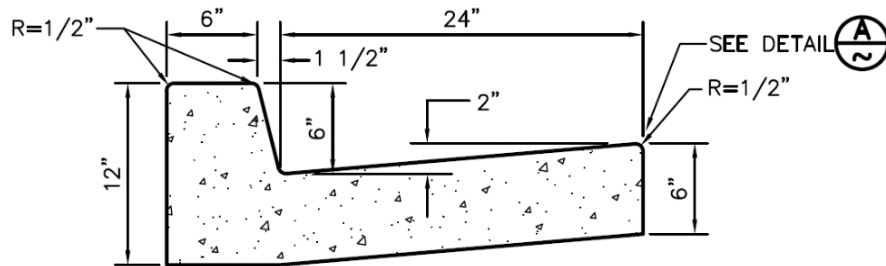
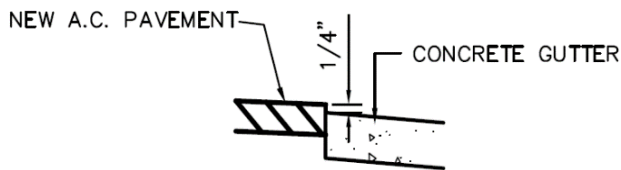
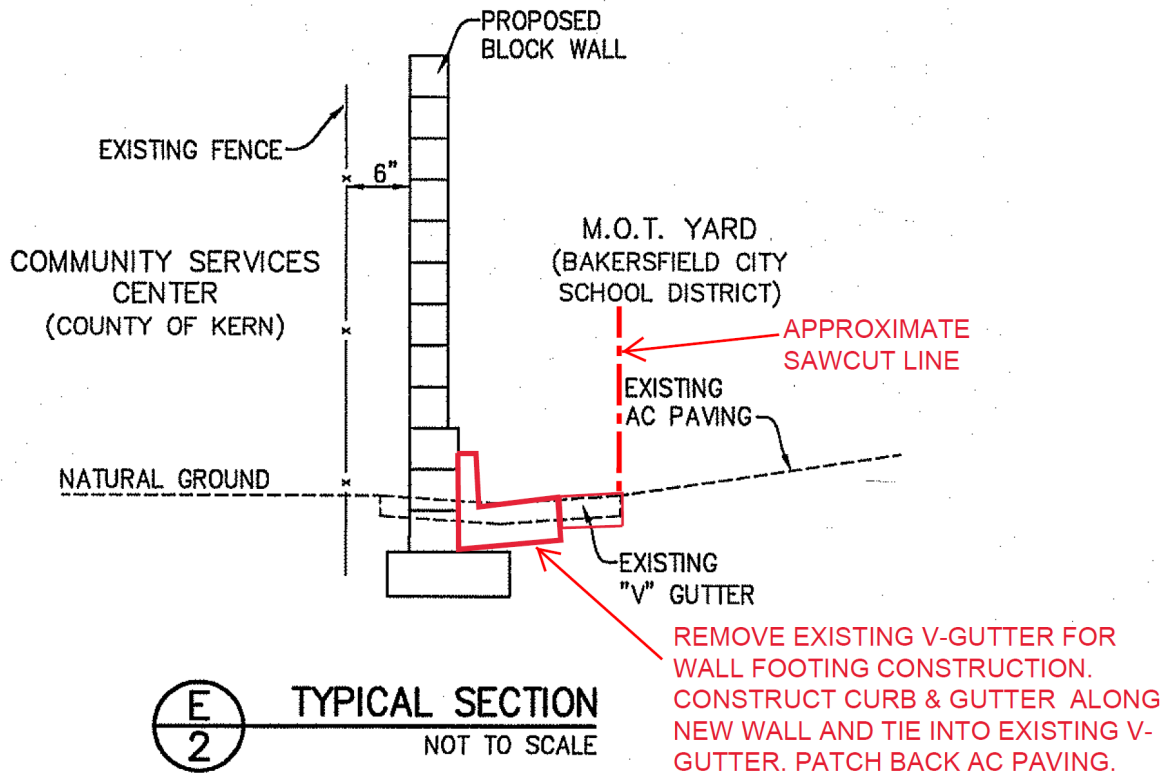



Utility pole with possible underground conduits to be aware of

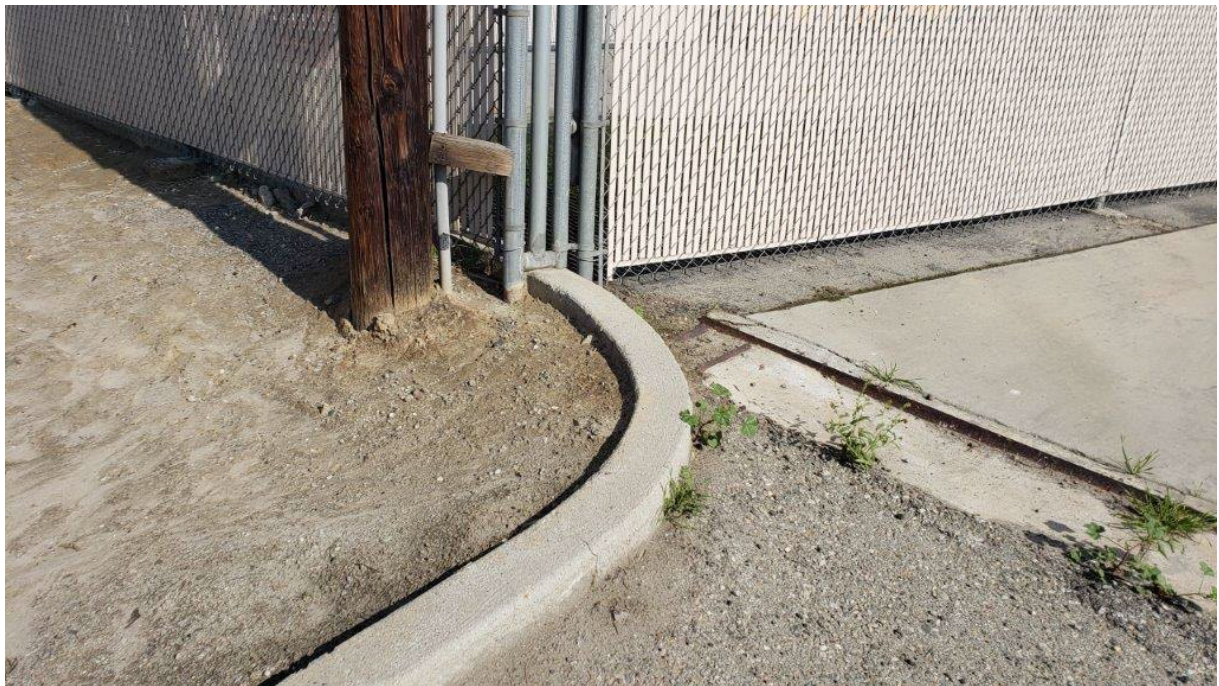

South entry – north side condition



South entry – south side condition



South exit – north side condition



South exit – south side condition

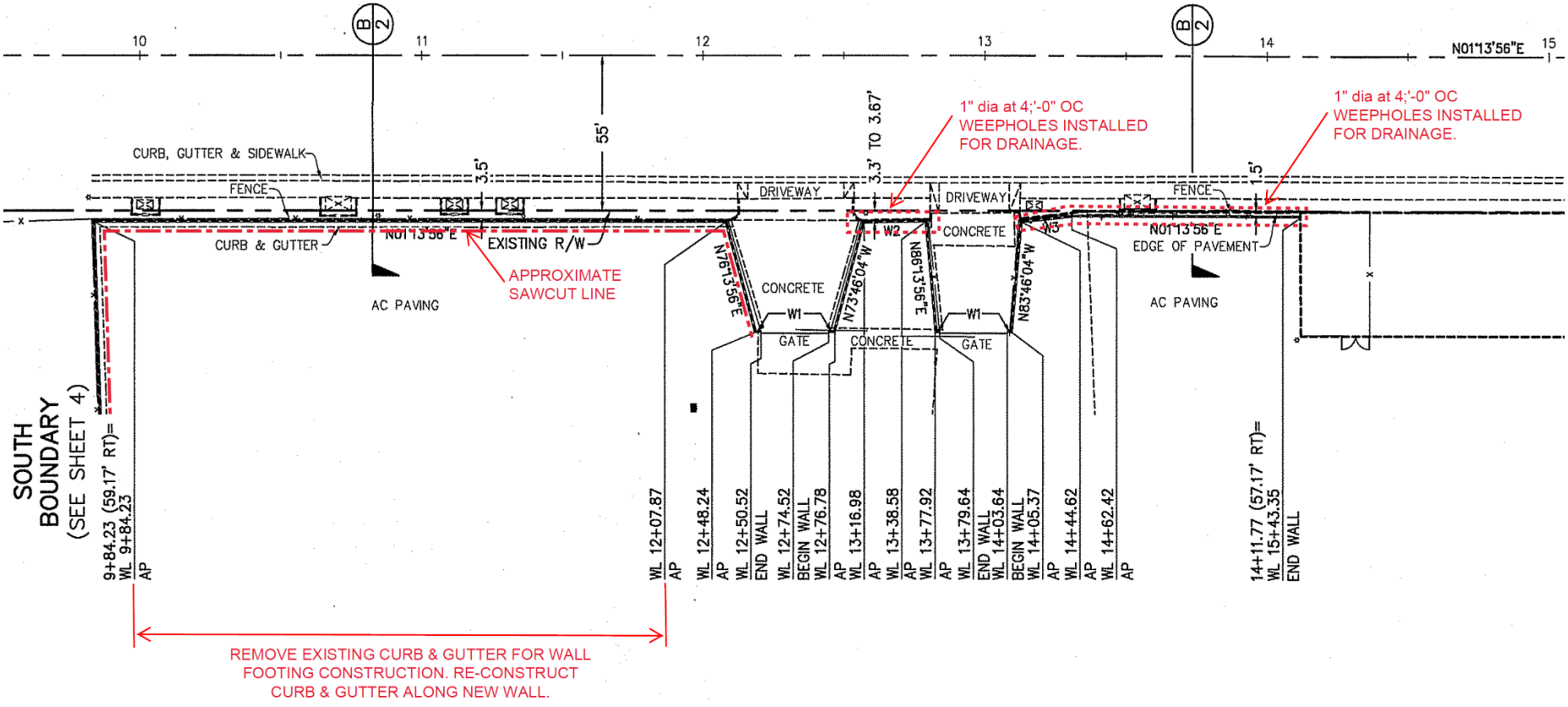

MARTIN LUTHER
KING DRIVE
(SEE SHEET 3)

9+84.23 (59.17' RT)=
WL 9+84.23
AP

WL 12+61.58
AP

M.O.T. YARD
(BAKERSFIELD CITY SCHOO

COMMUNITY SERVICE
(COUNTY OF KE

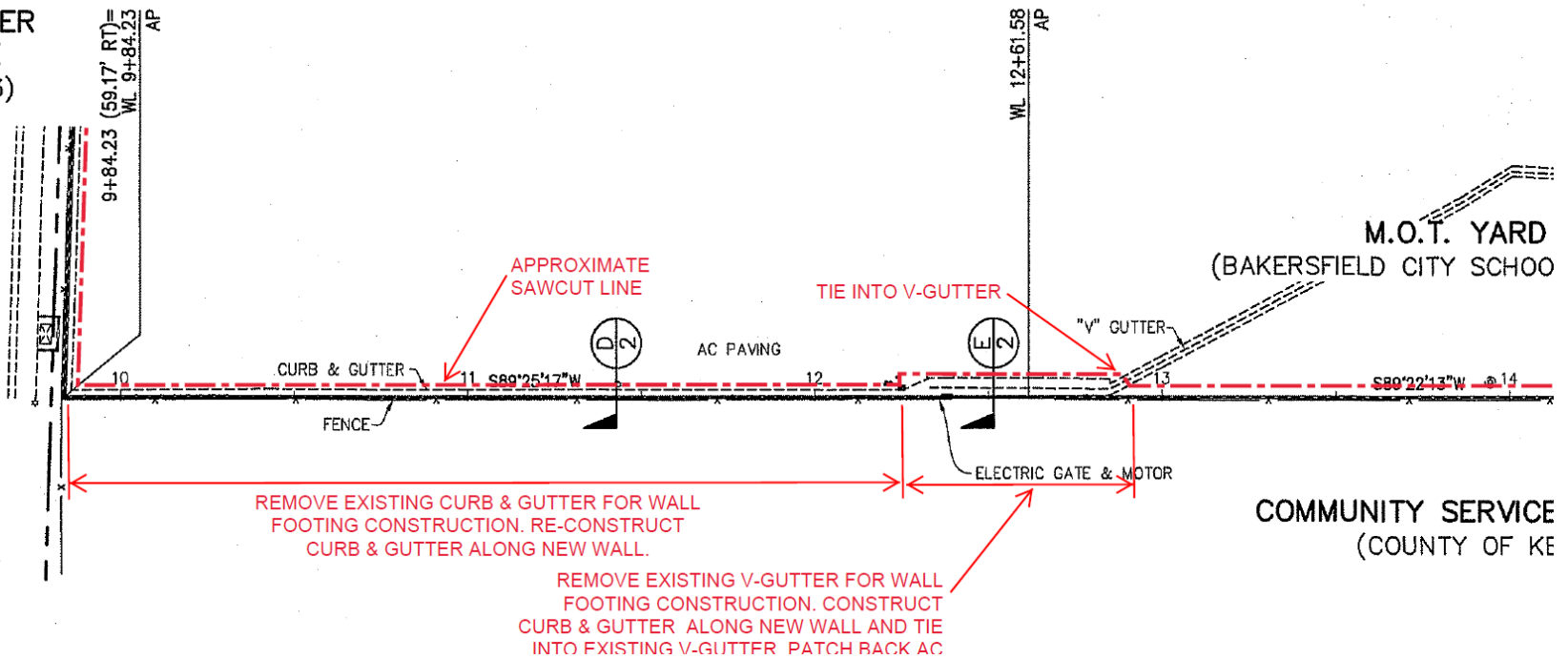

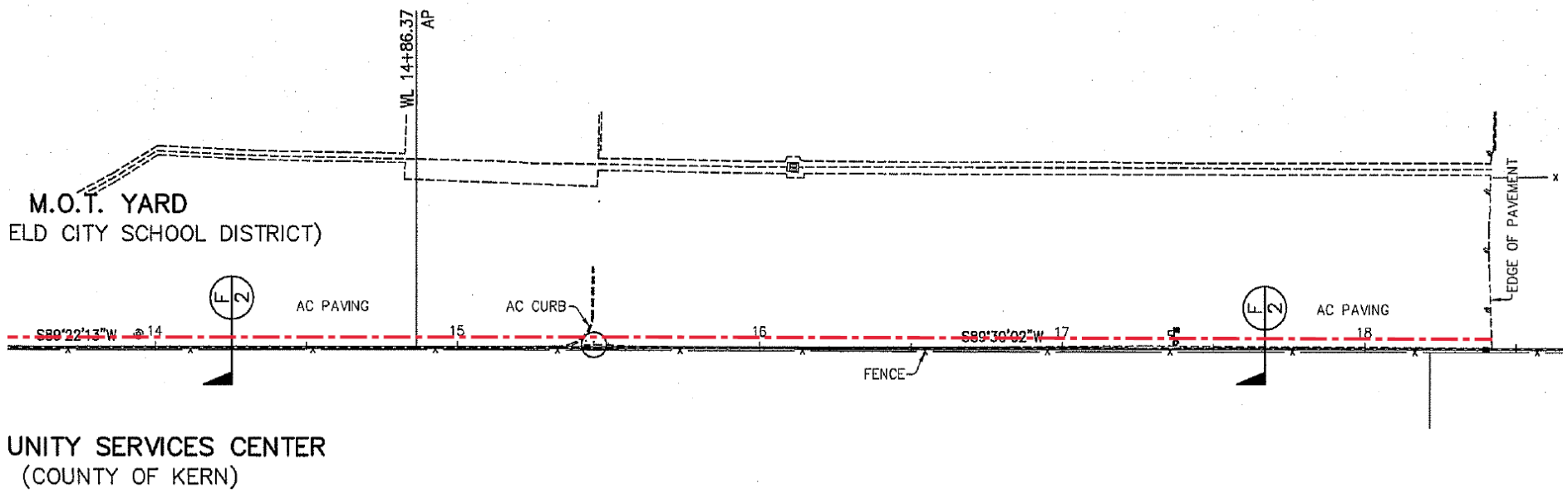

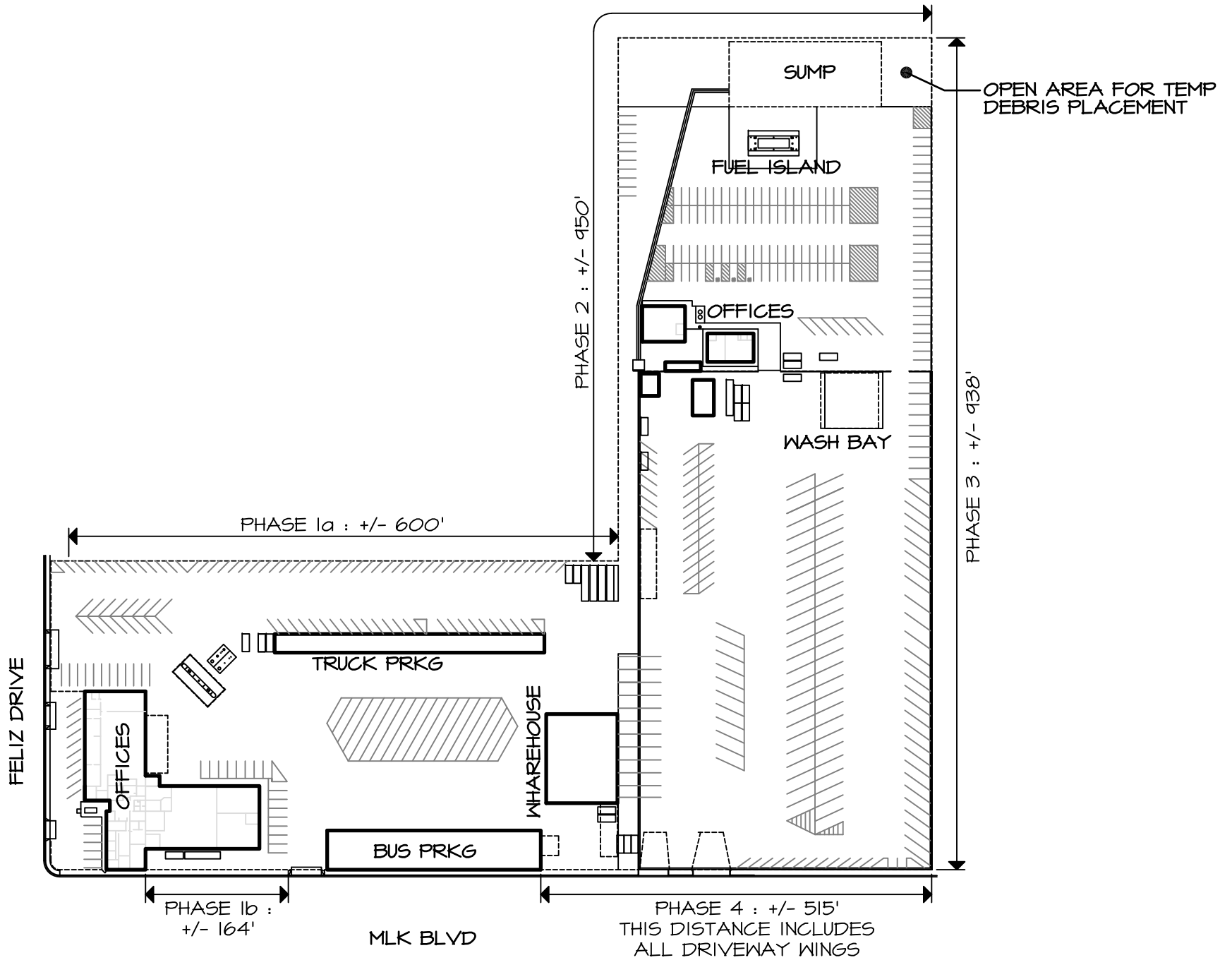

MOT YARD - OVERALL SITE PLAN
PHASING PLAN , 1-26-23