

PRIVATE WALL PLANS

BAKERSFIELD CITY SCHOOL DISTRICT

M.O.T. YARD - 1501 FELIZ DRIVE

BAKERSFIELD, CALIFORNIA

BENCHMARK USED:

TOP OF CONCRETE MONUMENT IN LAMPHOLE AT THE EAST QUARTER CORNER OF SECTION 5, 30/28 M.D.M. LYING 29.45' SOUTH OF THE CENTERLINE INTERSECTION OF EAST BELLE TERRACE AND COTTONWOOD ROAD.

ELEVATION = 385.41 (CITY DATUM) PER TRACT 6378 PLANS

SUBTRACT 1.52' TO OBTAIN COUNTY DATUM.

COUNTY BENCHMARK: CHISELED "O" ON TOP OF CURB, NORTH SIDE OF EAST BELLE TERRACE 175'± WEST OF COTTONWOOD ROAD AT EASTERLY END OF DRIVE APPROACH.

ELEVATION= 384.44 (COUNTY DATUM) PER K.C.S.F.B. 1055, PAGE 79.

BASIS OF BEARINGS:

THE BEARING OF NORTH 01°13'56" EAST AS SHOWN FOR THE WEST LINE OF THE NORTHWEST QUARTER OF SECTION 4, T. 30 S., R. 28 E., M.D.B. & M. (ALSO BEING THE CENTERLINE OF MARTIN LUTHER KING DRIVE) AS PER PARCEL MAP 11782 FILED NOVEMBER 26, 2008 IN BOOK 57 OF PARCEL MAPS, AT PAGE 34 IN THE OFFICE OF THE KERN COUNTY RECORDER WAS USED AS THE BASIS OF BEARINGS SHOWN UPON THESE PLANS.

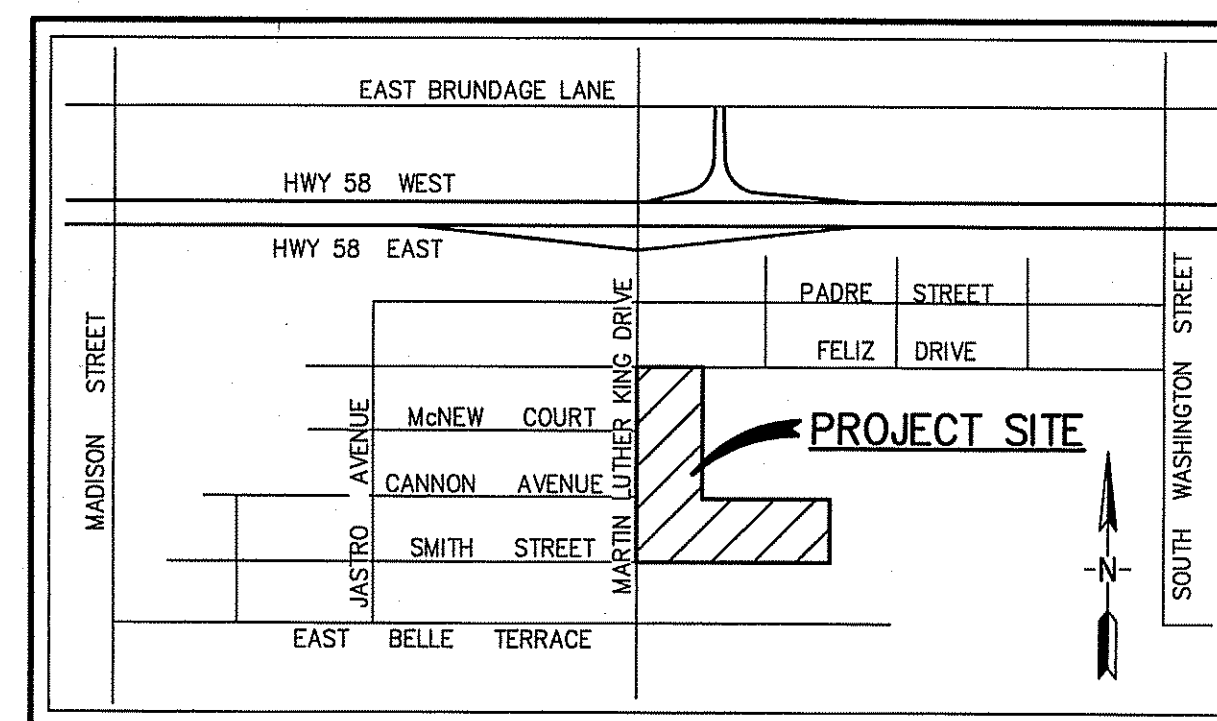

VICINITY MAP
NO SCALE

MATERIALS LIST
ESTIMATED QUANTITIES FOR PLAN CHECK AND INSPECTION FEE CALCULATIONS. NOT TO BE USED FOR BIDDING PURPOSES.

BLOCK WALL	3,166 LF
8' WROUGHT IRON FENCE	171 LF

SHEET No. INDEX

- ① TITLE SHEET
- ② GENERAL NOTES
TYPICAL SECTIONS
- ③ MARTIN LUTHER KING DRIVE
- ④ SOUTH BOUNDARY
- ⑤ SOUTH PORTION - EAST BOUNDARY
NORTH BOUNDARY
- ⑥ NORTH PORTION - EAST BOUNDARY
- ⑦ FELIZ DRIVE

KEY MAP LEGEND

- Ⓧ SHEET INDEX NUMBER
- - - PROPOSED BLOCK WALL

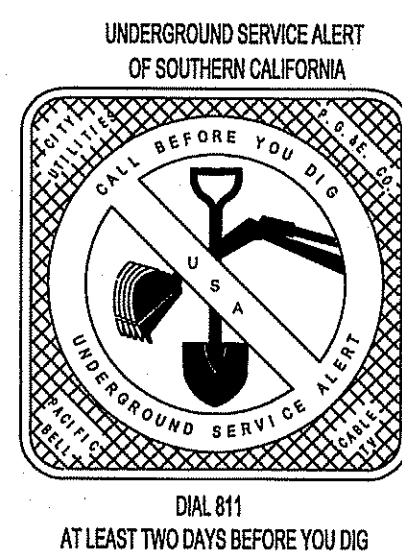

OPEN STREET PERMIT NOTE
AN OPEN STREET PERMIT SHALL BE OBTAINED FROM THE CITY OF BAKERSFIELD PUBLIC WORKS DEPARTMENT FOR ANY WORK PERFORMED WITHIN EXISTING ACCEPTED STREET RIGHT OF WAY. UNLESS SECURED BY A SUBDIVISION AGREEMENT, SECURITY BASED ON AN APPROVED ENGINEER'S ESTIMATE FOR THE WORK PERFORMED WITHIN RIGHT OF WAY AND INSURANCE AS REQUIRED SHALL BE PROVIDED PRIOR TO ISSUANCE OF A PERMIT.

CITY INSPECTION NOTE
NO CITY INSPECTIONS SHALL BE GIVEN FOR THE WORK IN THIS AREA UNTIL AN ENCROACHMENT PERMIT WITH APPROPRIATE SECURITY AND INSURANCE HAS BEEN OBTAINED.

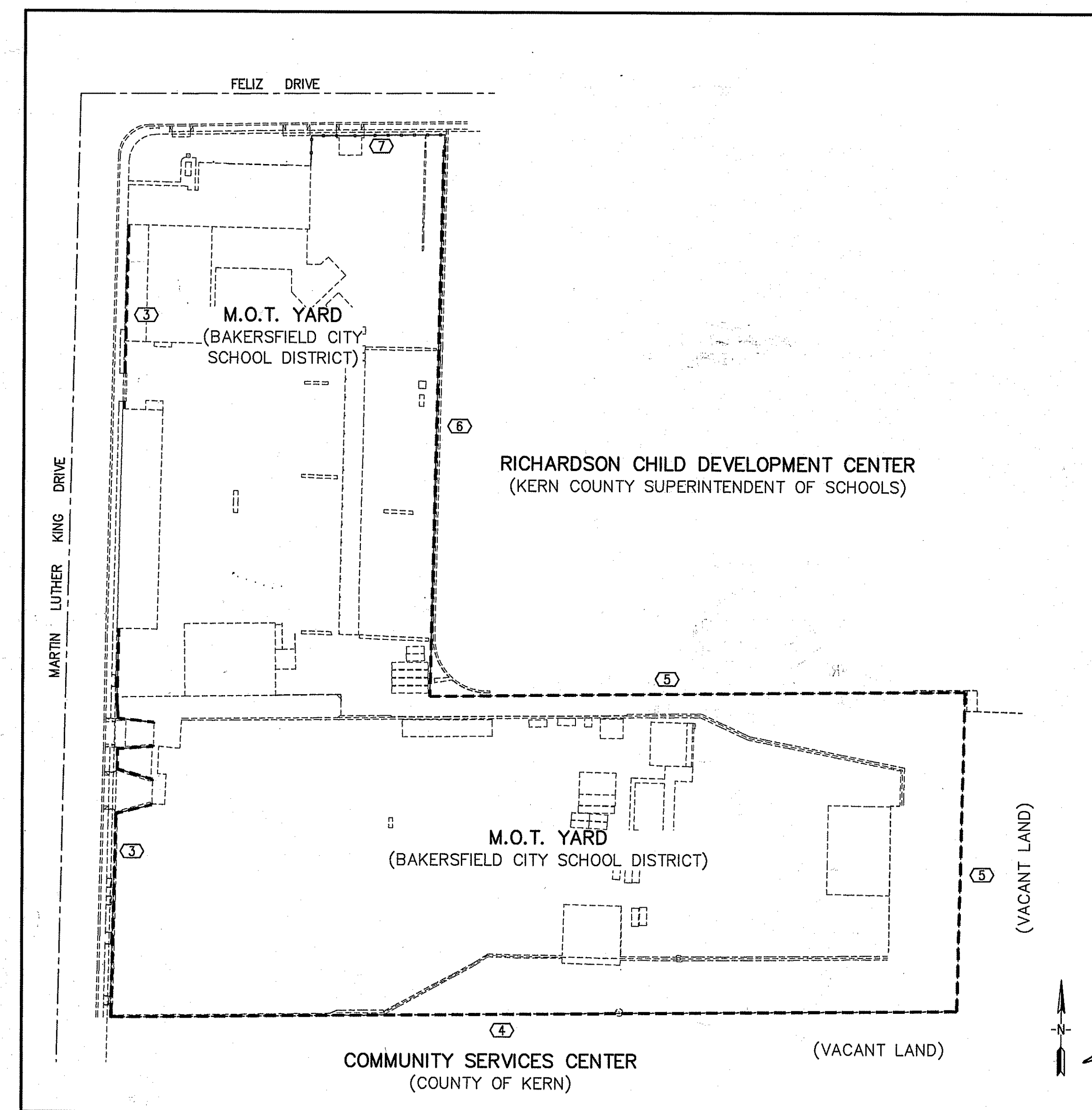

KEY MAP
SCALE: 1"=100'

ENGINEER'S STATEMENT:

THESE PLANS AND SPECIFICATIONS WERE PREPARED BY ME OR UNDER MY DIRECTION, AND TO THE BEST OF MY KNOWLEDGE AND BELIEF COMPLY WITH CITY OF BAKERSFIELD ORDINANCES, STANDARDS AND DESIGN CRITERIA, AND INCLUDE ALL IMPROVEMENT REQUIREMENTS OF THE ADVISORY AGENCY OR OTHER REVIEW BOARD. ANY ERRORS, OMISSIONS OR OTHER VIOLATIONS OF THOSE ORDINANCES, REGULATIONS OR DESIGN CRITERIA ENCOUNTERED DURING CONSTRUCTION SHALL BE CORRECTED AT THE CONTRACTOR'S EXPENSE. ALL WORK SHALL BE CONDUCTED IN ACCORDANCE WITH THE CITY ENGINEER'S AS-BUILT PLANS TO BE SUBMITTED TO THE CITY ENGINEER.

PORTER & ASSOCIATES, INC.
ENGINEERING & SURVEYING
1200 21st Street, Bakersfield, California 93301
861.327.0362 FAX 861.327.1065

FRED W. PORTER II
PROJECT ENGINEER: 000,000
DRAFTSMAN: LQH
PA REVIEW BY: _____
DATE: _____

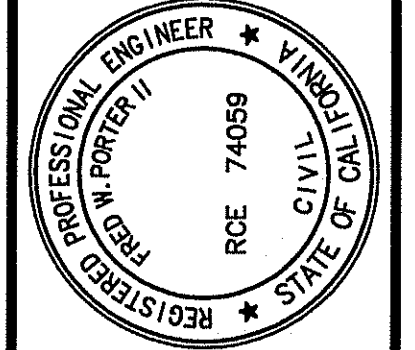

WALL PLANS
BAKERSFIELD CITY SCHOOL DISTRICT
M.O.T. YARD - 1501 FELIZ DRIVE
TITLE SHEET

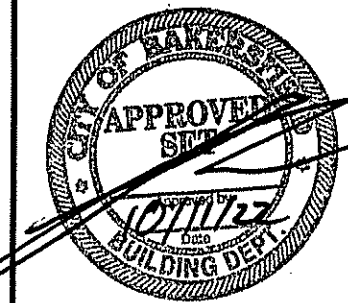

DATE: 08/23/2022
PA JOB No. 3239
SHEET
1
OF 7 SHEETS

COB RECORDS No. _____

GENERAL NOTES

- ALL CONSTRUCTION SHALL CONFORM TO THIS PLAN, THE CALIFORNIA BUILDING CODE, LATEST EDITION, AND STANDARDS PERTAINING THERETO. THESE DOCUMENTS SHALL BE MADE A PART HEREOF.
- ALL CONSTRUCTION WITHIN THE CITY RIGHT-OF-WAY OR CITY EASEMENTS SHALL BE IN ACCORDANCE WITH THE PROPOSED CITY OF BAKERSFIELD STANDARDS AND STATE OF CALIFORNIA, DEPARTMENT OF TRANSPORTATION STANDARD SPECIFICATIONS, LATEST EDITION. THESE STANDARDS, DRAWINGS AND DETAILS SHALL BE CONSIDERED A PART OF THESE PLANS AND THE CONTRACTOR SHALL OBTAIN A COPY FOR HIS USE.
- THE CONTRACTOR SHALL OBTAIN AND PAY FOR ALL NECESSARY PERMITS BEFORE START OF CONSTRUCTION. AN OPEN STREET PERMIT SHALL BE OBTAINED FROM THE CITY OF BAKERSFIELD PUBLIC WORKS DEPARTMENT FOR ANY WORK TO BE PERFORMED IN THE EXISTING, ACCEPTED STREET RIGHT-OF-WAY. UNLESS SECURED BY AN IMPROVEMENT AGREEMENT, APPROVED INSURANCE AND SECURITY BASED ON AN APPROVED ENGINEER'S ESTIMATE FOR THE WORK PERFORMED WITHIN THE STREET RIGHT-OF-WAY SHALL BE POSTED PRIOR TO ISSUANCE OF A PERMIT.
- 24 HOUR NOTICE: PRIOR TO THE START OF ANY PHASE OF CONSTRUCTION, THE CITY CONSTRUCTION INSPECTION SECTION SHALL BE GIVEN AT LEAST 24 HOURS NOTICE. THE SECTION MAY BE NOTIFIED AT (661) 328-3049.
- THE CONTRACTOR IS RESPONSIBLE FOR VERIFYING DIMENSIONS, DATA AND MEASUREMENTS AT THE BUILDING SITE PRIOR TO CONSTRUCTION. DO NOT SCALE DRAWINGS. WRITTEN DIMENSIONS ON THESE DRAWINGS SHALL HAVE PRECEDENCE OVER SCALED DIMENSIONS. PORTER & ASSOCIATES, INC. MUST BE NOTIFIED OF ANY VARIATIONS FROM THE DIMENSIONS AND CONDITIONS SHOWN BY THESE DRAWINGS.
- EXISTING UTILITY AND UNDERGROUND LINES HAVE BEEN SHOWN ON THIS PLAN ACCORDING TO AVAILABLE RECORDS. THE ENGINEER IS NOT RESPONSIBLE FOR POSSIBLE ERRORS OR OMISSIONS. THE CONTRACTOR IS RESPONSIBLE FOR VERIFICATION OF THE LOCATION AND DEPTH OF ALL UTILITIES PRIOR TO BEGINNING OF ANY WORK. UNDERGROUND SERVICE ALERT (U.S.A.: 811) SHALL BE CONTACTED AT LEAST TWO WORKING DAYS PRIOR TO ANY CONSTRUCTION OR EXCAVATION.
- ANY EXISTING IMPROVEMENTS OR UTILITIES THAT ARE REMOVED, DAMAGED OR UNDERCUT BY THE CONTRACTOR'S OPERATIONS SHALL BE REPAIRED OR REPLACED AT THE CONTRACTOR'S EXPENSE, AS DIRECTED BY THE ENGINEER AND APPROVED BY THE GOVERNING AUTHORITY.
- IF A PROBLEM OR CONFLICT SHOULD ARISE DURING THE COURSE OF THE PROJECT, IT IS THE RESPONSIBILITY OF THE OWNER OR THE CONTRACTOR TO NOTIFY THE ENGINEER IMMEDIATELY PRIOR TO ANY FURTHER WORK.
- THE CONTRACTOR SHALL FURNISH ALL LABOR, MATERIALS, TOOLS, EQUIPMENT AND SUPERVISION NECESSARY FOR A COMPLETE AND FUNCTIONAL PRODUCT.
- ALL WORK WHICH IS DEFECTIVE IN ITS CONSTRUCTION OR DEFICIENT IN ANY OF THE REQUIREMENTS OF THESE DRAWINGS AND SPECIFICATIONS SHALL BE REMEDIATED, OR REMOVED AND REPLACED BY THE CONTRACTOR IN AN ACCEPTABLE MANNER, AND NO COMPENSATION WILL BE ALLOWED FOR SUCH CORRECTION.
- IN THE EVENT CONSTRUCTION STAKING BASED ON THE CONSULTANT'S PLANS, DRAWINGS OR OTHER DOCUMENTS IS ACCOMPLISHED BY ANYONE OTHER THAN THE CONSULTANT, THE OWNER OR CONTRACTOR SHALL NOTIFY THE BUILDING OFFICIAL IN WRITING AS TO THE CHANGE OF ENGINEER IN RESPONSIBLE CHARGE.
- THE CONTRACTOR AGREES THAT HE SHALL ASSUME SOLE AND COMPLETE RESPONSIBILITY FOR JOB SITE CONDITIONS DURING THE COURSE OF CONSTRUCTION OF THIS PROJECT; INCLUDING EROSION, SEDIMENTATION & DUST CONTROL PLAN AND STORM WATER POLLUTION PREVENTION PLAN IMPLEMENTATION AND THE SAFETY OF ALL PERSONS AND PROPERTY; THAT THIS REQUIREMENT SHALL APPLY CONTINUOUSLY AND NOT BE LIMITED TO NORMAL WORKING HOURS; AND THAT THE CONTRACTOR SHALL DEFEND, INDEMNIFY AND HOLD THE OWNER AND THE ENGINEER HARMLESS FROM ANY AND ALL LIABILITY, REAL OR ALLEGED, IN CONNECTION WITH THE PERFORMANCE OF WORK ON THIS PROJECT, EXCEPTING FOR LIABILITY ARISING FROM THE SOLE NEGLIGENCE OF THE OWNER OR THE ENGINEER.
- IF THE CONTRACTOR IS IN DOUBT AS TO THE MEANING OF ANY PART OF THE DRAWINGS AND SPECIFICATIONS OR FINDS DISCREPANCIES IN OR OMISSIONS FROM THE DRAWINGS, HE SHALL SUBMIT A WRITTEN REQUEST FOR AN INTERPRETATION OR A CORRECTION THEREOF, PRIOR TO FILING HIS BID PRICE FOR THE PROJECT.
- PORTER & ASSOCIATES, INC. WILL NOT BE RESPONSIBLE OR LIABLE FOR UNAUTHORIZED CHANGES TO OR USES OF THESE PLANS. ANY AND ALL CHANGES TO THESE PLANS MUST BE APPROVED IN WRITING BY PORTER & ASSOCIATES, INC.
- AN OPEN STREET PERMIT SHALL BE OBTAINED FROM THE CITY OF BAKERSFIELD PUBLIC WORKS DEPARTMENT FOR ANY WORK PERFORMED WITHIN EXISTING ACCEPTED STREET RIGHT OF WAY, UNLESS SECURED BY A SUBDIVISION AGREEMENT, SECURITY BASED ON AN APPROVED ENGINEER'S ESTIMATE FOR THE WORK PERFORMED WITHIN RIGHT OF WAY AND INSURANCE AS REQUIRED SHALL BE PROVIDED PRIOR TO ISSUANCE OF A PERMIT.
- NO CITY INSPECTIONS WILL BE GIVEN FOR THE WORK IN THIS AREA UNTIL A SUBDIVISION PERMIT WITH APPROPRIATE SECURITY AND INSURANCE HAS BEEN OBTAINED.
- ANY WORK CONNECTING TO EXISTING PUBLIC FACILITIES FROM PRIVATE PROPERTY WILL REQUIRE AN ENGINEER'S ESTIMATE FOR THE WORK IN THE EXISTING PUBLIC RIGHT-OF-WAY TO ESTABLISH THE NECESSARY DEPOSIT FOR A STREET PERMIT. (FOR TRACTS WITH PRIVATE STREETS, PARCEL MAP IMPROVEMENTS, OR PUBLIC TRACTS WITHOUT RECORDED MAPS).
- ANY ITEMS IN PUBLIC RIGHT-OF-WAY THAT ARE DAMAGED OR DO NOT MEET CURRENT STANDARDS SET BY PUBLIC WORKS WILL REQUIRE REPAIRING AND/OR UPGRADING AS PER CITY ENGINEER.
- NORMAL STAKING AND MARKING OF THE PROJECT WILL BE SUPPLIED ONLY ONCE. ALL RESTAKING OR REMARKING SHALL BE AT THE EXPENSE OF THE CONTRACTOR.
- PRIOR TO THE START OF ANY PHASE OF CONSTRUCTION WITHIN THE STREET RIGHT-OF-WAY, THE CONTRACTOR SHALL GIVE THE CITY CONSTRUCTION INSPECTION DEPARTMENT AND THE CITY PARKS DEPARTMENT 48 HOURS NOTICE.

WALL NOTES

- CONTRACTOR SHALL BE RESPONSIBLE FOR CLEARING AND GRADING ALONG THE WALL LINE.
- BEARING SOIL SHALL BE COMPACTED TO 90% OF MAXIMUM DRY DENSITY AS DETERMINED BY ASTM D-1557 TO A DEPTH OF 12 INCHES BELOW BOTTOM OF FOOTING.
- EXCAVATED AREAS WIDER THAN WIDTH OF FOOTING SHALL BE RECOMPACTED TO 90% RELATIVE COMPACTION TO TOP OF FOOTING OR FILLED WITH CONCRETE.
- FOR ALL BLOCK WALLS WITHIN THE CITY RIGHT-OF-WAY OR EASEMENTS, THE CONTRACTOR WILL BE RESPONSIBLE FOR COMPACTION TESTS. THE NUMBER AND LOCATION OF TESTS TO BE DETERMINED BY THE CITY ENGINEER.
- WATERPROOF SURFACE IN ACCORDANCE WITH WATERPROOFING SPECIFICATIONS. COAT ONLY THAT PORTION BELOW HIGHEST GRADE SIDE DOWN TO FOOTING.
- OMITTED HEAD JOINTS SHALL SERVE AS WEEP HOLES. HEAD JOINTS SHALL BE OMITTED AT A SPACING OF 16 INCHES ON CENTER. DO NOT WATERPROOF OVER OMITTED HEAD JOINTS.
- FOR BLOCK WALLS THAT SERVE AS SCREEN FENCES, PROVIDE VERTICAL EXPANSION JOINTS PER BLOCK MANUFACTURER'S RECOMMENDATIONS. IF NO RECOMMENDATIONS EXIST, PROVIDE EXPANSION JOINTS WITH 3/8"-MAX. GAP AT MAXIMUM 48 FOOT INTERVALS ALONG THE ENTIRE LENGTH OF THE CONCRETE MASONRY BLOCK WALL.
- THE HEIGHT OF BLOCK WALLS THAT SERVE AS SCREEN FENCES SHALL BE 6'-0" MIN. MEASURED FROM THE HIGHEST ADJACENT GROUND.
- MASONRY BLOCK WALL PATTERN SHALL BE RUNNING BOND (COMMON BOND), UNLESS OTHERWISE NOTED.
- REBAR SPLICES SHALL BE LAPPED MINIMUM 24" FOR #4 BARS & 36" FOR #5 BARS.
- ALL REBAR ADJACENT TO SOIL SHALL HAVE 3 INCH MIN. CONCRETE COVER.
- GROUT ALL CELLS CONTAINING REBAR, TYPICAL.
- HORIZONTAL REBAR TO BE SPACED AS SHOWN.

WATERPROOFING SPECIFICATIONS

- WATERPROOF SURFACE WITH 1/4"-THICK ASPHALTIC WATERPROOF COATING OR APPROVED EQUAL AS PER PROPOSED CITY OF BAKERSFIELD STANDARD DRAWING L-9.

STRUCTURAL NOTES

- GENERAL NOTES
- ALL WORK SHALL BE PERFORMED IN ACCORDANCE WITH APPLICABLE SECTIONS OF THE CALIFORNIA BUILDING CODE, LATEST EDITION.

FOUNDAION NOTES

- ALLOWABLE SOIL BEARING VALUES PER CBC 2019, TBL 1806.2
- CONCRETE NOTES:
 - MATERIALS:
 - REINFORCING: ASTM A615, GRADE 60 DEFORMED BARS.
 - CEMENT: PORTLAND CEMENT, TYPE II, ASTM C-150.
 - AGGREGATE: ASTM C-33.
 - WATER: CLEAN AND DRINKABLE.
 - ADMIXTURES: ONLY AS APPROVED BY THE ENGINEER.
 - CONCRETE MIX DESIGN FOR FOOTINGS:
 - CALTRANS MINOR CONCRETE, 2500 PSI AT 28 DAYS.
 - 505 LB OF CEMENT (MIN) PER CUBIC YARD.
 - 3/4" AGGREGATE (MAX).
 - 5" SLUMP - MAXIMUM WATER/CEMENT RATIO: 0.55 (MAX).

MASONRY NOTES

- MATERIALS:
 - CONCRETE BLOCK MASONRY UNITS: ASTM C-90.
 - REINFORCING: ASTM A615, GRADE 60 DEFORMED BARS.
 - ADMIXTURES: ONLY AS APPROVED BY THE ENGINEER.
- MORTAR:
 - STRENGTH: TYPE S, 1900 PSI @ 28 DAYS.
- GROUT:
 - STRENGTH: 2000 PSI @ 28 DAYS.
 - CONCRETE BLOCK MASONRY UNITS SHALL BE DRY AND CLEAN BEFORE GROUTING OPERATION.

MATERIALS LEGEND

BLOCK:
6"x8"x16" PRECISION BLOCK
8"x8"x16" PRECISION BLOCK
CAP:
2" BLOCK
COLOR:
GREY

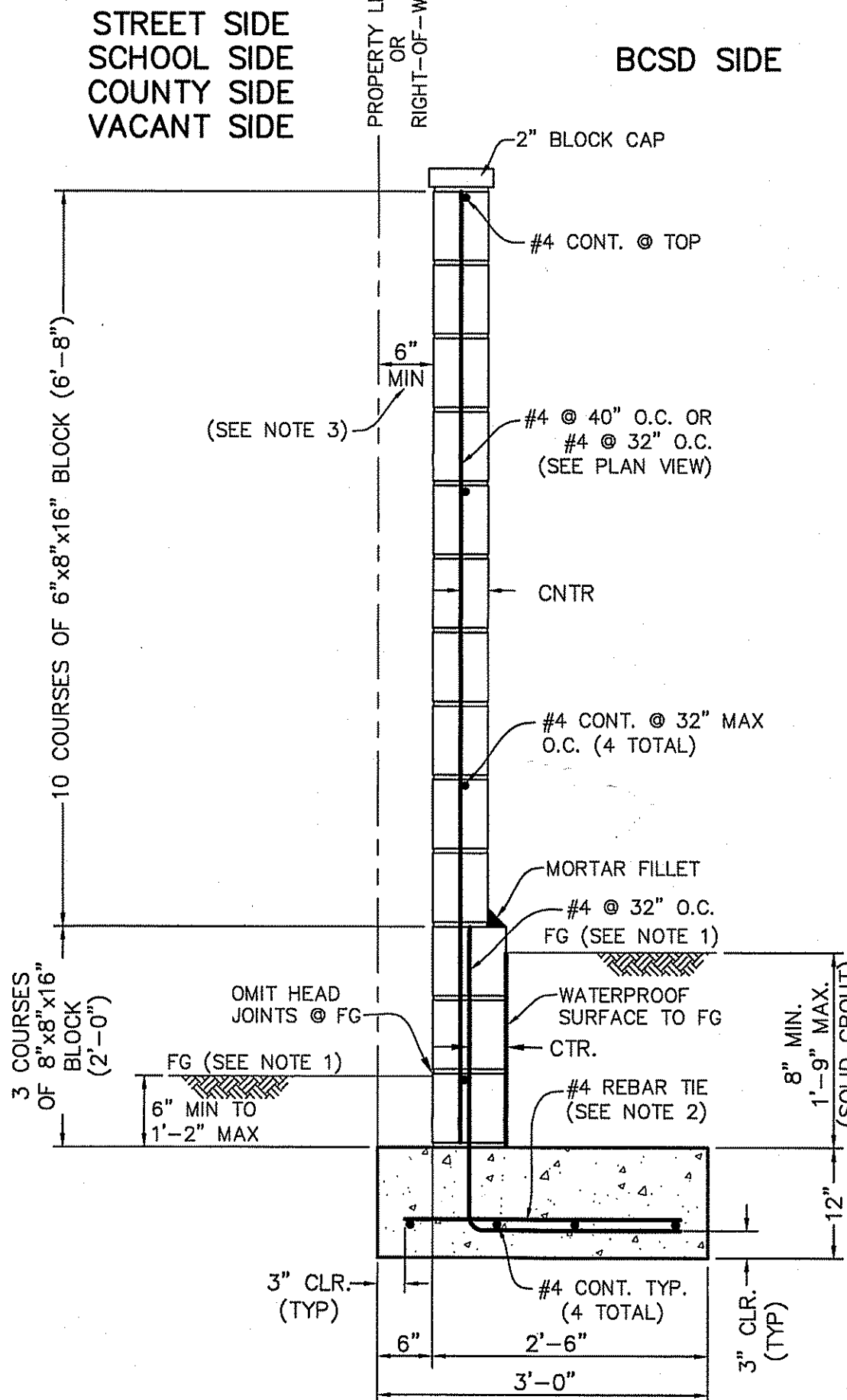

- NOTES:**
- HIGH SIDE FINISH GROUND VARIES.
 - #4 REBAR TIE SPACING SHALL MATCH REBAR SPACING IN WALL.
 - SEE PLAN VIEW AND TYPICAL SECTIONS FOR DISTANCE.

A
2 8'-8" WALL
N.T.S.

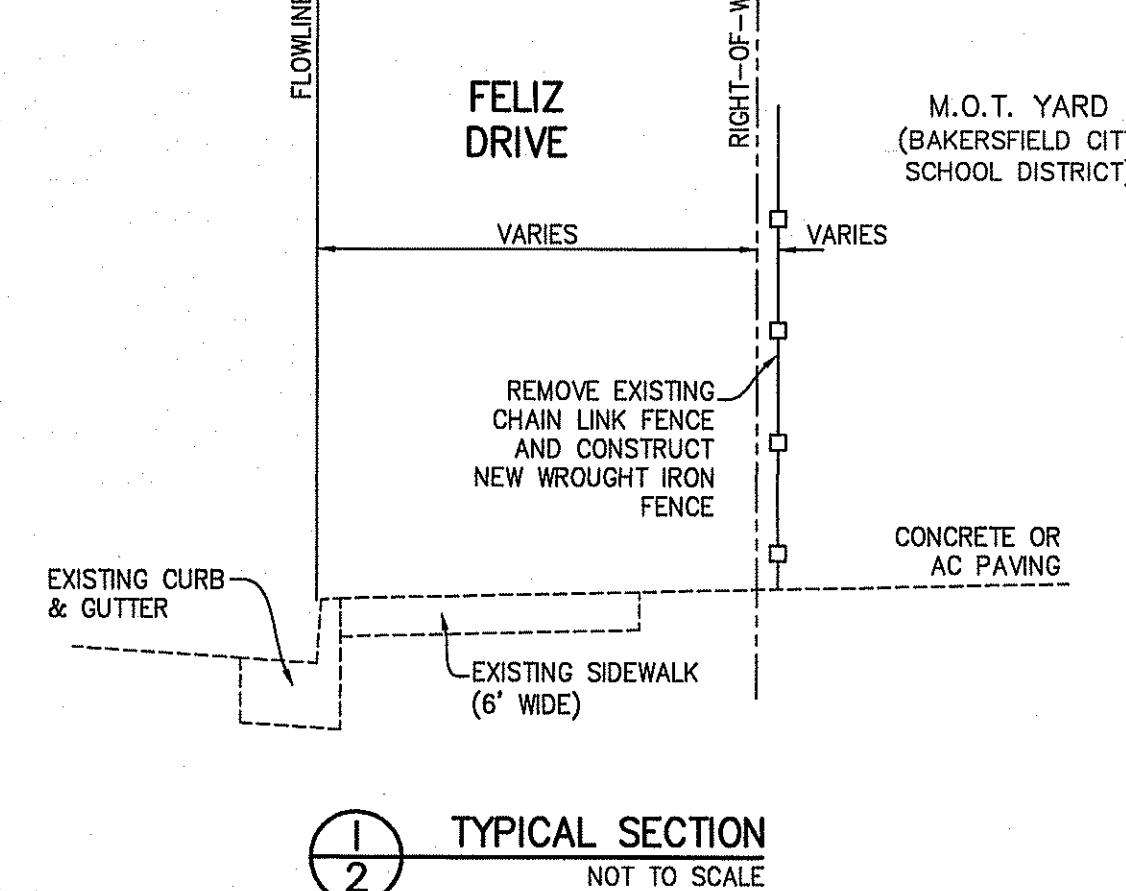
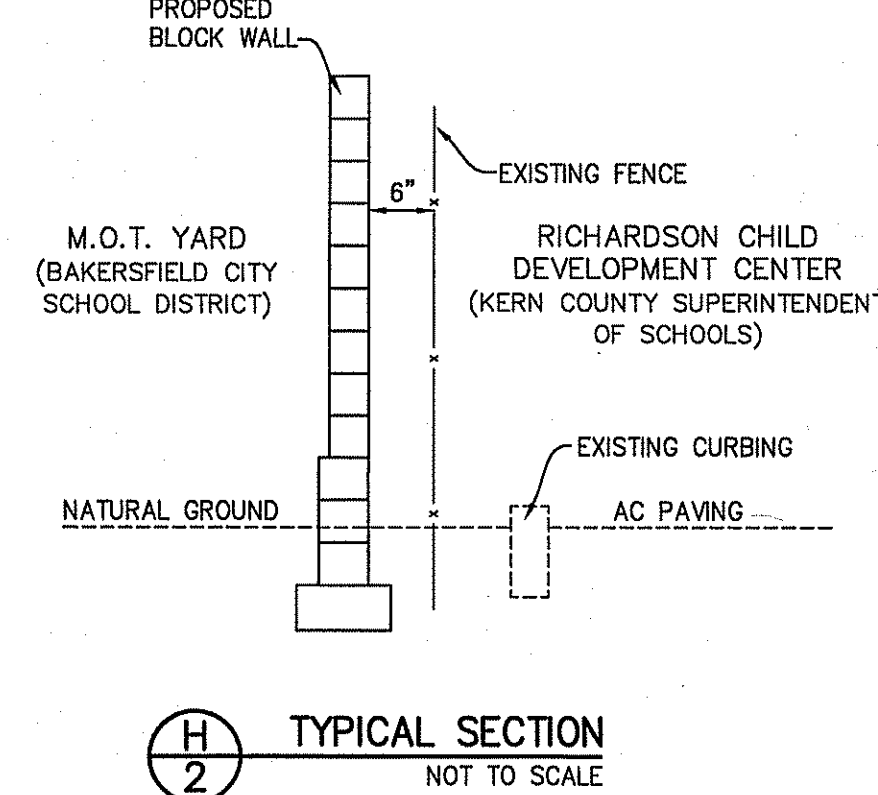
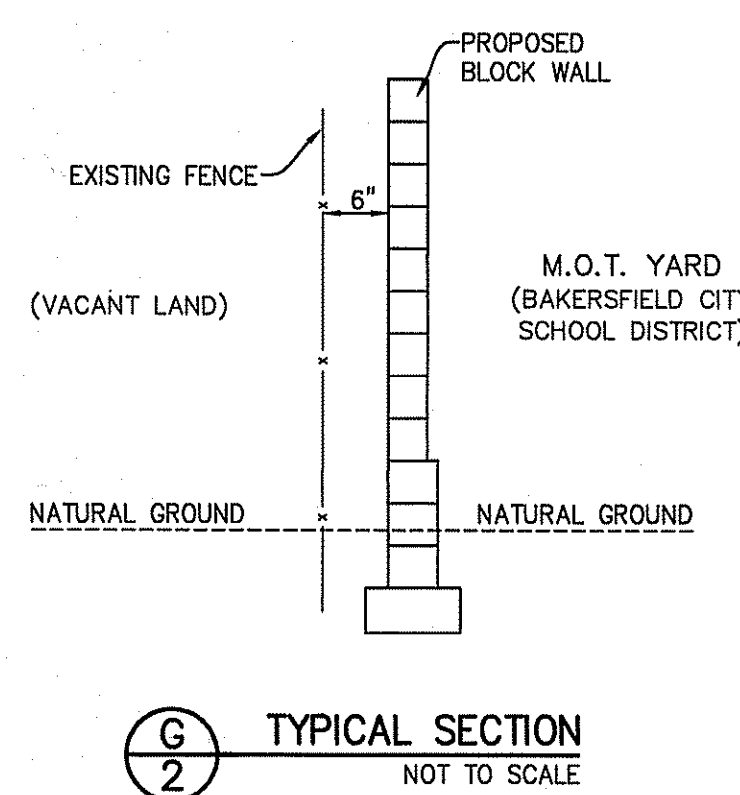
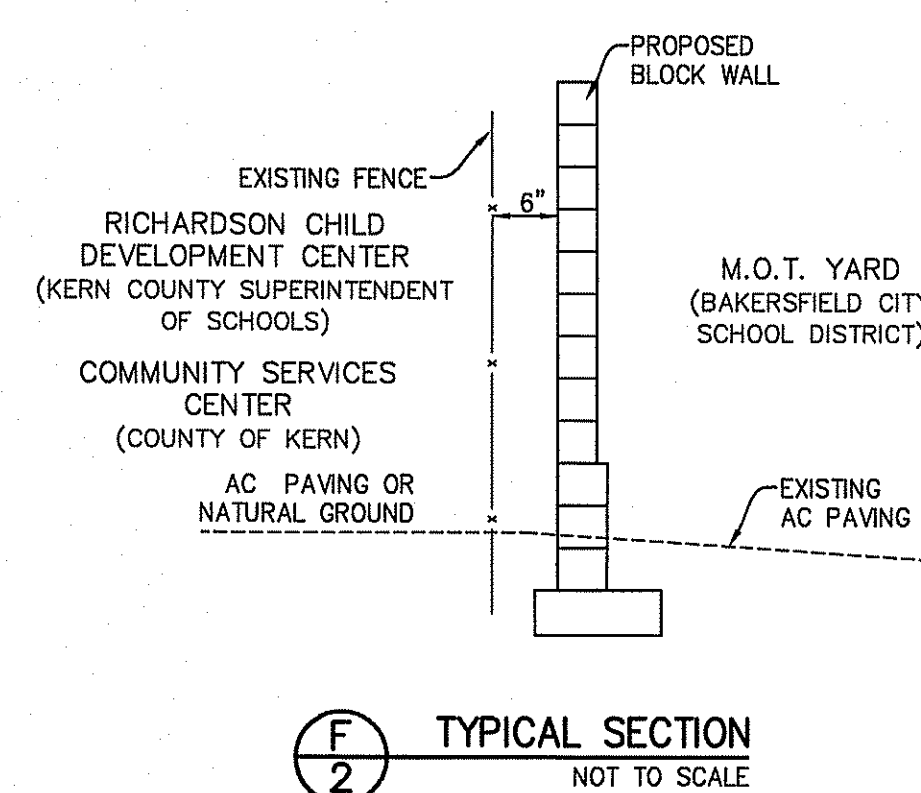
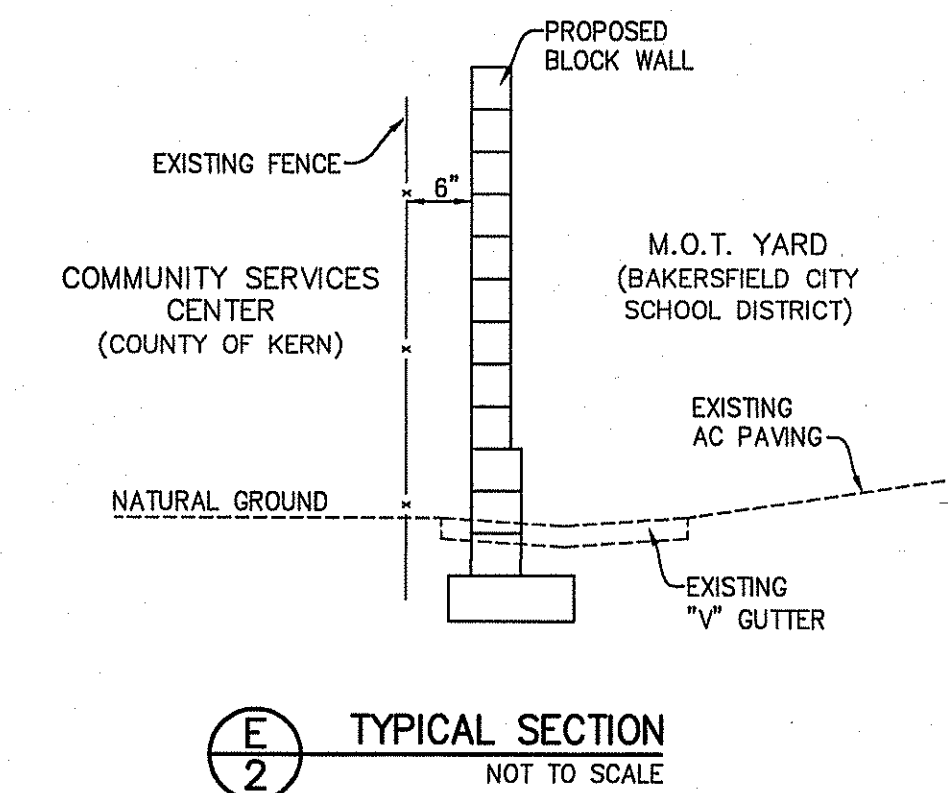
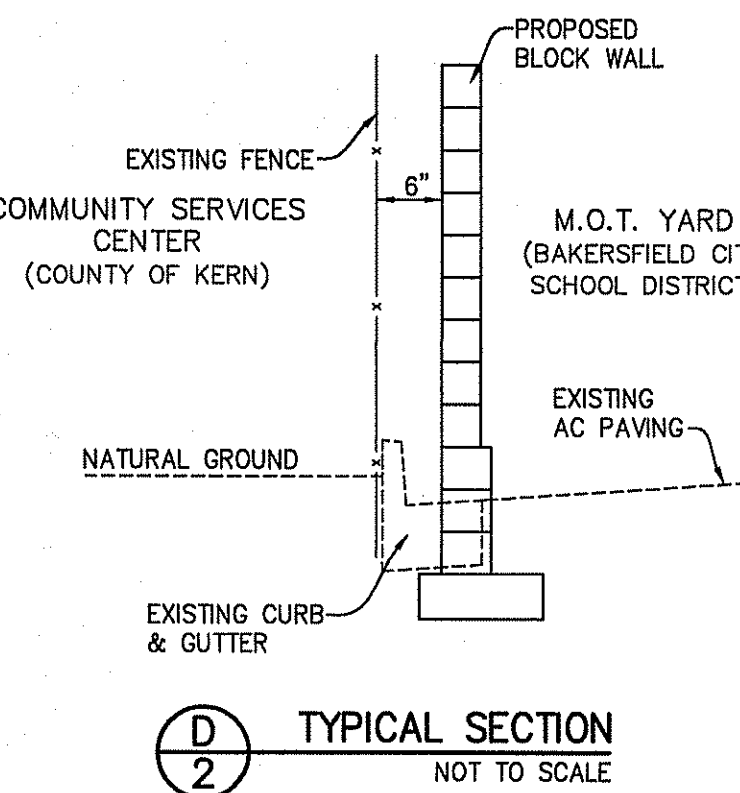
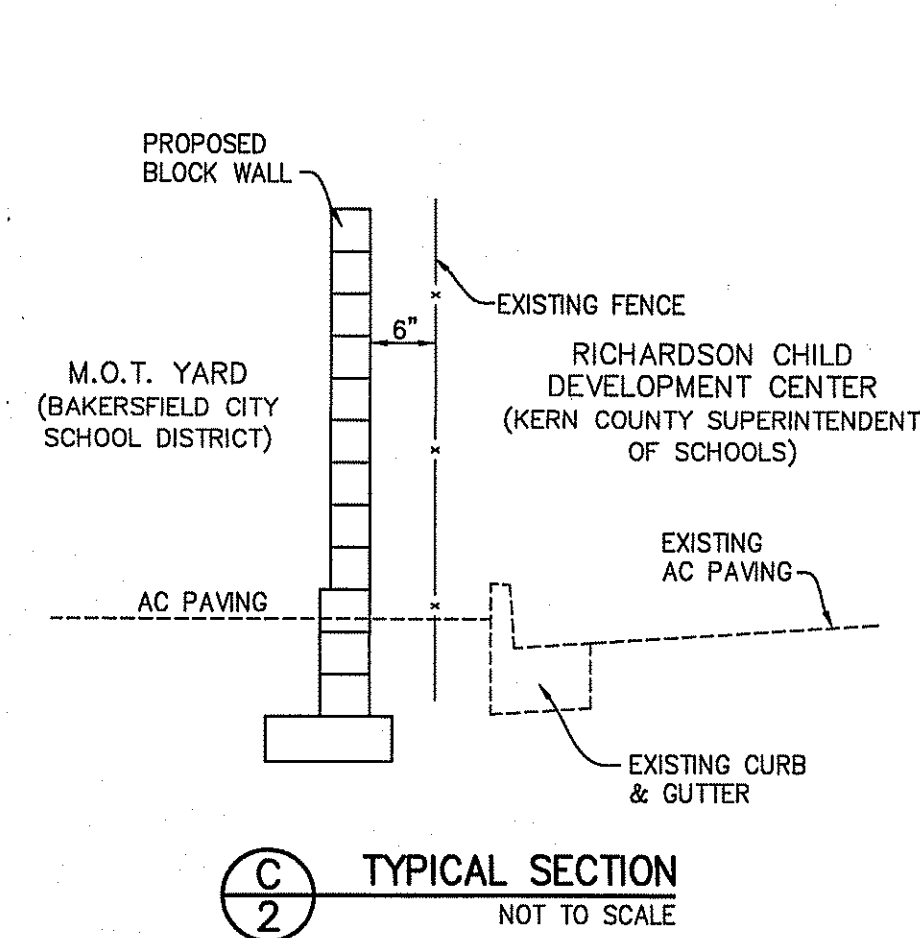
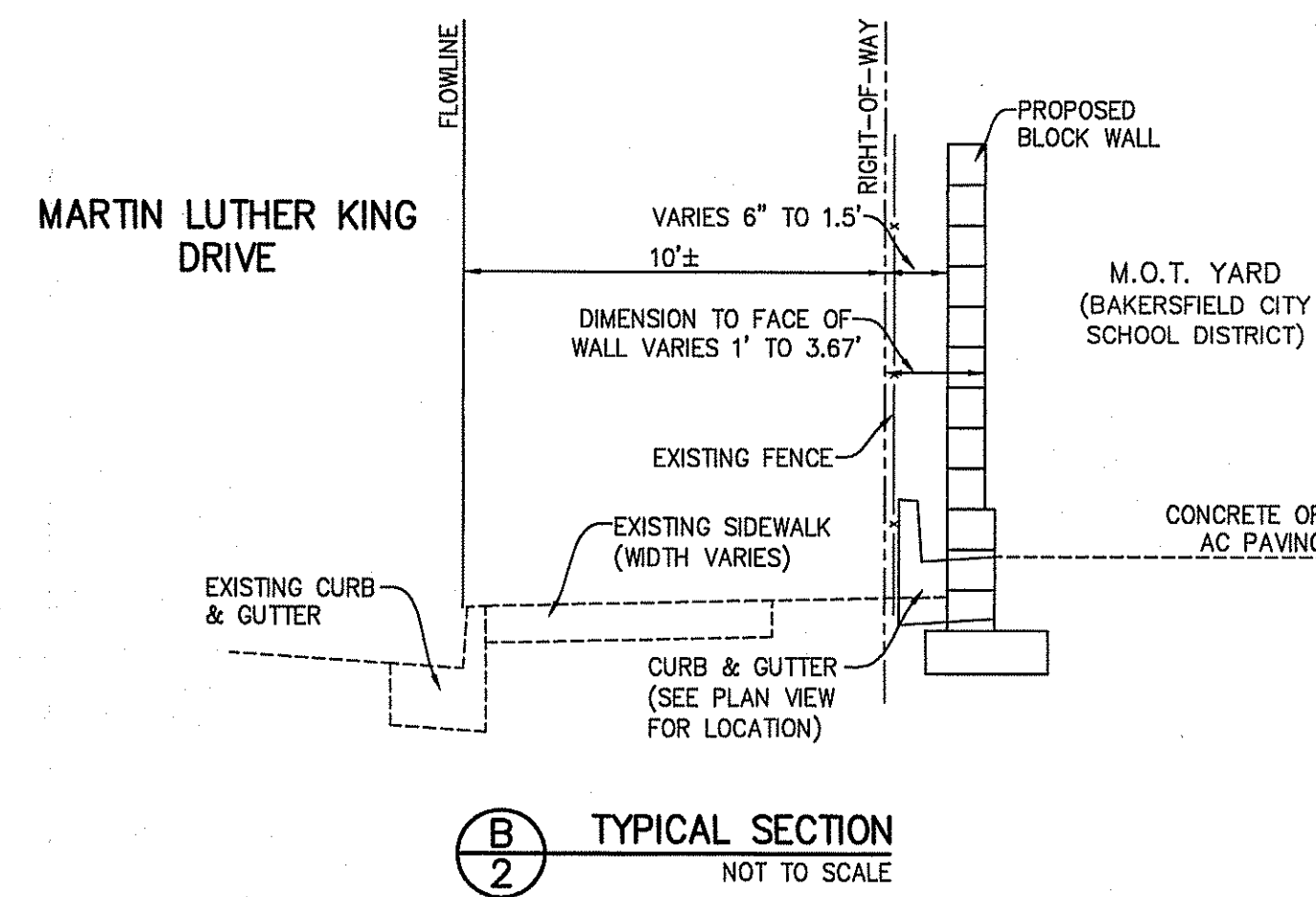

THE ABOVE DRAWINGS AND SPECIFICATIONS AND THEIR ARRANGEMENTS REPRESENTED THEREBY ARE AND SHALL REMAIN THE PROPERTY OF THE ENGINEER. NO PART THEREOF SHALL BE COPIED, REPRODUCED, OR TRANSMITTED IN ANY FORM OR BY ANY MEANS, ELECTRONIC OR MECHANICAL, INCLUDING PHOTOCOPYING, RECORDING, OR BY ANY INFORMATION STORAGE AND RETRIEVAL SYSTEM, WITHOUT THE WRITTEN PERMISSION OF THE ENGINEER. VISUAL CONTACT WITH THESE DRAWINGS OR SPECIFICATIONS SHALL CONSTITUTE CONCLUSIVE EVIDENCE OF ACCEPTANCE OF THESE RESTRICTIONS. WRITTEN DIMENSIONS ON THESE DRAWINGS SHALL TAKE PRECEDENCE OVER SCALED DIMENSIONS. THE CONTRACTOR SHALL BE RESPONSIBLE FOR VERIFYING ALL DIMENSIONS AND CONDITIONS SHOWN BY THESE DRAWINGS. SHOP DETAILS MUST BE SUBMITTED TO THIS OFFICE FOR APPROVAL BEFORE PROCEEDING WITH FABRICATION.

PORTER & ASSOCIATES, INC.
ENGINEERING & SURVEYING
1200 21st Street, Bakersfield, California 93301
661.327.0362 FAX 661.327.1065

FRED W. PORTER II
REGISTERED PROFESSIONAL ENGINEER
RCE 74059
STATE OF CALIFORNIA
PROJECT ENGINEER: 080.000
DRAWN BY: LHM
PA REVIEW BY: [Signature]

WALL PLANS
BAKERSFIELD CITY SCHOOL DISTRICT
M.O.T. YARD - 1501 FELIZ DRIVE
GENERAL NOTES - TYPICAL SECTIONS



DATE: 08/23/2022
PA JOB No.: 3239
SHEET: **2**
OF 7 SHEETS

COB RECORDS No.

CONSTRUCTION NOTES

ALL STATIONS AND OFFSETS ARE TO BACK OF WALL (BCSD SIDE)
 ALL PROFILE STATIONING IS BASED ON CENTERLINE DATA (UNLESS OTHERWISE NOTED).
 ——— PROPOSED BLOCK WALL
 ——— CENTERLINE
 - - - RIGHT-OF-WAY
 NOTE "A": INSTALL #4 @ 32" O.C. INSTEAD OF #4 @ 40" O.C. AS PER DETAIL (A/2)

LEGEND

PC = PROPERTY CORNER
 AP = ANGLE POINT
 BC = BEGIN CURVE
 CL = CENTERLINE
 CONC = CONCRETE
 CONST = CONSTRUCTION
 EC = END CURVE
 FTG = FOOTING
 GB = GRADE BREAK
 L/S = LANDSCAPE
 R/W = RIGHT OF WAY
 TOF = TOP OF FOOTING
 FG = FINISHED GROUND (LOT SIDE)
 FG** = FINISHED GROUND (STREET SIDE)
 CTR = CENTER
 TOW = TOP OF WALL
 RETG = RETAINING
 MAX = MAXIMUM
 MIN = MINIMUM
 CLR = CLEAR
 WL = WALL/FENCE STATION
 W.F.E. = WALL FOOTING EASEMENT
 T.O.B. = TOP OF BERM
 PL INT = PROPERTY LINE INTERSECTION

BACK OF WALL BEARING TABLE	
BACK OF WALL NO.	BEARING
W1	N01°13'56"E
W2	N00°16'58"E
W3	N04°52'13"W

THE ABOVE DRAWINGS AND SPECIFICATIONS, AND IDEAS, DESIGNS, AND ARRANGEMENTS REPRESENTED THEREIN, ARE THE SOLE PROPERTY OF PORTER & ASSOCIATES, INC. AND ARE NOT TO BE REPRODUCED, COPIED, OR USED IN CONNECTION WITH ANY WORK OR PROJECT OTHER THAN THE SPECIFIC PROJECT FOR WHICH THEY HAVE BEEN PREPARED AND DEVELOPED. WITHOUT THE WRITTEN CONSENT OF PORTER & ASSOCIATES, INC., NO PART OF THESE DRAWINGS OR SPECIFICATIONS SHALL BE REPRODUCED, COPIED, OR USED IN CONNECTION WITH ANY OTHER PROJECT. CONTRACTORS SHALL VERIFY AND BE RESPONSIBLE FOR ALL DIMENSIONS AND CONDITIONS ON THE JOB AND THIS OFFICE MUST BE NOTIFIED OF ANY DISCREPANCIES IMMEDIATELY. THESE DRAWINGS AND SPECIFICATIONS SHALL BE VOID IF NOT APPROVED BY THE CITY OF BAKERSFIELD. THESE DRAWINGS AND SPECIFICATIONS MUST BE SUBMITTED TO THIS OFFICE FOR APPROVAL BEFORE PROCEEDING WITH FABRICATION.

PORTER & ASSOCIATES, INC.
 ENGINEERING & SURVEYING
 1200 21st Street, Bakersfield, California 93301
 661.327.0362 FAX 661.327.1065

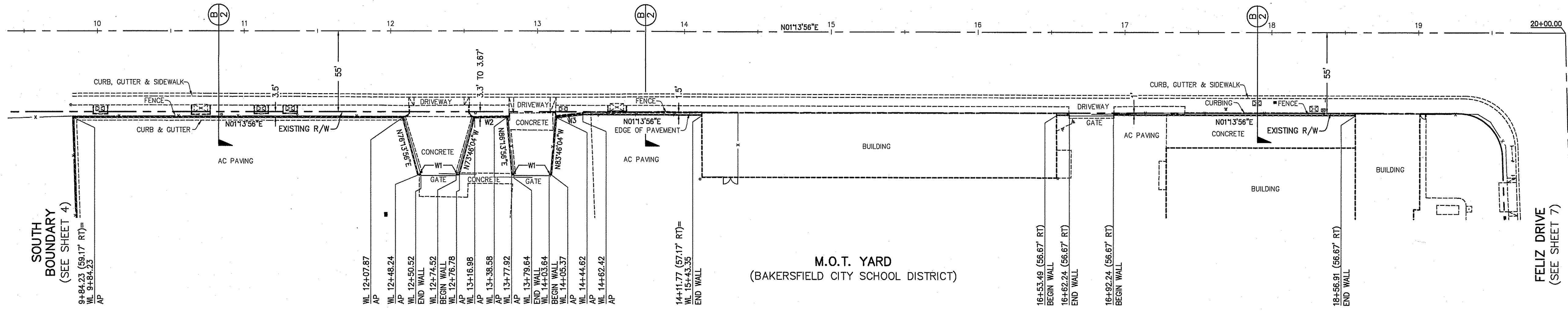

MARTIN LUTHER KING DRIVE

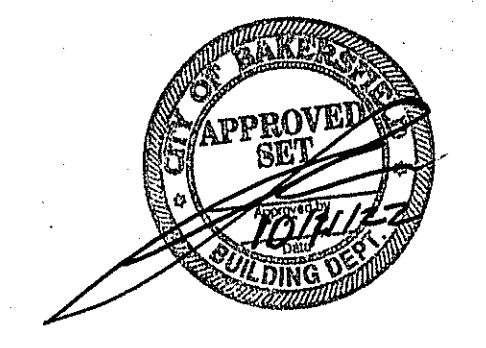
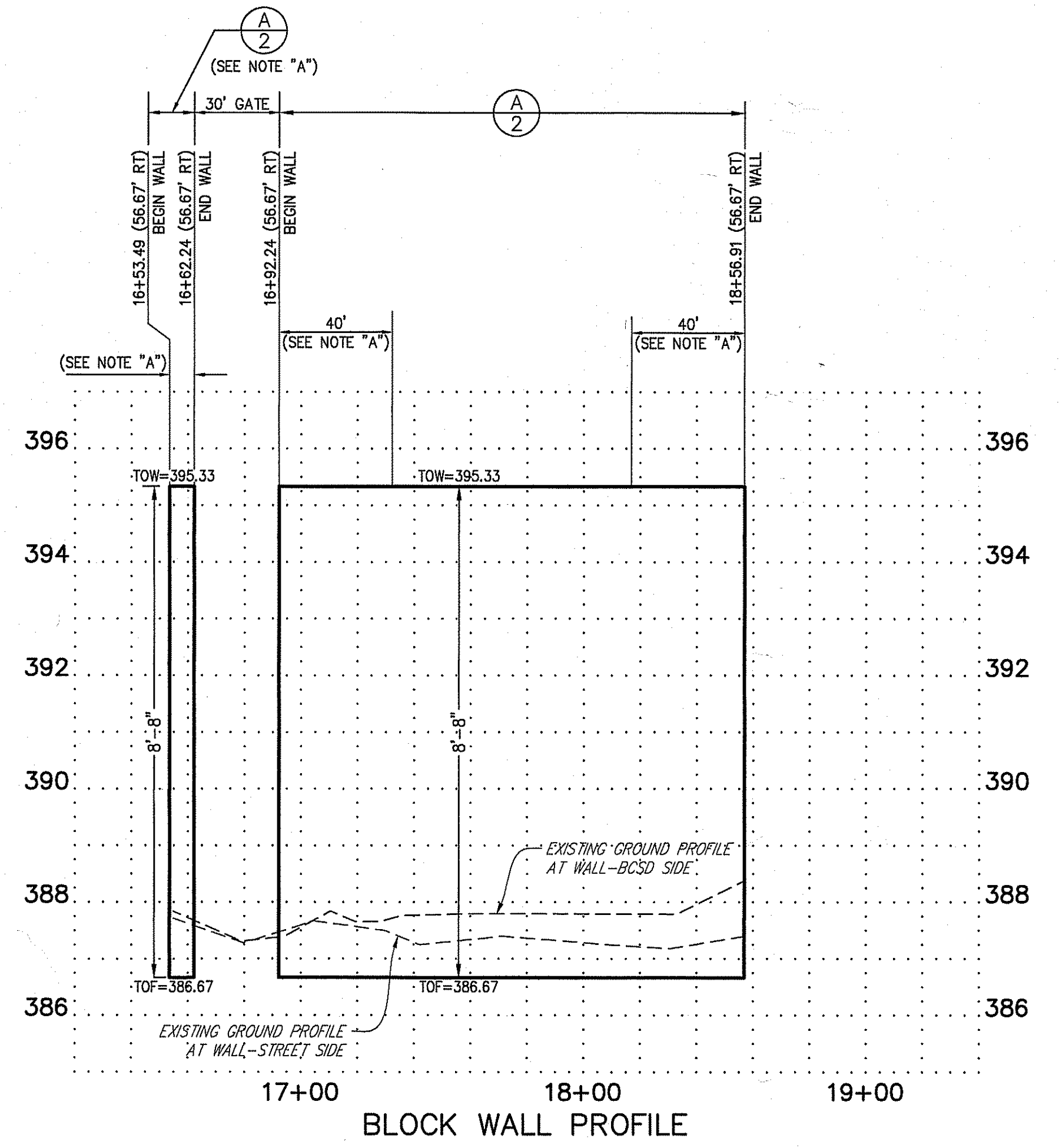
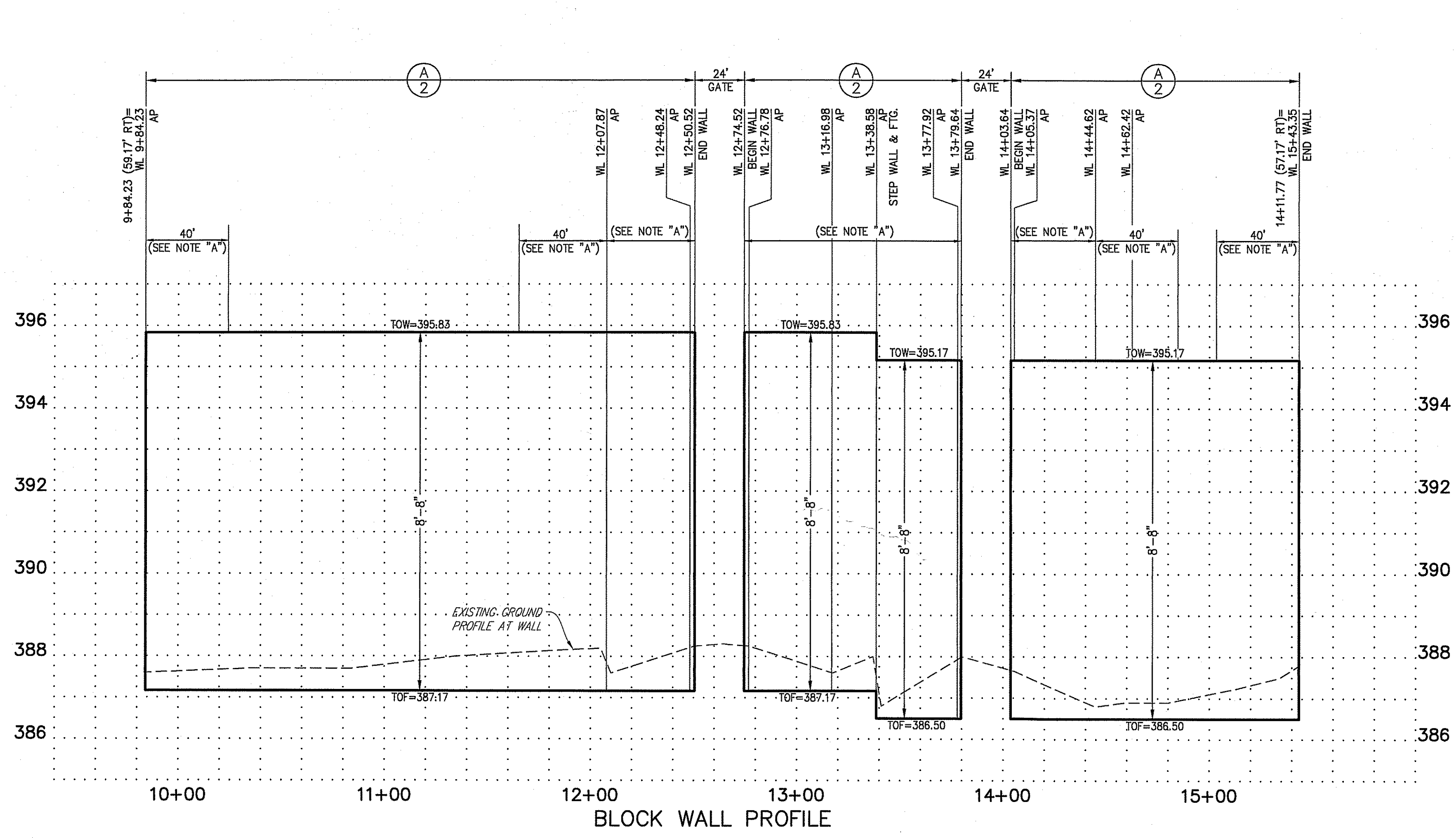
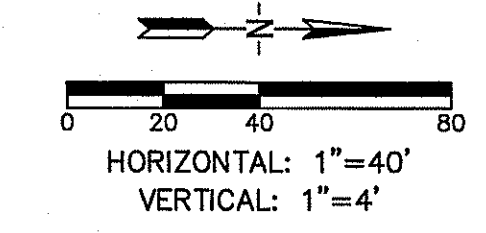

WALL PLANS
 BAKERSFIELD CITY SCHOOL DISTRICT
 M.O.T. YARD - 1501 FELIZ DRIVE
 MARTIN LUTHER KING DRIVE

DATE: 08/23/2022
 PA JOB No.: 3239
 SHEET: **3**
 OF 7 SHEETS

COB RECORDS No. _____

CONSTRUCTION NOTES

ALL STATIONS AND OFFSETS ARE TO BACK OF WALL (BCSD SIDE)

ALL PROFILE STATIONING IS BASED ON CENTERLINE DATA (UNLESS OTHERWISE NOTED).

- PROPOSED BLOCK WALL
- - - CENTERLINE
- - - RIGHT-OF-WAY

NOTE "A": INSTALL #4 @ 32" O.C. INSTEAD OF #4 @ 40" O.C. AS PER DETAIL (A)

LEGEND

- PC = PROPERTY CORNER
- AP = ANGLE POINT
- BC = BEGIN CURVE
- CL = CENTERLINE
- CONC = CONCRETE
- EC = END CURVE
- FTG = FOOTING
- GB = GRADE BREAK
- L/S = LANDSCAPE
- R/W = RIGHT OF WAY
- TOF = TOP OF FOOTING
- FG = FINISHED GROUND (LOT SIDE)
- FG** = FINISHED GROUND (STREET SIDE)
- CTR = CENTER
- TOW = TOP OF WALL
- RETG = RETAINING
- MAX = MAXIMUM
- MIN = MINIMUM
- CLR = CLEAR
- WL = WALL/FENCE STATION
- W.F.E. = WALL FOOTING EASEMENT
- T.O.B. = TOP OF BERM
- PL INT = PROPERTY LINE INTERSECTION

MARTIN LUTHER KING DRIVE
(SEE SHEET 3)

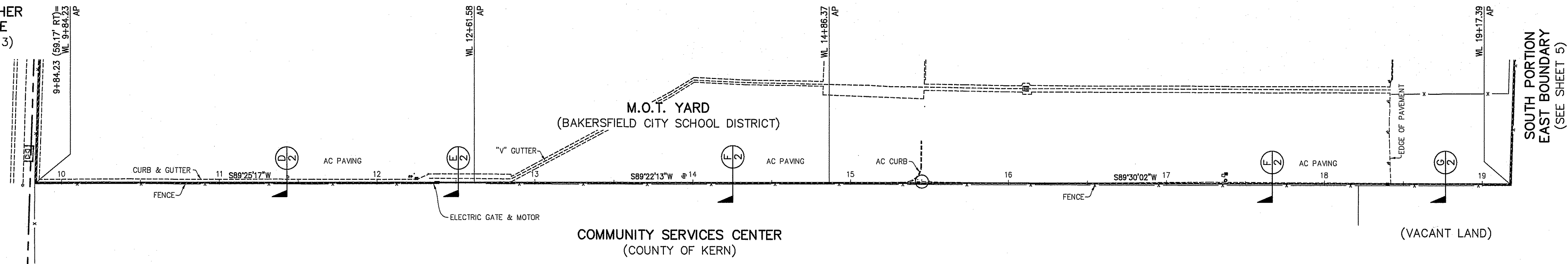

SOUTH BOUNDARY

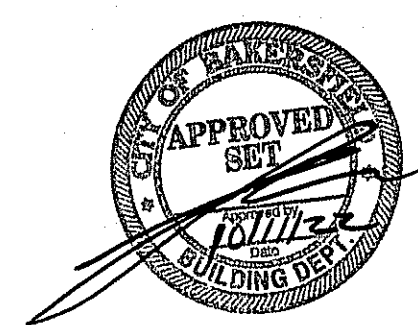
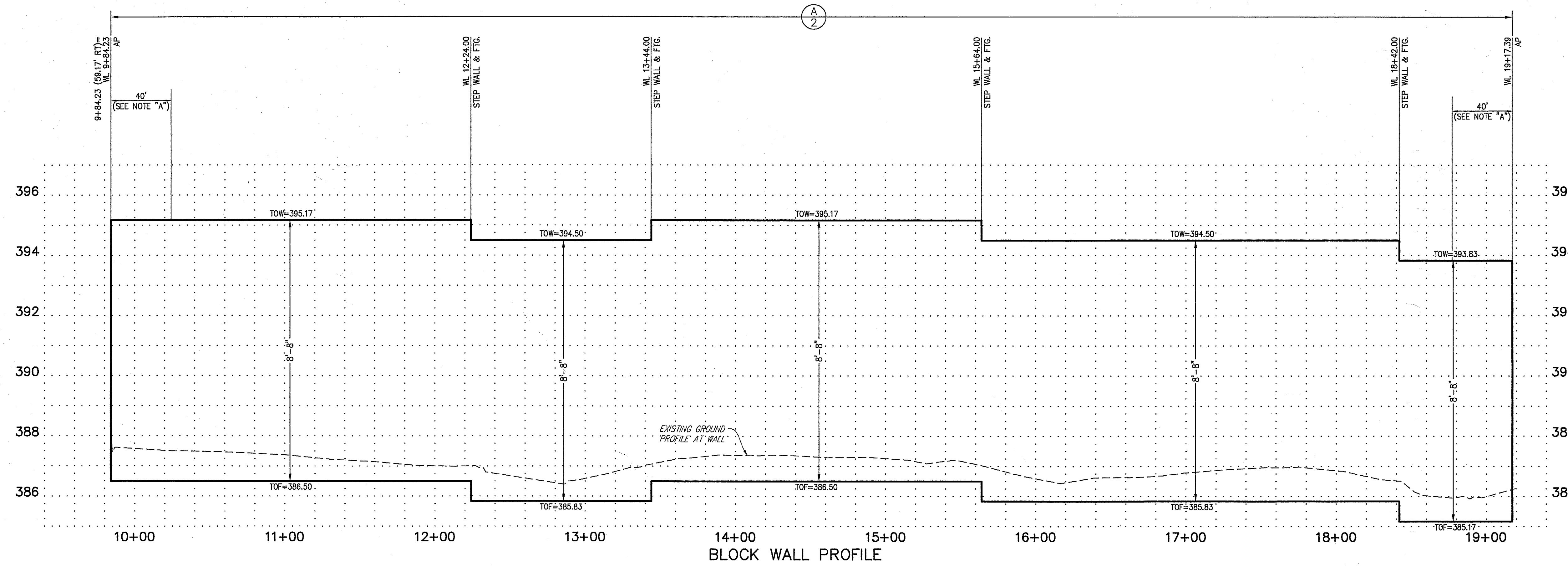
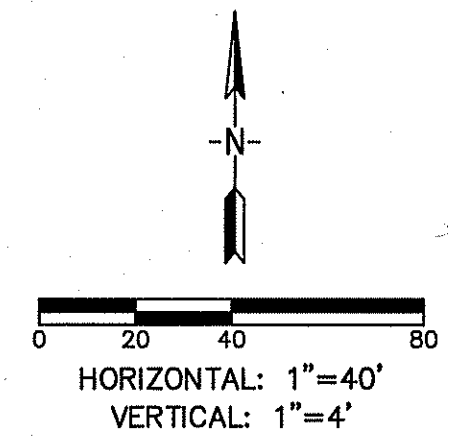

COB RECORDS No.

PORTER & ASSOCIATES, INC.
ENGINEERING & SURVEYING
1200 21st Street, Bakersfield, California 93301
661.327.0362 FAX 661.327.1065

FRED W. PORTER II
PROJECT ENGINEER: 000.000
DRAFTSMAN: LGH
PA REVIEW BY: _____
DATE: _____

REGISTERED PROFESSIONAL ENGINEER
FRED W. PORTER II
RCE 74059
CIVIL
STATE OF CALIFORNIA

WALL PLANS
BAKERSFIELD CITY SCHOOL DISTRICT
M.O.T. YARD - 1501 FELIZ DRIVE
SOUTH BOUNDARY

REVISIONS
DATE 08/23/2022
PA JOB No. 3239
SHEET
4
OF 7 SHEETS

CONSTRUCTION NOTES

ALL STATIONS AND OFFSETS ARE TO BACK OF WALL (BCSD SIDE)

ALL PROFILE STATIONING IS BASED ON CENTERLINE DATA (UNLESS OTHERWISE NOTED).

- PROPOSED BLOCK WALL
- CENTERLINE
- - - RIGHT-OF-WAY

NOTE "A": INSTALL #4 @ 32" O.C. INSTEAD OF #4 @ 40" O.C. AS PER DETAIL (A)

LEGEND

- PC = PROPERTY CORNER
- AP = ANGLE POINT
- BC = BEGIN CURVE
- CL = CENTERLINE
- CONC = CONCRETE
- CONST = CONSTRUCTION
- EC = END CURVE
- FTG = FOOTING
- GB = GRADE BREAK
- L/S = LANDSCAPE
- R/W = RIGHT OF WAY
- TOF = TOP OF FOOTING
- FG = FINISHED GROUND (LOT SIDE)
- FG** = FINISHED GROUND (STREET SIDE)
- CTR = CENTER
- TOW = TOP OF WALL
- RETG = RETAINING
- MAX = MAXIMUM
- MIN = MINIMUM
- CLR = CLEAR
- WL = WALL/FENCE STATION
- W.F.E. = WALL FOOTING EASEMENT
- T.O.B. = TOP OF BERM
- PL INT = PROPERTY LINE INTERSECTION

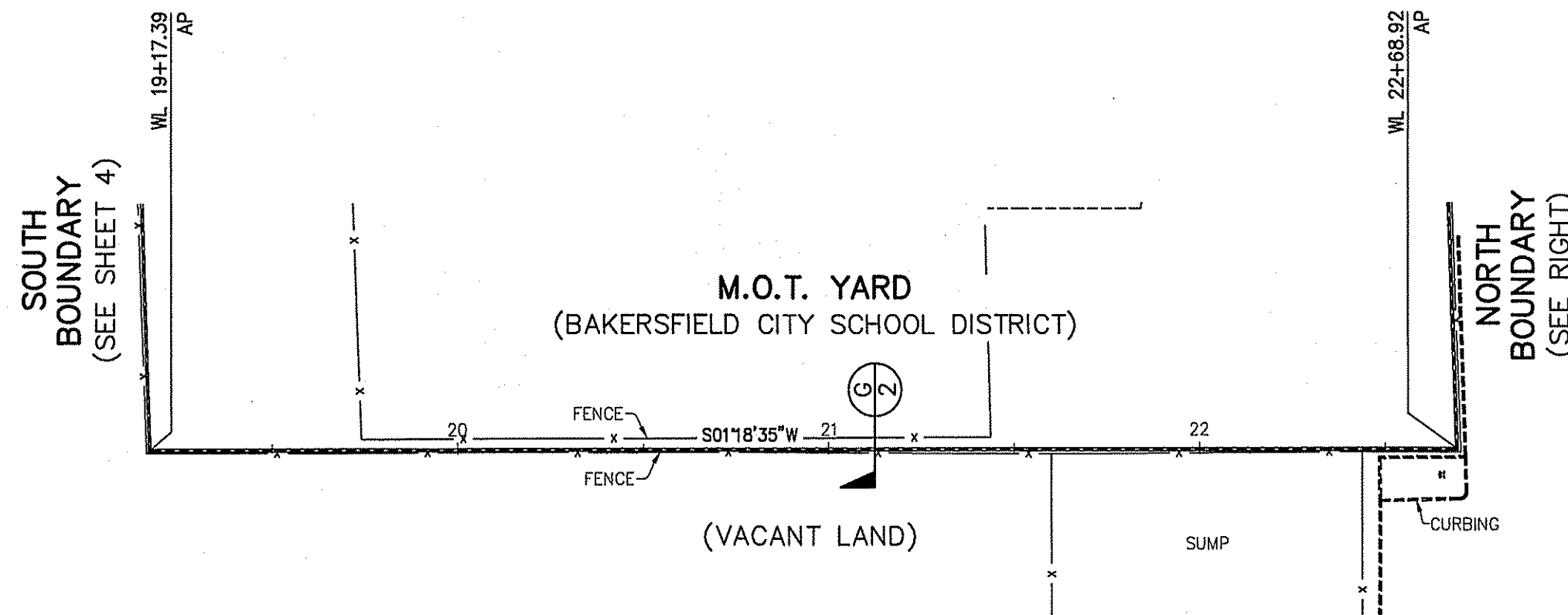

SOUTH PORTION EAST BOUNDARY

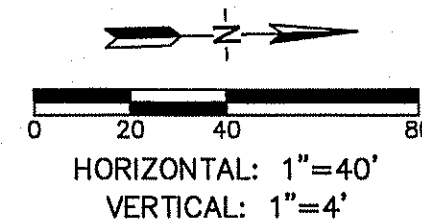

NORTH PORTION EAST BOUNDARY (SEE SHEET 6)

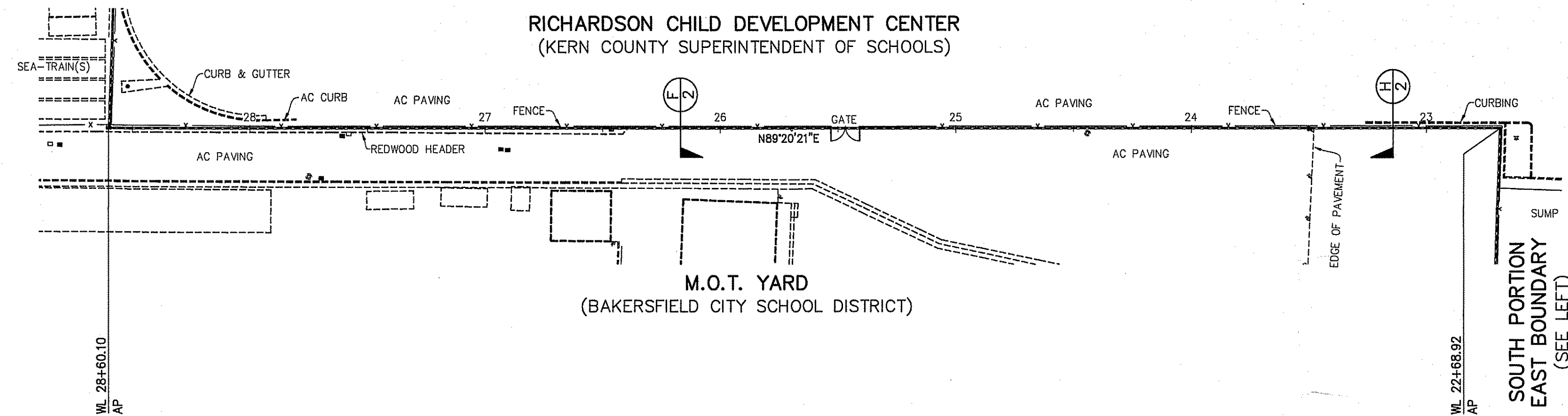

NORTH BOUNDARY

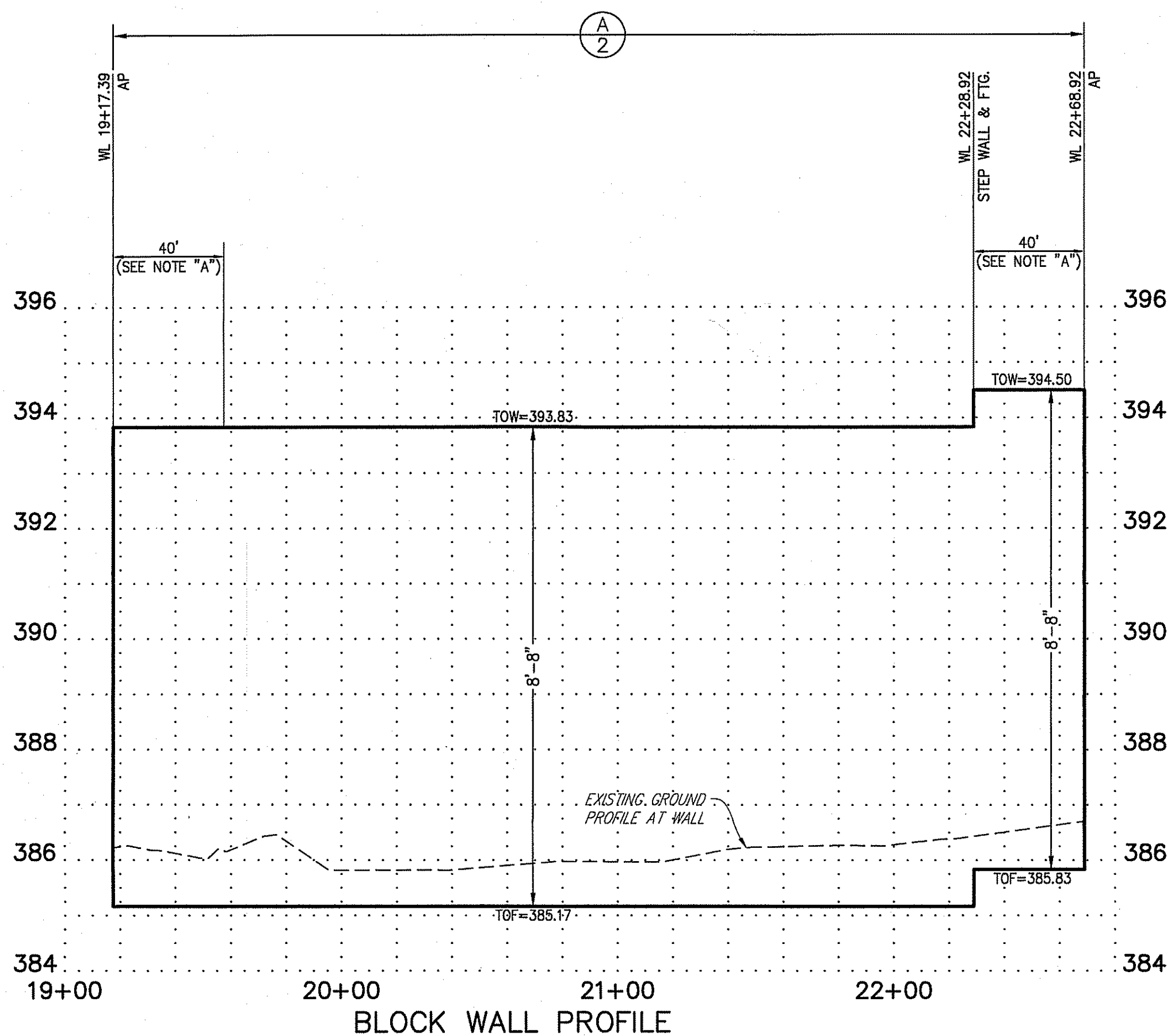
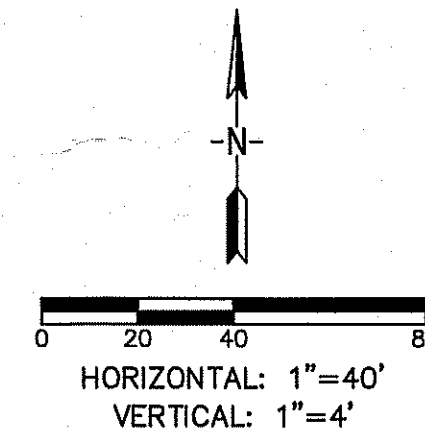

BLOCK WALL PROFILE

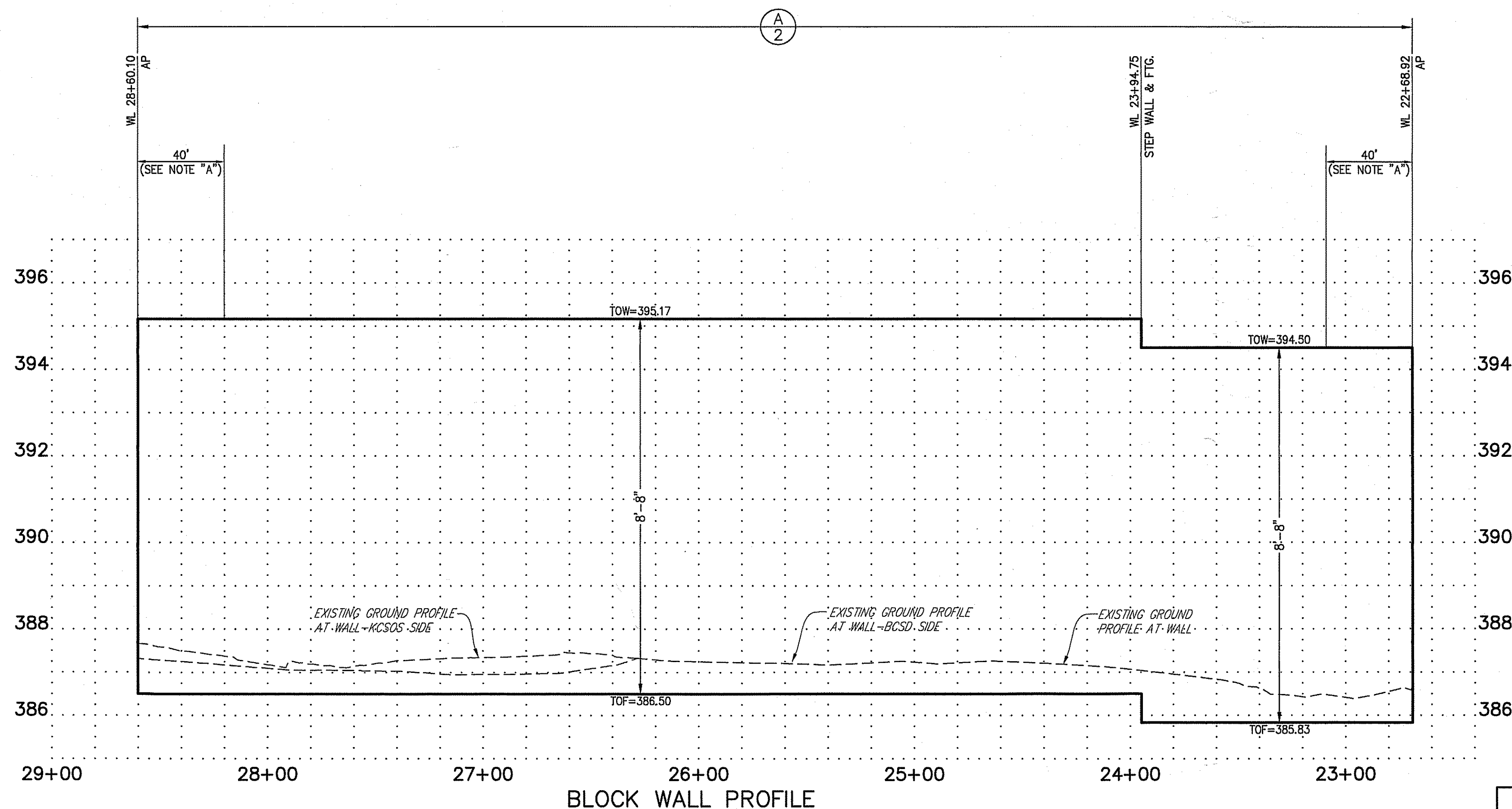

BLOCK WALL PROFILE

THESE DRAWINGS AND SPECIFICATIONS AND THEIR DESIGN AND ARRANGEMENTS REPRESENTED THEREBY ARE AND SHALL REMAIN THE PROPERTY OF THE ENGINEER. NO PART THEREOF SHALL BE COPIED, REPRODUCED, OR USED IN CONNECTION WITH ANY WORK OR PROJECT OTHER THAN THAT SPECIFICALLY AUTHORIZED BY THE ENGINEER. THE ENGINEER'S LIABILITY IS LIMITED TO THE DESIGN AND SPECIFICATIONS SHOWN ON THESE DRAWINGS. VISUAL CHECK WITH THESE DRAWINGS AND SPECIFICATIONS SHALL CONSTITUTE CONCLUSIVE EVIDENCE OF ACCEPTANCE OF THESE RESTRICTIONS. WRITTEN DIMENSIONS ON THESE DRAWINGS SHALL TAKE PRECEDENCE OVER SCALED DIMENSIONS. CONTRACTORS SHALL VERIFY AND BE RESPONSIBLE FOR THE ACCURACY OF ALL DIMENSIONS AND CONDITIONS SHOWN BY THESE DRAWINGS. SHOP DETAILS MUST BE SUBMITTED TO THIS OFFICE FOR APPROVAL BEFORE PROCEEDING WITH FABRICATION.

PORTER & ASSOCIATES, INC.
ENGINEERING & SURVEYING
1200 21st Street, Bakersfield, California 93301
661.327.0362 FAX 661.327.1065

FRED W. PORTER II
PROJECT ENGINEER: 000,000
DATE: _____
DRAFTSMAN: LGH
PA REVIEW BY: _____

REGISTERED PROFESSIONAL ENGINEER
FRED W. PORTER II
RCE 74089
STATE OF CALIFORNIA
CIVIL ENGINEER

WALL PLANS
BAKERSFIELD CITY SCHOOL DISTRICT
M.O.T. YARD - 1501 FELIZ DRIVE
SOUTH PORTION - EAST BOUNDARY
NORTH BOUNDARY

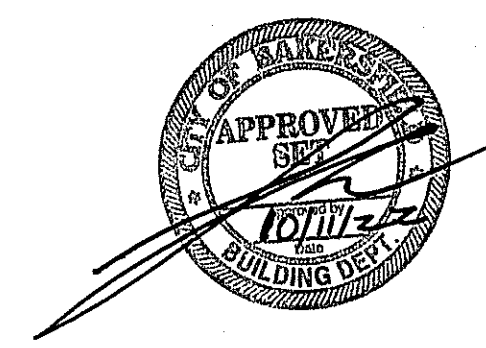

REVISIONS

DATE: 08/23/2022
PA JOB No. 3239

SHEET

5
OF 7 SHEETS

COB RECORDS No. _____

J:\3239\Wall Plans\3239Wall_Plan and Profile.dwg 08/26/22 matthewcarson

CONSTRUCTION NOTES

ALL STATIONS AND OFFSETS ARE TO BACK OF WALL (BCSD SIDE)

ALL PROFILE STATIONING IS BASED ON CENTERLINE DATA (UNLESS OTHERWISE NOTED).

- PROPOSED BLOCK WALL
- - - CENTERLINE
- - - RIGHT-OF-WAY

NOTE "A": INSTALL #4 @ 32" O.C. INSTEAD OF #4 @ 40" O.C. AS PER DETAIL (A)

LEGEND

- PC = PROPERTY CORNER
- AP = ANGLE POINT
- BC = BEGIN CURVE
- CL = CENTERLINE
- CONC = CONCRETE
- CONST = CONSTRUCTION
- EC = END CURVE
- FTG = FOOTING
- GB = GRADE BREAK
- L/S = LANDSCAPE
- R/W = RIGHT OF WAY
- TOF = TOP OF FOOTING
- FG = FINISHED GROUND (LOT SIDE)
- FG** = FINISHED GROUND (STREET SIDE)
- CTR = CENTER
- TOW = TOP OF WALL
- RETG = RETAINING
- MAX = MAXIMUM
- MIN = MINIMUM
- CLR = CLEAR
- WL = WALL/FENCE STATION
- W.F.E. = WALL FOOTING EASEMENT
- T.O.B. = TOP OF BERM
- PL INT = PROPERTY LINE INTERSECTION

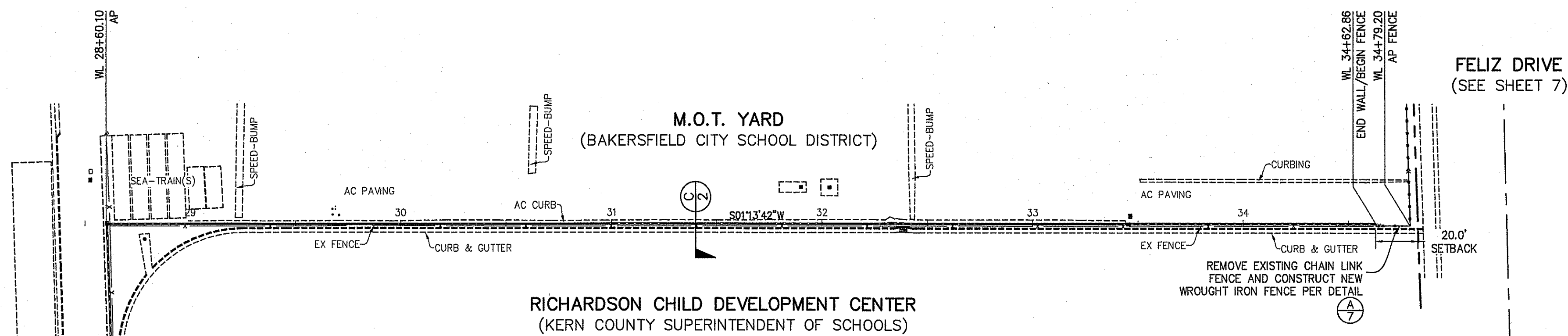

**NORTH PORTION
EAST BOUNDARY**

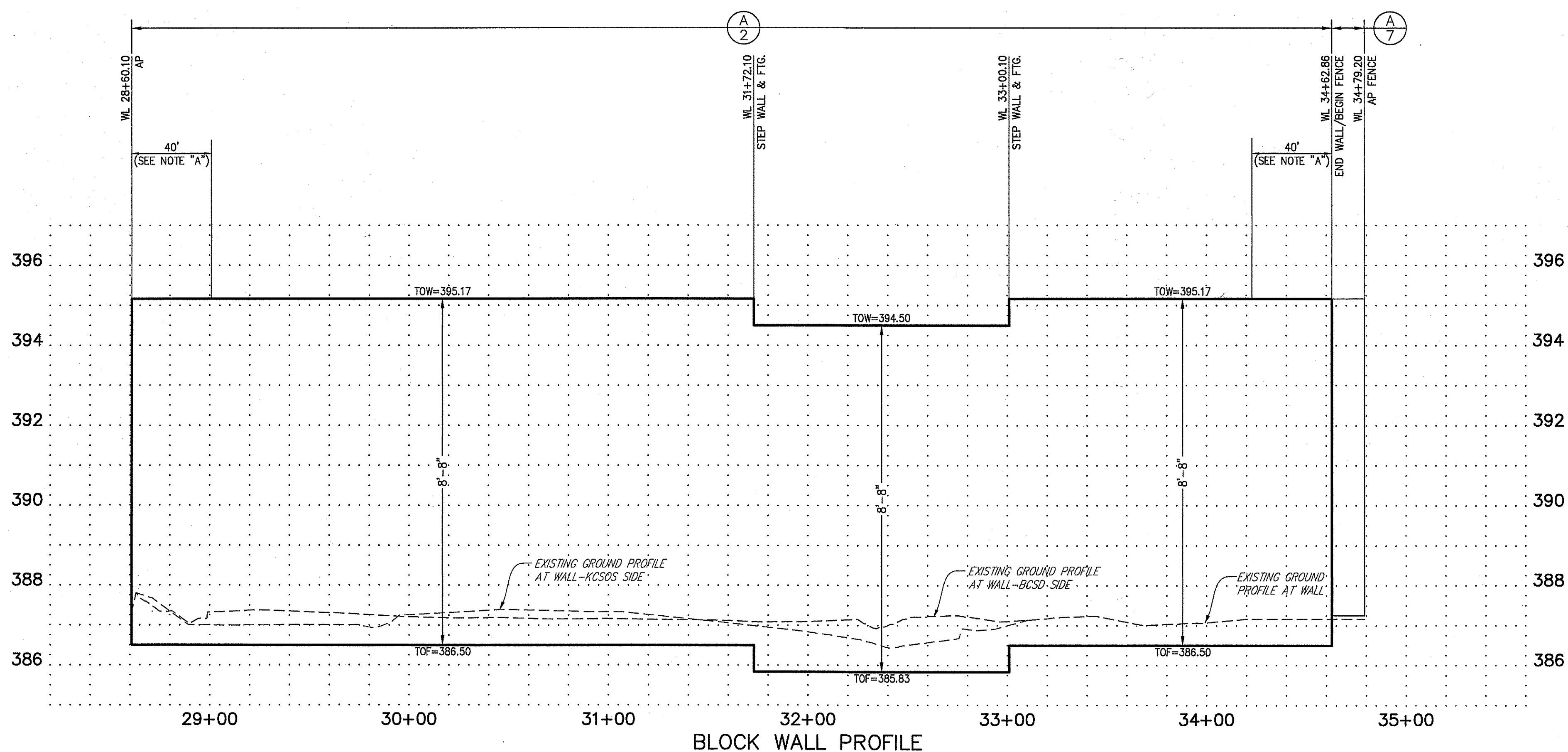
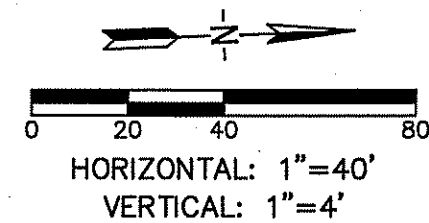

BLOCK WALL PROFILE

THESE DRAWINGS AND SPECIFICATIONS AND THEIR REVISIONS AND AMENDMENTS REPRESENTED THEREBY, ARE AND SHALL REMAIN THE PROPERTY OF THE ENGINEER. NO PART THEREOF SHALL BE COPIED, REPRODUCED, OR USED IN CONNECTION WITH ANY WORK OR PROJECT OTHER THAN THAT SPECIFICALLY IDENTIFIED HEREON. ANY REVISIONS TO THESE DRAWINGS SHALL BE MADE BY THE ENGINEER AND SHALL BE INDICATED BY A REVISION CIRCLE AND NUMBER. THE CONTRACTOR SHALL BE RESPONSIBLE FOR VERIFYING ALL DIMENSIONS AND CONDITIONS SHOWN ON THESE DRAWINGS. ANY VARIATIONS FROM THE DIMENSIONS AND CONDITIONS SHOWN BY THESE DRAWINGS, SHOP DETAILS OR FIELD CONDITIONS SHALL BE APPROVED BY THE ENGINEER BEFORE PROCEEDING WITH FABRICATION.

PORTER & ASSOCIATES, INC.
ENGINEERING & SURVEYING
1200 Z 1st Street, Bakersfield, California 93301
661.327.0362 FAX 661.327.1065

FRED W. PORTER II
PROJECT ENGINEER: 000,000
DATE: _____
DRAFTSMAN: LGH
PA REVIEW BY: _____

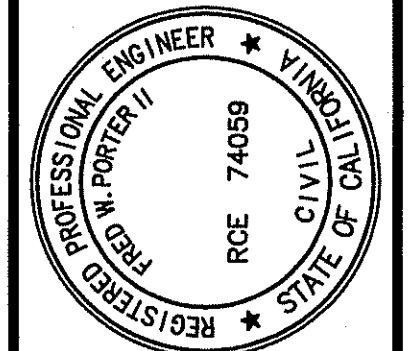

WALL PLANS
BAKERSFIELD CITY SCHOOL DISTRICT
M.O.T. YARD - 1501 FELIZ DRIVE
NORTH PORTION - EAST BOUNDARY

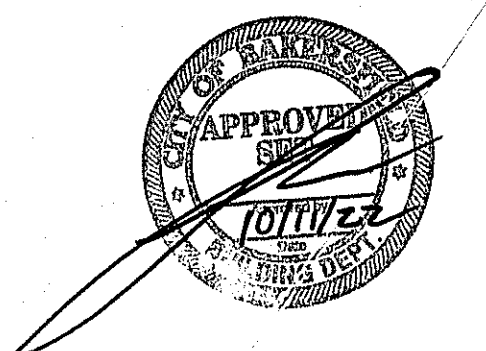

REVISIONS

DATE	08/23/2022
PA JOB No.	3239
SHEET	6
OF 7 SHEETS	

COB RECORDS No. _____

J:\3239 Wall Plans\3239Wall_Plan and Profile.dwg 08/26/22 matthewcarson

CONSTRUCTION NOTES

ALL STATIONS AND OFFSETS ARE TO BACK OF WALL (BCSD SIDE)

ALL PROFILE STATIONING IS BASED ON CENTERLINE DATA (UNLESS OTHERWISE NOTED).

- PROPOSED BLOCK WALL
- CENTERLINE
- - - - RIGHT-OF-WAY

NOTE "A": INSTALL #4 @ 32" O.C. INSTEAD OF #4 @ 40" O.C. AS PER DETAIL (A/2)

LEGEND

- PC = PROPERTY CORNER
- AP = ANGLE POINT
- BC = BEGIN CURVE
- CL = CENTERLINE
- CONC = CONCRETE
- CONST = CONSTRUCTION
- EC = END CURVE
- FTG = FOOTING
- GB = GRADE BREAK
- L/S = LANDSCAPE
- R/W = RIGHT OF WAY
- TOF = TOP OF FOOTING
- FG = FINISHED GROUND (LOT SIDE)
- FG** = FINISHED GROUND (STREET SIDE)
- CTR = CENTER
- TOW = TOP OF WALL
- RETG = RETAINING
- MAX = MAXIMUM
- MIN = MINIMUM
- CLR = CLEAR
- WL = WALL/FENCE STATION
- W.F.E. = WALL FOOTING EASEMENT
- T.O.B. = TOP OF BERM
- PL INT = PROPERTY LINE INTERSECTION

BACK OF WALL NO.	BEARING
W1	S01°23'31"W
W2	S89°27'06"W

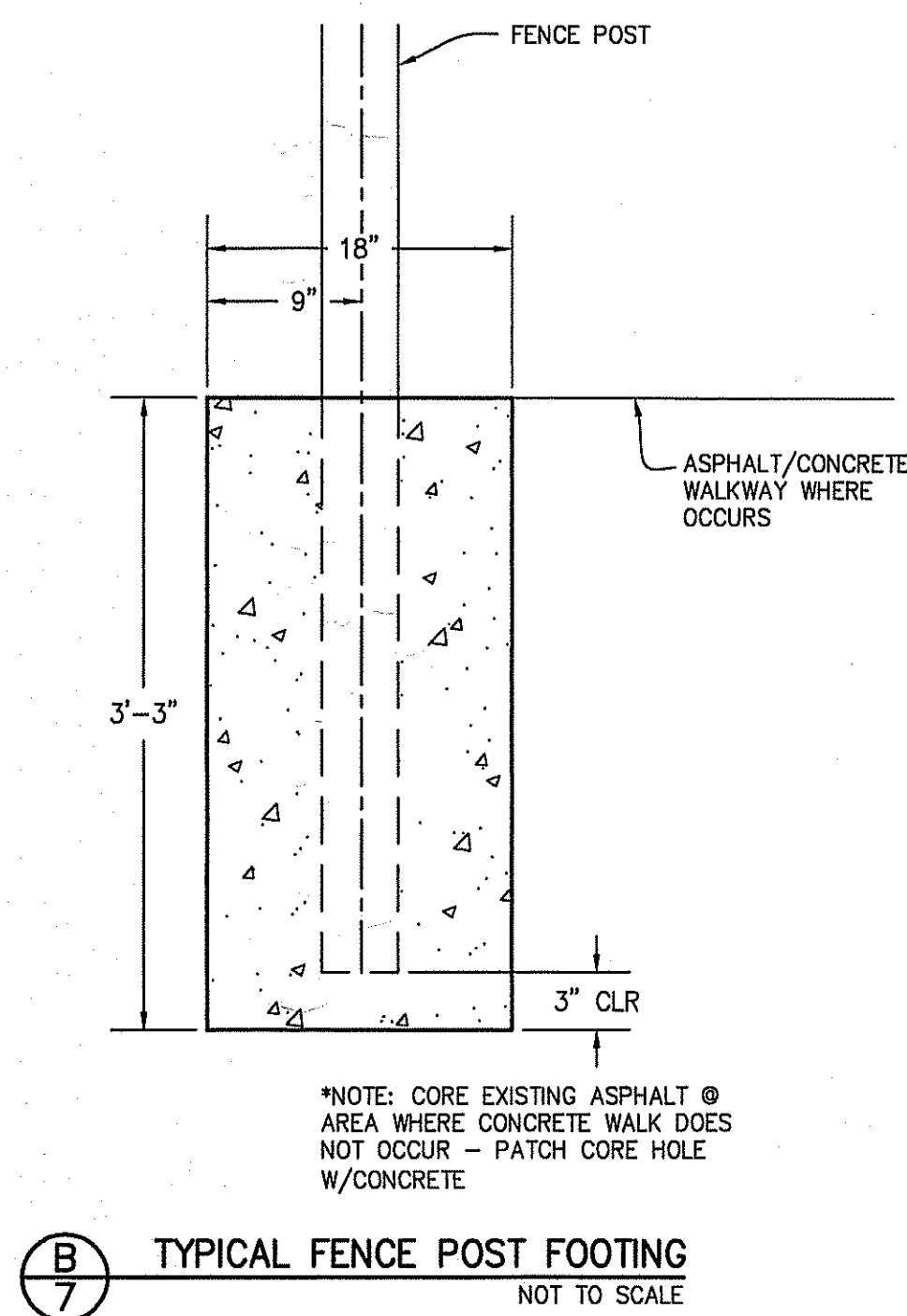
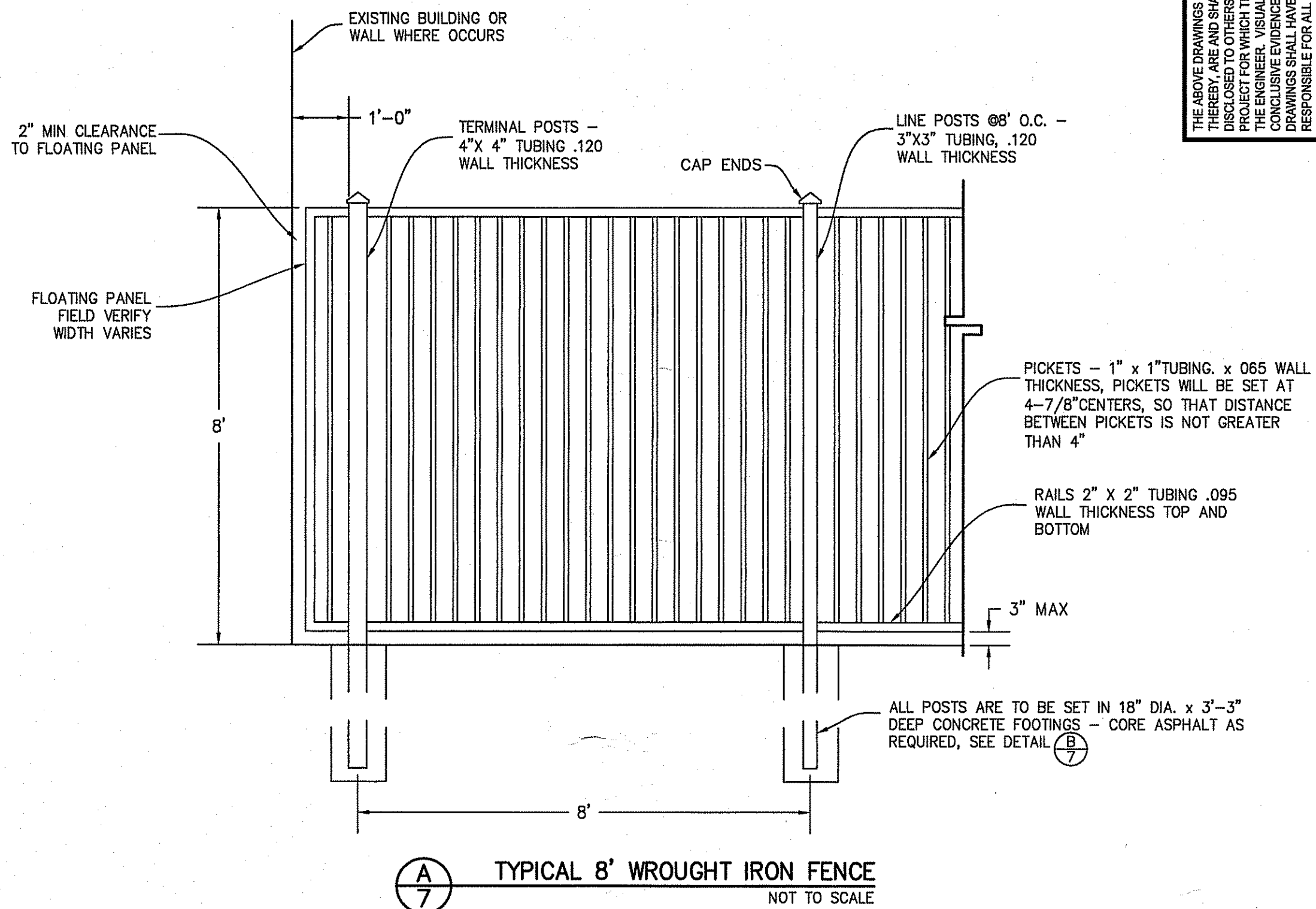
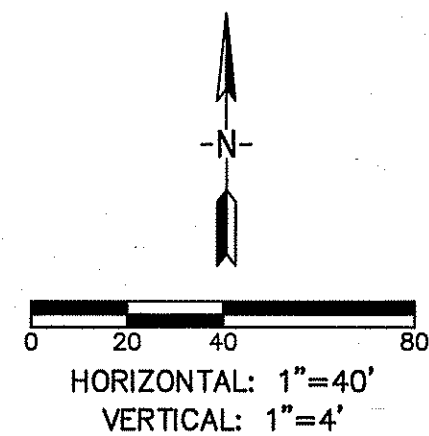
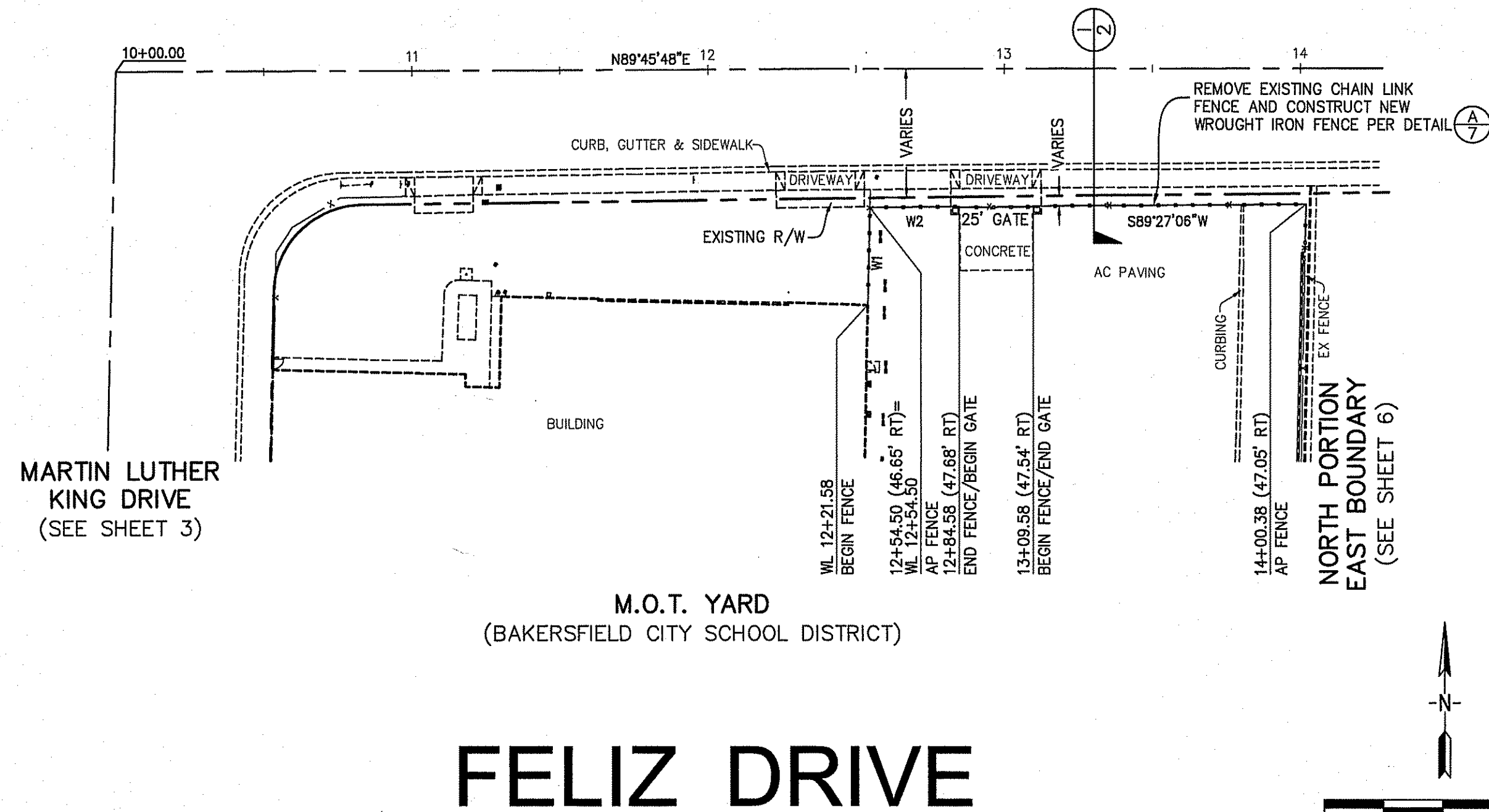

THE ABOVE DRAWINGS AND SPECIFICATIONS AND THEIR REVISIONS AND AMENDMENTS REPRESENTED THEREBY ARE AND SHALL REMAIN THE PROPERTY OF THE ENGINEER. NO PART THEREOF SHALL BE COPIED, REPRODUCED, OR USED IN CONNECTION WITH ANY WORK OR PROJECT OTHER THAN THE SPECIFIC PROJECT AND SITE FOR WHICH THEY WERE PREPARED WITHOUT THE WRITTEN CONSENT OF THE ENGINEER. VISUAL CONTACT WITH THESE DRAWINGS OR SPECIFICATIONS SHALL CONSTITUTE CONCLUSIVE EVIDENCE OF ACCEPTANCE OF THESE RESTRICTIONS. WRITTEN DIMENSIONS ON THESE DRAWINGS SHALL TAKE PRECEDENCE OVER SCALED DIMENSIONS. CONTRACTORS SHALL VERIFY AND BE RESPONSIBLE FOR ALL DIMENSIONS AND CONDITIONS SHOWN IN THESE DRAWINGS. SHOP DETAILS OF ANY VARIATIONS FROM THE DIMENSIONS AND CONDITIONS SHOWN IN THESE DRAWINGS, SHOP DETAILS MUST BE SUBMITTED TO THIS OFFICE FOR APPROVAL BEFORE PROCEEDING WITH FABRICATION.

PORTER & ASSOCIATES, INC.
ENGINEERING & SURVEYING
1200 21st Street, Bakersfield, California 93301
661.327.0562 FAX 661.327.1065

FRED W. PORTER II
PROJECT ENGINEER: 000.000
DRAFTSMAN: LGH
DATE: _____
PA REVIEW BY: _____

REGISTERED PROFESSIONAL ENGINEER
FRED W. PORTER II
RCE 74089
CIVIL
STATE OF CALIFORNIA

WALL PLANS
BAKERSFIELD CITY SCHOOL DISTRICT
M.O.T. YARD - 1501 FELIZ DRIVE
FELIZ DRIVE

REVISIONS

DATE: 08/23/2022
PA JOB No. 3239

SHEET
7
OF 7 SHEETS

APPROVED
FRED W. PORTER II
BUILDING DIVISION

COB RECORDS No. _____

S:\3239 Wall Plans\3239Wall_Plan and Profile.dwg 08/26/22 matthewcarson

CONSTRUCTION NOTES

ALL STATIONS AND OFFSETS ARE TO BACK OF WALL (BCSD SIDE)
 ALL PROFILE STATIONING IS BASED ON CENTERLINE DATA (UNLESS OTHERWISE NOTED).

- PROPOSED BLOCK WALL
- CENTERLINE
- RIGHT-OF-WAY

NOTE "A": INSTALL #4 @ 32" O.C. INSTEAD OF #4 @ 40" O.C. AS PER DETAIL A

LEGEND

- PC = PROPERTY CORNER
- AP = ANGLE POINT
- BC = BEGIN CURVE
- CL = CENTERLINE
- CONC = CONCRETE
- CONST = CONSTRUCTION
- EC = END CURVE
- FTG = FOOTING
- GB = GRADE BREAK
- L/S = LANDSCAPE
- R/W = RIGHT OF WAY
- TOF = TOP OF FOOTING
- FG = FINISHED GROUND (LOT SIDE)
- FG** = FINISHED GROUND (STREET SIDE)
- CTR = CENTER
- TOW = TOP OF WALL
- RETG = RETAINING
- MAX = MAXIMUM
- MIN = MINIMUM
- CLR = CLEAR
- WL = WALL STATION
- W.F.E. = WALL FOOTING EASEMENT
- T.O.B. = TOP OF BERM
- PL INT = PROPERTY LINE INTERSECTION

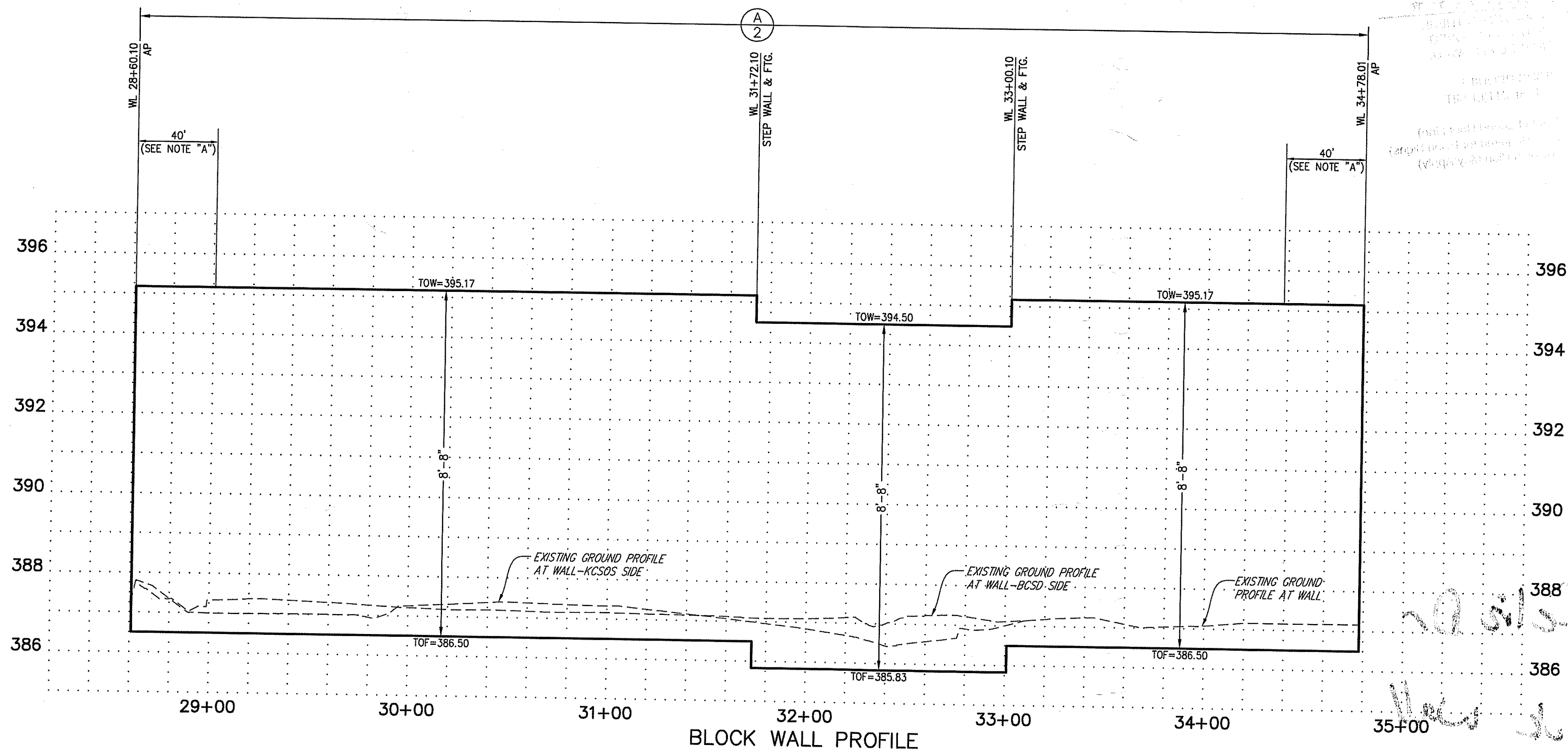
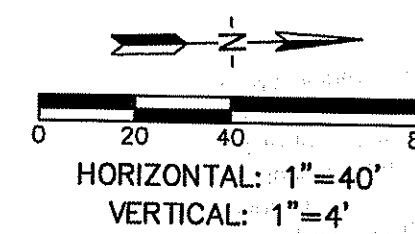
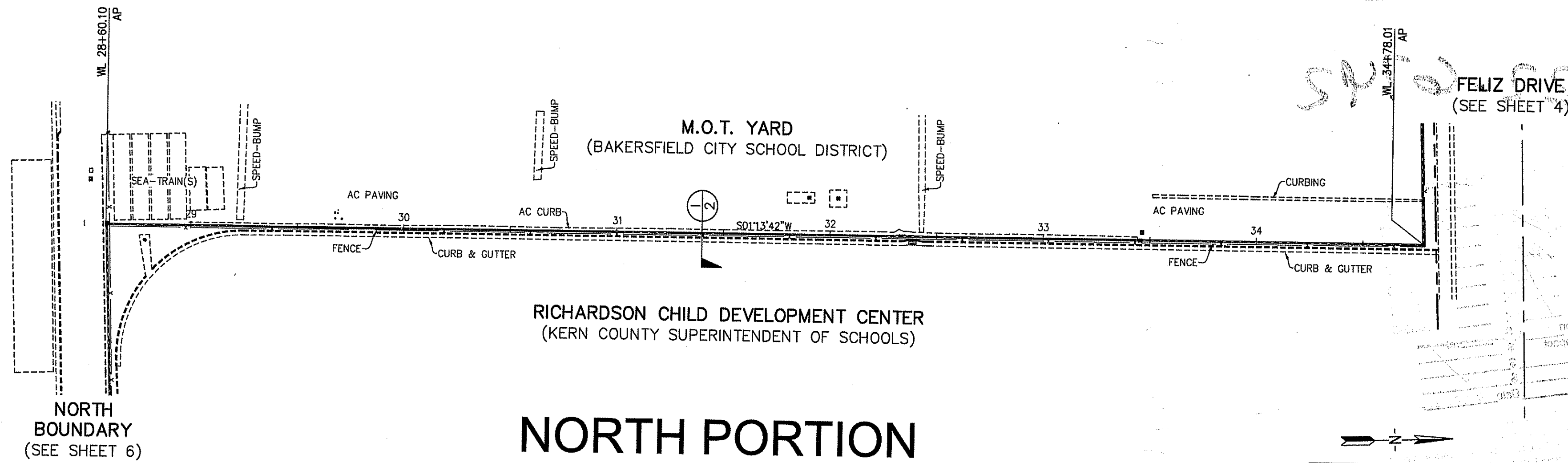

Block wall 1201

THE ABOVE DRAWINGS AND SPECIFICATIONS, AND IDEAS, DESIGNS, AND ARRANGEMENTS REPRESENTED THEREIN ARE THE SOLE PROPERTY OF PORTER & ASSOCIATES, INC. NO PART THEREOF SHALL BE COPIED, REPRODUCED, OR USED IN CONNECTION WITH ANY PROJECT WITHOUT THE WRITTEN CONSENT OF PORTER & ASSOCIATES, INC. WITH THESE DRAWINGS OR SPECIFICATIONS SHALL CONSTITUTE NO WARRANTY OF ANY KIND, EXPRESS OR IMPLIED, INCLUDING BUT NOT LIMITED TO, THE MERCHANTABILITY OF ANY MATERIALS OR THE FITNESS OF ANY DESIGN OR DRAWING FOR ANY PARTICULAR PURPOSE. CONTRACTORS SHALL BE RESPONSIBLE FOR ALL DIMENSIONS AND CONDITIONS ON THE JOB AND THIS OFFICE MUST BE NOTIFIED OF ANY DISCREPANCIES IMMEDIATELY UPON DISCOVERY. THIS OFFICE SHALL NOT BE RESPONSIBLE FOR ANY DAMAGE TO OR LOSS OF ANY PROPERTY OR PERSONAL INJURY OR DEATH ARISING OUT OF THE USE OF THESE DRAWINGS. SHOP DETAILS MUST BE SUBMITTED TO THIS OFFICE FOR APPROVAL BEFORE PROCEEDING WITH FABRICATION.

PORTER & ASSOCIATES, INC.
 ENGINEERING & SURVEYING
 1200 21st Street, Bakersfield, California 93301
 661.327.0362 FAX 661.327.1065

FRED W. PORTER II
 PROJECT ENGINEER: 000,000
 DRAFTSMAN: LGH
 PA REVIEW BY: _____ DATE: _____

REGISTERED PROFESSIONAL ENGINEER
 FRED W. PORTER II
 RCE 74098
 CIVIL
 STATE OF CALIFORNIA

WALL PLANS
 BAKERSFIELD CITY SCHOOL DISTRICT
 M.O.T. YARD - 1501 FELIZ DRIVE
 NORTH PORTION - EAST BOUNDARY

DATE 4/22/2022
 PA JOB No. 3239
 SHEET **7**
 OF 7 SHEETS

REVISIONS

COB RECORDS No. _____

RECEIVED
 JUN 02 2022
 CITY OF BAKERSFIELD
 BUILDING DEPARTMENT

CHECK SET 22-6742
 CITY OF BAKERSFIELD
 APPROVED BY [Signature] DATE 7/2/22
 THIS SET OF PLANS AND SPECIFICATIONS OF THE WORK FOR THE JOB AT ALL TIMES AND IT IS THE APPLICANT'S RESPONSIBILITY TO OBTAIN ALL NECESSARY PERMITS AND WITHOUT WRITING FROM THE BUILDING DEPARTMENT. THE APPLICANT SHALL BE RESPONSIBLE FOR THE OBTAINING OF THE NECESSARY PERMITS AND WITHOUT WRITING FROM THE BUILDING DEPARTMENT. THE APPLICANT SHALL BE RESPONSIBLE FOR THE OBTAINING OF THE NECESSARY PERMITS AND WITHOUT WRITING FROM THE BUILDING DEPARTMENT.
 CLASS OF WORK: New Addition, Addition, Demolish, Repair, Move
 TR _____ LOR _____
 USE ZONE A _____ H _____ C _____ M _____ PCD PUD _____
 TYPE OF CONSTRUCTION: I, II, III, IV, V
 OCCUPANCY GROUP: A _____ B _____ E _____ F _____ H _____ M _____ R _____ S _____ U _____
 BUILDING PERMIT NO. _____ DATE _____
 All construction shall comply with building requirements for curb, gutters, sidewalks and parking.

22-6742

CONTRACTOR'S CHECK DATE: 6-9-22

_____ CIVIL ENGINEER	_____ ARCHITECT
_____ ELECTRICAL	_____ MECHANICAL
_____ PLUMBING	_____ CONCRETE
_____ MECHANICAL	_____ CONCRETE
_____ MECH. TITLE 2	_____ CONCRETE
_____ Sewer Connection	_____ CONCRETE
_____ Transportation Impact	_____ CONCRETE
_____ Trunkline (TYPE)	_____ CONCRETE
_____ Trunkline (TYPE)	_____ CONCRETE
Initials: <u>ST</u>	Date: <u>9/7/22</u>

NOTICE
 Development Fees
 Assembly Bill 3081 (CHAP 5-14, ST 14.5, 1996) requires each local agency provide the project applicant a statement in writing at the time of imposition of fees or project approval of the amount of fees, a description of dedications, reservations, or other exactions and a notification that the 90-day approval period in which the applicant may protest such fees has begun.
 This notice serves to notify you that the 90-day approval period in which you may protest any imposed fees, description of dedications, reservations or other exactions will begin to run from the approved date as indicated on the building permit which describes the fees, description of dedications, reservations or other exactions.

*** ATTENTION ***
 IF ANY SIGNS SHOWN ON THESE PLANS ARE NOT APPROVED SEPARATE SIGN PERMIT MAY NOT BE ALLOWED.
 ALL SIGNS REQUIRE SEPARATE SIGN PERMIT
 (Bldg. Signs Not to Exceed Roof Line)
 (Structural Calculations Required for Pylon Signs)
 (Comprehensive Sign Plan May Apply)

1501 Feliz Dr
 Block wall