



LEAD REMEDIATION SCOPE OF WORK

Site Information:

Wayside Elementary School – HVAC Replacement
1000 Ming Avenue, Bakersfield, CA 93307



Prepared for:

Bakersfield City School District
1300 Baker Street, Bakersfield, CA 93305
(661) 631-5885

Prepared by:

Kristy Yowell, CAC 09-4500 / CDPH 4640
YES Environmental, Inc. (YES, Inc.)
YES, Inc. Project Number 23YES-117
April 10, 2024

This SOW should be printed in **color**.



1201 24th Street, Suite B110-377, Bakersfield, CA 93301 / (661) 527-0820

LEAD SCOPE OF WORK

Wayside Elementary School – HVAC Replacement

PURPOSE OF PROJECT

In order for Bakersfield City School District to modernize portions of buildings throughout the campus, lead-containing and lead-based materials will either be removed or disturbed, and the work must be done using lead-safe work practices. The contractor is responsible for field verifying their own measurements for bidding, notification, waste characterization, or any other purpose.

This Scope of Work should be used in conjunction with all Federal, State and local codes. *The information provided in this section is intended to assist the contractor in determining the extent of work; however, this information does **not** replace or supersede any direction or description of work as presented in the plans and specifications for this project.* If YES, Inc.'s scope of work and the plans and specifications differ, the contractor shall be obliged to bring any discrepancies to the attention of the architect/owner's representative prior to bidding the project via submission of a request for information to the architect.

DEFINITIONS

- Abatement Activities: precleaning of jobsite, setup of containment/regulated area, removal of asbestos-containing materials and final cleaning inside containment/regulated area in preparation for post abatement clearance air sampling or completion of work visual.

- Asbestos-Containing: material containing any detectable amount of asbestos. Acronym ACM.

- Lead-Containing: material containing any detectable amount of lead. Acronym LCP or LBP.

- Remediation Activities: precleaning of jobsite, setup of containment/regulated area, removal or disturbance of any sort of lead-containing materials and final cleaning inside containment/regulated area in preparation for job completion visual inspection by consultant.

- Contractor: Remediation contractor, abatement contractor or any trade qualified to conduct the work described in this Scope of Work.

- Consultant: BCSD's environmental consultant.

| Types of Lead Materials | | | |
|-------------------------|--------------------------------------------|---------------------------|--------------------------------------------------------------------|
| Types | Definition | Lead Content Standard | |
| LBP | Lead-based paint, coating or material | By XRF: By Paint Chip: | 1mg/cm ² or greater 0.5 wt%; or 5,000 ppm or greater |
| LCP | Lead-containing paint, coating or material | By XRF: By Paint Chip: | <1mg/cm ² <0.5 wt%; or 5,000 ppm |
| ND | No lead detected | By XRF: By Paint Chip: | Requires paint chip confirmation <reporting limit |

| Summary of XRF Findings | | |
|------------------------------------------------------------------------------------------------------------------------------------------------------------------------------------|-------------------------------------------------------------|---------------------------------|
| Material Description | Locations See XRF table for specific testing information | Lead Type & Result |
| All interior & exterior window sills, frame, windows, vertical support poles, trims, and any other painted component to the window systems NOTE: Various colors throughout. | Buildings A-H | LBP ≥1.00 mg/cm ² |



| Summary of XRF Findings | | |
|--------------------------------------------------------------------------------------------------------------------|--------------------------------------------------------------------|-------------------------------------|
| Material Description | Locations See XRF table for specific testing information | Lead Type & Result |
| All interior painted wood cabinets <i>NOTE: Various colors throughout</i> | Buildings A-H | LBP ≥1.00 mg/cm ² |
| All interior and exterior wood wall trims <i>NOTE: Various colors throughout</i> | Buildings A-H | LBP ≥1.00 mg/cm ² |
| All interior wood walls <i>NOTE: Various colors throughout</i> | Buildings A-H | LBP ≥1.00 mg/cm ² |
| All exterior vertical metal support poles at covered walkways throughout <i>NOTE: Various colors throughout</i> | Buildings A-H | LBP ≥1.00 mg/cm ² |
| All exterior metal fire extinguisher cabinets <i>NOTE: Various colors throughout</i> | Buildings A-H | LBP ≥1.00 mg/cm ² |
| All exterior wood door, jambs, trims, stops and door frame components <i>NOTE: Various colors throughout</i> | Buildings A-H | LBP ≥1.00 mg/cm ² |
| All blue painted exterior walkway striping | Buildings A-H = on the floor of the covered walkways throughout | LBP ≥1.00 mg/cm ² |
| All other painted components on campus – interior and exterior | Throughout all of the buildings inspected | LCP 0.00-0.99 mg/cm ² |

ADDITIONAL LEAD INFORMATION

Contractors, whose employees work at this site, are required to assess if their work will be subject to the requirements of the Cal/OSHA lead construction standard (CCR Title 8 § 1532.1). Cal/OSHA standards are designed to regulate and enforce on-the-job worker safety. Employers are required by law to ensure that employees are not exposed to airborne lead levels which exceed the permissible exposure limit (PEL). The standard requires worker exposure monitoring, medical surveillance, training, special work practices, etc.

Each contractor/employer who bids and/or performs work at the site will need to assess potential lead exposure to employees performing their particular scope of work. Contractors who perform work at this site may need to obtain additional data (beyond the data presented in this report) during their assessment and Cal/OSHA compliance planning. Individual contractors/subcontractors should be allowed access to the project to obtain any needed data (samples, consultation, etc.) to complete their employee exposure assessment.

Any work performed at the site where LBP or LCP is likely to be disturbed should be performed by a contractor trained and qualified to perform lead-related construction work. Any work that exceeds Cal/OSHA's permissible exposure limit or is performed to remediate a lead hazard must be conducted by CDPH certified personnel.

LEAD REGULATIONS FURTHER EXPLAINED

The lead work described in this Scope of Work is designed to assist the prime contractor and his sub-contractors to meet the requirements of the California lead standard for the construction industry, CCR Title 8, Section 1532.1. The requirements in this SOW are NOT intended to permanently eliminate lead-based paint or lead paint hazards. The results of the lead inspection indicate the materials anticipated to be disturbed contain lead-containing paint, not lead-based paint. Therefore, CDPH form 8551 which addresses Abatement of Lead Hazards shall not be submitted on this project.



1201 24th Street, Suite B110-377, Bakersfield, CA 93301 / (661) 527-0820

Should changes to any of the following occur, it may result in the requirement of form 8551 to be submitted to CDPH:

- Work practices demonstrated by the remediation contractor; or
- SOW is revised in such a way which meets the requirements for abatement.

If a lead hazard is created, the contractor creating the lead hazard shall be responsible for all costs associated with clean-up and compliance with Title 17.

MORE ON ASBESTOS & LEAD LOCATIONS, CONTENT & TYPE

Please see the attached initial asbestos and lead inspection report following this scope of work for identification of materials suspect to contain asbestos that have been sampled by YES, Inc. If any materials other than those identified in this scope of work and initial inspection are discovered and may be disturbed, work must be stopped and the project must be re-evaluated.

Of the materials being removed or disturbed, the contractor shall then refer to YES, Inc.'s initial inspection report and Scope of Work to determine the specific materials that contain asbestos and/or lead and those that have been determined to be free of asbestos and/or lead.

The initial inspection report does **not** denote materials to be removed; it reports whether materials present contain asbestos and/or lead. Contractor should refer to the architectural drawings and specifications for extent of work and locations.

NOTIFICATIONS

The contractor shall be responsible for the submission of all notifications triggered by lead disturbance. This includes, but is not limited to, the renovation or demolition permit release form to San Joaquin Valley Air Pollution Control District, Cal/OSHA Asbestos Notification and the Cal/OSHA Lead Work Pre-Job Notification.

SUPERVISOR & WORKER TRAINING REQUIRED

Workers and supervisors disturbing components with lead-containing must have, at a minimum, action-level lead training as described by Cal/OSHA 8 CCR 1532.1.

In addition, any contractor disturbing lead-based painted components on these structures must be RRP certified by the EPA as a company, and all individuals performing activities that disturb painted surfaces on behalf of the firm are either certified renovators or have been trained by a certified renovator. All renovations performed by the firm must be performed in accordance with the work practice standards of the Lead-Based Paint Renovation, Repair, and Painting Program in accordance with 40 CFR Part 745 Subpart E.

CAL/OSHA LEAD IN CONSTRUCTION STANDARD

The requirements within this scope of work (SOW) are designed to assist the remediation contractor to meet the requirements of the Cal/OSHA lead standard for the construction industry, Title 8 CCR Section 1532.1. The more stringent requirement between this SOW and Title 8 CCR Section 1532.1 shall take precedence.

PRE-JOB SUBMITTAL REQUIREMENTS

A hard copy of the remediation contractor's pre-job submittal packet shall be submitted to YES, Inc. and:

1. Include all of the items listed in the attached Submittal Requirements;
2. Be provided to and approved by YES, Inc. prior to the start of work by the remediation contractor.
3. Manifests shall be submitted to the project manager on the first day of the project for review, and also for final approval prior to waste removal from the job site.
4. Double sided copies are not acceptable.
5. Delays in providing the required submittals may affect the start of the project.
6. Electronic submittals will be accepted for viewing and approval purposes only.



OTHER CONSIDERATIONS

| Item | District Provided | Contractor Must Provide | Not Applicable / Required |
|----------------------------------------------------|-------------------|-------------------------|---------------------------|
| Water | X | | |
| Power | X | | |
| Removal of Items to be saved | X | | |
| Removal & Disposal of Items Remaining in Work Area | | X | |
| Safety & Security of Equipment | | X | |
| Challenge testing of HEPA filtered equipment | | X | |

ALLOWABLE FORMS OF COMMUNICATION

The contractor shall establish a means of communication between the supervisor and workers inside the containment/regulated area which includes two-way radios or equivalent. At no time will yelling, whistling or banging on containment, walls or on the decontamination chambers be allowed as a form of communication.

OCCUPANCY

This building will be unoccupied in the areas where lead disturbance is occurring. Other areas inside the building, but outside of the containment, may be occupied by staff and students, and other trades conducting work at this site.

WASTE BIN/CONTAINERS

All bins/containers brought on-site to deposit waste into must be lockable or securable. Bins shall be secured at the end of every shift. Plywood shall be placed under the wheels of each bin to protect the existing surface. Bins must be double lined with 6-mil poly prior to waste being deposited. Containers must have the appropriate labels affixed on them as soon as any lead-contaminated debris is deposited.

LEAD CONTAINMENT SETUP REQUIREMENTS

1. All poly used on this project shall be 6-mil and flame retardant.
2. A wash station that includes water, soap, towels and sticky mat shall be set up and used for hygiene purposes and to prevent the tracking out of lead-contaminated debris. Should a contractor's disturbance methods demand or choose to don disposable suits, the wash station must be built as a chamber. A chamber shall be built large enough to accommodate all workers donning PPE without being able to be seen by staff, students, or anyone else walking by.
3. The contractor is required to contain the disturbance of lead in a manner which prevents lead-contaminated dust, debris and water from leaving the regulated work area. Uncontrolled releases will not be allowed and will be cause for stopping the project until modified work practices and containment that prevent these releases from occurring are designed and implemented.
4. The containment must be developed in compliance with the requirements of CCR 8 1532.1, these specifications and must be approved by the consultant.
5. All those entering the regulated area must sign in on a roster that documents their presence in the area.

WORKER PROTECTION

The contractor shall provide respiratory protection as outlined in current Cal/OSHA regulations. However, at a minimum:

1. During the removal and detail cleaning of lead-containing or lead-based painted components, workers shall wear at a minimum, half-face negative-pressure respirator with P-100 HEPA cartridges.
2. Quality disposable coveralls such as Tyvek-like suits shall be worn by all workers during all remediation activities on this project. Exceptions to this must be submitted to consultant in writing for review/approval.
3. Contractor shall provide the chain of custody and laboratory results of their worker air monitoring results each week on Wednesday for the previous week's samples. Unless a negative exposure assessment is produced, worker air monitoring must continue as long as remediation activities are being performed.



HEPA FILTERED EQUIPMENT REQUIREMENTS

Units arriving dirty or appearing to be contaminated shall be removed from the project site. Units must be positioned in the standard upright manner in which the manufacturer designed the equipment to operate.

LEAD DISTURBANCE PROCEDURES

1. Lead remediation shall be performed using the most expedient method, contingent upon approval from the consultant.
2. All LCP and LBP components or materials must be stabilized in a manner approved by the consultant before it is disturbed.
3. All removal methods must be performed using amended water.
4. Lead-containing paints or components shall be disturbed and/or removed while being kept wet, inside a containment and promptly placed into leak-tight containers.
5. Lead waste must be containerized before any work stoppages, such as for breaks, lunch, or the end of a shift. Bulk debris must be kept adequately wet until containerized. The contractor must plan only to disturb amounts of material that can be cleaned up and containerized before the next work stoppage.

PROHIBITED WORK PRACTICES

1. Uncontrolled releases. This is cause for stopping the project until modified work practices and containment that prevent these releases from occurring are designed and implemented.
2. Dry removal or dry disturbance of any kind. Garden hoses are prohibited on this project during remediation activities.
3. Mechanical tools without HEPA vacuum attachment and HEPA vacuum properly attached according to manufacturer recommendation.

COMPLETION OF LEAD REMOVAL

The consultant will inspect work areas for visual signs of dust and debris related to the disturbance of lead. All surface areas must be clean. Residual dust, of any nature, that was generated on this project and found within the regulated area will be assumed to contain lead and must be cleaned. A passing visual inspection shall constitute the LCP and LBP paints or components are rendered stabilized before being removed in compliance with Cal/OSHA's Lead in Construction Standard 8 CCR 1532.1 and the work identified in the architectural drawings. Should the condition of the LCP and LBP change from the date and time the visual inspection was given by the consultant, the contractor shall stop work and contact the consultant for re-evaluation and/or reinspection of the component.

LEAD DISPOSAL

Waste characterization is the responsibility of the lead remediation contractor. Lead waste shall be secured on-site until characterized. Testing results shall be provided to the on-site project monitor within ten calendar days of the waste being generated. Lead waste shall be disposed of in accordance with the contractor's waste characterization.

The Contractor is required to comply with all regulations in Title 8 Section 1532.1 Lead in Construction, all appropriate sections of Title 17 Lead Related Construction and Cal/EPA Title 22 for waste classification and disposal. The containers shall be leak tight and meet the requirements as stated in these specifications. Bags and other containers shall not be overfilled.

Attachments:

- A. Lead Submittal Requirements
- B. Site & Building Maps
- C. Asbestos & Lead Survey



Attachment A – Submittal Requirements

Lead Submittal Requirements

Note: not all of the items listed below are applicable for every project. Only the items applicable are required to be included in the submittal packet.

Prestart Submittals

1. Contractor's license(s) & Training
 - a. CSLB license
 - b. EPA RRP
 - c. Proof of Lead Training
2. Notifications
 - a. San Joaquin Valley APCD or appropriate local EPA enforcement agency for the job site location.
 - b. Cal/OSHA
 - i. Lead notification
 - c. Equipment rented
 - i. Proof the rental company has been made aware the rented equipment will be used for lead related work.
3. Site specific safety/emergency plan
 - a. This must include, but is not limited to, the nearest hospital's phone number and address;
 - b. Local police department phone number and address;
 - c. Title, name and phone number of the contractor's contact whom should be contacted in the event of an emergency.
4. Contractor worker documentation for all workers on-site
 - a. Proof of lead training (Cal/OSHA, CDPH or EPA, etc.)
 - b. Proof of medical approval to wear a respirator
 - c. Respirator fit test
5. Contractor's respiratory protection program
6. Negative exposure assessment (if requesting to don lesser PPE than specified in the SOW)
7. Safety data sheets
 - a. All hazardous materials (as defined by Cal/OSHA)
8. Waste Disposal
 - a. Paperwork for landfill proving the landfill will accept the waste
 - b. Proof of licensed waste hauler and company for hazardous waste
 - c. Waste characterization of lead waste
 - d. Manifest for all types of waste to be generated



Submittals Required During the Project

1. Daily copies
 - a. Safety meeting (if held daily)
 - b. Worker roster of all employees onsite – regardless of training
 - c. Entry/exit log for employees entering/exiting containment/regulated area
2. Weekly
 - a. Safety meeting
 - b. Worker personal air monitoring
 - c. Area air monitoring

Submittals Required at the Conclusion of the Project

1. Contractor Air Monitoring & Lab Results (refer to the SOW for required frequency)
2. Any other paperwork as requested by the Consultant or Building Owner



1201 24th Street, Suite B110-377, Bakersfield, CA 93301 / (661) 527-0820

Attachment B – Site & Building Maps

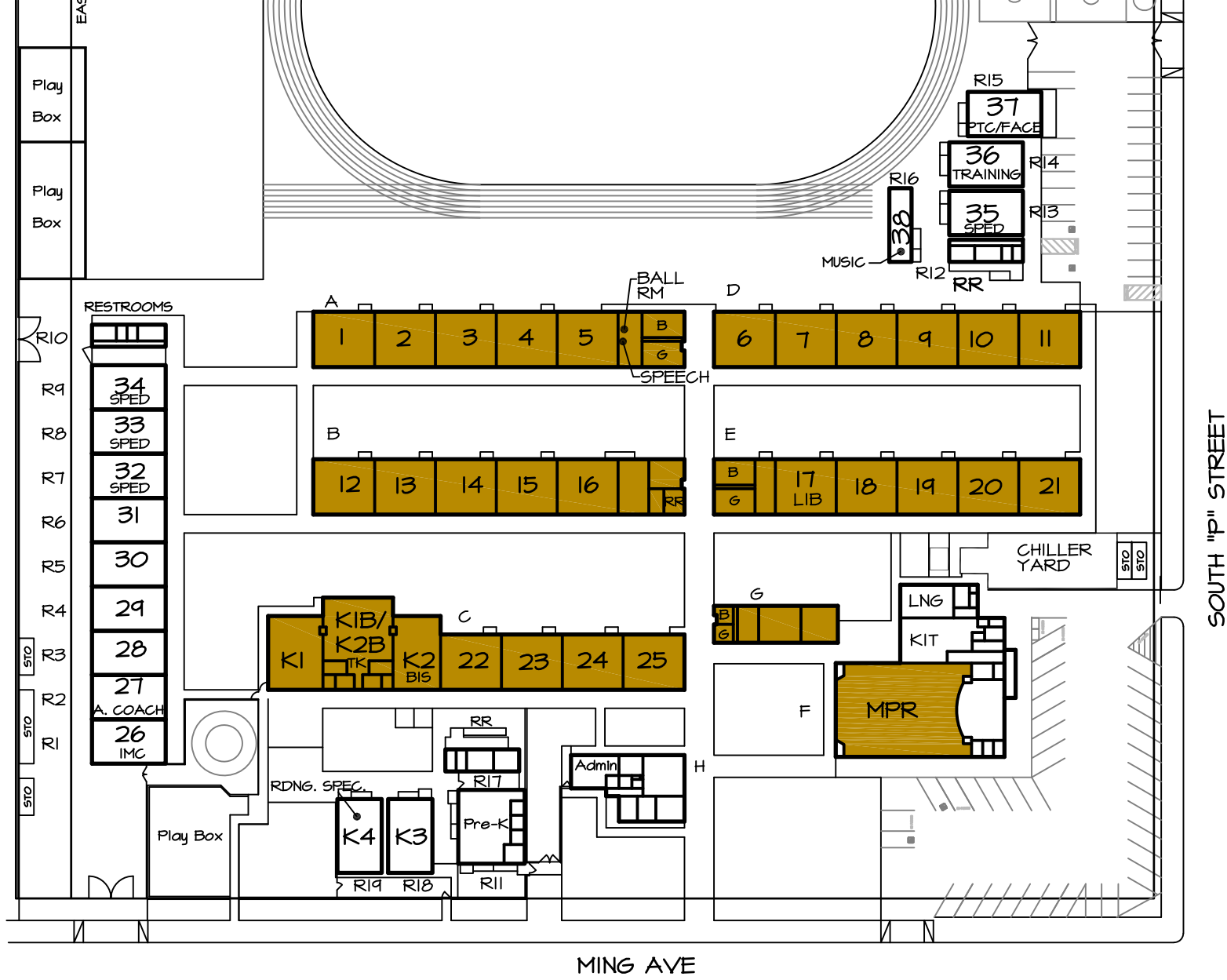

WAYSIDE ELEMENTARY SCHOOL
1000 MING AVE.

■ REMOVE PERMANENT ROOMS FROM CHILLER SYSTEM. INSTALL NEW INDIVIDUAL WALL OR ROOF UNIT



SITE PLAN

Bakersfield City School District
Wayside ES – HVAC MOD
YES Environmental, Inc. Project #: 23YES-05
Dec 2022 – June 2023

Building Maps



LBP Maps

Building A

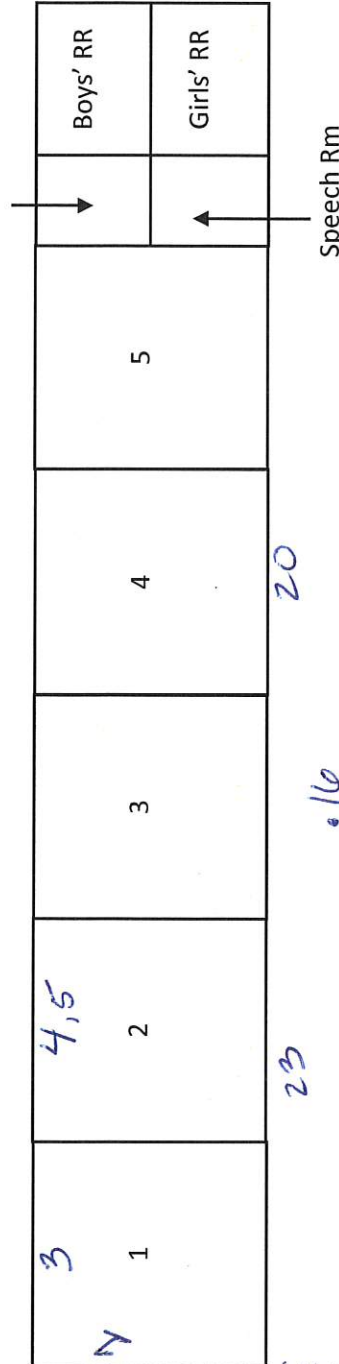

#'s = Line number on XRF report.

Not Drawn To Scale



Bakersfield City School District
Wayside ES – HVAC MOD
YES Environmental, Inc. Project #: 23YES-05
Dec 2022 – June 2023
Building Maps

Building B

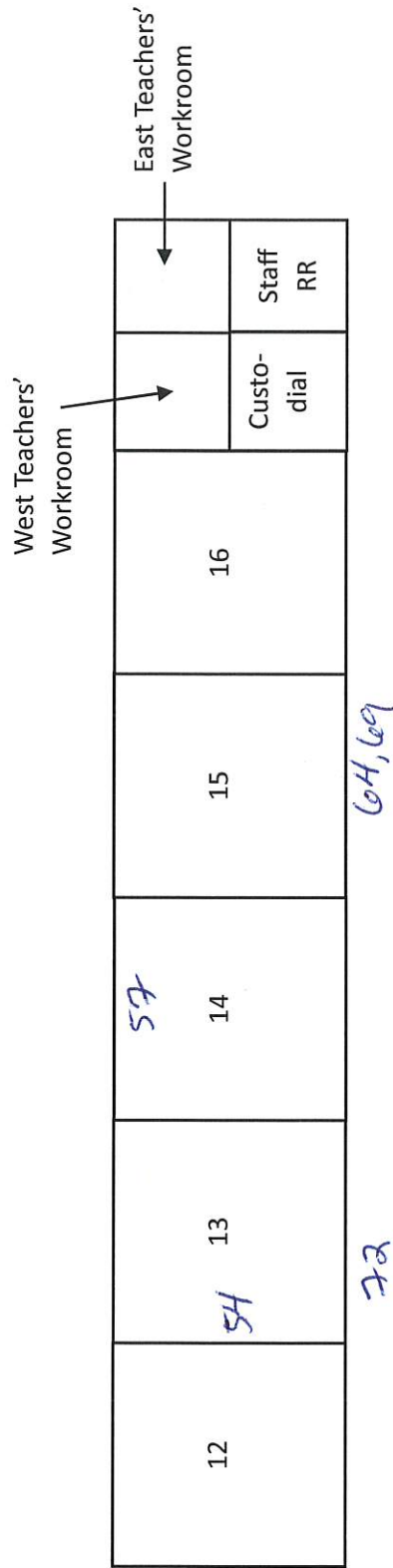

Not Drawn To Scale



LBB Maps

Bakersfield City School District
Wayside ES – HVAC MOD
YES Environmental, Inc. Project #: 23YES-05
Dec 2022 – June 2023

Building Maps

Building C

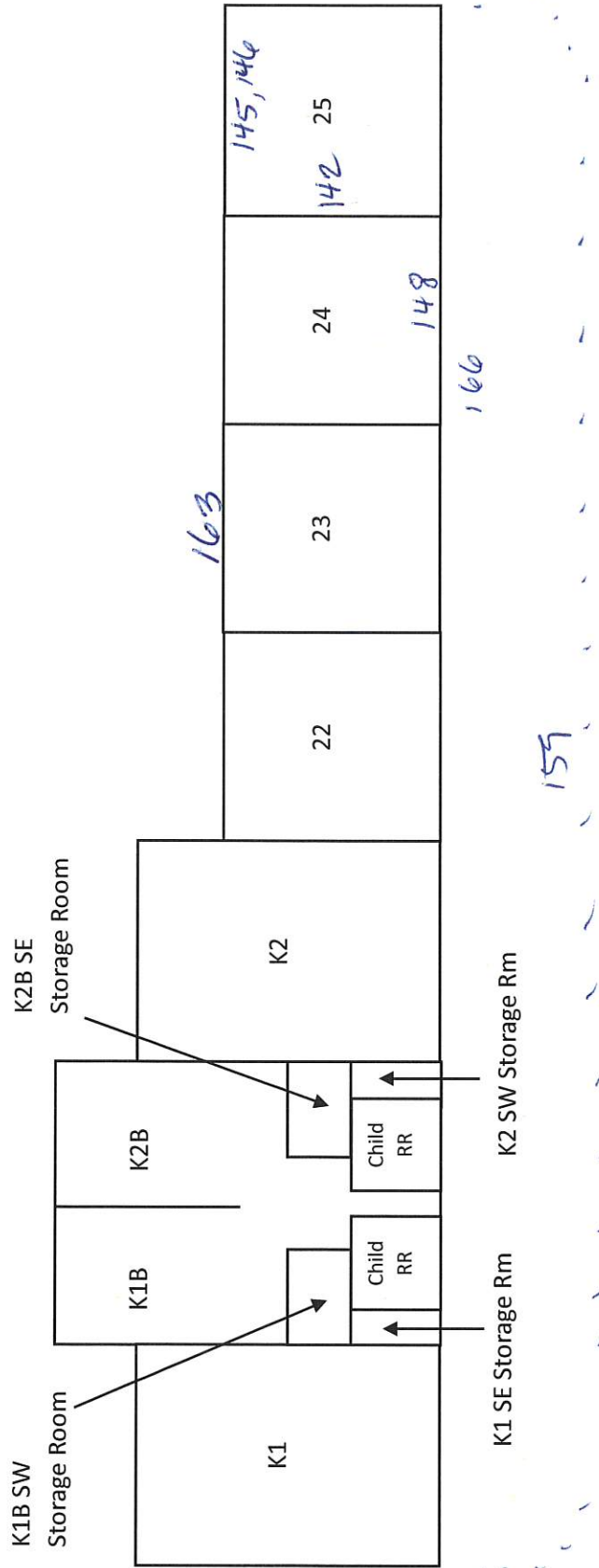

Not Drawn To Scale

Bakersfield City School District
Wayside ES – HVAC MOD
YES Environmental, Inc. Project #: 23YES-05
Dec 2022 – June 2023

Building Maps



LBF Maps

Building D

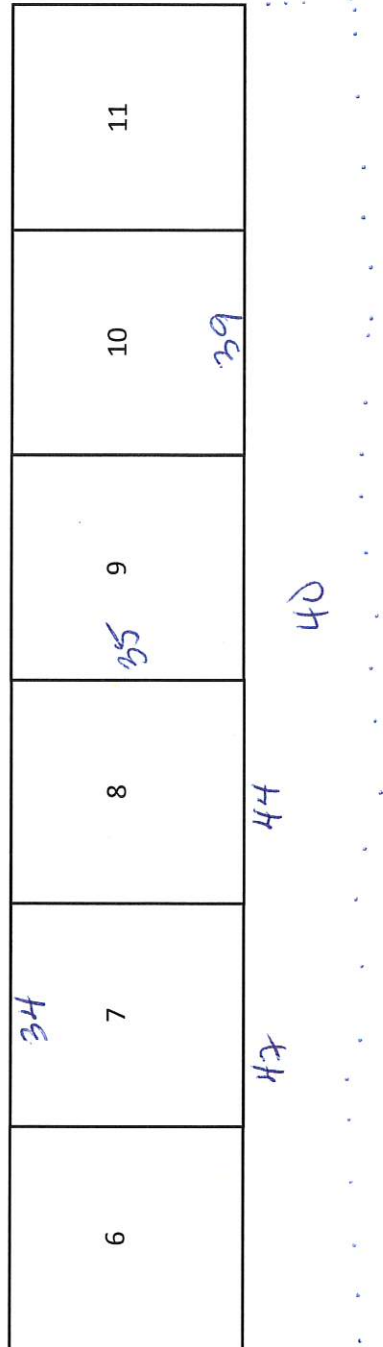

Not Drawn To Scale

Bakersfield City School District
 Wayside ES – HVAC MOD
 YES Environmental, Inc. Project #: 23YES-05
 Dec 2022 – June 2023



Building Maps

Building E

| | | | | | | |
|----------|------------------------|----|----|----|----|----|
| Boys' RR | Custo- dial Room | 17 | 18 | 19 | 20 | 21 |
| | | | | | | |

84, 85, 86

82
81

105

101

98, 102

107



Building F

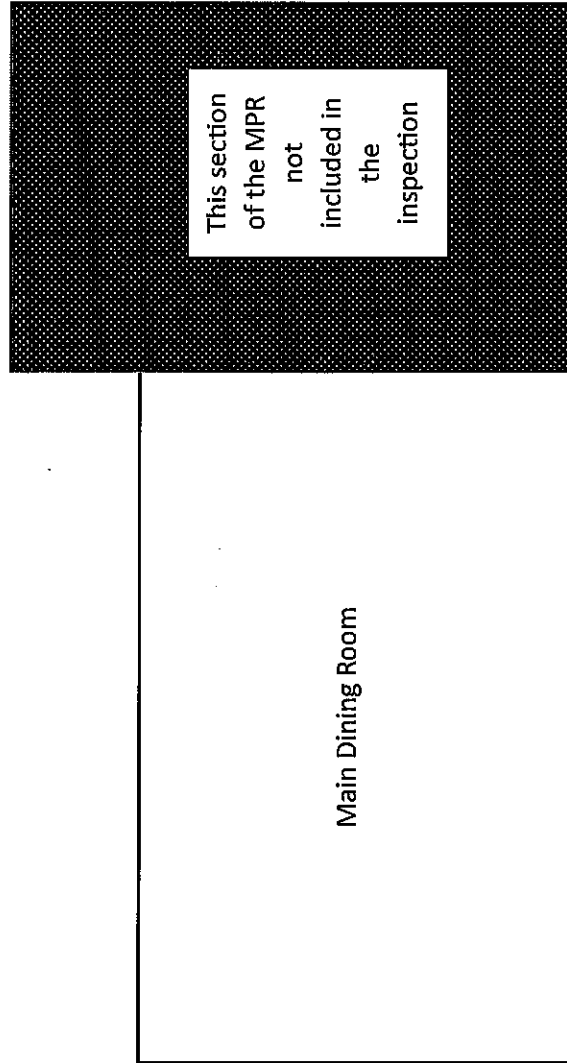

Not Drawn To Scale

Bakersfield City School District
Wayside ES – HVAC MOD
YES Environmental, Inc. Project #: 23YES-05
Dec 2022 – June 2023



Building Maps

Building G



123

134, 124, 125

128, 131

Not Drawn To Scale



Attachment C – Asbestos & Lead Survey



YES Environmental, Inc.

1201 24th Street, Suite B110-377, Bakersfield, CA 93301 / (661) 527-0820

CLIENT DEFINED SURVEY FOR LEAD BASED PAINT

Client: Bakersfield City School District

Site: Wayside ES – HVAC MOD

YES, Inc. Project Number: 23YES-05 VIKEN Serial #: 3333 Model #: Pb200

| NO. | SAMPLE LOCATION | COMPONENT | SUBSTRATE | COLOR | CONDITION | XRF RESULT MG/CM ² | |
|------------------------------|---------------------|------------------------------------|---------------------|-------|-----------|----------------------------------|-----|
| INTERIOR – BUILDING A | | | | | | | |
| 1. | ROOM 1 – WEST SIDE | CABINETS | WOOD | GREY | FAIR | 1.35 | LBP |
| 2. | ROOM 1 – NORTH SIDE | WINDOW | METAL | GREY | INTACT | 0.36 | LCP |
| 3. | ROOM 1 – NORTH SIDE | WINDOW TRIM | WOOD | GREY | INTACT | 1.10 | LBP |
| 4. | ROOM 2 – NORTH SIDE | WINDOW SILL | WOOD | GREY | INTACT | 1.11 | LBP |
| 5. | ROOM 2 – NORTH SIDE | VERTICAL WINDOW SUPPORT POLE | METAL | GREY | INTACT | 4.05 | LBP |
| 6. | ROOM 3 – SOUTH SIDE | WALL | PLASTER | GREY | INTACT | 0.10 | LCP |
| 7. | ROOM 3 – SOUTH SIDE | DOOR | TRIM | GREY | FAIR | 0.11 | LCP |
| 8. | ROOM 3 – SOUTH SIDE | DOOR FRAME | METAL | GREY | INTACT | 0.11 | LCP |
| 9. | ROOM 4 – SOUTH SIDE | DOOR | METAL | GREY | INTACT | 0.06 | LCP |
| 10. | ROOM 5 – CENTER | T-BAR GRID | METAL | WHITE | INTACT | 0.00 | LCP |
| 11. | ROOM 5 – CENTER | CEILING TILE 2X4 | FIBROUS MATERIAL | WHITE | INTACT | 0.02 | LCP |



YES Environmental, Inc.

1201 24th Street, Suite B110-377, Bakersfield, CA 93301 / (661) 527-0820

| NO. | SAMPLE LOCATION | COMPONENT | SUBSTRATE | COLOR | CONDITION | XRF RESULT MG/CM ² | |
|----------------------------------------|-------------------------------|--------------------------|-----------------|---------|-----------|----------------------------------|-----|
| INTERIOR – BUILDING A CONTINUED | | | | | | | |
| 12. | GIRLS RR – AT ENTRY | FLOOR | 2" CERAMIC TILE | GREY | INTACT | 0.17 | LCP |
| 13. | GIRLS RR – SOUTH SIDE | WALL | 4" CERAMIC TILE | WHITE | INTACT | 0.20 | LCP |
| 14. | GIRLS RR – SOUTH SIDE | SINK | PORCELAIN | WHITE | INTACT | 0.01 | LCP |
| 15. | BOYS RR – AT TOILETS | TOILET | PORCELAIN | WHITE | INTACT | 0.01 | LCP |
| EXTERIOR – BUILDING A | | | | | | | |
| 16. | SOUTH SIDE AT COVERED WALKWAY | VERTICAL SUPPORT POLES | METAL | DK GREY | FAIR | 1.72 | LBP |
| 17. | SOUTH SIDE AT ROOM 1 | DOOR | METAL | DK GREY | FAIR | 0.02 | LCP |
| 18. | SOUTH SIDE AT ROOM 2 | DOOR FRAME | METAL | DK GREY | FAIR | 0.40 | LCP |
| 19. | SOUTH SIDE AT ROOM 3 | DOOR TRIM | WOOD | DK GREY | INTACT | 0.22 | LCP |
| 20. | SOUTH SIDE AT ROOM 4 | WINDOW SILL/TRIM | WOOD | DK GREY | INTACT | 1.45 | LBP |
| 21. | NORTH SIDE AT BALL ROOM | WALL | PLASTER | CREAM | FAIR | 0.21 | LCP |
| 22. | SOUTH SIDE WEST END | FIRE EXT. CABINET INFILL | WOOD | CREAM | INTACT | 0.24 | LCP |
| 23. | SOUTH SIDE WEST END | FIRE EXT. CABINET | WOOD | METAL | INTACT | 2.05 | LBP |
| 24. | NORTH SIDE EAST END | WALL BASE | CONCRETE | CREAM | FAIR | 0.01 | LCP |



YES Environmental, Inc.

1201 24th Street, Suite B110-377, Bakersfield, CA 93301 / (661) 527-0820

| NO. | SAMPLE LOCATION | COMPONENT | SUBSTRATE | COLOR | CONDITION | XRF RESULT MG/CM ² | |
|----------------------------------------|------------------------------|------------------------------------|-----------|---------|-----------|----------------------------------|-----|
| EXTERIOR – BUILDING A CONTINUED | | | | | | | |
| 25. | SOUTH SIDE CENTER OF WALKWAY | FLOOR | CONCRETE | BLUE | FAIR | 0.60 | LCP |
| 26. | SOUTH SIDE CENTER OF WALKWAY | FLOOR | CONCRETE | WHITE | FAIR | 0.25 | LCP |
| 27. | WEST SIDE SOUTH END | ELECTRICAL BOX | METAL | GREEN | INTACT | 0.48 | LCP |
| 28. | NORTH SIDE WEST END | WINDOW | METAL | DK GREY | INTACT | 0.39 | LCP |
| 29. | NORTH SIDE CENTER | LOUVER | METAL | CREAM | INTACT | 0.07 | LCP |
| 30. | EAST SIDE | PLUMBERS CHASE ACCESS DOOR | WOOD | CREAM | FAIR | 0.09 | LCP |
| 31. | NORTH SIDE EAST END | DRINKING FOUNTAIN | PORCELAIN | WHITE | INTACT | 0.45 | LCP |
| INTERIOR – BUILDING D | | | | | | | |
| 32. | ROOM 7 – NORTH SIDE | WINDOW | METAL | GREY | INTACT | 0.22 | LCP |
| 33. | ROOM 7 – NORTH SIDE | WINDOW SILL | WOOD | GREY | INTACT | 0.67 | LCP |
| 34. | ROOM 7 – NORTH SIDE | VERTICAL WINDOW SUPPORT POLE | METAL | GREY | INTACT | 1.09 | LBP |
| 35. | ROOM 9 – WEST SIDE | CABINETS | WOOD | GREY | INTACT | 2.09 | LBP |
| 36. | ROOM 9 – WEST SIDE | WALL | PLASTER | GREY | INTACT | 0.32 | LCP |



YES Environmental, Inc.

1201 24th Street, Suite B110-377, Bakersfield, CA 93301 / (661) 527-0820

| NO. | SAMPLE LOCATION | COMPONENT | SUBSTRATE | COLOR | CONDITION | XRF RESULT MG/CM ² | |
|----------------------------------------|-------------------------------|-----------------------------|-----------|---------|-----------|----------------------------------|-----|
| INTERIOR – BUILDING D CONTINUED | | | | | | | |
| 37. | ROOM 10 – SOUTH SIDE | DOOR FRAME | METAL | GREY | FAIR | 0.50 | LCP |
| 38. | ROOM 10 – SOUTH SIDE | DOOR | METAL | DK GREY | FAIR | 0.05 | LCP |
| 39. | ROOM 10 – SOUTH SIDE | UPPER WALL TRIM | WOOD | GREY | INTACT | 1.81 | LBP |
| EXTERIOR – BUILDING D | | | | | | | |
| 40. | SOUTH SIDE AT COVERED WALKWAY | VERTICAL SUPPORT POLES | METAL | DK GREY | FAIR | 1.72 | LBP |
| 41. | SOUTH SIDE AT ROOM 9 | DOOR | METAL | DK GREY | FAIR | 0.02 | LCP |
| 42. | SOUTH SIDE AT ROOM 8 | DOOR FRAME | METAL | DK GREY | FAIR | 0.40 | LCP |
| 43. | SOUTH SIDE AT ROOM 7 | DOOR TRIM | WOOD | DK GREY | INTACT | 0.22 | LCP |
| 44. | SOUTH SIDE AT ROOM 8 | WINDOW SILL/TRIM | WOOD | DK GREY | INTACT | 1.47 | LBP |
| 45. | SOUTH SIDE AT ROOM 11 | WALL | PLASTER | CREAM | FAIR | 0.41 | LCP |
| 46. | SOUTH SIDE WEST END | FIRE EXT. CABINET INFILL | WOOD | CREAM | INTACT | 0.24 | LCP |
| 47. | SOUTH SIDE WEST END | FIRE EXT. CABINET | WOOD | METAL | INTACT | 2.05 | LBP |
| 48. | SOUTH SIDE EAST END | WALL BASE | CONCRETE | CREAM | FAIR | 0.45 | LCP |
| 49. | SOUTH SIDE CENTER OF WALKWAY | FLOOR | CONCRETE | BLUE | FAIR | 0.60 | LCP |



YES Environmental, Inc.

1201 24th Street, Suite B110-377, Bakersfield, CA 93301 / (661) 527-0820

| NO. | SAMPLE LOCATION | COMPONENT | SUBSTRATE | COLOR | CONDITION | XRF RESULT MG/CM ² | |
|----------------------------------------|-------------------------------|------------------------------|------------------|---------|-----------|----------------------------------|-----|
| EXTERIOR – BUILDING D CONTINUED | | | | | | | |
| 50. | SOUTH SIDE CENTER OF WALKWAY | FLOOR | CONCRETE | WHITE | FAIR | 0.25 | LCP |
| 51. | WEST SIDE SOUTH END | ELECTRICAL BOX | METAL | GREEN | INTACT | 0.48 | LCP |
| 52. | NORTH SIDE WEST END | WINDOW | METAL | DK GREY | INTACT | 0.43 | LCP |
| 53. | NORTH SIDE CENTER | LOUVER | METAL | CREAM | INTACT | 0.06 | LCP |
| INTERIOR – BUILDING B | | | | | | | |
| 54. | ROOM 13 – WEST SIDE | CABINET | WOOD | GREY | INTACT | 1.51 | LBP |
| 55. | ROOM 13 – NORTH SIDE | WINDOW | METAL | GREY | INTACT | 0.90 | LCP |
| 56. | ROOM 13 – NORTH SIDE | WINDOW SILL | WOOD | GREY | INTACT | 0.78 | LCP |
| 57. | ROOM 14 – NORTH SIDE | VERTICAL WINDOW SUPPORT POLE | METAL | GREY | INTACT | 5.46 | LBP |
| 58. | ROOM 15 – SOUTH SIDE WEST END | WALL | PLASTER | CREAM | INTACT | 0.13 | LCP |
| 59. | ROOM 15 – CENTER | T-BAR GRID | METAL | WHITE | INTACT | 0.01 | LCP |
| 60. | ROOM 15 – CENTER | CEILING TILE 2X4 | FIBROUS MATERIAL | WHITE | INTACT | 0.00 | LCP |
| 61. | ROOM 16 – SOUTH SIDE | DOOR FRAME | METAL | GREY | INTACT | 0.40 | LCP |
| 62. | ROOM 16 – SOUTH SIDE | DOOR | METAL | DK GREY | INTACT | 0.06 | LCP |

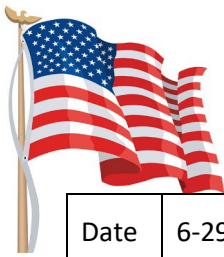

YES Environmental, Inc.

1201 24th Street, Suite B110-377, Bakersfield, CA 93301 / (661) 527-0820

| NO. | SAMPLE LOCATION | COMPONENT | SUBSTRATE | COLOR | CONDITION | XRF RESULT MG/CM ² | |
|----------------------------------------|-------------------------------|-----------------------------|-------------------------|---------|-----------|----------------------------------|-----|
| INTERIOR – BUILDING B CONTINUED | | | | | | | |
| 63. | ROM 12 – SOUTH SIDE | CEILING | 12" ACOUSTIC TILE | WHITE | INTACT | 0.07 | LCP |
| 64. | ROOM 15 – SOUTH SIDE | UPPER WINDOW SILL | WOOD | GREY | INTACT | 1.10 | LBP |
| EXTERIOR – BUILDING B | | | | | | | |
| 65. | SOUTH SIDE AT COVERED WALKWAY | VERTICAL SUPPORT POLES | METAL | DK GREY | FAIR | 2.61 | LBP |
| 66. | SOUTH SIDE AT ROOM 12 | DOOR | METAL | DK GREY | FAIR | 0.02 | LCP |
| 67. | SOUTH SIDE AT ROOM 13 | DOOR FRAME | METAL | DK GREY | FAIR | 0.40 | LCP |
| 68. | SOUTH SIDE AT ROOM 14 | DOOR TRIM | WOOD | DK GREY | INTACT | 0.22 | LCP |
| 69. | SOUTH SIDE AT ROOM 15 | WINDOW SILL/TRIM | WOOD | DK GREY | INTACT | 3.98 | LBP |
| 70. | SOUTH SIDE CENTER | WALL | PLASTER | CREAM | FAIR | 0.36 | LCP |
| 71. | SOUTH SIDE EAST END | FIRE EXT. CABINET INFILL | WOOD | CREAM | INTACT | 0.24 | LCP |
| 72. | SOUTH SIDE WEST END | FIRE EXT. CABINET | WOOD | METAL | INTACT | 1.18 | LBP |
| 73. | NORTH SIDE EAST END | WALL BASE | CONCRETE | CREAM | FAIR | 0.47 | LCP |
| 74. | SOUTH SIDE CENTER OF WALKWAY | FLOOR | CONCRETE | BLUE | FAIR | 0.50 | LCP |



YES Environmental, Inc.

1201 24th Street, Suite B110-377, Bakersfield, CA 93301 / (661) 527-0820

| NO. | SAMPLE LOCATION | COMPONENT | SUBSTRATE | COLOR | CONDITION | XRF RESULT MG/CM ² | |
|----------------------------------------|-------------------------------|------------------------------|-----------|---------|-----------|----------------------------------|-----|
| EXTERIOR – BUILDING B CONTINUED | | | | | | | |
| 75. | SOUTH SIDE CENTER OF WALKWAY | FLOOR | CONCRETE | WHITE | FAIR | 0.46 | LCP |
| 76. | WEST SIDE SOUTH END | ELECTRICAL BOX | METAL | GREEN | INTACT | 0.48 | LCP |
| 77. | NORTH SIDE WEST END | WINDOW | METAL | DK GREY | INTACT | 0.39 | LCP |
| 78. | NORTH SIDE CENTER | LOUVER | METAL | CREAM | INTACT | 0.07 | LCP |
| 79. | EAST SIDE | WALL | PLASTER | YELLOW | FAIR | 0.47 | LCP |
| 80. | EAST SIDE | DRINKING FOUNTAIN | PORCELAIN | WHITE | INTACT | 0.26 | LCP |
| INTERIOR – BUILDING E | | | | | | | |
| 81. | ROOM 20 – WEST SIDE | CABINETS | WOOD | GREY | FAIR | 1.69 | LBP |
| 82. | ROOM 20 – WEST SIDE | WALL ABOVE SINK | WOOD | GREY | INTACT | 2.39 | LBP |
| 83. | ROOM 20 – NORTH SIDE | WINDOW | METAL | GREY | INTACT | 0.24 | LCP |
| 84. | ROOM 21 – NORTH SIDE | WINDOW TRIM | WOOD | GREY | INTACT | 6.70 | LBP |
| 85. | ROOM 21 – NORTH SIDE | WINDOW SILL | WOOD | GREY | INTACT | 1.36 | LBP |
| 86. | ROOM 21 – NORTH SIDE | VERTICAL WINDOW SUPPORT POLE | METAL | GREY | INTACT | 1.18 | LBP |
| 87. | ROOM 18 – SOUTH SIDE WEST END | WALL | PLASTER | GREY | INTACT | 0.17 | LCP |



YES Environmental, Inc.

1201 24th Street, Suite B110-377, Bakersfield, CA 93301 / (661) 527-0820

| NO. | SAMPLE LOCATION | COMPONENT | SUBSTRATE | COLOR | CONDITION | XRF RESULT MG/CM ² | |
|----------------------------------------|-------------------------------|-------------------------------|------------------|---------|-----------|----------------------------------|-----|
| INTERIOR – BUILDING E CONTINUED | | | | | | | |
| 88. | ROOM 19 – SOUTH SIDE | DOOR TRIM | WOOD | GREY | FAIR | 0.06 | LCP |
| 89. | ROOM 19 – SOUTH SIDE | DOOR FRAME | METAL | GREY | INTACT | 0.72 | LCP |
| 90. | ROOM 20 – SOUTH SIDE | DOOR | METAL | GREY | INTACT | 0.06 | LCP |
| 91. | ROOM 18 - CENTER | T-BAR GRID | METAL | WHITE | INTACT | 0.07 | LCP |
| 92. | ROOM 18 - CENTER | CEILING TILE 2X4 | FIBROUS MATERIAL | WHITE | INTACT | 0.01 | LCP |
| 93. | WEST END GIRLS RR – CENTER | FLOOR | 2" CERAMIC TILE | GREY | INTACT | 0.03 | LCP |
| 94. | WEST END GIRLS RR – WEST WALL | WALL | 4" CERAMIC TILE | WHITE | INTACT | 0.17 | LCP |
| 95. | WEST END BOYS RR – NORTH WALL | SINK | PORCELAIN | WHITE | INTACT | 0.07 | LCP |
| 96. | WEST END BOYS RR – SOUTH WALL | TOILET | PORCELAIN | WHITE | INTACT | 0.46 | LCP |
| 97. | CUSTODIAL ROOM – WEST SIDE | CABINETS | WOOD | BLUE | FAIR | 0.22 | LCP |
| EXTERIOR – BUILDING E | | | | | | | |
| 98. | SOUTH SIDE CENTER | VERTICAL WINDOW SUPPORT POLES | METAL | DK GREY | FAIR | 1.42 | LBP |
| 99. | SOUTH SIDE AT ROOM 20 | DOOR | METAL | DK GREY | FAIR | 0.04 | LCP |



YES Environmental, Inc.

1201 24th Street, Suite B110-377, Bakersfield, CA 93301 / (661) 527-0820

| NO. | SAMPLE LOCATION | COMPONENT | SUBSTRATE | COLOR | CONDITION | XRF RESULT MG/CM ² | |
|----------------------------------------|------------------------------|-----------------------------|-----------|---------|-----------|----------------------------------|-----|
| EXTERIOR – BUILDING E CONTINUED | | | | | | | |
| 100 | SOUTH SIDE AT ROOM 21 | DOOR FRAME | METAL | DK GREY | FAIR | 0.54 | LCP |
| 101 | SOUTH SIDE AT ROOM 19 | DOOR TRIM | WOOD | DK GREY | INTACT | 1.20 | LBP |
| 102 | SOUTH SIDE AT ROOM 18 | WINDOW SILL/TRIM | WOOD | DK GREY | INTACT | 2.13 | LBP |
| 103 | NORTH SIDE CENTER | WALL | PLASTER | CREAM | FAIR | 0.33 | LCP |
| 104 | SOUTH SIDE CENTER | FIRE EXT. CABINET INFILL | WOOD | CREAM | INTACT | 0.77 | LCP |
| 105 | SOUTH SIDE EAST END | FIRE EXT. CABINET | WOOD | METAL | INTACT | 2.88 | LBP |
| 106 | SOUTH SIDE CENTER | WALL BASE | CONCRETE | CREAM | FAIR | 0.11 | LCP |
| 107 | SOUTH SIDE CENTER OF WALKWAY | FLOOR | CONCRETE | BLUE | FAIR | 1.11 | LBP |
| 108 | SOUTH SIDE CENTER OF WALKWAY | FLOOR | CONCRETE | WHITE | FAIR | 0.24 | LCP |
| 109 | NORTH SIDE EAST END | WINDOW | METAL | DK GREY | INTACT | 0.41 | LCP |
| 110 | NORTH SIDE WEST END | LOUVER | METAL | CREAM | INTACT | 0.05 | LCP |
| 111 | WEST SIDE | WALL | PLASTER | GREEN | INTACT | 0.53 | LCP |
| INTERIOR – BUILDING G | | | | | | | |
| 112 | BOOK ROOM – WEST SIDE | WALL | PLASTER | CREAM | FAIR | 0.01 | LCP |



YES Environmental, Inc.

1201 24th Street, Suite B110-377, Bakersfield, CA 93301 / (661) 527-0820

| NO. | SAMPLE LOCATION | COMPONENT | SUBSTRATE | COLOR | CONDITION | XRF RESULT MG/CM ² | |
|----------------------------------------|-------------------------|------------------------------|-----------|---------|-----------|----------------------------------|-----|
| INTERIOR – BUILDING G CONTINUED | | | | | | | |
| 113 | BOOK ROOM – CENTER | PONY WALL | WOOD | GREEN | FAIR | 0.33 | LCP |
| 114 | BOOK ROOM – CENTER | DOOR FRAME | WOOD | BLUE | FAIR | 0.08 | LCP |
| 115 | BOOK ROOM – EAST SIDE | BOOK SHELVES | WOOD | GREEN | FAIR | 0.72 | LCP |
| 116 | BOOK ROOM – CENTER | PONY WALL | DRYWALL | GREEN | FAIR | 0.05 | LCP |
| 117 | BOOK ROOM – CENTER | DOOR | METAL | BLUE | FAIR | 0.00 | LCP |
| 118 | BOOK ROOM – NORTH SIDE | WINDOW | METAL | GREY | INTACT | 0.24 | LCP |
| 119 | BOOK ROOM – NORTH SIDE | WINDOW TRIM | WOOD | GREY | INTACT | 6.70 | LBP |
| 120 | BOOK ROOM – NORTH SIDE | WINDOW SILL | WOOD | GREY | INTACT | 1.36 | LBP |
| 121 | BOOK ROOM – NORTH SIDE | VERTICAL WINDOW SUPPORT POLE | METAL | GREY | INTACT | 1.18 | LBP |
| 122 | BOOK ROOM – SOUTH ENTRY | DOOR | WOOD | DK GREY | FAIR | 0.41 | LCP |
| 123 | BOOK ROOM – SOUTH ENTRY | DOOR JAMB | WOOD | BLUE | FAIR | 8.15 | LBP |
| EXTERIOR – BUILDING G | | | | | | | |
| 124 | SOUTH SIDE EAST END | DOOR | WOOD | DK GREY | FAIR | 1.76 | LBP |
| 125 | SOUTH SIDE EAST END | DOOR FRAME | WOOD | DK GREY | FAIR | 9.97 | LBP |



YES Environmental, Inc.

1201 24th Street, Suite B110-377, Bakersfield, CA 93301 / (661) 527-0820

| NO. | SAMPLE LOCATION | COMPONENT | SUBSTRATE | COLOR | CONDITION | XRF RESULT MG/CM ² | |
|----------------------------------------|-------------------------------|-------------------------------------|-----------|---------|-----------|----------------------------------|-----|
| EXTERIOR – BUILDING G CONTINUED | | | | | | | |
| 126 | SOUTH SIDE CENTER | WALL | PLASTER | CREAM | INTACT | 0.25 | LCP |
| 127 | SOUTH SIDE CENTER | WALL BASE | CONCRETE | CREAM | FAIR | 0.97 | LCP |
| 128 | SOUTH SIDE CENTER AT WALKWAY | VERTICAL SUPPORT POLE | METAL | DK GREY | FAIR | 2.40 | LBP |
| 129 | SOUTH SIDE CENTER AT WALKWAY | FLOOR | CONCRETE | WHITE | FAIR | 0.34 | LCP |
| 130 | SOUTH SIDE CENTER AT WALKWAY | FLOOR | CONCRETE | YELLOW | FAIR | 0.29 | LCP |
| 131 | NORTH SIDE EAST END | WINDOW | METAL | DK GREY | INTACT | 0.41 | LCP |
| 132 | NORTH SIDE WEST END | LOUVER | METAL | CREAM | INTACT | 0.05 | LCP |
| 133 | SOUTH SIDE CENTER | VERTICAL WINDOW SUPPORT POLES | METAL | DK GREY | FAIR | 1.42 | LBP |
| 134 | SOUTH SIDE EAST END | WINDOW SILL/TRIM | WOOD | DK GREY | INTACT | 2.13 | LBP |
| INTERIOR – BUILDING F (MPR) | | | | | | | |
| 135 | MAIN DINING ROOM – NORTH SIDE | UPPER WALL | PLASTER | LT GREY | INTACT | 0.13 | LCP |
| 136 | MAIN DINING ROOM – NORTH SIDE | LOWER WALL | WOOD | DK GREY | INTACT | 0.22 | LCP |
| 137 | MAIN DINING ROOM – NORTH SIDE | MID-WALL TRIM | WOOD | DK GREY | INTACT | 0.08 | LCP |



YES Environmental, Inc.

1201 24th Street, Suite B110-377, Bakersfield, CA 93301 / (661) 527-0820

| NO. | SAMPLE LOCATION | COMPONENT | SUBSTRATE | COLOR | CONDITION | XRF RESULT MG/CM ² | |
|----------------------------------------------|-------------------------------|------------------------------|------------------|-------|-----------|----------------------------------|-----|
| INTERIOR – BUILDING F (MPR) CONTINUED | | | | | | | |
| 138 | MAIN DINING ROOM - CENTER | T-BAR GRID | METAL | WHITE | INTACT | 0.01 | LCP |
| 139 | MAIN DINING ROOM – CENTER | CEILING TILE 2X4 | FIBROUS MATERIAL | WHITE | INTACT | 0.07 | LCP |
| 140 | NORTH KITCHEN | CEILING | PLASTER | CREAM | INTACT | 0.01 | LCP |
| 141 | MAIN DINING ROOM – NORTH SIDE | DOOR | WOOD | CREAM | INTACT | 0.62 | LCP |
| INTERIOR – BUILDING C | | | | | | | |
| 142 | ROOM 25 – WEST SIDE | CABINETS | WOOD | GREY | FAIR | 1.70 | LBP |
| 143 | ROOM 25 – NORTH SIDE | WINDOW | METAL | GREY | INTACT | 0.19 | LCP |
| 144 | ROOM 24 – NORTH SIDE WEST END | WINDOW TRIM | WOOD | GREY | INTACT | 0.75 | LCP |
| 145 | ROOM 25 – NORTH SIDE | WINDOW SILL | WOOD | GREY | INTACT | 3.59 | LBP |
| 146 | ROOM 25 – NORTH SIDE | VERTICAL WINDOW SUPPORT POLE | METAL | GREY | INTACT | 1.66 | LBP |
| 147 | ROOM 23 – SOUTH SIDE WEST END | WALL | PLASTER | GREY | INTACT | 0.17 | LCP |
| 148 | ROOM 24 – SOUTH SIDE | DOOR | TRIM | GREY | FAIR | 1.71 | LBP |
| 149 | ROOM 24 – SOUTH SIDE | DOOR FRAME | METAL | GREY | INTACT | 0.53 | LCP |
| 150 | ROOM 24 – SOUTH SIDE | DOOR | METAL | GREY | INTACT | 0.06 | LCP |



YES Environmental, Inc.

1201 24th Street, Suite B110-377, Bakersfield, CA 93301 / (661) 527-0820

| NO. | SAMPLE LOCATION | COMPONENT | SUBSTRATE | COLOR | CONDITION | XRF RESULT MG/CM ² | |
|----------------------------------------|----------------------------|------------------------|------------------|---------|-----------|----------------------------------|-----|
| INTERIOR – BUILDING C CONTINUED | | | | | | | |
| 151 | ROOM K2 – CENTER | T-BAR GRID | METAL | WHITE | INTACT | 0.02 | LCP |
| 152 | ROOM K2 - CENTER | CEILING TILE 2X4 | FIBROUS MATERIAL | WHITE | INTACT | 0.04 | LCP |
| 153 | K2B - CENTER | FLOOR | 2" CERAMIC TILE | GREY | INTACT | 0.09 | LCP |
| 154 | K2B – EAST SIDE | WALL | 4" CERAMIC TILE | WHITE | INTACT | 0.07 | LCP |
| 155 | K1B – RR | SINK | PORCELAIN | WHITE | INTACT | 0.30 | LCP |
| 156 | K1B – RR | TOILET | PORCELAIN | WHITE | INTACT | 0.90 | LCP |
| 157 | K2B – SE STORAGE ROOM | DOOR FRAME | WOOD | GREY | FAIR | 0.62 | LCP |
| 158 | K1 – EAST SIDE | DOOR | WOOD | GREY | FAIR | 0.14 | LCP |
| EXTERIOR – BUILDING C | | | | | | | |
| 159 | SOUTH SIDE COVERED WALKWAY | VERTICAL SUPPORT POLES | METAL | DK GREY | FAIR | 2.61 | LBP |
| 160 | SOUTH ROOM K1 | DOOR | METAL | DK GREY | FAIR | 0.02 | LCP |
| 161 | SOUTH SIDE ROOM K2 | DOOR FRAME | METAL | DK GREY | FAIR | 0.40 | LCP |
| 162 | SOUTH SIDE ROOM 23 | DOOR TRIM | WOOD | DK GREY | INTACT | 0.22 | LCP |
| 163 | NORTH SIDE CENTER | WINDOW SILL/TRIM | WOOD | DK GREY | INTACT | 3.98 | LBP |

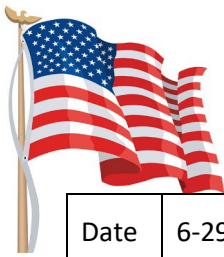

YES Environmental, Inc.

1201 24th Street, Suite B110-377, Bakersfield, CA 93301 / (661) 527-0820

| NO. | SAMPLE LOCATION | COMPONENT | SUBSTRATE | COLOR | CONDITION | XRF RESULT MG/CM ² | |
|-----------------------------------------------|----------------------------|-----------------------------|---------------------|---------|-----------|----------------------------------|-----|
| EXTERIOR – BUILDING C CONTINUED | | | | | | | |
| 164 | SOUTH SIDE CENTER | WALL | PLASTER | CREAM | FAIR | 0.36 | LCP |
| 165 | SOUTH SIDE EAST END | FIRE EXT. CABINET INFILL | WOOD | CREAM | INTACT | 0.24 | LCP |
| 166 | SOUTH SIDE EAST END | FIRE EXT. CABINET | WOOD | METAL | INTACT | 1.18 | LBP |
| 167 | NORTH SIDE WEST END | WALL BASE | CONCRETE | CREAM | FAIR | 0.47 | LCP |
| 168 | SOUTH SIDE COVERED WALKWAY | FLOOR | CONCRETE | BLUE | FAIR | 0.50 | LCP |
| 169 | SOUTH SIDE COVERED WALKWAY | FLOOR | CONCRETE | WHITE | FAIR | 0.72 | LCP |
| 170 | SOUTH SIDE ROOM 25 | WINDOW | METAL | DK GREY | INTACT | 0.43 | LCP |
| 171 | NORTH SIDE EAST END | LOUVER | METAL | CREAM | INTACT | 0.05 | LCP |
| 172 | NORTH SIDE CENTER | WALL | PLASTER | CREAM | FAIR | 0.39 | LCP |
| INTERIOR - R1-R10 (CRs 26-34 & RR) | | | | | | | |
| 173 | ROOM 26 – CENTER | CEILING TILE 2'X4 | FIBROUS MATERIAL | WHITE | INTACT | 0.03 | LCP |
| 174 | ROOM 30 – WEST SIDE | WALL | DRYWALL | YELLOW | INTACT | 0.04 | LCP |
| 175 | ROOM 33 – CENTER | CEILING TILE 2'X4 | FIBROUS MATERIAL | WHITE | INTACT | 0.02 | LCP |
| 176 | ROOM 29 – EAST SIDE | WALL | DRYWALL | YELLOW | INTACT | 0.06 | LCP |



YES Environmental, Inc.

1201 24th Street, Suite B110-377, Bakersfield, CA 93301 / (661) 527-0820

| NO. | SAMPLE LOCATION | COMPONENT | SUBSTRATE | COLOR | CONDITION | XRF RESULT MG/CM ² | | |
|-----------------------------------------------|-----------------------------|-------------------|------------------|-----------------------|-------------|----------------------------------|-------------|-------------------------------------------------------|
| Date | 6-29-2023 | Start Time | 12:00 pm | Beginning Calibration | 1.04 = 1.00 | 1.04 = 1.09 | 1.04 = 1.12 | Lead-Containing Paint (LCP) or Lead-Based Paint (LBP) |
| Date | 6-29-2023 | End Time | 4:00 pm | Ending Calibration | 1.04 = 1.18 | 1.04 = 1.16 | 1.04 = 1.06 | |
| EXTERIOR - R1-R10 (CRs 26-34 & RR) | | | | | | | | |
| 177 | EAST SIDE AT CR 27 | WALL | STUCCO | CREAM | INTACT | 0.01 | LCP | |
| 178 | EAST SIDE AT CR 32 | WALL | STUCCO | CREAM | INTACT | 0.02 | LCP | |
| INTERIOR – R18 (CR K3) & R19 (K4) | | | | | | | | |
| 179 | R18 - NORTH SIDE CENTER | CEILING TILE 2’X4 | FIBROUS MATERIAL | WHITE | INTACT | 0.00 | LCP | |
| EXTERIOR - R18 (CR K3) & R19 (K4) | | | | | | | | |
| 180 | R19 - NORTH SIDE CENTER | WALL | WOOD | CREAM | INTACT | 0.01 | LCP | |
| INTERIOR – R17 (RR BLDG) | | | | | | | | |
| 181 | NO PAINTED MATERIALS INSIDE | | | | | | | |
| EXTERIOR – R17 (RR BLDG) | | | | | | | | |
| 182 | WEST SIDE CENTER | WALL | WOOD | CREAM | INTACT | 0.01 | LCP | |
| INTERIOR – R11 (PRE K) | | | | | | | | |
| 183 | CENTER OF ROOM | CEILING TILE 2’X4 | FIBROUS MATERIAL | WHITE | INTACT | 0.03 | LCP | |
| EXTERIOR – R11 (PRE K) | | | | | | | | |
| 184 | WEST SIDE NORTH END | WALL | WOOD | CREAM | INTACT | 0.09 | LCP | |



YES Environmental, Inc.

1201 24th Street, Suite B110-377, Bakersfield, CA 93301 / (661) 527-0820

| NO. | SAMPLE LOCATION | COMPONENT | SUBSTRATE | COLOR | CONDITION | XRF RESULT MG/CM ² | | |
|--------------------------------------------|-------------------|-------------------|------------------|-----------------------|-------------|----------------------------------|-------------|-------------------------------------------------------|
| Date | 6-29-2023 | Start Time | 12:00 pm | Beginning Calibration | 1.04 = 1.00 | 1.04 = 1.09 | 1.04 = 1.12 | Lead-Containing Paint (LCP) or Lead-Based Paint (LBP) |
| Date | 6-29-2023 | End Time | 4:00 pm | Ending Calibration | 1.04 = 1.18 | 1.04 = 1.16 | 1.04 = 1.06 | |
| INTERIOR – R13 (R35) & R14 (36) | | | | | | | | |
| 185 | CENTER OF ROOM | CEILING TILE 2'X4 | FIBROUS MATERIAL | WHITE | INTACT | 0.03 | LCP | |
| EXTERIOR - R13 (R35) & R14 (36) | | | | | | | | |
| 186 | EAST SIDE CENTER | WALL | WOOD | TAN | INTACT | 0.11 | LCP | |
| INTERIOR – R15 (R37) | | | | | | | | |
| 187 | CENTER OF ROOM | CEILING TILE 2'X4 | FIBROUS MATERIAL | WHITE | INTACT | 0.03 | LCP | |
| EXTERIOR - R15 (R37) | | | | | | | | |
| 188 | EAST SIDE CENTER | WALL | WOOD | TAN | INTACT | 0.07 | LCP | |
| INTERIOR – R16 (38) | | | | | | | | |
| 189 | CENTER OF CEILING | CEILING TILE 2'X4 | FIBROUS MATERIAL | WHITE | INTACT | 0.00 | LCP | |
| EXTERIOR - R16 (38) | | | | | | | | |
| 190 | WEST SIDE CENTER | WALL | WOOD | TAN | INTACT | 0.09 | LCP | |
| INTERIOR – R12 (RR BLDG) | | | | | | | | |
| 191 | CENTER OF CEILING | CEILING TILE 2'X4 | FIBROUS MATERIAL | WHITE | INTACT | 0.00 | LCP | |
| ROW INTENTIONALLY LEFT BLANK | | | | | | | | |



YES Environmental, Inc.

1201 24th Street, Suite B110-377, Bakersfield, CA 93301 / (661) 527-0820

| Date | 6-29-2023 | Start Time | 12:00 pm | Beginning Calibration | 1.04 = | 1.00 | 1.04 = | 1.09 | 1.04 = | 1.12 | Lead-Containing Paint (LCP) or Lead-Based Paint (LBP) |
|---------------------------------|---------------------------------|------------|----------|-----------------------|------------------|-------|-----------|----------------------------------|--------|------|-------------------------------------------------------|
| Date | 6-29-2023 | End Time | 4:00 pm | Ending Calibration | 1.04 = | 1.18 | 1.04 = | 1.16 | 1.04 = | 1.06 | |
| NO. | SAMPLE LOCATION | | | COMPONENT | SUBSTRATE | COLOR | CONDITION | XRF RESULT MG/CM ² | | | |
| EXTERIOR - R12 (RR BLDG) | | | | | | | | | | | |
| 192 | WEST SIDE CENTER | | | WALL | WOOD | TAN | INTACT | 0.05 | | LCP | |
| INTERIOR – BUILDING A | | | | | | | | | | | |
| 193 | SOUTH VP OFFICE – CENTER | | | CEILING TILE 2X4 | FIBROUS MATERIAL | WHITE | INTACT | 0.00 | | LCP | |
| 194 | WEST OFFICE – CENTER OF CEILING | | | CEILING TILE 12” | FIBROUS MATERIAL | WHITE | FAIR | 0.02 | | LCP | |
| 195 | FRONT OFFICE – NORTH SIDE | | | WALL | PLASTER | CREAM | INTACT | 0.17 | | LCP | |



YES Environmental, Inc.

1201 24th Street, Suite B110-377, Bakersfield, CA 93301 / (661) 527-0820

Client: Bakersfield City School District

Site: Wayside ES

YES Project No.: 23YES-05

Date of Inspection: 6/27/2023

Inspection Report

Building: Campus Wide

| Component | HMR # | Sample # | Material Description | Substrate | ACM Y/N | Friable Y/N |
|-----------|-------|----------|----------------------|-----------|------------|----------------|
| Ground | 38 | 38A-B | Asphalt | | N | n/a |

Building: Covered Walkways Throughout Campus

| Component | HMR # | Sample # | Material Description | Substrate | ACM Y/N | Friable Y/N |
|-----------|-------|----------|------------------------------------------------------------------------------------------------------|--------------------|------------|----------------|
| Ground | 38 | | Asphalt | | N | n/a |
| Ground | - | | Concrete - bare & exposed | | n/a | n/a |
| Ceilings | 35 | | Exterior stucco, painted | | N | n/a |
| Roof | 36 | | White coated foam on silver paint on rolled composition roofing | Diagonal sheathing | Y | N |
| | NOTE | | Foam=ND; Silver Paint=2-4% CH; Rolled Composition Roofing & Felts=ND | | | |
| Roof | 37 | | White coated foam on silver paint on penetration mastic | | Y | N |
| | NOTE | | Foam=ND; Silver Paint=2-4% CH; Mastics=Assumed | | | |
| | NOTE | | On components such as, but not limited to, roof jacks, roof vents, conduits, sleepers, patches, etc. | | | |

RED=contains asbestos

BLACK=no asbestos detected or non-suspect



YES Environmental, Inc.

1201 24th Street, Suite B110-377, Bakersfield, CA 93301 / (661) 527-0820

Client: Bakersfield City School District

Site: Wayside ES

YES Project No.: 23YES-05

Date of Inspection: 6/27/2023

Inspection Report

| | | | |
|------------------|--------------|-------------------|--------------|
| Building: | Chiller Yard | Room Name: | Chiller Yard |
|------------------|--------------|-------------------|--------------|

| Component | HMR # | Sample # | Material Description | Substrate | ACM Y/N | Friable Y/N |
|-----------|-------|----------|-------------------------------------------|-----------|------------|----------------|
| Ground | - | | Concrete - bare & exposed | | n/a | n/a |
| Walls | - | | CMU | | n/a | n/a |
| Pipes | 47 | 47A-C | Paper jacketed fiberglass pipe insulation | | N | n/a |
| | NOTE | | Mostly concealed behind metal jacketing | | | |

RED=contains asbestos

BLACK=no asbestos detected or non-suspect



YES Environmental, Inc.

1201 24th Street, Suite B110-377, Bakersfield, CA 93301 / (661) 527-0820

Client: Bakersfield City School District

Site: Wayside ES

YES Project No.: 23YES-05

Date of Inspection: 6/27/2023

Inspection Report

| | | | |
|-------------------------------------------------------------------------------------------------------------------------------------------------------------------------------------------------------------------------------------------------------------------------------------------------------------------------------------------------------------------------------------|-----------------------------|-------------------|-------|
| Building: | Building A - Classrooms 1-5 | Room Name: | Attic |
| <p>Attic is defined as: every enclosed spaced that is contiguous and/or beneath the roof, attic, void, and plenum space above every room in this building including, but not limited to, exterior enclosed eaves, enclosed hallways, walkways, corridors, wall cavities, etc. and all spaces beneath the roof and above ceilings that are or are not readily accessible.</p> | | | |
| <p>Attic Floor is defined as: the surface within an attic space, serving as the ceiling for the room(s) below and/or an area with exposed joists. It is not a term that can be used to infer a walkable surface.</p> | | | |

| Component | HMR # | Sample # | Material Description | Substrate | ACM Y/N | Friable Y/N |
|--------------------|-------|----------|---------------------------------------------------------------------------------------------------------------------|-----------|------------|----------------|
| Attic Floor | 26 | | Roofing debris with silver paint | | Y | Y |
| | NOTE | | Silver Paint=3% CH; Other various roof material=ND material exists on and inbetween the floor joists of this space. | This | | |
| Attic Floor | - | | Fiberglass batt insulation | | Y | Y |
| | NOTE | | Contaminated with asbestos roofing debris | | | |
| Walls | - | | Wood | | n/a | n/a |
| Flue Pipes | | | Transite flue pipes - Known Asbestos Material (typically 10-20% Chrysotile) | | Y | N |
| Ceiling | - | | Diagonal sheathing | | n/a | n/a |

RED=contains asbestos

BLACK=no asbestos detected or non-suspect



YES Environmental, Inc.

1201 24th Street, Suite B110-377, Bakersfield, CA 93301 / (661) 527-0820

| | | | | | |
|------------------|-----------------------------|-------------------------|------------------|---------------------------|-----|
| Building: | Building A - Classrooms 1-5 | Room Name: | Classroom 1 | Rm Ft²: | 960 |
| | | Room Dimensions: | L=32 W=30 H=9/12 | | |

| Component | HMR # | Sample # | Material Description | Substrate | ACM Y/N | Friable Y/N |
|-----------|-------|----------|----------------------------------------------------------|----------------------|------------|----------------|
| Floor | 1 | | Carpet & glue - grey/green/multi | Concrete | N | n/a |
| Floor | 2 | | Carpet & glue - black/white speckled | Concrete | N | n/a |
| BB | 3 | 03B | Baseboard & glue 3" & 4" blue | wood | N | n/a |
| BB | - | | Wood baseboard | | n/a | n/a |
| Walls | 4 | 04A | Plaster - sanded finish | | N | n/a |
| Walls | 5 | 05A | Tackboards & glue | Plaster | N | n/a |
| Sink | 6 | 06D | Sink coating - black (stainless steel) | | N | n/a |
| Ceiling | 7 | 07A | Lay-in panels - 2' x 4' gouge pinhole | ACM Roofing debris | N | n/a |
| Ceiling | 26 | | Roofing debris with silver paint | F/G insulation | Y | Y |
| | NOTE | | Silver Paint=3% CH; Other various roof material=ND | | | |
| Ceiling | - | | Fiberglass insulation | ACM Roofing debris | n/a | n/a |
| Ceiling | 26 | | Roofing debris with silver paint | 12" ACT | Y | Y |
| | NOTE | | Silver Paint=3% CH; Other various roof material=ND | | | |
| Ceiling | 8 | | Acoustic ceiling tiles 12" uniform hole pattern (nailed) | wood slat | N | n/a |
| Ceiling | - | | Wood slats | ACM Roofing debris | n/a | n/a |
| Ceiling | 26 | | Roofing debris with silver paint | Wool batt insulation | Y | Y |
| | NOTE | | Silver Paint=3% CH; Other various roof material=ND | | | |
| Ceiling | 24 | | Wool-batt insulation glued (black) to paper backing | diagonal sheathing | N | n/a |

RED=contains asbestos

BLACK=no asbestos detected or non-suspect



YES Environmental, Inc.

1201 24th Street, Suite B110-377, Bakersfield, CA 93301 / (661) 527-0820

| | | | | | |
|------------------|-----------------------------|-------------------------|------------------|---------------------------|-----|
| Building: | Building A - Classrooms 1-5 | Room Name: | Classroom 2 | Rm Ft²: | 960 |
| | | Room Dimensions: | L=32 W=30 H=9/12 | | |

| Component | HMR # | Sample # | Material Description | Substrate | ACM Y/N | Friable Y/N |
|-----------|-------|----------|----------------------------------------------------------|----------------------|------------|----------------|
| Floor | 1 | 01B | Carpet & glue - grey/green/multi | Concrete | N | n/a |
| Floor | 2 | | Carpet & glue - black/white speckled | Concrete | N | n/a |
| BB | 3 | | Baseboard & glue 3" & 4" blue | wood | N | n/a |
| BB | - | | Wood baseboard | | n/a | n/a |
| Walls | 4 | | Plaster - sanded finish | | N | n/a |
| Walls | 5 | | Tackboards & glue | Plaster | N | n/a |
| Sink | 6 | | Sink coating - black (stainless steel) | | N | n/a |
| Ceiling | 7 | | Lay-in panels - 2' x 4' gouge pinhole | ACM Roofing debris | N | n/a |
| Ceiling | 26 | | Roofing debris with silver paint | F/G insulation | Y | Y |
| | NOTE | | Silver Paint=3% CH; Other various roof material=ND | | | |
| Ceiling | - | | Fiberglass insulation | ACM Roofing debris | n/a | n/a |
| Ceiling | 26 | | Roofing debris with silver paint | 12" ACT | Y | Y |
| | NOTE | | Silver Paint=3% CH; Other various roof material=ND | | | |
| Ceiling | 8 | 08D | Acoustic ceiling tiles 12" uniform hole pattern (nailed) | wood slat | N | n/a |
| Ceiling | - | | Wood slats | ACM Roofing debris | n/a | n/a |
| Ceiling | 26 | | Roofing debris with silver paint | Wool batt insulation | Y | Y |
| | NOTE | | Silver Paint=3% CH; Other various roof material=ND | | | |
| Ceiling | 24 | | Wool-batt insulation glued (black) to paper backing | diagonal sheathing | N | n/a |

RED=contains asbestos

BLACK=no asbestos detected or non-suspect



YES Environmental, Inc.

1201 24th Street, Suite B110-377, Bakersfield, CA 93301 / (661) 527-0820

| | | | | | |
|------------------|-----------------------------|-------------------------|------------------|---------------------------|-----|
| Building: | Building A - Classrooms 1-5 | Room Name: | Classroom 3 | Rm Ft²: | 960 |
| | | Room Dimensions: | L=32 W=30 H=9/12 | | |

| Component | HMR # | Sample # | Material Description | Substrate | ACM Y/N | Friable Y/N |
|-----------|-------|----------|----------------------------------------------------------|----------------------|------------|----------------|
| Floor | 1 | | Carpet & glue - grey/green/multi | Concrete | N | n/a |
| Floor | 2 | 02A | Carpet & glue - black/white speckled | Concrete | N | n/a |
| BB | 3 | 03C | Baseboard & glue 3" & 4" blue | wood | N | n/a |
| BB | - | | Wood baseboard | | n/a | n/a |
| Walls | 4 | 04I | Plaster - sanded finish | | N | n/a |
| Walls | 5 | | Tackboards & glue | Plaster | N | n/a |
| Sink | 6 | | Sink coating - black (stainless steel) | | N | n/a |
| Ceiling | 7 | 07C | Lay-in panels - 2' x 4' gouge pinhole | ACM Roofing debris | N | n/a |
| Ceiling | 26 | | Roofing debris with silver paint | F/G insulation | Y | Y |
| | NOTE | | Silver Paint=3% CH; Other various roof material=ND | | | |
| Ceiling | - | | Fiberglass insulation | ACM Roofing debris | n/a | n/a |
| Ceiling | 26 | | Roofing debris with silver paint | 12" ACT | Y | Y |
| | NOTE | | Silver Paint=3% CH; Other various roof material=ND | | | |
| Ceiling | 8 | | Acoustic ceiling tiles 12" uniform hole pattern (nailed) | wood slat | N | n/a |
| Ceiling | - | | Wood slats | ACM Roofing debris | n/a | n/a |
| Ceiling | 26 | | Roofing debris with silver paint | Wool batt insulation | Y | Y |
| | NOTE | | Silver Paint=3% CH; Other various roof material=ND | | | |
| Ceiling | 24 | | Wool-batt insulation glued (black) to paper backing | diagonal sheathing | N | n/a |

RED=contains asbestos

BLACK=no asbestos detected or non-suspect



YES Environmental, Inc.

1201 24th Street, Suite B110-377, Bakersfield, CA 93301 / (661) 527-0820

| | | | | | |
|------------------|-----------------------------|-------------------------|------------------|---------------------------|-----|
| Building: | Building A - Classrooms 1-5 | Room Name: | Classroom 4 | Rm Ft²: | 960 |
| | | Room Dimensions: | L=32 W=30 H=9/12 | | |

| Component | HMR # | Sample # | Material Description | Substrate | ACM Y/N | Friable Y/N |
|-----------|-------|----------|----------------------------------------------------------|----------------------|------------|----------------|
| Floor | 1 | | Carpet & glue - grey/green/multi | Concrete | N | n/a |
| Floor | 2 | | Carpet & glue - black/white speckled | Concrete | N | n/a |
| BB | 3 | | Baseboard & glue 3" & 4" blue | wood | N | n/a |
| BB | - | | Wood baseboard | | n/a | n/a |
| Walls | 4 | | Plaster - sanded finish | | N | n/a |
| Walls | 5 | | Tackboards & glue | Plaster | N | n/a |
| Sink | 6 | | Sink coating - black (stainless steel) | | N | n/a |
| Ceiling | 7 | | Lay-in panels - 2' x 4' gouge pinhole | ACM Roofing debris | N | n/a |
| Ceiling | 26 | | Roofing debris with silver paint | F/G insulation | Y | Y |
| | NOTE | | Silver Paint=3% CH; Other various roof material=ND | | | |
| Ceiling | - | | Fiberglass insulation | ACM Roofing debris | n/a | n/a |
| Ceiling | 26 | | Roofing debris with silver paint | 12" ACT | Y | Y |
| | NOTE | | Silver Paint=3% CH; Other various roof material=ND | | | |
| Ceiling | 8 | 08A | Acoustic ceiling tiles 12" uniform hole pattern (nailed) | wood slat | N | n/a |
| Ceiling | - | | Wood slats | ACM Roofing debris | n/a | n/a |
| Ceiling | 26 | | Roofing debris with silver paint | Wool batt insulation | Y | Y |
| | NOTE | | Silver Paint=3% CH; Other various roof material=ND | | | |
| Ceiling | 24 | | Wool-batt insulation glued (black) to paper backing | diagonal sheathing | N | n/a |

RED=contains asbestos

BLACK=no asbestos detected or non-suspect



YES Environmental, Inc.

1201 24th Street, Suite B110-377, Bakersfield, CA 93301 / (661) 527-0820

| | | | | | |
|------------------|-----------------------------|-------------------------|------------------|---------------------------|-----|
| Building: | Building A - Classrooms 1-5 | Room Name: | Classroom 5 | Rm Ft²: | 960 |
| | | Room Dimensions: | L=32 W=30 H=9/12 | | |

| Component | HMR # | Sample # | Material Description | Substrate | ACM Y/N | Friable Y/N |
|-----------|-------|----------|----------------------------------------------------------|----------------------|------------|----------------|
| Floor | 1 | | Carpet & glue - grey/green/multi | Concrete | N | n/a |
| Floor | 2 | | Carpet & glue - black/white speckled | Concrete | N | n/a |
| BB | 3 | | Baseboard & glue 3" & 4" blue | wood | N | n/a |
| BB | - | | Wood baseboard | | n/a | n/a |
| Walls | 4 | | Plaster - sanded finish | | N | n/a |
| Walls | 5 | | Tackboards & glue | Plaster | N | n/a |
| Sink | 6 | | Sink coating - black (stainless steel) | | N | n/a |
| Ceiling | 7 | | Lay-in panels - 2' x 4' gouge pinhole | ACM Roofing debris | N | n/a |
| Ceiling | 26 | | Roofing debris with silver paint | F/G insulation | Y | Y |
| | NOTE | | Silver Paint=3% CH; Other various roof material=ND | | | |
| Ceiling | - | | Fiberglass insulation | ACM Roofing debris | n/a | n/a |
| Ceiling | 26 | | Roofing debris with silver paint | 12" ACT | Y | Y |
| | NOTE | | Silver Paint=3% CH; Other various roof material=ND | | | |
| Ceiling | 8 | | Acoustic ceiling tiles 12" uniform hole pattern (nailed) | wood slat | N | n/a |
| Ceiling | - | | Wood slats | ACM Roofing debris | n/a | n/a |
| Ceiling | 26 | | Roofing debris with silver paint | Wool batt insulation | Y | Y |
| | NOTE | | Silver Paint=3% CH; Other various roof material=ND | | | |
| Ceiling | 24 | | Wool-batt insulation glued (black) to paper backing | diagonal sheathing | N | n/a |

RED=contains asbestos

BLACK=no asbestos detected or non-suspect



YES Environmental, Inc.

1201 24th Street, Suite B110-377, Bakersfield, CA 93301 / (661) 527-0820

| | | |
|---------------------------------------------------------------------------------|---------------------------------------|-------------------------------|
| Building: Building A - Classrooms 1-5 East of Rm 5 & West of Girls RR | Room Name: Speech Room | Rm Ft²: 208 |
| | Room Dimensions: L=13 W=16 H=9 | |

| Component | HMR # | Sample # | Material Description | Substrate | ACM Y/N | Friable Y/N |
|-----------|-------|----------|----------------------------------------------------|--------------------|------------|----------------|
| Floor | 1 | | Carpet & glue - grey/green/multi | Concrete | N | n/a |
| Floor | 2 | | Carpet & glue - black/white speckled | Concrete | N | n/a |
| BB | 3 | | Baseboard & glue 3" & 4" blue | wood | N | n/a |
| Walls | 4 | | Plaster - sanded finish | | N | n/a |
| Ceiling | 4 | | Plaster - sanded finish | ACM Roofing debris | N | n/a |
| Ceiling | 26 | | Roofing debris with silver paint | | Y | Y |
| | NOTE | | Silver Paint=3% CH; Other various roof material=ND | | | |

| | | |
|--------------------------------------------------------------|--------------------------------------|-------------------------------|
| Building: Building A - Classrooms 1-5 East of Rm 5 | Room Name: Girls' Restroom | Rm Ft²: 352 |
| | Room Dimensions: L=22 W=16 H= | |

| Component | HMR # | Sample # | Material Description | Substrate | ACM Y/N | Friable Y/N |
|-----------|-------|----------|----------------------------------------------------|--------------------|------------|----------------|
| Floor | 9 | 09B | Ceramic floor tile grout (2" grey) | | N | n/a |
| BB | | | None | | | |
| Walls | 10 | 10B-C | Ceramic wall tile grout - blue (4" white) | Plaster | N | n/a |
| | NOTE | | AFF 6' | | | |
| Walls | 4 | 04J | Plaster - sanded finish | | N | n/a |
| Ceiling | 4 | | Plaster - sanded finish | ACM Roofing debris | N | n/a |
| Ceiling | 26 | | Roofing debris with silver paint | | Y | Y |
| | NOTE | | Silver Paint=3% CH; Other various roof material=ND | | | |

RED=contains asbestos

BLACK=no asbestos detected or non-suspect



YES Environmental, Inc.

1201 24th Street, Suite B110-377, Bakersfield, CA 93301 / (661) 527-0820

| | | |
|--------------------------------------------------------------|----------------------------------|-------------------------------|
| Building: Building A - Classrooms 1-5 East of Rm 5 | Room Name: Boys' Restroom | Rm Ft²: 352 |
| Room Dimensions: L=22 W=16 H= | | |

| Component | HMR # | Sample # | Material Description | Substrate | ACM Y/N | Friable Y/N |
|-----------|-------|----------|----------------------------------------------------|--------------------|------------|----------------|
| Floor | 9 | | Ceramic floor tile grout (2" grey) | | N | n/a |
| BB | | | None | | | |
| Walls | 10 | | Ceramic wall tile grout - blue (4" white) | Plaster | N | n/a |
| | NOTE | | AFF 6' | | | |
| Walls | 4 | | Plaster - sanded finish | | N | n/a |
| Ceiling | 4 | | Plaster - sanded finish | ACM Roofing debris | N | n/a |
| Ceiling | 26 | | Roofing debris with silver paint | | Y | Y |
| | NOTE | | Silver Paint=3% CH; Other various roof material=ND | | | |

| | | |
|-----------------------------------------------------------------------------------|-----------------------------------|-------------------------------|
| Building: Building A - Classrooms 1-5 East of Rm 5 - north side of bldg | Room Name: North Ball Room | Rm Ft²: 208 |
| Room Dimensions: L=16 W=13 H=12 | | |

| Component | HMR # | Sample # | Material Description | Substrate | ACM Y/N | Friable Y/N |
|-----------|-------|----------|----------------------------------------------|-----------|------------|----------------|
| Floor | - | | Concrete - bare & exposed | | n/a | n/a |
| BB | - | | Wood | | n/a | n/a |
| Walls | - | | Plywod on lower 4' of walls | | n/a | n/a |
| Walls | 4 | | Plaster - sanded finish | | N | n/a |
| Ceiling | - | | Plywood - painted | | n/a | n/a |
| Door | 11 | | Fire Door - label painted over | | Y | Y |
| | NOTE | | Assumed. Test before disturbing or removing. | | | |

RED=contains asbestos

BLACK=no asbestos detected or non-suspect



YES Environmental, Inc.

1201 24th Street, Suite B110-377, Bakersfield, CA 93301 / (661) 527-0820

| | | | |
|------------------|-----------------------------|-------------------|----------|
| Building: | Building A - Classrooms 1-5 | Room Name: | Exterior |
|------------------|-----------------------------|-------------------|----------|

| Component | HMR # | Sample # | Material Description | Substrate | ACM Y/N | Friable Y/N |
|-----------|-------|----------|------------------------------------------------------------------------------------------------------|--------------------|------------|----------------|
| Ground | 38 | 38A | Asphalt | | N | n/a |
| Ground | - | | Concrete - bare & exposed | | n/a | n/a |
| Walls | 35 | 35A,G | Exterior stucco, painted & vapor barrier | | N | n/a |
| Windows | 28 | 28A-B | Exterior window putty | | N | n/a |
| Eaves | 35 | | Exterior stucco, painted | | N | n/a |
| Roof | 36 | 36A | White coated foam on silver paint on rolled composition roofing | Diagonal sheathing | Y | N |
| | NOTE | | Foam=ND; Silver Paint=2-4% CH; Rolled Composition Roofing & Felts=ND | | | |
| Roof | 37 | | White coated foam on silver paint on penetration mastic | | Y | N |
| | NOTE | | Foam=ND; Silver Paint=2-4% CH; Mastics=Assumed | | | |
| | NOTE | | On components such as, but not limited to, roof jacks, roof vents, conduits, sleepers, patches, etc. | | | |

RED=contains asbestos

BLACK=no asbestos detected or non-suspect



YES Environmental, Inc.

1201 24th Street, Suite B110-377, Bakersfield, CA 93301 / (661) 527-0820

Client: Bakersfield City School District

Site: Wayside ES

YES Project No.: 23YES-05

Date of Inspection: 6/27/2023

Inspection Report

| | | | |
|-------------------------------------------------------------------------------------------------------------------------------------------------------------------------------------------------------------------------------------------------------------------------------------------------------------------------------------------------------------------------------------|-------------------------------|-------------------|-------|
| Building: | Building B - Classrooms 12-16 | Room Name: | Attic |
| <p>Attic is defined as: every enclosed spaced that is contiguous and/or beneath the roof, attic, void, and plenum space above every room in this building including, but not limited to, exterior enclosed eaves, enclosed hallways, walkways, corridors, wall cavities, etc. and all spaces beneath the roof and above ceilings that are or are not readily accessible.</p> | | | |
| <p>Attic Floor is defined as: the surface within an attic space, serving as the ceiling for the room(s) below and/or an area with exposed joists. It is not a term that can be used to infer a walkable surface.</p> | | | |

| Component | HMR # | Sample # | Material Description | Substrate | ACM Y/N | Friable Y/N |
|--------------------|-------|----------|---------------------------------------------------------------------------------------------------------------------|-----------|------------|----------------|
| Attic Floor | 26 | | Roofing debris with silver paint | | Y | Y |
| | NOTE | | Silver Paint=3% CH; Other various roof material=ND material exists on and inbetween the floor joists of this space. | This | | |
| Attic Floor | - | | Fiberglass batt insulation | | Y | Y |
| | NOTE | | Contaminated with asbestos roofing debris | | | |
| Walls | - | | Wood | | n/a | n/a |
| Flue Pipes | | | Transite flue pipes - Known Asbestos Material (typically 10-20% Chrysotile) | | Y | N |
| Ceiling | - | | Diagonal sheathing | | n/a | n/a |

RED=contains asbestos

BLACK=no asbestos detected or non-suspect



YES Environmental, Inc.

1201 24th Street, Suite B110-377, Bakersfield, CA 93301 / (661) 527-0820

| | | | | | |
|------------------|-------------------------------|-------------------------|------------------|---------------------------|-----|
| Building: | Building B - Classrooms 12-16 | Room Name: | Classroom 12 | Rm Ft²: | 960 |
| | | Room Dimensions: | L=32 W=30 H=9/12 | | |

| Component | HMR # | Sample # | Material Description | Substrate | ACM Y/N | Friable Y/N |
|-----------|-------|----------|----------------------------------------------------------|----------------------|------------|----------------|
| Floor | 1 | | Carpet & glue - grey/green/multi | Concrete | N | n/a |
| Floor | 2 | | Carpet & glue - black/white speckled | Concrete | N | n/a |
| BB | 12 | 12B | Baseboard & glue - 4" lt green | wood | N | n/a |
| BB | - | | Wood baseboard | | n/a | n/a |
| Walls | 4 | | Plaster - sanded finish | | N | n/a |
| Walls | 5 | | Tackboards & glue | Plaster | N | n/a |
| Sink | 6 | | Sink coating - black (stainless steel) | | N | n/a |
| Ceiling | 7 | | Lay-in panels - 2' x 4' gouge pinhole | ACM Roofing debris | N | n/a |
| Ceiling | 26 | | Roofing debris with silver paint | F/G insulation | Y | Y |
| | NOTE | | Silver Paint=3% CH; Other various roof material=ND | | | |
| Ceiling | - | | Fiberglass insulation | ACM Roofing debris | n/a | n/a |
| Ceiling | 26 | | Roofing debris with silver paint | 12" ACT | Y | Y |
| | NOTE | | Silver Paint=3% CH; Other various roof material=ND | | | |
| Ceiling | 8 | O8F | Acoustic ceiling tiles 12" uniform hole pattern (nailed) | wood slat | N | n/a |
| Ceiling | - | | Wood slats | ACM Roofing debris | n/a | n/a |
| Ceiling | 26 | | Roofing debris with silver paint | Wool batt insulation | Y | Y |
| | NOTE | | Silver Paint=3% CH; Other various roof material=ND | | | |
| Ceiling | 24 | | Wool-batt insulation glued (black) to paper backing | diagonal sheathing | N | n/a |

RED=contains asbestos

BLACK=no asbestos detected or non-suspect



YES Environmental, Inc.

1201 24th Street, Suite B110-377, Bakersfield, CA 93301 / (661) 527-0820

| | | | | | |
|------------------|-------------------------------|-------------------------|------------------|---------------------------|-----|
| Building: | Building B - Classrooms 12-16 | Room Name: | Classroom 13 | Rm Ft²: | 960 |
| | | Room Dimensions: | L=32 W=30 H=9/12 | | |

| Component | HMR # | Sample # | Material Description | Substrate | ACM Y/N | Friable Y/N |
|-----------|-------|----------|----------------------------------------------------------|----------------------|------------|----------------|
| Floor | 1 | | Carpet & glue - grey/green/multi | Concrete | N | n/a |
| Floor | 2 | | Carpet & glue - black/white speckled | Concrete | N | n/a |
| BB | 3 | | Baseboard & glue 3" & 4" blue | wood | N | n/a |
| BB | - | | Wood baseboard | | n/a | n/a |
| Walls | 4 | 04C | Plaster - sanded finish | | N | n/a |
| Walls | 5 | | Tackboards & glue | Plaster | N | n/a |
| Sink | 6 | | Sink coating - black (stainless steel) | | N | n/a |
| Ceiling | 7 | 07E | Lay-in panels - 2' x 4' gouge pinhole | ACM Roofing debris | N | n/a |
| Ceiling | 26 | | Roofing debris with silver paint | F/G insulation | Y | Y |
| | NOTE | | Silver Paint=3% CH; Other various roof material=ND | | | |
| Ceiling | - | | Fiberglass insulation | ACM Roofing debris | n/a | n/a |
| Ceiling | 26 | | Roofing debris with silver paint | 12" ACT | Y | Y |
| | NOTE | | Silver Paint=3% CH; Other various roof material=ND | | | |
| Ceiling | 8 | | Acoustic ceiling tiles 12" uniform hole pattern (nailed) | wood slat | N | n/a |
| Ceiling | - | | Wood slats | ACM Roofing debris | n/a | n/a |
| Ceiling | 26 | | Roofing debris with silver paint | Wool batt insulation | Y | Y |
| | NOTE | | Silver Paint=3% CH; Other various roof material=ND | | | |
| Ceiling | 24 | | Wool-batt insulation glued (black) to paper backing | diagonal sheathing | N | n/a |

RED=contains asbestos

BLACK=no asbestos detected or non-suspect



YES Environmental, Inc.

1201 24th Street, Suite B110-377, Bakersfield, CA 93301 / (661) 527-0820

| | | | | | |
|------------------|-------------------------------|-------------------------|------------------|---------------------------|-----|
| Building: | Building B - Classrooms 12-16 | Room Name: | Classroom 14 | Rm Ft²: | 960 |
| | | Room Dimensions: | L=32 W=30 H=9/12 | | |

| Component | HMR # | Sample # | Material Description | Substrate | ACM Y/N | Friable Y/N |
|-----------|-------|----------|----------------------------------------------------|--------------------|------------|----------------|
| Floor | 1 | | Carpet & glue - grey/green/multi | Concrete | N | n/a |
| Floor | 2 | | Carpet & glue - black/white speckled | Concrete | N | n/a |
| BB | 12 | 12A | Baseboard & glue - 4" lt green | wood | N | n/a |
| BB | - | | Wood baseboard | | n/a | n/a |
| Walls | 4 | | Plaster - sanded finish | | N | n/a |
| Walls | 5 | | Tackboards & glue | Plaster | N | n/a |
| Sink | 6 | 06B | Sink coating - black (stainless steel) | | N | n/a |
| Ceiling | 7 | 07F | Lay-in panels - 2' x 4' gouge pinhole | ACM Roofing debris | N | n/a |
| Ceiling | 26 | | Roofing debris with silver paint | F/G insulation | Y | Y |
| | NOTE | | Silver Paint=3% CH; Other various roof material=ND | | | |
| Ceiling | - | | Fiberglass insulation | ACM Roofing debris | n/a | n/a |
| Ceiling | 26 | | Roofing debris with silver paint | Unfinished drywall | Y | Y |
| | NOTE | | Silver Paint=3% CH; Other various roof material=ND | | | |
| Ceiling | 25 | 25A | Unfinished drywall, with tape & joint compound | ACM Roofing debris | N | n/a |
| Ceiling | 26 | | Roofing debris with silver paint | diagonal sheathing | Y | Y |
| | NOTE | | Silver Paint=3% CH; Other various roof material=ND | | | |

RED=contains asbestos

BLACK=no asbestos detected or non-suspect



YES Environmental, Inc.

1201 24th Street, Suite B110-377, Bakersfield, CA 93301 / (661) 527-0820

| | | | | | |
|------------------|-------------------------------|-------------------------|------------------|---------------------------|-----|
| Building: | Building B - Classrooms 12-16 | Room Name: | Classroom 15 | Rm Ft²: | 960 |
| | | Room Dimensions: | L=32 W=30 H=9/12 | | |

| Component | HMR # | Sample # | Material Description | Substrate | ACM Y/N | Friable Y/N |
|-----------|-------|----------|----------------------------------------------------------|----------------------|------------|----------------|
| Floor | 1 | | Carpet & glue - grey/green/multi | Concrete | N | n/a |
| Floor | 2 | 02D | Carpet & glue - black/white speckled | Concrete | N | n/a |
| BB | 3 | | Baseboard & glue 3" & 4" blue | wood | N | n/a |
| BB | - | | Wood baseboard | | n/a | n/a |
| Walls | 4 | 04F | Plaster - sanded finish | | N | n/a |
| Walls | 5 | | Tackboards & glue | Plaster | N | n/a |
| Sink | 6 | | Sink coating - black (stainless steel) | | N | n/a |
| Ceiling | 7 | | Lay-in panels - 2' x 4' gouge pinhole | ACM Roofing debris | N | n/a |
| Ceiling | 26 | | Roofing debris with silver paint | F/G insulation | Y | Y |
| | NOTE | | Silver Paint=3% CH; Other various roof material=ND | | | |
| Ceiling | - | | Fiberglass insulation | ACM Roofing debris | n/a | n/a |
| Ceiling | 26 | | Roofing debris with silver paint | 12" ACT | Y | Y |
| | NOTE | | Silver Paint=3% CH; Other various roof material=ND | | | |
| Ceiling | 8 | 08E | Acoustic ceiling tiles 12" uniform hole pattern (nailed) | wood slat | N | n/a |
| Ceiling | - | | Wood slats | ACM Roofing debris | n/a | n/a |
| Ceiling | 26 | | Roofing debris with silver paint | Wool batt insulation | Y | Y |
| | NOTE | | Silver Paint=3% CH; Other various roof material=ND | | | |
| Ceiling | 24 | | Wool-batt insulation glued (black) to paper backing | diagonal sheathing | N | n/a |

RED=contains asbestos

BLACK=no asbestos detected or non-suspect



YES Environmental, Inc.

1201 24th Street, Suite B110-377, Bakersfield, CA 93301 / (661) 527-0820

| | | | | | |
|------------------|-------------------------------|-------------------------|------------------|---------------------------|-----|
| Building: | Building B - Classrooms 12-16 | Room Name: | Classroom 16 | Rm Ft²: | 960 |
| | | Room Dimensions: | L=32 W=30 H=9/12 | | |

| Component | HMR # | Sample # | Material Description | Substrate | ACM Y/N | Friable Y/N |
|-----------|-------|----------|----------------------------------------------------------|----------------------|------------|----------------|
| Floor | 1 | 01C | Carpet & glue - grey/green/multi | Concrete | N | n/a |
| Floor | 2 | | Carpet & glue - black/white speckled | Concrete | N | n/a |
| BB | 3 | | Baseboard & glue 3" & 4" blue | wood | N | n/a |
| BB | - | | Wood baseboard | | n/a | n/a |
| Walls | 4 | | Plaster - sanded finish | | N | n/a |
| Walls | 5 | | Tackboards & glue | Plaster | N | n/a |
| Sink | 6 | | Sink coating - black (stainless steel) | | N | n/a |
| Ceiling | 7 | | Lay-in panels - 2' x 4' gouge pinhole | ACM Roofing debris | N | n/a |
| Ceiling | 26 | | Roofing debris with silver paint | F/G insulation | Y | Y |
| | NOTE | | Silver Paint=3% CH; Other various roof material=ND | | | |
| Ceiling | - | | Fiberglass insulation | ACM Roofing debris | n/a | n/a |
| Ceiling | 26 | | Roofing debris with silver paint | 12" ACT | Y | Y |
| | NOTE | | Silver Paint=3% CH; Other various roof material=ND | | | |
| Ceiling | 8 | | Acoustic ceiling tiles 12" uniform hole pattern (nailed) | wood slat | N | n/a |
| Ceiling | - | | Wood slats | ACM Roofing debris | n/a | n/a |
| Ceiling | 26 | | Roofing debris with silver paint | Wool batt insulation | Y | Y |
| | NOTE | | Silver Paint=3% CH; Other various roof material=ND | | | |
| Ceiling | 24 | | Wool-batt insulation glued (black) to paper backing | diagonal sheathing | N | n/a |

RED=contains asbestos

BLACK=no asbestos detected or non-suspect



YES Environmental, Inc.

1201 24th Street, Suite B110-377, Bakersfield, CA 93301 / (661) 527-0820

| | | | |
|-----------------------------------------------------------------|------------------------------|-----------------------|-------------------------------|
| Building: Building B - Classrooms 12-16 East of Rm 16 | Room Name: | Custodial Room | Rm Ft²: 143 |
| | Room Dimensions: L=13 | W=11 H=9 | |

| Component | HMR # | Sample # | Material Description | Substrate | ACM Y/N | Friable Y/N |
|-----------|-------|----------|----------------------------------------------------|--------------------|------------|----------------|
| Floor | - | | Concrete - bare & exposed | | n/a | n/a |
| BB | - | | Wood | | n/a | n/a |
| Walls | 4 | 04B | Plaster - sanded finish | | N | n/a |
| Ceiling | 4 | | Plaster - sanded finish | ACM Roofing debris | N | n/a |
| Ceiling | 26 | 26C | Roofing debris with silver paint | | Y | Y |
| | NOTE | | Silver Paint=3% CH; Other various roof material=ND | | | |
| NOTE | | | ATTIC ACCESS | | | |

RED=contains asbestos

BLACK=no asbestos detected or non-suspect



YES Environmental, Inc.

1201 24th Street, Suite B110-377, Bakersfield, CA 93301 / (661) 527-0820

| | | |
|----------------------------------------------------------------------------------|-------------------------------------------|-------------------------------|
| Building: Building B - Classrooms 12-16 Inside East Teachers' Workroom | Room Name: East Teachers' Workroom | Rm Ft²: 288 |
| Room Dimensions: L=18 W=16 H=12 | | |

| Component | HMR # | Sample # | Material Description | Substrate | ACM Y/N | Friable Y/N |
|-----------|-------|----------|-----------------------------------------------------------|----------------------|------------|----------------|
| Floor | 13 | | Floor tile & glue 12" blue/grey oatmeal | Concrete | N | n/a |
| BB | 14 | 14A | Baseboard & glue 4" dk grey | Wood | N | n/a |
| BB | - | | Wood | | n/a | n/a |
| Walls | 4 | | Plaster - sanded finish | | N | n/a |
| Ceiling | 15 | 15A | Lay-in panels - 2' x 4' variety (fiss/gouge) various ages | ACM Roofing debris | N | n/a |
| Ceiling | 26 | | Roofing debris with silver paint | F/G insulation | Y | Y |
| | NOTE | | Silver Paint=3% CH; Other various roof material=ND | | | |
| Ceiling | - | | Fiberglass insulation | ACM Roofing debris | n/a | n/a |
| Ceiling | 26 | | Roofing debris with silver paint | 12" ACT | Y | Y |
| | NOTE | | Silver Paint=3% CH; Other various roof material=ND | | | |
| Ceiling | 8 | | Acoustic ceiling tiles 12" uniform hole pattern (nailed) | wood slat | N | n/a |
| Ceiling | - | | Wood slats | ACM Roofing debris | n/a | n/a |
| Ceiling | 26 | | Roofing debris with silver paint | Wool batt insulation | Y | Y |
| | NOTE | | Silver Paint=3% CH; Other various roof material=ND | | | |
| Ceiling | 24 | | Wool-batt insulation glued (black) to paper backing | diagonal sheathing | N | n/a |

RED=contains asbestos

BLACK=no asbestos detected or non-suspect



YES Environmental, Inc.

1201 24th Street, Suite B110-377, Bakersfield, CA 93301 / (661) 527-0820

| | | |
|-----------------------------------------------------------------|---------------------------------------|-------------------------------|
| Building: Building B - Classrooms 12-16 East of Rm 16 | Room Name: Staff Restroom | Rm Ft²: 112 |
| | Room Dimensions: L=14 W=8 H=12 | |

| Component | HMR # | Sample # | Material Description | Substrate | ACM Y/N | Friable Y/N |
|-----------|-------|----------|----------------------------------------------------|--------------------|------------|----------------|
| Floor | 16 | 16A | Sheet flooring & glue - grey mosaic pattern | Concrete | N | n/a |
| BB | | | None | | | |
| Walls | 17 | 17A | Plaster - smooth finish | | N | n/a |
| Ceiling | 4 | | Plaster - sanded finish | ACM Roofing debris | N | n/a |
| Ceiling | 26 | | Roofing debris with silver paint | | Y | Y |
| | NOTE | | Silver Paint=3% CH; Other various roof material=ND | | | |

| | | |
|---------------------------------------------------------------------|-------------------------------------------|-------------------------------|
| Building: Building B - Classrooms 12-16 adjacent to CR 16 | Room Name: West Teachers' Workroom | Rm Ft²: 640 |
| | Room Dimensions: L=32 W=20 H=12 | |

| Component | HMR # | Sample # | Material Description | Substrate | ACM Y/N | Friable Y/N |
|-----------|-------|----------|-----------------------------------------------------------|-----------|------------|----------------|
| Floor | 13 | 13A | Floor tile & glue 12" blue/grey oatmeal | Concrete | N | n/a |
| BB | 14 | | Baseboard & glue 4" dk grey | Wood | N | n/a |
| BB | - | | Wood | | n/a | n/a |
| Walls | 4 | | Plaster - sanded finish | | N | n/a |
| Walls | 5 | 05C | Tackboards & glue | Plaster | N | n/a |
| Ceiling | 15 | | Lay-in panels - 2' x 4' variety (fiss/gouge) various ages | Plywood | N | n/a |
| Door | 11 | | Fire Door - label painted over | | Y | Y |
| | NOTE | | Assumed. Test before disturbing or removing. | | | |

RED=contains asbestos

BLACK=no asbestos detected or non-suspect



YES Environmental, Inc.

1201 24th Street, Suite B110-377, Bakersfield, CA 93301 / (661) 527-0820

| | | | |
|------------------|-------------------------------|-------------------|----------|
| Building: | Building B - Classrooms 12-16 | Room Name: | Exterior |
|------------------|-------------------------------|-------------------|----------|

| Component | HMR # | Sample # | Material Description | Substrate | ACM Y/N | Friable Y/N |
|-----------------|-------|----------|------------------------------------------|-----------|------------|----------------|
| Ground | 38 | | Asphalt | | N | n/a |
| Ground | - | | Concrete - bare & exposed | | n/a | n/a |
| Walls & Soffit: | 35 | | Exterior stucco, painted & vapor barrier | | N | n/a |

NOTE No other areas of stucco contain asbestos on this building. See the limited location of the asbestos-containing stucco below.

Exterior Soffit

| | | | | | |
|-------------------|----|-----|------------------------------------------------------------------|---|---|
| PATCH ONLY | 35 | 35B | Exterior stucco, painted & vapor barrier - 1% CH in texture coat | Y | Y |
|-------------------|----|-----|------------------------------------------------------------------|---|---|

| | | | | | | |
|----------------|------|-------|--------------------------------------------------------------------------------------|--|---|-----|
| Windows | 28 | 28C-D | Exterior window putty | | N | n/a |
| Eaves | 35 | | Exterior stucco, painted | | N | n/a |
| Roof | 36 | | White coated foam on silver paint on rolled composition roofing & Diagonal sheathing | | Y | N |
| | NOTE | | Foam=ND; Silver Paint=2-4% CH; Rolled Composition Roofing & Felts=ND | | | |

RED=contains asbestos

BLACK=no asbestos detected or non-suspect



YES Environmental, Inc.

1201 24th Street, Suite B110-377, Bakersfield, CA 93301 / (661) 527-0820

| | | | | |
|-------------|------|------------------------------------------------------------------------------------------------------|---|---|
| Roof | 37 | White coated foam on silver paint on penetration mastic | Y | N |
| | NOTE | Foam=ND; Silver Paint=2-4% CH; Mastics=Assumed | | |
| | NOTE | On components such as, but not limited to, roof jacks, roof vents, conduits, sleepers, patches, etc. | | |

RED=contains asbestos

BLACK=no asbestos detected or non-suspect



YES Environmental, Inc.

1201 24th Street, Suite B110-377, Bakersfield, CA 93301 / (661) 527-0820

Client: Bakersfield City School District

Site: Wayside ES

YES Project No.: 23YES-05

Date of Inspection: 6/27/2023

Inspection Report

| | | | |
|-------------------------------------------------------------------------------------------------------------------------------------------------------------------------------------------------------------------------------------------------------------------------------------------------------------------------------------------------------------------------------------|---------------------------------|-------------------|-------|
| Building: | Building C - Rooms K1-K2, 22-25 | Room Name: | Attic |
| <p>Attic is defined as: every enclosed spaced that is contiguous and/or beneath the roof, attic, void, and plenum space above every room in this building including, but not limited to, exterior enclosed eaves, enclosed hallways, walkways, corridors, wall cavities, etc. and all spaces beneath the roof and above ceilings that are or are not readily accessible.</p> | | | |
| <p>Attic Floor is defined as: the surface within an attic space, serving as the ceiling for the room(s) below and/or an area with exposed joists. It is not a term that can be used to infer a walkable surface.</p> | | | |

| Component | HMR # | Sample # | Material Description | Substrate | ACM Y/N | Friable Y/N |
|--------------------|-------|----------|---------------------------------------------------------------------------------------------------------------------|-----------|------------|----------------|
| Attic Floor | 26 | | Roofing debris with silver paint | | Y | Y |
| | NOTE | | Silver Paint=3% CH; Other various roof material=ND material exists on and inbetween the floor joists of this space. | This | | |
| Attic Floor | - | | Fiberglass batt insulation | | Y | Y |
| | NOTE | | Contaminated with asbestos roofing debris | | | |
| Walls | - | | Wood | | n/a | n/a |
| Flue Pipes | | | Transite flue pipes - Known Asbestos Material | | | |
| Ceiling | - | | Diagonal sheathing | | n/a | n/a |

RED=contains asbestos

BLACK=no asbestos detected or non-suspect



YES Environmental, Inc.

1201 24th Street, Suite B110-377, Bakersfield, CA 93301 / (661) 527-0820

| Building: | | Building C - Rooms K1-K2, 22-25 | | Room Name: | Classroom K1 | | Rm Ft ² : | 960 |
|-----------|------------|---------------------------------|----------------------------------------------------------------------------------------|----------------------|--------------|----------------|----------------------|-----|
| | | Room Dimensions: | | L=40 | W=24 | H=9/12 | | |
| Component | HMR # | Sample # | Material Description | Substrate | ACM Y/N | Friable Y/N | | |
| Floor | 23 NOTE | 23A | Floor tile & glue 12" lt grey/cream mosaic 50% of floor | Concrete | N | n/a | | |
| Floor | 1 NOTE | | Carpet & glue - grey/green/multi 50% of floor | Concrete | N | n/a | | |
| BB | 3 | | Baseboard & glue 3" & 4" blue | wood | N | n/a | | |
| BB | - | | Wood baseboard | | n/a | n/a | | |
| Walls | 4 | | Plaster - sanded finish | | N | n/a | | |
| Walls | 5 | | Tackboards & glue | Plaster | N | n/a | | |
| Sink | 6 | | Sink coating - black (stainless steel) | | N | n/a | | |
| Ceiling | 7 | | Lay-in panels - 2' x 4' gouge pinhole | ACM Roofing debris | N | n/a | | |
| Ceiling | 26 NOTE | | Roofing debris with silver paint Silver Paint=3% CH; Other various roof material=ND | F/G insulation | Y | Y | | |
| Ceiling | - | | Fiberglass insulation | ACM Roofing debris | n/a | n/a | | |
| Ceiling | 26 NOTE | | Roofing debris with silver paint Silver Paint=3% CH; Other various roof material=ND | 12" ACT | Y | Y | | |
| Ceiling | 8 | | Acoustic ceiling tiles 12" uniform hole pattern (nailed) | wood slat | N | n/a | | |
| Ceiling | - | | Wood slats | ACM Roofing debris | n/a | n/a | | |
| Ceiling | 26 NOTE | | Roofing debris with silver paint Silver Paint=3% CH; Other various roof material=ND | Wool batt insulation | Y | Y | | |
| Ceiling | 24 | | Wool-batt insulation glued (black) to paper backing | diagonal sheathing | N | n/a | | |

RED=contains asbestos

BLACK=no asbestos detected or non-suspect



YES Environmental, Inc.

1201 24th Street, Suite B110-377, Bakersfield, CA 93301 / (661) 527-0820

| Building: | | Building C - Rooms K1-K2, 22-25 | | Room Name: | | K1 SE Storage RM | | Rm Ft ² : | | 36 |
|-------------------------------|-------|---------------------------------|----------------------------------------------------------|----------------------|------------|------------------|-----|----------------------|--|----|
| Located inside K1 - SE corner | | | | Room Dimensions: | | L=6 | W=6 | H=8 | | |
| Component | HMR # | Sample # | Material Description | Substrate | ACM Y/N | Friable Y/N | | | | |
| Floor | 23 | | Floor tile & glue 12" lt grey/cream mosaic | Concrete | N | n/a | | | | |
| BB | 3 | | Baseboard & glue 3" & 4" blue | wood | N | n/a | | | | |
| BB | - | | Wood baseboard | | n/a | n/a | | | | |
| Walls | 4 | | Plaster - sanded finish | | N | n/a | | | | |
| Ceiling | 8 | | Acoustic ceiling tiles 12" uniform hole pattern (nailed) | Wood slat | N | n/a | | | | |
| Ceiling | - | | Wood slats | ACM Roofing debris | n/a | n/a | | | | |
| Ceiling | 26 | | Roofing debris with silver paint | Wool batt insulation | Y | Y | | | | |
| | NOTE | | Silver Paint=3% CH; Other various roof material=ND | | | | | | | |
| Ceiling | 24 | | Wool-batt insulation glued (black) to paper backing | diagonal sheathing | N | n/a | | | | |

RED=contains asbestos

BLACK=no asbestos detected or non-suspect



YES Environmental, Inc.

1201 24th Street, Suite B110-377, Bakersfield, CA 93301 / (661) 527-0820

| Building: | | Building C - Rooms K1-K2, 22-25 | | Room Name: | | K1B | | Rm Ft ² : | | 680 | |
|-----------|-------|---------------------------------|----------------------------------------------------------|----------------------|------------|----------------|--|----------------------|--|-----|--|
| | | Room Dimensions: | | L=34 | | W=20 | | H=9/12 | | | |
| Component | HMR # | Sample # | Material Description | Substrate | ACM Y/N | Friable Y/N | | | | | |
| Floor | 23 | | Floor tile & glue 12" lt grey/cream mosaic | Concrete | N | n/a | | | | | |
| | NOTE | | 50% of floor | | | | | | | | |
| Floor | 1 | | Carpet & glue - grey/green/multi | Concrete | N | n/a | | | | | |
| | NOTE | | 50% of floor | | | | | | | | |
| BB | 3 | | Baseboard & glue 3" & 4" blue | wood | N | n/a | | | | | |
| BB | - | | Wood baseboard | | n/a | n/a | | | | | |
| Walls | 4 | | Plaster - sanded finish | | N | n/a | | | | | |
| Walls | 5 | | Tackboards & glue | Plaster | N | n/a | | | | | |
| Sink | 6 | | Sink coating - black (stainless steel) | | N | n/a | | | | | |
| Ceiling | 7 | | Lay-in panels - 2' x 4' gouge pinhole | ACM Roofing debris | N | n/a | | | | | |
| Ceiling | 26 | | Roofing debris with silver paint | F/G insulation | Y | Y | | | | | |
| | NOTE | | Silver Paint=3% CH; Other various roof material=ND | | | | | | | | |
| Ceiling | - | | Fiberglass insulation | ACM Roofing debris | n/a | n/a | | | | | |
| Ceiling | 26 | | Roofing debris with silver paint | 12" ACT | Y | Y | | | | | |
| | NOTE | | Silver Paint=3% CH; Other various roof material=ND | | | | | | | | |
| Ceiling | 8 | | Acoustic ceiling tiles 12" uniform hole pattern (nailed) | | N | n/a | | | | | |
| Ceiling | - | | Wood slats | ACM Roofing debris | n/a | n/a | | | | | |
| Ceiling | 26 | | Roofing debris with silver paint | Wool batt insulation | Y | Y | | | | | |
| | NOTE | | Silver Paint=3% CH; Other various roof material=ND | | | | | | | | |
| Ceiling | 24 | | Wool-batt insulation glued (black) to paper backing | diagonal sheathing | N | n/a | | | | | |

RED=contains asbestos

BLACK=no asbestos detected or non-suspect



YES Environmental, Inc.

1201 24th Street, Suite B110-377, Bakersfield, CA 93301 / (661) 527-0820

| | | | | | |
|------------------|---------------------------------|-------------------------|-------------------|---------------------------|----|
| Building: | Building C - Rooms K1-K2, 22-25 | Room Name: | K1B SW Storage Rm | Rm Ft²: | 72 |
| | | Room Dimensions: | L=12 W=6 H=8 | | |

| Component | HMR # | Sample # | Material Description | Substrate | ACM Y/N | Friable Y/N |
|----------------|-------------|----------|-----------------------------------------------------------|----------------------|------------|----------------|
| Floor | 23 | | Floor tile & glue 12" lt grey/cream mosaic | Concrete | N | n/a |
| BB | 3 | | Baseboard & glue 3" & 4" blue | wood | N | n/a |
| BB | - | | Wood baseboard | | n/a | n/a |
| Walls | 4 | | Plaster - sanded finish | | N | n/a |
| Ceiling | 8 | | Acoustic ceiling tiles 12" uniform hole pattern (nailed) | Wood slat | N | n/a |
| Ceiling | - | | Wood slats | ACM Roofing debris | n/a | n/a |
| Ceiling | 26 | | Roofing debris with silver paint | Wool batt insulation | Y | Y |
| | NOTE | | Silver Paint=3% CH; Other various roof material=ND | | | |
| Ceiling | 24 | | Wool-batt insulation glued (black) to paper backing | ACM Roofing debris | N | n/a |
| Ceiling | 26 | | Roofing debris with silver paint | Diagonal Sheathing | Y | Y |
| | NOTE | | Silver Paint=3% CH; Other various roof material=ND | | | |

| | | | | | |
|------------------|---------------------------------|-------------------------|--------------|---------------------------|----|
| Building: | Building C - Rooms K1-K2, 22-25 | Room Name: | K1B Child RR | Rm Ft²: | 80 |
| | | Room Dimensions: | L=10 W=8 H=8 | | |

| Component | HMR # | Sample # | Material Description | Substrate | ACM Y/N | Friable Y/N |
|----------------|-------------|----------|-----------------------------------------------------------|--------------------|------------|----------------|
| Floor | 9 | | Ceramic floor tile grout (2" grey) | | N | n/a |
| BB | | | None | | | |
| Walls | 10 | | Ceramic wall tile grout - blue (4" white) | Plaster | N | n/a |
| | NOTE | | AFF 6' | | | |
| Walls | 4 | | Plaster - sanded finish | | N | n/a |
| Ceiling | 4 | | Plaster - sanded finish | ACM Roofing debris | N | n/a |
| Ceiling | 26 | | Roofing debris with silver paint | | Y | Y |
| | NOTE | | Silver Paint=3% CH; Other various roof material=ND | | | |

RED=contains asbestos

BLACK=no asbestos detected or non-suspect



YES Environmental, Inc.

1201 24th Street, Suite B110-377, Bakersfield, CA 93301 / (661) 527-0820

| Building: | | Building C - Rooms K1-K2, 22-25 | | Room Name: | K2B | | Rm Ft ² : | 680 | |
|-----------|-------|---------------------------------|----------------------------------------------------------|----------------------|------------|----------------|----------------------|-----|--|
| | | Room Dimensions: | | L=34 | W=20 | H=9/12 | | | |
| Component | HMR # | Sample # | Material Description | Substrate | ACM Y/N | Friable Y/N | | | |
| Floor | 23 | | Floor tile & glue 12" lt grey/cream mosaic | Concrete | N | n/a | | | |
| | NOTE | | 50% of floor | | | | | | |
| Floor | 1 | | Carpet & glue - grey/green/multi | Concrete | N | n/a | | | |
| | NOTE | | 50% of floor | | | | | | |
| BB | 3 | | Baseboard & glue 3" & 4" blue | wood | N | n/a | | | |
| BB | - | | Wood baseboard | | n/a | n/a | | | |
| Walls | 4 | | Plaster - sanded finish | | N | n/a | | | |
| Walls | 5 | | Tackboards & glue | Plaster | N | n/a | | | |
| Sink | 6 | | Sink coating - black (stainless steel) | | N | n/a | | | |
| Ceiling | 7 | | Lay-in panels - 2' x 4' gouge pinhole | ACM Roofing debris | N | n/a | | | |
| Ceiling | 26 | | Roofing debris with silver paint | F/G insulation | Y | Y | | | |
| | NOTE | | Silver Paint=3% CH; Other various roof material=ND | | | | | | |
| Ceiling | - | | Fiberglass insulation | ACM Roofing debris | n/a | n/a | | | |
| Ceiling | 26 | | Roofing debris with silver paint | 12" ACT | Y | Y | | | |
| | NOTE | | Silver Paint=3% CH; Other various roof material=ND | | | | | | |
| Ceiling | 8 | | Acoustic ceiling tiles 12" uniform hole pattern (nailed) | Wood slat | N | n/a | | | |
| Ceiling | - | | Wood slats | ACM Roofing debris | n/a | n/a | | | |
| Ceiling | 26 | | Roofing debris with silver paint | Wool batt insulation | Y | Y | | | |
| | NOTE | | Silver Paint=3% CH; Other various roof material=ND | | | | | | |
| Ceiling | 24 | | Wool-batt insulation glued (black) to paper backing | diagonal sheathing | N | n/a | | | |

RED=contains asbestos

BLACK=no asbestos detected or non-suspect



YES Environmental, Inc.

1201 24th Street, Suite B110-377, Bakersfield, CA 93301 / (661) 527-0820

| | | | | | |
|------------------|---------------------------------|-------------------------|-------------------|---------------------------|----|
| Building: | Building C - Rooms K1-K2, 22-25 | Room Name: | K2B SE Storage Rm | Rm Ft²: | 72 |
| | | Room Dimensions: | L=12 W=6 H=8 | | |

| Component | HMR # | Sample # | Material Description | Substrate | ACM Y/N | Friable Y/N |
|-----------|-------|----------|----------------------------------------------------------|----------------------|------------|----------------|
| Floor | 23 | | Floor tile & glue 12" lt grey/cream mosaic | Concrete | N | n/a |
| BB | 3 | | Baseboard & glue 3" & 4" blue | wood | N | n/a |
| BB | - | | Wood baseboard | | n/a | n/a |
| Walls | 4 | | Plaster - sanded finish | | N | n/a |
| Ceiling | 8 | | Acoustic ceiling tiles 12" uniform hole pattern (nailed) | Wood slat | N | n/a |
| Ceiling | - | | Wood slats | ACM Roofing debris | n/a | n/a |
| Ceiling | 26 | | Roofing debris with silver paint | Wool batt insulation | Y | Y |
| | NOTE | | Silver Paint=3% CH; Other various roof material=ND | | | |
| Ceiling | 24 | | Wool-batt insulation glued (black) to paper backing | ACM Roofing debris | N | n/a |
| Ceiling | 26 | | Roofing debris with silver paint | diagonal sheathing | Y | Y |
| | NOTE | | Silver Paint=3% CH; Other various roof material=ND | | | |

| | | | | | |
|------------------|---------------------------------|-------------------------|--------------|---------------------------|----|
| Building: | Building C - Rooms K1-K2, 22-25 | Room Name: | K2B Child RR | Rm Ft²: | 80 |
| | | Room Dimensions: | L=10 W=8 H=8 | | |

| Component | HMR # | Sample # | Material Description | Substrate | ACM Y/N | Friable Y/N |
|-----------|-------|----------|----------------------------------------------------|--------------------|------------|----------------|
| Floor | 9 | | Ceramic floor tile grout (2" grey) | | N | n/a |
| BB | | | None | | | |
| Walls | 10 | | Ceramic wall tile grout - blue (4" white) | Plaster | N | n/a |
| | NOTE | | AFF 6' | | | |
| Walls | 4 | | Plaster - sanded finish | | N | n/a |
| Ceiling | 4 | | Plaster - sanded finish | ACM Roofing debris | N | n/a |
| Ceiling | 26 | | Roofing debris with silver paint | | Y | Y |
| | NOTE | | Silver Paint=3% CH; Other various roof material=ND | | | |

RED=contains asbestos

BLACK=no asbestos detected or non-suspect



YES Environmental, Inc.

1201 24th Street, Suite B110-377, Bakersfield, CA 93301 / (661) 527-0820

| Building: | | Building C - Rooms K1-K2, 22-25 | | Room Name: | Classroom K2 | | Rm Ft ² : | 960 |
|-----------|-------|---------------------------------|----------------------------------------------------------|----------------------|--------------|----------------|----------------------|-----|
| | | Room Dimensions: | | L=40 | W=24 | H=9/12 | | |
| Component | HMR # | Sample # | Material Description | Substrate | ACM Y/N | Friable Y/N | | |
| Floor | 23 | | Floor tile & glue 12" lt grey/cream mosaic | Concrete | N | n/a | | |
| | NOTE | | 50% of floor | | | | | |
| Floor | 1 | | Carpet & glue - grey/green/multi | Concrete | N | n/a | | |
| | NOTE | | 50% of floor | | | | | |
| BB | 3 | 03E | Baseboard & glue 3" & 4" blue | wood | N | n/a | | |
| BB | - | | Wood baseboard | | n/a | n/a | | |
| Walls | 4 | | Plaster - sanded finish | | N | n/a | | |
| Walls | 5 | | Tackboards & glue | Plaster | N | n/a | | |
| Sink | 6 | | Sink coating - black (stainless steel) | | N | n/a | | |
| Ceiling | 7 | | Lay-in panels - 2' x 4' gouge pinhole | ACM Roofing debris | N | n/a | | |
| Ceiling | 26 | | Roofing debris with silver paint | F/G insulation | Y | Y | | |
| | NOTE | | Silver Paint=3% CH; Other various roof material=ND | | | | | |
| Ceiling | - | | Fiberglass insulation | ACM Roofing debris | n/a | n/a | | |
| Ceiling | 26 | | Roofing debris with silver paint | 12" ACT | Y | Y | | |
| | NOTE | | Silver Paint=3% CH; Other various roof material=ND | | | | | |
| Ceiling | 8 | | Acoustic ceiling tiles 12" uniform hole pattern (nailed) | wood slat | | | | |
| Ceiling | - | | Wood slats | ACM Roofing debris | n/a | n/a | | |
| Ceiling | 26 | | Roofing debris with silver paint | Wool batt insulation | Y | Y | | |
| | NOTE | | Silver Paint=3% CH; Other various roof material=ND | | | | | |
| Ceiling | 24 | | Wool-batt insulation glued (black) to paper backing | diagonal sheathing | N | n/a | | |

RED=contains asbestos

BLACK=no asbestos detected or non-suspect



YES Environmental, Inc.

1201 24th Street, Suite B110-377, Bakersfield, CA 93301 / (661) 527-0820

| Building: | | Building C - Rooms K1-K2, 22-25 | | Room Name: | | K2 SW Storage RM | | Rm Ft ² : | | 36 |
|-----------|-------|---------------------------------|----------------------------------------------------------|----------------------|------------|------------------|--|----------------------|--|----|
| | | Room Dimensions: | | L=6 | W=6 | H=8 | | | | |
| Component | HMR # | Sample # | Material Description | Substrate | ACM Y/N | Friable Y/N | | | | |
| Floor | 23 | | Floor tile & glue 12" lt grey/cream mosaic | Concrete | N | n/a | | | | |
| BB | 3 | | Baseboard & glue 3" & 4" blue | wood | N | n/a | | | | |
| BB | - | | Wood baseboard | | n/a | n/a | | | | |
| Walls | 4 | | Plaster - sanded finish | | N | n/a | | | | |
| Ceiling | 8 | | Acoustic ceiling tiles 12" uniform hole pattern (nailed) | Wood slats | N | n/a | | | | |
| Ceiling | - | | Wood slats | ACM Roofing debris | n/a | n/a | | | | |
| Ceiling | 26 | | Roofing debris with silver paint | Wool batt insulation | Y | Y | | | | |
| | NOTE | | Silver Paint=3% CH; Other various roof material=ND | | | | | | | |
| Ceiling | 24 | | Wool-batt insulation glued (black) to paper backing | diagonal sheathing | N | n/a | | | | |

RED=contains asbestos

BLACK=no asbestos detected or non-suspect



YES Environmental, Inc.

1201 24th Street, Suite B110-377, Bakersfield, CA 93301 / (661) 527-0820

| | | | | | |
|------------------|---------------------------------|-------------------------|------------------|---------------------------|-----|
| Building: | Building C - Rooms K1-K2, 22-25 | Room Name: | Classroom 22 | Rm Ft²: | 960 |
| | | Room Dimensions: | L=32 W=30 H=9/12 | | |

| Component | HMR # | Sample # | Material Description | Substrate | ACM Y/N | Friable Y/N |
|-----------|-------|----------|----------------------------------------------------------|----------------------|------------|----------------|
| Floor | 1 | | Carpet & glue - grey/green/multi | Concrete | N | n/a |
| Floor | 2 | | Carpet & glue - black/white speckled | Concrete | N | n/a |
| BB | 22 | | Baseboard & glue 3" & 4" tan | wood | N | n/a |
| BB | - | | Wood baseboard | | n/a | n/a |
| Walls | 4 | 04K | Plaster - sanded finish | | N | n/a |
| Walls | 5 | | Tackboards & glue | Plaster | N | n/a |
| Sink | 6 | | Sink coating - black (stainless steel) | | N | n/a |
| Ceiling | 7 | | Lay-in panels - 2' x 4' gouge pinhole | ACM Roofing debris | N | n/a |
| Ceiling | 26 | | Roofing debris with silver paint | F/G insulation | Y | Y |
| | NOTE | | Silver Paint=3% CH; Other various roof material=ND | c2 | | |
| Ceiling | - | | Fiberglass insulation | ACM Roofing debris | n/a | n/a |
| Ceiling | 26 | | Roofing debris with silver paint | 12" ACT | Y | Y |
| | NOTE | | Silver Paint=3% CH; Other various roof material=ND | | | |
| Ceiling | 8 | | Acoustic ceiling tiles 12" uniform hole pattern (nailed) | wood slats | N | n/a |
| Ceiling | - | | Wood slats | ACM Roofing debris | n/a | n/a |
| Ceiling | 26 | | Roofing debris with silver paint | Wool batt insulation | Y | Y |
| | NOTE | | Silver Paint=3% CH; Other various roof material=ND | | | |
| Ceiling | 24 | | Wool-batt insulation glued (black) to paper backing | Diagonal sheathing | N | n/a |

RED=contains asbestos

BLACK=no asbestos detected or non-suspect



YES Environmental, Inc.

1201 24th Street, Suite B110-377, Bakersfield, CA 93301 / (661) 527-0820

| | | | | | |
|------------------|---------------------------------|-------------------------|------------------|---------------------------|-----|
| Building: | Building C - Rooms K1-K2, 22-25 | Room Name: | Classroom 23 | Rm Ft²: | 960 |
| | | Room Dimensions: | L=32 W=30 H=9/12 | | |

| Component | HMR # | Sample # | Material Description | Substrate | ACM Y/N | Friable Y/N |
|-----------|-------|----------|----------------------------------------------------------|----------------------|------------|----------------|
| Floor | 1 | | Carpet & glue - grey/green/multi | Concrete | N | n/a |
| Floor | 2 | 02E | Carpet & glue - black/white speckled | Concrete | N | n/a |
| BB | 22 | 22B | Baseboard & glue 3" & 4" tan | wood | N | n/a |
| BB | - | | Wood baseboard | | n/a | n/a |
| Walls | 4 | | Plaster - sanded finish | | N | n/a |
| Walls | 5 | | Tackboards & glue | Plaster | N | n/a |
| Sink | 6 | 06E | Sink coating - black (stainless steel) | | N | n/a |
| Ceiling | 7 | | Lay-in panels - 2' x 4' gouge pinhole | ACM Roofing debris | N | n/a |
| Ceiling | 26 | | Roofing debris with silver paint | F/G insulation | Y | Y |
| | NOTE | | Silver Paint=3% CH; Other various roof material=ND | | | |
| Ceiling | - | | Fiberglass insulation | ACM Roofing debris | n/a | n/a |
| Ceiling | 26 | | Roofing debris with silver paint | 12" ACT | Y | Y |
| | NOTE | | Silver Paint=3% CH; Other various roof material=ND | | | |
| Ceiling | 8 | | Acoustic ceiling tiles 12" uniform hole pattern (nailed) | wood slat | N | n/a |
| Ceiling | - | | Wood slats | ACM Roofing debris | n/a | n/a |
| Ceiling | 26 | | Roofing debris with silver paint | Wool batt insulation | Y | Y |
| | NOTE | | Silver Paint=3% CH; Other various roof material=ND | | | |
| Ceiling | 24 | | Wool-batt insulation glued (black) to paper backing | diagonal sheathing | N | n/a |

RED=contains asbestos

BLACK=no asbestos detected or non-suspect



YES Environmental, Inc.

1201 24th Street, Suite B110-377, Bakersfield, CA 93301 / (661) 527-0820

| | | | | | |
|------------------|---------------------------------|-------------------------|------------------|---------------------------|-----|
| Building: | Building C - Rooms K1-K2, 22-25 | Room Name: | Classroom 24 | Rm Ft²: | 960 |
| | | Room Dimensions: | L=32 W=30 H=9/12 | | |

| Component | HMR # | Sample # | Material Description | Substrate | ACM Y/N | Friable Y/N |
|-----------|-------|----------|----------------------------------------------------------|----------------------|------------|----------------|
| Floor | 1 | 01E | Carpet & glue - grey/green/multi | Concrete | N | n/a |
| Floor | 2 | | Carpet & glue - black/white speckled | Concrete | N | n/a |
| BB | 22 | | Baseboard & glue 3" & 4" tan | wood | N | n/a |
| BB | - | | Wood baseboard | | n/a | n/a |
| Walls | 4 | | Plaster - sanded finish | | N | n/a |
| Walls | 5 | | Tackboards & glue | Plaster | N | n/a |
| Sink | 6 | | Sink coating - black (stainless steel) | | N | n/a |
| Ceiling | 7 | | Lay-in panels - 2' x 4' gouge pinhole | ACM Roofing debris | N | n/a |
| Ceiling | 26 | | Roofing debris with silver paint | F/G insulation | Y | Y |
| | NOTE | | Silver Paint=3% CH; Other various roof material=ND | | | |
| Ceiling | - | | Fiberglass insulation | ACM Roofing debris | n/a | n/a |
| Ceiling | 26 | | Roofing debris with silver paint | 12" ACT | Y | Y |
| | NOTE | | Silver Paint=3% CH; Other various roof material=ND | | | |
| Ceiling | 8 | | Acoustic ceiling tiles 12" uniform hole pattern (nailed) | wood slat | N | n/a |
| Ceiling | - | | Wood slats | ACM Roofing debris | n/a | n/a |
| Ceiling | 26 | | Roofing debris with silver paint | Wool batt insulation | Y | Y |
| | NOTE | | Silver Paint=3% CH; Other various roof material=ND | | | |
| Ceiling | 24 | | Wool-batt insulation glued (black) to paper backing | diagonal sheathing | N | n/a |

RED=contains asbestos

BLACK=no asbestos detected or non-suspect



YES Environmental, Inc.

1201 24th Street, Suite B110-377, Bakersfield, CA 93301 / (661) 527-0820

| | | | | | |
|------------------|---------------------------------|-------------------------|------------------|---------------------------|-----|
| Building: | Building C - Rooms K1-K2, 22-25 | Room Name: | Classroom 25 | Rm Ft²: | 960 |
| | | Room Dimensions: | L=32 W=30 H=9/12 | | |

| Component | HMR # | Sample # | Material Description | Substrate | ACM Y/N | Friable Y/N |
|-----------|-------|----------|----------------------------------------------------------|----------------------|------------|----------------|
| Floor | 1 | | Carpet & glue - grey/green/multi | Concrete | N | n/a |
| Floor | 2 | | Carpet & glue - black/white speckled | Concrete | N | n/a |
| BB | 22 | | Baseboard & glue 3" & 4" tan | wood | N | n/a |
| BB | - | | Wood baseboard | | n/a | n/a |
| Walls | 4 | | Plaster - sanded finish | | N | n/a |
| Walls | 5 | | Tackboards & glue | Plaster | N | n/a |
| Sink | 6 | | Sink coating - black (stainless steel) | | N | n/a |
| Ceiling | 7 | | Lay-in panels - 2' x 4' gouge pinhole | ACM Roofing debris | N | n/a |
| Ceiling | 26 | | Roofing debris with silver paint | F/G insulation | Y | Y |
| | NOTE | | Silver Paint=3% CH; Other various roof material=ND | | | |
| Ceiling | - | | Fiberglass insulation | ACM Roofing debris | n/a | n/a |
| Ceiling | 26 | | Roofing debris with silver paint | 12" ACT | Y | Y |
| | NOTE | | Silver Paint=3% CH; Other various roof material=ND | | | |
| Ceiling | 8 | | Acoustic ceiling tiles 12" uniform hole pattern (nailed) | wood slat | N | n/a |
| Ceiling | - | | Wood slats | ACM Roofing debris | n/a | n/a |
| Ceiling | 26 | | Roofing debris with silver paint | Wool batt insulation | Y | Y |
| | NOTE | | Silver Paint=3% CH; Other various roof material=ND | | | |
| Ceiling | 24 | | Wool-batt insulation glued (black) to paper backing | diagonal sheathing | N | n/a |

RED=contains asbestos

BLACK=no asbestos detected or non-suspect



YES Environmental, Inc.

1201 24th Street, Suite B110-377, Bakersfield, CA 93301 / (661) 527-0820

| | | | |
|------------------|---------------------------------|-------------------|----------|
| Building: | Building C - Rooms K1-K2, 22-25 | Room Name: | Exterior |
|------------------|---------------------------------|-------------------|----------|

| Component | HMR # | Sample # | Material Description | Substrate | ACM Y/N | Friable Y/N |
|-----------|-------|----------|------------------------------------------------------------------------------------------------------|-----------|------------|----------------|
| Ground | 38 | | Asphalt | | N | n/a |
| Ground | - | | Concrete - bare & exposed | | n/a | n/a |
| Walls | 35 | | Exterior stucco, painted & vapor barrier | | N | n/a |
| Windows | 28 | 28E-F | Exterior window putty | | N | n/a |
| Eaves | 35 | | Exterior stucco, painted | | N | n/a |
| Roof | 36 | 36D | White coated foam on silver paint on rolled composition roofing & Diagonal sheathing | | Y | N |
| | NOTE | | Foam=ND; Silver Paint=2-4% CH; Rolled Composition Roofing & Felts=ND | | | |
| Roof | 37 | | White coated foam on silver paint on penetration mastic | | Y | N |
| | NOTE | | Foam=ND; Silver Paint=2-4% CH; Mastics=Assumed | | | |
| | NOTE | | On components such as, but not limited to, roof jacks, roof vents, conduits, sleepers, patches, etc. | | | |

RED=contains asbestos

BLACK=no asbestos detected or non-suspect



YES Environmental, Inc.

1201 24th Street, Suite B110-377, Bakersfield, CA 93301 / (661) 527-0820

Client: Bakersfield City School District

Site: Wayside ES

YES Project No.: 23YES-05

Date of Inspection: 6/27/2023

Inspection Report

| | | | |
|-------------------------------------------------------------------------------------------------------------------------------------------------------------------------------------------------------------------------------------------------------------------------------------------------------------------------------------------------------------------------------------|------------------------------|-------------------|-------|
| Building: | Building D - Classrooms 6-11 | Room Name: | Attic |
| <p>Attic is defined as: every enclosed spaced that is contiguous and/or beneath the roof, attic, void, and plenum space above every room in this building including, but not limited to, exterior enclosed eaves, enclosed hallways, walkways, corridors, wall cavities, etc. and all spaces beneath the roof and above ceilings that are or are not readily accessible.</p> | | | |
| <p>Attic Floor is defined as: the surface within an attic space, serving as the ceiling for the room(s) below and/or an area with exposed joists. It is not a term that can be used to infer a walkable surface.</p> | | | |

| Component | HMR # | Sample # | Material Description | Substrate | ACM Y/N | Friable Y/N |
|--------------------|-------|----------|---------------------------------------------------------------------------------------------------------------------|-----------|------------|----------------|
| Attic Floor | 26 | | Roofing debris with silver paint | | Y | Y |
| | NOTE | | Silver Paint=3% CH; Other various roof material=ND material exists on and inbetween the floor joists of this space. | This | | |
| Attic Floor | - | | Fiberglass batt insulation | | Y | Y |
| | NOTE | | Contaminated with asbestos roofing debris | | | |
| Walls | - | | Wood | | n/a | n/a |
| Flue Pipes | | | Transite flue pipes - Known Asbestos Material (typically 10-20% Chrysotile) | | Y | N |
| Ceiling | - | | Diagonal sheathing | | n/a | n/a |

RED=contains asbestos

BLACK=no asbestos detected or non-suspect



YES Environmental, Inc.

1201 24th Street, Suite B110-377, Bakersfield, CA 93301 / (661) 527-0820

| | | | | | |
|------------------|------------------------------|-------------------------|------------------|---------------------------|-----|
| Building: | Building D - Classrooms 6-11 | Room Name: | Classroom 6 | Rm Ft²: | 960 |
| | | Room Dimensions: | L=32 W=30 H=9/12 | | |

| Component | HMR # | Sample # | Material Description | Substrate | ACM Y/N | Friable Y/N |
|-----------|-------|----------|----------------------------------------------------------|----------------------|------------|----------------|
| Floor | 1 | | Carpet & glue - grey/green/multi | Concrete | N | n/a |
| Floor | 2 | 02B | Carpet & glue - black/white speckled | Concrete | N | n/a |
| BB | 3 | 03D | Baseboard & glue 3" & 4" blue | wood | N | n/a |
| BB | - | | Wood baseboard | | n/a | n/a |
| Walls | 4 | | Plaster - sanded finish | | N | n/a |
| Walls | 5 | | Tackboards & glue | Plaster | N | n/a |
| Sink | 6 | 06C | Sink coating - black (stainless steel) | | N | n/a |
| Ceiling | 7 | | Lay-in panels - 2' x 4' gouge pinhole | ACM Roofing debris | N | n/a |
| Ceiling | 26 | | Roofing debris with silver paint | F/G insulation | Y | Y |
| | NOTE | | Silver Paint=3% CH; Other various roof material=ND | | | |
| Ceiling | - | | Fiberglass insulation | ACM Roofing debris | n/a | n/a |
| Ceiling | 26 | | Roofing debris with silver paint | 12" ACT | Y | Y |
| | NOTE | | Silver Paint=3% CH; Other various roof material=ND | | | |
| Ceiling | 8 | 08B | Acoustic ceiling tiles 12" uniform hole pattern (nailed) | wood slat | N | n/a |
| Ceiling | - | | Wood slats | ACM Roofing debris | n/a | n/a |
| Ceiling | 26 | | Roofing debris with silver paint | Wool batt insulation | Y | Y |
| | NOTE | | Silver Paint=3% CH; Other various roof material=ND | | | |
| Ceiling | 24 | 24A | Wool-batt insulation glued (black) to paper backing | diagonal sheathing | N | n/a |

RED=contains asbestos

BLACK=no asbestos detected or non-suspect



YES Environmental, Inc.

1201 24th Street, Suite B110-377, Bakersfield, CA 93301 / (661) 527-0820

| | | | | | |
|------------------|------------------------------|-------------------------|------------------|---------------------------|-----|
| Building: | Building D - Classrooms 6-11 | Room Name: | Classroom 7 | Rm Ft²: | 960 |
| | | Room Dimensions: | L=32 W=30 H=9/12 | | |

| Component | HMR # | Sample # | Material Description | Substrate | ACM Y/N | Friable Y/N |
|-----------|-------|----------|----------------------------------------------------------|----------------------|------------|----------------|
| Floor | 1 | 01A | Carpet & glue - grey/green/multi | Concrete | N | n/a |
| Floor | 2 | | Carpet & glue - black/white speckled | Concrete | N | n/a |
| BB | 3 | | Baseboard & glue 3" & 4" blue | wood | N | n/a |
| BB | - | | Wood baseboard | | n/a | n/a |
| Walls | 4 | 04G | Plaster - sanded finish | | N | n/a |
| Walls | 5 | | Tackboards & glue | Plaster | N | n/a |
| Sink | 6 | | Sink coating - black (stainless steel) | | N | n/a |
| Ceiling | 7 | 07B | Lay-in panels - 2' x 4' gouge pinhole | ACM Roofing debris | N | n/a |
| Ceiling | 26 | | Roofing debris with silver paint | F/G insulation | Y | Y |
| | NOTE | | Silver Paint=3% CH; Other various roof material=ND | | | |
| Ceiling | - | | Fiberglass insulation | ACM Roofing debris | n/a | n/a |
| Ceiling | 26 | | Roofing debris with silver paint | 12" ACT | Y | Y |
| | NOTE | | Silver Paint=3% CH; Other various roof material=ND | | | |
| Ceiling | 8 | | Acoustic ceiling tiles 12" uniform hole pattern (nailed) | wood slat | N | n/a |
| Ceiling | - | | Wood slats | ACM Roofing debris | n/a | n/a |
| Ceiling | 26 | | Roofing debris with silver paint | Wool batt insulation | Y | Y |
| | NOTE | | Silver Paint=3% CH; Other various roof material=ND | | | |
| Ceiling | 24 | | Wool-batt insulation glued (black) to paper backing | diagonal sheathing | N | n/a |

RED=contains asbestos

BLACK=no asbestos detected or non-suspect



YES Environmental, Inc.

1201 24th Street, Suite B110-377, Bakersfield, CA 93301 / (661) 527-0820

| | | | | | |
|------------------|------------------------------|-------------------------|------------------|---------------------------|-----|
| Building: | Building D - Classrooms 6-11 | Room Name: | Classroom 8 | Rm Ft²: | 960 |
| | | Room Dimensions: | L=32 W=30 H=9/12 | | |

| Component | HMR # | Sample # | Material Description | Substrate | ACM Y/N | Friable Y/N |
|-----------|-------|----------|----------------------------------------------------------|----------------------|------------|----------------|
| Floor | 1 | | Carpet & glue - grey/green/multi | Concrete | N | n/a |
| Floor | 2 | | Carpet & glue - black/white speckled | Concrete | N | n/a |
| BB | 3 | | Baseboard & glue 3" & 4" blue | wood | N | n/a |
| BB | - | | Wood baseboard | | n/a | n/a |
| Walls | 4 | 04H | Plaster - sanded finish | | N | n/a |
| Walls | 5 | | Tackboards & glue | Plaster | N | n/a |
| Sink | 6 | | Sink coating - black (stainless steel) | | N | n/a |
| Ceiling | 7 | | Lay-in panels - 2' x 4' gouge pinhole | ACM Roofing debris | N | n/a |
| Ceiling | 26 | | Roofing debris with silver paint | F/G insulation | Y | Y |
| | NOTE | | Silver Paint=3% CH; Other various roof material=ND | | | |
| Ceiling | - | | Fiberglass insulation | ACM Roofing debris | n/a | n/a |
| Ceiling | 26 | | Roofing debris with silver paint | 12" ACT | Y | Y |
| | NOTE | | Silver Paint=3% CH; Other various roof material=ND | | | |
| Ceiling | 8 | | Acoustic ceiling tiles 12" uniform hole pattern (nailed) | wood slat | N | n/a |
| Ceiling | - | | Wood slats | ACM Roofing debris | n/a | n/a |
| Ceiling | 26 | | Roofing debris with silver paint | Wool batt insulation | Y | Y |
| | NOTE | | Silver Paint=3% CH; Other various roof material=ND | | | |
| Ceiling | 24 | | Wool-batt insulation glued (black) to paper backing | diagonal sheathing | N | n/a |

RED=contains asbestos

BLACK=no asbestos detected or non-suspect



YES Environmental, Inc.

1201 24th Street, Suite B110-377, Bakersfield, CA 93301 / (661) 527-0820

| | | | | | |
|------------------|------------------------------|-------------------------|------------------|---------------------------|-----|
| Building: | Building D - Classrooms 6-11 | Room Name: | Classroom 9 | Rm Ft²: | 960 |
| | | Room Dimensions: | L=32 W=30 H=9/12 | | |

| Component | HMR # | Sample # | Material Description | Substrate | ACM Y/N | Friable Y/N |
|-----------|-------|----------|----------------------------------------------------------|----------------------|------------|----------------|
| Floor | 1 | | Carpet & glue - grey/green/multi | Concrete | N | n/a |
| Floor | 2 | | Carpet & glue - black/white speckled | Concrete | N | n/a |
| BB | 3 | | Baseboard & glue 3" & 4" blue | wood | N | n/a |
| BB | - | | Wood baseboard | | n/a | n/a |
| Walls | 4 | | Plaster - sanded finish | | N | n/a |
| Walls | 5 | 05D | Tackboards & glue | Plaster | N | n/a |
| Sink | 6 | | Sink coating - black (stainless steel) | | N | n/a |
| Ceiling | 7 | | Lay-in panels - 2' x 4' gouge pinhole | ACM Roofing debris | N | n/a |
| Ceiling | 26 | | Roofing debris with silver paint | F/G insulation | Y | Y |
| | NOTE | | Silver Paint=3% CH; Other various roof material=ND | | | |
| Ceiling | - | | Fiberglass insulation | ACM Roofing debris | n/a | n/a |
| Ceiling | 26 | | Roofing debris with silver paint | 12" ACT | Y | Y |
| | NOTE | | Silver Paint=3% CH; Other various roof material=ND | | | |
| Ceiling | 8 | 08C | Acoustic ceiling tiles 12" uniform hole pattern (nailed) | wood slat | N | n/a |
| Ceiling | - | | Wood slats | ACM Roofing debris | n/a | n/a |
| Ceiling | 26 | | Roofing debris with silver paint | Wool batt insulation | Y | Y |
| | NOTE | | Silver Paint=3% CH; Other various roof material=ND | | | |
| Ceiling | 24 | | Wool-batt insulation glued (black) to paper backing | diagonal sheathing | N | n/a |

RED=contains asbestos

BLACK=no asbestos detected or non-suspect



YES Environmental, Inc.

1201 24th Street, Suite B110-377, Bakersfield, CA 93301 / (661) 527-0820

| | | | | | |
|------------------|------------------------------|-------------------------|------------------|---------------------------|-----|
| Building: | Building D - Classrooms 6-11 | Room Name: | Classroom 10 | Rm Ft²: | 960 |
| | | Room Dimensions: | L=32 W=30 H=9/12 | | |

| Component | HMR # | Sample # | Material Description | Substrate | ACM Y/N | Friable Y/N |
|-----------|-------|----------|----------------------------------------------------------|----------------------|------------|----------------|
| Floor | 1 | | Carpet & glue - grey/green/multi | Concrete | N | n/a |
| Floor | 2 | | Carpet & glue - black/white speckled | Concrete | N | n/a |
| BB | 3 | 03A | Baseboard & glue 3" & 4" blue | wood | N | n/a |
| BB | - | | Wood baseboard | | n/a | n/a |
| Walls | 4 | | Plaster - sanded finish | | N | n/a |
| Walls | 5 | | Tackboards & glue | Plaster | N | n/a |
| Sink | 6 | | Sink coating - black (stainless steel) | | N | n/a |
| Ceiling | 7 | 07D | Lay-in panels - 2' x 4' gouge pinhole | ACM Roofing debris | N | n/a |
| Ceiling | 26 | | Roofing debris with silver paint | F/G insulation | Y | Y |
| | NOTE | | Silver Paint=3% CH; Other various roof material=ND | | | |
| Ceiling | - | | Fiberglass insulation | ACM Roofing debris | n/a | n/a |
| Ceiling | 26 | 26A | Roofing debris with silver paint | 12" ACT | Y | Y |
| | NOTE | | Silver Paint=3% CH; Other various roof material=ND | | | |
| Ceiling | 8 | | Acoustic ceiling tiles 12" uniform hole pattern (nailed) | wood slat | N | n/a |
| Ceiling | - | | Wood slats | ACM Roofing debris | n/a | n/a |
| Ceiling | 26 | | Roofing debris with silver paint | Wool batt insulation | Y | Y |
| | NOTE | | Silver Paint=3% CH; Other various roof material=ND | | | |
| Ceiling | 24 | 24B | Wool-batt insulation glued (black) to paper backing | diagonal sheathing | N | n/a |

RED=contains asbestos

BLACK=no asbestos detected or non-suspect



YES Environmental, Inc.

1201 24th Street, Suite B110-377, Bakersfield, CA 93301 / (661) 527-0820

| | | | | | |
|------------------|------------------------------|-------------------------|------------------|---------------------------|-----|
| Building: | Building D - Classrooms 6-11 | Room Name: | Classroom 11 | Rm Ft²: | 960 |
| | | Room Dimensions: | L=32 W=30 H=9/12 | | |

| Component | HMR # | Sample # | Material Description | Substrate | ACM Y/N | Friable Y/N |
|-----------|-------|----------|----------------------------------------------------------|----------------------|------------|----------------|
| Floor | 1 | | Carpet & glue - grey/green/multi | Concrete | N | n/a |
| Floor | 2 | | Carpet & glue - black/white speckled | Concrete | N | n/a |
| BB | 3 | | Baseboard & glue 3" & 4" blue | wood | N | n/a |
| BB | - | | Wood baseboard | | n/a | n/a |
| Walls | 4 | 04E | Plaster - sanded finish | | N | n/a |
| Walls | 5 | | Tackboards & glue | Plaster | N | n/a |
| Sink | 6 | | Sink coating - black (stainless steel) | | N | n/a |
| Ceiling | 7 | | Lay-in panels - 2' x 4' gouge pinhole | ACM Roofing debris | N | n/a |
| Ceiling | 26 | | Roofing debris with silver paint | F/G insulation | Y | Y |
| | NOTE | | Silver Paint=3% CH; Other various roof material=ND | | | |
| Ceiling | - | | Fiberglass insulation | ACM Roofing debris | n/a | n/a |
| Ceiling | 26 | | Roofing debris with silver paint | 12" ACT | Y | Y |
| | NOTE | | Silver Paint=3% CH; Other various roof material=ND | | | |
| Ceiling | 8 | | Acoustic ceiling tiles 12" uniform hole pattern (nailed) | wood slat | N | n/a |
| Ceiling | - | | Wood slats | ACM Roofing debris | n/a | n/a |
| Ceiling | 26 | | Roofing debris with silver paint | Wool batt insulation | Y | Y |
| | NOTE | | Silver Paint=3% CH; Other various roof material=ND | | | |
| Ceiling | 24 | | Wool-batt insulation glued (black) to paper backing | diagonal sheathing | N | n/a |

RED=contains asbestos

BLACK=no asbestos detected or non-suspect



YES Environmental, Inc.

1201 24th Street, Suite B110-377, Bakersfield, CA 93301 / (661) 527-0820

| | | | |
|------------------|------------------------------|-------------------|----------|
| Building: | Building D - Classrooms 6-11 | Room Name: | Exterior |
|------------------|------------------------------|-------------------|----------|

| Component | HMR # | Sample # | Material Description | Substrate | ACM Y/N | Friable Y/N |
|-----------|-------|----------|------------------------------------------------------------------------------------------------------|-----------|------------|----------------|
| Ground | 38 | | Asphalt | | N | n/a |
| Ground | - | | Concrete - bare & exposed | | n/a | n/a |
| Walls | 35 | | Exterior stucco, painted & vapor barrier | | N | n/a |
| Windows | 28 | 28G-H | Exterior window putty | | N | n/a |
| Eaves | 35 | 35C | Exterior stucco, painted | | N | n/a |
| Roof | 36 | | White coated foam on silver paint on rolled composition roofing & Diagonal sheathing | | Y | N |
| | NOTE | | Foam=ND; Silver Paint=2-4% CH; Rolled Composition Roofing & Felts=ND | | | |
| Roof | 37 | | White coated foam on silver paint on penetration mastic | | Y | N |
| | NOTE | | Foam=ND; Silver Paint=2-4% CH; Mastics=Assumed | | | |
| | NOTE | | On components such as, but not limited to, roof jacks, roof vents, conduits, sleepers, patches, etc. | | | |

RED=contains asbestos

BLACK=no asbestos detected or non-suspect



YES Environmental, Inc.

1201 24th Street, Suite B110-377, Bakersfield, CA 93301 / (661) 527-0820

Client: Bakersfield City School District

Site: Wayside ES

YES Project No.: 23YES-05

Date of Inspection: 6/27/2023

Inspection Report

| | | | |
|-------------------------------------------------------------------------------------------------------------------------------------------------------------------------------------------------------------------------------------------------------------------------------------------------------------------------------------------------------------------------------------|-------------------------------|-------------------|-------|
| Building: | Building E - Classrooms 17-21 | Room Name: | Attic |
| <p>Attic is defined as: every enclosed spaced that is contiguous and/or beneath the roof, attic, void, and plenum space above every room in this building including, but not limited to, exterior enclosed eaves, enclosed hallways, walkways, corridors, wall cavities, etc. and all spaces beneath the roof and above ceilings that are or are not readily accessible.</p> | | | |
| <p>Attic Floor is defined as: the surface within an attic space, serving as the ceiling for the room(s) below and/or an area with exposed joists. It is not a term that can be used to infer a walkable surface.</p> | | | |

| Component | HMR # | Sample # | Material Description | Substrate | ACM Y/N | Friable Y/N |
|--------------------|-------|----------|---------------------------------------------------------------------------------------------------------------------|-----------|------------|----------------|
| Attic Floor | 26 | | Roofing debris with silver paint | | Y | Y |
| | NOTE | | Silver Paint=3% CH; Other various roof material=ND material exists on and inbetween the floor joists of this space. | This | | |
| Attic Floor | - | | Fiberglass batt insulation | | Y | Y |
| | NOTE | | Contaminated with asbestos roofing debris | | | |
| Walls | - | | Wood | | n/a | n/a |
| Flue Pipes | | | Transite flue pipes - Known Asbestos Material (typically 10-20% Chrysotile) | | Y | N |
| Ceiling | - | | Diagonal sheathing | | n/a | n/a |

RED=contains asbestos

BLACK=no asbestos detected or non-suspect



YES Environmental, Inc.

1201 24th Street, Suite B110-377, Bakersfield, CA 93301 / (661) 527-0820

| | | |
|-------------------------------------------------------------------|---------------------------------------|-------------------------------|
| Building: Building E - Classrooms 17-21 West of Room 17 | Room Name: Boys' Restroom | Rm Ft²: 286 |
| | Room Dimensions: L=22 W=13 H=9 | |

| Component | HMR # | Sample # | Material Description | Substrate | ACM Y/N | Friable Y/N |
|-----------|------------|----------|----------------------------------------------------------------------------------------|--------------------|------------|----------------|
| Floor | 9 | 09A | Ceramic floor tile grout (2" grey) | | N | n/a |
| BB | | | None | | | |
| Walls | 10 NOTE | 10A | Ceramic wall tile grout - blue (4" white) AFF 6' | Plaster | N | n/a |
| Walls | 4 | | Plaster - sanded finish | | N | n/a |
| Ceiling | 4 | | Plaster - sanded finish | ACM Roofing debris | N | n/a |
| Ceiling | 26 NOTE | | Roofing debris with silver paint Silver Paint=3% CH; Other various roof material=ND | | Y | Y |

| | | |
|-------------------------------------------------------------------|---------------------------------------|-------------------------------|
| Building: Building E - Classrooms 17-21 West of Room 17 | Room Name: Girls' Restroom | Rm Ft²: 286 |
| | Room Dimensions: L=22 W=13 H=9 | |

| Component | HMR # | Sample # | Material Description | Substrate | ACM Y/N | Friable Y/N |
|-----------|------------|----------|----------------------------------------------------------------------------------------|--------------------|------------|----------------|
| Floor | 9 | | Ceramic floor tile grout (2" grey) | | N | n/a |
| BB | | | None | | | |
| Walls | 10 NOTE | | Ceramic wall tile grout - blue (4" white) AFF 6' | Plaster | N | n/a |
| Walls | 4 | | Plaster - sanded finish | | N | n/a |
| Ceiling | 4 | | Plaster - sanded finish | ACM Roofing debris | N | n/a |
| Ceiling | 26 NOTE | | Roofing debris with silver paint Silver Paint=3% CH; Other various roof material=ND | | Y | Y |

RED=contains asbestos

BLACK=no asbestos detected or non-suspect



YES Environmental, Inc.

1201 24th Street, Suite B110-377, Bakersfield, CA 93301 / (661) 527-0820

| Building: Building E - Classrooms 17-21 | | Room Name: Custodial Room | | Rm Ft²: 30 | | |
|------------------------------------------------|-------|----------------------------------------|----------------------------------------------------|------------------------------|------------|----------------|
| West of Room 17 | | Room Dimensions: L=30 W=10 H=12 | | | | |
| Component | HMR # | Sample # | Material Description | Substrate | ACM Y/N | Friable Y/N |
| Floor | - | | Concrete - bare & exposed | | N | n/a |
| BB | | | None | | n/a | n/a |
| Walls | 4 | | Plaster - sanded finish | | N | n/a |
| Ceiling | 4 | 04D | Plaster - sanded finish | ACM Roofing debris | N | n/a |
| Ceiling | 26 | | Roofing debris with silver paint | | Y | Y |
| | NOTE | | Silver Paint=3% CH; Other various roof material=ND | | | |

RED=contains asbestos

BLACK=no asbestos detected or non-suspect



YES Environmental, Inc.

1201 24th Street, Suite B110-377, Bakersfield, CA 93301 / (661) 527-0820

| | | | | | |
|------------------|-------------------------------|-------------------------|--------------------|---------------------------|-----|
| Building: | Building E - Classrooms 17-21 | Room Name: | Classroom 17 (Lib) | Rm Ft²: | 960 |
| | | Room Dimensions: | L=32 W=30 H=9/12 | | |

| Component | HMR # | Sample # | Material Description | Substrate | ACM Y/N | Friable Y/N |
|-----------|-------|----------|----------------------------------------------------------|----------------------|------------|----------------|
| Floor | 18 | 18A | Carpet squares & glue - multi bright colored | Concrete | N | n/a |
| Floor | 19 | 19A | Carpet & glue - black/white speckled | Concrete | N | n/a |
| BB | 20 | 20A | Baseboard & glue 4" black | | N | n/a |
| Walls | 4 | | Plaster - sanded finish | | N | n/a |
| Walls | 21 | 21A | Drywall, smooth texture | | N | n/a |
| | NOTE | | Confirmed at north and west walls. | | | |
| Walls | 5 | | Tackboards & glue | Plaster | N | n/a |
| Ceiling | 7 | | Lay-in panels - 2' x 4' gouge pinhole | ACM Roofing debris | N | n/a |
| Ceiling | 26 | 26B | Roofing debris with silver paint | F/G insulation | Y | Y |
| | NOTE | | Silver Paint=3% CH; Other various roof material=ND | | | |
| Ceiling | - | | Fiberglass insulation | ACM Roofing debris | n/a | n/a |
| Ceiling | 26 | | Roofing debris with silver paint | 12" ACT | Y | Y |
| | NOTE | | Silver Paint=3% CH; Other various roof material=ND | | | |
| Ceiling | 8 | 08G | Acoustic ceiling tiles 12" uniform hole pattern (nailed) | wood slat | N | n/a |
| Ceiling | - | | Wood slats | ACM Roofing debris | n/a | n/a |
| Ceiling | 26 | | Roofing debris with silver paint | Wool batt insulation | Y | Y |
| | NOTE | | Silver Paint=3% CH; Other various roof material=ND | | | |
| Ceiling | 24 | | Wool-batt insulation glued (black) to paper backing | diagonal sheathing | N | n/a |

RED=contains asbestos

BLACK=no asbestos detected or non-suspect



YES Environmental, Inc.

1201 24th Street, Suite B110-377, Bakersfield, CA 93301 / (661) 527-0820

| | | | | | |
|------------------|-------------------------------|-------------------------|------------------|---------------------------|-----|
| Building: | Building E - Classrooms 17-21 | Room Name: | Classroom 18 | Rm Ft²: | 960 |
| | | Room Dimensions: | L=32 W=30 H=9/12 | | |

| Component | HMR # | Sample # | Material Description | Substrate | ACM Y/N | Friable Y/N |
|-----------|-------|----------|----------------------------------------------------------|----------------------|------------|----------------|
| Floor | 1 | 01D | Carpet & glue - grey/green/multi | Concrete | N | n/a |
| Floor | 2 | | Carpet & glue - black/white speckled | Concrete | N | n/a |
| BB | 22 | 22A | Baseboard & glue 3" & 4" tan | wood | N | n/a |
| BB | - | | Wood baseboard | | n/a | n/a |
| Walls | 4 | 04M | Plaster - sanded finish | | N | n/a |
| Walls | 5 | | Tackboards & glue | Plaster | N | n/a |
| Sink | 6 | | Sink coating - black (stainless steel) | | N | n/a |
| Ceiling | 7 | 07G | Lay-in panels - 2' x 4' gouge pinhole | ACM Roofing debris | N | n/a |
| Ceiling | 26 | | Roofing debris with silver paint | F/G insulation | Y | Y |
| | NOTE | | Silver Paint=3% CH; Other various roof material=ND | | | |
| Ceiling | - | | Fiberglass insulation | ACM Roofing debris | n/a | n/a |
| Ceiling | 26 | | Roofing debris with silver paint | 12" ACT | Y | Y |
| | NOTE | | Silver Paint=3% CH; Other various roof material=ND | | | |
| Ceiling | 8 | | Acoustic ceiling tiles 12" uniform hole pattern (nailed) | wood slat | N | n/a |
| Ceiling | - | | Wood slats | ACM Roofing debris | n/a | n/a |
| Ceiling | 26 | | Roofing debris with silver paint | Wool batt insulation | Y | Y |
| | NOTE | | Silver Paint=3% CH; Other various roof material=ND | | | |
| Ceiling | 24 | | Wool-batt insulation glued (black) to paper backing | diagonal sheathing | N | n/a |

RED=contains asbestos

BLACK=no asbestos detected or non-suspect



YES Environmental, Inc.

1201 24th Street, Suite B110-377, Bakersfield, CA 93301 / (661) 527-0820

| | | | | | |
|------------------|-------------------------------|-------------------------|------------------|---------------------------|-----|
| Building: | Building E - Classrooms 17-21 | Room Name: | Classroom 19 | Rm Ft²: | 960 |
| | | Room Dimensions: | L=32 W=30 H=9/12 | | |

| Component | HMR # | Sample # | Material Description | Substrate | ACM Y/N | Friable Y/N |
|-----------|-------|----------|----------------------------------------------------------|----------------------|------------|----------------|
| Floor | 1 | | Carpet & glue - grey/green/multi | Concrete | N | n/a |
| Floor | 2 | | Carpet & glue - black/white speckled | Concrete | N | n/a |
| BB | 22 | | Baseboard & glue 3" & 4" tan | wood | N | n/a |
| BB | - | | Wood baseboard | | n/a | n/a |
| Walls | 4 | | Plaster - sanded finish | | N | n/a |
| Walls | 5 | | Tackboards & glue | Plaster | N | n/a |
| Sink | 6 | 06A | Sink coating - black (stainless steel) | | N | n/a |
| Ceiling | 7 | | Lay-in panels - 2' x 4' gouge pinhole | ACM Roofing debris | N | n/a |
| Ceiling | 26 | | Roofing debris with silver paint | F/G insulation | Y | Y |
| | NOTE | | Silver Paint=3% CH; Other various roof material=ND | | | |
| Ceiling | - | | Fiberglass insulation | ACM Roofing debris | n/a | n/a |
| Ceiling | 26 | | Roofing debris with silver paint | 12" ACT | Y | Y |
| | NOTE | | Silver Paint=3% CH; Other various roof material=ND | | | |
| Ceiling | 8 | 08H | Acoustic ceiling tiles 12" uniform hole pattern (nailed) | wood slat | N | n/a |
| Ceiling | - | | Wood slats | ACM Roofing debris | n/a | n/a |
| Ceiling | 26 | | Roofing debris with silver paint | Wool batt insulation | Y | Y |
| | NOTE | | Silver Paint=3% CH; Other various roof material=ND | | | |
| Ceiling | 24 | | Wool-batt insulation glued (black) to paper backing | diagonal sheathing | N | n/a |

RED=contains asbestos

BLACK=no asbestos detected or non-suspect



YES Environmental, Inc.

1201 24th Street, Suite B110-377, Bakersfield, CA 93301 / (661) 527-0820

| | | | | | |
|------------------|-------------------------------|-------------------------|------------------|---------------------------|-----|
| Building: | Building E - Classrooms 17-21 | Room Name: | Classroom 20 | Rm Ft²: | 960 |
| | | Room Dimensions: | L=32 W=30 H=9/12 | | |

| Component | HMR # | Sample # | Material Description | Substrate | ACM Y/N | Friable Y/N |
|-----------|-------|----------|----------------------------------------------------------|----------------------|------------|----------------|
| Floor | 1 | | Carpet & glue - grey/green/multi | Concrete | N | n/a |
| Floor | 2 | 02C | Carpet & glue - black/white speckled | Concrete | N | n/a |
| BB | 22 | | Baseboard & glue 3" & 4" tan | wood | N | n/a |
| BB | - | | Wood baseboard | | n/a | n/a |
| Walls | 4 | | Plaster - sanded finish | | N | n/a |
| Walls | 5 | | Tackboards & glue | Plaster | N | n/a |
| Sink | 6 | | Sink coating - black (stainless steel) | | N | n/a |
| Ceiling | 7 | 07H | Lay-in panels - 2' x 4' gouge pinhole | ACM Roofing debris | N | n/a |
| Ceiling | 26 | | Roofing debris with silver paint | F/G insulation | Y | Y |
| | NOTE | | Silver Paint=3% CH; Other various roof material=ND | | | |
| Ceiling | - | | Fiberglass insulation | ACM Roofing debris | n/a | n/a |
| Ceiling | 26 | | Roofing debris with silver paint | 12" ACT | Y | Y |
| | NOTE | | Silver Paint=3% CH; Other various roof material=ND | | | |
| Ceiling | 8 | | Acoustic ceiling tiles 12" uniform hole pattern (nailed) | wood slat | N | n/a |
| Ceiling | - | | Wood slats | ACM Roofing debris | n/a | n/a |
| Ceiling | 26 | | Roofing debris with silver paint | Wool batt insulation | Y | Y |
| | NOTE | | Silver Paint=3% CH; Other various roof material=ND | | | |
| Ceiling | 24 | | Wool-batt insulation glued (black) to paper backing | diagonal sheathing | N | n/a |

RED=contains asbestos

BLACK=no asbestos detected or non-suspect



YES Environmental, Inc.

1201 24th Street, Suite B110-377, Bakersfield, CA 93301 / (661) 527-0820

| | | | | | |
|------------------|-------------------------------|-------------------------|------------------|---------------------------|-----|
| Building: | Building E - Classrooms 17-21 | Room Name: | Classroom 21 | Rm Ft²: | 960 |
| | | Room Dimensions: | L=32 W=30 H=9/12 | | |

| Component | HMR # | Sample # | Material Description | Substrate | ACM Y/N | Friable Y/N |
|-----------|-------|----------|----------------------------------------------------------|----------------------|------------|----------------|
| Floor | 1 | | Carpet & glue - grey/green/multi | Concrete | N | n/a |
| Floor | 2 | | Carpet & glue - black/white speckled | Concrete | N | n/a |
| BB | 3 | | Baseboard & glue 3" & 4" blue | wood | N | n/a |
| BB | - | | Wood baseboard | | n/a | n/a |
| Walls | 4 | 04L | Plaster - sanded finish | | N | n/a |
| Walls | 5 | 05B | Tackboards & glue | Plaster | N | n/a |
| Sink | 6 | | Sink coating - black (stainless steel) | | N | n/a |
| Ceiling | 7 | | Lay-in panels - 2' x 4' gouge pinhole | ACM Roofing debris | N | n/a |
| Ceiling | 26 | | Roofing debris with silver paint | F/G insulation | Y | Y |
| | NOTE | | Silver Paint=3% CH; Other various roof material=ND | | | |
| Ceiling | - | | Fiberglass insulation | ACM Roofing debris | n/a | n/a |
| Ceiling | 26 | | Roofing debris with silver paint | 12" ACT | Y | Y |
| | NOTE | | Silver Paint=3% CH; Other various roof material=ND | | | |
| Ceiling | 8 | | Acoustic ceiling tiles 12" uniform hole pattern (nailed) | wood slat | N | n/a |
| Ceiling | - | | Wood slats | ACM Roofing debris | n/a | n/a |
| Ceiling | 26 | | Roofing debris with silver paint | Wool batt insulation | Y | Y |
| | NOTE | | Silver Paint=3% CH; Other various roof material=ND | | | |
| Ceiling | 24 | | Wool-batt insulation glued (black) to paper backing | diagonal sheathing | N | n/a |

RED=contains asbestos

BLACK=no asbestos detected or non-suspect



YES Environmental, Inc.

1201 24th Street, Suite B110-377, Bakersfield, CA 93301 / (661) 527-0820

| | | | |
|------------------|-------------------------------|-------------------|----------|
| Building: | Building E - Classrooms 17-21 | Room Name: | Exterior |
|------------------|-------------------------------|-------------------|----------|

| Component | HMR # | Sample # | Material Description | Substrate | ACM Y/N | Friable Y/N |
|-----------|-------|----------|------------------------------------------------------------------------------------------------------|-----------|------------|----------------|
| Ground | 38 | | Asphalt | | N | n/a |
| Ground | - | | Concrete - bare & exposed | | n/a | n/a |
| Walls | 35 | | Exterior stucco, painted & vapor barrier | | N | n/a |
| Windows | 28 | 28I-J | Exterior window putty | | N | n/a |
| Eaves | 35 | 35D | Exterior stucco, painted | | N | n/a |
| Roof | 36 | 36B | White coated foam on silver paint on rolled composition roofing & Diagonal sheathing | | Y | N |
| | NOTE | | Foam=ND; Silver Paint=2-4% CH; Rolled Composition Roofing & Felts=ND | | | |
| Roof | 37 | | White coated foam on silver paint on penetration mastic | | Y | N |
| | NOTE | | Foam=ND; Silver Paint=2-4% CH; Mastics=Assumed | | | |
| | NOTE | | On components such as, but not limited to, roof jacks, roof vents, conduits, sleepers, patches, etc. | | | |

RED=contains asbestos

BLACK=no asbestos detected or non-suspect



YES Environmental, Inc.

1201 24th Street, Suite B110-377, Bakersfield, CA 93301 / (661) 527-0820

Client: Bakersfield City School District

Site: Wayside ES

YES Project No.: 23YES-05

Date of Inspection: 6/27/2023

Inspection Report

| | | | |
|-------------------------------------------------------------------------------------------------------------------------------------------------------------------------------------------------------------------------------------------------------------------------------------------------------------------------------------------------------------------------------------|-------------------------------------|-------------------|-------|
| Building: | Building F - Multi-Purpose Building | Room Name: | Attic |
| <p>Attic is defined as: every enclosed spaced that is contiguous and/or beneath the roof, attic, void, and plenum space above every room in this building including, but not limited to, exterior enclosed eaves, enclosed hallways, walkways, corridors, wall cavities, etc. and all spaces beneath the roof and above ceilings that are or are not readily accessible.</p> | | | |
| <p>Attic Floor is defined as: the surface within an attic space, serving as the ceiling for the room(s) below and/or an area with exposed joists. It is not a term that can be used to infer a walkable surface.</p> | | | |

| Component | HMR # | Sample # | Material Description | Substrate | ACM Y/N | Friable Y/N |
|--------------------|-------|----------|------------------------------------------------------------------------------------------------------------------------|-----------|------------|----------------|
| Attic Floor | 26 | | Roofing debris with silver paint | | Y | Y |
| | NOTE | | Silver Paint=3% CH; Other various roof material=ND material exists on and inbetween the floor joists of this space. | This | | |
| Attic Floor | - | | Fiberglass batt insulation | | Y | Y |
| | NOTE | | Contaminated with asbestos roofing debris | | | |
| Walls | - | | Wood | | n/a | n/a |
| Flue Pipes | | | Transite flue pipes - Known Asbestos Material (typically 10-20% Chrysotile) | | Y | N |
| Ceiling | - | | Diagonal sheathing | | n/a | n/a |

RED=contains asbestos

BLACK=no asbestos detected or non-suspect



YES Environmental, Inc.

1201 24th Street, Suite B110-377, Bakersfield, CA 93301 / (661) 527-0820

| Building: | | Building F - Multi-Purpose Building | | Room Name: Representative of ceilings throughout | | |
|------------------|--------------|-------------------------------------|----------------------------------------------------------|---------------------------------------------------------|------------|------------|
| Component | HMR # | Sample # | Material Description | Substrate | Y/N | Y/N |
| Walls | 4 | | Plaster - sanded finish | | N | n/a |
| Walls | 5 | | Tackboards & glue | | N | n/a |
| Ceiling | 7 | | Lay-in panels - 2' x 4' gouge pinhole | ACM Roofing debris | N | n/a |
| Ceiling | 26 | | Roofing debris with silver paint | F/G insulation | Y | Y |
| | NOTE | | Silver Paint=3% CH; Other various roof material=ND | | | |
| Ceiling | - | | Fiberglass insulation | ACM Roofing debris | n/a | n/a |
| Ceiling | 26 | | Roofing debris with silver paint | 12" ACT | Y | Y |
| | NOTE | | Silver Paint=3% CH; Other various roof material=ND | | | |
| Ceiling | 8 | | Acoustic ceiling tiles 12" uniform hole pattern (nailed) | Plaster | N | n/a |
| Ceiling | 27 | | Plaster, Rough Finish | ACM Roofing debris | N | n/a |
| Ceiling | 26 | | Roofing debris with silver paint | Wool batt insulation | Y | Y |
| | NOTE | | Silver Paint=3% CH; Other various roof material=ND | | | |
| Ceiling | 24 | | Wool-batt insulation glued (black) to paper backing | diagonal sheathing | N | n/a |

RED=contains asbestos

BLACK=no asbestos detected or non-suspect



YES Environmental, Inc.

1201 24th Street, Suite B110-377, Bakersfield, CA 93301 / (661) 527-0820

| | | | | | |
|------------------|-------------------------------------|-------------------------|--------------------------|---------------------------|-------|
| Building: | Building F - Multi-Purpose Building | Room Name: | Main Dining Room | Rm Ft²: | 3,600 |
| | | Room Dimensions: | L=72 W=50 H=12 | | |

| Component | HMR # | Sample # | Material Description | Substrate | ACM Y/N | Friable Y/N |
|-----------|-------|----------|----------------------------------------------------------|----------------------|------------|----------------|
| Floor | 13 | 13B | Floor tile & glue 12" blue/grey oatmeal | Concrete | N | n/a |
| BB | 3 | | Baseboard & glue 3" & 4" blue | | N | n/a |
| Walls | 4 | 04N | Plaster - sanded finish | | N | n/a |
| Walls | 5 | | Tackboards & glue | | N | n/a |
| Ceiling | 7 | 07I | Lay-in panels - 2' x 4' gouge pinhole | ACM Roofing debris | N | n/a |
| Ceiling | 26 | | Roofing debris with silver paint | F/G insulation | Y | Y |
| | NOTE | | Silver Paint=3% CH; Other various roof material=ND | | | |
| Ceiling | - | | Fiberglass insulation | ACM Roofing debris | n/a | n/a |
| Ceiling | 26 | | Roofing debris with silver paint | 12" ACT | Y | Y |
| | NOTE | | Silver Paint=3% CH; Other various roof material=ND | | | |
| Ceiling | 8 | | Acoustic ceiling tiles 12" uniform hole pattern (nailed) | Plaster | N | n/a |
| Ceiling | 27 | 27A | Plaster, Rough Finish | ACM Roofing debris | N | n/a |
| Ceiling | 26 | | Roofing debris with silver paint | Wool batt insulation | Y | Y |
| | NOTE | | Silver Paint=3% CH; Other various roof material=ND | | | |
| Ceiling | 24 | 24C | Wool-batt insulation glued (black) to paper backing | diagonal sheathing | N | n/a |

RED=contains asbestos

BLACK=no asbestos detected or non-suspect



YES Environmental, Inc.

1201 24th Street, Suite B110-377, Bakersfield, CA 93301 / (661) 527-0820

| | | | |
|------------------|-------------------------------------|-------------------|----------|
| Building: | Building F - Multi-Purpose Building | Room Name: | Exterior |
|------------------|-------------------------------------|-------------------|----------|

| Component | HMR # | Sample # | Material Description | Substrate | ACM Y/N | Friable Y/N |
|-----------|-------|----------|------------------------------------------------------------------------------------------------------|-----------|------------|----------------|
| Ground | 38 | | Asphalt | | N | n/a |
| Ground | - | | Concrete - bare & exposed | | n/a | n/a |
| Walls | 35 | | Exterior stucco, painted & vapor barrier | | N | n/a |
| Windows | 28 | | Exterior window putty | | N | n/a |
| Eaves | 35 | 35F | Exterior stucco, painted | | N | n/a |
| Roof | 36 | 36C | White coated foam on silver paint on rolled composition roofing & Diagonal sheathing | | Y | N |
| | NOTE | | Foam=ND; Silver Paint=2-4% CH; Rolled Composition Roofing & Felts=ND | | | |
| Roof | 37 | | White coated foam on silver paint on penetration mastic | | Y | N |
| | NOTE | | Foam=ND; Silver Paint=2-4% CH; Mastics=Assumed | | | |
| | NOTE | | On components such as, but not limited to, roof jacks, roof vents, conduits, sleepers, patches, etc. | | | |

RED=contains asbestos

BLACK=no asbestos detected or non-suspect



YES Environmental, Inc.

1201 24th Street, Suite B110-377, Bakersfield, CA 93301 / (661) 527-0820

Client: Bakersfield City School District

Site: Wayside ES

YES Project No.: 23YES-05

Date of Inspection: 6/27/2023

Inspection Report

| | | | |
|-------------------------------------------------------------------------------------------------------------------------------------------------------------------------------------------------------------------------------------------------------------------------------------------------------------------------------------------------------------------------------------|---------------------------------|-------------------|-------|
| Building: | Building G - Book Room Building | Room Name: | Attic |
| <p>Attic is defined as: every enclosed spaced that is contiguous and/or beneath the roof, attic, void, and plenum space above every room in this building including, but not limited to, exterior enclosed eaves, enclosed hallways, walkways, corridors, wall cavities, etc. and all spaces beneath the roof and above ceilings that are or are not readily accessible.</p> | | | |
| <p>Attic Floor is defined as: the surface within an attic space, serving as the ceiling for the room(s) below and/or an area with exposed joists. It is not a term that can be used to infer a walkable surface.</p> | | | |

| Component | HMR # | Sample # | Material Description | Substrate | ACM Y/N | Friable Y/N |
|--------------------|-------|----------|---------------------------------------------------------------------------------------------------------------------|-----------|------------|----------------|
| Attic Floor | 26 | | Roofing debris with silver paint | | Y | Y |
| | NOTE | | Silver Paint=3% CH; Other various roof material=ND material exists on and inbetween the floor joists of this space. | This | | |
| Attic Floor | - | | Fiberglass batt insulation | | Y | Y |
| | NOTE | | Contaminated with asbestos roofing debris | | | |
| Walls | - | | Wood | | n/a | n/a |
| Flue Pipes | | | Transite flue pipes - Known Asbestos Material (typically 10-20% Chrysotile) | | Y | N |
| Ceiling | - | | Diagonal sheathing | | n/a | n/a |

RED=contains asbestos

BLACK=no asbestos detected or non-suspect



YES Environmental, Inc.

1201 24th Street, Suite B110-377, Bakersfield, CA 93301 / (661) 527-0820

| | | | | | |
|------------------|---------------------------------|-------------------------|---------------------|---------------------------|-----|
| Building: | Building G - Book Room Building | Room Name: | West Boys' Restroom | Rm Ft²: | 140 |
| | | Room Dimensions: | L=14 W=10 H=9 | | |

| Component | HMR # | Sample # | Material Description | Substrate | ACM Y/N | Friable Y/N |
|-----------|-------|----------|----------------------------------------------------|--------------------|------------|----------------|
| Floor | 9 | 09C | Ceramic floor tile grout (2" grey) | | N | n/a |
| BB | | | None | | | |
| Walls | 10 | | Ceramic wall tile grout - blue (4" white) | Plaster | N | n/a |
| | NOTE | | AFF 6' | | | |
| Walls | 4 | | Plaster - sanded finish | | N | n/a |
| Ceiling | 4 | | Plaster - sanded finish | ACM Roofing debris | N | n/a |
| Ceiling | 26 | | Roofing debris with silver paint | | Y | Y |
| | NOTE | | Silver Paint=3% CH; Other various roof material=ND | | | |

| | | | | | |
|------------------|---------------------------------|-------------------------|--------------------|---------------------------|-----|
| Building: | Building G - Book Room Building | Room Name: | SW Girls' Restroom | Rm Ft²: | 190 |
| | | Room Dimensions: | L=19 W=10 H=9 | | |

| Component | HMR # | Sample # | Material Description | Substrate | ACM Y/N | Friable Y/N |
|-----------|-------|----------|----------------------------------------------------|--------------------|------------|----------------|
| Floor | 9 | | Ceramic floor tile grout (2" grey) | | N | n/a |
| BB | | | None | | | |
| Walls | 10 | | Ceramic wall tile grout - blue (4" white) | Plaster | N | n/a |
| | NOTE | | AFF 6' | | | |
| Walls | 4 | | Plaster - sanded finish | | N | n/a |
| Ceiling | 4 | | Plaster - sanded finish | ACM Roofing debris | N | n/a |
| Ceiling | 26 | | Roofing debris with silver paint | | Y | Y |
| | NOTE | | Silver Paint=3% CH; Other various roof material=ND | | | |

RED=contains asbestos

BLACK=no asbestos detected or non-suspect



YES Environmental, Inc.

1201 24th Street, Suite B110-377, Bakersfield, CA 93301 / (661) 527-0820

| | | | | | |
|------------------|---------------------------------|-------------------------|----------------|---------------------------|-----|
| Building: | Building G - Book Room Building | Room Name: | Book Room | Rm Ft²: | 798 |
| | | Room Dimensions: | L=42 W=19 H=12 | | |

| Component | HMR # | Sample # | Material Description | Substrate | ACM Y/N | Friable Y/N |
|-----------|-------|----------|----------------------------------------------------|--------------------|------------|----------------|
| Floor | 23 | 23B | Floor tile & glue 12" lt grey/cream mosaic | Concrete | N | n/a |
| BB | 3 | 03F | Baseboard & glue 3" & 4" blue | | N | n/a |
| Walls | 4 | | Plaster - sanded finish | | N | n/a |
| Ceiling | 4 | | Plaster - sanded finish | ACM Roofing debris | N | n/a |
| Ceiling | 26 | | Roofing debris with silver paint | | Y | Y |
| | NOTE | | Silver Paint=3% CH; Other various roof material=ND | | | |

| | | | |
|------------------|---------------------------------|-------------------|----------|
| Building: | Building G - Book Room Building | Room Name: | Exterior |
|------------------|---------------------------------|-------------------|----------|

| Component | HMR # | Sample # | Material Description | Substrate | ACM Y/N | Friable Y/N |
|-----------|-------|----------|------------------------------------------------------------------------------------------------------|--------------------|------------|----------------|
| Ground | 38 | | Asphalt | | N | n/a |
| Ground | - | | Concrete - bare & exposed | | n/a | n/a |
| Walls | 35 | | Exterior stucco, painted & vapor barrier | | N | n/a |
| Windows | 28 | 28K-L | Exterior window putty | | N | n/a |
| Eaves | 35 | 35E | Exterior stucco, painted | | N | n/a |
| Roof | 36 | | White coated foam on silver paint on rolled composition roofing | Diagonal sheathing | Y | N |
| | NOTE | | Foam=ND; Silver Paint=2-4% CH; Rolled Composition Roofing & Felts=ND | | | |
| Roof | 37 | | White coated foam on silver paint on penetration mastic | | Y | N |
| | NOTE | | Foam=ND; Silver Paint=2-4% CH; Mastics=Assumed | | | |
| | NOTE | | On components such as, but not limited to, roof jacks, roof vents, conduits, sleepers, patches, etc. | | | |

RED=contains asbestos

BLACK=no asbestos detected or non-suspect



YES Environmental, Inc.

1201 24th Street, Suite B110-377, Bakersfield, CA 93301 / (661) 527-0820

Client: Bakersfield City School District

Site: Wayside ES

YES Project No.: 23YES-05

Date of Inspection: 6/27/2023

Inspection Report

| | | | |
|-------------------------------------------------------------------------------------------------------------------------------------------------------------------------------------------------------------------------------------------------------------------------------------------------------------------------------------------------------------------------------------|-----------------------------|-------------------|-------|
| Building: | Building H - Administration | Room Name: | Attic |
| <p>Attic is defined as: every enclosed spaced that is contiguous and/or beneath the roof, attic, void, and plenum space above every room in this building including, but not limited to, exterior enclosed eaves, enclosed hallways, walkways, corridors, wall cavities, etc. and all spaces beneath the roof and above ceilings that are or are not readily accessible.</p> | | | |
| <p>Attic Floor is defined as: the surface within an attic space, serving as the ceiling for the room(s) below and/or an area with exposed joists. It is not a term that can be used to infer a walkable surface.</p> | | | |

| Component | HMR # | Sample # | Material Description | Substrate | ACM Y/N | Friable Y/N |
|--------------------|-------|----------|-----------------------------------------------------------------------------------------------------------------------------|-----------|------------|----------------|
| Attic Floor | 26 | | Roofing debris with silver paint | | Y | Y |
| | NOTE | | Silver Paint=3% CH; Other various roof material=ND This material exists on and inbetween the floor joists of this space. | | | |
| Attic Floor | - | | Fiberglass batt insulation | | Y | Y |
| | NOTE | | Contaminated with asbestos roofing debris | | | |
| Walls | - | | Wood | | n/a | n/a |
| Flue Pipes | | | Transite flue pipes - Known Asbestos Material (typically 10-20% Chrysotile) | | Y | N |
| Ceiling | - | | Diagonal sheathing | | n/a | n/a |

Inspection limited to ceilings and walls above the ceilings in these buildings for fire alarm work in accordance with BCSD plans.

RED=contains asbestos

BLACK=no asbestos detected or non-suspect



YES Environmental, Inc.

1201 24th Street, Suite B110-377, Bakersfield, CA 93301 / (661) 527-0820

| | |
|----------------------------------------------|---------------------------------------------------------|
| Building: Building H - Administration | Room Name: Representative of ceilings throughout |
|----------------------------------------------|---------------------------------------------------------|

| Component | HMR # | Sample # | Material Description | Substrate | Y/N | Y/N |
|-----------|-------|----------|------------------------------------------------------------|----------------------|-----|-----|
| Walls | 4 | | Plaster - sanded finish | | N | n/a |
| Walls | 29 | 29A | Drywall, orange-peel texture | | N | n/a |
| Walls | 5 | | Tackboards & glue | | N | n/a |
| Ceiling | 15 | 15B-C | Lay-in panels - 2' x 4' variety (fiss/gouge) various ages | ACM Roofing debris | N | n/a |
| Ceiling | 26 | | Roofing debris with silver paint | F/G insulation | Y | Y |
| | NOTE | | Silver Paint=3% CH; Other various roof material=ND | | | |
| Ceiling | - | | Fiberglass insulation | ACM Roofing debris | n/a | n/a |
| Ceiling | 26 | | Roofing debris with silver paint | 12" ACT | Y | Y |
| | NOTE | | Silver Paint=3% CH; Other various roof material=ND | | | |
| Ceiling | 8 | | Acoustic ceiling tiles 12" uniform hole pattern (nailed) | wood slat | N | n/a |
| Ceiling | 30 | 30A | Acoustic ceiling tiles 12" random pinhole pattern (nailed) | wood slat | N | n/a |
| Ceiling | - | | Wood slats | ACM Roofing debris | n/a | n/a |
| Ceiling | 26 | | Roofing debris with silver paint | Wool batt insulation | Y | Y |
| | NOTE | | Silver Paint=3% CH; Other various roof material=ND | | | |
| Ceiling | 24 | | Wool-batt insulation glued (black) to paper backing | diagonal sheathing | N | n/a |

Inspection limited to ceilings and walls above the ceilings in these buildings for fire alarm work in accordance with BCSD plans.

RED=contains asbestos

BLACK=no asbestos detected or non-suspect



YES Environmental, Inc.

1201 24th Street, Suite B110-377, Bakersfield, CA 93301 / (661) 527-0820

| | |
|----------------------------------------------|----------------------------|
| Building: Building H - Administration | Room Name: Exterior |
|----------------------------------------------|----------------------------|

| Component | HMR # | Sample # | Material Description | Substrate | ACM Y/N | Friable Y/N |
|-----------|-------|----------|------------------------------------------------------------------------------------------------------|--------------------|------------|----------------|
| Ground | 38 | | Asphalt | | N | n/a |
| Ground | - | | Concrete - bare & exposed | | n/a | n/a |
| Walls | 35 | | Exterior stucco, painted & vapor barrier | | N | n/a |
| Windows | 28 | | Exterior window putty | | N | n/a |
| Eaves | 35 | | Exterior stucco, painted | | N | n/a |
| Roof | 36 | | White coated foam on silver paint on rolled composition roofing | Diagonal sheathing | Y | N |
| | NOTE | | Foam=ND; Silver Paint=2-4% CH; Rolled Composition Roofing & Felts=ND | | | |
| Roof | 37 | | White coated foam on silver paint on penetration mastic | | Y | N |
| | NOTE | | Foam=ND; Silver Paint=2-4% CH; Mastics=Assumed | | | |
| | NOTE | | On components such as, but not limited to, roof jacks, roof vents, conduits, sleepers, patches, etc. | | | |

RED=contains asbestos

BLACK=no asbestos detected or non-suspect



YES Environmental, Inc.

1201 24th Street, Suite B110-377, Bakersfield, CA 93301 / (661) 527-0820

Client: Bakersfield City School District

Site: Wayside ES

YES Project No.: 23YES-05

Date of Inspection: 6/27/2023

Inspection Report

| | | | |
|------------------|---------------------------|-------------------|-----------------------------------------------------|
| Building: | R13 (CR 35) & R14 (CR 36) | Room Name: | Representative of ceilings & upper walls throughout |
|------------------|---------------------------|-------------------|-----------------------------------------------------|

| Component | HMR # | Sample # | Material Description | Substrate | Y/N | Y/N |
|-------------|-------|----------|-------------------------------------------------|-----------------|-----|-----|
| Upper Walls | 42 | 42A | Unfinished drywall (no T&J) with tackboard glue | | N | n/a |
| Ceiling | 41 | 41B | Lay-in panels 2'x4' fissure pinhole pattern | F/G insulation | N | n/a |
| Ceiling | - | | Fiberglass insulation | Metal roof deck | n/a | n/a |
| Ceiling | - | | Metal roof deck | | n/a | n/a |

Inspection limited to ceilings and walls above the ceilings in these buildings for fire alarm work in accordance with BCSD plans.

| | | | |
|------------------|---------------------------|-------------------|---------------------------|
| Building: | R13 (CR 35) & R14 (CR 36) | Room Name: | Exterior upper walls only |
|------------------|---------------------------|-------------------|---------------------------|

| Component | HMR # | Sample # | Material Description | Substrate | ACM Y/N | Friable Y/N |
|-----------|-------|----------|----------------------|-----------|------------|----------------|
| Walls | - | | Wood | | n/a | n/a |

Inspection limited to upper exterior walls in these buildings for fire alarm work in accordance with BCSD plans.

RED=contains asbestos

BLACK=no asbestos detected or non-suspect



YES Environmental, Inc.

1201 24th Street, Suite B110-377, Bakersfield, CA 93301 / (661) 527-0820

Client: Bakersfield City School District

Site: Wayside ES

YES Project No.: 23YES-05

Date of Inspection: 6/27/2023

Inspection Report

| | |
|------------------------------|-----------------------------------------------------------------------|
| Building: R15 (CR 37) | Room Name: Representative of ceilings & upper walls throughout |
|------------------------------|-----------------------------------------------------------------------|

| Component | HMR # | Sample # | Material Description | Substrate | Y/N | Y/N |
|-------------|-------|----------|-------------------------------------------------|-----------------|-----|-----|
| Upper Walls | 44 | 44A | Unfinished drywall (no T&J) with tackboard glue | | N | n/a |
| Ceiling | 43 | 43A | Lay-in panels 2'x4' fiberglass plastic jacketed | F/G insulation | N | n/a |
| Ceiling | - | | Fiberglass insulation | Metal roof deck | n/a | n/a |
| Ceiling | - | | Metal roof deck | | n/a | n/a |

Inspection limited to ceilings and walls above the ceilings in these buildings for fire alarm work in accordance with BCSD plans.

| | |
|------------------------------|---------------------------------------------|
| Building: R15 (CR 37) | Room Name: Exterior upper walls only |
|------------------------------|---------------------------------------------|

| Component | HMR # | Sample # | Material Description | Substrate | ACM Y/N | Friable Y/N |
|-----------|-------|----------|----------------------|-----------|------------|----------------|
| Walls | - | | Wood | | n/a | n/a |

Inspection limited to upper exterior walls in these buildings for fire alarm work in accordance with BCSD plans.

RED=contains asbestos

BLACK=no asbestos detected or non-suspect



YES Environmental, Inc.

1201 24th Street, Suite B110-377, Bakersfield, CA 93301 / (661) 527-0820

Client: Bakersfield City School District

Site: Wayside ES

YES Project No.: 23YES-05

Date of Inspection: 6/27/2023

Inspection Report

| | |
|------------------------------|-----------------------------------------------------------------------|
| Building: R16 (CR 38) | Room Name: Representative of ceilings & upper walls throughout |
|------------------------------|-----------------------------------------------------------------------|

| Component | HMR # | Sample # | Material Description | Substrate | Y/N | Y/N |
|-------------|-------|----------|---------------------------------------------|-----------------|-----|-----|
| Upper Walls | - | | exposed studs above ceiling panels | | n/a | n/a |
| Ceiling | 41 | 41A | Lay-in panels 2'x4' fissure pinhole pattern | F/G insulation | N | n/a |
| Ceiling | - | | Fiberglass insulation | Metal roof deck | n/a | n/a |
| Ceiling | - | | Metal roof deck | | n/a | n/a |

Inspection limited to ceilings and walls above the ceilings in these buildings for fire alarm work in accordance with BCSD plans.

| | |
|------------------------------|---------------------------------------------|
| Building: R16 (CR 38) | Room Name: Exterior upper walls only |
|------------------------------|---------------------------------------------|

| Component | HMR # | Sample # | Material Description | Substrate | ACM Y/N | Friable Y/N |
|-----------|-------|----------|----------------------|-----------|------------|----------------|
| Walls | - | | Wood | | n/a | n/a |

Inspection limited to upper exterior walls in these buildings for fire alarm work in accordance with BCSD plans.

RED=contains asbestos

BLACK=no asbestos detected or non-suspect



YES Environmental, Inc.

1201 24th Street, Suite B110-377, Bakersfield, CA 93301 / (661) 527-0820

Client: Bakersfield City School District

Site: Wayside ES

YES Project No.: 23YES-05

Date of Inspection: 6/27/2023

Inspection Report

| | |
|--------------------------------|-----------------------------------------------------------------------|
| Building: R12 Restrooms | Room Name: Representative of ceilings & upper walls throughout |
|--------------------------------|-----------------------------------------------------------------------|

| Component | HMR # | Sample # | Material Description | Substrate | Y/N | Y/N |
|-------------|-------|----------|--------------------------------------------|-----------------|-----|-----|
| Upper Walls | - | | exposed studs above ceiling panels | | n/a | n/a |
| Ceiling | 45 | 45A | Lay-in panels 2'x4' vinyl jacketed drywall | F/G insulation | N | n/a |
| Ceiling | - | | Fiberglass insulation | Metal roof deck | n/a | n/a |
| Ceiling | - | | Metal roof deck | | n/a | n/a |

Inspection limited to ceilings and walls above the ceilings in these buildings for fire alarm work in accordance with BCSD plans.

| | |
|--------------------------------|---------------------------------------------|
| Building: R12 Restrooms | Room Name: Exterior upper walls only |
|--------------------------------|---------------------------------------------|

| Component | HMR # | Sample # | Material Description | Substrate | ACM Y/N | Friable Y/N |
|-----------|-------|----------|----------------------|-----------|------------|----------------|
| Walls | - | | Wood | | N | n/a |

Inspection limited to upper exterior walls in these buildings for fire alarm work in accordance with BCSD plans.

RED=contains asbestos

BLACK=no asbestos detected or non-suspect



YES Environmental, Inc.

1201 24th Street, Suite B110-377, Bakersfield, CA 93301 / (661) 527-0820

Client: Bakersfield City School District

Site: Wayside ES

YES Project No.: 23YES-05

Date of Inspection: 6/27/2023

Inspection Report

| | |
|--------------------------------|-----------------------------------------------------------------------|
| Building: R10 Restrooms | Room Name: Representative of ceilings & upper walls throughout |
|--------------------------------|-----------------------------------------------------------------------|

| Component | HMR # | Sample # | Material Description | Substrate | Y/N | Y/N |
|-------------|-------|----------|--------------------------------------------|-----------------|-----|-----|
| Upper Walls | - | | exposed studs above ceiling panels | | n/a | n/a |
| Ceiling | 40 | 40A | Lay-in panels 2'x4' vinyl jacketed drywall | F/G insulation | N | n/a |
| Ceiling | - | | Fiberglass insulation | Metal roof deck | n/a | n/a |
| Ceiling | - | | Metal roof deck | | n/a | n/a |

Inspection limited to ceilings and walls above the ceilings in these buildings for fire alarm work in accordance with BCSD plans.

| | |
|--------------------------------|---------------------------------------------|
| Building: R10 Restrooms | Room Name: Exterior upper walls only |
|--------------------------------|---------------------------------------------|

| Component | HMR # | Sample # | Material Description | Substrate | ACM Y/N | Friable Y/N |
|-----------|-------|----------|---------------------------------|-----------|------------|----------------|
| Walls | 46 | 46A | Stucco finish over cement board | | N | n/a |

Inspection limited to upper exterior walls in these buildings for fire alarm work in accordance with BCSD plans.

RED=contains asbestos

BLACK=no asbestos detected or non-suspect



YES Environmental, Inc.

1201 24th Street, Suite B110-377, Bakersfield, CA 93301 / (661) 527-0820

Client: Bakersfield City School District

Site: Wayside ES

YES Project No.: 23YES-05

Date of Inspection: 6/27/2023

Inspection Report

| | | | |
|------------------|-------------------|-------------------|-----------------------------------------------------|
| Building: | R1-R9 (CRs 26-34) | Room Name: | Representative of ceilings & upper walls throughout |
|------------------|-------------------|-------------------|-----------------------------------------------------|

| Component | HMR # | Sample # | Material Description | Substrate | Y/N | Y/N |
|-------------|-------|----------|-------------------------------------------------|-----------------|-----|-----|
| Upper Walls | 33 | 33A-C | Unfinished drywall (no T&J) with tackboard glue | | N | n/a |
| Ceiling | 34 | 34A-B | Lay-in panels 2'x4' gouge pinhole pattern | F/G insulation | N | n/a |
| Ceiling | - | | Fiberglass insulation | Metal roof deck | n/a | n/a |
| Ceiling | - | | Metal roof deck | | n/a | n/a |

Inspection limited to ceilings and walls above the ceilings in these buildings for fire alarm work in accordance with BCSD plans.

| | | | |
|------------------|-------------------|-------------------|---------------------------|
| Building: | R1-R9 (CRs 26-34) | Room Name: | Exterior upper walls only |
|------------------|-------------------|-------------------|---------------------------|

| Component | HMR # | Sample # | Material Description | Substrate | ACM Y/N | Friable Y/N |
|-----------|-------|----------|---------------------------------|-----------|------------|----------------|
| Walls | 39 | 39A-C | Stucco finish over cement board | | n/a | n/a |

Inspection limited to upper exterior walls in these buildings for fire alarm work in accordance with BCSD plans.

RED=contains asbestos

BLACK=no asbestos detected or non-suspect



YES Environmental, Inc.

1201 24th Street, Suite B110-377, Bakersfield, CA 93301 / (661) 527-0820

Client: Bakersfield City School District

Site: Wayside ES

YES Project No.: 23YES-05

Date of Inspection: 6/27/2023

Inspection Report

| | |
|--------------------------------------|-----------------------------------------------------------------------|
| Building: R18 (K3) & K19 (K4) | Room Name: Representative of ceilings & upper walls throughout |
|--------------------------------------|-----------------------------------------------------------------------|

| Component | HMR # | Sample # | Material Description | Substrate | Y/N | Y/N |
|-------------|-------|----------|----------------------------------------------|-----------------|-----|-----|
| Upper Walls | - | | Fiberglass insulation above ceiling on walls | | n/a | n/a |
| Ceiling | 31 | 31B | Lay-in panels 2'x4' fissure pinhole pattern | F/G insulation | N | n/a |
| Ceiling | - | | Fiberglass insulation | Metal roof deck | n/a | n/a |
| Ceiling | - | | Metal roof deck | | n/a | n/a |

Inspection limited to ceilings and walls above the ceilings in these buildings for fire alarm work in accordance with BCSD plans.

| | |
|--------------------------------------|---------------------------------------------|
| Building: R18 (K3) & K19 (K4) | Room Name: Exterior upper walls only |
|--------------------------------------|---------------------------------------------|

| Component | HMR # | Sample # | Material Description | Substrate | ACM Y/N | Friable Y/N |
|-----------|-------|----------|----------------------|-----------|------------|----------------|
| Walls | - | | Wood | | n/a | n/a |

Inspection limited to upper exterior walls in these buildings for fire alarm work in accordance with BCSD plans.

RED=contains asbestos

BLACK=no asbestos detected or non-suspect



YES Environmental, Inc.

1201 24th Street, Suite B110-377, Bakersfield, CA 93301 / (661) 527-0820

Client: Bakersfield City School District

Site: Wayside ES

YES Project No.: 23YES-05

Date of Inspection: 6/27/2023

Inspection Report

| | |
|------------------------------|-----------------------------------------------------------------------|
| Building: R11 - Pre K | Room Name: Representative of ceilings & upper walls throughout |
|------------------------------|-----------------------------------------------------------------------|

| Component | HMR # | Sample # | Material Description | Substrate | Y/N | Y/N |
|-------------|-------|----------|----------------------------------------------|-----------------|-----|-----|
| Upper Walls | - | | Fiberglass insulation above ceiling on walls | | n/a | n/a |
| Ceiling | 31 | | Lay-in panels 2'x4' fissure pinhole pattern | F/G insulation | N | n/a |
| Ceiling | - | | Fiberglass insulation | Metal roof deck | n/a | n/a |
| Ceiling | - | | Metal roof deck | | n/a | n/a |

Inspection limited to ceilings and walls above the ceilings in these buildings for fire alarm work in accordance with BCSD plans.

| | |
|------------------------------|---------------------------------------------|
| Building: R11 - Pre K | Room Name: Exterior upper walls only |
|------------------------------|---------------------------------------------|

| Component | HMR # | Sample # | Material Description | Substrate | ACM Y/N | Friable Y/N |
|-----------|-------|----------|----------------------|-----------|------------|----------------|
| Walls | - | | Wood | | n/a | n/a |

Inspection limited to upper exterior walls in these buildings for fire alarm work in accordance with BCSD plans.

RED=contains asbestos

BLACK=no asbestos detected or non-suspect



YES Environmental, Inc.

1201 24th Street, Suite B110-377, Bakersfield, CA 93301 / (661) 527-0820

Client: Bakersfield City School District

Site: Wayside ES

YES Project No.: 23YES-05

Date of Inspection: 6/27/2023

Inspection Report

| | |
|------------------------------------------|-----------------------------------------------------------------------|
| Building: R17 - Restroom Portable | Room Name: Representative of ceilings & upper walls throughout |
|------------------------------------------|-----------------------------------------------------------------------|

| Component | HMR # | Sample # | Material Description | Substrate | Y/N | Y/N |
|-----------|-------|----------|---------------------------------------------|-----------------|-----|-----|
| Walls | 32 | 32A | unfinished drywall (no T&J) | | N | n/a |
| Ceiling | 31 | 31A | Lay-in panels 2'x4' fissure pinhole pattern | F/G insulation | N | n/a |
| Ceiling | - | | Fiberglass insulation | Metal roof deck | n/a | n/a |
| Ceiling | - | | Metal roof deck | | n/a | n/a |

Inspection limited to ceilings and walls above the ceilings in these buildings for fire alarm work in accordance with BCSD plans.

| | |
|------------------------------------------|---------------------------------------------|
| Building: R17 - Restroom Portable | Room Name: Exterior upper walls only |
|------------------------------------------|---------------------------------------------|

| Component | HMR # | Sample # | Material Description | Substrate | ACM Y/N | Friable Y/N |
|-----------|-------|----------|----------------------|-----------|------------|----------------|
| Walls | - | | Wood | | n/a | n/a |

Inspection limited to upper exterior walls in these buildings for fire alarm work in accordance with BCSD plans.

RED=contains asbestos

BLACK=no asbestos detected or non-suspect