



ASBESTOS ABATEMENT SCOPE OF WORK

Site Information:

Wayside Elementary School – HVAC Replacement
1000 Ming Avenue, Bakersfield, CA 93307



Prepared for:

Bakersfield City School District
1300 Baker Street, Bakersfield, CA 93305
(661) 631-5885

Prepared by:

Kristy Yowell, CAC 09-4500 / CDPH 4640
YES Environmental, Inc. (YES, Inc.)
YES, Inc. Project Number 23YES-117
April 10, 2024

This SOW should be printed in **color**.



1201 24th Street, Suite B110-377, Bakersfield, CA 93301 / (661) 527-0820

ASBESTOS SCOPE OF WORK
Wayside Elementary School – HVAC Replacement

PURPOSE OF PROJECT

In order for Bakersfield City School District to install a new HVAC system, portions of buildings throughout campus have asbestos-containing materials and/or materials contaminated by asbestos that will either be removed or disturbed, and the work must be done using asbestos-safe work practices. The contractor is responsible for field verifying their own measurements for bidding, notification, waste characterization, or any other purpose.

This Scope of Work should be used in conjunction with all Federal, State and local codes. *The information provided in this section is intended to assist the contractor in determining the extent of work; however, this information does not replace or supersede any direction or description of work as presented in the plans and specifications for this project.* If YES, Inc.'s scope of work and the plans and specifications differ, the contractor shall be obliged to bring any discrepancies to the attention of the architect/owner's representative prior to bidding the project via submission of a request for information to the architect.

PHASING

This is a phased project. The contractor shall refer to the plans and specifications for phasing information.

MOBILIZATIONS

The contractor shall include in their bid cost for multiple mobilizations that will be requirements in order to coordinate necessary abatement and/or remediation activities with other trades, the District, and all other associated

DAYS BY PHASE FOR ABATEMENT ACTIVITIES

The contractor is limited to the follow number of days in order to complete abatement and remediation activities. This number of days does not include removal of containment.

- Phase 1 = 30 Business Days
- Phase 2 = 30 Business Days
- Phase 3 = 50 Business Days
- Phase 4 = 30 Business Days
- Phase 5 = 40 Business Days
- Total = 180 Days

DEFINITIONS

- Abatement Activities: precleaning of jobsite, setup of containment/regulated area, removal of asbestos-containing materials and final cleaning inside containment/regulated area in preparation for post abatement clearance air sampling or completion of work visual.
- Asbestos-Containing: material containing any detectable amount of asbestos. Acronym ACM.
- Attic Floor: is the surface within an attic space, serving as the ceiling for the room(s) below, and/or area with exposed joists. It is **not** a term that can used to infer a walkable surface.
- Lead-Containing: material containing any detectable amount of lead. Acronym LCP or LBP.
- Remediation Activities: precleaning of jobsite, setup of containment/regulated area, removal or disturbance of any sort of lead-containing materials and final cleaning inside containment/regulated area in preparation for job completion visual inspection by consultant.



1201 24th Street, Suite B110-377, Bakersfield, CA 93301 / (661) 527-0820

Contractor: Remediation contractor, abatement contractor or any trade qualified to conduct the work described in this Scope of Work.

Consultant: BCSD's environmental consultant.

ASBESTOS & LEAD LOCATIONS, CONTENT & TYPE

Please see the attached Inspection Report by Room (IRBR) following this scope of work for identification of materials suspect to contain asbestos that have been sampled by YES, Inc. If any materials other than those identified in this scope of work and IRBRs are discovered and may be disturbed, work must be stopped and the project must be re-evaluated.

Of the materials being removed or disturbed, the contractor shall then refer to YES, Inc.'s IRBRs, XRF report and Scope of Work to determine the specific materials that contain asbestos and/or lead and those that have been determined to be free of asbestos and/or lead.

The IRBRs and XRF report do not denote materials to be removed; they report whether materials present contain asbestos and/or lead. Contractor should refer to the plans and specifications for abatement locations.

NOTIFICATIONS

The contractor shall be responsible for the submission of all notifications triggered by asbestos removal. This includes the renovation or demolition permit release form to San Joaquin Valley Air Pollution Control District and the Cal/OSHA Asbestos Notification.

SUPERVISOR & WORKER TRAINING REQUIRED

Workers and supervisors disturbing asbestos shall have AHERA accredited training as asbestos workers or contractor supervisors. Any exceptions to these training requirements shall be submitted to the consultant and building owner representative for review and await on approval before commencing with disturbance of ACM.

PRE-JOB SUBMITTAL REQUIREMENTS

A hard copy of the contractor's pre-job submittal packet shall be submitted to the consultant and:

1. Include all of the items listed in the attached Submittal Requirements;
2. Be provided to and approved by the consultant prior to the start of work by the contractor.
3. Manifests shall be submitted to the consultant on the first day of the project for review, and also for final approval prior to waste removal from the job site.
4. Double sided copies are not acceptable.
5. Delays in providing the required submittals may affect the start of the project.
6. Electronic submittals will be accepted for viewing and approval purposes only.

OTHER CONSIDERATIONS

Item	District Provided	Contractor Must Provide	Not Applicable / Required
Water	X		
Power	X		
Removal of Items to be saved	X		
Removal & Disposal of Items Remaining in Work Area		X	
Safety & Security of Equipment		X	
On-site challenge testing of HEPA filtered equipment within 5 calendar days of the start of the job		X	

SOFT DEMOLITION REQUIREMENTS



1201 24th Street, Suite B110-377, Bakersfield, CA 93301 / (661) 527-0820

The contractor shall perform all soft demolition requirements prior to the commencement of containment setup. All components such as, but not limited to, cabinetry and walls shall be removed to expose any potentially concealed asbestos-containing materials prior to the start of abatement. However, if the removal of any of these components may disturb ACM, they shall be removed after containment and negative pressure are established and approved by the consultant. In addition, should the contractor discover any concealed ACM, they shall immediately bring it to the attention of the consultant and owner representative who will confirm the material and quantity. The agreed upon quantity and type of material(s) shall be recorded on the contractor's daily paperwork on the day it is discovered.

LAYERS OF ROOFING

The contractor is responsible for removal of all roofing layers down to the wood or metal substrate regardless of asbestos content, unless otherwise noted in the Scope of Work. Where it is unknown how many layers of roofing materials exist, it must be assumed that there are multiple roofing material layers present. The contractor may, upon request and approval by the client, collect core samples of any roof to be removed for the purpose of determining its depth and structure. If coring is conducted, it is the responsibility of the contractor to repair the areas affected to industry standards using non-asbestos materials.

INCLEMENT WEATHER

Roof abatement shall be planned and scheduled when there are favorable weather conditions, such as when there is a forecast for "clear skies" and no rain for three or more days. The contractor shall remove only that amount of roofing material that can be re-roofed or covered and secured from weather on the same work day. Work may be halted at the discretion of the onsite project manager if wind conditions occur, which can or does cause removed roofing materials to be blown off the roof area or beyond the designated removal area. All roofing work shall be coordinated to allow other trades to work at the same time as long as their work is located in areas where contamination cannot occur.

ALLOWABLE FORMS OF COMMUNICATION

The contractor shall establish a means of communication between the supervisor and workers inside the containment/regulated area which includes two-way radios or equivalent. At no time will yelling, whistling or banging on containment, walls or on the decontamination chambers be allowed as a form of communication.

OCCUPANCY

The building will be unoccupied in the areas where abatement is occurring. Other areas on campus, but outside of the abatement containment or regulated areas, may be occupied by staff, students, and other trades conducting work at this site.

WASTE BIN/CONTAINERS

All bins/containers brought on-site to deposit waste into must be lockable or securable. Bins shall be secured at the end of every shift. Plywood shall be placed under the wheels of each bin to protect the existing surface. Bins must be double lined with 6-mil poly prior to waste being deposited. Containers must have the appropriate labels affixed on them as soon as any ACM debris is deposited.

ASBESTOS CONTAINMENT/REGULATED AREA SETUP REQUIREMENTS

Containment setup requirements for all containments/regulated areas:

1. Buildings A, B, C, D, E, F and G shall have no more than one containment constructed for purposes of interior abatement in each of the buildings. These containments shall use either an exterior poly tunnel to connect the various rooms or submit an alternative option to the consultant for review. Without receiving approval of any alternate option, the contractor shall build the containment to meet the requirements in this SOW. Any other building's requiring containment for abatement will be addressed on a case-by-case basis by the consultant.
2. If the setup of the containments requires questionable installation, the district representative and consultant shall be asked in writing and approval must be given in writing prior to work being performed.



3. All containments shall be under full containment and negative pressure built in the most appropriate manner which meets or exceeds the requirements listed in this SOW and Cal/OSHA regulations.
4. The contractor shall exercise care during the construction and deconstruction of the required exterior poly tunnel. If products used to set up the tunnel or the interior containments leave a residue, the contractor shall be responsible for the removal of the residue immediately following receipt of the passing clearance air sampling results.
5. All poly used on this project shall be a minimum of 6-mil thickness and flame retardant (FR).
6. All interior containments shall have view windows installed at locations approved by the consultant.
7. All containments shall be built to accommodate the proper opening/closing function of the doors leading to each classroom. This includes ensuring any poly tunnel connecting the rooms to form containments are built in such a fashion the poly is not torn during the operation of the doors at the beginning and end of shifts.
8. All critical barriers shall be sealed prior to any installation of poly on the floors, walls or ceilings. They shall be covered with at least one layer of 6-mil FR poly and sealed with duct tape or an equivalent. As ceilings and walls are abated, the contractor shall assure that any additional critical barriers discovered are sealed immediately. Should Class I work be required, the requirements of this section will be required to change to meet or exceed its regulatory requirements.
9. Anything left inside a room where abatement is required shall be covered with at least one layer of 6-mil FR poly and sealed with tape which will provide an adequate seal but not damage the component. At no time shall components which cannot be cleaned be left exposed inside containment/regulated area during abatement.
10. If exterior tunneling is used to create containments, cover floors in the tunnels connecting the rooms with a minimum of two layers of 6-mil polyethylene sheeting. A distance of at least four (4) feet between seams is sufficient. DO NOT locate any seams at wall/floor joints. Floor sheeting shall extend at least twelve inches (12") up the sidewalls of the tunnel. Plastic shall be sized to minimize seams. Sheeting shall be installed in a fashion so as to prevent slippage between successive layers of material.
11. For Cal/OSHA class II, III or IV work, each interior containment shall have at a minimum, a two-stage decontamination chamber setup which meets the following conditions:
 - Must be adjacent to the regulated area/containment for the decontamination of employees and their equipment used inside the regulated area/containment;
 - Shall be built large enough to accommodate all workers donning PPE without being able to be seen by staff, students, or anyone else walking by.
 - The chamber farthest away from the regulated area/containment shall be designed for employees to don PPE before entering the regulated area/containment; to don street clothes upon exiting the regulated area/containment; and storage of other necessary items of the employees which cannot enter the regulated area/containment.
 - The chamber most adjacent to the regulated area/containment shall be designed for the person exiting the regulated area/containment to use water, soap, and towels to decontaminate any part of their bodies and PPE such as their respirator.
 - Both chambers shall be of sufficient size to accommodate cleaning of equipment and removing PPE without the spreading of contamination beyond the area (as determined by visual accumulations).
12. All Class I containments shall have a three-stage decontamination chamber with an operational shower. The clean-room shall be built large enough to accommodate all workers donning PPE without being able to be seen by staff, students, or anyone else walking by.
13. Any floors requiring protection from being contaminated by asbestos during abatement shall be covered with two layers of 6-mil FR poly and shall extend at least 12" up the walls.
14. Any walls requiring protection from being contaminated by asbestos during abatement shall be covered with at least two layers of 6-mil FR poly.
15. The consultant must give final approval for containment/regulated area setups before abatement or disturbance of ACM commences.
16. All those entering the containment/regulated area must sign in on an entry/exit log that documents their entrance and exit times. This record is to also include lunch times and other breaks.



17. Containments shall be sufficient to prevent dust, debris and water from leaving the work area at all times. The contractor shall continually inspect the containment/regulated area for deficiencies or breaches. If any are discovered, all abatement activities shall halt immediately until the deficiencies are fixed or repaired satisfactorily. These incidents shall be reported to the consultant immediately.
18. Abatement shall not commence if waste bins are not onsite at the time abatement is ready to begin.
19. At no time shall asbestos-containing debris be allowed to remain exposed or accessible in waste bins at the end of shifts. The contractor shall locate their securable dumpster immediately adjacent to the containment/regulated area or as close as possible.
20. Setup for the removal of exterior materials shall consist of establishing a regulated area with asbestos caution/warning barrier tape that encompasses the entire work area where disturbance of the asbestos-containing materials will occur.
21. A wash station which includes water, soap, and towels shall be set up and used for hygiene purposes and to prevent the tracking out of asbestos debris. This wash station shall be built large enough that it allows for all workers exiting the regulated area to properly decontaminate themselves and their equipment without being seen by anyone walking by.
22. At no time shall asbestos-containing materials be allowed to exit the containment/regulated area without being single wrapped in six-mil FR poly, or double bagged and placed in a double lined dumpster with 6-mil poly. All waste shall be properly labeled immediately upon exiting containment and prior to being deposited into the waste bin.

ADDITIONAL EXTERIOR CONTAINMENT/REGULATED AREA REQUIREMENTS

23. Setup for the removal of exterior materials shall consist of establishing a regulated area with asbestos caution/warning barrier tape that encompasses the entire work area where disturbance of the asbestos-containing materials will occur.
24. A wash station which includes water, soap, and towels shall be set up and used for hygiene purposes and to prevent the tracking out of asbestos debris.
25. At no time shall asbestos-containing materials be allowed to exit the containment/regulated area without being single wrapped in six-mil flame retardant poly, or double bagged and placed in a double lined dumpster with 6-mil poly.

WORKER PROTECTION

The contractor shall provide respiratory protection as outlined in current Cal/OSHA regulations. However, at a minimum:

1. During the removal and detail cleaning of flooring, flooring mastics, roofing, roofing mastics, transite and other various namely non-friable ACM workers shall wear at a minimum, half-face negative-pressure respirator with P-100 HEPA cartridges. Should Class I materials be discovered and require disturbance, workers shall wear at a minimum, powered-air purifying respirators equipped with P-100 HEPA cartridges. Dual cartridges (P-100 & Organic Vapor) shall be utilized during mastic removal involving chemical stripping.
2. Quality disposable coveralls such as Tyvek-like suits shall be worn by all workers during all remediation activities on this project. Exceptions to this must be submitted to consultant in writing for review/approval.
3. Should personal air monitoring results not be received and provided to the consultant on the following week after being collected on the worker, the consultant reserves the right to require the workers to don PAPRs until personal air monitoring results are received.

NEGATIVE PRESSURE & HEPA FILTERED EQUIPMENT REQUIREMENTS

1. Challenge testing is required on equipment using HEPA filters (see Other Considerations above). Units arriving dirty or appearing to be contaminated shall be removed from the project site. Units must be positioned in the standard upright manner in which the manufacturer designed the equipment to operate.
2. The contractor shall ensure that sufficient negative air units are used to create a minimum air pressure differential of -0.030" and recorded on a manometer. Negative air units shall run continuously until



clearance has been achieved. All air filtration devices shall remain sealed when not functioning. All units shall discharge to the exterior of the building during abatement activities.

3. At the end of each shift, if containment cannot be secured while exhausting to the exterior of the building, the contractor shall put the negative air units in scrub mode overnight. At the beginning of each shift, the contractor shall re-establish negative pressure in each containment.

ASBESTOS ABATEMENT PROCEDURES

Abatement procedures for all ACM on this project:

1. Wet all ACM with an amended water solution using equipment capable of providing a fine spray mist, in order to reduce airborne-fiber concentrations immediately prior to the material being disturbed and during disturbance. Garden hoses are prohibited on this project.
2. The contractor shall use the following product to remove the asbestos-containing mastic throughout: CHEMSAFE CLEAR. See attached Safety Data Sheet for product.
3. Contractor shall remove all of the ceilings, associated contaminated insulation, including the wood slats that the 12" acoustic ceiling tiles are nailed to.
4. Transite flue pipes shall be removed only at an existing joint beneath roof so that the section of transite pipe at or above the roof remain undisturbed.
5. The ACM can be double bagged in poly bags. An acceptable alternative is disposal of ACM into a single poly bag which is placed into a leak-tight drum or burrito-wrapping for disposal.
6. Bags and/or burrito-wrapped ACM should be securely sealed to prevent accidental opening and leakage by tying tops of bags in an overhand knot or by taping in gooseneck fashion.
7. Unless the roofing material is carried or passed to the ground by hand, it shall be lowered to the ground via covered, dust-tight chute, crane, or hoist. All waste shall be sufficiently wetted with amended water to prevent fiber release. If fiber release cannot be prevented, then the chute and bin must be within a negative pressure enclosure. **In no case shall roofing materials be dropped or thrown into bins or dumpsters from the roof.**
8. The abated roof area shall be HEPA vacuumed after roofing materials have been removed. Particular attention shall be directed at gaps between the wood members and in the rain gutters.
9. Any component contaminated by ACM and is non-porous (cleanable) shall be brought to the consultant for approval. Contingent upon approval of the component being non-porous, the contractor may setup a cleaning area for these components that is separate from the non-cleanable items. Immediately following the cleanable items being cleaned, the contractor shall notify the consultant of this activity and request a visual inspection for cleanliness. Following the receipt of a passing visual inspection from the consultant, the component may then be passed out of containment and discarded as construction debris or saved for the district to reuse.
10. Contractor shall generate only as much debris as they can bag and deposit into a waste bin at the end of an 8-hour shift.
11. After completion of all stripping work, surfaces from which asbestos-containing materials have been removed shall be wet-wiped or cleaned by some equivalent method to remove all visible residue. If it is quicker and more cost effective to discard the entire component as ACM, contractor must submit for approval prior to the job commencing to the consultant and building owner.
12. Asbestos-contaminated waste that has been containerized shall be transported out of the work area through the worker decontamination enclosure or through an approved pass-out arrangement.

PROHIBITED WORK PRACTICES

1. Uncontrolled releases. This is cause for stopping the project until modified work practices and containment that prevent these releases from occurring are designed and implemented.
2. Dry removal or dry disturbance of any kind.
3. Wet methods do not include the use of garden hoses.
4. Mechanical tools without HEPA vacuum attachment and HEPA vacuum properly attached according to manufacturer recommendation.



COMPLETION OF ASBESTOS ABATEMENT & CLEARANCE AIR SAMPLES

1. After final cleaning of any interior containment of a building intended to be reoccupied has been completed, a visual clearance inspection shall be performed by the consultant. Contractor personnel shall be present and available to address any deficiencies in cleaning. On the business day following visual clearance of the containment, a set of five clearance air samples shall be collected to be analyzed by Transmission Electron Microscopy (TEM) or Phase Contrast Microscopy (PCM).
2. Final clearance for re-occupancy using the TEM shall be contingent upon meeting AHERA criteria for response action completion of an average of 70 structures per square millimeter (70 s/mm²) or less for the 5 samples collected inside the containment (40 CFR 763, Appendix A). In the event clearance air samples do not meet this re-occupancy criteria, the contractor shall be responsible for re-cleaning failed areas, and for costs associated with collection and analysis of additional clearance air samples (\$1,400/per set of clearances) in accordance with the sampling protocol described above.
3. Where PCM clearance criteria is used, final clearance for re-occupancy shall be contingent upon meeting AHERA criteria for response action completion when the results of the samples collected show that the concentration of fibers for each of the five samples is less than or equal to a limit of quantitation for PCM (0.01 fibers per cubic centimeter (0.01 f/cm³) of air).
4. After final cleaning of any exterior containment has been completed, a visual clearance inspection shall be performed by the consultant. The consultant will inspect work areas for visual signs of dust and debris related to the disturbance of asbestos. All surface areas must be clean. Residual dust, of any nature, that was generated on this project and found within or immediately outside the regulated area/containment, will be assumed to contain asbestos and must be re-cleaned. A passing visual inspection performed by the consultant on exterior containments/regulated areas will determine completion of work.

PERSONAL AIR MONITORING RESULTS FOR WORKERS

The contractor shall promptly post and provide a copy of worker personal air monitoring results in compliance with Cal/OSHA requirements to the consultant. Results of worker air monitoring shall be turned in to the consultant each Tuesday for the previous week air samples.

ASBESTOS DISPOSAL

Non-asbestos containing materials which are removed from containment before any asbestos-containing materials are disturbed, may be discarded as construction debris.

Non-friable ACM or materials contaminated by non-friable ACM removed by non-mechanical or hand methods shall be discarded as non-friable, non-hazardous asbestos-containing waste and manifested accordingly. ACM waste with less than 1% asbestos shall be discarded as non-friable, non-hazardous asbestos-containing waste and manifested accordingly.

Friable ACM, materials contaminated by friable ACM, and non-friable materials removed by mechanical means shall be discarded as friable, hazardous asbestos-containing waste and manifested.

The contractor shall notify the consultant and the District representative at least **24** hours in advance of when the manifest must be signed.

Attachments:

- A. Site & Building Maps
- B. Submittal Requirements
- C. Safety Data Sheets for Chemsafe Clear
- D. Asbestos Inspection Report by Room



1201 24th Street, Suite B110-377, Bakersfield, CA 93301 / (661) 527-0820

Attachment A – Site & Building Maps

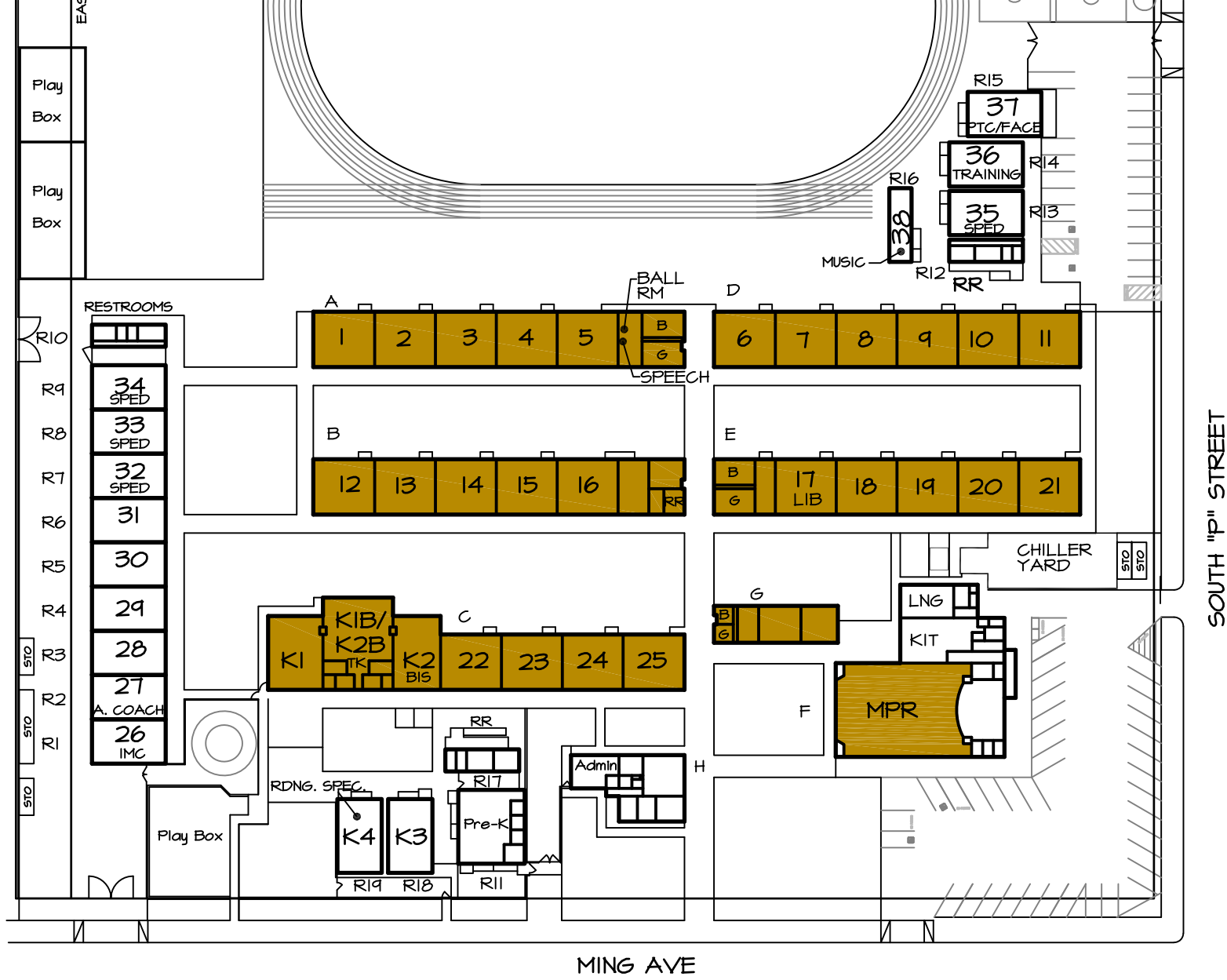

WAYSIDE ELEMENTARY SCHOOL
1000 MING AVE.

■ REMOVE PERMANENT ROOMS FROM CHILLER SYSTEM. INSTALL NEW INDIVIDUAL WALL OR ROOF UNIT



SITE PLAN



Building A

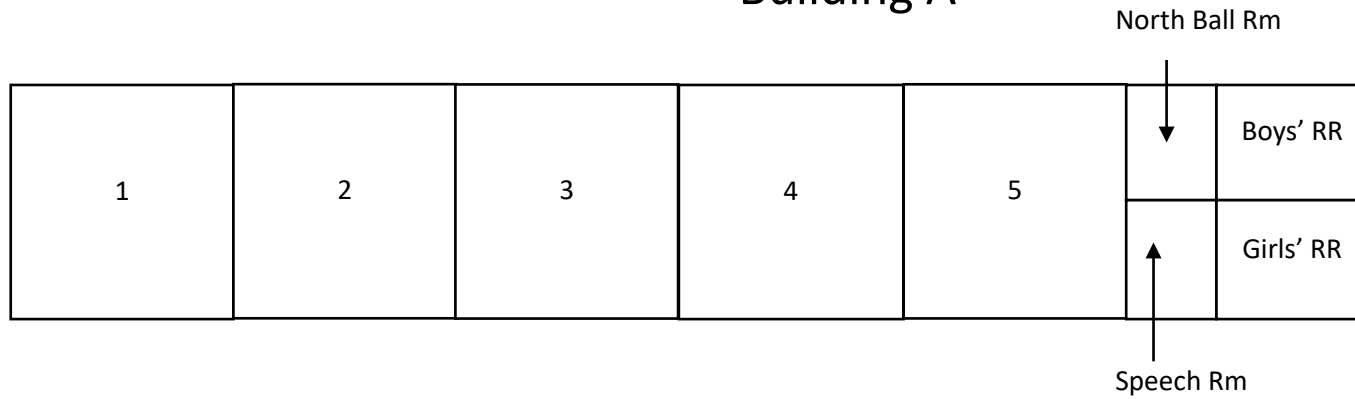



Building B

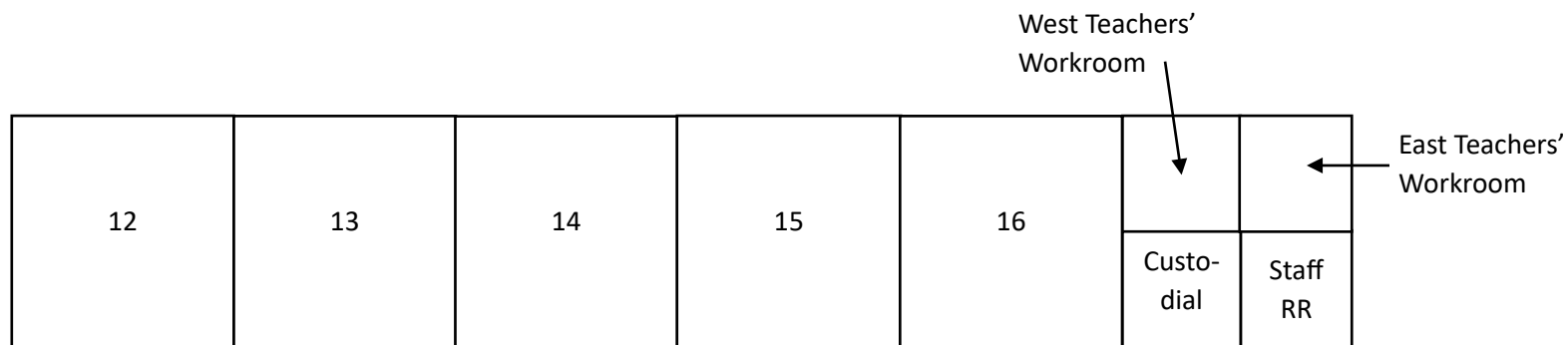



Building C

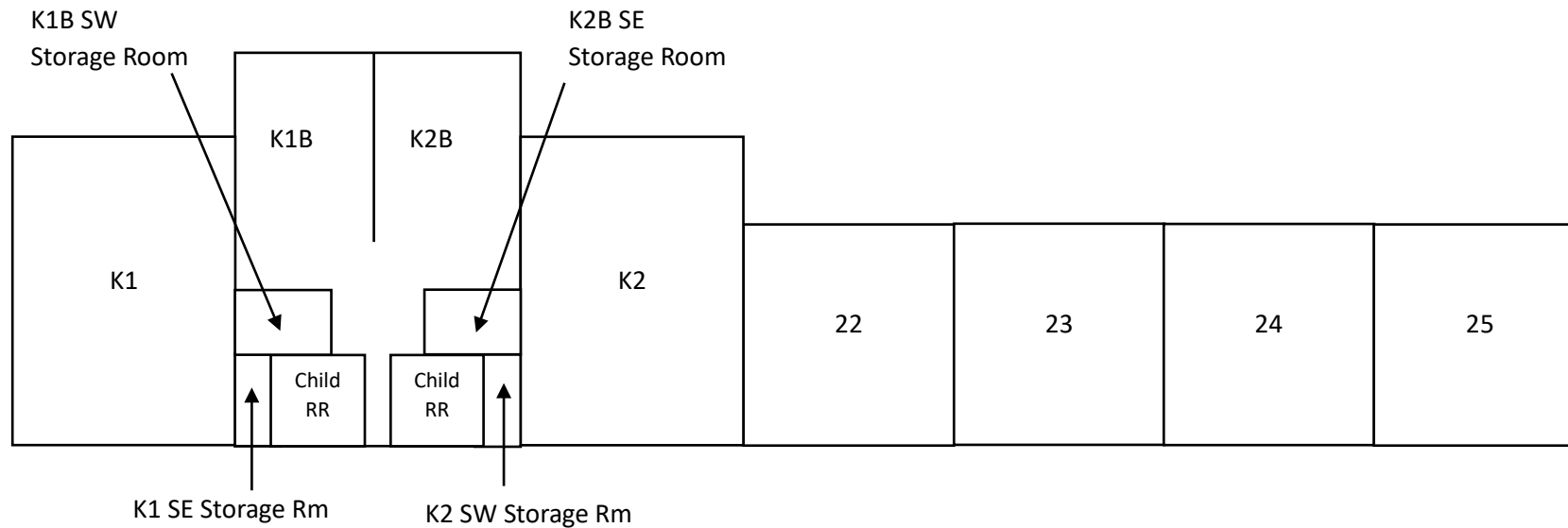

Not Drawn To Scale



Building D

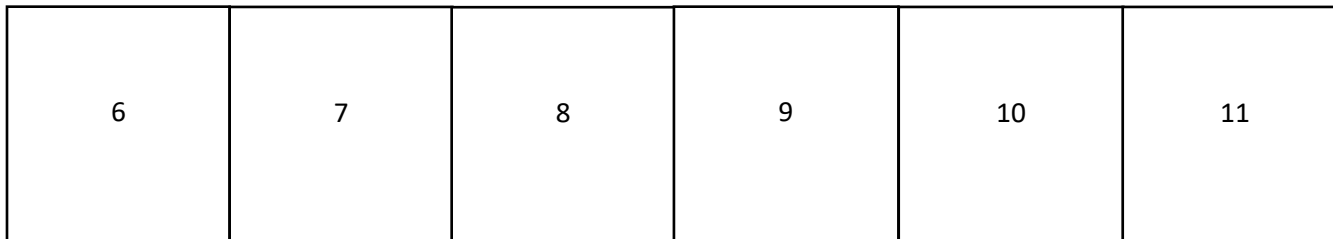



Building E

Boys' RR	Custo- dial Room	17	18	19	20	21
Girls' RR						



Building F

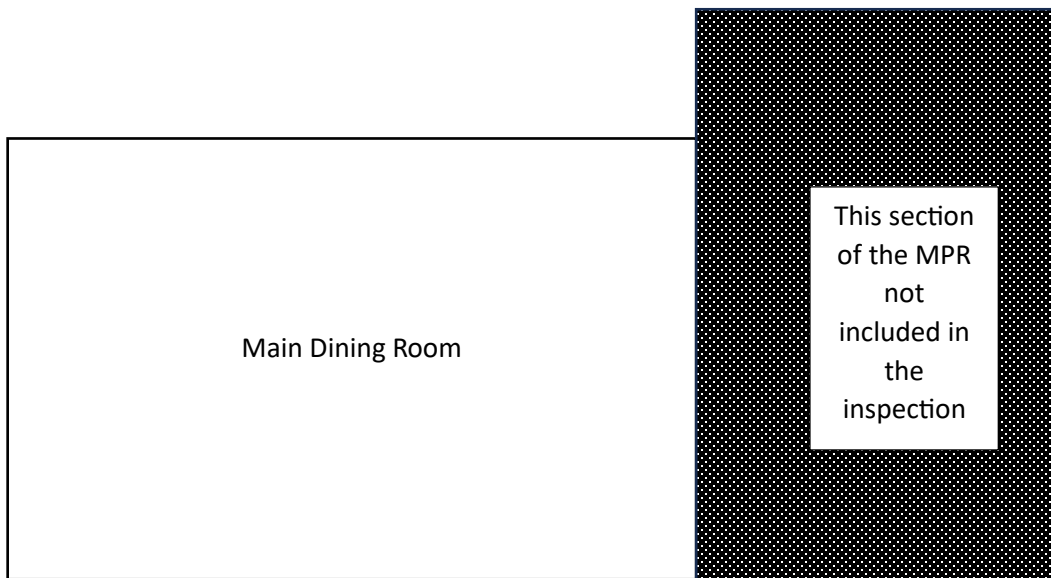

Not Drawn To Scale



Building G

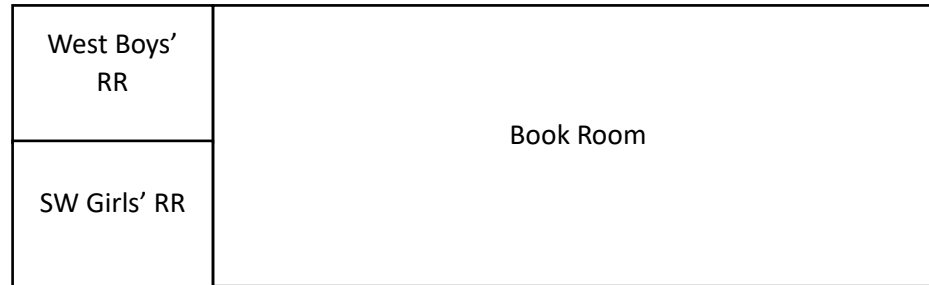



Attachment B – Submittal Requirements

Asbestos Submittal Requirements

Note: not all of the items listed below are applicable for every project. Only the items applicable are required to be included in the submittal packet.

Prestart Submittals

1. Contractor's license(s)
 - a. CSLB license with asbestos certification
2. DOSH registration
3. Notifications
 - a. Appropriate local EPA enforcement agency for the job site location.
 - b. Cal/OSHA asbestos notification
 - c. Equipment rented
 - i. Proof the rental company has been made aware the rented equipment will be used for asbestos related work.
4. Site specific safety/emergency plan
 - a. This must include, but is not limited to, the nearest hospital's phone number and address;
 - b. Local police department phone number and address;
 - c. Title, name and phone number of the contractor's contact whom should be contacted in the event of an emergency.
5. Contractor worker documentation for all workers on-site
 - a. Proof of AHERA training
 - b. Proof of Medical approval to wear a respirator
 - c. Respirator fit test
6. Contractor's respiratory protection program
7. Challenge testing certificates
8. Negative exposure assessment (if requesting to don lesser PPE than specified in the SOW)
9. Safety data sheets for all hazardous materials (as defined by Cal/OSHA)
10. Waste Disposal
 - a. Paperwork for landfill proving the landfill will accept the waste
 - b. Proof of licensed waste hauler and company for hazardous waste
 - c. Waste characterization of lead waste
 - d. Manifest for all types of waste to be generated

Submittals Required During the Project

1. Daily copies
 - a. Safety meeting (if held daily)
 - b. Worker roster of all employees onsite – regardless of training
 - c. Entry/exit log for employees entering/exiting containment/regulated area
 - d. HEPA filter change log
2. Weekly
 - a. Safety meeting
 - b. Worker personal air monitoring
 - c. Area air monitoring

Submittals Required at the Conclusion of the Project

1. Contractor air monitoring & laboratory results (refer to the SOW for required frequency)
2. Any other paperwork as requested by the Consultant or Building Owner



1201 24th Street, Suite B110-377, Bakersfield, CA 93301 / (661) 527-0820

Attachment C – Safety Data Sheet

SAFETY DATA SHEET**TRADE NAME: CHEMSAFE CLEAR**

PAGE 1 OF 8

ISSUE DATE: 1/15/1990

REVISION DATE: 4/15/2015

1. PRODUCT AND COMPANY IDENTIFICATION**GHS PRODUCT IDENTIFIER:**

TRADE NAME; CHEMSAFE CLEAR (CARB COMPLIANT)

OTHER MEANS OF IDENTIFICATION:**RECOMMENDED USE OF THE CHEMICAL AND RESTRICTIONS ON USE:**

RECOMMENDED USE: Mastic Removal

SUPPLIER'S DETAILS:

1480 GRANDVIEW AVE.
THOROFARE, NJ 08086
(800)767-6933

EMERGENCY PHONE NUMBER:

COMPANY PHONE NUMBER: (800)767-6933

(24HR) EMERGENCY NUMBER: CHEM-TREC (800)424-9300

2. HAZARD IDENTIFICATION**GHS CLASSIFICATION:**

GHS CLASSIFICATION SCALE: 1=SEVERE HAZARD, 4=SLIGHT HAZARD)

ASPIRATION HAZARD
SERIOUS EYE DAMAGE IRRITATION

CATEGORY 1
CATEGORY 2A

LABEL ELEMENTS:**SIGNAL WORD: DANGER****HAZARD STATEMENTS:**

Causes serious eye irritation
May be fatal if swallowed and enters airways

HAZARD SYMBOLS:**PRECAUTIONARY STATEMENTS:**

Keep out of reach of children
 Wash hands, face and all exposed skin areas after handling.
 Wear protective gloves/protective clothing/eye protection/face protection

PRECAUTIONARY STATEMENTS (RESPONSE):

IF SWALLOWED: Immediately call a poison center or doctor or physician. Do not induce vomiting.

IF IN EYES: Rinse cautiously with water for several minutes. Remove contact lenses if easy to do. Continue rinsing. If eye irritation persists, get medical advice/attention.

PRECAUTIONARY STATEMENTS (STORAGE):

Store locked up.

PRECAUTIONARY STATEMENTS (DISPOSAL):

Dispose of contents/container to an approved waste disposal plant in accordance with applicable local/regional/national and international regulations and product characteristics at time of disposal.

OTHER HAZARDS:

Repeated or prolonged exposure can cause skin dryness or cracking.

3. COMPOSITION INFORMATION ON INGREDIENTS

INGREDIENT IDENTITY	CAS NUMBER	PERCENTAGE
DISTILLATES, PETROLEUM HYDROTREATED, LIGHT	64742-47-8	PROPRIETARY
BUTOXYDIGLYCOL	112-34-5	PROPRIETARY

REMAINING INGREDIENTS ARE NOT REPORTABLE UNDER OSHA/SDS GUIDELINES. THE EXACT PERCENTAGES OF SOME INGREDIENTS HAVE BEEN WITHHELD AS (CBI) CONFIDENTIAL BUSINESS INFORMATION TRADE SECRET.

4. FIRST AID MEASURES

INGESTION: If swallowed, wash out mouth with water. Do not induce vomiting, this product is an aspiration hazard. If spontaneous vomiting occurs, keep head below hips to prevent aspiration of liquid into the lung. Never give anything by mouth to an unconscious person.

SKIN CONTACT: Remove contaminated clothing. Wash with soap and plenty of water for 15 minutes. Wash contaminated clothing before reuse. If irritation occurs get medical advice.

INHALATION: Move individual away from exposure and into fresh air. If breathing is irregular or stopped, administer artificial respiration. In case of shortness of breath, give oxygen. Call a physician immediately.

EYE CONTACT: Rinse cautiously with water for several minutes. Remove contact lenses if easy to do. Continue rinsing. If eye irritation persists, get medical attention/advice.

Most Important Symptoms and Effects, Acute and Delayed

INGESTION: Symptoms may include diarrhea, gastric pain, and vomiting.

SKIN CONTACT: Symptoms may include redness, dryness and cracking of skin.

INHALATION: Not expected; however, symptoms may include irritation of respiratory tract and/or CNS symptoms such as dizziness, confusion, drowsiness or fatigue.

EYE CONTACT: Symptoms may include stinging, tearing, redness and blurred vision.

Indication of immediate medical attention and special treatment needed, if necessary.

Treat Symptomatically.

5. FIRE FIGHTING MEASURES

Suitable extinguishing media: Use fire extinguishers suitable for surrounding fire, possibly consisting of water spray, dry chemical, carbon dioxide, or foam.

Unsuitable extinguishing media- Do not use water jet.

Specific hazards arising from the chemical: In a fire or if heated, a pressure increase will occur and the container may burst. Material will burn in a fire. Flash point is over 200F. Material will emulsify and not directly float with water spray and emulsion could aid in not exacerbating fire.

Hazardous thermal decomposition products: carbon monoxide and CO₂

Special protective actions for fire-fighters: Keep product containers and surrounding areas cool with water spray. No action shall be taken involving any personal risk or without suitable training.

Special protective equipment for fire-fighters: Fire fighters should wear appropriate protective equipment and self-contained breathing apparatus (SCBA) with a full face-piece operated in positive pressure mode.

6. ACCIDENTAL RELEASE MEASURES

Personal precautions, protective equipment and emergency procedures:

For non-emergency personnel: No action shall be taken involving any personal risk or without suitable training. Evacuate surrounding areas. Keep unnecessary and unprotected personnel from entering. Do not touch or walk through spilled material. Provide adequate ventilation. Avoid breathing vapor or mists. Put on appropriate personal protective equipment. Wear appropriate respirator when ventilation is inadequate.

For emergency responders: If specialized clothing is required to deal with the spillage, take note of information in section 8 for further information. See also information in non-emergency personnel above.

Environmental precautions: Avoid dispersal of spilled material with soil, waterways, drains and sewers. See section 12 for additional ecological information.

Methods and materials for containment and cleaning up.

Small spill: Stop leak if without risk. Move containers from the spill area. Absorb with an inert dry non combustible material such as diatomaceous earth or vermiculite and place in an appropriate waste disposal container. Mop any remaining residues with soap and water and dispose of wastes via a licensed waste disposal contractor according to federal, state and local regulations.

Large spill: Stop leak if without risk. Move containers from spill area. Prevent entry into sewers, drains, water courses and confined areas. Wash spillages into an effluent treatment plant or absorb with an inert dry non combustible material such as diatomaceous earth or vermiculite and place in a appropriate waste disposal containers. Mop any remaining residues with soap and water and dispose of wastes via a licensed waste disposal contractor according to federal, state and local regulations.

7. HANDLING AND STORAGE

Precautions for Safe Handling:

Safe Handling Advice: Utilize appropriate personal protective equipment when handling product. Do not swallow. Avoid contact with eyes, skin and clothing. Avoid breathing vapor or mists. Use only with adequate ventilation. Wear appropriate respirator when ventilation is inadequate. Do not enter storage areas and confined spaces unless adequately ventilated. Keep in the original container and tightly closed when not in use. Store and use away from heat, sparks, open flame or any other ignition source. No smoking. Wash face, hands and any exposed skin thoroughly after handling. Wear protective gloves/protective clothing/eye protection and face protection during use. Emptied containers can contain product residues and remain hazardous. Do not reuse, flame cut, braze or weld container and observe all sds information around empty containers and dispose of in accordance with federal, state and local regulations.

Advice on general occupational hygiene: Eating, drinking and smoking should be prohibited in areas where this material is handled, stored and processed. Workers should wash hands and face before eating, drinking and smoking. Remove contaminated clothing and protective equipment before entering eating areas. See also section 8 for additional hygiene information.

Conditions for safe storage including any incompatibilities:

Store in original container in a dry, cool and well ventilated area away from strong oxidizing agents (see section 10) and food and drink. Store locked up. Eliminate all ignition sources. Keep container tightly closed when not in use. Do not store in unlabeled containers.

8. EXPOSURE CONTROLS/ PERSONAL PROTECTION

Control Parameters	Occupational Exposure Limits			
	Ingredient Identity	ACGIH TLV	OSHA PEL	NIOSH IDLH
Butoxydiglycol	112-34-5	TWA 10ppm		

Distillates, Petroleum TWA:skin absorption 200mg/m³ (as total hydrocarbon vapor) 8 hours
Hydrotreated, Light 64742-47-8

Appropriate Engineering Controls

Engineering Controls: Use only with adequate ventilation. Use process enclosures, local exhaust ventilation or other engineering controls to keep worker exposure to airborne contaminants and air concentrations below occupational exposure standards.

Individual protection measures, such as personal protective equipment. (PPE)

Eye/Face Protection: Wear approved tightly sealed safety goggles

Skin & Body Protection: Wear chemical resistant, impervious gloves at all times when handling chemical products. Check during use that gloves are still retaining their impervious properties, as the time for breakthrough can change from different manufacturers and chemical mixtures cannot always be accurately measured. Appropriate footwear and suitable protective clothing should be worn for the degree and risk of exposure.

Respiratory Protection: If workplace exposure limits of product or any component is exceeded, utilize proper respiratory protection program guidelines (see OSHA 1910.134 and American National Standard ANSI Z88.2) Use a properly fitted NIOSH/MSHA air-purifying or air-fed respirator in compliance with the above mentioned standard if a risk assessment indicates this is necessary. Respirator selection must be based on known or anticipated exposure levels, the hazards of the product and the safe working limits of the selected respirator.

9. PHYSICAL AND CHEMICAL PROPERTIES

Appearance: clear liquid

Odor: near odorless

Odor threshold: not available

pH: not applicable

Melting Point/Freezing Point: -56F

Initial Boiling Point/Range: 344F-473F

Flash Pt: >200F lowest ingredient, does not sustain combustion

Evaporation Rate: <1 (butyl acetate=1)

Lower explosive limits: .6% Aliphatic Solvent

Upper explosive limits: 5.5% Aliphatic Solvent

Vapor Pressure: meets CARB guidelines

Vapor Density: 4.5-5 (air=1)

Relative Density: .84

Solubility in water: Emulsifies

Partition coefficient: not applicable

Auto ignition temp: >428F

Decomposition Temp: not available

Viscosity: pourable liquid

10. STABILITY AND REACTIVITY

Reactivity: Stable in normal ambient temperature and pressure

Chemical Stability: Stable under recommended storage conditions.

Possibility of Hazardous Reactions: not under normal conditions of storage and use.

Conditions to Avoid: Open flames, sparks

Incompatible Materials: Oxidizing materials

Hazardous Decomposition Products: Carbon monoxide and Carbon Dioxide

11. TOXICOLOGICAL INFORMATION

Acute toxicity: Not classified,

Skin corrosion irritation: not classified,

Serious Eye damage: classified, Category 2, Causes serious eye irritation, Butoxydiglycol 112-34-5

Sensitization: Not classified,

Mutagenicity: Not classified,

Carcinogenicity: Not classified

Reproductive Toxicity: Not Classified

Teratogenicity: Not Available

Specific target Organ Toxicity (single exposure)

Not classified

Specific target Organ Toxicity (repeated exposure):

Not classified

Aspiration Hazard:

Distillate petroleum hydrotreated, light 64742-47-8 , Aspiration Hazard Category 1

SAFETY DATA SHEET**TRADE NAME: CHEMSAFE CLEAR**

PAGE 7 OF 8

Information on the likely routes of exposure:**Ingestion:** May be harmful if swallowed. May be fatal if swallowed and enters airways.**Inhalation:** Do not breathe vapors or mists.**Skin:** May be harmful in contact with skin.**Eye:** Causes serious eye irritation**Symptoms related to the physical, chemical and toxicological characteristics****Ingestion:** See section iv, most important symptoms and effects, acute and delayed.**Inhalation:** See section iv, most important symptoms and effects, acute and delayed.**Skin:** See section iv, most important symptoms and effects, acute and delayed.**Eye:** See section iv, most important symptoms and effects, acute and delayed.**Delayed and immediate effects and also chronic effects from short and long term exposure.**

General: Prolonged or repeated contact can defat the skin and lead to irritation, cracking and/or dermatitis

Carcinogenicity: no known significant effects or critical hazards. Not classifiable.

Numerical measures of Toxicity

Not Available

12. ECOLOGICAL INFORMATION**Toxicity:**

<u>Ingredient name</u>	<u>Result</u>	<u>Species</u>	<u>Exposure</u>
Distillate Petroleum, Hydrotreated, light	Chronic NOEL 0.48 mg/l	Daphnia	21 days

Persistence and degradability:Distillate Petroleum: Biodegradability-inherent
Hydrotreated

Butoxydiglycol 112-34-5: readily biodegradable

Bioaccumulation Potential:

Not expected to bioaccumulate

Mobility in Soil:

No data

Other adverse Effects:

No known significant effects or critical hazards

13. DISPOSAL CONSIDERATIONS

Dispose in accordance with applicable federal, state and local regulations.

SAFETY DATA SHEET**TRADE NAME: CHEMSAFE CLEAR**

PAGE 8 OF 8

14. TRANSPORTATION INFORMATION

DOT: NOT REGULATED
IATA: NOT REGULATED
IMDG: NOT REGULATED

15. REGULATORY INFORMATION

U.S. FEDERAL REGULATIONS: All ingredients are listed or exempted with TSCA.

SARA 302/304: no products were found.

SARA 311/312: acute health hazard

Ingredient	%	FIRE HAZARD	PRESSURE RELEASE	REACTIVE	IMMEDIATE ACUTE	DELAYED CHRONIC
Distillate Petroleum, Hydrotreated	80-95	YES	NO	NO	NO	NO
Butoxydiglycol 112-34-5	PROPRIETARY				YES	YES

SARA 313: butoxydiglycol, <12%

STATE REGULATIONS:

Ingredient	New York	New Jersey	Massachusetts	Pennsylvania
Distillate Petroleum Hydrotreated. 64742-47-8	No	No	No	No
Butoxydiglycol 112-34-5	No	Yes	Yes	yes

California Prop 65: none known

16. OTHER INFORMATION

HMIS RATING: HEALTH (1) FIRE (1) REACTIVITY (0)
 4=EXTREME, 3=HIGH, 2=MODERATE, 1=SLIGHT, 0=INSIGNIFICANT

NOTICE TO READER:

To the best of our knowledge, the information contained herein is accurate. However, neither the above-named supplier, nor any of its subsidiaries assumes any liability whatsoever for the accuracy or completeness of the information contained herein. The information on this sds was obtained from sources which we believe are reliable. However, the information is provided without any warranty, expressed or implied, regarding its correctness. Users are advised to confirm in advance of need, that information is current, applicable and suited to the circumstances of use. Vendor assumes no responsibility for injury to vendee or third persons proximately caused by the material if reasonable safety procedures are not adhered to as stipulated in the sds. Furthermore, vendor assumes no responsibility for injury caused by abnormal use of this material even if reasonable safety procedures are followed.



1201 24th Street, Suite B110-377, Bakersfield, CA 93301 / (661) 527-0820

Attachment D – Asbestos Inspection Report by Room



YES Environmental, Inc.

1201 24th Street, Suite B110-377, Bakersfield, CA 93301 / (661) 527-0820

Client: Bakersfield City School District

Site: Wayside ES

YES Project No.: 23YES-05

Date of Inspection: 6/27/2023

Inspection Report

Building: Campus Wide

Component	HMR #	Sample #	Material Description	Substrate	ACM Y/N	Friable Y/N
Ground	38	38A-B	Asphalt		N	n/a

Building: Covered Walkways Throughout Campus

Component	HMR #	Sample #	Material Description	Substrate	ACM Y/N	Friable Y/N
Ground	38		Asphalt		N	n/a
Ground	-		Concrete - bare & exposed		n/a	n/a
Ceilings	35		Exterior stucco, painted		N	n/a
Roof	36		White coated foam on silver paint on rolled composition roofing	Diagonal sheathing	Y	N
	NOTE		Foam=ND; Silver Paint=2-4% CH; Rolled Composition Roofing & Felts=ND			
Roof	37		White coated foam on silver paint on penetration mastic		Y	N
	NOTE		Foam=ND; Silver Paint=2-4% CH; Mastics=Assumed			
	NOTE		On components such as, but not limited to, roof jacks, roof vents, conduits, sleepers, patches, etc.			

RED=contains asbestos

BLACK=no asbestos detected or non-suspect



YES Environmental, Inc.

1201 24th Street, Suite B110-377, Bakersfield, CA 93301 / (661) 527-0820

Client: Bakersfield City School District

Site: Wayside ES

YES Project No.: 23YES-05

Date of Inspection: 6/27/2023

Inspection Report

Building:	Chiller Yard	Room Name:	Chiller Yard
------------------	--------------	-------------------	--------------

Component	HMR #	Sample #	Material Description	Substrate	ACM Y/N	Friable Y/N
Ground	-		Concrete - bare & exposed		n/a	n/a
Walls	-		CMU		n/a	n/a
Pipes	47	47A-C	Paper jacketed fiberglass pipe insulation		N	n/a
	NOTE		Mostly concealed behind metal jacketing			

RED=contains asbestos

BLACK=no asbestos detected or non-suspect



YES Environmental, Inc.

1201 24th Street, Suite B110-377, Bakersfield, CA 93301 / (661) 527-0820

Client: Bakersfield City School District

Site: Wayside ES

YES Project No.: 23YES-05

Date of Inspection: 6/27/2023

Inspection Report

Building:	Building A - Classrooms 1-5	Room Name:	Attic
<p>Attic is defined as: every enclosed spaced that is contiguous and/or beneath the roof, attic, void, and plenum space above every room in this building including, but not limited to, exterior enclosed eaves, enclosed hallways, walkways, corridors, wall cavities, etc. and all spaces beneath the roof and above ceilings that are or are not readily accessible.</p>			
<p>Attic Floor is defined as: the surface within an attic space, serving as the ceiling for the room(s) below and/or an area with exposed joists. It is not a term that can be used to infer a walkable surface.</p>			

Component	HMR #	Sample #	Material Description	Substrate	ACM Y/N	Friable Y/N
Attic Floor	26		Roofing debris with silver paint		Y	Y
	NOTE		Silver Paint=3% CH; Other various roof material=ND material exists on and inbetween the floor joists of this space.	This		
Attic Floor	-		Fiberglass batt insulation		Y	Y
	NOTE		Contaminated with asbestos roofing debris			
Walls	-		Wood		n/a	n/a
Flue Pipes			Transite flue pipes - Known Asbestos Material (typically 10-20% Chrysotile)		Y	N
Ceiling	-		Diagonal sheathing		n/a	n/a

RED=contains asbestos

BLACK=no asbestos detected or non-suspect



YES Environmental, Inc.

1201 24th Street, Suite B110-377, Bakersfield, CA 93301 / (661) 527-0820

Building:	Building A - Classrooms 1-5	Room Name:	Classroom 1	Rm Ft²:	960
		Room Dimensions:	L=32 W=30 H=9/12		

Component	HMR #	Sample #	Material Description	Substrate	ACM Y/N	Friable Y/N
Floor	1		Carpet & glue - grey/green/multi	Concrete	N	n/a
Floor	2		Carpet & glue - black/white speckled	Concrete	N	n/a
BB	3	03B	Baseboard & glue 3" & 4" blue	wood	N	n/a
BB	-		Wood baseboard		n/a	n/a
Walls	4	04A	Plaster - sanded finish		N	n/a
Walls	5	05A	Tackboards & glue	Plaster	N	n/a
Sink	6	06D	Sink coating - black (stainless steel)		N	n/a
Ceiling	7	07A	Lay-in panels - 2' x 4' gouge pinhole	ACM Roofing debris	N	n/a
Ceiling	26		Roofing debris with silver paint	F/G insulation	Y	Y
	NOTE		Silver Paint=3% CH; Other various roof material=ND			
Ceiling	-		Fiberglass insulation	ACM Roofing debris	n/a	n/a
Ceiling	26		Roofing debris with silver paint	12" ACT	Y	Y
	NOTE		Silver Paint=3% CH; Other various roof material=ND			
Ceiling	8		Acoustic ceiling tiles 12" uniform hole pattern (nailed)	wood slat	N	n/a
Ceiling	-		Wood slats	ACM Roofing debris	n/a	n/a
Ceiling	26		Roofing debris with silver paint	Wool batt insulation	Y	Y
	NOTE		Silver Paint=3% CH; Other various roof material=ND			
Ceiling	24		Wool-batt insulation glued (black) to paper backing	diagonal sheathing	N	n/a

RED=contains asbestos

BLACK=no asbestos detected or non-suspect



YES Environmental, Inc.

1201 24th Street, Suite B110-377, Bakersfield, CA 93301 / (661) 527-0820

Building:	Building A - Classrooms 1-5	Room Name:	Classroom 2	Rm Ft²:	960
		Room Dimensions:	L=32 W=30 H=9/12		

Component	HMR #	Sample #	Material Description	Substrate	ACM Y/N	Friable Y/N
Floor	1	01B	Carpet & glue - grey/green/multi	Concrete	N	n/a
Floor	2		Carpet & glue - black/white speckled	Concrete	N	n/a
BB	3		Baseboard & glue 3" & 4" blue	wood	N	n/a
BB	-		Wood baseboard		n/a	n/a
Walls	4		Plaster - sanded finish		N	n/a
Walls	5		Tackboards & glue	Plaster	N	n/a
Sink	6		Sink coating - black (stainless steel)		N	n/a
Ceiling	7		Lay-in panels - 2' x 4' gouge pinhole	ACM Roofing debris	N	n/a
Ceiling	26		Roofing debris with silver paint	F/G insulation	Y	Y
	NOTE		Silver Paint=3% CH; Other various roof material=ND			
Ceiling	-		Fiberglass insulation	ACM Roofing debris	n/a	n/a
Ceiling	26		Roofing debris with silver paint	12" ACT	Y	Y
	NOTE		Silver Paint=3% CH; Other various roof material=ND			
Ceiling	8	08D	Acoustic ceiling tiles 12" uniform hole pattern (nailed)	wood slat	N	n/a
Ceiling	-		Wood slats	ACM Roofing debris	n/a	n/a
Ceiling	26		Roofing debris with silver paint	Wool batt insulation	Y	Y
	NOTE		Silver Paint=3% CH; Other various roof material=ND			
Ceiling	24		Wool-batt insulation glued (black) to paper backing	diagonal sheathing	N	n/a

RED=contains asbestos

BLACK=no asbestos detected or non-suspect



YES Environmental, Inc.

1201 24th Street, Suite B110-377, Bakersfield, CA 93301 / (661) 527-0820

Building:	Building A - Classrooms 1-5	Room Name:	Classroom 3	Rm Ft²:	960
		Room Dimensions:	L=32 W=30 H=9/12		

Component	HMR #	Sample #	Material Description	Substrate	ACM Y/N	Friable Y/N
Floor	1		Carpet & glue - grey/green/multi	Concrete	N	n/a
Floor	2	02A	Carpet & glue - black/white speckled	Concrete	N	n/a
BB	3	03C	Baseboard & glue 3" & 4" blue	wood	N	n/a
BB	-		Wood baseboard		n/a	n/a
Walls	4	04I	Plaster - sanded finish		N	n/a
Walls	5		Tackboards & glue	Plaster	N	n/a
Sink	6		Sink coating - black (stainless steel)		N	n/a
Ceiling	7	07C	Lay-in panels - 2' x 4' gouge pinhole	ACM Roofing debris	N	n/a
Ceiling	26		Roofing debris with silver paint	F/G insulation	Y	Y
	NOTE		Silver Paint=3% CH; Other various roof material=ND			
Ceiling	-		Fiberglass insulation	ACM Roofing debris	n/a	n/a
Ceiling	26		Roofing debris with silver paint	12" ACT	Y	Y
	NOTE		Silver Paint=3% CH; Other various roof material=ND			
Ceiling	8		Acoustic ceiling tiles 12" uniform hole pattern (nailed)	wood slat	N	n/a
Ceiling	-		Wood slats	ACM Roofing debris	n/a	n/a
Ceiling	26		Roofing debris with silver paint	Wool batt insulation	Y	Y
	NOTE		Silver Paint=3% CH; Other various roof material=ND			
Ceiling	24		Wool-batt insulation glued (black) to paper backing	diagonal sheathing	N	n/a

RED=contains asbestos

BLACK=no asbestos detected or non-suspect



YES Environmental, Inc.

1201 24th Street, Suite B110-377, Bakersfield, CA 93301 / (661) 527-0820

Building:	Building A - Classrooms 1-5	Room Name:	Classroom 4	Rm Ft²:	960
		Room Dimensions:	L=32 W=30 H=9/12		

Component	HMR #	Sample #	Material Description	Substrate	ACM Y/N	Friable Y/N
Floor	1		Carpet & glue - grey/green/multi	Concrete	N	n/a
Floor	2		Carpet & glue - black/white speckled	Concrete	N	n/a
BB	3		Baseboard & glue 3" & 4" blue	wood	N	n/a
BB	-		Wood baseboard		n/a	n/a
Walls	4		Plaster - sanded finish		N	n/a
Walls	5		Tackboards & glue	Plaster	N	n/a
Sink	6		Sink coating - black (stainless steel)		N	n/a
Ceiling	7		Lay-in panels - 2' x 4' gouge pinhole	ACM Roofing debris	N	n/a
Ceiling	26		Roofing debris with silver paint	F/G insulation	Y	Y
	NOTE		Silver Paint=3% CH; Other various roof material=ND			
Ceiling	-		Fiberglass insulation	ACM Roofing debris	n/a	n/a
Ceiling	26		Roofing debris with silver paint	12" ACT	Y	Y
	NOTE		Silver Paint=3% CH; Other various roof material=ND			
Ceiling	8	08A	Acoustic ceiling tiles 12" uniform hole pattern (nailed)	wood slat	N	n/a
Ceiling	-		Wood slats	ACM Roofing debris	n/a	n/a
Ceiling	26		Roofing debris with silver paint	Wool batt insulation	Y	Y
	NOTE		Silver Paint=3% CH; Other various roof material=ND			
Ceiling	24		Wool-batt insulation glued (black) to paper backing	diagonal sheathing	N	n/a

RED=contains asbestos

BLACK=no asbestos detected or non-suspect



YES Environmental, Inc.

1201 24th Street, Suite B110-377, Bakersfield, CA 93301 / (661) 527-0820

Building:	Building A - Classrooms 1-5	Room Name:	Classroom 5	Rm Ft²:	960
		Room Dimensions:	L=32 W=30 H=9/12		

Component	HMR #	Sample #	Material Description	Substrate	ACM Y/N	Friable Y/N
Floor	1		Carpet & glue - grey/green/multi	Concrete	N	n/a
Floor	2		Carpet & glue - black/white speckled	Concrete	N	n/a
BB	3		Baseboard & glue 3" & 4" blue	wood	N	n/a
BB	-		Wood baseboard		n/a	n/a
Walls	4		Plaster - sanded finish		N	n/a
Walls	5		Tackboards & glue	Plaster	N	n/a
Sink	6		Sink coating - black (stainless steel)		N	n/a
Ceiling	7		Lay-in panels - 2' x 4' gouge pinhole	ACM Roofing debris	N	n/a
Ceiling	26		Roofing debris with silver paint	F/G insulation	Y	Y
	NOTE		Silver Paint=3% CH; Other various roof material=ND			
Ceiling	-		Fiberglass insulation	ACM Roofing debris	n/a	n/a
Ceiling	26		Roofing debris with silver paint	12" ACT	Y	Y
	NOTE		Silver Paint=3% CH; Other various roof material=ND			
Ceiling	8		Acoustic ceiling tiles 12" uniform hole pattern (nailed)	wood slat	N	n/a
Ceiling	-		Wood slats	ACM Roofing debris	n/a	n/a
Ceiling	26		Roofing debris with silver paint	Wool batt insulation	Y	Y
	NOTE		Silver Paint=3% CH; Other various roof material=ND			
Ceiling	24		Wool-batt insulation glued (black) to paper backing	diagonal sheathing	N	n/a

RED=contains asbestos

BLACK=no asbestos detected or non-suspect



YES Environmental, Inc.

1201 24th Street, Suite B110-377, Bakersfield, CA 93301 / (661) 527-0820

Building: Building A - Classrooms 1-5 East of Rm 5 & West of Girls RR	Room Name: Speech Room	Rm Ft²: 208
	Room Dimensions: L=13 W=16 H=9	

Component	HMR #	Sample #	Material Description	Substrate	ACM Y/N	Friable Y/N
Floor	1		Carpet & glue - grey/green/multi	Concrete	N	n/a
Floor	2		Carpet & glue - black/white speckled	Concrete	N	n/a
BB	3		Baseboard & glue 3" & 4" blue	wood	N	n/a
Walls	4		Plaster - sanded finish		N	n/a
Ceiling	4		Plaster - sanded finish	ACM Roofing debris	N	n/a
Ceiling	26		Roofing debris with silver paint		Y	Y
	NOTE		Silver Paint=3% CH; Other various roof material=ND			

Building: Building A - Classrooms 1-5 East of Rm 5	Room Name: Girls' Restroom	Rm Ft²: 352
	Room Dimensions: L=22 W=16 H=	

Component	HMR #	Sample #	Material Description	Substrate	ACM Y/N	Friable Y/N
Floor	9	09B	Ceramic floor tile grout (2" grey)		N	n/a
BB			None			
Walls	10	10B-C	Ceramic wall tile grout - blue (4" white)	Plaster	N	n/a
	NOTE		AFF 6'			
Walls	4	04J	Plaster - sanded finish		N	n/a
Ceiling	4		Plaster - sanded finish	ACM Roofing debris	N	n/a
Ceiling	26		Roofing debris with silver paint		Y	Y
	NOTE		Silver Paint=3% CH; Other various roof material=ND			

RED=contains asbestos

BLACK=no asbestos detected or non-suspect



YES Environmental, Inc.

1201 24th Street, Suite B110-377, Bakersfield, CA 93301 / (661) 527-0820

Building: Building A - Classrooms 1-5 East of Rm 5	Room Name: Boys' Restroom	Rm Ft²: 352
Room Dimensions: L=22 W=16 H=		

Component	HMR #	Sample #	Material Description	Substrate	ACM Y/N	Friable Y/N
Floor	9		Ceramic floor tile grout (2" grey)		N	n/a
BB			None			
Walls	10		Ceramic wall tile grout - blue (4" white)	Plaster	N	n/a
	NOTE		AFF 6'			
Walls	4		Plaster - sanded finish		N	n/a
Ceiling	4		Plaster - sanded finish	ACM Roofing debris	N	n/a
Ceiling	26		Roofing debris with silver paint		Y	Y
	NOTE		Silver Paint=3% CH; Other various roof material=ND			

Building: Building A - Classrooms 1-5 East of Rm 5 - north side of bldg	Room Name: North Ball Room	Rm Ft²: 208
Room Dimensions: L=16 W=13 H=12		

Component	HMR #	Sample #	Material Description	Substrate	ACM Y/N	Friable Y/N
Floor	-		Concrete - bare & exposed		n/a	n/a
BB	-		Wood		n/a	n/a
Walls	-		Plywod on lower 4' of walls		n/a	n/a
Walls	4		Plaster - sanded finish		N	n/a
Ceiling	-		Plywood - painted		n/a	n/a
Door	11		Fire Door - label painted over		Y	Y
	NOTE		Assumed. Test before disturbing or removing.			

RED=contains asbestos

BLACK=no asbestos detected or non-suspect



YES Environmental, Inc.

1201 24th Street, Suite B110-377, Bakersfield, CA 93301 / (661) 527-0820

Building:	Building A - Classrooms 1-5	Room Name:	Exterior
------------------	-----------------------------	-------------------	----------

Component	HMR #	Sample #	Material Description	Substrate	ACM Y/N	Friable Y/N
Ground	38	38A	Asphalt		N	n/a
Ground	-		Concrete - bare & exposed		n/a	n/a
Walls	35	35A,G	Exterior stucco, painted & vapor barrier		N	n/a
Windows	28	28A-B	Exterior window putty		N	n/a
Eaves	35		Exterior stucco, painted		N	n/a
Roof	36	36A	White coated foam on silver paint on rolled composition roofing	Diagonal sheathing	Y	N
	NOTE		Foam=ND; Silver Paint=2-4% CH; Rolled Composition Roofing & Felts=ND			
Roof	37		White coated foam on silver paint on penetration mastic		Y	N
	NOTE		Foam=ND; Silver Paint=2-4% CH; Mastics=Assumed			
	NOTE		On components such as, but not limited to, roof jacks, roof vents, conduits, sleepers, patches, etc.			

RED=contains asbestos

BLACK=no asbestos detected or non-suspect



YES Environmental, Inc.

1201 24th Street, Suite B110-377, Bakersfield, CA 93301 / (661) 527-0820

Client: Bakersfield City School District

Site: Wayside ES

YES Project No.: 23YES-05

Date of Inspection: 6/27/2023

Inspection Report

Building:	Building B - Classrooms 12-16	Room Name:	Attic
<p>Attic is defined as: every enclosed spaced that is contiguous and/or beneath the roof, attic, void, and plenum space above every room in this building including, but not limited to, exterior enclosed eaves, enclosed hallways, walkways, corridors, wall cavities, etc. and all spaces beneath the roof and above ceilings that are or are not readily accessible.</p>			
<p>Attic Floor is defined as: the surface within an attic space, serving as the ceiling for the room(s) below and/or an area with exposed joists. It is not a term that can be used to infer a walkable surface.</p>			

Component	HMR #	Sample #	Material Description	Substrate	ACM Y/N	Friable Y/N
Attic Floor	26		Roofing debris with silver paint		Y	Y
	NOTE		Silver Paint=3% CH; Other various roof material=ND material exists on and inbetween the floor joists of this space.	This		
Attic Floor	-		Fiberglass batt insulation		Y	Y
	NOTE		Contaminated with asbestos roofing debris			
Walls	-		Wood		n/a	n/a
Flue Pipes			Transite flue pipes - Known Asbestos Material (typically 10-20% Chrysotile)		Y	N
Ceiling	-		Diagonal sheathing		n/a	n/a

RED=contains asbestos

BLACK=no asbestos detected or non-suspect



YES Environmental, Inc.

1201 24th Street, Suite B110-377, Bakersfield, CA 93301 / (661) 527-0820

Building:	Building B - Classrooms 12-16	Room Name:	Classroom 12	Rm Ft²:	960
		Room Dimensions:	L=32 W=30 H=9/12		

Component	HMR #	Sample #	Material Description	Substrate	ACM Y/N	Friable Y/N
Floor	1		Carpet & glue - grey/green/multi	Concrete	N	n/a
Floor	2		Carpet & glue - black/white speckled	Concrete	N	n/a
BB	12	12B	Baseboard & glue - 4" lt green	wood	N	n/a
BB	-		Wood baseboard		n/a	n/a
Walls	4		Plaster - sanded finish		N	n/a
Walls	5		Tackboards & glue	Plaster	N	n/a
Sink	6		Sink coating - black (stainless steel)		N	n/a
Ceiling	7		Lay-in panels - 2' x 4' gouge pinhole	ACM Roofing debris	N	n/a
Ceiling	26		Roofing debris with silver paint	F/G insulation	Y	Y
	NOTE		Silver Paint=3% CH; Other various roof material=ND			
Ceiling	-		Fiberglass insulation	ACM Roofing debris	n/a	n/a
Ceiling	26		Roofing debris with silver paint	12" ACT	Y	Y
	NOTE		Silver Paint=3% CH; Other various roof material=ND			
Ceiling	8	O8F	Acoustic ceiling tiles 12" uniform hole pattern (nailed)	wood slat	N	n/a
Ceiling	-		Wood slats	ACM Roofing debris	n/a	n/a
Ceiling	26		Roofing debris with silver paint	Wool batt insulation	Y	Y
	NOTE		Silver Paint=3% CH; Other various roof material=ND			
Ceiling	24		Wool-batt insulation glued (black) to paper backing	diagonal sheathing	N	n/a

RED=contains asbestos

BLACK=no asbestos detected or non-suspect



YES Environmental, Inc.

1201 24th Street, Suite B110-377, Bakersfield, CA 93301 / (661) 527-0820

Building:	Building B - Classrooms 12-16	Room Name:	Classroom 13	Rm Ft²:	960
		Room Dimensions:	L=32 W=30 H=9/12		

Component	HMR #	Sample #	Material Description	Substrate	ACM Y/N	Friable Y/N
Floor	1		Carpet & glue - grey/green/multi	Concrete	N	n/a
Floor	2		Carpet & glue - black/white speckled	Concrete	N	n/a
BB	3		Baseboard & glue 3" & 4" blue	wood	N	n/a
BB	-		Wood baseboard		n/a	n/a
Walls	4	04C	Plaster - sanded finish		N	n/a
Walls	5		Tackboards & glue	Plaster	N	n/a
Sink	6		Sink coating - black (stainless steel)		N	n/a
Ceiling	7	07E	Lay-in panels - 2' x 4' gouge pinhole	ACM Roofing debris	N	n/a
Ceiling	26		Roofing debris with silver paint	F/G insulation	Y	Y
	NOTE		Silver Paint=3% CH; Other various roof material=ND			
Ceiling	-		Fiberglass insulation	ACM Roofing debris	n/a	n/a
Ceiling	26		Roofing debris with silver paint	12" ACT	Y	Y
	NOTE		Silver Paint=3% CH; Other various roof material=ND			
Ceiling	8		Acoustic ceiling tiles 12" uniform hole pattern (nailed)	wood slat	N	n/a
Ceiling	-		Wood slats	ACM Roofing debris	n/a	n/a
Ceiling	26		Roofing debris with silver paint	Wool batt insulation	Y	Y
	NOTE		Silver Paint=3% CH; Other various roof material=ND			
Ceiling	24		Wool-batt insulation glued (black) to paper backing	diagonal sheathing	N	n/a

RED=contains asbestos

BLACK=no asbestos detected or non-suspect



YES Environmental, Inc.

1201 24th Street, Suite B110-377, Bakersfield, CA 93301 / (661) 527-0820

Building:	Building B - Classrooms 12-16	Room Name:	Classroom 14	Rm Ft²:	960
		Room Dimensions:	L=32 W=30 H=9/12		

Component	HMR #	Sample #	Material Description	Substrate	ACM Y/N	Friable Y/N
Floor	1		Carpet & glue - grey/green/multi	Concrete	N	n/a
Floor	2		Carpet & glue - black/white speckled	Concrete	N	n/a
BB	12	12A	Baseboard & glue - 4" lt green	wood	N	n/a
BB	-		Wood baseboard		n/a	n/a
Walls	4		Plaster - sanded finish		N	n/a
Walls	5		Tackboards & glue	Plaster	N	n/a
Sink	6	06B	Sink coating - black (stainless steel)		N	n/a
Ceiling	7	07F	Lay-in panels - 2' x 4' gouge pinhole	ACM Roofing debris	N	n/a
Ceiling	26		Roofing debris with silver paint	F/G insulation	Y	Y
	NOTE		Silver Paint=3% CH; Other various roof material=ND			
Ceiling	-		Fiberglass insulation	ACM Roofing debris	n/a	n/a
Ceiling	26		Roofing debris with silver paint	Unfinished drywall	Y	Y
	NOTE		Silver Paint=3% CH; Other various roof material=ND			
Ceiling	25	25A	Unfinished drywall, with tape & joint compound	ACM Roofing debris	N	n/a
Ceiling	26		Roofing debris with silver paint	diagonal sheathing	Y	Y
	NOTE		Silver Paint=3% CH; Other various roof material=ND			

RED=contains asbestos

BLACK=no asbestos detected or non-suspect



YES Environmental, Inc.

1201 24th Street, Suite B110-377, Bakersfield, CA 93301 / (661) 527-0820

Building:	Building B - Classrooms 12-16	Room Name:	Classroom 15	Rm Ft²:	960
		Room Dimensions:	L=32 W=30 H=9/12		

Component	HMR #	Sample #	Material Description	Substrate	ACM Y/N	Friable Y/N
Floor	1		Carpet & glue - grey/green/multi	Concrete	N	n/a
Floor	2	02D	Carpet & glue - black/white speckled	Concrete	N	n/a
BB	3		Baseboard & glue 3" & 4" blue	wood	N	n/a
BB	-		Wood baseboard		n/a	n/a
Walls	4	04F	Plaster - sanded finish		N	n/a
Walls	5		Tackboards & glue	Plaster	N	n/a
Sink	6		Sink coating - black (stainless steel)		N	n/a
Ceiling	7		Lay-in panels - 2' x 4' gouge pinhole	ACM Roofing debris	N	n/a
Ceiling	26		Roofing debris with silver paint	F/G insulation	Y	Y
	NOTE		Silver Paint=3% CH; Other various roof material=ND			
Ceiling	-		Fiberglass insulation	ACM Roofing debris	n/a	n/a
Ceiling	26		Roofing debris with silver paint	12" ACT	Y	Y
	NOTE		Silver Paint=3% CH; Other various roof material=ND			
Ceiling	8	08E	Acoustic ceiling tiles 12" uniform hole pattern (nailed)	wood slat	N	n/a
Ceiling	-		Wood slats	ACM Roofing debris	n/a	n/a
Ceiling	26		Roofing debris with silver paint	Wool batt insulation	Y	Y
	NOTE		Silver Paint=3% CH; Other various roof material=ND			
Ceiling	24		Wool-batt insulation glued (black) to paper backing	diagonal sheathing	N	n/a

RED=contains asbestos

BLACK=no asbestos detected or non-suspect



YES Environmental, Inc.

1201 24th Street, Suite B110-377, Bakersfield, CA 93301 / (661) 527-0820

Building:	Building B - Classrooms 12-16	Room Name:	Classroom 16	Rm Ft²:	960
		Room Dimensions:	L=32 W=30 H=9/12		

Component	HMR #	Sample #	Material Description	Substrate	ACM Y/N	Friable Y/N
Floor	1	01C	Carpet & glue - grey/green/multi	Concrete	N	n/a
Floor	2		Carpet & glue - black/white speckled	Concrete	N	n/a
BB	3		Baseboard & glue 3" & 4" blue	wood	N	n/a
BB	-		Wood baseboard		n/a	n/a
Walls	4		Plaster - sanded finish		N	n/a
Walls	5		Tackboards & glue	Plaster	N	n/a
Sink	6		Sink coating - black (stainless steel)		N	n/a
Ceiling	7		Lay-in panels - 2' x 4' gouge pinhole	ACM Roofing debris	N	n/a
Ceiling	26		Roofing debris with silver paint	F/G insulation	Y	Y
	NOTE		Silver Paint=3% CH; Other various roof material=ND			
Ceiling	-		Fiberglass insulation	ACM Roofing debris	n/a	n/a
Ceiling	26		Roofing debris with silver paint	12" ACT	Y	Y
	NOTE		Silver Paint=3% CH; Other various roof material=ND			
Ceiling	8		Acoustic ceiling tiles 12" uniform hole pattern (nailed)	wood slat	N	n/a
Ceiling	-		Wood slats	ACM Roofing debris	n/a	n/a
Ceiling	26		Roofing debris with silver paint	Wool batt insulation	Y	Y
	NOTE		Silver Paint=3% CH; Other various roof material=ND			
Ceiling	24		Wool-batt insulation glued (black) to paper backing	diagonal sheathing	N	n/a

RED=contains asbestos

BLACK=no asbestos detected or non-suspect



YES Environmental, Inc.

1201 24th Street, Suite B110-377, Bakersfield, CA 93301 / (661) 527-0820

Building: Building B - Classrooms 12-16 East of Rm 16	Room Name:	Custodial Room	Rm Ft²: 143
	Room Dimensions: L=13	W=11 H=9	

Component	HMR #	Sample #	Material Description	Substrate	ACM Y/N	Friable Y/N
Floor	-		Concrete - bare & exposed		n/a	n/a
BB	-		Wood		n/a	n/a
Walls	4	04B	Plaster - sanded finish		N	n/a
Ceiling	4		Plaster - sanded finish	ACM Roofing debris	N	n/a
Ceiling	26	26C	Roofing debris with silver paint		Y	Y
	NOTE		Silver Paint=3% CH; Other various roof material=ND			
NOTE			ATTIC ACCESS			

RED=contains asbestos

BLACK=no asbestos detected or non-suspect



YES Environmental, Inc.

1201 24th Street, Suite B110-377, Bakersfield, CA 93301 / (661) 527-0820

Building: Building B - Classrooms 12-16	Room Name: East Teachers' Workroom	Rm Ft²: 288
Inside East Teachers' Workroom	Room Dimensions: L=18 W=16 H=12	

Component	HMR #	Sample #	Material Description	Substrate	ACM Y/N	Friable Y/N
Floor	13		Floor tile & glue 12" blue/grey oatmeal	Concrete	N	n/a
BB	14	14A	Baseboard & glue 4" dk grey	Wood	N	n/a
BB	-		Wood		n/a	n/a
Walls	4		Plaster - sanded finish		N	n/a
Ceiling	15	15A	Lay-in panels - 2' x 4' variety (fiss/gouge) various ages	ACM Roofing debris	N	n/a
Ceiling	26		Roofing debris with silver paint	F/G insulation	Y	Y
	NOTE		Silver Paint=3% CH; Other various roof material=ND			
Ceiling	-		Fiberglass insulation	ACM Roofing debris	n/a	n/a
Ceiling	26		Roofing debris with silver paint	12" ACT	Y	Y
	NOTE		Silver Paint=3% CH; Other various roof material=ND			
Ceiling	8		Acoustic ceiling tiles 12" uniform hole pattern (nailed)	wood slat	N	n/a
Ceiling	-		Wood slats	ACM Roofing debris	n/a	n/a
Ceiling	26		Roofing debris with silver paint	Wool batt insulation	Y	Y
	NOTE		Silver Paint=3% CH; Other various roof material=ND			
Ceiling	24		Wool-batt insulation glued (black) to paper backing	diagonal sheathing	N	n/a

RED=contains asbestos

BLACK=no asbestos detected or non-suspect



YES Environmental, Inc.

1201 24th Street, Suite B110-377, Bakersfield, CA 93301 / (661) 527-0820

Building: Building B - Classrooms 12-16 East of Rm 16	Room Name: Staff Restroom	Rm Ft²: 112
	Room Dimensions: L=14 W=8 H=12	

Component	HMR #	Sample #	Material Description	Substrate	ACM Y/N	Friable Y/N
Floor	16	16A	Sheet flooring & glue - grey mosaic pattern	Concrete	N	n/a
BB			None			
Walls	17	17A	Plaster - smooth finish		N	n/a
Ceiling	4		Plaster - sanded finish	ACM Roofing debris	N	n/a
Ceiling	26		Roofing debris with silver paint		Y	Y
	NOTE		Silver Paint=3% CH; Other various roof material=ND			

Building: Building B - Classrooms 12-16 adjacent to CR 16	Room Name: West Teachers' Workroom	Rm Ft²: 640
	Room Dimensions: L=32 W=20 H=12	

Component	HMR #	Sample #	Material Description	Substrate	ACM Y/N	Friable Y/N
Floor	13	13A	Floor tile & glue 12" blue/grey oatmeal	Concrete	N	n/a
BB	14		Baseboard & glue 4" dk grey	Wood	N	n/a
BB	-		Wood		n/a	n/a
Walls	4		Plaster - sanded finish		N	n/a
Walls	5	05C	Tackboards & glue	Plaster	N	n/a
Ceiling	15		Lay-in panels - 2' x 4' variety (fiss/gouge) various ages	Plywood	N	n/a
Door	11		Fire Door - label painted over		Y	Y
	NOTE		Assumed. Test before disturbing or removing.			

RED=contains asbestos

BLACK=no asbestos detected or non-suspect



YES Environmental, Inc.

1201 24th Street, Suite B110-377, Bakersfield, CA 93301 / (661) 527-0820

Building:	Building B - Classrooms 12-16	Room Name:	Exterior
------------------	-------------------------------	-------------------	----------

Component	HMR #	Sample #	Material Description	Substrate	ACM Y/N	Friable Y/N
Ground	38		Asphalt		N	n/a
Ground	-		Concrete - bare & exposed		n/a	n/a
Walls & Soffit:	35		Exterior stucco, painted & vapor barrier		N	n/a

NOTE No other areas of stucco contain asbestos on this building. See the limited location of the asbestos-containing stucco below.

Exterior Soffit

PATCH ONLY	35	35B	Exterior stucco, painted & vapor barrier - 1% CH in texture coat	Y	Y
-------------------	----	-----	--	---	---

Windows	28	28C-D	Exterior window putty		N	n/a
Eaves	35		Exterior stucco, painted		N	n/a
Roof	36		White coated foam on silver paint on rolled composition roofing & Diagonal sheathing		Y	N
	NOTE		Foam=ND; Silver Paint=2-4% CH; Rolled Composition Roofing & Felts=ND			

RED=contains asbestos

BLACK=no asbestos detected or non-suspect



YES Environmental, Inc.

1201 24th Street, Suite B110-377, Bakersfield, CA 93301 / (661) 527-0820

Roof	37	White coated foam on silver paint on penetration mastic	Y	N
	NOTE	Foam=ND; Silver Paint=2-4% CH; Mastics=Assumed		
	NOTE	On components such as, but not limited to, roof jacks, roof vents, conduits, sleepers, patches, etc.		

RED=contains asbestos

BLACK=no asbestos detected or non-suspect



YES Environmental, Inc.

1201 24th Street, Suite B110-377, Bakersfield, CA 93301 / (661) 527-0820

Client: Bakersfield City School District

Site: Wayside ES

YES Project No.: 23YES-05

Date of Inspection: 6/27/2023

Inspection Report

Building:	Building C - Rooms K1-K2, 22-25	Room Name:	Attic
<p>Attic is defined as: every enclosed spaced that is contiguous and/or beneath the roof, attic, void, and plenum space above every room in this building including, but not limited to, exterior enclosed eaves, enclosed hallways, walkways, corridors, wall cavities, etc. and all spaces beneath the roof and above ceilings that are or are not readily accessible.</p>			
<p>Attic Floor is defined as: the surface within an attic space, serving as the ceiling for the room(s) below and/or an area with exposed joists. It is not a term that can be used to infer a walkable surface.</p>			

Component	HMR #	Sample #	Material Description	Substrate	ACM Y/N	Friable Y/N
Attic Floor	26		Roofing debris with silver paint		Y	Y
	NOTE		Silver Paint=3% CH; Other various roof material=ND material exists on and inbetween the floor joists of this space.	This		
Attic Floor	-		Fiberglass batt insulation		Y	Y
	NOTE		Contaminated with asbestos roofing debris			
Walls	-		Wood		n/a	n/a
Flue Pipes			Transite flue pipes - Known Asbestos Material			
Ceiling	-		Diagonal sheathing		n/a	n/a

RED=contains asbestos

BLACK=no asbestos detected or non-suspect



YES Environmental, Inc.

1201 24th Street, Suite B110-377, Bakersfield, CA 93301 / (661) 527-0820

Building:		Building C - Rooms K1-K2, 22-25		Room Name:	Classroom K1		Rm Ft ² :	960
		Room Dimensions:		L=40	W=24	H=9/12		
Component	HMR #	Sample #	Material Description	Substrate	ACM Y/N	Friable Y/N		
Floor	23	23A	Floor tile & glue 12" lt grey/cream mosaic	Concrete	N	n/a		
	NOTE		50% of floor					
Floor	1		Carpet & glue - grey/green/multi	Concrete	N	n/a		
	NOTE		50% of floor					
BB	3		Baseboard & glue 3" & 4" blue	wood	N	n/a		
BB	-		Wood baseboard		n/a	n/a		
Walls	4		Plaster - sanded finish		N	n/a		
Walls	5		Tackboards & glue	Plaster	N	n/a		
Sink	6		Sink coating - black (stainless steel)		N	n/a		
Ceiling	7		Lay-in panels - 2' x 4' gouge pinhole	ACM Roofing debris	N	n/a		
Ceiling	26		Roofing debris with silver paint	F/G insulation	Y	Y		
	NOTE		Silver Paint=3% CH; Other various roof material=ND					
Ceiling	-		Fiberglass insulation	ACM Roofing debris	n/a	n/a		
Ceiling	26		Roofing debris with silver paint	12" ACT	Y	Y		
	NOTE		Silver Paint=3% CH; Other various roof material=ND					
Ceiling	8		Acoustic ceiling tiles 12" uniform hole pattern (nailed)	wood slat	N	n/a		
Ceiling	-		Wood slats	ACM Roofing debris	n/a	n/a		
Ceiling	26		Roofing debris with silver paint	Wool batt insulation	Y	Y		
	NOTE		Silver Paint=3% CH; Other various roof material=ND					
Ceiling	24		Wool-batt insulation glued (black) to paper backing	diagonal sheathing	N	n/a		

RED=contains asbestos

BLACK=no asbestos detected or non-suspect



YES Environmental, Inc.

1201 24th Street, Suite B110-377, Bakersfield, CA 93301 / (661) 527-0820

Building: Building C - Rooms K1-K2, 22-25 Located inside K1 - SE corner	Room Name: K1 SE Storage RM	Rm Ft²: 36
	Room Dimensions: L=6 W=6 H=8	

Component	HMR #	Sample #	Material Description	Substrate	ACM Y/N	Friable Y/N
Floor	23		Floor tile & glue 12" lt grey/cream mosaic	Concrete	N	n/a
BB	3		Baseboard & glue 3" & 4" blue	wood	N	n/a
BB	-		Wood baseboard		n/a	n/a
Walls	4		Plaster - sanded finish		N	n/a
Ceiling	8		Acoustic ceiling tiles 12" uniform hole pattern (nailed)	Wood slat	N	n/a
Ceiling	-		Wood slats	ACM Roofing debris	n/a	n/a
Ceiling	26		Roofing debris with silver paint	Wool batt insulation	Y	Y
	NOTE		Silver Paint=3% CH; Other various roof material=ND			
Ceiling	24		Wool-batt insulation glued (black) to paper backing	diagonal sheathing	N	n/a

RED=contains asbestos

BLACK=no asbestos detected or non-suspect



YES Environmental, Inc.

1201 24th Street, Suite B110-377, Bakersfield, CA 93301 / (661) 527-0820

Building:		Building C - Rooms K1-K2, 22-25		Room Name:	K1B		Rm Ft ² :	680	
		Room Dimensions:		L=34	W=20	H=9/12			
Component	HMR #	Sample #	Material Description	Substrate	ACM Y/N	Friable Y/N			
Floor	23		Floor tile & glue 12" lt grey/cream mosaic	Concrete	N	n/a			
	NOTE		50% of floor						
Floor	1		Carpet & glue - grey/green/multi	Concrete	N	n/a			
	NOTE		50% of floor						
BB	3		Baseboard & glue 3" & 4" blue	wood	N	n/a			
BB	-		Wood baseboard		n/a	n/a			
Walls	4		Plaster - sanded finish		N	n/a			
Walls	5		Tackboards & glue	Plaster	N	n/a			
Sink	6		Sink coating - black (stainless steel)		N	n/a			
Ceiling	7		Lay-in panels - 2' x 4' gouge pinhole	ACM Roofing debris	N	n/a			
Ceiling	26		Roofing debris with silver paint	F/G insulation	Y	Y			
	NOTE		Silver Paint=3% CH; Other various roof material=ND						
Ceiling	-		Fiberglass insulation	ACM Roofing debris	n/a	n/a			
Ceiling	26		Roofing debris with silver paint	12" ACT	Y	Y			
	NOTE		Silver Paint=3% CH; Other various roof material=ND						
Ceiling	8		Acoustic ceiling tiles 12" uniform hole pattern (nailed)		N	n/a			
Ceiling	-		Wood slats	ACM Roofing debris	n/a	n/a			
Ceiling	26		Roofing debris with silver paint	Wool batt insulation	Y	Y			
	NOTE		Silver Paint=3% CH; Other various roof material=ND						
Ceiling	24		Wool-batt insulation glued (black) to paper backing	diagonal sheathing	N	n/a			

RED=contains asbestos

BLACK=no asbestos detected or non-suspect



YES Environmental, Inc.

1201 24th Street, Suite B110-377, Bakersfield, CA 93301 / (661) 527-0820

Building:	Building C - Rooms K1-K2, 22-25	Room Name:	K1B SW Storage Rm	Rm Ft²:	72
		Room Dimensions:	L=12 W=6 H=8		

Component	HMR #	Sample #	Material Description	Substrate	ACM Y/N	Friable Y/N
Floor	23		Floor tile & glue 12" lt grey/cream mosaic	Concrete	N	n/a
BB	3		Baseboard & glue 3" & 4" blue	wood	N	n/a
BB	-		Wood baseboard		n/a	n/a
Walls	4		Plaster - sanded finish		N	n/a
Ceiling	8		Acoustic ceiling tiles 12" uniform hole pattern (nailed)	Wood slat	N	n/a
Ceiling	-		Wood slats	ACM Roofing debris	n/a	n/a
Ceiling	26		Roofing debris with silver paint	Wool batt insulation	Y	Y
	NOTE		Silver Paint=3% CH; Other various roof material=ND			
Ceiling	24		Wool-batt insulation glued (black) to paper backing	ACM Roofing debris	N	n/a
Ceiling	26		Roofing debris with silver paint	Diagonal Sheathing	Y	Y
	NOTE		Silver Paint=3% CH; Other various roof material=ND			

Building:	Building C - Rooms K1-K2, 22-25	Room Name:	K1B Child RR	Rm Ft²:	80
		Room Dimensions:	L=10 W=8 H=8		

Component	HMR #	Sample #	Material Description	Substrate	ACM Y/N	Friable Y/N
Floor	9		Ceramic floor tile grout (2" grey)		N	n/a
BB			None			
Walls	10		Ceramic wall tile grout - blue (4" white)	Plaster	N	n/a
	NOTE		AFF 6'			
Walls	4		Plaster - sanded finish		N	n/a
Ceiling	4		Plaster - sanded finish	ACM Roofing debris	N	n/a
Ceiling	26		Roofing debris with silver paint		Y	Y
	NOTE		Silver Paint=3% CH; Other various roof material=ND			

RED=contains asbestos

BLACK=no asbestos detected or non-suspect



YES Environmental, Inc.

1201 24th Street, Suite B110-377, Bakersfield, CA 93301 / (661) 527-0820

Building:		Building C - Rooms K1-K2, 22-25		Room Name:	K2B		Rm Ft ² :	680
		Room Dimensions:		L=34	W=20	H=9/12		
Component	HMR #	Sample #	Material Description	Substrate	ACM Y/N	Friable Y/N		
Floor	23		Floor tile & glue 12" lt grey/cream mosaic	Concrete	N	n/a		
	NOTE		50% of floor					
Floor	1		Carpet & glue - grey/green/multi	Concrete	N	n/a		
	NOTE		50% of floor					
BB	3		Baseboard & glue 3" & 4" blue	wood	N	n/a		
BB	-		Wood baseboard		n/a	n/a		
Walls	4		Plaster - sanded finish		N	n/a		
Walls	5		Tackboards & glue	Plaster	N	n/a		
Sink	6		Sink coating - black (stainless steel)		N	n/a		
Ceiling	7		Lay-in panels - 2' x 4' gouge pinhole	ACM Roofing debris	N	n/a		
Ceiling	26		Roofing debris with silver paint	F/G insulation	Y	Y		
	NOTE		Silver Paint=3% CH; Other various roof material=ND					
Ceiling	-		Fiberglass insulation	ACM Roofing debris	n/a	n/a		
Ceiling	26		Roofing debris with silver paint	12" ACT	Y	Y		
	NOTE		Silver Paint=3% CH; Other various roof material=ND					
Ceiling	8		Acoustic ceiling tiles 12" uniform hole pattern (nailed)	Wood slat	N	n/a		
Ceiling	-		Wood slats	ACM Roofing debris	n/a	n/a		
Ceiling	26		Roofing debris with silver paint	Wool batt insulation	Y	Y		
	NOTE		Silver Paint=3% CH; Other various roof material=ND					
Ceiling	24		Wool-batt insulation glued (black) to paper backing	diagonal sheathing	N	n/a		

RED=contains asbestos

BLACK=no asbestos detected or non-suspect



YES Environmental, Inc.

1201 24th Street, Suite B110-377, Bakersfield, CA 93301 / (661) 527-0820

Building:	Building C - Rooms K1-K2, 22-25	Room Name:	K2B SE Storage Rm	Rm Ft²:	72
		Room Dimensions:	L=12 W=6 H=8		

Component	HMR #	Sample #	Material Description	Substrate	ACM Y/N	Friable Y/N
Floor	23		Floor tile & glue 12" lt grey/cream mosaic	Concrete	N	n/a
BB	3		Baseboard & glue 3" & 4" blue	wood	N	n/a
BB	-		Wood baseboard		n/a	n/a
Walls	4		Plaster - sanded finish		N	n/a
Ceiling	8		Acoustic ceiling tiles 12" uniform hole pattern (nailed)	Wood slat	N	n/a
Ceiling	-		Wood slats	ACM Roofing debris	n/a	n/a
Ceiling	26		Roofing debris with silver paint	Wool batt insulation	Y	Y
	NOTE		Silver Paint=3% CH; Other various roof material=ND			
Ceiling	24		Wool-batt insulation glued (black) to paper backing	ACM Roofing debris	N	n/a
Ceiling	26		Roofing debris with silver paint	diagonal sheathing	Y	Y
	NOTE		Silver Paint=3% CH; Other various roof material=ND			

Building:	Building C - Rooms K1-K2, 22-25	Room Name:	K2B Child RR	Rm Ft²:	80
		Room Dimensions:	L=10 W=8 H=8		

Component	HMR #	Sample #	Material Description	Substrate	ACM Y/N	Friable Y/N
Floor	9		Ceramic floor tile grout (2" grey)		N	n/a
BB			None			
Walls	10		Ceramic wall tile grout - blue (4" white)	Plaster	N	n/a
	NOTE		AFF 6'			
Walls	4		Plaster - sanded finish		N	n/a
Ceiling	4		Plaster - sanded finish	ACM Roofing debris	N	n/a
Ceiling	26		Roofing debris with silver paint		Y	Y
	NOTE		Silver Paint=3% CH; Other various roof material=ND			

RED=contains asbestos

BLACK=no asbestos detected or non-suspect



YES Environmental, Inc.

1201 24th Street, Suite B110-377, Bakersfield, CA 93301 / (661) 527-0820

Building:	Building C - Rooms K1-K2, 22-25	Room Name:	Classroom K2	Rm Ft²:	960
		Room Dimensions:	L=40 W=24 H=9/12		

Component	HMR #	Sample #	Material Description	Substrate	ACM Y/N	Friable Y/N
Floor	23		Floor tile & glue 12" lt grey/cream mosaic	Concrete	N	n/a
	NOTE		50% of floor			
Floor	1		Carpet & glue - grey/green/multi	Concrete	N	n/a
	NOTE		50% of floor			
BB	3	03E	Baseboard & glue 3" & 4" blue	wood	N	n/a
BB	-		Wood baseboard		n/a	n/a
Walls	4		Plaster - sanded finish		N	n/a
Walls	5		Tackboards & glue	Plaster	N	n/a
Sink	6		Sink coating - black (stainless steel)		N	n/a
Ceiling	7		Lay-in panels - 2' x 4' gouge pinhole	ACM Roofing debris	N	n/a
Ceiling	26		Roofing debris with silver paint	F/G insulation	Y	Y
	NOTE		Silver Paint=3% CH; Other various roof material=ND			
Ceiling	-		Fiberglass insulation	ACM Roofing debris	n/a	n/a
Ceiling	26		Roofing debris with silver paint	12" ACT	Y	Y
	NOTE		Silver Paint=3% CH; Other various roof material=ND			
Ceiling	8		Acoustic ceiling tiles 12" uniform hole pattern (nailed)	wood slat		
Ceiling	-		Wood slats	ACM Roofing debris	n/a	n/a
Ceiling	26		Roofing debris with silver paint	Wool batt insulation	Y	Y
	NOTE		Silver Paint=3% CH; Other various roof material=ND			
Ceiling	24		Wool-batt insulation glued (black) to paper backing	diagonal sheathing	N	n/a

RED=contains asbestos

BLACK=no asbestos detected or non-suspect



YES Environmental, Inc.

1201 24th Street, Suite B110-377, Bakersfield, CA 93301 / (661) 527-0820

Building:	Building C - Rooms K1-K2, 22-25	Room Name:	K2 SW Storage RM	Rm Ft²:	36
		Room Dimensions:	L=6 W=6 H=8		

Component	HMR #	Sample #	Material Description	Substrate	ACM Y/N	Friable Y/N
Floor	23		Floor tile & glue 12" lt grey/cream mosaic	Concrete	N	n/a
BB	3		Baseboard & glue 3" & 4" blue	wood	N	n/a
BB	-		Wood baseboard		n/a	n/a
Walls	4		Plaster - sanded finish		N	n/a
Ceiling	8		Acoustic ceiling tiles 12" uniform hole pattern (nailed)	Wood slats	N	n/a
Ceiling	-		Wood slats	ACM Roofing debris	n/a	n/a
Ceiling	26		Roofing debris with silver paint	Wool batt insulation	Y	Y
	NOTE		Silver Paint=3% CH; Other various roof material=ND			
Ceiling	24		Wool-batt insulation glued (black) to paper backing	diagonal sheathing	N	n/a

RED=contains asbestos

BLACK=no asbestos detected or non-suspect



YES Environmental, Inc.

1201 24th Street, Suite B110-377, Bakersfield, CA 93301 / (661) 527-0820

Building:	Building C - Rooms K1-K2, 22-25	Room Name:	Classroom 22	Rm Ft²:	960
		Room Dimensions:	L=32 W=30 H=9/12		

Component	HMR #	Sample #	Material Description	Substrate	ACM Y/N	Friable Y/N
Floor	1		Carpet & glue - grey/green/multi	Concrete	N	n/a
Floor	2		Carpet & glue - black/white speckled	Concrete	N	n/a
BB	22		Baseboard & glue 3" & 4" tan	wood	N	n/a
BB	-		Wood baseboard		n/a	n/a
Walls	4	04K	Plaster - sanded finish		N	n/a
Walls	5		Tackboards & glue	Plaster	N	n/a
Sink	6		Sink coating - black (stainless steel)		N	n/a
Ceiling	7		Lay-in panels - 2' x 4' gouge pinhole	ACM Roofing debris	N	n/a
Ceiling	26		Roofing debris with silver paint	F/G insulation	Y	Y
	NOTE		Silver Paint=3% CH; Other various roof material=ND	c2		
Ceiling	-		Fiberglass insulation	ACM Roofing debris	n/a	n/a
Ceiling	26		Roofing debris with silver paint	12" ACT	Y	Y
	NOTE		Silver Paint=3% CH; Other various roof material=ND			
Ceiling	8		Acoustic ceiling tiles 12" uniform hole pattern (nailed)	wood slats	N	n/a
Ceiling	-		Wood slats	ACM Roofing debris	n/a	n/a
Ceiling	26		Roofing debris with silver paint	Wool batt insulation	Y	Y
	NOTE		Silver Paint=3% CH; Other various roof material=ND			
Ceiling	24		Wool-batt insulation glued (black) to paper backing	Diagonal sheathing	N	n/a

RED=contains asbestos

BLACK=no asbestos detected or non-suspect



YES Environmental, Inc.

1201 24th Street, Suite B110-377, Bakersfield, CA 93301 / (661) 527-0820

Building:	Building C - Rooms K1-K2, 22-25	Room Name:	Classroom 23	Rm Ft²:	960
		Room Dimensions:	L=32 W=30 H=9/12		

Component	HMR #	Sample #	Material Description	Substrate	ACM Y/N	Friable Y/N
Floor	1		Carpet & glue - grey/green/multi	Concrete	N	n/a
Floor	2	02E	Carpet & glue - black/white speckled	Concrete	N	n/a
BB	22	22B	Baseboard & glue 3" & 4" tan	wood	N	n/a
BB	-		Wood baseboard		n/a	n/a
Walls	4		Plaster - sanded finish		N	n/a
Walls	5		Tackboards & glue	Plaster	N	n/a
Sink	6	06E	Sink coating - black (stainless steel)		N	n/a
Ceiling	7		Lay-in panels - 2' x 4' gouge pinhole	ACM Roofing debris	N	n/a
Ceiling	26		Roofing debris with silver paint	F/G insulation	Y	Y
	NOTE		Silver Paint=3% CH; Other various roof material=ND			
Ceiling	-		Fiberglass insulation	ACM Roofing debris	n/a	n/a
Ceiling	26		Roofing debris with silver paint	12" ACT	Y	Y
	NOTE		Silver Paint=3% CH; Other various roof material=ND			
Ceiling	8		Acoustic ceiling tiles 12" uniform hole pattern (nailed)	wood slat	N	n/a
Ceiling	-		Wood slats	ACM Roofing debris	n/a	n/a
Ceiling	26		Roofing debris with silver paint	Wool batt insulation	Y	Y
	NOTE		Silver Paint=3% CH; Other various roof material=ND			
Ceiling	24		Wool-batt insulation glued (black) to paper backing	diagonal sheathing	N	n/a

RED=contains asbestos

BLACK=no asbestos detected or non-suspect



YES Environmental, Inc.

1201 24th Street, Suite B110-377, Bakersfield, CA 93301 / (661) 527-0820

Building:	Building C - Rooms K1-K2, 22-25	Room Name:	Classroom 24	Rm Ft²:	960
		Room Dimensions:	L=32 W=30 H=9/12		

Component	HMR #	Sample #	Material Description	Substrate	ACM Y/N	Friable Y/N
Floor	1	01E	Carpet & glue - grey/green/multi	Concrete	N	n/a
Floor	2		Carpet & glue - black/white speckled	Concrete	N	n/a
BB	22		Baseboard & glue 3" & 4" tan	wood	N	n/a
BB	-		Wood baseboard		n/a	n/a
Walls	4		Plaster - sanded finish		N	n/a
Walls	5		Tackboards & glue	Plaster	N	n/a
Sink	6		Sink coating - black (stainless steel)		N	n/a
Ceiling	7		Lay-in panels - 2' x 4' gouge pinhole	ACM Roofing debris	N	n/a
Ceiling	26		Roofing debris with silver paint	F/G insulation	Y	Y
	NOTE		Silver Paint=3% CH; Other various roof material=ND			
Ceiling	-		Fiberglass insulation	ACM Roofing debris	n/a	n/a
Ceiling	26		Roofing debris with silver paint	12" ACT	Y	Y
	NOTE		Silver Paint=3% CH; Other various roof material=ND			
Ceiling	8		Acoustic ceiling tiles 12" uniform hole pattern (nailed)	wood slat	N	n/a
Ceiling	-		Wood slats	ACM Roofing debris	n/a	n/a
Ceiling	26		Roofing debris with silver paint	Wool batt insulation	Y	Y
	NOTE		Silver Paint=3% CH; Other various roof material=ND			
Ceiling	24		Wool-batt insulation glued (black) to paper backing	diagonal sheathing	N	n/a

RED=contains asbestos

BLACK=no asbestos detected or non-suspect



YES Environmental, Inc.

1201 24th Street, Suite B110-377, Bakersfield, CA 93301 / (661) 527-0820

Building:	Building C - Rooms K1-K2, 22-25	Room Name:	Classroom 25	Rm Ft²:	960
		Room Dimensions:	L=32 W=30 H=9/12		

Component	HMR #	Sample #	Material Description	Substrate	ACM Y/N	Friable Y/N
Floor	1		Carpet & glue - grey/green/multi	Concrete	N	n/a
Floor	2		Carpet & glue - black/white speckled	Concrete	N	n/a
BB	22		Baseboard & glue 3" & 4" tan	wood	N	n/a
BB	-		Wood baseboard		n/a	n/a
Walls	4		Plaster - sanded finish		N	n/a
Walls	5		Tackboards & glue	Plaster	N	n/a
Sink	6		Sink coating - black (stainless steel)		N	n/a
Ceiling	7		Lay-in panels - 2' x 4' gouge pinhole	ACM Roofing debris	N	n/a
Ceiling	26		Roofing debris with silver paint	F/G insulation	Y	Y
	NOTE		Silver Paint=3% CH; Other various roof material=ND			
Ceiling	-		Fiberglass insulation	ACM Roofing debris	n/a	n/a
Ceiling	26		Roofing debris with silver paint	12" ACT	Y	Y
	NOTE		Silver Paint=3% CH; Other various roof material=ND			
Ceiling	8		Acoustic ceiling tiles 12" uniform hole pattern (nailed)	wood slat	N	n/a
Ceiling	-		Wood slats	ACM Roofing debris	n/a	n/a
Ceiling	26		Roofing debris with silver paint	Wool batt insulation	Y	Y
	NOTE		Silver Paint=3% CH; Other various roof material=ND			
Ceiling	24		Wool-batt insulation glued (black) to paper backing	diagonal sheathing	N	n/a

RED=contains asbestos

BLACK=no asbestos detected or non-suspect



YES Environmental, Inc.

1201 24th Street, Suite B110-377, Bakersfield, CA 93301 / (661) 527-0820

Building:	Building C - Rooms K1-K2, 22-25	Room Name:	Exterior
------------------	---------------------------------	-------------------	----------

Component	HMR #	Sample #	Material Description	Substrate	ACM Y/N	Friable Y/N
Ground	38		Asphalt		N	n/a
Ground	-		Concrete - bare & exposed		n/a	n/a
Walls	35		Exterior stucco, painted & vapor barrier		N	n/a
Windows	28	28E-F	Exterior window putty		N	n/a
Eaves	35		Exterior stucco, painted		N	n/a
Roof	36	36D	White coated foam on silver paint on rolled composition roofing & Diagonal sheathing		Y	N
	NOTE		Foam=ND; Silver Paint=2-4% CH; Rolled Composition Roofing & Felts=ND			
Roof	37		White coated foam on silver paint on penetration mastic		Y	N
	NOTE		Foam=ND; Silver Paint=2-4% CH; Mastics=Assumed			
	NOTE		On components such as, but not limited to, roof jacks, roof vents, conduits, sleepers, patches, etc.			

RED=contains asbestos

BLACK=no asbestos detected or non-suspect



YES Environmental, Inc.

1201 24th Street, Suite B110-377, Bakersfield, CA 93301 / (661) 527-0820

Client: Bakersfield City School District

Site: Wayside ES

YES Project No.: 23YES-05

Date of Inspection: 6/27/2023

Inspection Report

Building: Building D - Classrooms 6-11 **Room Name:** Attic

Attic is defined as: every enclosed spaced that is contiguous and/or beneath the roof, attic, void, and plenum space above every room in this building including, but not limited to, exterior enclosed eaves, enclosed hallways, walkways, corridors, wall cavities, etc. and all spaces beneath the roof and above ceilings that are or are not readily accessible.

Attic Floor is defined as: the surface within an attic space, serving as the ceiling for the room(s) below and/or an area with exposed joists. It is not a term that can be used to infer a walkable surface.

Component	HMR #	Sample #	Material Description	Substrate	ACM Y/N	Friable Y/N
Attic Floor	26		Roofing debris with silver paint		Y	Y
	NOTE		Silver Paint=3% CH; Other various roof material=ND material exists on and inbetween the floor joists of this space.	This		
Attic Floor	-		Fiberglass batt insulation		Y	Y
	NOTE		Contaminated with asbestos roofing debris			
Walls	-		Wood		n/a	n/a
Flue Pipes			Transite flue pipes - Known Asbestos Material (typically 10-20% Chrysotile)		Y	N
Ceiling	-		Diagonal sheathing		n/a	n/a

RED=contains asbestos

BLACK=no asbestos detected or non-suspect



YES Environmental, Inc.

1201 24th Street, Suite B110-377, Bakersfield, CA 93301 / (661) 527-0820

Building:	Building D - Classrooms 6-11	Room Name:	Classroom 6	Rm Ft²:	960
		Room Dimensions:	L=32 W=30 H=9/12		

Component	HMR #	Sample #	Material Description	Substrate	ACM Y/N	Friable Y/N
Floor	1		Carpet & glue - grey/green/multi	Concrete	N	n/a
Floor	2	02B	Carpet & glue - black/white speckled	Concrete	N	n/a
BB	3	03D	Baseboard & glue 3" & 4" blue	wood	N	n/a
BB	-		Wood baseboard		n/a	n/a
Walls	4		Plaster - sanded finish		N	n/a
Walls	5		Tackboards & glue	Plaster	N	n/a
Sink	6	06C	Sink coating - black (stainless steel)		N	n/a
Ceiling	7		Lay-in panels - 2' x 4' gouge pinhole	ACM Roofing debris	N	n/a
Ceiling	26		Roofing debris with silver paint	F/G insulation	Y	Y
	NOTE		Silver Paint=3% CH; Other various roof material=ND			
Ceiling	-		Fiberglass insulation	ACM Roofing debris	n/a	n/a
Ceiling	26		Roofing debris with silver paint	12" ACT	Y	Y
	NOTE		Silver Paint=3% CH; Other various roof material=ND			
Ceiling	8	08B	Acoustic ceiling tiles 12" uniform hole pattern (nailed)	wood slat	N	n/a
Ceiling	-		Wood slats	ACM Roofing debris	n/a	n/a
Ceiling	26		Roofing debris with silver paint	Wool batt insulation	Y	Y
	NOTE		Silver Paint=3% CH; Other various roof material=ND			
Ceiling	24	24A	Wool-batt insulation glued (black) to paper backing	diagonal sheathing	N	n/a

RED=contains asbestos

BLACK=no asbestos detected or non-suspect



YES Environmental, Inc.

1201 24th Street, Suite B110-377, Bakersfield, CA 93301 / (661) 527-0820

Building:	Building D - Classrooms 6-11	Room Name:	Classroom 7	Rm Ft²:	960
		Room Dimensions:	L=32 W=30 H=9/12		

Component	HMR #	Sample #	Material Description	Substrate	ACM Y/N	Friable Y/N
Floor	1	01A	Carpet & glue - grey/green/multi	Concrete	N	n/a
Floor	2		Carpet & glue - black/white speckled	Concrete	N	n/a
BB	3		Baseboard & glue 3" & 4" blue	wood	N	n/a
BB	-		Wood baseboard		n/a	n/a
Walls	4	04G	Plaster - sanded finish		N	n/a
Walls	5		Tackboards & glue	Plaster	N	n/a
Sink	6		Sink coating - black (stainless steel)		N	n/a
Ceiling	7	07B	Lay-in panels - 2' x 4' gouge pinhole	ACM Roofing debris	N	n/a
Ceiling	26		Roofing debris with silver paint	F/G insulation	Y	Y
	NOTE		Silver Paint=3% CH; Other various roof material=ND			
Ceiling	-		Fiberglass insulation	ACM Roofing debris	n/a	n/a
Ceiling	26		Roofing debris with silver paint	12" ACT	Y	Y
	NOTE		Silver Paint=3% CH; Other various roof material=ND			
Ceiling	8		Acoustic ceiling tiles 12" uniform hole pattern (nailed)	wood slat	N	n/a
Ceiling	-		Wood slats	ACM Roofing debris	n/a	n/a
Ceiling	26		Roofing debris with silver paint	Wool batt insulation	Y	Y
	NOTE		Silver Paint=3% CH; Other various roof material=ND			
Ceiling	24		Wool-batt insulation glued (black) to paper backing	diagonal sheathing	N	n/a

RED=contains asbestos

BLACK=no asbestos detected or non-suspect



YES Environmental, Inc.

1201 24th Street, Suite B110-377, Bakersfield, CA 93301 / (661) 527-0820

Building:	Building D - Classrooms 6-11	Room Name:	Classroom 8	Rm Ft²:	960
		Room Dimensions:	L=32 W=30 H=9/12		

Component	HMR #	Sample #	Material Description	Substrate	ACM Y/N	Friable Y/N
Floor	1		Carpet & glue - grey/green/multi	Concrete	N	n/a
Floor	2		Carpet & glue - black/white speckled	Concrete	N	n/a
BB	3		Baseboard & glue 3" & 4" blue	wood	N	n/a
BB	-		Wood baseboard		n/a	n/a
Walls	4	04H	Plaster - sanded finish		N	n/a
Walls	5		Tackboards & glue	Plaster	N	n/a
Sink	6		Sink coating - black (stainless steel)		N	n/a
Ceiling	7		Lay-in panels - 2' x 4' gouge pinhole	ACM Roofing debris	N	n/a
Ceiling	26		Roofing debris with silver paint	F/G insulation	Y	Y
	NOTE		Silver Paint=3% CH; Other various roof material=ND			
Ceiling	-		Fiberglass insulation	ACM Roofing debris	n/a	n/a
Ceiling	26		Roofing debris with silver paint	12" ACT	Y	Y
	NOTE		Silver Paint=3% CH; Other various roof material=ND			
Ceiling	8		Acoustic ceiling tiles 12" uniform hole pattern (nailed)	wood slat	N	n/a
Ceiling	-		Wood slats	ACM Roofing debris	n/a	n/a
Ceiling	26		Roofing debris with silver paint	Wool batt insulation	Y	Y
	NOTE		Silver Paint=3% CH; Other various roof material=ND			
Ceiling	24		Wool-batt insulation glued (black) to paper backing	diagonal sheathing	N	n/a

RED=contains asbestos

BLACK=no asbestos detected or non-suspect



YES Environmental, Inc.

1201 24th Street, Suite B110-377, Bakersfield, CA 93301 / (661) 527-0820

Building:	Building D - Classrooms 6-11	Room Name:	Classroom 9	Rm Ft²:	960
		Room Dimensions:	L=32 W=30 H=9/12		

Component	HMR #	Sample #	Material Description	Substrate	ACM Y/N	Friable Y/N
Floor	1		Carpet & glue - grey/green/multi	Concrete	N	n/a
Floor	2		Carpet & glue - black/white speckled	Concrete	N	n/a
BB	3		Baseboard & glue 3" & 4" blue	wood	N	n/a
BB	-		Wood baseboard		n/a	n/a
Walls	4		Plaster - sanded finish		N	n/a
Walls	5	05D	Tackboards & glue	Plaster	N	n/a
Sink	6		Sink coating - black (stainless steel)		N	n/a
Ceiling	7		Lay-in panels - 2' x 4' gouge pinhole	ACM Roofing debris	N	n/a
Ceiling	26		Roofing debris with silver paint	F/G insulation	Y	Y
	NOTE		Silver Paint=3% CH; Other various roof material=ND			
Ceiling	-		Fiberglass insulation	ACM Roofing debris	n/a	n/a
Ceiling	26		Roofing debris with silver paint	12" ACT	Y	Y
	NOTE		Silver Paint=3% CH; Other various roof material=ND			
Ceiling	8	08C	Acoustic ceiling tiles 12" uniform hole pattern (nailed)	wood slat	N	n/a
Ceiling	-		Wood slats	ACM Roofing debris	n/a	n/a
Ceiling	26		Roofing debris with silver paint	Wool batt insulation	Y	Y
	NOTE		Silver Paint=3% CH; Other various roof material=ND			
Ceiling	24		Wool-batt insulation glued (black) to paper backing	diagonal sheathing	N	n/a

RED=contains asbestos

BLACK=no asbestos detected or non-suspect



YES Environmental, Inc.

1201 24th Street, Suite B110-377, Bakersfield, CA 93301 / (661) 527-0820

Building:	Building D - Classrooms 6-11	Room Name:	Classroom 10	Rm Ft²:	960
		Room Dimensions:	L=32 W=30 H=9/12		

Component	HMR #	Sample #	Material Description	Substrate	ACM Y/N	Friable Y/N
Floor	1		Carpet & glue - grey/green/multi	Concrete	N	n/a
Floor	2		Carpet & glue - black/white speckled	Concrete	N	n/a
BB	3	03A	Baseboard & glue 3" & 4" blue	wood	N	n/a
BB	-		Wood baseboard		n/a	n/a
Walls	4		Plaster - sanded finish		N	n/a
Walls	5		Tackboards & glue	Plaster	N	n/a
Sink	6		Sink coating - black (stainless steel)		N	n/a
Ceiling	7	07D	Lay-in panels - 2' x 4' gouge pinhole	ACM Roofing debris	N	n/a
Ceiling	26		Roofing debris with silver paint	F/G insulation	Y	Y
	NOTE		Silver Paint=3% CH; Other various roof material=ND			
Ceiling	-		Fiberglass insulation	ACM Roofing debris	n/a	n/a
Ceiling	26	26A	Roofing debris with silver paint	12" ACT	Y	Y
	NOTE		Silver Paint=3% CH; Other various roof material=ND			
Ceiling	8		Acoustic ceiling tiles 12" uniform hole pattern (nailed)	wood slat	N	n/a
Ceiling	-		Wood slats	ACM Roofing debris	n/a	n/a
Ceiling	26		Roofing debris with silver paint	Wool batt insulation	Y	Y
	NOTE		Silver Paint=3% CH; Other various roof material=ND			
Ceiling	24	24B	Wool-batt insulation glued (black) to paper backing	diagonal sheathing	N	n/a

RED=contains asbestos

BLACK=no asbestos detected or non-suspect



YES Environmental, Inc.

1201 24th Street, Suite B110-377, Bakersfield, CA 93301 / (661) 527-0820

Building:	Building D - Classrooms 6-11	Room Name:	Classroom 11	Rm Ft²:	960
		Room Dimensions:	L=32 W=30 H=9/12		

Component	HMR #	Sample #	Material Description	Substrate	ACM Y/N	Friable Y/N
Floor	1		Carpet & glue - grey/green/multi	Concrete	N	n/a
Floor	2		Carpet & glue - black/white speckled	Concrete	N	n/a
BB	3		Baseboard & glue 3" & 4" blue	wood	N	n/a
BB	-		Wood baseboard		n/a	n/a
Walls	4	04E	Plaster - sanded finish		N	n/a
Walls	5		Tackboards & glue	Plaster	N	n/a
Sink	6		Sink coating - black (stainless steel)		N	n/a
Ceiling	7		Lay-in panels - 2' x 4' gouge pinhole	ACM Roofing debris	N	n/a
Ceiling	26		Roofing debris with silver paint	F/G insulation	Y	Y
	NOTE		Silver Paint=3% CH; Other various roof material=ND			
Ceiling	-		Fiberglass insulation	ACM Roofing debris	n/a	n/a
Ceiling	26		Roofing debris with silver paint	12" ACT	Y	Y
	NOTE		Silver Paint=3% CH; Other various roof material=ND			
Ceiling	8		Acoustic ceiling tiles 12" uniform hole pattern (nailed)	wood slat	N	n/a
Ceiling	-		Wood slats	ACM Roofing debris	n/a	n/a
Ceiling	26		Roofing debris with silver paint	Wool batt insulation	Y	Y
	NOTE		Silver Paint=3% CH; Other various roof material=ND			
Ceiling	24		Wool-batt insulation glued (black) to paper backing	diagonal sheathing	N	n/a

RED=contains asbestos

BLACK=no asbestos detected or non-suspect



YES Environmental, Inc.

1201 24th Street, Suite B110-377, Bakersfield, CA 93301 / (661) 527-0820

Building:	Building D - Classrooms 6-11	Room Name:	Exterior
------------------	------------------------------	-------------------	----------

Component	HMR #	Sample #	Material Description	Substrate	ACM Y/N	Friable Y/N
Ground	38		Asphalt		N	n/a
Ground	-		Concrete - bare & exposed		n/a	n/a
Walls	35		Exterior stucco, painted & vapor barrier		N	n/a
Windows	28	28G-H	Exterior window putty		N	n/a
Eaves	35	35C	Exterior stucco, painted		N	n/a
Roof	36		White coated foam on silver paint on rolled composition roofing & Diagonal sheathing		Y	N
	NOTE		Foam=ND; Silver Paint=2-4% CH; Rolled Composition Roofing & Felts=ND			
Roof	37		White coated foam on silver paint on penetration mastic		Y	N
	NOTE		Foam=ND; Silver Paint=2-4% CH; Mastics=Assumed			
	NOTE		On components such as, but not limited to, roof jacks, roof vents, conduits, sleepers, patches, etc.			

RED=contains asbestos

BLACK=no asbestos detected or non-suspect



YES Environmental, Inc.

1201 24th Street, Suite B110-377, Bakersfield, CA 93301 / (661) 527-0820

Client: Bakersfield City School District

Site: Wayside ES

YES Project No.: 23YES-05

Date of Inspection: 6/27/2023

Inspection Report

Building:	Building E - Classrooms 17-21	Room Name:	Attic
<p>Attic is defined as: every enclosed spaced that is contiguous and/or beneath the roof, attic, void, and plenum space above every room in this building including, but not limited to, exterior enclosed eaves, enclosed hallways, walkways, corridors, wall cavities, etc. and all spaces beneath the roof and above ceilings that are or are not readily accessible.</p>			
<p>Attic Floor is defined as: the surface within an attic space, serving as the ceiling for the room(s) below and/or an area with exposed joists. It is not a term that can be used to infer a walkable surface.</p>			

Component	HMR #	Sample #	Material Description	Substrate	ACM Y/N	Friable Y/N
Attic Floor	26		Roofing debris with silver paint		Y	Y
	NOTE		Silver Paint=3% CH; Other various roof material=ND material exists on and inbetween the floor joists of this space.	This		
Attic Floor	-		Fiberglass batt insulation		Y	Y
	NOTE		Contaminated with asbestos roofing debris			
Walls	-		Wood		n/a	n/a
Flue Pipes			Transite flue pipes - Known Asbestos Material (typically 10-20% Chrysotile)		Y	N
Ceiling	-		Diagonal sheathing		n/a	n/a

RED=contains asbestos

BLACK=no asbestos detected or non-suspect



YES Environmental, Inc.

1201 24th Street, Suite B110-377, Bakersfield, CA 93301 / (661) 527-0820

Building: Building E - Classrooms 17-21 West of Room 17	Room Name: Boys' Restroom	Rm Ft²: 286
	Room Dimensions: L=22 W=13 H=9	

Component	HMR #	Sample #	Material Description	Substrate	ACM Y/N	Friable Y/N
Floor	9	09A	Ceramic floor tile grout (2" grey)		N	n/a
BB			None			
Walls	10 NOTE	10A	Ceramic wall tile grout - blue (4" white) AFF 6'	Plaster	N	n/a
Walls	4		Plaster - sanded finish		N	n/a
Ceiling	4		Plaster - sanded finish	ACM Roofing debris	N	n/a
Ceiling	26 NOTE		Roofing debris with silver paint Silver Paint=3% CH; Other various roof material=ND		Y	Y

Building: Building E - Classrooms 17-21 West of Room 17	Room Name: Girls' Restroom	Rm Ft²: 286
	Room Dimensions: L=22 W=13 H=9	

Component	HMR #	Sample #	Material Description	Substrate	ACM Y/N	Friable Y/N
Floor	9		Ceramic floor tile grout (2" grey)		N	n/a
BB			None			
Walls	10 NOTE		Ceramic wall tile grout - blue (4" white) AFF 6'	Plaster	N	n/a
Walls	4		Plaster - sanded finish		N	n/a
Ceiling	4		Plaster - sanded finish	ACM Roofing debris	N	n/a
Ceiling	26 NOTE		Roofing debris with silver paint Silver Paint=3% CH; Other various roof material=ND		Y	Y

RED=contains asbestos

BLACK=no asbestos detected or non-suspect



YES Environmental, Inc.

1201 24th Street, Suite B110-377, Bakersfield, CA 93301 / (661) 527-0820

Building:	Building E - Classrooms 17-21	Room Name:	Custodial Room	Rm Ft²:	30
	West of Room 17	Room Dimensions:	L=30 W=10 H=12		

Component	HMR #	Sample #	Material Description	Substrate	ACM Y/N	Friable Y/N
Floor	-		Concrete - bare & exposed		N	n/a
BB			None		n/a	n/a
Walls	4		Plaster - sanded finish		N	n/a
Ceiling	4	04D	Plaster - sanded finish	ACM Roofing debris	N	n/a
Ceiling	26		Roofing debris with silver paint		Y	Y
	NOTE		Silver Paint=3% CH; Other various roof material=ND			

RED=contains asbestos

BLACK=no asbestos detected or non-suspect



YES Environmental, Inc.

1201 24th Street, Suite B110-377, Bakersfield, CA 93301 / (661) 527-0820

Building:	Building E - Classrooms 17-21	Room Name:	Classroom 17 (Lib)	Rm Ft²:	960
		Room Dimensions:	L=32 W=30 H=9/12		

Component	HMR #	Sample #	Material Description	Substrate	ACM Y/N	Friable Y/N
Floor	18	18A	Carpet squares & glue - multi bright colored	Concrete	N	n/a
Floor	19	19A	Carpet & glue - black/white speckled	Concrete	N	n/a
BB	20	20A	Baseboard & glue 4" black		N	n/a
Walls	4		Plaster - sanded finish		N	n/a
Walls	21	21A	Drywall, smooth texture		N	n/a
	NOTE		Confirmed at north and west walls.			
Walls	5		Tackboards & glue	Plaster	N	n/a
Ceiling	7		Lay-in panels - 2' x 4' gouge pinhole	ACM Roofing debris	N	n/a
Ceiling	26	26B	Roofing debris with silver paint	F/G insulation	Y	Y
	NOTE		Silver Paint=3% CH; Other various roof material=ND			
Ceiling	-		Fiberglass insulation	ACM Roofing debris	n/a	n/a
Ceiling	26		Roofing debris with silver paint	12" ACT	Y	Y
	NOTE		Silver Paint=3% CH; Other various roof material=ND			
Ceiling	8	08G	Acoustic ceiling tiles 12" uniform hole pattern (nailed)	wood slat	N	n/a
Ceiling	-		Wood slats	ACM Roofing debris	n/a	n/a
Ceiling	26		Roofing debris with silver paint	Wool batt insulation	Y	Y
	NOTE		Silver Paint=3% CH; Other various roof material=ND			
Ceiling	24		Wool-batt insulation glued (black) to paper backing	diagonal sheathing	N	n/a

RED=contains asbestos

BLACK=no asbestos detected or non-suspect



YES Environmental, Inc.

1201 24th Street, Suite B110-377, Bakersfield, CA 93301 / (661) 527-0820

Building:	Building E - Classrooms 17-21	Room Name:	Classroom 18	Rm Ft²:	960
		Room Dimensions:	L=32 W=30 H=9/12		

Component	HMR #	Sample #	Material Description	Substrate	ACM Y/N	Friable Y/N
Floor	1	01D	Carpet & glue - grey/green/multi	Concrete	N	n/a
Floor	2		Carpet & glue - black/white speckled	Concrete	N	n/a
BB	22	22A	Baseboard & glue 3" & 4" tan	wood	N	n/a
BB	-		Wood baseboard		n/a	n/a
Walls	4	04M	Plaster - sanded finish		N	n/a
Walls	5		Tackboards & glue	Plaster	N	n/a
Sink	6		Sink coating - black (stainless steel)		N	n/a
Ceiling	7	07G	Lay-in panels - 2' x 4' gouge pinhole	ACM Roofing debris	N	n/a
Ceiling	26		Roofing debris with silver paint	F/G insulation	Y	Y
	NOTE		Silver Paint=3% CH; Other various roof material=ND			
Ceiling	-		Fiberglass insulation	ACM Roofing debris	n/a	n/a
Ceiling	26		Roofing debris with silver paint	12" ACT	Y	Y
	NOTE		Silver Paint=3% CH; Other various roof material=ND			
Ceiling	8		Acoustic ceiling tiles 12" uniform hole pattern (nailed)	wood slat	N	n/a
Ceiling	-		Wood slats	ACM Roofing debris	n/a	n/a
Ceiling	26		Roofing debris with silver paint	Wool batt insulation	Y	Y
	NOTE		Silver Paint=3% CH; Other various roof material=ND			
Ceiling	24		Wool-batt insulation glued (black) to paper backing	diagonal sheathing	N	n/a

RED=contains asbestos

BLACK=no asbestos detected or non-suspect



YES Environmental, Inc.

1201 24th Street, Suite B110-377, Bakersfield, CA 93301 / (661) 527-0820

Building:	Building E - Classrooms 17-21	Room Name:	Classroom 19	Rm Ft²:	960
		Room Dimensions:	L=32 W=30 H=9/12		

Component	HMR #	Sample #	Material Description	Substrate	ACM Y/N	Friable Y/N
Floor	1		Carpet & glue - grey/green/multi	Concrete	N	n/a
Floor	2		Carpet & glue - black/white speckled	Concrete	N	n/a
BB	22		Baseboard & glue 3" & 4" tan	wood	N	n/a
BB	-		Wood baseboard		n/a	n/a
Walls	4		Plaster - sanded finish		N	n/a
Walls	5		Tackboards & glue	Plaster	N	n/a
Sink	6	06A	Sink coating - black (stainless steel)		N	n/a
Ceiling	7		Lay-in panels - 2' x 4' gouge pinhole	ACM Roofing debris	N	n/a
Ceiling	26		Roofing debris with silver paint	F/G insulation	Y	Y
	NOTE		Silver Paint=3% CH; Other various roof material=ND			
Ceiling	-		Fiberglass insulation	ACM Roofing debris	n/a	n/a
Ceiling	26		Roofing debris with silver paint	12" ACT	Y	Y
	NOTE		Silver Paint=3% CH; Other various roof material=ND			
Ceiling	8	08H	Acoustic ceiling tiles 12" uniform hole pattern (nailed)	wood slat	N	n/a
Ceiling	-		Wood slats	ACM Roofing debris	n/a	n/a
Ceiling	26		Roofing debris with silver paint	Wool batt insulation	Y	Y
	NOTE		Silver Paint=3% CH; Other various roof material=ND			
Ceiling	24		Wool-batt insulation glued (black) to paper backing	diagonal sheathing	N	n/a

RED=contains asbestos

BLACK=no asbestos detected or non-suspect



YES Environmental, Inc.

1201 24th Street, Suite B110-377, Bakersfield, CA 93301 / (661) 527-0820

Building:	Building E - Classrooms 17-21	Room Name:	Classroom 20	Rm Ft²:	960
		Room Dimensions:	L=32 W=30 H=9/12		

Component	HMR #	Sample #	Material Description	Substrate	ACM Y/N	Friable Y/N
Floor	1		Carpet & glue - grey/green/multi	Concrete	N	n/a
Floor	2	02C	Carpet & glue - black/white speckled	Concrete	N	n/a
BB	22		Baseboard & glue 3" & 4" tan	wood	N	n/a
BB	-		Wood baseboard		n/a	n/a
Walls	4		Plaster - sanded finish		N	n/a
Walls	5		Tackboards & glue	Plaster	N	n/a
Sink	6		Sink coating - black (stainless steel)		N	n/a
Ceiling	7	07H	Lay-in panels - 2' x 4' gouge pinhole	ACM Roofing debris	N	n/a
Ceiling	26		Roofing debris with silver paint	F/G insulation	Y	Y
	NOTE		Silver Paint=3% CH; Other various roof material=ND			
Ceiling	-		Fiberglass insulation	ACM Roofing debris	n/a	n/a
Ceiling	26		Roofing debris with silver paint	12" ACT	Y	Y
	NOTE		Silver Paint=3% CH; Other various roof material=ND			
Ceiling	8		Acoustic ceiling tiles 12" uniform hole pattern (nailed)	wood slat	N	n/a
Ceiling	-		Wood slats	ACM Roofing debris	n/a	n/a
Ceiling	26		Roofing debris with silver paint	Wool batt insulation	Y	Y
	NOTE		Silver Paint=3% CH; Other various roof material=ND			
Ceiling	24		Wool-batt insulation glued (black) to paper backing	diagonal sheathing	N	n/a

RED=contains asbestos

BLACK=no asbestos detected or non-suspect



YES Environmental, Inc.

1201 24th Street, Suite B110-377, Bakersfield, CA 93301 / (661) 527-0820

Building:	Building E - Classrooms 17-21	Room Name:	Classroom 21	Rm Ft²:	960
		Room Dimensions:	L=32 W=30 H=9/12		

Component	HMR #	Sample #	Material Description	Substrate	ACM Y/N	Friable Y/N
Floor	1		Carpet & glue - grey/green/multi	Concrete	N	n/a
Floor	2		Carpet & glue - black/white speckled	Concrete	N	n/a
BB	3		Baseboard & glue 3" & 4" blue	wood	N	n/a
BB	-		Wood baseboard		n/a	n/a
Walls	4	04L	Plaster - sanded finish		N	n/a
Walls	5	05B	Tackboards & glue	Plaster	N	n/a
Sink	6		Sink coating - black (stainless steel)		N	n/a
Ceiling	7		Lay-in panels - 2' x 4' gouge pinhole	ACM Roofing debris	N	n/a
Ceiling	26		Roofing debris with silver paint	F/G insulation	Y	Y
	NOTE		Silver Paint=3% CH; Other various roof material=ND			
Ceiling	-		Fiberglass insulation	ACM Roofing debris	n/a	n/a
Ceiling	26		Roofing debris with silver paint	12" ACT	Y	Y
	NOTE		Silver Paint=3% CH; Other various roof material=ND			
Ceiling	8		Acoustic ceiling tiles 12" uniform hole pattern (nailed)	wood slat	N	n/a
Ceiling	-		Wood slats	ACM Roofing debris	n/a	n/a
Ceiling	26		Roofing debris with silver paint	Wool batt insulation	Y	Y
	NOTE		Silver Paint=3% CH; Other various roof material=ND			
Ceiling	24		Wool-batt insulation glued (black) to paper backing	diagonal sheathing	N	n/a

RED=contains asbestos

BLACK=no asbestos detected or non-suspect



YES Environmental, Inc.

1201 24th Street, Suite B110-377, Bakersfield, CA 93301 / (661) 527-0820

Building:	Building E - Classrooms 17-21	Room Name:	Exterior
------------------	-------------------------------	-------------------	----------

Component	HMR #	Sample #	Material Description	Substrate	ACM Y/N	Friable Y/N
Ground	38		Asphalt		N	n/a
Ground	-		Concrete - bare & exposed		n/a	n/a
Walls	35		Exterior stucco, painted & vapor barrier		N	n/a
Windows	28	28I-J	Exterior window putty		N	n/a
Eaves	35	35D	Exterior stucco, painted		N	n/a
Roof	36	36B	White coated foam on silver paint on rolled composition roofing & Diagonal sheathing		Y	N
	NOTE		Foam=ND; Silver Paint=2-4% CH; Rolled Composition Roofing & Felts=ND			
Roof	37		White coated foam on silver paint on penetration mastic		Y	N
	NOTE		Foam=ND; Silver Paint=2-4% CH; Mastics=Assumed			
	NOTE		On components such as, but not limited to, roof jacks, roof vents, conduits, sleepers, patches, etc.			

RED=contains asbestos

BLACK=no asbestos detected or non-suspect



YES Environmental, Inc.

1201 24th Street, Suite B110-377, Bakersfield, CA 93301 / (661) 527-0820

Client: Bakersfield City School District

Site: Wayside ES

YES Project No.: 23YES-05

Date of Inspection: 6/27/2023

Inspection Report

Building:	Building F - Multi-Purpose Building	Room Name:	Attic
<p>Attic is defined as: every enclosed spaced that is contiguous and/or beneath the roof, attic, void, and plenum space above every room in this building including, but not limited to, exterior enclosed eaves, enclosed hallways, walkways, corridors, wall cavities, etc. and all spaces beneath the roof and above ceilings that are or are not readily accessible.</p>			
<p>Attic Floor is defined as: the surface within an attic space, serving as the ceiling for the room(s) below and/or an area with exposed joists. It is not a term that can be used to infer a walkable surface.</p>			

Component	HMR #	Sample #	Material Description	Substrate	ACM Y/N	Friable Y/N
Attic Floor	26		Roofing debris with silver paint		Y	Y
	NOTE		Silver Paint=3% CH; Other various roof material=ND material exists on and inbetween the floor joists of this space.	This		
Attic Floor	-		Fiberglass batt insulation		Y	Y
	NOTE		Contaminated with asbestos roofing debris			
Walls	-		Wood		n/a	n/a
Flue Pipes			Transite flue pipes - Known Asbestos Material (typically 10-20% Chrysotile)		Y	N
Ceiling	-		Diagonal sheathing		n/a	n/a

RED=contains asbestos

BLACK=no asbestos detected or non-suspect



YES Environmental, Inc.

1201 24th Street, Suite B110-377, Bakersfield, CA 93301 / (661) 527-0820

Building:	Building F - Multi-Purpose Building	Room Name:	Representative of ceilings throughout
------------------	-------------------------------------	-------------------	---------------------------------------

Component	HMR #	Sample #	Material Description	Substrate	Y/N	Y/N
Walls	4		Plaster - sanded finish		N	n/a
Walls	5		Tackboards & glue		N	n/a
Ceiling	7		Lay-in panels - 2' x 4' gouge pinhole	ACM Roofing debris	N	n/a
Ceiling	26		Roofing debris with silver paint	F/G insulation	Y	Y
	NOTE		Silver Paint=3% CH; Other various roof material=ND			
Ceiling	-		Fiberglass insulation	ACM Roofing debris	n/a	n/a
Ceiling	26		Roofing debris with silver paint	12" ACT	Y	Y
	NOTE		Silver Paint=3% CH; Other various roof material=ND			
Ceiling	8		Acoustic ceiling tiles 12" uniform hole pattern (nailed)	Plaster	N	n/a
Ceiling	27		Plaster, Rough Finish	ACM Roofing debris	N	n/a
Ceiling	26		Roofing debris with silver paint	Wool batt insulation	Y	Y
	NOTE		Silver Paint=3% CH; Other various roof material=ND			
Ceiling	24		Wool-batt insulation glued (black) to paper backing	diagonal sheathing	N	n/a

RED=contains asbestos

BLACK=no asbestos detected or non-suspect



YES Environmental, Inc.

1201 24th Street, Suite B110-377, Bakersfield, CA 93301 / (661) 527-0820

Building:	Building F - Multi-Purpose Building	Room Name:	Main Dining Room	Rm Ft²:	3,600
		Room Dimensions:	L=72 W=50 H=12		

Component	HMR #	Sample #	Material Description	Substrate	ACM Y/N	Friable Y/N
Floor	13	13B	Floor tile & glue 12" blue/grey oatmeal	Concrete	N	n/a
BB	3		Baseboard & glue 3" & 4" blue		N	n/a
Walls	4	04N	Plaster - sanded finish		N	n/a
Walls	5		Tackboards & glue		N	n/a
Ceiling	7	07I	Lay-in panels - 2' x 4' gouge pinhole	ACM Roofing debris	N	n/a
Ceiling	26		Roofing debris with silver paint	F/G insulation	Y	Y
	NOTE		Silver Paint=3% CH; Other various roof material=ND			
Ceiling	-		Fiberglass insulation	ACM Roofing debris	n/a	n/a
Ceiling	26		Roofing debris with silver paint	12" ACT	Y	Y
	NOTE		Silver Paint=3% CH; Other various roof material=ND			
Ceiling	8		Acoustic ceiling tiles 12" uniform hole pattern (nailed)	Plaster	N	n/a
Ceiling	27	27A	Plaster, Rough Finish	ACM Roofing debris	N	n/a
Ceiling	26		Roofing debris with silver paint	Wool batt insulation	Y	Y
	NOTE		Silver Paint=3% CH; Other various roof material=ND			
Ceiling	24	24C	Wool-batt insulation glued (black) to paper backing	diagonal sheathing	N	n/a

RED=contains asbestos

BLACK=no asbestos detected or non-suspect



YES Environmental, Inc.

1201 24th Street, Suite B110-377, Bakersfield, CA 93301 / (661) 527-0820

Building:	Building F - Multi-Purpose Building	Room Name:	Exterior
------------------	-------------------------------------	-------------------	----------

Component	HMR #	Sample #	Material Description	Substrate	ACM Y/N	Friable Y/N
Ground	38		Asphalt		N	n/a
Ground	-		Concrete - bare & exposed		n/a	n/a
Walls	35		Exterior stucco, painted & vapor barrier		N	n/a
Windows	28		Exterior window putty		N	n/a
Eaves	35	35F	Exterior stucco, painted		N	n/a
Roof	36	36C	White coated foam on silver paint on rolled composition roofing & Diagonal sheathing		Y	N
	NOTE		Foam=ND; Silver Paint=2-4% CH; Rolled Composition Roofing & Felts=ND			
Roof	37		White coated foam on silver paint on penetration mastic		Y	N
	NOTE		Foam=ND; Silver Paint=2-4% CH; Mastics=Assumed			
	NOTE		On components such as, but not limited to, roof jacks, roof vents, conduits, sleepers, patches, etc.			

RED=contains asbestos

BLACK=no asbestos detected or non-suspect



YES Environmental, Inc.

1201 24th Street, Suite B110-377, Bakersfield, CA 93301 / (661) 527-0820

Client: Bakersfield City School District

Site: Wayside ES

YES Project No.: 23YES-05

Date of Inspection: 6/27/2023

Inspection Report

Building:	Building G - Book Room Building	Room Name:	Attic
<p>Attic is defined as: every enclosed spaced that is contiguous and/or beneath the roof, attic, void, and plenum space above every room in this building including, but not limited to, exterior enclosed eaves, enclosed hallways, walkways, corridors, wall cavities, etc. and all spaces beneath the roof and above ceilings that are or are not readily accessible.</p>			
<p>Attic Floor is defined as: the surface within an attic space, serving as the ceiling for the room(s) below and/or an area with exposed joists. It is not a term that can be used to infer a walkable surface.</p>			

Component	HMR #	Sample #	Material Description	Substrate	ACM Y/N	Friable Y/N
Attic Floor	26		Roofing debris with silver paint		Y	Y
	NOTE		Silver Paint=3% CH; Other various roof material=ND material exists on and inbetween the floor joists of this space.	This		
Attic Floor	-		Fiberglass batt insulation		Y	Y
	NOTE		Contaminated with asbestos roofing debris			
Walls	-		Wood		n/a	n/a
Flue Pipes			Transite flue pipes - Known Asbestos Material (typically 10-20% Chrysotile)		Y	N
Ceiling	-		Diagonal sheathing		n/a	n/a

RED=contains asbestos

BLACK=no asbestos detected or non-suspect



YES Environmental, Inc.

1201 24th Street, Suite B110-377, Bakersfield, CA 93301 / (661) 527-0820

Building:	Building G - Book Room Building	Room Name:	West Boys' Restroom	Rm Ft²:	140
		Room Dimensions:	L=14 W=10 H=9		

Component	HMR #	Sample #	Material Description	Substrate	ACM Y/N	Friable Y/N
Floor	9	09C	Ceramic floor tile grout (2" grey)		N	n/a
BB			None			
Walls	10		Ceramic wall tile grout - blue (4" white)	Plaster	N	n/a
	NOTE		AFF 6'			
Walls	4		Plaster - sanded finish		N	n/a
Ceiling	4		Plaster - sanded finish	ACM Roofing debris	N	n/a
Ceiling	26		Roofing debris with silver paint		Y	Y
	NOTE		Silver Paint=3% CH; Other various roof material=ND			

Building:	Building G - Book Room Building	Room Name:	SW Girls' Restroom	Rm Ft²:	190
		Room Dimensions:	L=19 W=10 H=9		

Component	HMR #	Sample #	Material Description	Substrate	ACM Y/N	Friable Y/N
Floor	9		Ceramic floor tile grout (2" grey)		N	n/a
BB			None			
Walls	10		Ceramic wall tile grout - blue (4" white)	Plaster	N	n/a
	NOTE		AFF 6'			
Walls	4		Plaster - sanded finish		N	n/a
Ceiling	4		Plaster - sanded finish	ACM Roofing debris	N	n/a
Ceiling	26		Roofing debris with silver paint		Y	Y
	NOTE		Silver Paint=3% CH; Other various roof material=ND			

RED=contains asbestos

BLACK=no asbestos detected or non-suspect



YES Environmental, Inc.

1201 24th Street, Suite B110-377, Bakersfield, CA 93301 / (661) 527-0820

Building:	Building G - Book Room Building	Room Name:	Book Room	Rm Ft²:	798
		Room Dimensions:	L=42 W=19 H=12		

Component	HMR #	Sample #	Material Description	Substrate	ACM Y/N	Friable Y/N
Floor	23	23B	Floor tile & glue 12" lt grey/cream mosaic	Concrete	N	n/a
BB	3	03F	Baseboard & glue 3" & 4" blue		N	n/a
Walls	4		Plaster - sanded finish		N	n/a
Ceiling	4		Plaster - sanded finish	ACM Roofing debris	N	n/a
Ceiling	26		Roofing debris with silver paint		Y	Y
	NOTE		Silver Paint=3% CH; Other various roof material=ND			

Building:	Building G - Book Room Building	Room Name:	Exterior
------------------	---------------------------------	-------------------	----------

Component	HMR #	Sample #	Material Description	Substrate	ACM Y/N	Friable Y/N
Ground	38		Asphalt		N	n/a
Ground	-		Concrete - bare & exposed		n/a	n/a
Walls	35		Exterior stucco, painted & vapor barrier		N	n/a
Windows	28	28K-L	Exterior window putty		N	n/a
Eaves	35	35E	Exterior stucco, painted		N	n/a
Roof	36		White coated foam on silver paint on rolled composition roofing	Diagonal sheathing	Y	N
	NOTE		Foam=ND; Silver Paint=2-4% CH; Rolled Composition Roofing & Felts=ND			
Roof	37		White coated foam on silver paint on penetration mastic		Y	N
	NOTE		Foam=ND; Silver Paint=2-4% CH; Mastics=Assumed			
	NOTE		On components such as, but not limited to, roof jacks, roof vents, conduits, sleepers, patches, etc.			

RED=contains asbestos

BLACK=no asbestos detected or non-suspect



YES Environmental, Inc.

1201 24th Street, Suite B110-377, Bakersfield, CA 93301 / (661) 527-0820

Client: Bakersfield City School District

Site: Wayside ES

YES Project No.: 23YES-05

Date of Inspection: 6/27/2023

Inspection Report

Building:	Building H - Administration	Room Name:	Attic
<p>Attic is defined as: every enclosed spaced that is contiguous and/or beneath the roof, attic, void, and plenum space above every room in this building including, but not limited to, exterior enclosed eaves, enclosed hallways, walkways, corridors, wall cavities, etc. and all spaces beneath the roof and above ceilings that are or are not readily accessible.</p>			
<p>Attic Floor is defined as: the surface within an attic space, serving as the ceiling for the room(s) below and/or an area with exposed joists. It is not a term that can be used to infer a walkable surface.</p>			

Component	HMR #	Sample #	Material Description	Substrate	ACM Y/N	Friable Y/N
Attic Floor	26		Roofing debris with silver paint		Y	Y
	NOTE		Silver Paint=3% CH; Other various roof material=ND This material exists on and inbetween the floor joists of this space.			
Attic Floor	-		Fiberglass batt insulation		Y	Y
	NOTE		Contaminated with asbestos roofing debris			
Walls	-		Wood		n/a	n/a
Flue Pipes			Transite flue pipes - Known Asbestos Material (typically 10-20% Chrysotile)		Y	N
Ceiling	-		Diagonal sheathing		n/a	n/a

Inspection limited to ceilings and walls above the ceilings in these buildings for fire alarm work in accordance with BCSD plans.

RED=contains asbestos

BLACK=no asbestos detected or non-suspect



YES Environmental, Inc.

1201 24th Street, Suite B110-377, Bakersfield, CA 93301 / (661) 527-0820

Building:		Room Name:				
Building H - Administration		Representative of ceilings throughout				
Component	HMR #	Sample #	Material Description	Substrate	Y/N	Y/N
Walls	4		Plaster - sanded finish		N	n/a
Walls	29	29A	Drywall, orange-peel texture		N	n/a
Walls	5		Tackboards & glue		N	n/a
Ceiling	15	15B-C	Lay-in panels - 2' x 4' variety (fiss/gouge) various ages	ACM Roofing debris	N	n/a
Ceiling	26		Roofing debris with silver paint	F/G insulation	Y	Y
	NOTE		Silver Paint=3% CH; Other various roof material=ND			
Ceiling	-		Fiberglass insulation	ACM Roofing debris	n/a	n/a
Ceiling	26		Roofing debris with silver paint	12" ACT	Y	Y
	NOTE		Silver Paint=3% CH; Other various roof material=ND			
Ceiling	8		Acoustic ceiling tiles 12" uniform hole pattern (nailed)	wood slat	N	n/a
Ceiling	30	30A	Acoustic ceiling tiles 12" random pinhole pattern (nailed)	wood slat	N	n/a
Ceiling	-		Wood slats	ACM Roofing debris	n/a	n/a
Ceiling	26		Roofing debris with silver paint	Wool batt insulation	Y	Y
	NOTE		Silver Paint=3% CH; Other various roof material=ND			
Ceiling	24		Wool-batt insulation glued (black) to paper backing	diagonal sheathing	N	n/a
Inspection limited to ceilings and walls above the ceilings in these buildings for fire alarm work in accordance with BCSD plans.						

RED=contains asbestos

BLACK=no asbestos detected or non-suspect



YES Environmental, Inc.

1201 24th Street, Suite B110-377, Bakersfield, CA 93301 / (661) 527-0820

Building: Building H - Administration	Room Name: Exterior
--	----------------------------

Component	HMR #	Sample #	Material Description	Substrate	ACM Y/N	Friable Y/N
Ground	38		Asphalt		N	n/a
Ground	-		Concrete - bare & exposed		n/a	n/a
Walls	35		Exterior stucco, painted & vapor barrier		N	n/a
Windows	28		Exterior window putty		N	n/a
Eaves	35		Exterior stucco, painted		N	n/a
Roof	36		White coated foam on silver paint on rolled composition roofing	Diagonal sheathing	Y	N
	NOTE		Foam=ND; Silver Paint=2-4% CH; Rolled Composition Roofing & Felts=ND			
Roof	37		White coated foam on silver paint on penetration mastic		Y	N
	NOTE		Foam=ND; Silver Paint=2-4% CH; Mastics=Assumed			
	NOTE		On components such as, but not limited to, roof jacks, roof vents, conduits, sleepers, patches, etc.			

RED=contains asbestos

BLACK=no asbestos detected or non-suspect



YES Environmental, Inc.

1201 24th Street, Suite B110-377, Bakersfield, CA 93301 / (661) 527-0820

Client: Bakersfield City School District

Site: Wayside ES

YES Project No.: 23YES-05

Date of Inspection: 6/27/2023

Inspection Report

Building:	R13 (CR 35) & R14 (CR 36)	Room Name:	Representative of ceilings & upper walls throughout
------------------	---------------------------	-------------------	---

Component	HMR #	Sample #	Material Description	Substrate	Y/N	Y/N
Upper Walls	42	42A	Unfinished drywall (no T&J) with tackboard glue		N	n/a
Ceiling	41	41B	Lay-in panels 2'x4' fissure pinhole pattern	F/G insulation	N	n/a
Ceiling	-		Fiberglass insulation	Metal roof deck	n/a	n/a
Ceiling	-		Metal roof deck		n/a	n/a

Inspection limited to ceilings and walls above the ceilings in these buildings for fire alarm work in accordance with BCSD plans.

Building:	R13 (CR 35) & R14 (CR 36)	Room Name:	Exterior upper walls only
------------------	---------------------------	-------------------	---------------------------

Component	HMR #	Sample #	Material Description	Substrate	ACM Y/N	Friable Y/N
Walls	-		Wood		n/a	n/a

Inspection limited to upper exterior walls in these buildings for fire alarm work in accordance with BCSD plans.

RED=contains asbestos

BLACK=no asbestos detected or non-suspect



YES Environmental, Inc.

1201 24th Street, Suite B110-377, Bakersfield, CA 93301 / (661) 527-0820

Client: Bakersfield City School District

Site: Wayside ES

YES Project No.: 23YES-05

Date of Inspection: 6/27/2023

Inspection Report

Building: R15 (CR 37)	Room Name: Representative of ceilings & upper walls throughout
------------------------------	---

Component	HMR #	Sample #	Material Description	Substrate	Y/N	Y/N
Upper Walls	44	44A	Unfinished drywall (no T&J) with tackboard glue		N	n/a
Ceiling	43	43A	Lay-in panels 2'x4' fiberglass plastic jacketed	F/G insulation	N	n/a
Ceiling	-		Fiberglass insulation	Metal roof deck	n/a	n/a
Ceiling	-		Metal roof deck		n/a	n/a

Inspection limited to ceilings and walls above the ceilings in these buildings for fire alarm work in accordance with BCSD plans.

Building: R15 (CR 37)	Room Name: Exterior upper walls only
------------------------------	---

Component	HMR #	Sample #	Material Description	Substrate	ACM Y/N	Friable Y/N
Walls	-		Wood		n/a	n/a

Inspection limited to upper exterior walls in these buildings for fire alarm work in accordance with BCSD plans.

RED=contains asbestos

BLACK=no asbestos detected or non-suspect



YES Environmental, Inc.

1201 24th Street, Suite B110-377, Bakersfield, CA 93301 / (661) 527-0820

Client: Bakersfield City School District

Site: Wayside ES

YES Project No.: 23YES-05

Date of Inspection: 6/27/2023

Inspection Report

Building: R16 (CR 38)	Room Name: Representative of ceilings & upper walls throughout
------------------------------	---

Component	HMR #	Sample #	Material Description	Substrate	Y/N	Y/N
Upper Walls	-		exposed studs above ceiling panels		n/a	n/a
Ceiling	41	41A	Lay-in panels 2'x4' fissure pinhole pattern	F/G insulation	N	n/a
Ceiling	-		Fiberglass insulation	Metal roof deck	n/a	n/a
Ceiling	-		Metal roof deck		n/a	n/a

Inspection limited to ceilings and walls above the ceilings in these buildings for fire alarm work in accordance with BCSD plans.

Building: R16 (CR 38)	Room Name: Exterior upper walls only
------------------------------	---

Component	HMR #	Sample #	Material Description	Substrate	ACM Y/N	Friable Y/N
Walls	-		Wood		n/a	n/a

Inspection limited to upper exterior walls in these buildings for fire alarm work in accordance with BCSD plans.

RED=contains asbestos

BLACK=no asbestos detected or non-suspect



YES Environmental, Inc.

1201 24th Street, Suite B110-377, Bakersfield, CA 93301 / (661) 527-0820

Client: Bakersfield City School District

Site: Wayside ES

YES Project No.: 23YES-05

Date of Inspection: 6/27/2023

Inspection Report

Building: R12 Restrooms	Room Name: Representative of ceilings & upper walls throughout
--------------------------------	---

Component	HMR #	Sample #	Material Description	Substrate	Y/N	Y/N
Upper Walls	-		exposed studs above ceiling panels		n/a	n/a
Ceiling	45	45A	Lay-in panels 2'x4' vinyl jacketed drywall	F/G insulation	N	n/a
Ceiling	-		Fiberglass insulation	Metal roof deck	n/a	n/a
Ceiling	-		Metal roof deck		n/a	n/a

Inspection limited to ceilings and walls above the ceilings in these buildings for fire alarm work in accordance with BCSD plans.

Building: R12 Restrooms	Room Name: Exterior upper walls only
--------------------------------	---

Component	HMR #	Sample #	Material Description	Substrate	ACM Y/N	Friable Y/N
Walls	-		Wood		N	n/a

Inspection limited to upper exterior walls in these buildings for fire alarm work in accordance with BCSD plans.

RED=contains asbestos

BLACK=no asbestos detected or non-suspect



YES Environmental, Inc.

1201 24th Street, Suite B110-377, Bakersfield, CA 93301 / (661) 527-0820

Client: Bakersfield City School District

Site: Wayside ES

YES Project No.: 23YES-05

Date of Inspection: 6/27/2023

Inspection Report

Building: R10 Restrooms	Room Name: Representative of ceilings & upper walls throughout
--------------------------------	---

Component	HMR #	Sample #	Material Description	Substrate	Y/N	Y/N
Upper Walls	-		exposed studs above ceiling panels		n/a	n/a
Ceiling	40	40A	Lay-in panels 2'x4' vinyl jacketed drywall	F/G insulation	N	n/a
Ceiling	-		Fiberglass insulation	Metal roof deck	n/a	n/a
Ceiling	-		Metal roof deck		n/a	n/a

Inspection limited to ceilings and walls above the ceilings in these buildings for fire alarm work in accordance with BCSD plans.

Building: R10 Restrooms	Room Name: Exterior upper walls only
--------------------------------	---

Component	HMR #	Sample #	Material Description	Substrate	ACM Y/N	Friable Y/N
Walls	46	46A	Stucco finish over cement board		N	n/a

Inspection limited to upper exterior walls in these buildings for fire alarm work in accordance with BCSD plans.

RED=contains asbestos

BLACK=no asbestos detected or non-suspect



YES Environmental, Inc.

1201 24th Street, Suite B110-377, Bakersfield, CA 93301 / (661) 527-0820

Client: Bakersfield City School District

Site: Wayside ES

YES Project No.: 23YES-05

Date of Inspection: 6/27/2023

Inspection Report

Building: R1-R9 (CRs 26-34)	Room Name: Representative of ceilings & upper walls throughout
------------------------------------	---

Component	HMR #	Sample #	Material Description	Substrate	Y/N	Y/N
Upper Walls	33	33A-C	Unfinished drywall (no T&J) with tackboard glue		N	n/a
Ceiling	34	34A-B	Lay-in panels 2'x4' gouge pinhole pattern	F/G insulation	N	n/a
Ceiling	-		Fiberglass insulation	Metal roof deck	n/a	n/a
Ceiling	-		Metal roof deck		n/a	n/a

Inspection limited to ceilings and walls above the ceilings in these buildings for fire alarm work in accordance with BCSD plans.

Building: R1-R9 (CRs 26-34)	Room Name: Exterior upper walls only
------------------------------------	---

Component	HMR #	Sample #	Material Description	Substrate	ACM Y/N	Friable Y/N
Walls	39	39A-C	Stucco finish over cement board		n/a	n/a

Inspection limited to upper exterior walls in these buildings for fire alarm work in accordance with BCSD plans.

RED=contains asbestos

BLACK=no asbestos detected or non-suspect



YES Environmental, Inc.

1201 24th Street, Suite B110-377, Bakersfield, CA 93301 / (661) 527-0820

Client: Bakersfield City School District

Site: Wayside ES

YES Project No.: 23YES-05

Date of Inspection: 6/27/2023

Inspection Report

Building: R18 (K3) & K19 (K4)	Room Name: Representative of ceilings & upper walls throughout
--------------------------------------	---

Component	HMR #	Sample #	Material Description	Substrate	Y/N	Y/N
Upper Walls	-		Fiberglass insulation above ceiling on walls		n/a	n/a
Ceiling	31	31B	Lay-in panels 2'x4' fissure pinhole pattern	F/G insulation	N	n/a
Ceiling	-		Fiberglass insulation	Metal roof deck	n/a	n/a
Ceiling	-		Metal roof deck		n/a	n/a

Inspection limited to ceilings and walls above the ceilings in these buildings for fire alarm work in accordance with BCSD plans.

Building: R18 (K3) & K19 (K4)	Room Name: Exterior upper walls only
--------------------------------------	---

Component	HMR #	Sample #	Material Description	Substrate	ACM Y/N	Friable Y/N
Walls	-		Wood		n/a	n/a

Inspection limited to upper exterior walls in these buildings for fire alarm work in accordance with BCSD plans.

RED=contains asbestos

BLACK=no asbestos detected or non-suspect



YES Environmental, Inc.

1201 24th Street, Suite B110-377, Bakersfield, CA 93301 / (661) 527-0820

Client: Bakersfield City School District

Site: Wayside ES

YES Project No.: 23YES-05

Date of Inspection: 6/27/2023

Inspection Report

Building: R11 - Pre K	Room Name: Representative of ceilings & upper walls throughout
------------------------------	---

Component	HMR #	Sample #	Material Description	Substrate	Y/N	Y/N
Upper Walls	-		Fiberglass insulation above ceiling on walls		n/a	n/a
Ceiling	31		Lay-in panels 2'x4' fissure pinhole pattern	F/G insulation	N	n/a
Ceiling	-		Fiberglass insulation	Metal roof deck	n/a	n/a
Ceiling	-		Metal roof deck		n/a	n/a

Inspection limited to ceilings and walls above the ceilings in these buildings for fire alarm work in accordance with BCSD plans.

Building: R11 - Pre K	Room Name: Exterior upper walls only
------------------------------	---

Component	HMR #	Sample #	Material Description	Substrate	ACM Y/N	Friable Y/N
Walls	-		Wood		n/a	n/a

Inspection limited to upper exterior walls in these buildings for fire alarm work in accordance with BCSD plans.

RED=contains asbestos

BLACK=no asbestos detected or non-suspect



YES Environmental, Inc.

1201 24th Street, Suite B110-377, Bakersfield, CA 93301 / (661) 527-0820

Client: Bakersfield City School District

Site: Wayside ES

YES Project No.: 23YES-05

Date of Inspection: 6/27/2023

Inspection Report

Building:	R17 - Restroom Portable	Room Name:	Representative of ceilings & upper walls throughout
------------------	-------------------------	-------------------	---

Component	HMR #	Sample #	Material Description	Substrate	Y/N	Y/N
Walls	32	32A	unfinished drywall (no T&J)		N	n/a
Ceiling	31	31A	Lay-in panels 2'x4' fissure pinhole pattern	F/G insulation	N	n/a
Ceiling	-		Fiberglass insulation	Metal roof deck	n/a	n/a
Ceiling	-		Metal roof deck		n/a	n/a

Inspection limited to ceilings and walls above the ceilings in these buildings for fire alarm work in accordance with BCSD plans.

Building:	R17 - Restroom Portable	Room Name:	Exterior upper walls only
------------------	-------------------------	-------------------	---------------------------

Component	HMR #	Sample #	Material Description	Substrate	ACM Y/N	Friable Y/N
Walls	-		Wood		n/a	n/a

Inspection limited to upper exterior walls in these buildings for fire alarm work in accordance with BCSD plans.

RED=contains asbestos

BLACK=no asbestos detected or non-suspect