

KEYNOTES

2.100	SANCTUARY REMOVE DAMAGED CONCRETE SLAB	02072
2.101	TILE (VCT) AS REQUIRED	02072
2.102	REMOVE (E) PLUMBING	02072
2.103	REMOVE (E) DRINKING FOUNTAIN	02072
2.104	REMOVE (E) CABINET DOOR	02072
2.105	REMOVE (E) WINDOW SASH	02072
2.106	REMOVE (E) WINDOW SASH	02072
2.107	REMOVE (E) WINDOW SASH	02072
2.108	REMOVE (E) WINDOW SASH	02072
2.109	REMOVE (E) WINDOW SASH	02072
2.110	REMOVE (E) WINDOW SASH	02072
2.111	REMOVE (E) WALLS AS INDICATED	02072
2.112	REMOVE (E) CABINET E/O/C	02072
2.113	REMOVE (E) CABINET E/O/C	02072
2.114	REMOVE (E) CABINET E/O/C	02072
2.115	REMOVE (E) CABINET E/O/C	02072
2.116	REMOVE (E) CABINET E/O/C	02072
2.117	REMOVE (E) CABINET E/O/C	02072
2.118	REMOVE (E) CABINET E/O/C	02072
2.119	REMOVE (E) CABINET E/O/C	02072
2.120	REMOVE (E) CABINET E/O/C	02072
2.121	REMOVE (E) CABINET E/O/C	02072
2.122	REMOVE (E) CABINET E/O/C	02072
2.123	REMOVE (E) CABINET E/O/C	02072
2.124	REMOVE (E) CABINET E/O/C	02072
2.125	REMOVE (E) CABINET E/O/C	02072
2.126	REMOVE (E) CABINET E/O/C	02072
2.127	REMOVE (E) CABINET E/O/C	02072
2.128	REMOVE (E) CABINET E/O/C	02072
2.129	REMOVE (E) CABINET E/O/C	02072
2.130	REMOVE (E) CABINET E/O/C	02072
2.131	REMOVE (E) CABINET E/O/C	02072
2.132	REMOVE (E) CABINET E/O/C	02072
2.133	REMOVE (E) CABINET E/O/C	02072
2.134	REMOVE (E) CABINET E/O/C	02072
2.135	REMOVE (E) CABINET E/O/C	02072
2.136	REMOVE (E) CABINET E/O/C	02072
2.137	REMOVE (E) CABINET E/O/C	02072
2.138	REMOVE (E) CABINET E/O/C	02072
2.139	REMOVE (E) CABINET E/O/C	02072
2.140	REMOVE (E) CABINET E/O/C	02072
2.141	REMOVE (E) CABINET E/O/C	02072
2.142	REMOVE (E) CABINET E/O/C	02072
2.143	REMOVE (E) CABINET E/O/C	02072
2.144	REMOVE (E) CABINET E/O/C	02072
2.145	REMOVE (E) CABINET E/O/C	02072
2.146	REMOVE (E) CABINET E/O/C	02072
2.147	REMOVE (E) CABINET E/O/C	02072
2.148	REMOVE (E) CABINET E/O/C	02072
2.149	REMOVE (E) CABINET E/O/C	02072
2.150	REMOVE (E) CABINET E/O/C	02072
2.151	REMOVE (E) CABINET E/O/C	02072
2.152	REMOVE (E) CABINET E/O/C	02072
2.153	REMOVE (E) CABINET E/O/C	02072
2.154	REMOVE (E) CABINET E/O/C	02072
2.155	REMOVE (E) CABINET E/O/C	02072
2.156	REMOVE (E) CABINET E/O/C	02072
2.157	REMOVE (E) CABINET E/O/C	02072
2.158	REMOVE (E) CABINET E/O/C	02072
2.159	REMOVE (E) CABINET E/O/C	02072
2.160	REMOVE (E) CABINET E/O/C	02072
2.161	REMOVE (E) CABINET E/O/C	02072
2.162	REMOVE (E) CABINET E/O/C	02072
2.163	REMOVE (E) CABINET E/O/C	02072
2.164	REMOVE (E) CABINET E/O/C	02072
2.165	REMOVE (E) CABINET E/O/C	02072
2.166	REMOVE (E) CABINET E/O/C	02072
2.167	REMOVE (E) CABINET E/O/C	02072
2.168	REMOVE (E) CABINET E/O/C	02072
2.169	REMOVE (E) CABINET E/O/C	02072
2.170	REMOVE (E) CABINET E/O/C	02072
2.171	REMOVE (E) CABINET E/O/C	02072
2.172	REMOVE (E) CABINET E/O/C	02072
2.173	REMOVE (E) CABINET E/O/C	02072
2.174	REMOVE (E) CABINET E/O/C	02072
2.175	REMOVE (E) CABINET E/O/C	02072
2.176	REMOVE (E) CABINET E/O/C	02072
2.177	REMOVE (E) CABINET E/O/C	02072
2.178	REMOVE (E) CABINET E/O/C	02072
2.179	REMOVE (E) CABINET E/O/C	02072
2.180	REMOVE (E) CABINET E/O/C	02072
2.181	REMOVE (E) CABINET E/O/C	02072
2.182	REMOVE (E) CABINET E/O/C	02072
2.183	REMOVE (E) CABINET E/O/C	02072
2.184	REMOVE (E) CABINET E/O/C	02072
2.185	REMOVE (E) CABINET E/O/C	02072
2.186	REMOVE (E) CABINET E/O/C	02072
2.187	REMOVE (E) CABINET E/O/C	02072
2.188	REMOVE (E) CABINET E/O/C	02072
2.189	REMOVE (E) CABINET E/O/C	02072
2.190	REMOVE (E) CABINET E/O/C	02072
2.191	REMOVE (E) CABINET E/O/C	02072
2.192	REMOVE (E) CABINET E/O/C	02072
2.193	REMOVE (E) CABINET E/O/C	02072
2.194	REMOVE (E) CABINET E/O/C	02072
2.195	REMOVE (E) CABINET E/O/C	02072
2.196	REMOVE (E) CABINET E/O/C	02072
2.197	REMOVE (E) CABINET E/O/C	02072
2.198	REMOVE (E) CABINET E/O/C	02072
2.199	REMOVE (E) CABINET E/O/C	02072
2.200	REMOVE (E) CABINET E/O/C	02072

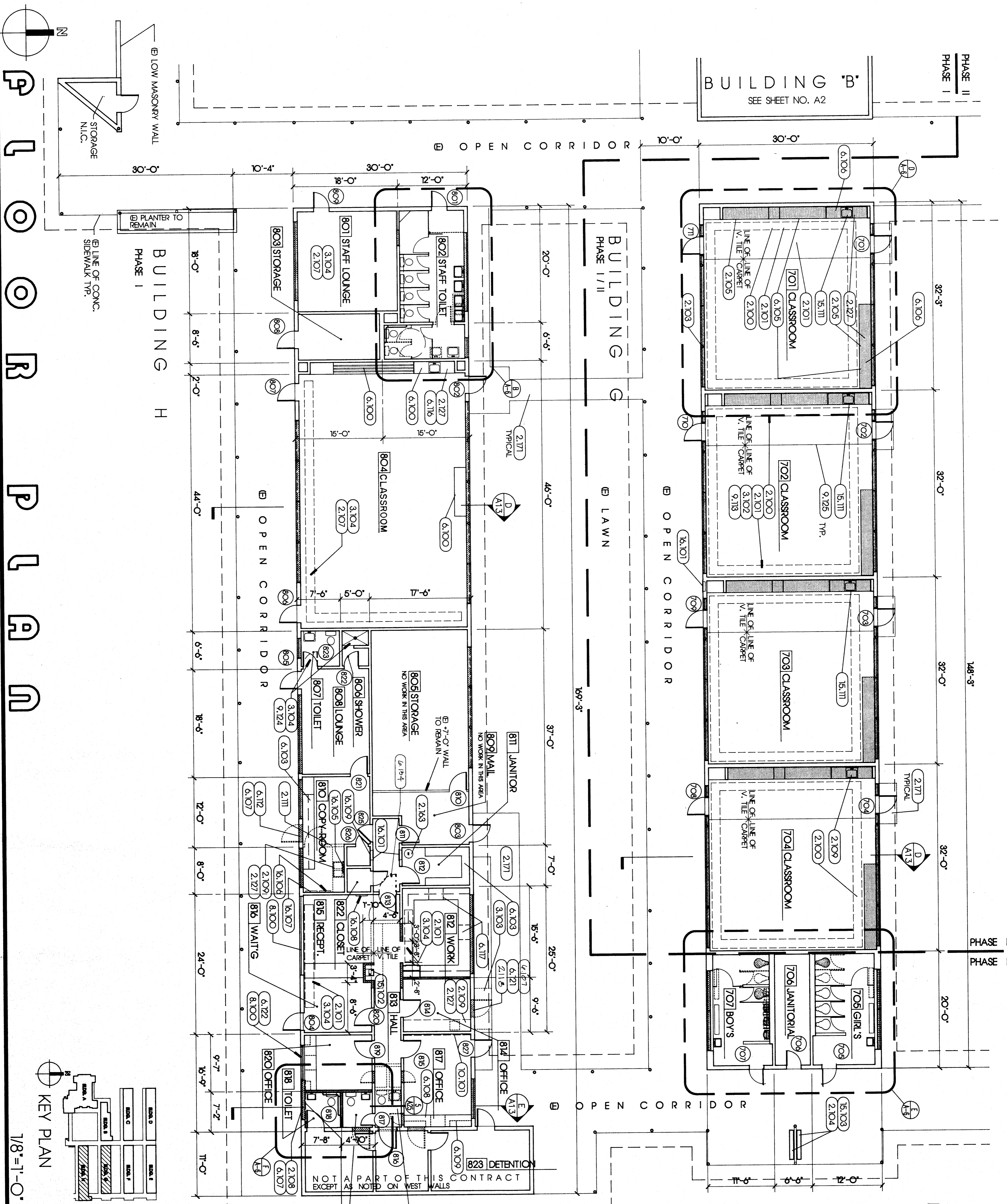

NOTES

- PROVIDE MIN. R-R INSULATION IN CEILING OF ALL BUILDING C & D ROOMS AND ALL IN-FILL CONSTRUCTION OF WALLS OF BUILDING C & D.
- REMOVE (E) DOOR HARDWARE FROM (E) DOORS SCHEDULED TO RECEIVE HARDWARE ONLY. SEE DOOR SCHEDULE.
- REMOVE (E) DOORS & FRAMES. PROVIDE DOORS & FRAMES AS SCHEDULED.
- SAVAGED (E) NOT SCHEDULED TO BE REMOVED TO GREATEST EXTENT POSSIBLE. REINSTALL AS REQUIRED AT CONCRETE PATCH AREAS SCHEDULED TO RECEIVE CARPETING OVER (E) VOT TO PROVIDE UNIFORM SURFACE SUBSTRATE.
- NOTES TYPICAL OF ALL CLASSROOMS EXCEPT AS NOTED.
- THE AREAS DESIGNATED ON THE DRAWINGS IN-DICATING CONCRETE WORK ARE NOT INTENDED TO SHOW THE EXACT EXTENT OF REPAIR WORK. ONLY THE CONTRACTOR SHALL VERIFY THE EXACT EXTENT OF REPAIR WORK PRIOR TO THE START OF REPAIR WORK. REMOVE (E) CONCRETE PATCHES TO BE IN A STATE OF DISPAR REPAIR BEFORE REPAIRABLE REPAIRS, PATCHING & FINISHING.

pechin associates
architects aia

1400 easton drive suite 138
bakersfield, ca 93309 (805)322-2021

Bessie E. Owens School
Modernization
Bakersfield City School District

DATE	ISSUE FOR

DATE	REVISION

THESE DRAWINGS, RELATED SPECIFICATIONS, IDEAS, DESIGNS, AND ARRANGEMENTS REPRESENTED THEREBY ARE AND SHALL REMAIN THE PROPERTY OF THE ARCHITECT; AND NO PART THEREOF SHALL BE COPIED, DISCLOSED TO OTHERS OR USED IN CONNECTION WITH ANY WORK OR PROJECT OTHER THAN THE SPECIFIC PROJECT FOR WHICH THEY HAVE BEEN PREPARED AND DEVELOPED WITHOUT THE WRITTEN CONSENT OF THE ARCHITECT. VISUAL CONTACT WITH THESE DRAWINGS OR SPECIFICATIONS SHALL CONSTITUTE CONCLUSIVE EVIDENCE OF ACCEPTANCE OF THESE RESTRICTIONS.

WRITTEN DIMENSIONS ON THESE DRAWINGS SHALL HAVE PRECEDENCE OVER SCALED DIMENSIONS; CONTRACTORS SHALL VERIFY AND BE RESPONSIBLE FOR ALL DIMENSIONS AND CONDITIONS ON THE JOB AND THIS OFFICE MUST BE NOTIFIED OF ANY VARIATIONS FROM THE DIMENSIONS AND CONDITIONS SHOWN BY THESE DRAWINGS.

DETAILED SHOP DRAWINGS MUST BE SUBMITTED TO THIS OFFICE FOR REVIEW BEFORE PROCEEDING WITH THE FABRICATION OF ANY PRODUCT TO BE INCLUDED IN THIS PROJECT.