

P L O O R P L A N

1/8" = 1'-0"

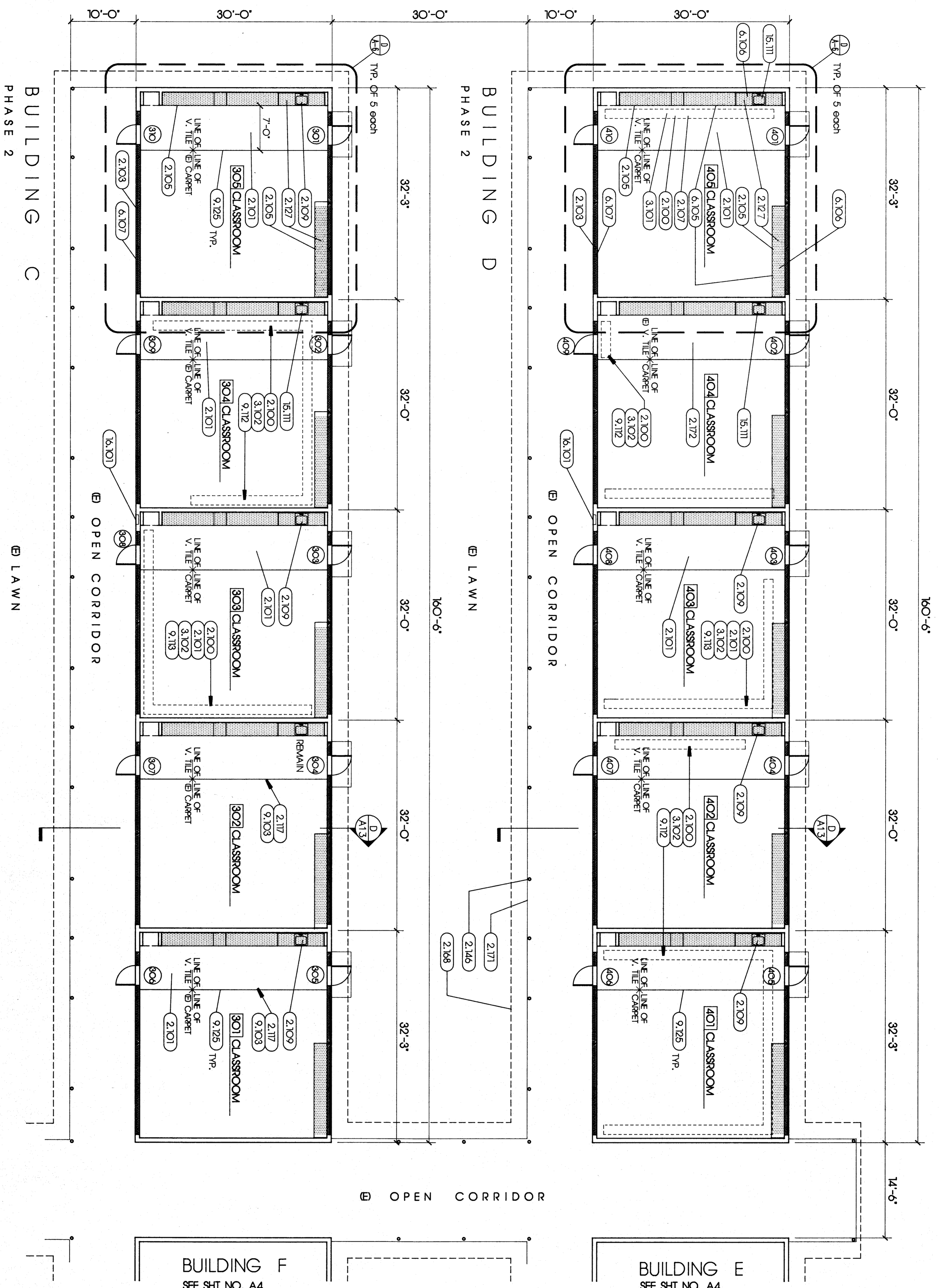

KEY NOTES

- 2.100 SANCTUARY REMOVE DAMAGED 02072
- 2.101 REMOVE (E) VINYL COMPOSITION 02072
- 2.103 TILE (VCT) AS REQUIRED 02072
- 2.105 REMOVE (E) CABINET DOOR 02072
- 2.109 REMOVE DAMAGED VINYL TILE 02072
- 2.109 PLANS (E) SIMS; SEE FLOORING 02072
- 2.117 CRT & REMOVE (E) CARPET AS 02072
- 2.127 REMOVE (E) CABINET F/OB 02072
- 2.144 CONCRETE TO REMAIN 02072
- 2.146 REMOVE (E) OVERHANG 02072
- 2.171 (E) CONCRETE WALK TO REMAIN 02072
- 2.172 (E) VCT TO REMAIN EXCEPT AS 02072
- 3.101 CONCRETE TO REMAIN (E) ACCEPTABLE 02072
- 3.102 AS FLOORING SUBSTRATE 02072
- 6.105 PLASTIC LAMINATE CABINET DOOR 02072
- 6.106 REMOVE (E) VCT UNDER CABINET AS 02072
- 6.107 INFLIT (E) OPEN G W/2x6 STUDS 02072
- 8.10 O.C. 02072
- 9.103 VINYL COMPOSITION (VCT) 09650
- 9.112 FLOORING VCT UNDER (E) VCT IS 09650
- 9.113 REMOVE (E) VCT UNDER CABINET AS 09650
- 9.125 CARPET EDGE 09650
- 15.111 REINFORCEMENT (E) PLASTERING 15400
- 15.112 FLYTIMERS; SEE PLUMBING PLANS 15400
- 16.101 (E) ELECTRICAL PANEL 16200

NOTES

- PROVIDE MIN. R-10 INSULATION IN CEILING OF ALL BUILDING C & D ROOMS AND ALL INFILL CONSTRUCTION OF WALLS OF BUILDING C & D.
- REMOVE (E) DOOR HARDWARE FROM (E) DOORS SCHEDULED TO RECEIVE HARDWARE ONLY. SEE DOOR SCHEDULE.
- REMOVE (E) DOORS & FRAMES. PROVIDE DOORS & FRAMES AS SCHEDULED.
- SALVAGED (E) VCT SCHEDULED TO BE REMOVED TO GREATEST EXTENT POSSIBLE. REINSTALL AS REQUIRED TO CLASSROOMS (E) VCT TO PROVIDE UNIFORM SURFACE SUBSTRATE.
- NOTES TYPICAL OF ALL CLASSROOMS EXCEPT AS NOTED.
- THE AREAS DESIGNATED ON THE DRAWINGS INDICATING CONCRETE WORK ARE NOT INTENDED TO SHOW THE EXACT EXTENT OR AREA OF WORK BUT IS SHOWN FOR CONTRACTOR'S REFERENCE. THE CONTRACTOR SHALL INFER THE EXACT START OF REMOVAL SAWCUT & REMOVE (E) CONCRETE VERIFIED TO BE IN A STATE OF DISPERAIR BEYOND REASONABLE REMEDIAL PATCHING & GRINDING.

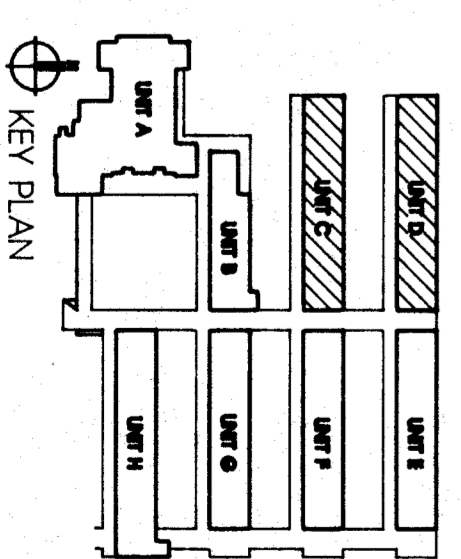

<p>pechin associates aia</p> <p>1400 easton drive suite 138 bakersfield, ca 93309 (805)322-2021</p>	<p><i>Jarvis C. Pechin</i> C-8366</p> <p>Bessie E. Owens Elementary School Modernization Bakersfield City School District</p>	DATE	ISSUE FOR	<p>THESE DRAWINGS, RELATED SPECIFICATIONS, IDEAS, DESIGNS, AND ARRANGEMENTS REPRESENTED THEREBY ARE AND SHALL REMAIN THE PROPERTY OF THE ARCHITECT; AND NO PART THEREOF SHALL BE COPIED, DISCLOSED TO OTHERS OR USED IN CONNECTION WITH ANY WORK OR PROJECT OTHER THAN THE SPECIFIC PROJECT FOR WHICH THEY HAVE BEEN PREPARED AND DEVELOPED WITHOUT THE WRITTEN CONSENT OF THE ARCHITECT. VISUAL CONTACT WITH THESE DRAWINGS OR SPECIFICATIONS SHALL CONSTITUTE CONCLUSIVE EVIDENCE OF ACCEPTANCE OF THESE RESTRICTIONS.</p> <p>WRITTEN DIMENSIONS ON THESE DRAWINGS SHALL HAVE PRECEDENCE OVER SCALED DIMENSIONS; CONTRACTORS SHALL BE RESPONSIBLE FOR ANY VARIATIONS FROM THE DIMENSIONS AND CONDITIONS SHOWN BY THOSE DRAWINGS.</p> <p>DETAILED SHOP DRAWINGS MUST BE SUBMITTED TO THIS OFFICE FOR REVIEW BEFORE PROCEEDING WITH THE FABRICATION OF ANY PRODUCT TO BE INCLUDED IN THIS PROJECT.</p>
		DATE	REVISION	