

SOUTH KING STREET

OWENS STREET

ADJACENT CITY OF BAKERSFIELD PARKS & RECREATION
(MARTIN LUTHER KING PARK)

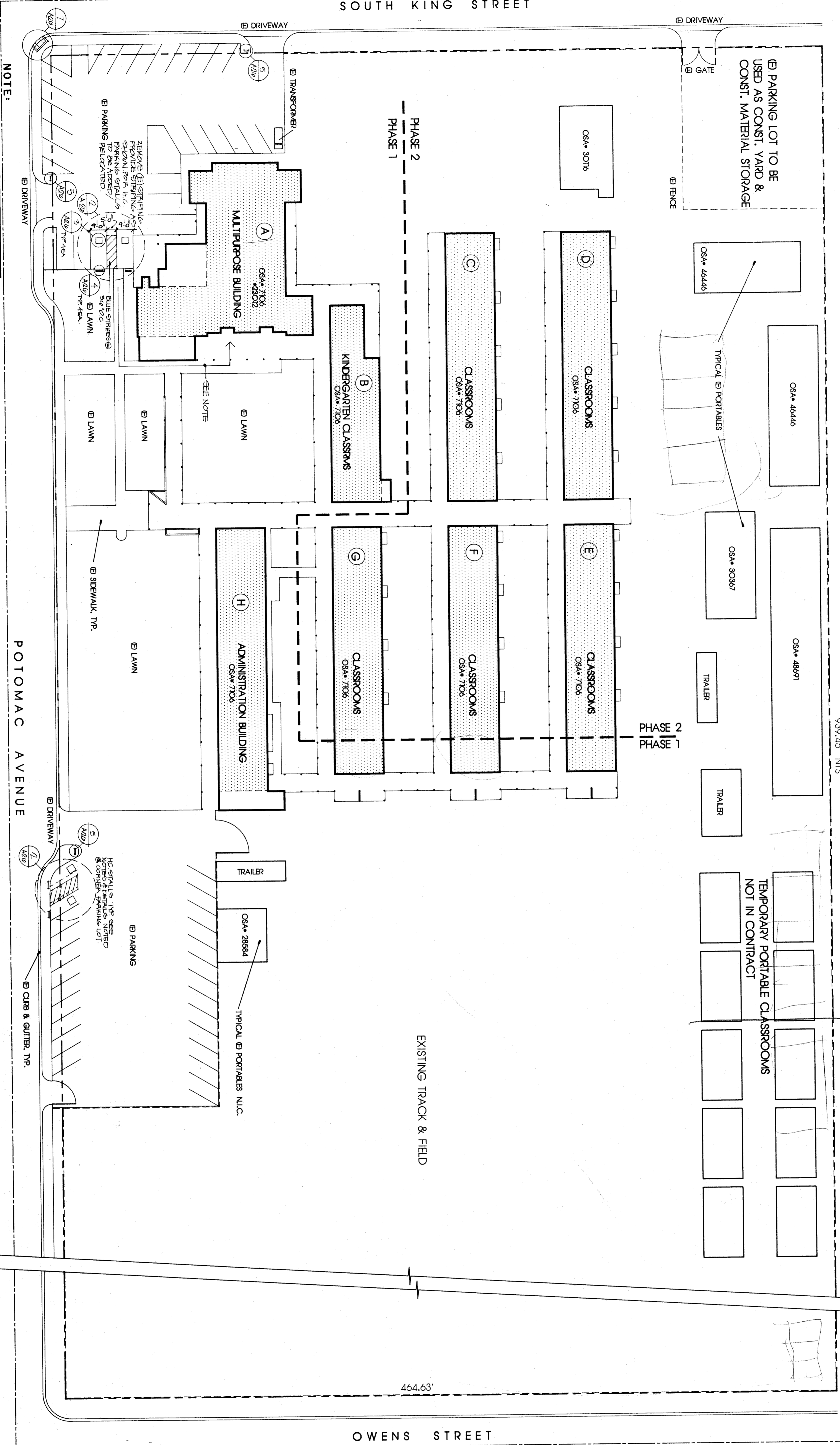

NOTE:
GENERAL CONTRACTOR SHALL VERIFY AND PROVIDE AS REQUIRED BARRIER-FREE PATHS TRAVEL WITH 2% MAX. SLOPE OR COMPLY WITH REQUIREMENTS FOR PEDESTRIAN RAMPS.

LEGEND

- WORK UNDER THIS CONTRACT
- NOT IN CONTRACT
- BUILDING DESIGNATION

SITE PLAN

1/32" = 1'-0"

pechin associates architects aia
Jarvis C. Pechin
 1400 easton drive suite 138
 bakersfield, ca 93309 (805) 322-2021

Bessie E. Owens Elementary School Modernization
 Bakersfield City School District

DATE	ISSUE FOR
DATE	REVISION

THESE DRAWINGS, RELATED SPECIFICATIONS, IDEAS, DESIGNS, AND ARRANGEMENTS REPRESENTED THEREBY ARE AND SHALL REMAIN THE PROPERTY OF THE ARCHITECT, AND NO PART THEREOF SHALL BE COPIED, DISCLOSED TO OTHERS OR USED IN CONNECTION WITH ANY WORK OR PROJECT OTHER THAN THE SPECIFIC PROJECT FOR WHICH THEY HAVE BEEN PREPARED AND DEVELOPED WITHOUT THE WRITTEN CONSENT OF THE ARCHITECT. VISUAL CONTACT WITH THESE DRAWINGS OR SPECIFICATIONS SHALL CONSTITUTE CONCLUSIVE EVIDENCE OF ACCEPTANCE OF THESE RESTRICTIONS.

WRITTEN DIMENSIONS ON THESE DRAWINGS SHALL HAVE PRECEDENCE OVER SCALED DIMENSIONS; CONTRACTORS SHALL VERIFY AND BE RESPONSIBLE FOR ALL DIMENSIONS AND CONDITIONS ON THE JOB AND THIS OFFICE MUST BE NOTIFIED OF ANY VARIATIONS FROM THE DIMENSIONS AND CONDITIONS SHOWN BY THESE DRAWINGS.

DETAILED SHOP DRAWINGS MUST BE SUBMITTED TO THIS OFFICE FOR REVIEW BEFORE PROCEEDING WITH THE FABRICATION OF ANY PRODUCT TO BE INCLUDED IN THIS PROJECT.