

**SHEET NOTES**

- NOTES ON THIS SHEET ARE TO BE USED ON THIS SHEET ONLY.
- ① WALL MOUNTED CAMERA. SEE TITLE SHEET FOR ADDITIONAL INFORMATION.
  - ② INTERCOM HORN. SEE TITLE SHEET FOR ADDITIONAL INFORMATION.
  - ③ (N) REAX IDF LOCATION. SEE TITLE SHEET FOR ADDITIONAL INFORMATION.
  - ④ (E) MDF. SEE TITLE SHEET FOR ADDITIONAL INFORMATION. (#03-120098)

AGENCY INFORMATION:

AGENCY TRACKING NO. 63321-356  
 FILE NO. 15-6

IDENTIFICATION STAMP  
 DIV. OF THE STATE ARCHITECT  
 OFFICE OF REGULATION SERVICES  
**03-120240**  
 AC. PLS. SS. 17  
 DATE: JAN 02 2020

SEAL

**COPYRIGHT:**  
 Any reproduction or distribution for any purpose other than authorized by IBI Group is forbidden.

**REVISIONS**

NO.	DATE SUBMITTED	DATE APPROVED	DESCRIPTION

CONSULTANT

*Fred Brakeman*

**INFINITY**  
 COMMUNICATIONS AND CONSULTING

PO BOX 6069, BAKERSFIELD CA 93386  
 Ph: 663716-1840 FX: 663716-1841  
 www.infinitycomm.com

PRIME CONSULTANT

**IBI** ARCHITECTURE PLANNING

**San Luis Obispo**  
 4119 Broad Street, Suite 210  
 San Luis Obispo, CA 93401  
 805.546.0433 fax: 805.546.0504  
 ibigroup.com

BAKERSFIELD CITY SCHOOL DISTRICT

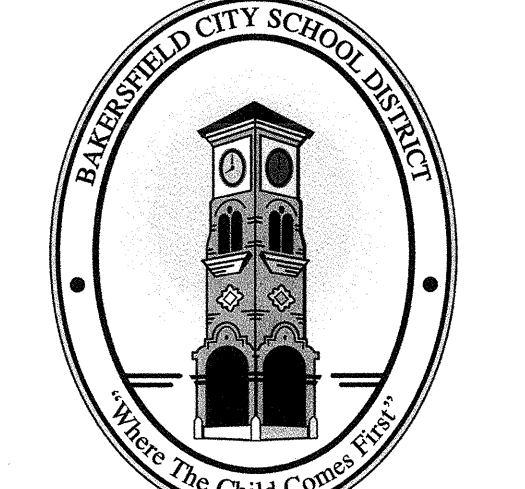

**BESSIE OWENS E.S. KINDERGARTEN MODULAR BUILDINGS**  
 815 POTOMAC AVE, BAKERSFIELD, CA 93307

OPSC or OSHPD PROJ. NO.:	N/A
PROJECT NO.:	118932
DRAWN BY:	Author
CHKD BY:	Checker
ISSUE DATE:	08/27/2019

**SITE PLAN**

SHEET NUMBER

**T0.1**

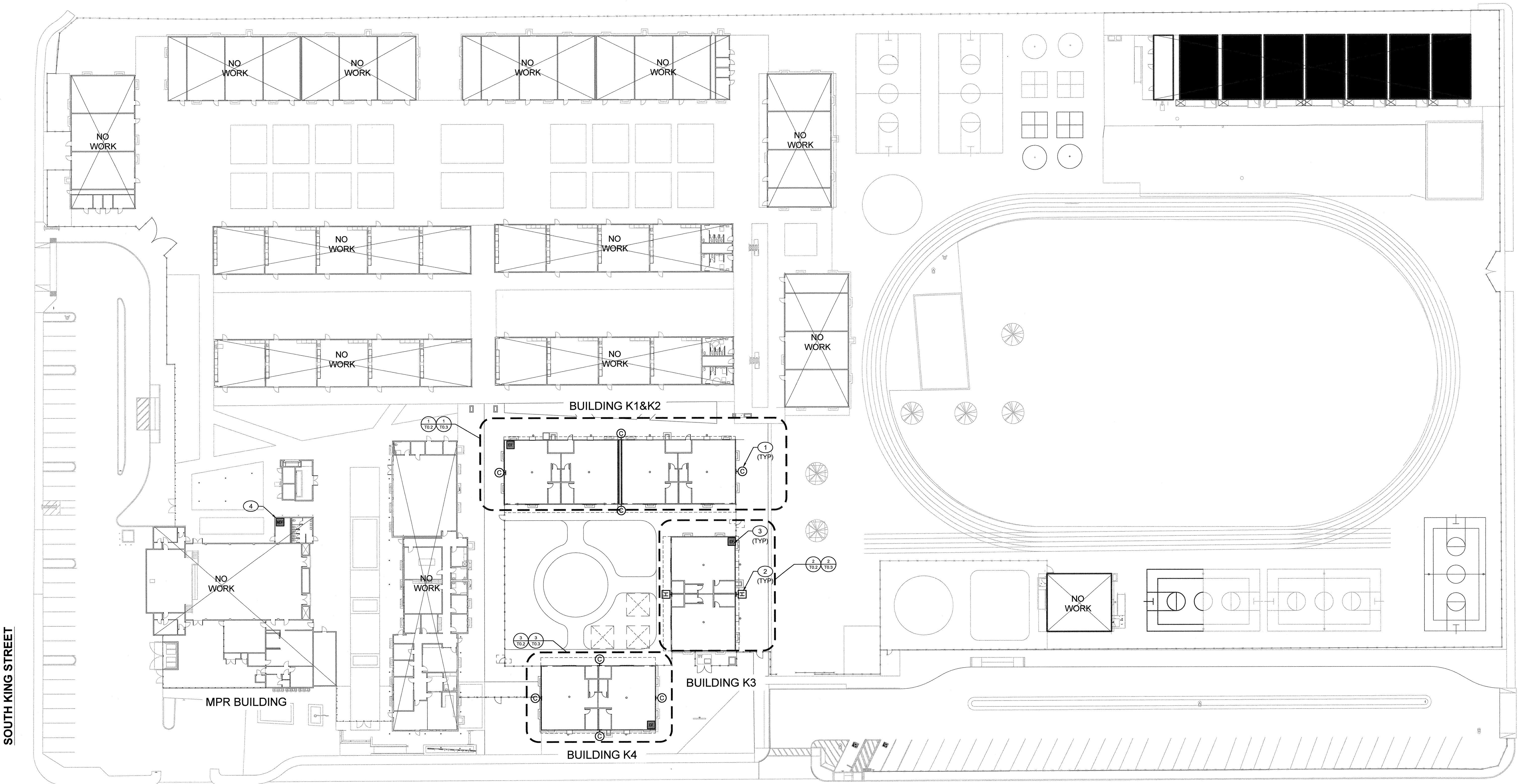

SOUTH KING STREET

OWENS STREET

POTOMAC AVENUE

① BESSIE OWENS E.S. PHASE II - SITE PLAN  
 1" = 30'-0"

CONSTRUCTION DOCUMENTS

PLOT DATE: 2019-10-21 12:02:08 PM C:\Users\rausen\OneDrive\Documents\ATW-118932-SITE\Documents\T0.1 - CENTRAL\_rbaen.rvt